

advanced FLOW engineering

Instruction Manual P/N: 46-70212 (AOD)

Make: **Ford** Model: **F-Series Pickups** Year: **1980-1992** Engine: **V8-5.0L/5.8L**



- Please read the entire instruction manual before proceeding.
- Ensure all components listed are present.
- If you are missing any of the components, call customer support.
- Ensure you have all necessary tools before proceeding.
- Do not attempt to work on your vehicle when the engine is hot.

Retain factory parts for future use.

Label	Qty.	Description	Part Number
A	1	Transmission Pan - Machined Fins	05-60369
B	14	M8 x 1.25 x 25mm bolt	03-50231
C	14	M8 Washer	03-50228
D	1	3/4" NPT Plug	03-50222
E	1	1/8" NPT Plug	03-50029
F	1	M6 x 1.0 x 8mm bolt	03-50407
G	1	Fender Washer	03-50412
H	1	Gasket	05-60459

Installation will require the following tools:

10mm socket, Socket driver (ratchet), 1/2" Extension, 1/2" Ratchet, 3/16" allen wrench, 6mm allen wrench, 4mm allen wrench, thread locker, teflon tape, lint-free rags.

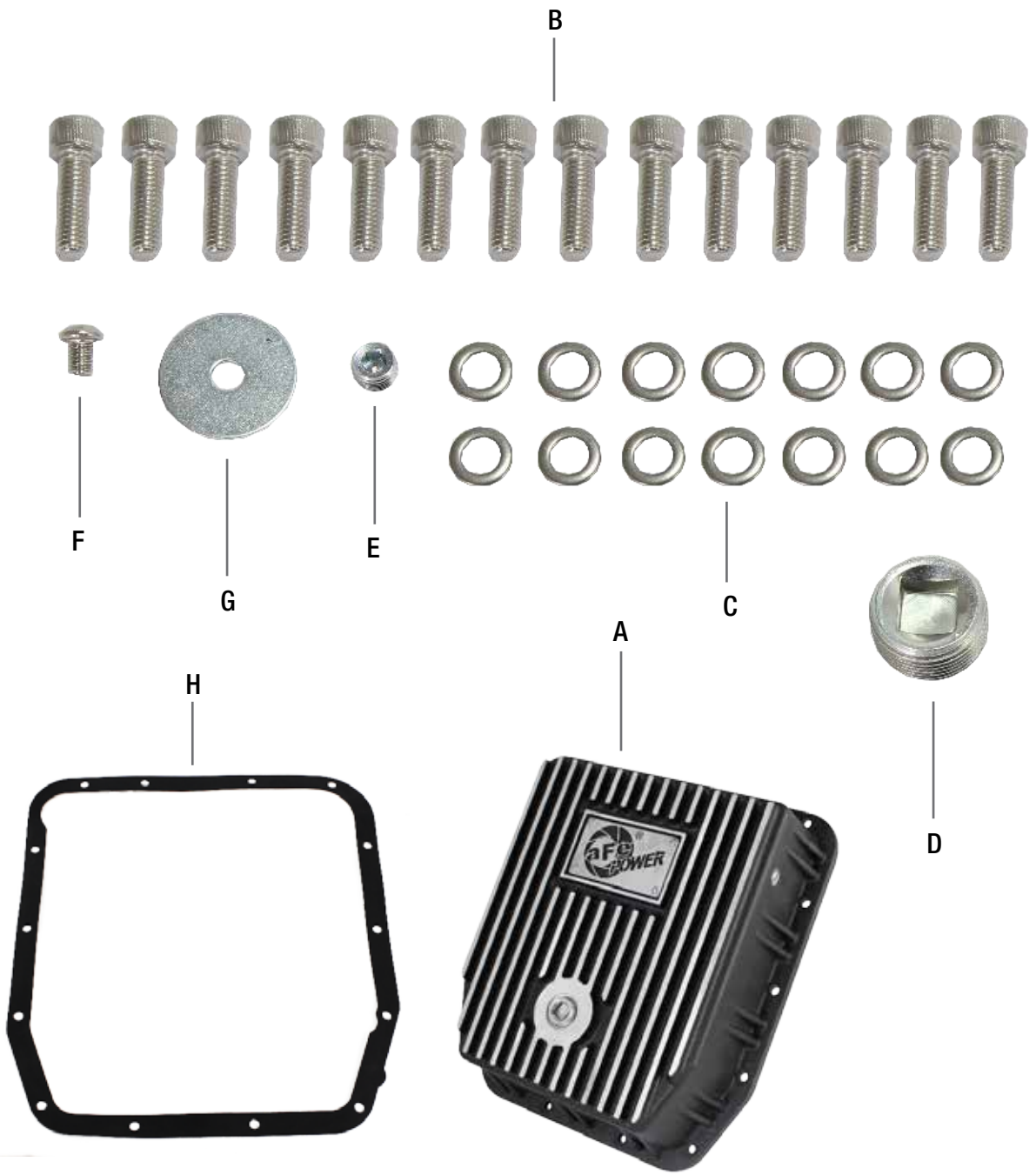

**Figure A****Refer to Figure A for steps 1-2**

Step 1: Park vehicle on flat, dry surface and engage the parking brake.

Step 2: Using a 10mm socket, remove the 14 bolts holding the transmission pan. As you remove the transmission pan bolts, the fluid will start to drain.



REMOVAL

Figure B

Refer to Figure B for steps 3-5

aFe recommends replacing filter at this time with the deep sump 4x4 filter

Step 3: Remove the stock filter from the transmission.

Step 4: Wipe any residual transmission fluid from the transmission with a lint-free rag.

Step 5: Install the transmission filter into the transmission.

**Figure C****Refer to Figure C for step 6-7**

Step 6: Remove the magnet from the stock pan.

Step 7: Install the magnet on the aFe transmission pan and retain using the supplied M6 x 1.0 x 8mm bolt and fender washer. Make sure to use a drop of thread locker on the bolt and carefully tighten.

INSTALL



Figure D

Refer to Figure D for step 8-10

Step 8: Install teflon tape on the 3/4" NPT plug, and on the 1/8" NPT plug.

Step 9: Use a 3/16" allen wrench, install the 1/8" NPT plug into the transmission pan.

Step 10: Using a 1/2" extension and a 1/2" ratchet, install the 3/4" NPT plug into the transmission pan.

**Figure E****Refer to Figure E for step 11-12**

Step 11: Using the supplied gasket, install the aFe transmission pan using a 6mm allen wrench and 14 - M8 x 1.25 x 25mm bolts and 14 - M8 washers.

Step 12: Tighten the bolts in a criss-cross pattern to 12-14lb-ft.



Figure F

Refer to Figure F for steps 13-14

Step 13: The transmission dipstick is located in the engine compartment. Fill the transmission to the factory specifications using the recommended oil. Reinstall dipstick.

***Note: The aFe pan holds approximately 7 quarts of transmission fluid. (2-3 more quarts than stock).**

Step 14: Your installation is now complete.

***Transmission fluid expands. Always check oil level per factory recommendations when the truck is hot.**

***Caution*: A running truck will be hot. Take every precaution necessary to prevent being burned.**



Transmission Filter



P/N:44-TF003

aFe Power Hat



P/N: 40-10083

aFe Diesel Tee



P/N: 40-30221 (M)
P/N: 40-30222 (L)
P/N: 40-30223 (XL)
P/N: 40-30224 (2XL)
P/N: 40-30225 (3XL)

aFe Power Backpack



P/N: 40-33203

Watch G-Shock



P/N: 40-10125