

How to Switch to Amber Daytime Running Light (DRL) for AlphaRex 04-08 Ford F150 / 06-08 Lincoln Mark LT Headlights

Table of Contents

- AMBER SWITCH PLUGS LOCATION
- CONNECT THE AMBER SWITCH PLUGS
- COMPLETE SWITCHING INTO AMBER DRL & PARKING LIGHTS

Disclaimer: This installation article is a tutorial guide. By reading this article, you agree it is for reference only and AlphaRex USA and its distributors make no guarantee on the finished results. Under no circumstances whatsoever shall AlphaRex USA nor its distributors be liable for any damage, misuse or personal injuries. If you do not fully understand the installation procedure, it is highly recommended that you seek help from professional mechanics to do the installation.

This instruction guide is applicable to the following ALPHAREX headlight products:

04-08 Ford F150 / 06-08 Lincoln Mark LT NOVA-Series LED Projector Headlights (Alpha-Black) / SKU: 880130
04-08 Ford F150 / 06-08 Lincoln Mark LT NOVA-Series LED Projector Headlights (Chrome) / SKU: 880129
04-08 Ford F150 / 06-08 Lincoln Mark LT NOVA-Series LED Projector Headlights (Black) / SKU: 880128
04-08 Ford F150 / 06-08 Lincoln Mark LT LUXX-Series LED Projector Headlights (Alpha-Black) / SKU: 880133
04-08 Ford F150 / 06-08 Lincoln Mark LT LUXX-Series LED Projector Headlights (Chrome) / SKU: 880132
04-08 Ford F150 / 06-08 Lincoln Mark LT LUXX-Series LED Projector Headlights (Black) / SKU: 880131

In the product list, the LUXX-Series and the NOVA-Series headlights designed for the 2004-08 Ford F150 | 2006-08 Lincoln Mark LT offer an optional switch plug, allowing you to customize the color of the Daytime Running Lights (DRL) and Parking lights to Amber (Yellow). By default, these lights come in White from the factory.

Customers have the flexibility to choose Amber (Yellow color) based on their preference. PLEASE NOTE: Once you have plugged in and switched to Amber, the color of the Daytime Running Lights (DRL) and Parking lights will remain in Amber (Yellow color).



AMBER SWITCH PLUGS LOCATION

To access, open the dust cover at the back of each ALPHAREX headlight.



Within the headlight assembly, locate the plug connectors designed for transitioning the DRL (Daytime Running Lights) and Parking lights into Amber (Yellow color).

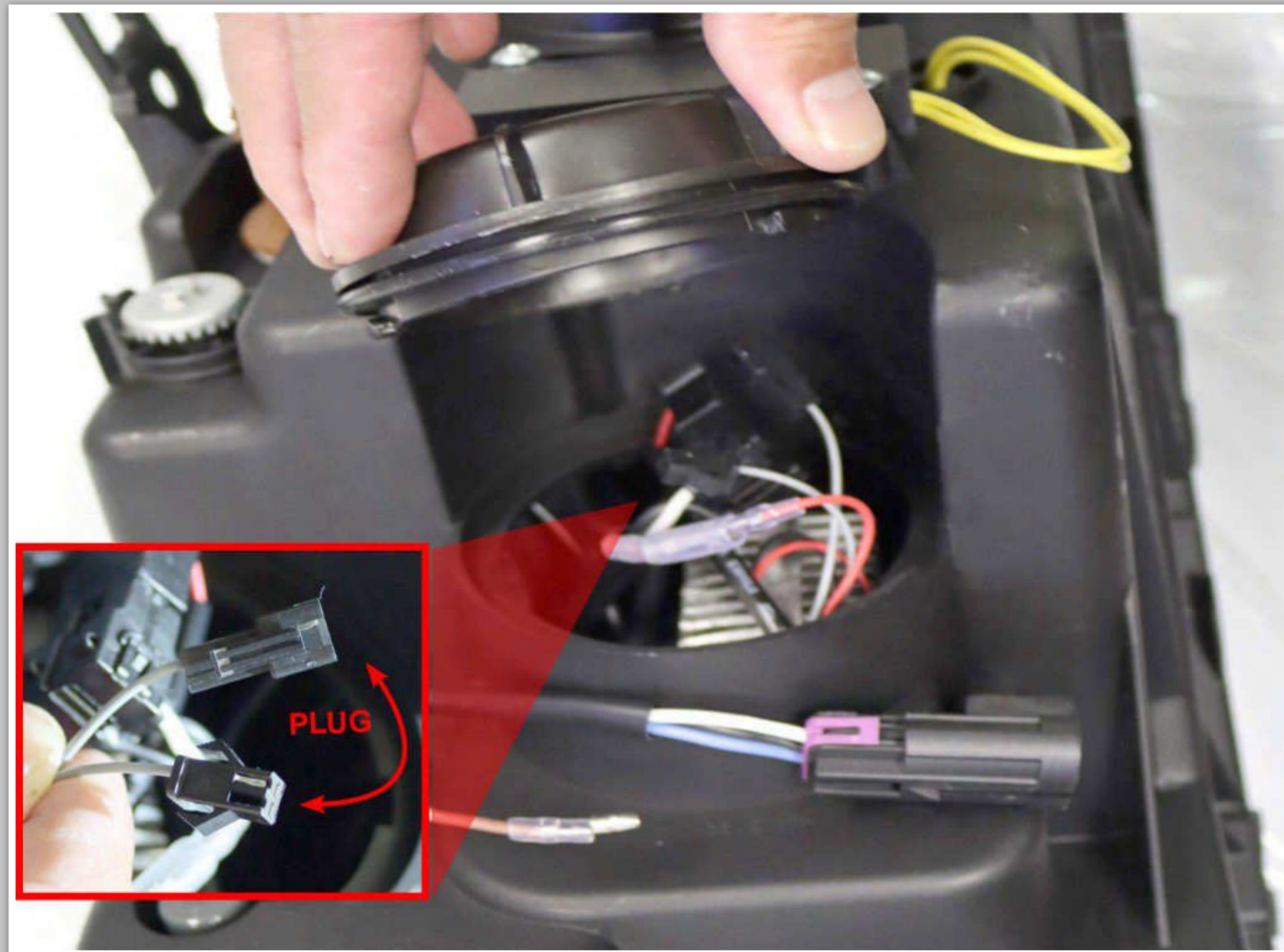

CONNECT THE AMBER SWITCH PLUGS

Connect the amber DRL plugs inside each headlight set, ensuring a secure and proper connection between them. DO NOT USE DIELECTRIC GREASE!

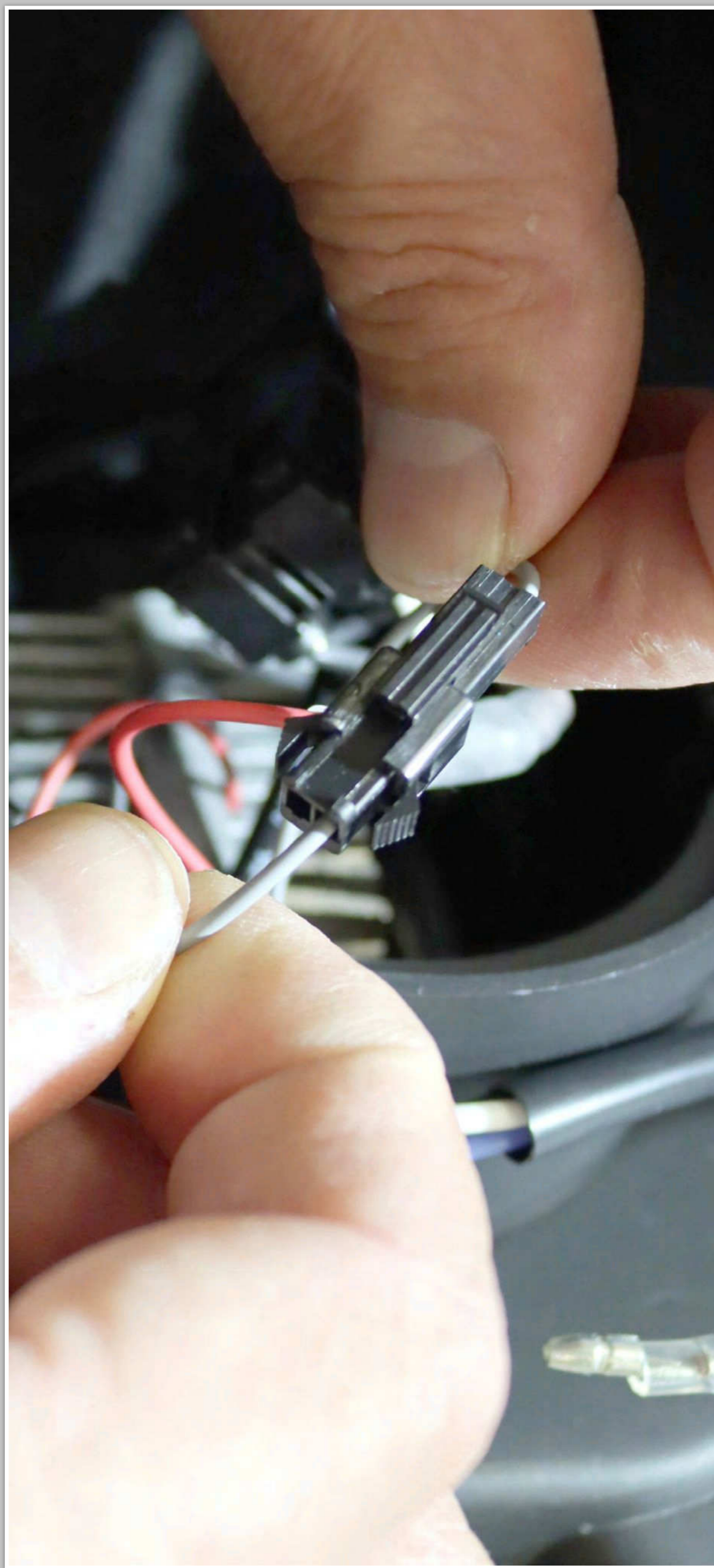

COMPLETE SWITCHING INTO AMBER DRL & PARKING LIGHTS

After plugging in the connection, reinstall the headlights onto the vehicle. Congratulations! You have successfully switched to Amber (Yellow color) Daytime Running Lights (DRL) and Parking lights.

