



American
SHIFTER COMPANY



THE NEW *Dual-Action*

The all-new American Shifter Dual-Action Shifter assembly has everything you need in a shifter! Which do you prefer—a side action shifter, or a push button shifter?

The American Shifter has both.

Shift however you want.

Use any knob you want.

The Dual-Action shifter features all of the convenience of any other shifter, but without the limitations.

SHIFTER

*patent pending

Push Button Shift
OR
Side Action Shift

**BOTH OPTIONS WITH
ONE MECHANISM!**

**EXTENDED MOUNTING PLATE
Mid or Rear Mount in One Kit!**



**NEUTRAL
SAFETY
SWITCH**

Precision-Engineered Shifter Assembly

- **Positive Lockout in Park & Neutral**
- **Teflon-Smooth Button Action**
- **Removable Stick**
- **Use Any Knob**
- **Includes All Hardware**



Shifter Stick Variety

The American Shifter dual-action shifter works with any length or shaped shifter you want. We've got the whole range from 23" double bend shifters to 6" straight shifters. Get the leg room, leverage and shifter feel you want.



Side Shift Adapter

The Side Shift Adapter is the amazing mechanism that allows you to have the dual-action shifting that's not only the best of both worlds, is the best of ALL worlds. It's made to be super heavy-duty- it's a machined chunk of steel! Long live the super smooth shifting action!

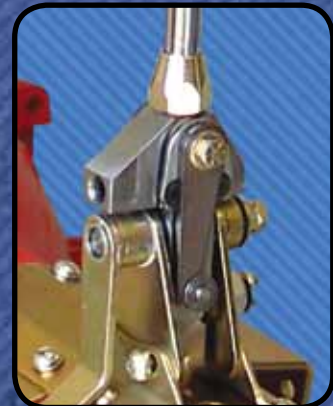

*patent pending

ASCS2 - # 96139

Shifter Kit Selection Chart

Simply follow the steps below to find out your ordering code for the shifting kit of your choice.

1 Choose your desired shifter action:

- 1 Push Button (*single action*)
- 2 Push Button & Side Shift (*dual action*)

3 Choose the shifter arm style:

- 06N 6" Straight
- 08N 8" Single Bend
- 10S 10" Single Bend
- 12S 12" Single Bend
- 16S 16" Single Bend
- 23S 23" Single Bend
- 23D 23" Dual Bend

2 Choose the correct application:

- F1 Ford C4
- F2 Ford C6
- F3 Ford FMX
- F4 Ford AOD
- G1 GM 4L60
- G2 GM 4L60 E
- G3 GM 4L80 (E)
- G4 GM 400 TH
- G5 GM 700 R4
- G6 GM 350 (TH)
- G7 GM 200R4
- G8 GM TH-200
- G9 GM Powerglide
- C1 Chrysler 727
- C2 Chrysler 904
- C3 Chrysler 518
- C4 Chrysler 45RFE / 54RFE

4 Choose the knob that comes with the kit:

- 1 Black
- 2 Billet

5 Fill in the blanks below to create the ordering code that's right for you and right for your ride:

Code Prefix	Shifter Action	Trans. App.	Shifter Arm	Knob Type	Ordering Code:		
ASCS +	<input type="text"/>	+	<input type="text"/>	+	<input type="text"/>	=	<input type="text"/>

Example: If you wanted a dual-shifter for a Ford AOD transmission with a 23" dual-bend shifter arm and a billet knob, your ordering code would be **ASCS2F423D2**

Limited Edition Series Shift Knobs

There is no look more unique or eye catching than these custom, hand-crafted shift knobs made by various automotive artists. Each knob is made out of durable resins and vividly colored for years of unrivaled and uncommon individuality.



HAND-PAINTED



INCLUDED THREADED BASE



Tiny Tiki™

2.25" x 2.25" x 2.25"
ASCSN00002 - # 14611



Johnny Tiki™

3.5" x 2" x 2"
ASCSN00001 - # 14610



Vintage Keg Barrel™

2.25" x 2" x 2"
ASCSN00003 - # 14612



Aldo™ Aztec Tiki

3.6" x 2.6" x 2.75"
ASCSN00019 - # 95998



Boom Boom™ Fuse Bomb

4.75" x 2.6" x 2.6"
ASCSN00007 - # 14616



TikiApple™ Pineapple Tiki

5" x 2.75" x 3"
ASCSN00008 - # 14617



Frank-o-Pirate™ Skull
3.25" x 2.75" x 3.5"
ASCSN00009 - # 14649



El Diablo™ Devil
2.6" x 2.3" x 2.4"
ASCSN00010 - # 14650



FrankenSpeed™
3.25" x 2.4" x 2.5"
ASCSN00011 - # 14651



VonWolf™
2.5" x 3.4" x 2"
ASCSN00005 - # 14613



Petey O Piston™
4" x 2.5" x 3.3"
ASCSN00021 - # 96204



Timmy the Top Hat Skull™
3.75" x 2.3" x 5.4"
ASCSN00022 - # 96214



TicBom™
4" x 1.8" x 2.25"
ASCSN00012 - # 14668



Royal Crown™
2.4" x 2.9" x 2.9"
ASCSN00013 - # 14669



Crushed Beer Can™
4.6" x 3" x 3"
ASCSN00015 - # 14671





Grippy™ 8 Ball Zombie Hand

2.6" x 4.5" x 2"
ASCSN00026 - # 54881



Candy™ Blonde Naked Lady

7.5" x 2.25" x 2.4"
ASCSN00017 - # 14673



Cindy™ Brunette Naked Lady With Tattoos

7.5" x 2.25" x 2.4"
ASCSN00018 - # 14674



Spark Plug Wire™

2.7" x 6.5" x 1.85"
ASCSN00014 - # 14670



Flying Eye Ball™

2.5" x 7" x 3.5"
ASCSN00016 - # 14672



Marvin The Mummy™

2.6" x 2.5" x 2.5"
ASCSN00024 - # 54553



Quick Draw™ Pistol Grip

5" x 1.4" x 4.25"
ASCSN00031 - # 54891



German WWII Helmet™

3.7" x 3.1" x 2.2"
ASCSN00023 - # 96215



Mud Flap Girl™

5" x 2.7" x 7.25"
ASCSN00020 - # 95999



Taz The Charging Goat™

3.3" x 4.12" x 2.3"
ASCSN00025 - # 54559



**Sack-O-Cash™
Bag Of Money**

5" x 2.3" x 2"
ASCSN00032 - # 55915



Noz™ Skull

4" x 3.1" x 2.8"
ASCSN00030 - # 54889



Osama Bin Hidin™

4" x 2.5" x 3.75"
ASCSN00033 - # 76510



Sammie™ Shrunkin Head™

3.15" x 3" x 4"
ASCSN00027 - # 54883



Munch™ Skull

3.3" x 2.56" x 3"
ASCSN00028 - # 54885



The Boss™ Monkey

3" x 3.1" x 2.8"
ASCSN00029 - # 54887



BAM™ Dynamite

9.65" x 2.3" x 2.6"
ASCSN00006 - # 14615



Air Bag™

2.75" x 2.25" x 2.25"
ASCSN00034 - # 00855



Pineapple Grenade™

4.4" x 2.25" x 2.1"
ASCSN05001 - # 28127



Plum Grenade™

3.6" x 2.6" x 2.25"
ASCSN05002 - # 28128



Grenade™

4" x 2.4" x 2.25"
ASCSN05003 - # 28129



Skulls n Bones™ Series

Large Skull Shift Knobs

What a bunch of characters! With such a large variety, these skull shift knobs are sure to tickle any passenger's funny bone. With durably painted features and incredible detail, your custom skull shift knob will look as nice years from now as it did the day you got it. Every time you shift out of park you'll be reminded you're cruising a one-of-a-kind ride. Adapter not included, drill to fit.



Skullvis II™
ASCNS06058 - # 00066



Dirty Potter Skull™
ASCNS06035 - # 00044



Hill Billy Skull™
ASCNS06036 - # 00045



Chopper Biker Skull™
ASCNS06034 - # 00043



Midnight Rider Skull™
ASCNS06033 - # 00042



Mr. Dean™
ASCNS06070 - # 00078



Che Skull™
ASCNS06057 - # 00065



Skater Skull™
ASCNS06006 - # 00015



DJ Skull™
ASCNS06073 - # 00082



Mullet Man Skull™
ASCNS06037 - # 00046



EZ Rider Biker Skeleton™
ASCNS06019 - # 00028



Super Skull™
ASCNS06038 - # 00047



Betty Sue™
ASCNS06039 - # 00048



Skulldam Hussein™
ASCSN06020 - # 00029



Skull Racer Joe™
ASCSN06041 - # 00050



Captain Jack™
ASCSN06044 - # 00052



El Bandito™
ASCSN06045 - # 00053



Marilyn Skull™
ASCSN06056 - # 00064



Hail Caesar™
ASCSN06046 - # 00054



Republican™
ASCSN06051 - # 00059



Democrat™
ASCSN06050 - # 00058



Groom™
ASCSN06072 - # 00081



Dirty Bride Skull™
ASCSN06048 - # 00056



Skull King™
ASCSN06047 - # 00055



Queen Skull™
ASCSN06049 - # 00057



Kurt Skullbain™
ASCSN06054 - # 00062



Skull Slash™
ASCSN06052 - # 00060



Indy Skull™
ASCSN06055 - # 00063



Zapata Skull™
ASCSN06053 - # 00061



Small Skull Shift Knobs

Every ounce of the glory of the large knobs, yet compressed into a smaller form. Adapter not included, drill to fit.



Jungle Camo Skull™
ASCSN06030 - # 00039*



Desert Camo Skull™
ASCSN06031 - # 00040*



Urban Camo Skull™
ASCSN06029 - # 00038*



Skull With Red Eyes™
ASCSN06059 - # 00067*



Slick Skull With Bandana™
ASCSN06003 - # 00012



Willy Wonka Skull™
ASCSN06016 - # 00025



Skull With Eyes™
ASCSN06061 - # 00069*
rubber insert included



Dr Skull™
ASCSN06010 - # 00019



Wicked Bride™ Skull
ASCSN06012 - # 00021



Yar! Buccaneer Skull™
ASCSN06005 - # 00014



Yankee Skull™
ASCSN06014 - # 00023



13 Hatter Skull™
ASCSN060008 - # 00017



Mad Hatter Skull™
ASCSN06017 - # 00026



Uncle Sam Skull™
ASCSN06015 - # 00024



Frankenskull™
ASCSN06071 - # 00080



Skull With Dagger™
ASCSN06004 - # 00013



Das German Helmet Skull™
ASCSN06023 - # 00032



Southern Rebel Skull™
ASCSN06013 - # 00022



Biker Skull™
ASCSN06007 - # 00016



Mohawk German Helmet Skull™
ASCSN06024 - # 00033



Sammy Skull™
ASCSN06032 - # 00041



Skully The Clown Skull™
ASCSN06018 - # 00027*



Rasta Man Skull™
ASCSN06011 - # 00020



Chrome Skull™
ASCSN06060 - # 00068*
rubber insert included

Illuminated Chrome Skull™ Shift Knobs

ALSO AVAILABLE
NON-ILLUMINATED!

This chromed-out skull has illuminated eyes! Bright red L.E.D.s light up at the push a button, and slowly fade out over 20 seconds. It also has a very satisfying weighty feel due to its all-metal construction. Stands 2½" tall. Also available in non-illuminated.



ASCSN06002 - # 14564



ASCSN06001 - # 14563

Translucent Skull Shift Knobs

These colored clear knobs are awesome! They catch the light and emanate it back to you in one of three popular colors, and they're skulls! How much more glorious could they be? Skulls are about 2.5" wide x 3" tall x 4.3" deep. Adapter included.



Crystal Purple
ASCSN06065 - # 00073



Crystal Black
ASCSN06066 - # 00074



Crystal
ASCSN06063 - # 00071

Eyeball™ Series

American Shifter Company's fun Eyeball Series is sure to impress. This blood shot eyeball shift knob includes a threaded shift adapter and detailed instructions for easy installation. Ball is 2 inches in diameter.



Strung Out™ Blood Shot EyeBall
ASCSN12001 - # 00239

Reptile™ Series

Chrome-out your ride with a Cobra™ Shift Knob. Available with non-illuminated eyes or illuminated eyes. Simply push the button to reveal bright red L.E.D.s. Includes a rubber shift adapter and detailed instructions for easy installation.



Cobra™
ASCSN14001 - # 54573



Illuminated Cobra™
ASCSN14002 - # 54575

Metal Mantra™ Series

Add a serious touch of class to your ride with the American Shifter Metal Mantra Series. These custom all-metal bullet spike shift knobs are sure to impress. Includes detailed instructions for easy installation. Tap to size or set screw.



Bullet Spike™
ASCSN07001 - #14595

ANY BALL YOU WANT!

Bank Shot™ Series (Billiard)

Only American Shifter™ uses 100% Real Authentic unused billiard balls, then machines an opening in each one to insert a precision threaded adapter to ensure a snug fit. This unique system improves drivers feedback while providing a smooth sold shift feeling. All balls are 2 ¼ inches in diameter and include a threaded shift adapter.

**MACHINE INSERT
INSTALLED**



1 Ball Billiard Pool™
ASCSN03001 - # 96046



2 Ball Billiard Pool™
ASCSN03002 - # 96047



3 Ball Billiard Pool™
ASCSN03003 - # 96048



4 Ball Billiard Pool™
ASCSN03004 - # 96049



5 Ball Billiard Pool™
ASCSN03005 - # 96050



6 Ball Billiard Pool™
ASCSN03006 - # 96051



7 Ball Billiard Pool™
ASCSN03007 - # 96052



8 Ball Billiard Pool™
ASCSN03008 - # 14561



9 Ball Billiard Pool™
ASCSN03009 - # 96053



10 Ball Billiard Pool™
ASCSN03010 - # 96054



11 Ball Billiard Pool™
ASCSN03011 - # 96055



12 Ball Billiard Pool™
ASCSN03012 - # 96056



13 Ball Billiard Pool™
ASCSN03013 - # 96057



14 Ball Billiard Pool™
ASCSN03014 - # 96058



15 Ball Billiard Pool™
ASCSN03015 - # 96059



White Cue Ball Billiard
ASCSN030CW - # 96060

Cue Ball Billiard Pool™ Shift Knobs With Metal Flakes



Black
ASCSN03018 - # 53781



Clear
ASCSN03019 - # 53783



Red
ASCSN03020 - # 53785



Blue
ASCSN03021 - # 54086



Orange
ASCSN03022 - # 54088



Green
ASCSN03023 - # 54090



White 8 Ball
ASCSN03016 - # 00230



Red 8 Ball
ASCSN03017 - # 00231

Flame™ Series

These sizzling shift knobs have all the fun of the classic shift knob with an added flame twist. The Flame Series comes in a variety of bright colors, are 2 ¼ inches in diameter and include a threaded shift adapter and detailed instructions for easy installation.



Ivory
ASCSN11001 - # 00240



Red
ASCSN11006 - # 53773



Blue
ASCSN11007 - # 53775



Orange
ASCSN11008 - # 53777



Green
ASCSN11009 - # 53779



Black
ASCSN11002 - # 00241



Black 8 Ball
ASCSN11003 - # 00242



White 8 Ball
ASCSN11004 - # 00243



Clear
ASCSN11005 - # 53771

Business Card Holder With Arm
ASCDSS001 - # 56609
knob not included



Billiard Ball Shift Knob Display
ASCPOP003 - # 56611
knobs not included



Old Skool™ Series

American Shifter features a whole series of different classic shift knobs that any enthusiast is sure to recognize and appreciate. Shift knobs are 2 ¼ inches in diameter.



Clear
ASCSN08004 - # 00225

Black
ASCSN08005 - # 00226

Sparkle™ Shift Knobs With Metal Flakes



Red
ASCSN11008 - # 00229



Orange
ASCSN11009 - # 53765



Green
ASCSN08007 - # 00228



Blue
ASCSN08006 - # 00227

Old Skool™ Shift Knobs

Snooker balls are 2" in diameter. Cue balls are 2 ¼ inches in diameter.



Black
Snooker - ASCSN08001 - # 00219
Cue - ASCSN030CB - # 96061



White
Snooker - ASCSN08002 - # 00220
Cue - ASCSN030CW - # 96060



Red
Snooker - ASCSN08003 - # 00221
Cue - ASCSN030CR - # 96062



Bug™ Series

These creepy crawly shift knobs are sure to be a hit while you are cruisin'. Choose from a variety of colors, all 2 ¼ inches in diameter. Includes a threaded shift adapter and detailed instructions.



White Spider™
ASCSN09001 - # 00222



Black Spider™
ASCSN09002 - # 00223



Clear Spider With Metal Flakes™
ASCSN09003 - # 53755



Red Spider With Metal Flakes™
ASCSN09004 - # 53757



Orange Spider With Metal Flakes™
ASCSN09006 - # 53761



Green Spider With Metal Flakes™
ASCSN09007 - # 53763



Blue Spider With Metal Flakes™
ASCSN09005 - # 53759



ARTWORK CLOSE-UP

Super Stripe™ Series

These gorgeous translucent Super Stripe knobs are an incredibly modern twist on a classy look - they appear like they're made out of candy or precious stones, and they feel perfect in your hand.



Multi Color
ASCSN01001 - # 00212



Red
ASCSN01002 - # 00213



Green
ASCSN01003 - # 00214



Dice™ Series

Your roll! These 20-sided icosahedrons or 6-sided traditional cubes will delight any fan of the odds! Available in an assortment of colors. 2 1/4" in diameter and super awesome. Set screw fitting.



Black Dice™
ASCSN04001 - # 14562



NEW
20 Sided Red Dice™
ASCSN04007 - # 08240



NEW
20 Sided Green Dice™
ASCSN04008 - # 08241



20 Sided Black Dice™
ASCSN04004 - # 55949



20 Sided Blue Dice™
ASCSN04005 - # 55951



20 Sided White Dice™
ASCSN04006 - # 55953



Nostalgic™ Series

American Shifter's Nostalgic Series offers the look of yesterday with the styling & performance of today's modern shift knobs. Each knob includes 4 interchangeable colored O-Rings allowing you to match the knob to your interior. *3/8 24 direct fit for American Shifter and Lokar shifters.



Billet With O-Ring Set
ASCSN13002 - # 54597

Black With O-Ring Set & Interchangeable Medallions
ASCSN13001 - # 49870

Metal Medallion Insert
ASCMD01 - # 54579

Retro™ Series

Add a touch of vintage to your ride with these retro shift knobs. Choose from a variety of colors and while you're at it, why not add custom etching to make a true statement! Shift knobs are 2.4 inches in diameter.



White
ASCSN10001 - # 00232



Black
ASCSN10002 - # 00233



Clear Sparkle
ASCSN10003 - # 00234



Retro Clear Red Sparkle
ASCSN10007 - # 00238



Clear Amber Sparkle
ASCSN10005 - # 00236



Clear Blue Sparkle
ASCSN10006 - # 00237



Clear Green Sparkle
ASCSN10008 - # 53767



Clear Black Sparkle
ASCSN10004 - # 00235



Dash Knobs

Dress up your dash with these snow cone and billet dash knobs. Available in a variety of colors & styles, your ride is sure to stand out of the crowd!

SnowCone™ Layered Tear Dash Knobs



Blue Tear™ Dash Knob
ASCKN01BL - # 55921



Black Tear™ Dash Knob
ASCKN01BK - # 55923



Red Tear™ Dash Knob
ASCKN01RD - # 55925



White Tear™ Dash Knob
ASCKN01WH - # 55927



Yellow Tear™ Dash Knob
ASCKN01YL - # 55929



Green Tear™ Dash Knob
ASCKN01GN - # 55931



Purple Tear™ Dash Knob
ASCKN01PU - # 55933



Orange Tear™ Dash Knob
ASCKN01OR - #55935

Billet Dash Knobs



Bullet™ Dash Knob
ASCKBS1 - # 55917



Retro™ Dash Knob
ASCKBS2 - #55919



Billet Stub™ Dash Knob
ASCKBS3 - #55963

NEW



Retro Machined Chrome Knob
ASCBWKNOB1 - #09111

NEW



Billet Dash Knob
ASCBWKNOB2 - #09113

Stripe Stix™ Series

Fun With Stripes! The Stripe Stix shift knob series are an excellent addition to any ride. These fun and translucent shift knobs are sure to be a hit. Choose from three bright colors!



Green
ASCSN02002 - # 00216



Red
ASCSN02001 - # 00215



Blue
ASCSN02003 - # 00217



Custom Shift Knob Engraving

NEW



Shift Patterns

4 Speed

01 - circle 01n - no circle	02 - circle 02n - no circle	03 - circle 03n - no circle	04 - circle 04n - no circle	05 - circle 05n - no circle	06 - circle 06n - no circle
07 - circle 07n - no circle	08 - circle 08n - no circle	09 - circle 09n - no circle	10 - circle 10n - no circle	11 - circle 11n - no circle	12 - circle 12n - no circle

5 Speed

13 - circle 13n - no circle	14 - circle 14n - no circle	15 - circle 15n - no circle	16 - circle 16n - no circle	17 - circle 17n - no circle	18 - circle 18n - no circle

6 Speed

19 - circle 19n - no circle	20 - circle 20n - no circle	21 - circle 21n - no circle	22 - circle 22n - no circle	23 - circle 23n - no circle	24 - circle 24n - no circle

25 - circle 25n - no circle	26 - circle 26n - no circle	41 - circle 41n - no circle			

Automatic

27 - circle 27n - no circle	28 - circle 28n - no circle	29 - circle 29n - no circle	30 - circle 30n - no circle		

4 x 4

31 - circle 31n - no circle	32 - circle 32n - no circle	33 - circle 33n - no circle	34 - circle 34n - no circle	35 - circle 35n - no circle	36 - circle 36n - no circle
37 - circle 37n - no circle	38 - circle 38n - no circle	39 - circle 39n - no circle	40 - circle 40n - no circle		

Popular Logos, Icons & Text

Sample Logos

 Brand American Shifter	 Brand V8	 Animals Dog 1	 Animals Cobra 1	 Automotive Flags 1	 Automotive Pistons
 Hands, Feet & Body Feet	 Music Guitars	 People & Characters Devil 3	 People & Characters Vampire	 Science Bio Hazard	 Science Nuclear Hazard 1
 Skulls Skull Face	 Skulls Skull & Bones 3	 Space Star 1	 Sports Football Helmet	 Symbols Celtic 2	 Symbols Ying Yang
 Text Need For Speed	 Transportation Route 66	 Nature Lightning 2	 Weapons & Ammo Bomb	 Weapons & Ammo Grenade 3	 Cards Spades 1

CHECK OUT HUNDREDS MORE ONLINE!



*Shift Knob Series that can be etched: Stripe Stix Series, Super Stripe Series, Bank Shot Series (Billiard), Flame Series, Old Skool Series, Bug Series, Eyeball Series,, and Retro Series.



Perfect as an air filter topper!

Filter Topper Skulls

These smaller skulls are perfect for column shift levers or for covering up that ugly air filter wingnut.

Southern Rebel Skull™
ASCSN06013 - # 00022



Jungle Camo Skull™
ASCSN06030 - # 00039*



Desert Camo Skull™
ASCSN06031 - # 00040*



Urban Camo Skull™
ASCSN06029 - # 00038*



Skull With Red Eyes™
ASCSN06059 - # 00067*



Skull With Eyes™
ASCSN06061 - # 00069*



Dr Skull™
ASCSN06010 - # 00019



Wicked Bride™ Skull
ASCSN06012 - # 00021



Yar! Buccaneer Skull™
ASCSN06005 - # 00014



Rasta Man Skull™
ASCSN06011 - # 00020



Uncle Sam Skull™
ASCSN06015 - # 00024



Frankenskull™
ASCSN06071 - # 00080



Skully The Clown Skull™
ASCSN06018 - # 00027*



Biker Skull™
ASCSN06007 - # 00016



Mad Hatter Skull™
ASCSN06017 - # 00026



Willy Wonka Skull™
ASCSN06016 - # 00025



Skull With Dagger™
ASCSN06004 - # 00013



Sammy Skull™
ASCSN06032 - # 00041



Slick Skull With Bandana™
ASCSN06003 - # 00012



Chrome Skull™
ASCSN06060 - # 00068*



Yankee Skull™
ASCSN06014 - # 00023



Das German Helmet Skull™
ASCSN06023 - # 00032



13 Hatter Skull™
ASCSN060008 - # 00017



Mohawk German Helmet Skull™
ASCSN06024 - # 00033

WORKS ON ALL
AMERICAN KNOBS!

Adapters

DUAL
ACTION!

Brody Suicide Knob Adapter Kits

These universal trucker knob kits make any shift knob into a steering wheel knob for your easy-turning joy! American Shifter's adapters are heavy duty with all-chrome construction and a rubber sleeve for safety so you won't damage your steering wheel.

1 PICK A KNOB

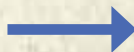

2 PICK A BRODY KNOB ADAPTER



**Convoy Brody I™
Knob Adapter**
ASCAD01 - # 00218

**Convoy Brody II™
Knob Adapter**
ASCAD06 - # 54577

Shift Knob Main Adapter

Make the shift knob of your dreams, by using American Shifter Company's shift knob adapter kit. Once installed on your knob, it allows you to use American Shifter's adapters to thread your shift knob directly onto your factory shift lever.

MAKE YOUR OWN SHIFT KNOB!



**Standard Shift Knob
Main Adapter**
ASCAD04 - # 00425

1 PICK AN ITEM

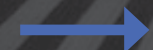

2 INSERT ADAPTER

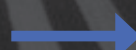

3 INSTALL ON
SHIFT LEVER



OEM Shift Knob Adapter Sets

Factory Fit! American Shifter Companies adapter & kits allow you to install your shift knob with ease. Simply insert the correct adapter and screw onto your shift lever. Use the chart below to identify what size is best for your vehicle.

UNIVERSAL

NEW



8 PIECE SETS



DELUXE 24 PIECE SETS



SINGLES	Part Number & SKU	Sizes	8 PIECE SETS		DELUXE 24 PIECE SETS	
			Metric (QTY) ASCAD02 #00423	Standard (QTY) ASCAD03 #00424	Metric (QTY) ASCAD08 #61271	Standard (QTY) ASCAD09 #61273
	ASCAD10 #00847	Universal				
	ASCAD11 #08191	16mm x 1.5 To 7mm	1		3	
	ASCAD12 #08200	16mm x 1.5 To 8mm x 1.5	1		3	
	ASCAD13 #08201	16mm x 1.5 To 8mm x 1.25	1		3	
	ASCAD14 #08202	16mm x 1.5 To 10mm x 1.5	1		3	
	ASCAD15 #08203	16mm x 1.5 To 10mm x 1.25	1		3	
	ASCAD16 #08204	16mm x 1.5 To 12mm x 1.5	1		3	
	ASCAD17 #08205	16mm x 1.5 To 12mm x 1.25	1		3	
	ASCAD18 #08206	16mm x 1.5 To 12mm x 1.75	1		3	
	ASCAD19 #08207	16mm x 1.5 To 1/2 13		1		3
	ASCAD20 #08208	16mm x 1.5 To 1/2 20		1		3
	ASCAD21 #08209	16mm x 1.5 To 1/4 28		1		3
	ASCAD22 #08210	16mm x 1.5 To 3/8 16		1		3
	ASCAD23 #08211	16mm x 1.5 To 3/8 24		1		3
	ASCAD24 #08212	16mm x 1.5 To 5/16 18		1		3
	ASCAD25 #08213	16mm x 1.5 To 5/16 24		1		3
	ASCAD26 #08214	16mm x 1.5 To 7/16 14		1		3

Vehicle Thread Adapter Chart

TYPE	SIZES	
B&M™ (most automatic)	1/2 - 20	
Gennie Shifter (automatic)	5/16 - 18	
Gennie Shifter Lo-Dapt™	3/8 - 16	
Hurst™ - Pro-Matic (before 1987), Vertical Gate (before 1987), V-Matic (before 1987)	7/16 - 20	
Hurst™ - Aluminum sticks, Quarter/Stick & Q/S 2	3/8 - 24	
Hurst™ - Comp/Plus (early), Indy 3 Speed, Indy Matic 1, Indy Pick Up Truck, Indy SSA	3/8 - 16	
Hurst™ - Auto/Stick1™, Auto/Stick3™, Billet/Plus™, Chrome replacement sticks, Comp/Plus™ (late) & OEM, Dual/Gate2™, Indy Qualifier™, Pro-Matic2™ (since 1987), Super Shifter 3™, V-Gate™ (since 1987), V-Matic 2™ (since 1987)	3/8 - 16	
Lokar®	5/16 - 20 or 3/8 - 16	

OEM	SIZES	
BMW X5™ (2004 & up automatic)	12mm x 1.50	
Chevrolet Camaro™ 5 & 6 Speed (manual)	16mm x 1.50	
Chevrolet Corvette™ 6 speed (1989-2004)	9/16 - 18	
Chrysler 300™ (automatic)	8mm x 1.25	
Chrysler R/T™ (newer automatic)	8mm x 1.25	
Chrysler SRT™ 8 (automatic)	8mm x 1.25	
Dodge Viper™ (manual)	1/2 - 20	
Dodge Magnum™ (manual)	8mm x 1.25	
Ford™ 28-48 (manual)	5/16 - 18 or 5/16 - 24	
Ford Cobra™ (1989 manual)	3/8	
Ford Mustang™ (manual)	12mm x 1.75	
Ford Mustang™ (Newer manual)	12mm x 1.25	
Honda™ (manual)	10mm x 1.50	

Jeep CJ™ (1955-1986 manual)	3/8 -24	
Jeep Wrangler™ (1955-1986 manual)	3/8 -24	
Mazda™ (manual)	10mm x 1.25	
Mitsubishi™ (manual)	10mm x 1.25	
Nissan™ (manual)	10mm x 1.25	
Pontiac Firebird™ 5 & 6 speed (manual)	16mm x 1.50	
Subaru™ (manual)	12mm x 1.25	
Toyota™ (most manual)	12mm x 1.25	
Toyota Corolla (2009 automatic)	8mm x 1.25	
Toyota Tacoma™ (manual)	12mm x 1.50	
VW™ Bug & Bus (before 1968 manual)	8mm x 1.50	
VW™ Bug & Bus (since 1968 manual)	10mm x 1.50	
VEHICLE SHIFTER THREAD ADAPTERS		
U.S. AUTOMOBILES		
VEHICLE	GEARBOX	THREADS
Camaro 1983-96	Manual Gearbox	16mm X 1.50
Camaro 1967-2002	Manual Gearbox	16mm X 1.50
Chevy Camaro,RS,Z-28 1986-2002	Manual Gearbox	6mm X 1.50
Chevy & GMC Truck 1936-1946	Manual Gearbox	3/8 X 24
Chevy Truck 1967-1972	Manual Gearbox	3/8 X 24
Chevy Older Models "1950s"	Manual Gearbox	3/8 X 24
Corvette 1984-2004	Manual Gearbox	9/16 X 18
Corvette C4 1995-96	Manual Gearbox	9/16 X 18
ZF 6-speed + C5	Manual Gearbox	9/16 X 18
Corvette 1968 to 1982	Manual Gearbox	9/16 X 18
Dodge Magnum 2005-06	Manual Gearbox	8mm X 1.25
Newer R/Ts	Manual Gearbox	8mm X 1.25
Chrysler 300s	Manual Gearbox	8mm X 1.25
Chrysler SRT 8's	Manual Gearbox	8mm X 1.25
Dodge Viper	Manual Gearbox	½ X 20
Mustang 1964-69 (Most Models)	Manual Gearbox	½ X 20
Mustang 1979-2004 (Most Models)	Manual Gearbox	12mm X 1.75
Ford Mustang 1994-2004	Borg-Warner T5	12mm X 1.75
Ford Cobra & Mustang 1999	Manual Gearbox	12mm X 1.75
Ford SVT Contour	Manual Gearbox	½ X 20
Ford Ranger XLT	Manual Gearbox	5/8 Splined
Ford F-150 1993 and 2000	Manual Gearbox	5/8 Splined
Ford Probe	Manual Gearbox	10 X 1.25
Ford Escort LX	Manual Gearbox	10 X 1.25
Ford Older Models 1950s	Manual Gearbox	5/16 X 24
Jeep Wrangler 1987 - 2004	Manual Gearbox	3/8 X 16, 10mm X 1.50
Jeep Wrangler TJ & Unlimited '97-'06	Manual Gearbox	10mm X 1.50
Jeep '55 - '86 CJ5/CJ6/CJ7/CJ8 Scrambler	Manual Gearbox	3/8 X 24
55-83 Jeep CJ-5	Manual Gearbox	3/8 X 24
55-75 Jeep CJ-6	Manual Gearbox	3/8 X 24
76-86 Jeep CJ-7	Manual Gearbox	3/8 X 24
81-85 Jeep CJ-8	Manual Gearbox	3/8 X 24
76-83 Jeep CJ-5	Manual Gearbox	3/8 X 24
76-86 Jeep CJ-7	Manual Gearbox	3/8 X 16

81-85 Jeep CJ-8	Manual Gearbox	3/8 X 16
87-95 Jeep Wrangler (YJ)	Manual Gearbox	3/8 X 16
97-06 Jeep Wrangler (TJ)	Manual Gearbox	10mm X 1.50
04-06 Jeep Wrangler	Manual Gearbox	10mm X 1.50
Unlimited (TJ)	Manual Gearbox	10mm X 1.50
Jaguar XJ6 1995-97	Manual Gearbox	8mm X 1.25
Jaguar X-Type/XJ8/XK8	Manual Gearbox	8mm X 1.25
Jag XJ-S 4.0L (from mid-1996,vin221855-on)	Manual Gearbox	8mm X 1.25
Jag XJ-S 6.0L (from mid-1993,vin188700-on)	Manual Gearbox	8mm X 1.25
Pontiac Firebird 1983 - 96	Manual Gearbox	16mm X 1.50
Pontiac Fiero	Manual Gearbox	16mm X 1.50
PT Cruiser	Manual w/ Kustom Kruzer Adapter	3/8 X 16 threads
Harley Davidson & Indian Motorcycle		3/8 X 24
IMPORT AUTO WITH ORIGINAL MANUAL GEARBOX		
VEHICLE	GEARBOX	THREADS
Acura	Manual Gearbox	10mm X 1.50
BMW-325	Manual Gearbox	15mm X 1.50
Honda Models	Manual Gearbox	10mm X 1.50
Hundai Excel GL	Manual Gearbox	10mm X 1.25
Hundai Accent	Manual Gearbox	10mm X 1.25
Geo tracker	Manual Gearbox	12mm X 1.25
Geo Storm	Manual Gearbox	10mm X 1.25
Mazda Miata All Years	Manual Gearbox	10mm X 1.25
Mazda RX-8 RX-7	Manual Gearbox	10mm X 1.25
Mazda Models	Manual Gearbox	10mm X 1.25
Mitsubishi lancer/evolution/eclipse	Manual Gearbox	10mm X 1.25
Mitsubishi Jeep SUV	Manual Gearbox	10mm X 1.25
Miata	Manual Gearbox	10mm X 1.25
Nissan Skyline (R34)*	Manual Gearbox	12mm X 1.25
Nissan Frontier	Manual Gearbox	10mm X 1.25
Nissan Sentra	Manual Gearbox	10mm X 1.25
Nissan Maxima	Manual Gearbox	10mm X 1.25
Nissan 350Z	Manual Gearbox	10mm X 1.25
Nissan (Most Models)	Manual Gearbox	10mm X 1.25
Datsun 300ZX (Nissan)	Manual Gearbox	10mm X 1.25
Datsun 280ZX	Manual Gearbox	8mm X 1.25
Datsun Older Hatchback	Manual Gearbox	8mm X 1.25
Datsun (2000's & 67 1/2 -70 1600's)	Manual Gearbox	8mm X 1.25
(SPL311-11001 up)	Manual Gearbox	
Isuzu Impulse	Manual Gearbox	10mm X 1.25
Subaru Models (Susuki-Impreza)	Manual Gearbox	12mm X 1.25
Susuki Samurai	Manual Gearbox	12mm X 1.25
Toyota Supra 1993 -98 (JZ)*	Manual Gearbox	12mm X 1.25
Toyota MR2 1991-95 (SW20)*	Manual Gearbox	12mm X 1.25
Toyota Corrola	Manual Gearbox	12mm X 1.25
Toyota Celica-Tercel	Manual Gearbox	12mm X 1.25
Toyota Camry	Manual Gearbox	12mm X 1.25
Toyota Trucks	Manual Gearbox	12mm X 1.25

Toyota (Most Models)	Manual Gearbox	12mm X 1.25
Ferrari 206,246,308,328,348	Manual Gearbox	10mm X 1.25
Ferrari Testarossa	Manual Gearbox	10mm X 1.25
Scion xA xB and tC	Manual Gearbox	12mm X 1.25
Scion tC and xB 2008 only	Automatic	8mm X 1.25
VOLKSWAGEN		
VEHICLE	GEARBOX	THREADS
Beetle 1952 - 61	Manual Gearbox	10mm X 1.50
Beetle 1962 - 67	Manual Gearbox	7mm X 1.0
Beetle 1968 - 79	Manual Gearbox	12mm X 1.50
Ghia 1956 - 61	Manual Gearbox	10mm X 1.50
Ghia 1962 - 67	Manual Gearbox	7mm X 1.0
Ghia 1968 - 74	Manual Gearbox	12mm X 1.50
Bus 1952 - 67	Manual Gearbox	10mm X 1.50
Bus 1968 - 79	Manual Gearbox	12mm X 1.50
Thing 1973 - 74	Manual Gearbox	12mm X 1.50
Type 3 1962 - 74	Manual Gearbox	12mm X 1.50
VW Rabbit	Manual Gearbox	12mm X 1.50
VW Jetta	Manual Gearbox	12mm X 1.50
VW Golf	Manual Gearbox	12mm X 1.50
Volkswagen 1980 - Up (Most models)	Manual Gearbox	12mm X 1.50
Volkswagen Vanagon 1984 to 1991	Manual Gearbox	14mm X 1.50
EMPI & Hurst Trigger Shifters	Manual Gearbox	3/8 X 24
SCAT Shifter	Manual Gearbox	3/8 X 16
AFTERMARKET SHIFTER		
VEHICLE	THREADS	
Gennie Commander	7/16 X 20	
Gennie Shifter Lo-Dapt	3/8 X 16	
Gennie Shifter Lo-Dapt II	16mm X 1.50	
Gennie Shifter Lo-Dapt III	(threadless)	
Brodie Knob Adapter	16mm X 1.50	
B&M Shifter	1/2 X 20	
EMPI Shifter	3/8 X 24	
SCAT Shifter	3/8 X 16	
HURST Shifter*	3/8 X 16, 3/8 X 24, 1/2 X 13, 7/16 X 20, 16mm X 1.50	

Lokar Shifter Knob Adapter	3/8 X 16, 3/8 X 24	
*Nearly all chrome-plated Steel sticks used on aftermarket Hurst shifters are 3/8 X 16. Aluminum, Black Aluminum, or Black Steel Sticks (Late Model Mustang and Quarter sticks) are 7/16 X 20. Older Hurst OEM shifter is 3/8 x 24. One exception to this is the T-56 six-speed shifter. While the chrome stick version is 3/8 X 16, the black stick version is 16mm X 1.50.		
HURST SHIFTER THREAD SIZE		
VEHICLE	THREADS	
Chrome replacement sticks thread size	3/8 X 16	
Aluminum stick thread size	7/16 X 20	
Auto/stick 1 & 3 stick thread size	3/8 X 16	
Billet/Plus w/chrome stick	3/8 X 16	
Comp/Plus (early)	3/8 X 16	
Comp/Plus (late), & OEM	3/8 X 16	
Dual/Gate 2 thread size	3/8 X 16	
Indy 3 speed thread size	3/8 X 24	
Indy Matic 1 thread size	3/8 X 24	
Indy Pick Up Truck	3/8 X 24	
Indy Qualifier thread size	3/8 X 16	
Indy SSA thread size	3/8 X 24	
Pro-Matic, before 1987	1/2 X 13	
Pro-Matic 2, since 1987	3/8 X 16	
Quarter/Stick & Q/Stick 2	7/16 X 20	
Super Shifter 3 thread size	3/8 X 16	
Vertical Gate, before 1987	1/2 X 13	
V-Gate 2, since 1987	3/8 X 16	
V-Matic, before 1987	1/2 X 13	
V-Matic 2, since 1987	3/8 x 16	
The brand names on this chart are not endorsed by Gennie Shifter, and Gennie Shifter makes no claims to the respective trademarks. They may not otherwise be copied, reproduced, distributed, published, downloaded, displayed or transmitted by any means without the prior written permission of the copyright or trademark owner.		

Stainless Brake, Fuel & Wire Clamps

* Size is inner diameter of clamp. Use for outer diameter of lines to clamp.

* Kits with stainless hardware - 10/32" button head allen AND #10 x 1/2" phillips.

3/16" (Brake Line)

Double kit (12) with hardware ASCLC2187. #61311

Single kit (12) with hardware ASCLC3187. #61293



1/4" (Truck Brakes)

Double kit (12) with hardware ASCLC2250. #61309

Single kit (12) with hardware ASCLC3250. #61295



1/2" (Air Lines)

Double kit (12) with hardware ASCLC2500. #61303

Single kit (12) with hardware ASCLC3500. #61305



3/8" (Fuel Lines)

Double kit (12) with hardware ASCLC2375. #61307

Single kit (12) with hardware ASCLC3375. #61297



5/8" (Battery Cable)

Double clamp with hardware ASCLC2625. #61301

Single kit (12) with hardware ASCLC3625. #61299



Engine and Transmission Dipsticks

American Shifter's Billet Dipsticks feature a braided stainless steel dipstick tube for not only a classy appearance, but also for rugged strength and extreme heat tolerance. Comes with a flexible fill tube adapter, mounting brackets for firewall and transmission mounting, and the peace of mind from knowing you've got the best looking and most functional dipstick available.



FIREWALL MOUNT

TRANSMISSION MOUNT



Engine Dipsticks

With the comprehensive variety of American Shifter™ Engine Dipsticks, you'll be sure to find what you need to monitor the precious oil in your engine.

DIPSTICK DESCRIPTION	PART NO.	PART NO.
Stainless Steel Chevy Big Block	ASCEDP1	56273
Chevy Small Block '79 & Earlier	ASCEDP2	56275
Early Ford 289-302	ASCEDP3	56277
Ford 302	ASCEDP4	56279
LSI	ASCEDP5	56281
Chevy Small Block '80 & Later	ASCEDP6	56283
Hemi Engine Oil Dipstick	ASCEDP7	56285
Ramjet/Chevy SB/GM Vortec	ASCEDP8	56287
Ford 351	ASCEDP9	56289
Ford Big Block	ASCEDP10	56291
Ford FE	ASCEDP11	56293
Chevy Small Block - Pre-1980 (No Tube)	ASCEDP12	56299
Chevy II 62-67 V8	ASCEDP13	56301

Transmission Dipsticks

American Shifter™ has your transmission longevity in mind! We've got an entire assortment of transmission dipsticks to help you get what you need to keep a watchful eye over your transmission fluid levels.



FORD TRANS	PART NO.	SKU.
C-4 Pan	ASCTDP2	56295
Ford C6, GM700-R4, GM 350/400 4L60, 4L60E, 904, Hi-Tech TH-350, Hi-Tech TH-400, Ford AOD	ASCTDP1	56271
MOPAR		
518	ASCTDP3	56297



Custom Knob Etching

With American Shifter's™ custom knob labels, your classy polished dipstick knob can say or show whatever you wish. Pick from the pre-made options, or whatever custom icon or logo you want.

Universal Polished Knob W/Flat Top
ASCSSK2 - # 61277



Knob with Custom Inserts

American Shifter's™ knob with custom inserts really adds that finishing touch. Put any image you want into the knob where it will be protected from heat and dirt by a plexi-glass cover. Logos, pictures, icons, colors- anything you want!

SmartStick Polished Knob w/Window
ASCSSK1 - # 61279



Emergency Brakes

Take a Brake! American Shifter's handbrakes offer superior performance with a classic modern design. Each handbrake features a chrome steel handle, heat treated ratcheting cut gear & lock, and a machined push button with optional o-rings.

Floor Mount

American Shifter's floor mount emergency hand brake sports a compact 10" handle with inner bushing to eliminate unwanted rattling & road noise. Installation is made simple with a 4 point mounting system that allows for direct floor, side, or custom mounting.



10"

Floor Mount Emergency Hand Brake Kit

ASCEBK01 - # 96138
cable not included.

Transmission Mount

American Shifter's vertical transmount emergency brake handle offers the classic look of yesterday with strength and performance of a modern handle. American Shifter's geometrical design delivers comfortable smooth operation in 11" or 16" hand brake levers.



11"

Transmission Mount Emergency Hand Brake Kit

ASCBH11 - # 54094
cable not included.

16"

Transmission Mount Emergency Hand Brake Kit

ASCBH16 - # 54096
cable not included.

Emergency Brake Cables

American Shifter's universal emergency brake cables are ideal for all installations. A simple cut to fit design allows for proper fitment while reducing installation time. Each kit comes with extra long stainless steel cables and housing allowing you to route the lines as needed. Kit includes adjustable main clevis and detailed instructions.



BRAKE EASY!

Emergency Hand Brake Cable Kit

ASCBC001 - # 96240

Power Remote Mount Emergency Brake Kits

Push Button Brakes! American Shifter's revolutionary power emergency brake kit makes it easy to activate your emergency brake with a push of a button! This amazing design mounts in a remote area of your vehicle and allows you to remove those unsightly brake handles. Simple one touch push button operation will activate and deactivate your emergency brakes with ease!

- Illuminated activation button
- Adjustable design
- Quick, smooth operation
- Compact design for easy mounting

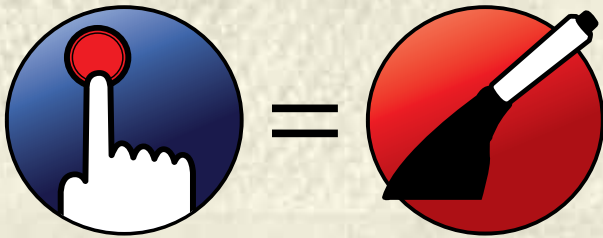

Power Remote Mount Emergency Brake Kit
ASCPB01 - # 00495

Power Remote Mount Emergency Brake Kit with 1 Touch
ASCPB02 - # 08184



Clevis Kits

American shifter clevis kits allow you to adapt American shifter brake cable kits to work on several rear brake systems.

Applications:

- 1984 - 1987 Corvettes
- 1988 and later Corvettes
- Wilwood Ford Explorer Style
- Wilwood Disc
- Baer Brakes



FORD

Ford Rear Disc Clevis Kit
ASCCV01 - # 53751

CHEVY/GM

Chevy/GM Rear Disc Clevis Kit
ASCCV02 - # 53753



Shifter & E-Brake Boot Kits

Shift Boot Caps

Add a touch of elegance to your vehicle with American Shifter's™ boot caps. American Shifter's™ Boot Cap works on all shift boots.

Shift Boot Nostalgic Chrome Cap
ASCAD07 - # 56309



FITS ALL VEHICLES!



Shifter or Emergency Brake Boot Kits

American Shifter's boot kits include all you need to dress up your shifter or emergency brake handle. Each kit includes a real Naugahyde boot, trim rings and mounting hardware. Available in several colors! Parts sold separately.

AVAILABLE IN 3 COLORS!



BLACK

GRAY

TAN



STYLE	PART NO.	SKU.
Black Vertical	ASCSB101BK	54585
Tan Vertical	ASCSB101TN	54587
Grey Vertical	ASCSB101GY	54589

STYLE	PART NO.	SKU.
Black Horizontal	ASCSB201BK	54595
Tan Horizontal	ASCSB201TN	54593
Grey Horizontal	ASCSB201GY	54591

Trim Rings

DRESS UP YOUR RIDE!



Round Shift Boot Trim Ring With Hardware
ASCTR101 - # 54581



Oval Shift Boot Trim Ring With Hardware
ASCTR201 - # 54583

Column Dress Up Kits

Separate your column from the rest with American Shifter's custom column dress up kits. Each kit offers detailed knob design for your turn signal, hazard, and light switch.



Retro Billet GM/Chevy
ASCCDK3 - # 56247



Billet Early GM/Chevy
ASCCDK1 - # 56243



Bullet Billet GM/Chevy
ASCCDK2 - # 56245



Deluxe Chrome Column Shift Lever
ASCCS1 - # 56269



Bullet™ Dash Knob
ASCKBS1 - # 55917



Retro™ Dash Knob
ASCKBS2 - #55919



Billet Stub™ Dash Knob
ASCKBS3 - #55963

NEW



Retro Machined Chrome Knob
ASCBWKNOB1 - #09111

NEW



Billet Dash Knob
ASCBWKNOB2 - #09113

A/C Vents

Cool down in style! American Shifter™ billet aluminum AC vents provide all the functionality of OEM or standard vents with the elegant look and feel of polished aluminum. Dress up your dash with billet air vents!



Billet A/C Vent
ASCBAC1 - #56595



“Swing” Billet A/C Vent
ASCBAC2 - #56597



Super Bright White 36mm Festoon LED 12v Bulb
ASCF36LEDW - #61275

Billet Dome Light

Turn on the light! American Shifter™ billet aluminum Courtesy Lights give your interior a touch of elegance and full functionality. American Shifter™ courtesy lights function both as a convenience and a safety factor when using your vehicle. Upgrade from standard and OEM lights and dress up your interior with polished aluminum courtesy lights!



Billet Courtesy Dome Light
ASCDML1 - #56593



Billet Door Handles

Make your doors shine! American Shifter™ Billet Door Handles can be installed onto your vehicle doors to give them a personal touch. Their sleek designs give the ideal look of speed and style to onlookers. Available in 3 popular designs and sold in pairs.



COMPLETE KITS



Bullet Lever Kit
ASCDH1K - #56585



Slash Lever Kit
ASCDH2K - #56587



Arrow Lever Kit
ASCDH3K - #56589

CABLE & PULLEY SYSTEM

Each kit contains everything you need for your handle or solenoid to release your door latch from any spot within your door, including the hardware and allen wrenches.



Advanced Cable & Pulley System
ASCDHA01 - #56591

Kick Down & Throttle Cables

American Shifter's™ advanced cable system guarantees a long life of smooth operation. Available for throttle, transmission kick down, and custom cable systems. Braided stainless cable housings provide durability and sharp looks.

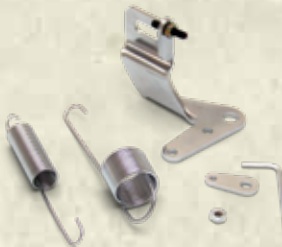

Throttle Cable Return Spring & Bracket
ASCKCBL7 - # 56261



GM TH-400 Electric Kick Down Cable Kit
ASCKCBL5 - # 56257



Ford C-6 Kick Down Cable Kit
ASCKCBL3 - # 56253

CABLES WITH CLASS!



THROTTLE CABLE KITS

PART NO.	SKU.	DESCRIPTION
ASCTCBL1	56265	Tuned-Port Adj. Throttle Cable 36"
ASCTCBL2	56263	36" Black Universal Throttle Cable

KICK DOWN CABLE KITS

PART NO.	SKU.	DESCRIPTION
ASCKCBL1	56249	GM TH-350
ASCKCBL2	56251	Ford C-4
ASCKCBL3	56253	Ford C-6
ASCKCBL4	56255	GM 700-R4
ASCKCBL5	56257	GM TH-400 Electric
ASCKCBL6	56259	Chevy Lt1 Throttle Cable Bracket
ASCKCBL7	56261	Throttle Cable Return Spring & Bracket

Pedals

American Shifter's™ advanced pedal assemblies offer a unique internal tension spring to ensure optimal performance and engine feedback. Available with a reinforced sturdy mounting system that allows a long life of smooth operation even under the harshest conditions.

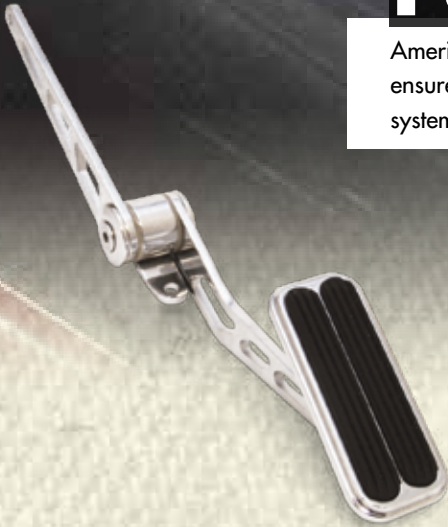

Gas Pedal Assembly - Firewall Mount
ASCPEDBA004 - # 56601



Billet Gas Pedal Assembly - Firewall Mount 1962-1967 Chevy II & Nova
ASCPEDBA001 - # 96132



Spoon Gas Pedal Assembly - Firewall Mount
ASCPEDBA003 - # 96137

Billet Gas Pedal Assembly - Firewall Mount 1964-1967 Chevelle
ASCPEDBA002 - # 96134



Billet Floor Mount Gas Pedal With Rubber Insert Assembly
ASCPEDBB001 - # 96133



Dimmer Switch Pedal - Direct Mount
ASCPEDCC001 - #56603



Billet Brake/Clutch Pedal Pad With Rubber Insert
ASCPEDAC001 - # 96135

Billet Door Looms

Hide Those Wires! American Shifter™ offers stainless steel door looms to hide those aftermarket wires that run through your door jambs. These are great complements to our power window kits, shaved door kits or custom stereo installs. The Stainless Steel Door Loom includes a pair of heavy-duty stainless steel braided hoses and billet aluminum hardware that resists rust for a lifetime of beauty. Custom made to ensure easy installation.

12"
ASCDL1 - #55977

18"
ASCDL2 #56239



Shifter Accessories

Ford AOD Adapter

Smooth Shifting! American Shifter's adjustable Ford AOD adapter removes the pain and guess work out of setting up your transmission shaft. American Shifter's unique adjustable design allows for fine tuned adjustments. Setting up your shift linkage has never been so easy!



Ford AOD Selector Shaft
ASCBK026 - # 49872



Neutral Safety Switch



Neutral Safety Switch
ASCSWT2 - # 56267

Neutral Safety Switch Backup Light Switch Kit



**Neutral Safety Switch Kit/
Backup Switch Kit**
ASCSWT2K - # 61253
Bracket Kit
ASCBK028 - # 00740

Micro Switch

These high-quality micro switches are ideal for all applications including parking & reverse lights! Ultra compact design ensures easy installation.



Micro Plunger Limit Switch
ASCSWT1 - # 56241

SmoothShift™ Shifter Linkage Kit

American Shifter's new SmoothShift™ shifter linkage kit will put a smile on your face every time you change gears! American Shifter's unique 48 spline design allows for the shifter arm to be positioned at any angle, resulting in longer or shorter shifter throw. Full 360° rotation allows for easy installation. Each kit includes rugged shift arm, column bushing, threaded connecting rods, ball pivot joints, hardware, and detailed instructions. Backed by a Limited Lifetime Warranty.

Fits:

- TH-200 Transmission
- TH-350 Transmission
- TH-400 Transmission
- TH-700R4 Transmission
- 4L60 Transmission
- 4L60E Transmission
- 4L80E Transmission



**Column Shift Linkage
Kit With Long Rod**
ASCCIM1 - # 56303

