



Content

- 1. View / Controls CarPro-Tec® GPS 2
- 2. Brief description of the controls 3
- 3. Turning Alarm and GPS tracker ON / OFF 3
- 4. Front of the CarPro-Tec® GPS - LED Indicator 4
 - a. Overview 4
 - b. LED Explanation 4
 - c. Explanation: Right Green LED 4
 - d. Blue LED light when connected to 5V power supply (GPS tacker-Module) 4
- 7. Settings for Siren (Time) 6
- 8. Adjusting the CarPro-Tec® GPS Infrasound-Sensor 7
- 9. What happens when the alarm is triggered? 8
- 11. Position monitoring on the Website (Online-Platform) 8
- Programming additional sensors 9
- Push button (programming sensors) 9**
 - LED Explanation 9
- 12. App GPS tracking 10
- 13. GeoFence-Area and Smart- Live-Tracking 10
- 14. Support 12
- 15. Questions and answers (FAQ) 12

1. View / Controls CarPro-Tec® GPS

Picture 1



Picture 2

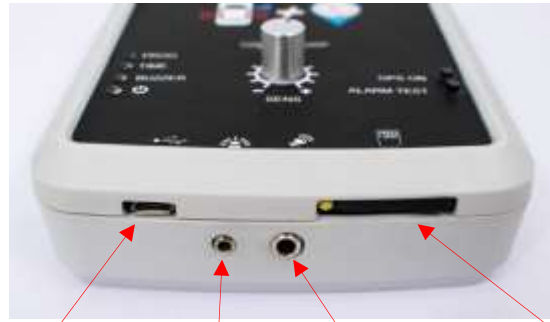

USB-Socket LED Socket Siren Socket SIM-Slot

2. Brief description of the controls

Pairing Buttons	With this button the radio components can be programmed. i.e. if you want to add additional sensors to your system. Protect your RV, vacation home, etc. with knockout gas, heat sensor, CO2, etc.
Siren setting	This button sets the time on how long the external siren will work
Signal transmitter	Switch on and off, the individual signal transmitter
On / Off button	This button can be used to switch the alarm module on and off
Alarm Test	This button can manually trigger an alarm on the GPS / GSM module to test the connection
GPS ON	With this button, the GPS / GSM module can be switched on, if the device is not connected to power supply. GPS turns on automatically when connected to power supply.
Room volume sensor	This knob adjusts the sensitivity of the integrated room volume sensor, clockwise increasing the sensitivity
USB-Socket	Connect the 5V power via micro USB plug
LED Socket	If desired, connect here the external arming LED display
Sirenen Socket	Here you can connect a wired siren, or a wireless siren radio transmitter (sold separately)
SIM-Slot	Insert SIM card for receiving text message, email and GPS inform.

3. Turning Alarm and GPS tracker ON / OFF

Note: The CarPro-Tec® GPS housing **has 2 modules, an alarm module (infrasound module) and a GPS tracker / GSM module.** The alarm and GPS modules are switched on and off separately. Both components have separate functions. To maintain all the functions of the CarPro-Tec® GPS, both components must work together and be powered up.

Turn ON Alarm

After the power supply is established, please turn on the alarm module. To do this, briefly press the on / off button with a pointed object (such as a ballpoint pen). (see picture 1)

Turn OFF Alarm

To turn off the alarm module, simply press the on / off button again. (see picture 1)

Turn ON GPS tracker

The GPS tracker starts automatically when connected to power supply.

If you want to start it already without power connection, press the "GPS ON" for one second. (see picture 1)

Turn OFF GPS tracker

To deactivate the GPS tracker, disconnect the plug from the USB socket and keep both buttons "GPS ON" and "Alarm Test" pressed for at least 3 seconds. (see picture 1)

4. Front of the CarPro-Tec® GPS - LED Indicator

a. Overview



LED - Indicator

b. LED Explanation



Power-LED=device in operation



Ready for pairing process



Pairing process successful = orange LED goes out



Armed



Triggering a sensor => left red LED flashes

c. Explanation: Right Green LED



LED	Green flashes short time all 3 seconds	Green flashes twice all 3 seconds	Green flashes long time all 3 seconds (1 sec. On, 3 sec. Off)	Green flashes constantly
Explanation	The device is connected with GSM-network	The device is connected with GPS-network	The connection to the GSM-network is established	SIM card was not recognized

d. Blue LED light when connected to 5V power supply (GPS tacker-Module)

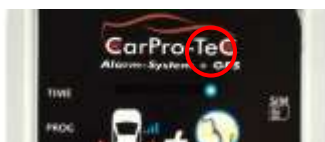

- Lights up constantly = GPS-module is connected to 5V power supply and working
- Flashing = GPS-module searching for GPS connection, temporarily disconnect the power and operate the unit on a battery-powered basis -> LED must flash when searching for GPS)

5. Mounting the CarPro-Tec® GPS

A suitable mounting location for the CarPro-Tec® GPS is:
a protected location in the vehicle near the power supply

1. Under the passenger seat
2. In the trunk
3. In the glove compartment
4. Place the CarProTec® GPS flat (with the LED area pointing upwards) so that the connection to GPS satellites can be made. The CarPro-Tec® GPS should be placed so that it cannot be easily seen from the outside. (trunk is an ideal place)

Connection of the CarPro-Tec® GPS to car power supply via the DC connector by means of USB charger in the vehicle.

Alternatively, the CarPro-Tec® GPS can be powered via the 12 to 5-volt converter available in our shop if you do not want to permanently occupy the DC connector.

The input voltage must be 5V. **Please note** that on many vehicles the DC connector socket is switched off when the key is removed. In this case, the CarPro-Tec® GPS is powered by the **internal battery for about 7 days**. If the vehicle not being used for more than 7 days, an optional powerbank can provide a power supply **for several weeks** (powerbank can be purchased in our shop).



Place the **arming LED light** that it is visible from the outside. (16.4 feet / 5-meter cable included for arming LED) If you want no arming LED light, do not connect the LED to the CarPro-Tec® GPS. Turn LED on / off via remote control. When turned on LED light will flash every 5 seconds.

Siren and arming LED can be connected as an option and are not mandatory for the operation of the CarPro-Tec® GPS.

The **Siren** should be placed away from the CarPro-Tec® GPS as the auto thief will most likely disable the siren first. If you want a silent alarm, do not connect the siren to the CarPro-Tec® GPS.



6. AMG World SIM Card

A SIM card is needed to have the CarProTec® GPS communicate with your cell phone to send E-Mail, text messages and provide current GPS position. The AMG World Sim Card can be used worldwide and is already included in your purchase and set up. No monthly cost accrue as SIM Card is included in purchase price. This includes 1.000 GPS positions and 10 alarm text messages per month.

Installation SIM Card

Open the SIM slot by pressing with a pointed object on the yellow button next to the SIM slot. Pull out SIM slot and place SIM Card as described below.



Important: SIM has to face down when inserted!



picture 1



picture 2

After inserting the SIM card, slide the SIM slot back into the CarPro-Tec® GPS as shown in picture 2.

6.1 Set up (only when you purchased a SIM Card from a different provider)

Notes:

- 1. Deactivate the PIN request of your SIM card before using it in the CarPro-Tec® GPS** (tip: inserting SIM into a mobile phone and switch off PIN query under Settings -> to make sure the phone deactivated the PIN request, please restart the phone!)
- 2. Please note that a prepaid card will be disabled after a period of inactivity.** Contact your GSM network provider/ SIM card provider for more information. The deactivation takes place depending on the provider after 3, 6 or 12 months.

7. Settings for Siren (Time)

Siren Settings

To set the siren running time, press the corresponding button labeled "Time".

The first press activates the setting mode.

The second press sets the run time to 0 seconds

The third, and so forth increases the run time by 10 seconds while the device is in setting mode.

Example:

- 10 seconds siren run = press 3 times
- 60 seconds siren run = press 8 times
- 2 minutes siren run = press 14 times

(Press the time button twice in quick succession, to have the system not activate the siren in the event of an alarm).



Signaling:

The device has 3 different types of signaler, each of which can be used to confirm inputs such as arm / disarm, or press a button and can be combined as desired.

Buzzer:

a short beep sound from the device. To control press the "Buzzer" button briefly, less than 0.5 seconds (i.e. just tap). If the device beeps for a long time, the signal transmitter is switched on. If it beeps twice, it is switched off.

Siren:

To control, press the "Buzzer" button for 1-3 seconds (i.e. keep it pressed). If the siren beeps once, the siren is switched on. If it beeps twice, it is switched off.



Vibration:

The device has a built-in vibration motor, which sets the housing in a slight vibration, to allow the quietest possible signaling. To control press the "Buzzer" button for more than 3 seconds. If the device hums once long, the signal generator is switched on, if it hums 2 times short, it is switched off.



8. Adjusting the CarPro-Tec® GPS Infrasonic-Sensor



-  Increase sensitivity -> Turn right
-  Reduce sensitivity-> Turn left

In this case, the activation of the beep by the "Buzzer" button (see above) is helpful in order to acoustically indicate the switching state (arming).

Please note that a violent leveraging of doors and windows by a vehicle thief causes them to be opened with a jerk. No vehicle thief can open a locked door or window "in slow motion" very carefully and slowly. Therefore, please set the sensitivity so that the alarm will be triggered by a small jerky opening of doors or windows.

If you set the sensitivity too high, it will lead to unwanted false triggering, i.e. due to drafts due to incompletely closed and sealed windows, ventilation flaps, etc.

Fine-tuning the sensitivity might require readjustment 2-3 times during practical tests.

If there is a short time after the first startup of the system and an alarm triggers, this may well be a "false" alarm due to too high set sensitivity of the sensor. In this case reduce the sensitivity on the knob very slightly to the left and then observe again.

9. What happens when the alarm is triggered?

The infrasound sensor of the CarPro-Tec® GPS triggers an alarm

- ➔ CarPro-Tec® GPS turns on the siren
- ➔ CarPro-Tec® GPS sends text message with current position to all programmed telephone numbers
- ➔ Current GPS-position will be transferred to the online portal – live tracking of vehicle
- ➔ CarPro-Tec® GPS calls all (max.3) programmed telephone numbers one after the other
 - ➔ If a call is answered, it can be heard inside the vehicle.
 - ➔ **ATTENTION: The AMG World SIM card cannot make calls, it can only send SMS and email and provide GPS tracking!**

10. Remote Control Features



Remote controls are supplied with 2 or 4 buttons (depending on availability). Important and relevant are only the following keys:

- Lock opened = Alarm system is disarmed
- Lock closed = Alarm system is armed

11. Position monitoring on the Website (Online-Platform)

If you use a SIM card with data volume in the CarPro-Tec® GPS, then you can log on the website with the access data that you find on the back of your device and see online the position. The username usually consists of **6 digits** and the **default password is 123456**.

The device allows live tracking of your vehicle.

Under the input field for logging in you can set the language of the page, by default this is set in English. A checkmark next to "Save settings on this computer" will save the language for future visits.

If you are logged in on the page, you will see the navigation bar on the left side consisting of the following:

Location list: Query the last known position of your CarPro-Tec®

History: Query and display of the stored position data of your CarPro-Tec®

Reports: Download various movement data of your CarPro-Tec® GPS as PDF or Excel file

Map: manual entry for longitude and latitude and display on the map

Chart: Statistics on the motion profile of your CarPro-Tec® GPS

Manage: Possibility to change the password for website access.

Attention! We recommend changing this as soon as possible to prevent external access to your data.

Programming additional sensors

Note: By default, all sensors and remote controls are delivered already set-up for immediate usage. However, if you order additional sensors, they have to be set up by the owner.

Push button (programming sensors)

1. Press Program button
2. LED (orange) is flashing
3. Trigger sensor (maybe multiple times)
4. orange LED will go off after successful programming



Instructions for additional sensors such as door/window sensors, glass-breakage sensors, motion detectors, smoke detectors and anesthetic gas detectors can be found in the AMG Shop. Enter the article number **900941** at the top of the search field.

LED Explanation



Ready for pairing process



Pairing process successful = orange LED goes out



Triggering a sensor => left red LED flashes

You can set your own personal monitoring, e.g. for RV / caravans, trucks, boats, vacation homes etc. There are a variety of wireless sensors available:



Gas detectors, knockout-gas detectors, smoke, water and temperature sensors, motion detectors, door / window magnetic sensors, bicycle and furniture security, DSP proximity detectors for outdoor use, etc.

Up to 20 additional wireless sensors can be registered in CarPro-Tec GPS Plus®, giving you a comprehensive safety system.

12. App GPS tracking

App „Smart-Tracking“ in Appstore and Google Playstore

To track your vehicle, please download the following available apps (free of charge). Smart Tracking for iOS and Android to get the current GPS position on your mobile device.

Download Android (Google Play)
Download iPhone (App Store)



Open the App -> Log in-display



= User name (User ID) = last 6 digits of the IMEI (see label)
= 1 2 3 4 5 6 (or own password, if not changed)

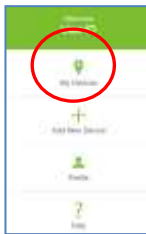

13. GeoFence-Area and Smart- Live-Tracking

a. GeoFence

→ Recommendation -> Establish the GeoFence-Area in the online portal at smart-tracking



= Capture new Geo dates

→ Assign a name for CarPro-Tec that is used in Info-SMS

→ Set area directly in the map

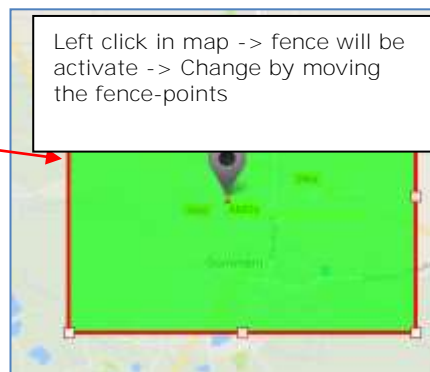

Pulling the fence sufficiently large to ensure 1x positioning inside ("leaving the area" see below) of the fence. Otherwise no tripping possible when crossing the fence

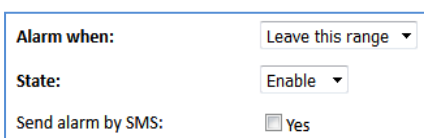

- ➔ Change: Alarm when:
 1. Leave this range = Leave this range
 2. Enter this range = Enter this range (Enter the area)
- ➔ State
 1. Power On = Enable
 2. Power Off = Disable

➔ Send Activate alarm by text message for GeoFence area

Send alarm by SMS: Yes

➔ SMS only to stored phone numbers

ATTENTION! Any text message dispatch is only possible with a suitable SIM card. Pure data SIM cards in the CarPro-Tec® GPS cannot send SMS!

Example-SMS: Leave the area

Example-SMS: Enter the area



Check at **smart-tracking** or on your app smart tracking for accurate tracking.

Prior to shipping, we have already installed and activated the GeoFence alarm info by e-mail to the customer's own e-mail address from our online system. If you set up a GeoFence area, you will receive an e-mail to your e-mail address when entering/leaving the area you have set up (usable with any SIM card with data volume, including AMG World SIM!).

➔ Data Usage/Alarm-E-Mail: 1x E-Mail = 10 GPS-Positions

b. Smart-Live-Tracking in Online-Portal



14. Support

Error description	TIPS and references
The device does not send the current GPS- position	<ul style="list-style-type: none"> - SIM card with monthly data volume embedded in CarPro-Tec® GPS? - Charge the internal batteries sufficiently and change them regularly - Prepaid SIM card is expired - For World SIM: 1,000 GPS positions consumed in the current month? -> 1,000 new posts available at the beginning of the following month - Connection to GPS satellites insufficient due to unfavorable mounting position
SIM card cannot be reached by call / text message and does not send a position	<ul style="list-style-type: none"> - PIN request of the SIM card disabled -> Control of a mobile phone (not for World SIM)
„False“ alarms	<ul style="list-style-type: none"> - Reduce the sensitivity of the infrasound sensor
Unintended call/SMS-function	1.
The data volume of the SIM is insufficient	<ul style="list-style-type: none"> - Buy additional data volume - Increase GPS position reporting interval
Settings do not change after SMS	<ul style="list-style-type: none"> - Reset the settings with RESET! And restart the programming of all settings - etc.

15. Questions and answers (FAQ)

Question: With which app can I monitor the position of the CarPro-Tec® GPS?

Answer: You can access the GPS portal from any Internet-enabled device smart-tracking.

There is no downloading and saving software (App) required.

We recommend setting a bookmark on the home screen, then you can log in with 1 click.



By SMS (command: LOC = see page 11) you can request the current position at any time.

Our CarPro-Tec® GPS with World Data-SIM can be used worldwide, without power connect, without your own SIM card and thus without additional SIM card costs.

Question: Why is a speed displayed even though the vehicle is not moving?

Answer: The GPS module of the CarPro-Tec® GPS receives different satellites. This is changing constantly. Depending on the position of the satellite used in relation to the GPS module, the speeds are derived from the previous and the next position calculation. This can sometimes be 16 feet or less, from this the system deduces that the GPS module/vehicle has moved and shows i.e. 1.2 Miles / h, although the vehicle is stationary.

Question: Why are different heights displayed?

Answer: This also depends on the position of the satellites used for the computation, it is sometimes 5 or more satellites, the altitude is more accurately determined, it is only 3, then a height determination is much more difficult. As the satellites are constantly changing, the GPS module tries to show an average of the different calculations, and this value is subject to normal fluctuations.

Question: Why are different battery levels transmitted?

Answer: CarPro-Tec® GPS has 2 small lithium rechargeable batteries that allow you to increase the time between charging and monitoring, i.e. at night, is bypassed.
The full charge will last for up to approximately 7 days, depending on various factors.
When a request is made, power is removed from the battery, the worse the radio connection for GPS and GSM, the more power is needed.

The battery level will be displayed correspondingly lower because the remaining working time would be shorter for this consumption. If the connections are good, less power is needed. The battery indicates a higher charge level or remaining working time.

As a rule, the consumption is reduced again after the signals have been sent, so that another battery indicator can be made at a different time. Add to that the temperature, it is colder, so the batteries are sluggish and less efficient than at room temperature. For smartphones, the battery indicator is also constantly changing, as this would irritate the user but the ads are "smoothed", the customer sees a slow sinking level, although this is not the reality.

Question: Why does the CarPro-Tec® GPS send an alarm even though nobody has opened the vehicle?

Answer: The system uses a highly sensitive sensor that detects even the smallest fluctuations in air volume. Since each vehicle is different in size, the sensor must be adjusted by means of rotary control so that it does not come to an unwanted triggering.

If the sensitivity is too high, small variations in air pressure, i.e. caused by wind blowing past the ventilation openings of the vehicle to trigger. Therefore, the sensitivity should be adjusted so that only a jerky opening of the doors leads to the triggering.

No thief can open a vehicle in slow motion. In addition, no thief expects that opening the doors or slamming the windows triggers an alarm.

In order to trigger an alarm independently of the room volume sensor, radio sensors for windows, doors and motion detectors are also available for the CarPro-Tec® GPS (see AMG shop).