

AMP RESEARCH BedStep[®]

MADE IN USA

APPLICATION:
Toyota Tundra

MODEL YR:
2014 - Current

PART NUMBER:
AMP 75309-01A

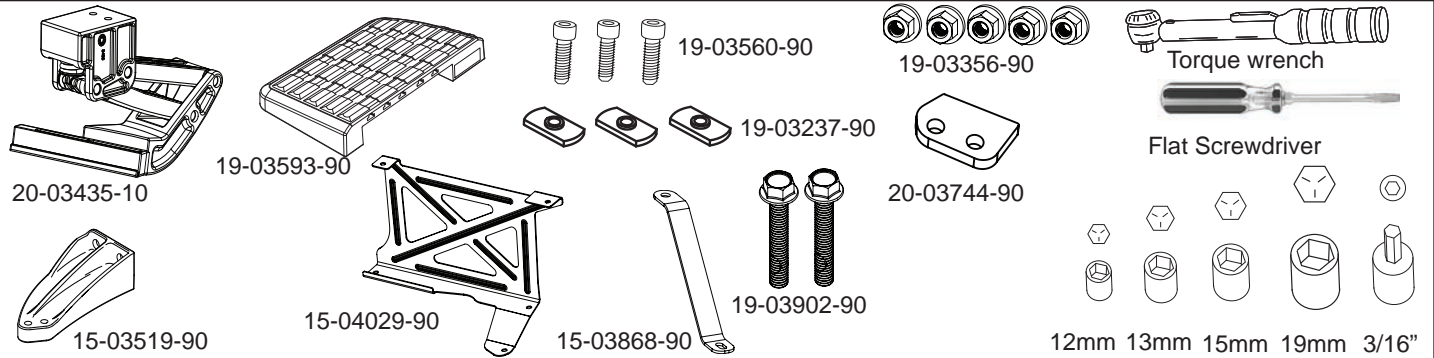

Secure linkage in vice and tighten bolts. Do not Torque. Allow steel bracket to rotate freely.

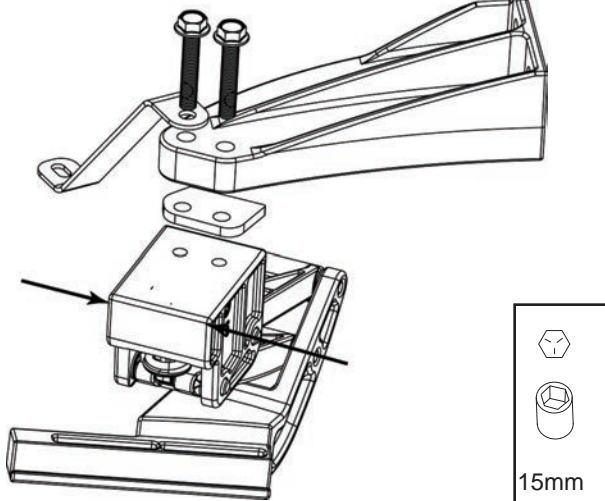

Remove corner bumper cap and use flat blade screwdriver to pry loose. Use caution when removing tabs.

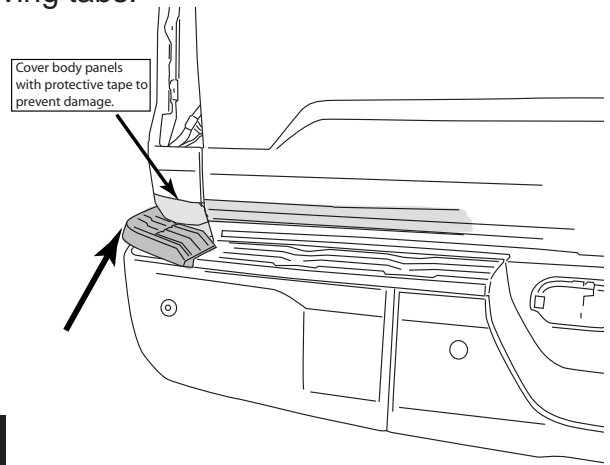

Remove license plate light by rotating and pulling out. Squeeze metal tabs holding trailer hitch plug and remove.

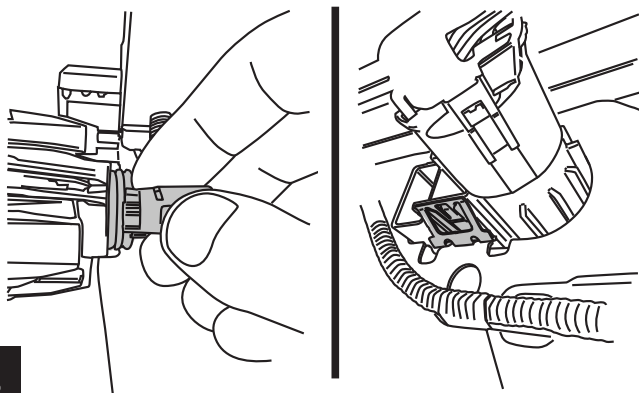

Remove plastic plug holding bumper cap onto lower portion of bumper. Remove license plate and plug behind holding bumper cap in place.

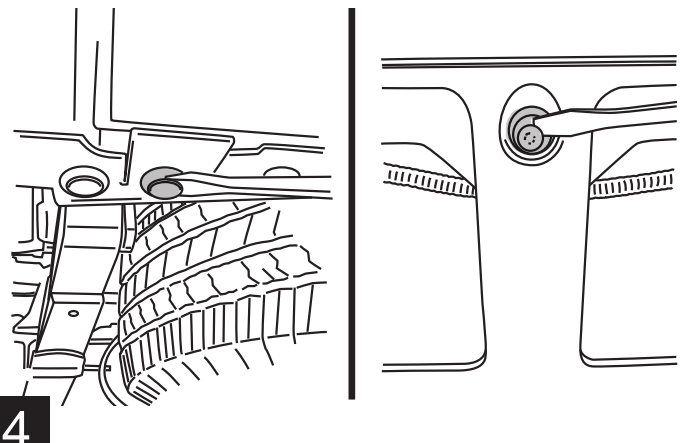

Remove bumper cap from bumper. Use flat blade screwdriver or long pliers from underside of bumper and fold or squeeze tabs inward.

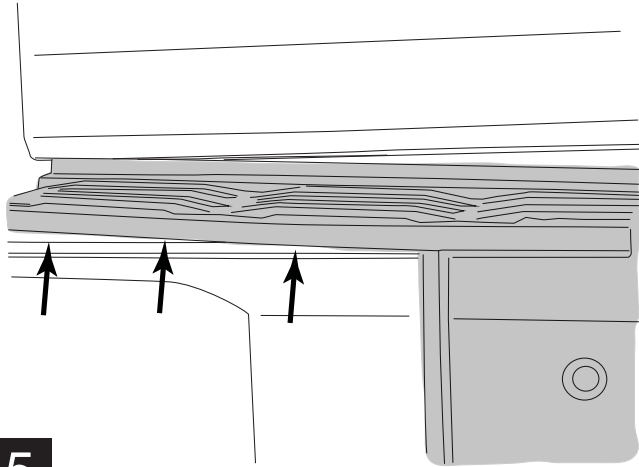

5

Loosen and remove three lower bolts that secure bumper corner bracket in place.

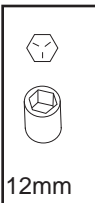
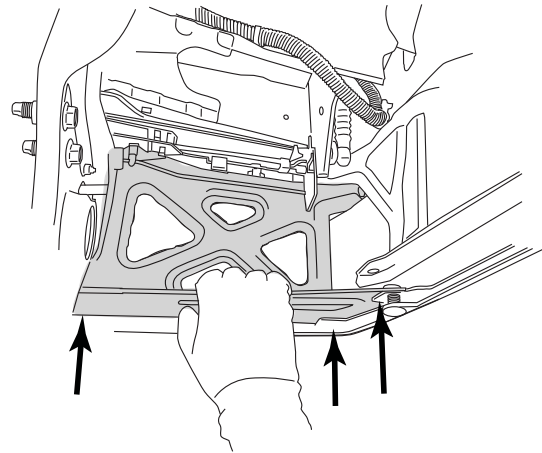

6

Lift bumper cap away and loosen and remove 2 upper bolts holding Re enforcement bracket in place.

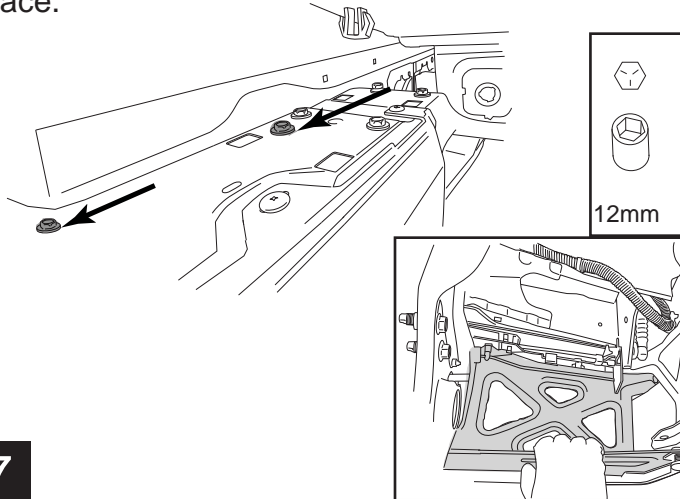

7

Replace Re enforcement bracket (15-03927-90). Reinstall bolts from step 6 and 7. Use provided nuts (19-03853-90) to secure bracket in place. Replace bumper components from steps 2-5.

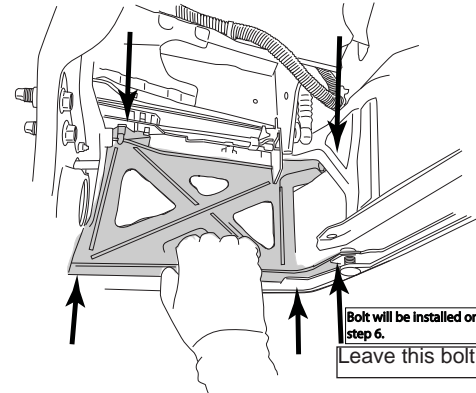

8

Driver Side bumper mount

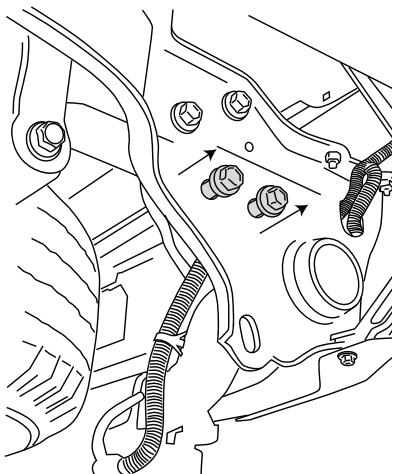

9

Install mounting bracket using factory fasteners. Torque fasteners to 90ft-lbs/125Nm. Align bumper support bracket (15-03868-90) to mounting hole in Re enforcement bracket (15-03927-90). Torque nuts to 33ft-lbs/44Nm.

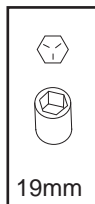

10

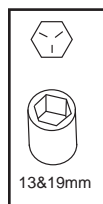
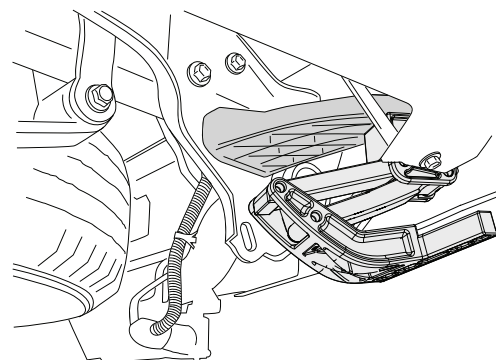

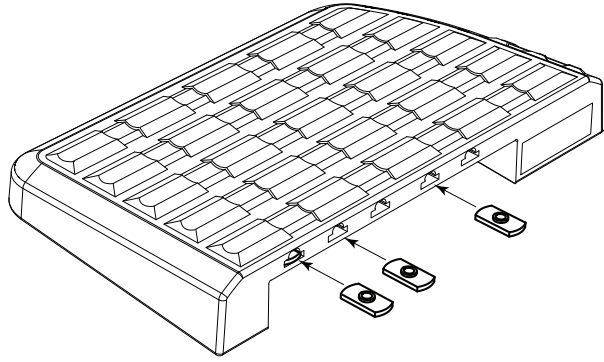

5

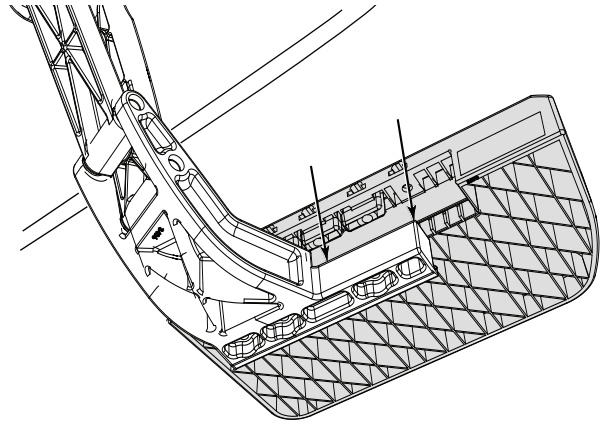

6

Torque bolts to 6 ft-lbs / 8 Nm.

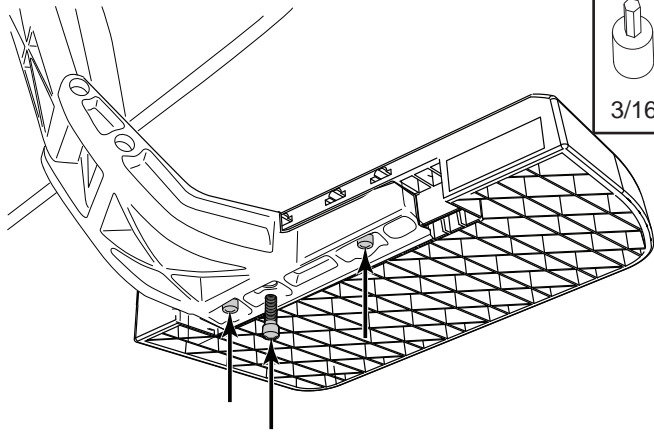

3/16"

7

NOTE: Overtightening may damage [step pad](#)

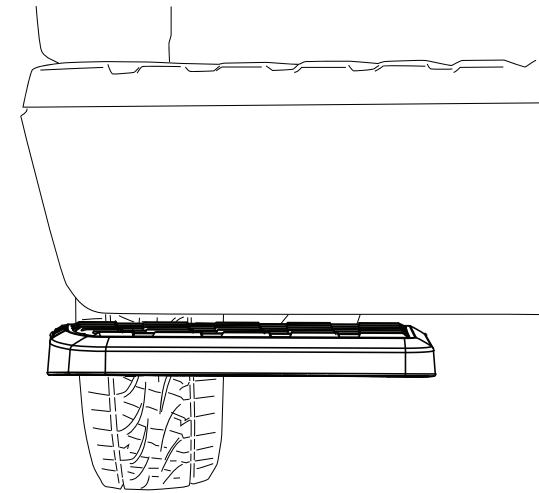

8

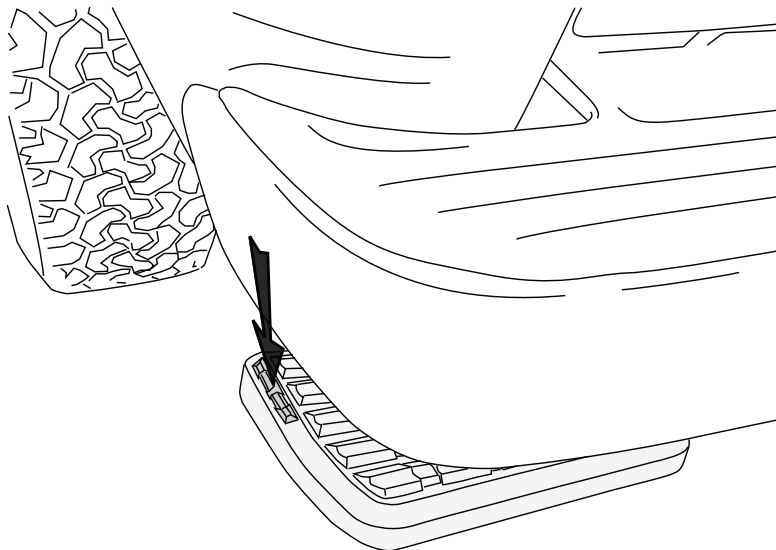

9