

**KIT #79412**

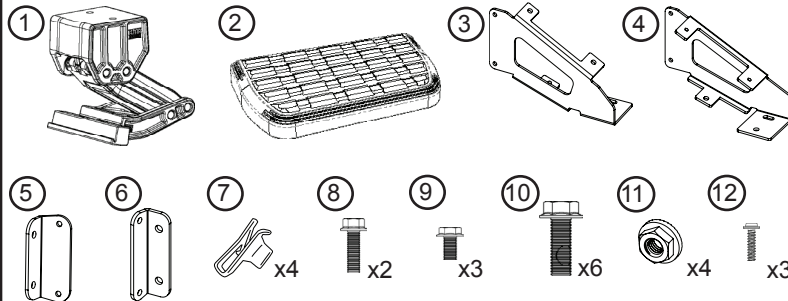

**P/N 75412 SOLD SEPARATELY**

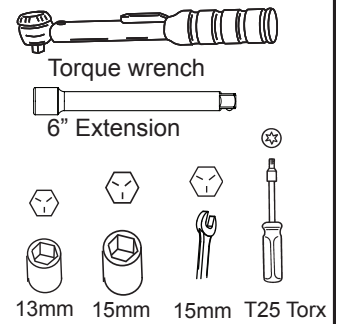

**Preview of final assembly...** Driver Side and Passenger Side will be assembled differently, resulting in mirror images of one another.

Driver Side

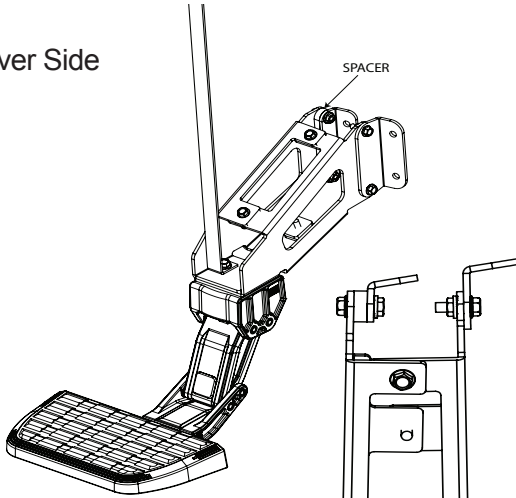

1

Passenger Side

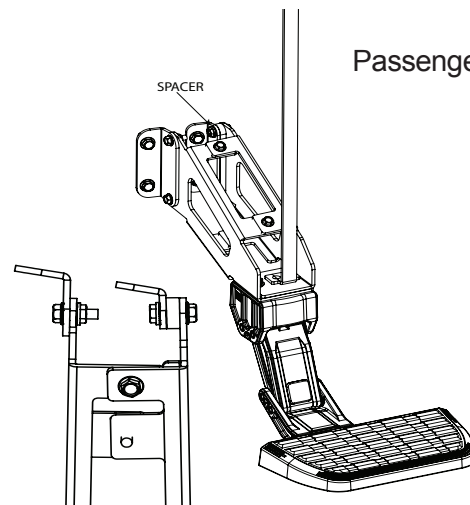

**Main Bracket Assembly...** On Driver side, bolt Left Main Bracket (3) over Right Main Bracket (4) and hand tighten all three (9) Small M8 Bolts (2 on top, 1 on bottom).

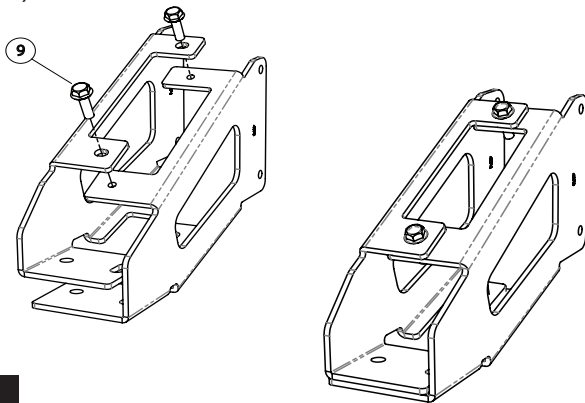

2

**L Bracket Assembly...** On Driver Side, bolt spacer in between Left Main Bracket (3) and L Bracket (6) using longer M8 bolts (8). Bolt Right Main Bracket (4) to L Bracket (5) using 2 M8 bolts. Tighten to 20 ft lbs.

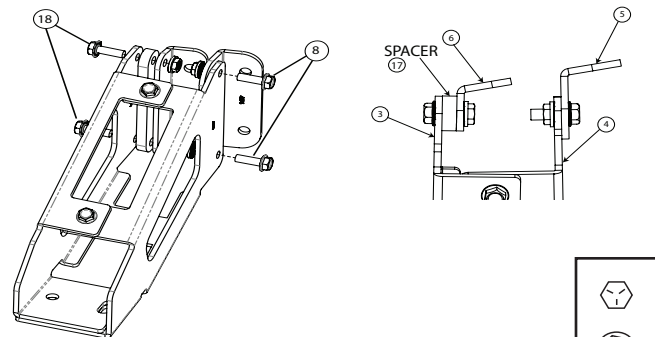

3

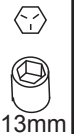
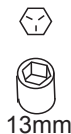

Assemble bracket to linkage assembly using M10 Bolts. Tighten just enough to be able to swivel assembly back and forth.

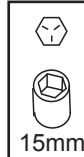
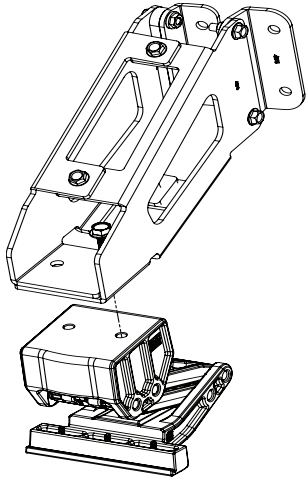

4

Insert four U clips into cutouts in frame. *Be careful not to drop U clips in frame.*

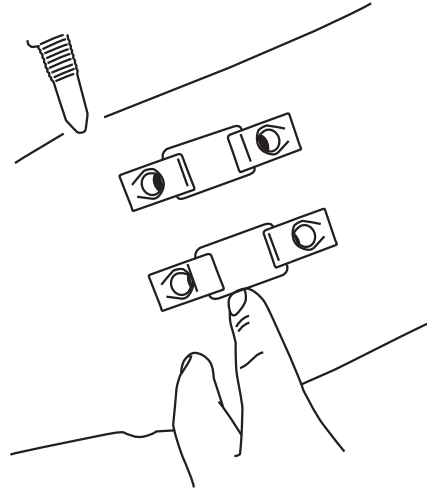

5

Set assembly in place and tighten 4 M10 bolts to the frame using a 15mm socket. Torque bolts to 33 ft-lbs. **Note: Extension may be needed to access bolts.**

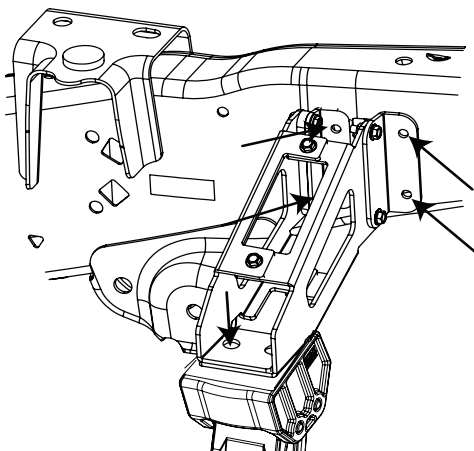

6

Insert L bracket in inner channel near the wheel well. Bolt L bracket with supplied nut and bolt. Do not tighten.

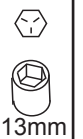
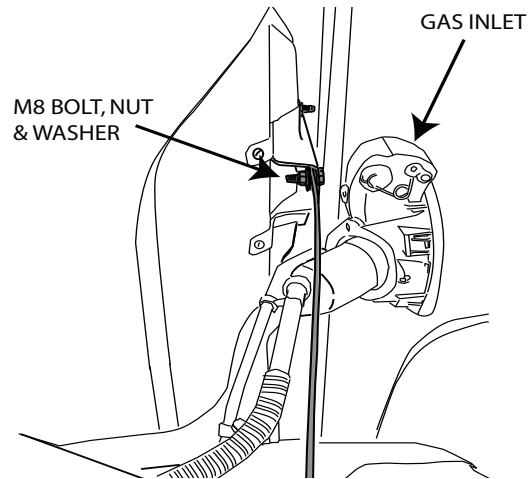

7

Attach L bracket to forward most bolt using the final M10 Bolt. Do not tighten. Orientation is shown below for driver side, mirror for passenger side.

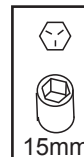
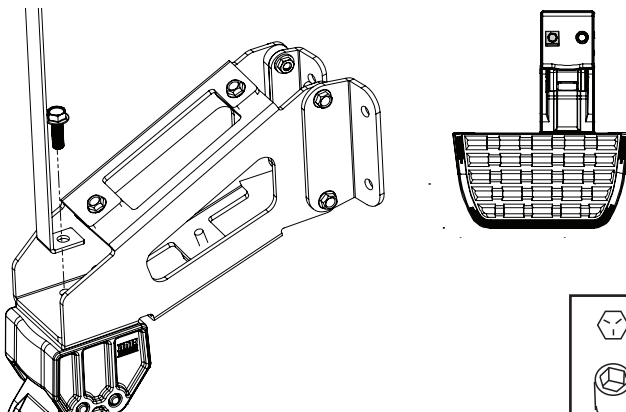

8

Offset the step pad forward and secure using provided PT Screws. Tighten to 5 ft-lbs using T25 torx bit. **Note: Driver side shown**

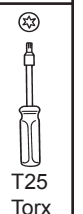
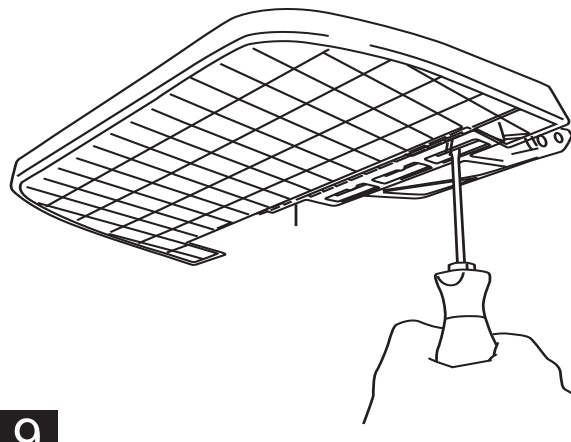

9

Adjust step pad to be in line with fender.

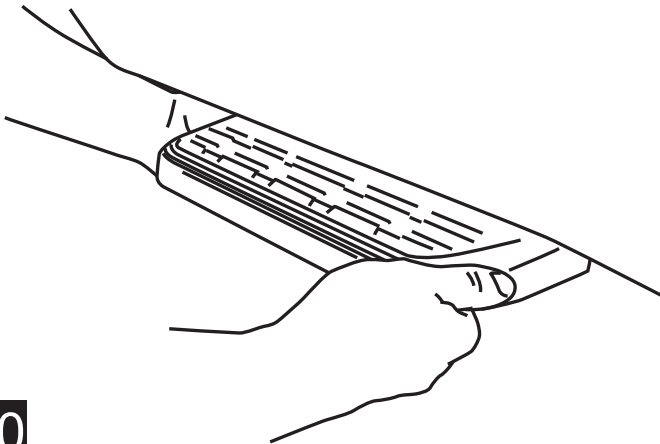

10

Once support bracket is secured, torque bolts to 33ft. lbs as shown below. Tighten M8 Bolts from step 2 to 20 ft lbs.

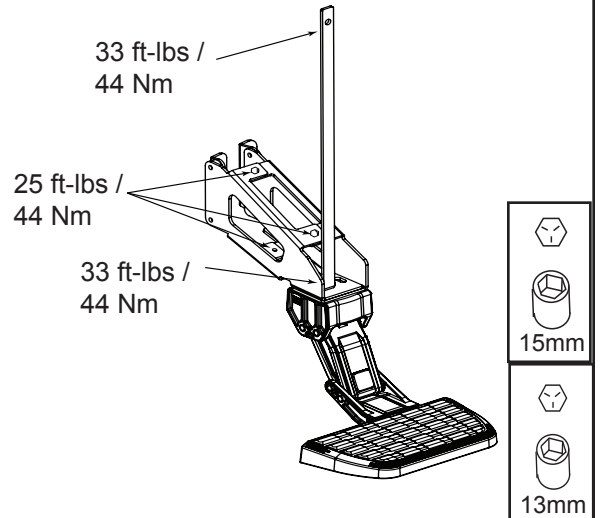

11

To deploy the step, press down using your foot on the outside edge of the step pad.

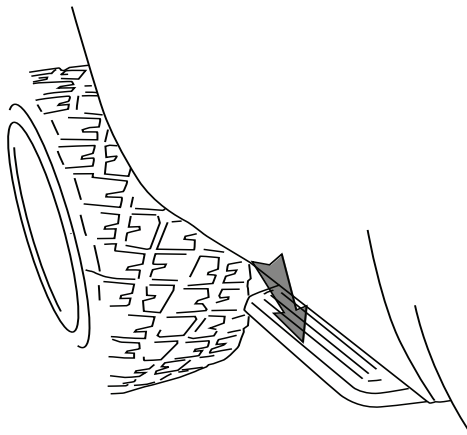

12

To retract, gently kick up on the underside of the step pad.

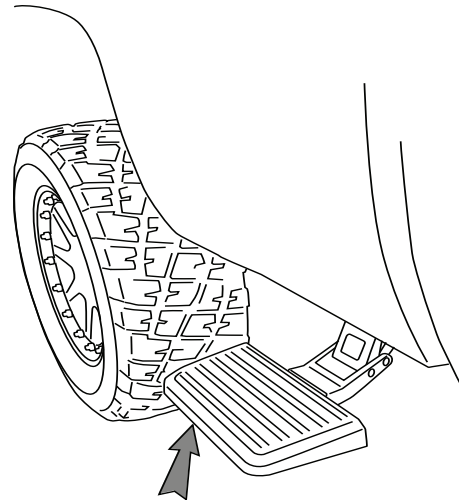

13

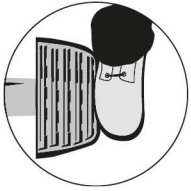

## BEDSTEP2™ OPERATION

The AMP Research BedStep2™ is foot operated and deploys and retracts with a nudge of your foot. To deploy, press down using your foot, on the outside edge of the step pad.

Maximum load capacity of the deployed step pad is 300 lbs.

Always use appropriate hand holds when stepping up to or down from your truck's cargo bed.

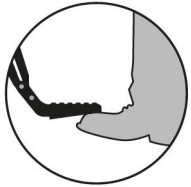

To retract, gently kick up on the underside of the step pad.

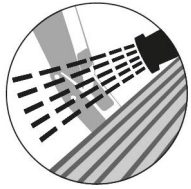

**MAINTENANCE TIPS** - The stepping surface and linkage should be periodically washed with mild soap and water using a soft brush or sponge to dislodge any mud, dirt or accumulated road grime.

**In severe driving conditions, pressure washing the linkage is strongly recommended.**

Do not apply silicone spray, waxes or protectants like Armor All® to the stepping surfaces.