

# Installation Instructions



## Ventvisor® Deflector

### Important Safety Information



- CAUTION - Before driving, ensure that the vent visors are properly secured to vehicle.
- Do not use automatic “brush-style” car washes.
- Do not use cleaning solvents of any kind.
- Periodically check all components for tightness.
- When using Surface Prep, avoid contact with skin. Use in well ventilated area. If contact is made with material, flush area with large amounts of water. If irritation persists, get immediate medical attention. USE PREP ON RUBBER ONLY

### Contents - 2 Piece Set **NOTE:** Actual product may vary from illustration.

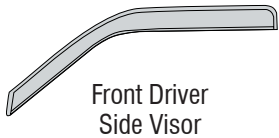

Front Driver Side Visor

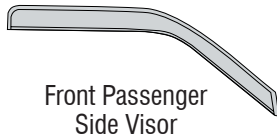

Front Passenger Side Visor



Alcohol Pad x2

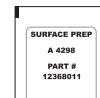

Surface Prep

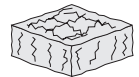

Scotch Brite pad

### Contents - 4 Piece Set

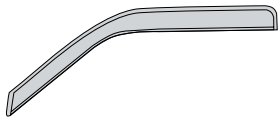

Front Driver Side Visor

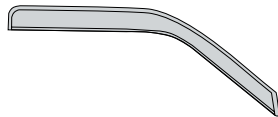

Front Passenger Side Visor



Rear Driver Side Visor



Rear Passenger Side Visor



Alcohol Pad x4



Surface Prep x2

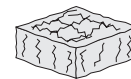

Scotch Brite pad

### Tools Required



Car Wash Supplies



Clean Towel



Nut Driver

### Preparation Before Painting / Installation

- A trial fit is recommended to ensure proper positioning and fit.
- Check fit of parts before painting as we will not accept the return of modified or painted parts.
- Wash and dry your vehicle to remove any debris and/or dirt from the installation area.

# Installation Steps

**NOTE:** Actual application may vary slightly from drawings.

Choose the appropriate installation method for your vehicle by viewing mirror diagram.

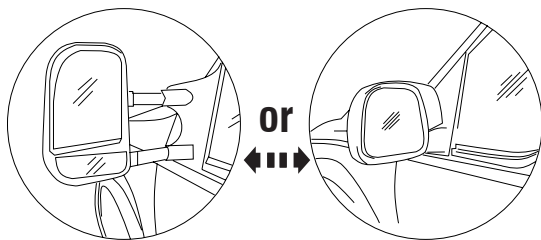

1

**NOTE:** Deflectors mount on the **OUTSIDE** rubber trim of door frame.

Remove the interior plastic mirror cap by pulling outwards.

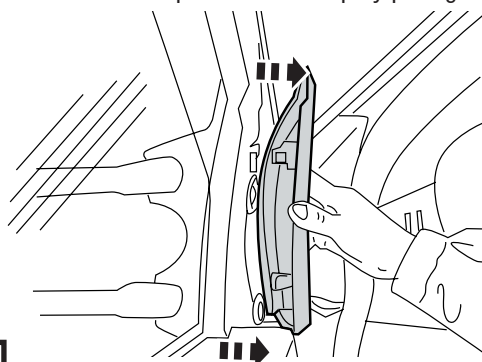

2

**NOTE :** 2008 and newer models proceed to Step 3. 2007 and older models proceed to Step 5.

Remove the (2) rubber caps to expose mirror mounting hardware. Temporarily remove the strip of adhesive tape.

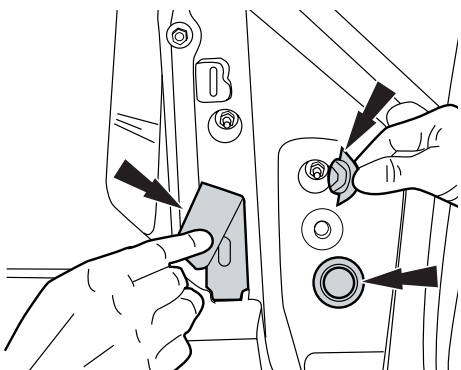

3



Loosen but do not totally remove the (4) exposed nuts to expose a gap necessary for the front end flange installation. **Proceed to Step 7**

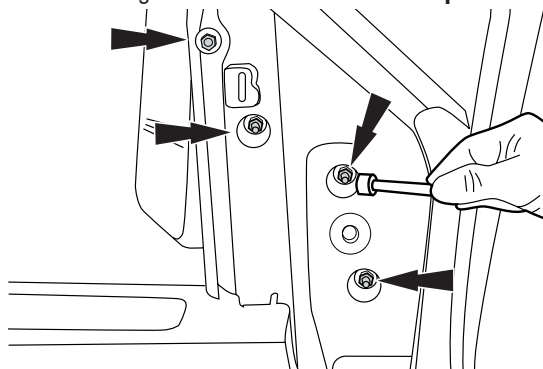

4

Remove the (2) rubber caps to expose mirror mounting hardware. Temporarily remove the strip of adhesive tape.

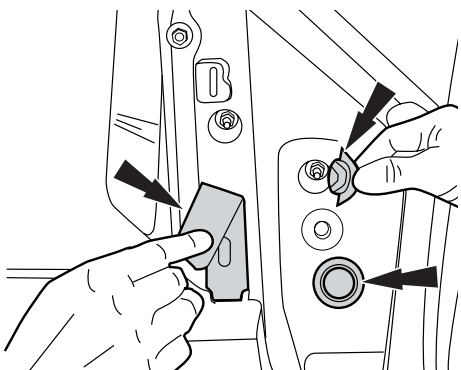

5



Loosen but do not totally remove the (5) exposed nuts to expose a gap necessary for the front end flange installation. **Proceed to Step 7**

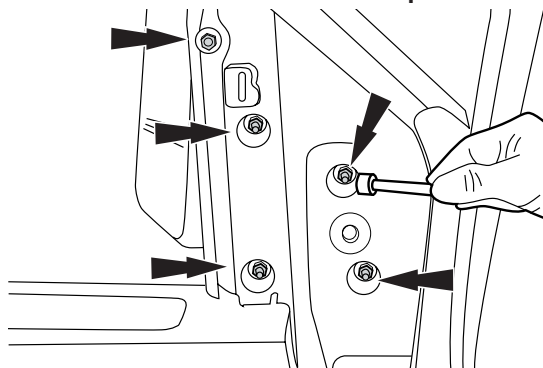

6



Scuff the rubber trim where the visor will mount with a scotch brite pad and clean with an alcohol pad. Then apply one coat of surface prep and let air dry.

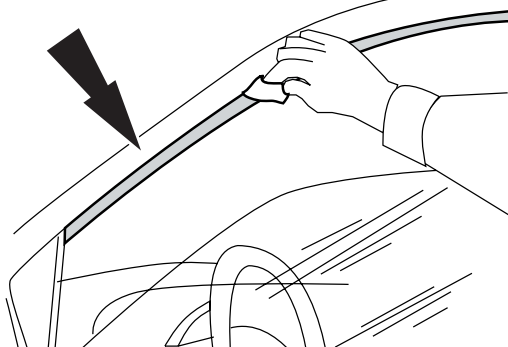

7

Remove tape liner from front flange. Peel back 2" (5 cm) of tape liner from each end of top flange.

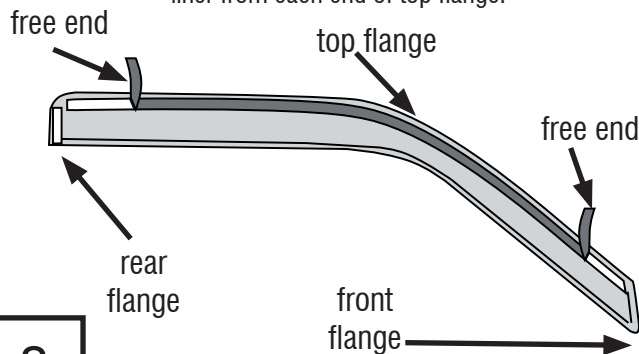

8

## Installation Steps

**NOTE:** Actual application may vary slightly from illustrations.

Align the driver side visor with the previously prepared rubber trim. Slide the front end flange under the mirror cap.

slide front flange under mirror cap

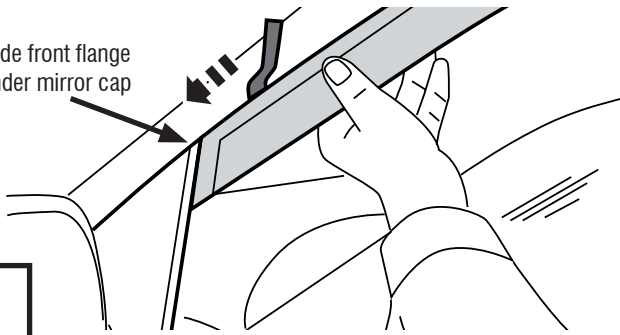

9

With the visor in its final position, remove the remainder of the liner by pulling on free ends.

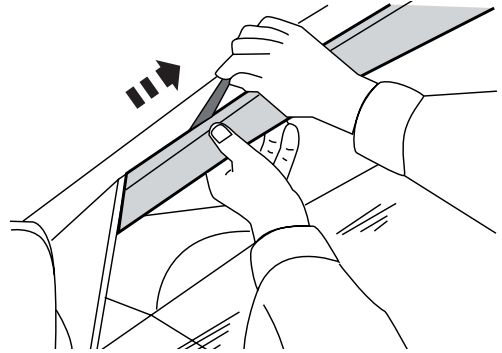

10

Apply pressure along the flange edges to secure in place.

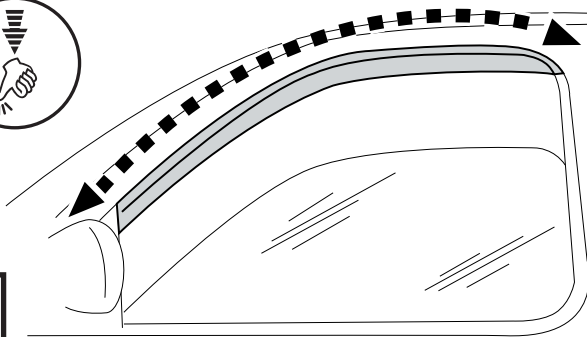

11



If applicable, reverse **Steps 2 thru 6** to retighten mirror. Replace tape previously removed, and replace rubber caps.

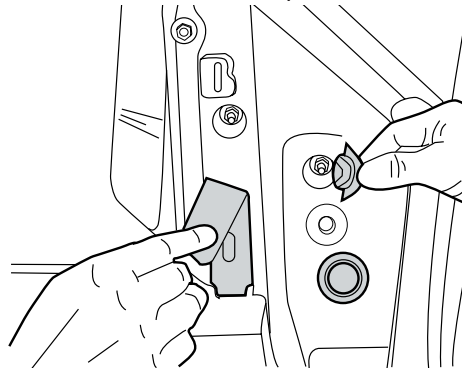

12

## 4 Piece Set

The **crew cab visor** attaches to the rubber trim. Prepare the trim with the scotch brite pad, alcohol pad, and surface prep before installing.

The **pop-out visor** attaches to the painted surface with the alcohol pad before installing. **Do not use the scotch brite pad and surface prep during the pop-out visor installation.**

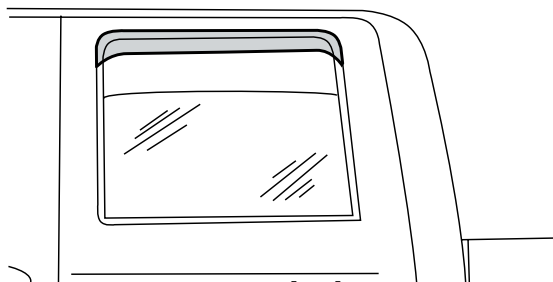

crew cab visor

OR

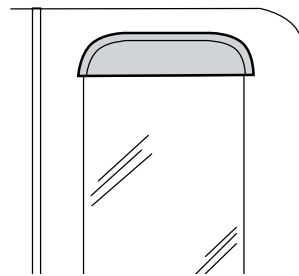

pop-out visor

13

## Care and Cleaning

- Wash only with mild soap & dry with a clean cloth.

## Congratulations!

You have purchased one of the many quality Auto Ventshade™ branded products offered by Lund International, Inc. We take the utmost pride in our products and want you to enjoy years of satisfaction from your investment. We have made every effort to ensure that your product is top quality in terms of fit, durability, finish and ease of installation.

