

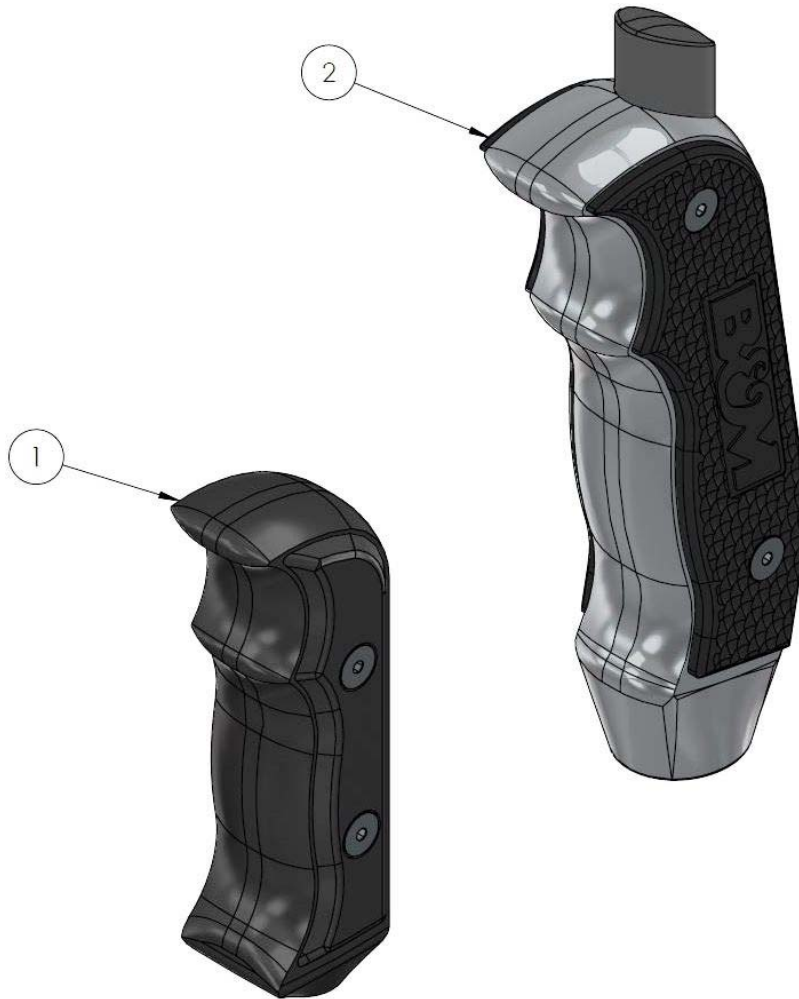

Installation Instructions for Catalog # 81101  
**MAGNUM GRIP SHIFTER HANDLES**  
 for 2007-2011 JEEP WRANGLER



ITEM NO.	PART NO.	DESCRIPTION	QTY.
1	N/A (SHIPS ASSEMBLED)	SHIFTER HANDLE ASSY, TRANSFER CASE, MAG GRIP, JEEP JK	1
N/A	4001714	• HANDLE BODY, TRANSFER CASE, MAG GRIP, JEEP JK	1
	3401537	• SCREW, 6-32 × 5/16" FLAT HEAD, ALLEN DRIVE	4
2	N/A (SHIPS ASSEMBLED)	SHIFTER HANDLE ASSY, MAIN, MAG GRIP, 07-11 WRANGLER	1
N/A	4001736	• HANDLE BODY, MAIN, MAG GRIP, 07-11 WRANGLER	1
	4101361	• PUSH BUTTON, MAGNUM GRIP SHIFT HANDLE	1
	3401550	• ROLL PIN, 3/32" DIA × 7/8" LONG	1
	3401549	• SCREW, 6-32 × 1/4" FLAT HEAD, ALLEN DRIVE	4
	4001492	• COVER, HANDLE, LEFT, DIAMOND KNURL, BLACK	1
	4001495	• COVER, HANDLE, RIGHT, DIAMOND KNURL, BLACK	1

## BEFORE STARTING

- Take a moment to read and understand these instructions before installing your B&M Magnum Grip Shifter Handle.
- Use the parts drawing and list (front page) to verify your kit's contents. In the unlikely event of missing parts, please contact B&M Technical Support for replacements.
- We highly recommend that you retain all factory parts.
- Work safely! Turn off your vehicle's ignition and set the parking brake.

## REMOVE THE STOCK SHIFTER HANDLES



1. Use a plastic trim tool to separate the trim ring from the bottom of each shifter handle.

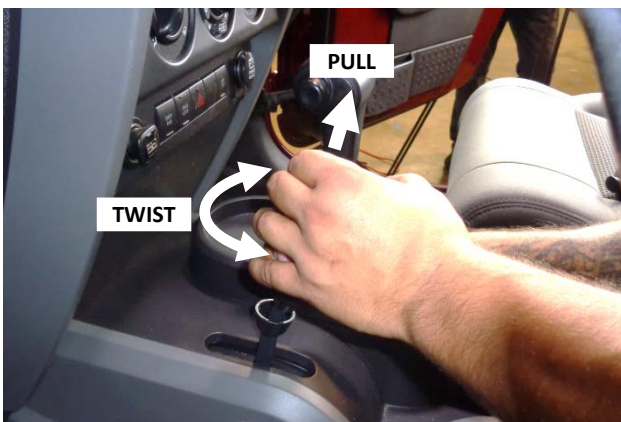

2. Grab the transfer case shifter handle firmly with both hands. Twist the handle side to side while pulling straight up to remove it from its lever.



3. Remove the screw at the base of the shifter handle and remove the handle from the lever.  
**NOTE: Retain the screw for use at Step 7.**

## INSTALL THE B&M SHIFTER HANDLES



4. On the transfer case shifter handle assembly (1), back out the four screws until their heads extend slightly above the handle surface.

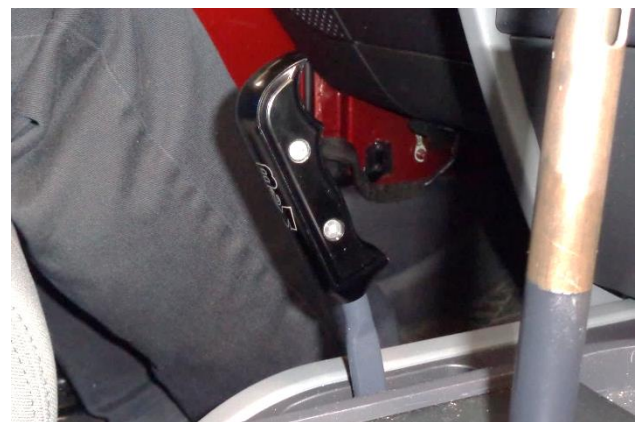

5. Install the handle on the transfer case shift lever. Align the handle as desired, then tighten the four screws.



6. On the main shifter handle assembly (2), remove the left handle cover. Install the handle on the shift lever, and align the handle and lever screw holes.



7. Install and tighten the stock shifter handle screw (removed at Step 3).



8. Reinstall the left shifter handle cover.



**Congratulations, the installation of your B&M Magnum Grip Shifter Handle is now complete!**