

2006 Chevrolet Trailblazer SS Exhaust System Installation



Precision manufactured using aircraft quality T-304 stainless steel; this system is designed to endure years of heavy use. Installing a Borla Performance Exhaust System on your vehicle will eliminate the restrictive design of the stock exhaust, allowing your engine to discharge exhaust gas easier. The result is more horsepower and torque, longer engine life, and a distinctive throaty growl- all this, with easy bolt-on installation. These installation instructions have been written to help you in the installation of your Borla Performance Exhaust System. Please read it completely before installing your system.

Thank you for purchasing a Borla Performance Cat-Back™ Exhaust System.

Borla Performance Cat-Back™ Exhaust System (Part number 140206) has been designed for the 2006 Chevrolet Trailblazer SS equipped with a 6.0L V8 engine, all-wheel drive and an automatic transmission.

Borla Performance Industries recommends that an exhaust shop or professional after market parts installer, who has all the necessary equipment, tools and experienced personnel needed for proper installation, should perform the installation of this system. However, if you decide to perform the installation, we recommend someone should help you. Ensure the installer uses all under car safety precautions including eye protection.

Please take time to read and understand the following...

By installing your Borla Performance Exhaust System, you indicate that you have read this document and you agree with the terms stated below.

It is the responsibility of the purchaser to follow all installation instruction guidelines and safety procedures supplied with your Borla Performance Exhaust System

Borla Performance Industries assumes no responsibility for damages occurring from misuse, abuse, improper installation, improper operation, lack of responsible care, or all previously stated reasons resulting from incompatibility with other manufacturer's products and/or systems.

Minimum Required Tool List:**TOOLS:**

- 1 3/8" Drive Ratchet
- 2 3/8" Drive Extension 3"
- 3 15mm Socket
- 4 Pry Bar
- 5 Pencil or marker

SHOP SUPPLIES:

- 1 Spray Lubricant

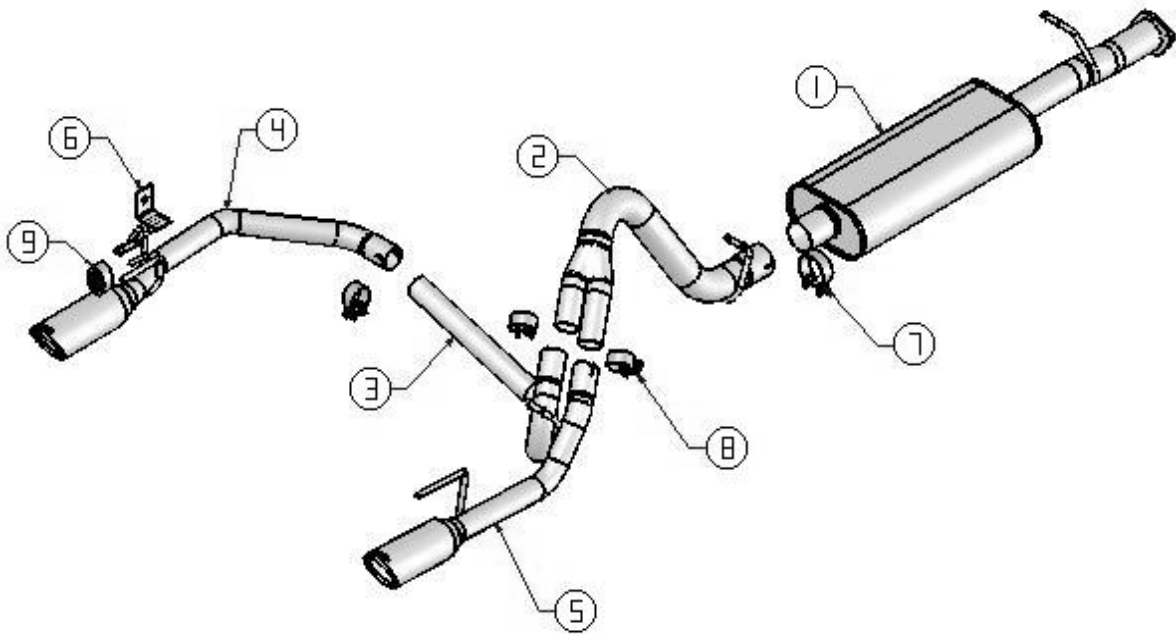
Borla Performance Cat-Back™ Bill of Materials

1. Muffler assembly
2. Over axle pipe
3. Intermediate pipe assembly
4. Left tail pipe assembly
5. Right tail pipe assembly
6. Bracket/Hanger assembly
7. 3.00" clamp
8. 2.25" clamp (qty 3)
9. Rubber isolator

Caution!!! *Never work on a hot exhaust system. Serious injury in the form of burns can result* If the vehicle has been in use and the exhaust system is hot, allow vehicle to cool for at least 1 hour. Always wear eye protection when working under any vehicle.

Note: It is our recommendation that you use a hoist or hydraulic lift to facilitate the installation of your new Borla Performance Cat-Back™ Exhaust System.

Taking all under car safety precautions, lift the vehicle using a hoist or hydraulic lift. Once this has been done, you may begin the removal of your old exhaust system from your vehicle.

Note: Before removing the original exhaust system from your vehicle, please compare the parts you have received with the bill of materials provided on the previous page to assure that you have all the parts necessary for the installation of your new Borla Performance Cat-Back™ Exhaust System.

Original Exhaust System Removal

Note: With a used vehicle, we suggest a penetrating spray lubricant to be applied liberally to all exhaust fasteners and allowing a significant period of time for the chemical to lubricate the threads before attempting to disassemble.

1. For an easier time during the removal of your original exhaust and the installation of your new exhaust, remove the spare tire as recommended by your vehicles manual.
2. Using a reciprocating saw or a hack saw, cut the exhaust just behind the muffler assembly as shown in figure 1.
3. Lubricate all the hangers and rubber isolators.
4. Using a muffler stand or an additional person to hold the rear muffler in position, remove the hanger from the rubber isolator and remove the rear muffler from the vehicle as shown in figure 2.
5. Unbolt one side of the center support bar and swing it out of the way as shown in figure 3.
6. Unbolt the flange shown in figure 4 located just ahead of the front muffler assembly.
7. Using a muffler stand or an additional person to hold the front muffler assembly in position, remove the hangers from the rubber isolators and remove the front muffler assembly from the vehicle as shown in figure 5.



Figure 1



Figure 2



Figure 3

Warning: Use extreme caution during installation. Torque all fasteners according to manufacturer's torque values and tightening sequence. **DO NOT** use air impact tools to tighten fasteners on Borla Performance Exhaust Systems. Use of such tools may result in bent flanges or gasket contact areas leading to exhaust leaks.

Borla Performance Cat-Back™ Exhaust System Installation

1. Install the front muffler assembly as shown in figure 6 making sure to install the hanger into the rubber isolator. Using the original hardware, hand tighten the flange. Reinstall the center support bar as also shown in figure 6.
2. Place a clamp over the expanded end of the over axle pipe and set it into position as shown in figure 7. Do Not tighten the clamp.
3. Attach the cut out template supplied with your system onto the vehicle as shown in figure 8. Using a pencil or marker, trace the cut out onto the rear of the vehicle.
4. Using a rotary cutting wheel, cut the rear of the vehicle 1/4" before the marks as shown in figure 9.

Figure 4



Figure 5



Figure 6



Figure 7



Figure 8

Borla Performance Cat-Back™ Exhaust System Installation (continued)

5. Using a rotary sander, clean up and shape the cut to the mark as shown in figure 10.
6. Using the hardware provided, install the bracket/hanger assembly on the driver side frame rail, at the rear of the vehicle as shown in figure 11. Install the rubber isolator onto the hanger/bracket assembly.
7. Place a clamp over the expanded end of the intermediate pipe and set it up into position as shown in figure 12. Do Not tighten the clamps.
8. Place a clamp over the expanded end of the left and right tail pipe assemblies and set them into position as shown in figure 13 making sure to install the hangers into the rubber isolators. Do Not tighten the clamps.
9. Check your exhaust system for proper clearance under the vehicle and also for tip alignment.
10. Once position has been determined to be correct, tighten the Accuseal™ clamps to 32-35 ft. lbs. and tighten the flange hardware to 18-22 ft. lbs.
11. Before starting your vehicle, make sure to check all wires, hoses, brake lines, body parts and tires for safe clearance from the exhaust system.
12. Start vehicle and check for any leaks. If any leaks are found, determine cause (such as loose hardware or incorrectly positioned clamp) and repair as necessary.

Note: When you first start your vehicle after the installation of your new Borla Performance Exhaust System, there may be some smoke and fumes coming from the system. This is a protective oil based coating used in the manufacturing of mandrel bent performance exhaust tubing. This is not a problem and will disappear within a very short period of time after the exhaust has reached normal operating temperatures.



Figure 9



Figure 10



Figure 11



Figure 12



Figure 13