

### 1. Parts list



**A** Monitor×1



**B** Wireless transmission camera×1



**C** Cup mount×1



**D** Monitor power extending line×2



**E** Cigarette lighter power line×1



**F** Screw×2



**G** User's manual×1

### 2. Testing

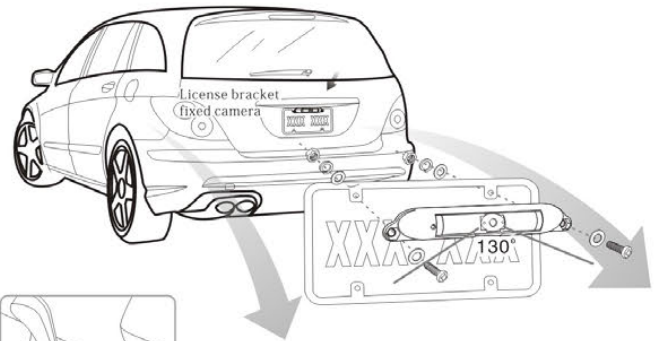
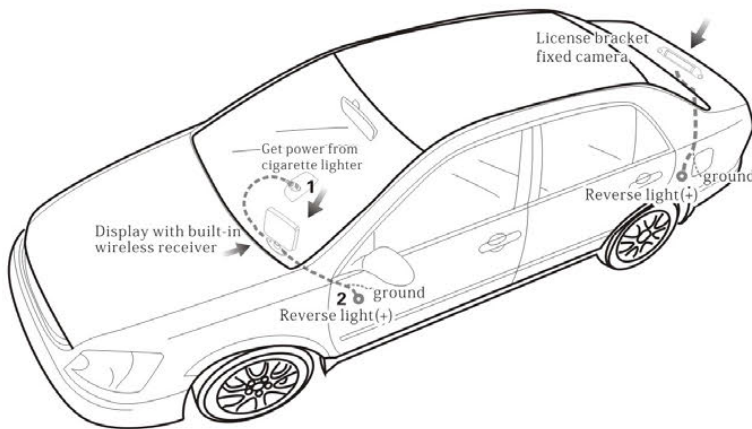

Testing:

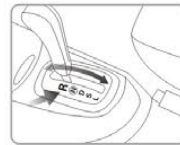

When the reverse gear is engaged, the system works automatically. The wireless camera at the back of car will send signals to the wireless monitor in front of car. Images at the back of car will be shown clearly. When there's no transmission signal, monitor will turn to sleep mode.

### 3. Preparations

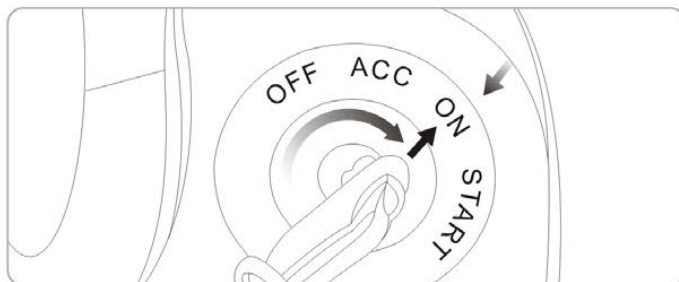

① Turn the key to the on, the power of the car is on.

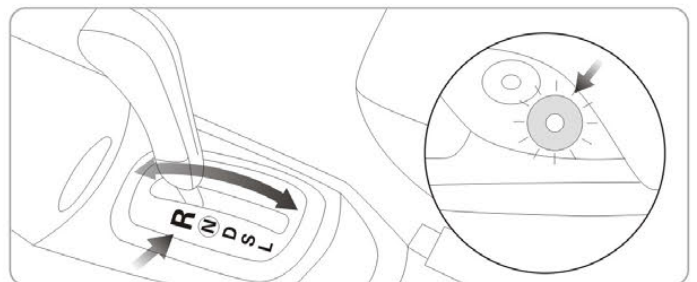

② Turn to the reverse gear, the reverse light is on

### 4. Camera installation

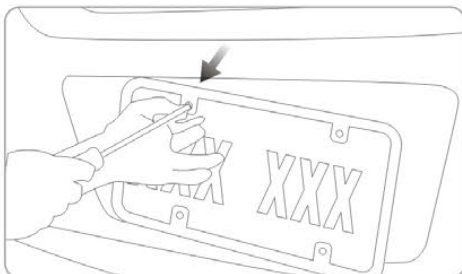

① Take down the license plate.

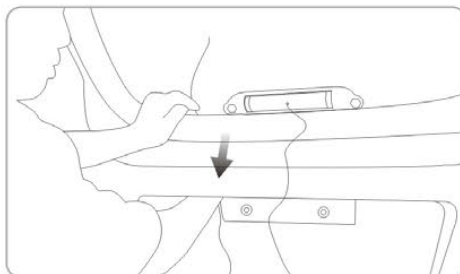

② Tow the camera power line into the car though the interstices of the car.

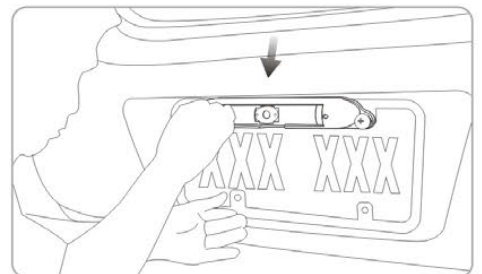

③ Install the camera onto the license plate, fix it with the spared screws.

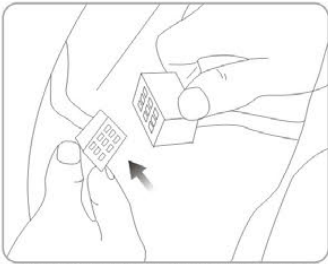

⑤ Find the power lines from the trunk at the back of car. Cut off the power of car.

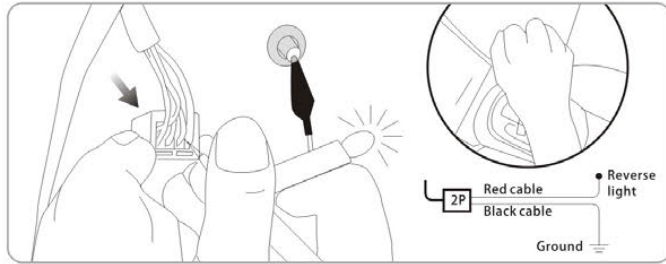

⑥ Black clamp connects to any iron part of car. Use the red pen to test every power line from the reverse light until the LED light is on. Then you can ensure that this is the power line.

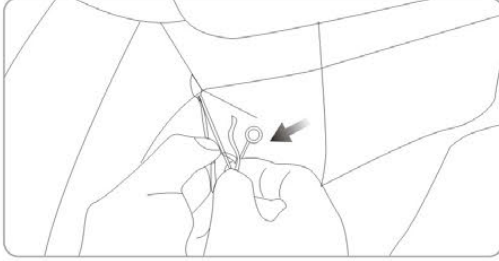

⑦ Connect the camera power line to the reverse light power line, anode to anode, cathode to cathode, then fix the cables with the rubberized fabric.

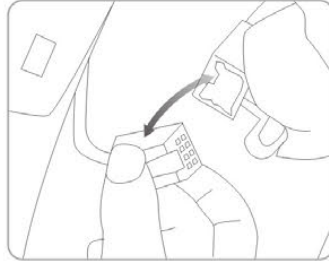

⑧ Connect the power lines as before.

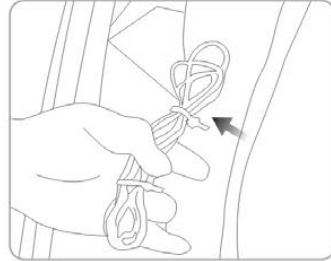

⑨ Enlace and hind other lines properly.

## 5. Two methods of monitor installation

### 1. Installation with cigarette lighter

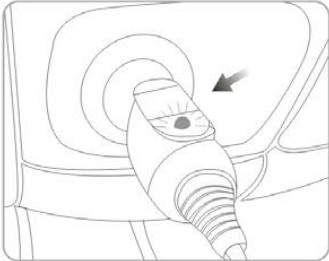

① Insert the cigarette lighter power line into the cigarette lighter in the car. When the light of the cigarette lighter is on, the power is on.

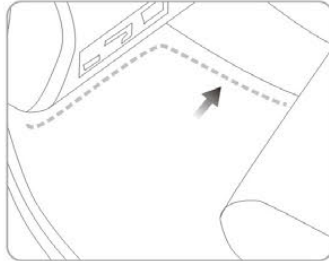

② Tow the cigarette lighter power line to the dashboard through the interstices of the car.

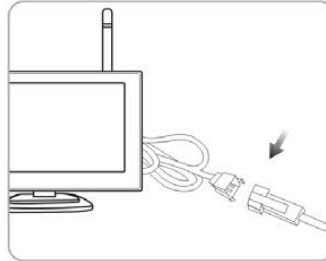

③ Connect the cigarette lighter power line to the 3" monitor

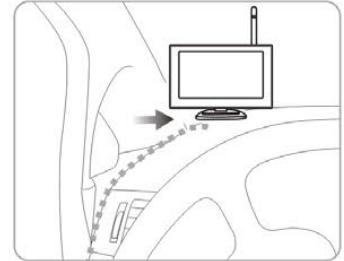

④ 1/2 Fix the monitor with Dash-mount pedestal onto the dashboard where is suitable.

### 2. Installation of power from the front reverse light

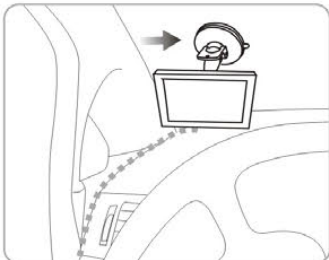

2/2 Or Fix the monitor with Suction cup mount on the glass where is suitable.

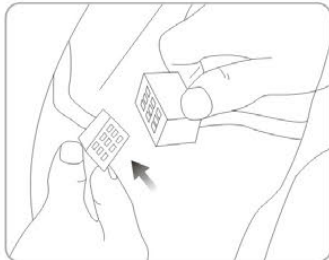

① Find the power lines from the driving room, cut off the power of car.

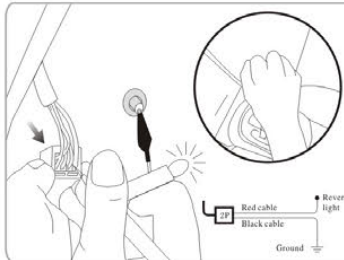

② Black clamp connects to any iron part of car. Use the red pen to test every power line from the reverse light until the LED light is on. Then you can ensure that this is the power line.

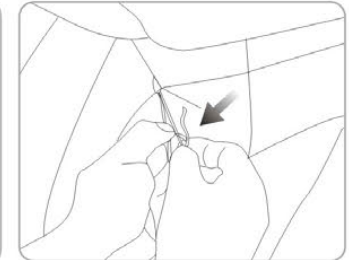

③ Connect the monitor power extending line (C) to the reverse light power line, anode to anode, cathode to cathode, then fix the cables with the rubberized fabric.

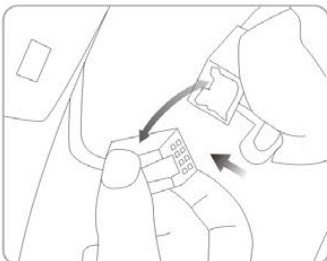

④ Connect the power lines as before.

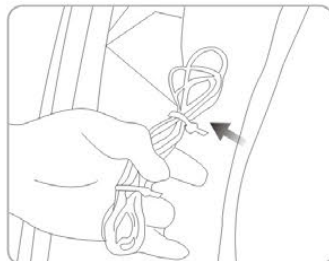

⑤ Enlace and hind other lines properly.

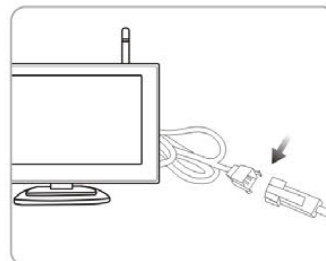

⑥ Connect the monitor power extending line to the 3" monitor

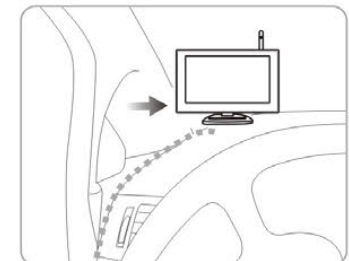

⑦ Fix the monitor with the magic plaster(H) onto the dashboard where is suitable.

### FCC Statement

1. This device complies with Part 15 of the FCC Rules.

Operation is subject to the following two conditions:

(1) This device may not cause harmful interference, and

(2) This device must accept any interference received, including interference that may cause undesired operation.

2. Changes or modifications not expressly approved by the party responsible for compliance could void the user's authority to operate the equipment.

## Operation Manual:

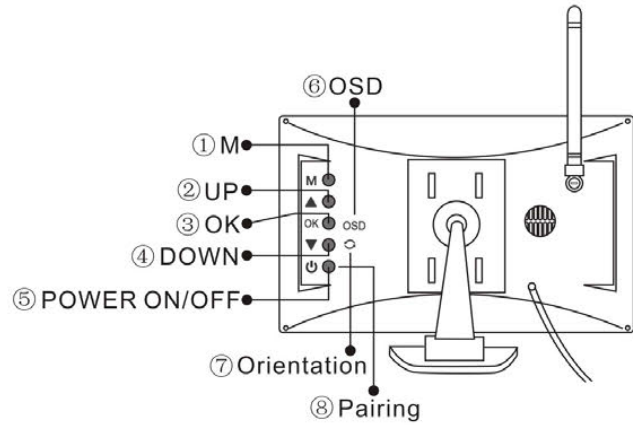

### Function and Operation:

1. **M**: Menu: select the Brightness/Color/default, press the "M" button 2-3S exit to Menu.
2. **▲**: In the menu, Up and down to select the Brightness/Color/default
3. **OK**: Enter and confirm
4. **▼**: In the menu, Up and down to select the Brightness/Color/default
5. **⏻**: Power/Pairing: select on/off.
6. **OSD**: Parking line: Not in the menu state, parking line or without parking line.
7. **↻**: Not in the menu state: switching image to flip up/down/reverse and non-reverse view.
8. **Pairing**: All the products paired in advance. If you have to replace the camera to another BOYO WiFi Bartype Camera, press the pairing button and the monitor will pair with the new camera automatically.

## ● Pairing between the camera and monitor ●

**Automatic pairing function:** All the products are paired before selling, The following procedure only be used if you have to replace the camera to another BOYO WiFi Bartype Camera for service.

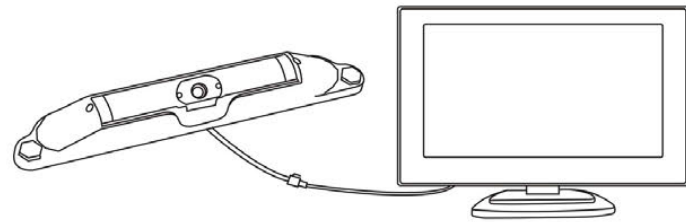

Camera power line with the monitor connection

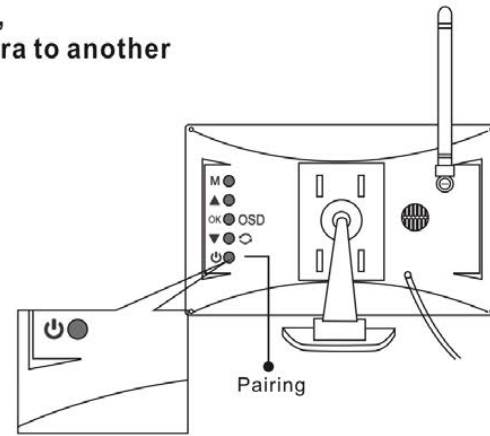

Press the button "Pairing" to pair, as shown on above picture



Pairing



Pairing completion

## Specifications:

**Model:**  
 Transmission method: Wifi digital signal  
 Video compress: H.264  
 Transmission distance: 67ft  
 Working temperature: -68°F ~ +140°F  
 Store temperature: -86°F ~ +176°F  
 Working humidity: 85%RH

**Camera:**  
 Image Sensor: CMOS  
 Resolution: 720\*480  
 Viewing angle: 120°~150°  
 Illumination: 0.02Lux  
 Transmission power: 80mW  
 Voltage: 12V  
 Waterproof level: IP67

**Monitor:**  
 Display: 4.3" TFT Monitor  
 Resolution: 480\*272  
 Contrast: adjustable  
 Brightness: adjustable  
 Voltage: 12V  
 Working temperature: -68°F ~ +140°F

Then fix the receiving location with the fixed screw nut

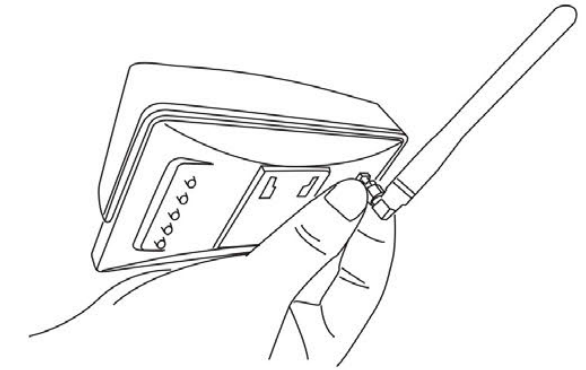
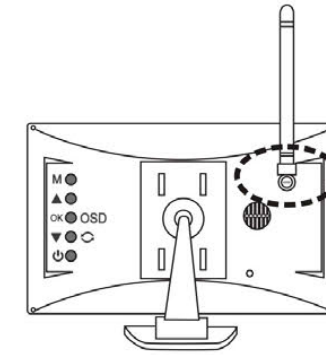

Please adjust the antenna on the monitor when you need to strengthen the wifi RX signal of the monitor.

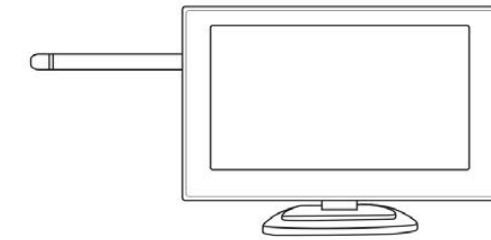
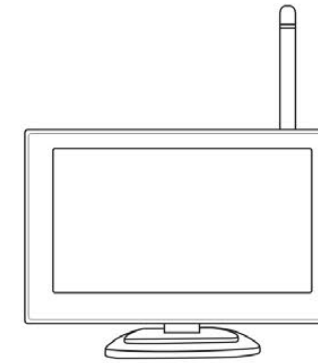

## Tips for antenna placing:

1. When the TX antenna of the camera is vertical direction, the RX device of monitor should be pointing vertical accordingly to get the best signal.
2. When the TX antenna of the camera is pointing horizontally, the RX device of monitor should also be horizontally to get the best signal.

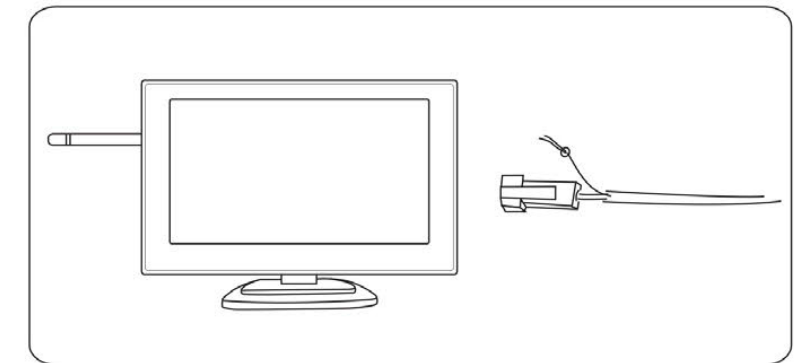
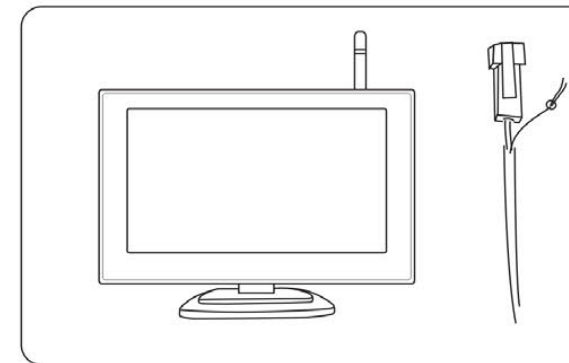

**Notice:** VTC404R/VTC424R are Recommended ideal wireless solution for SUV, Sedans, Family Vans etc, but NOT for Trucks and Trailers.