

1. Place the Model 2400 Tool Station in position on floor. Bolt it to the floor using four 1/2" anchor bolts (not provided).
2. Attach the Impact Holder Brackets (Item 2) with 1/4-20 x 5/8 Hex Head Cap Screws and 1/4-20 Hex Lock Nuts as shown.
3. Install the air supply to the 1/4" NPT Tee Fitting (Item 5) using thread sealant.

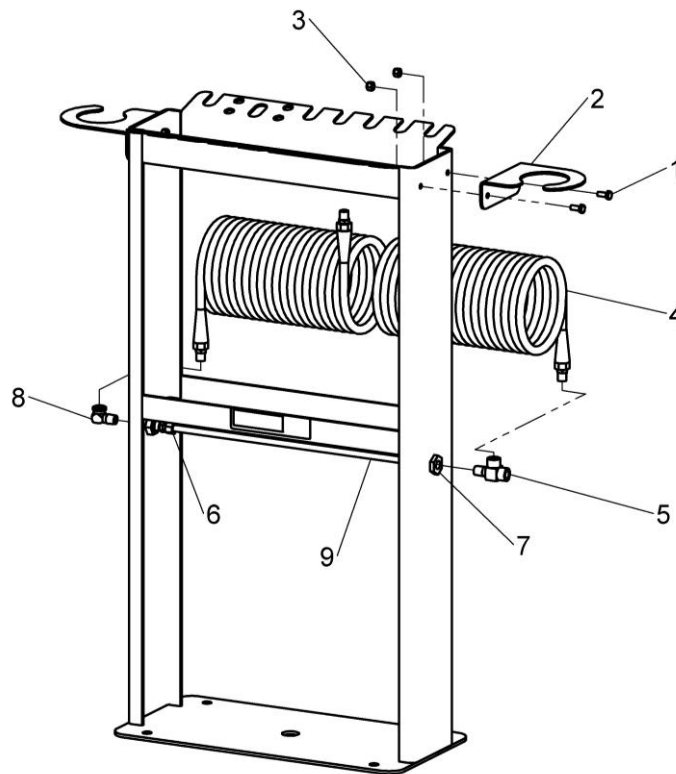

| ITEM | PART NO | QTY | DESCRIPTION |
|------|---------|-------|-------------------------------------|
| 1 | 028-210 | 4 | 1/4-20 X 5/8 Hex Head Cap Screw |
| 2 | 72-0451 | 2 | Impact Holder Bracket |
| 3 | 055-160 | 4 | 1/4-20 Nylon Hex Lock Nut |
| 4 | 62-0010 | 2 | 3/8" ID X 25' Recoil Air Hose |
| 5 | 096-155 | 1 | 1/4 NPT Tee Fitting |
| 6 | 60-0191 | 2 | 3/8" Tube to 1/4 NPT Fitting |
| 7 | 60-0192 | 2 | 1/4 NPT Bulkhead Fitting |
| 8 | 60-0194 | 1 | 1/4 NPT male x female Elbow Fitting |
| 9 | D20-006 | 16.5" | 3/8" OD Nylon Tubing |