

# INSTALLATION MANUAL

# 14022

## Level of Difficulty

Easy

Installation difficulty levels are based on time and effort involved and may vary depending on the installer level of expertise, condition of the vehicle and proper tools and equipment.

## Weight Carrying Capacity

Gross trailer weight (GTW)	12,000 lbs.
Tongue weight (TW)	1,200 lbs.

## Weight Distribution Capacity

Weight distribution (WD)	12,000 lbs.
WD tongue weight (WDTW)	1,200 lbs.

## Parts List

Item	Qty	Description
1	1	Trailer hitch

## Tools Required

Ratchet	Socket, 22mm
Torque wrench	Wrench, 22mm

## ⚠ WARNING

Never exceed the vehicle manufacturer's recommended towing capacity.

## Product Photo



## NOTICE

Before you begin installation, read all instructions thoroughly.

Proper tools will improve the quality of installation and reduce the time required.

Periodic inspection of the trailer hitch should be performed to ensure all mounting hardware remains tight and structural components are secure.

To help prevent damage to the product or vehicle, refer to the specified torque specifications when securing hardware during the installation process.

## SAFETY INSTRUCTIONS

Safety glasses should be worn at all times while installing this product.

# ASSEMBLY

## Parts List

Item	Qty	Description
1	1	Trailer hitch

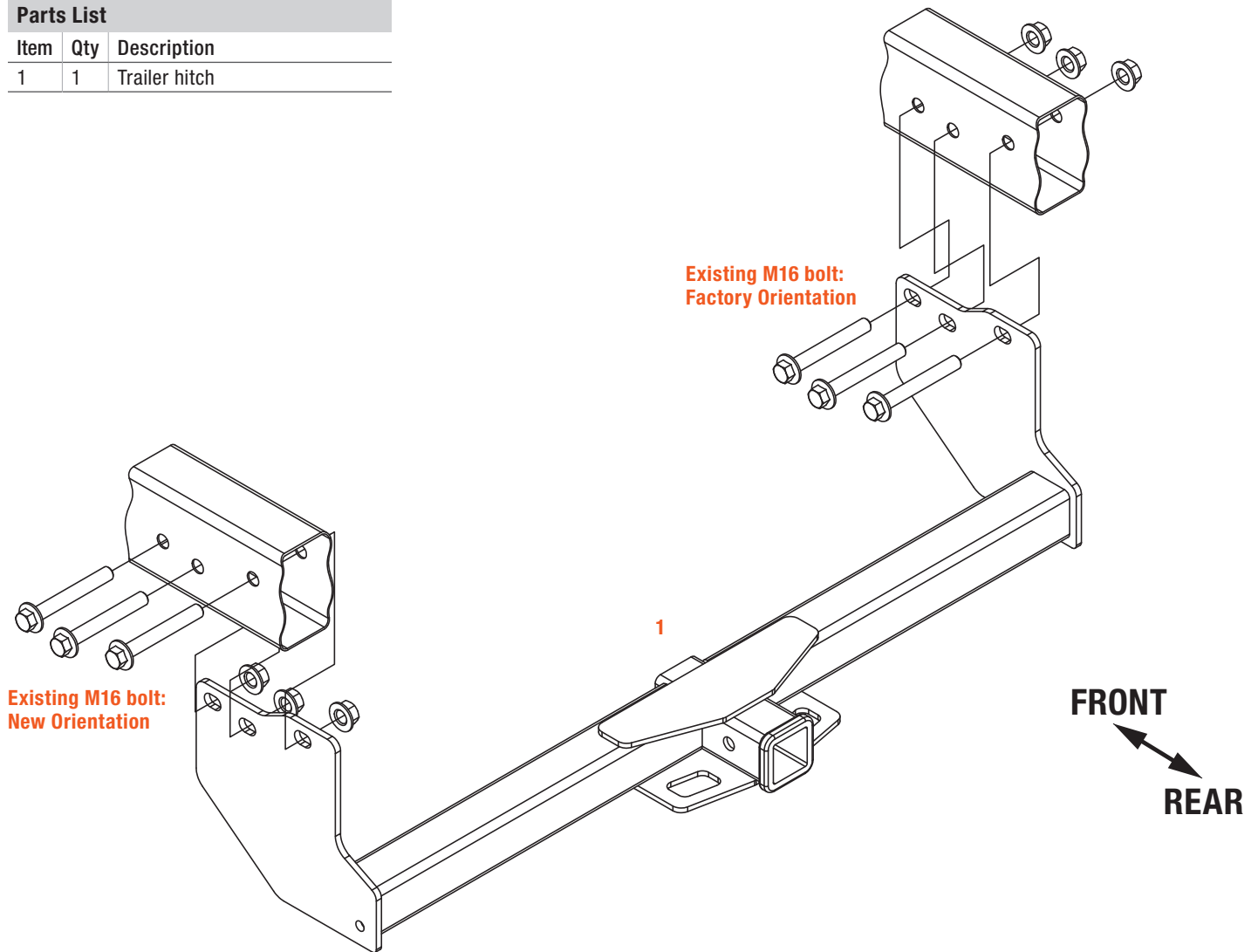

### Step 1

Remove the three bolts from the sides of each frame rail near the rear of the vehicle. Partially reinstall them from the outside of the vehicle towards the center.

### Step 2

Raise the hitch into position between the frame rails and slide the bolts through the hitch to secure it in place.

### Step 3

Torque the M16 hardware to 146 ft-lbs.