

# 12095 SATURN VUE, ALL INC. REDLINE, CHEVY CAPTIVA

GROSS LOAD CAPACITY WHEN USED AS A WEIGHT CARRYING HITCH: 3,500 LBS. TRAILER WEIGHT & 300 LBS. TONGUE WEIGHT.

\*\*\*DO NOT EXCEED VEHICLE MANUFACTURER'S RECOMMENDED TOWING CAPACITY.\*\*\*

Parts List			
ITEM	QTY	PART NUMBER	DESCRIPTION
1	6	M12-1.75 x 35mm	HEX BOLT
2	6	1/2"	CONICAL TOOTHED WASHER

## RUBBER ISOLATOR REMOVAL DIAGRAM

This technique can be used if an Exhaust Hanger Removal Pliers is not available.

Using a 5/8" open end wrench, slide the wrench up to the rubber isolator, cradling the hanger rod as shown. Next place the flat edge of a pry bar between the wrench and the hanger stop or hanger rod. Then simply rotate the pry bar toward the wrench to remove the rubber isolator.

Note: Using a spray lubricant or soapy water on the hanger rod and the rubber isolator helps removal.



PASSENGER SIDE FRAME RAIL

DRIVER SIDE FRAME RAIL

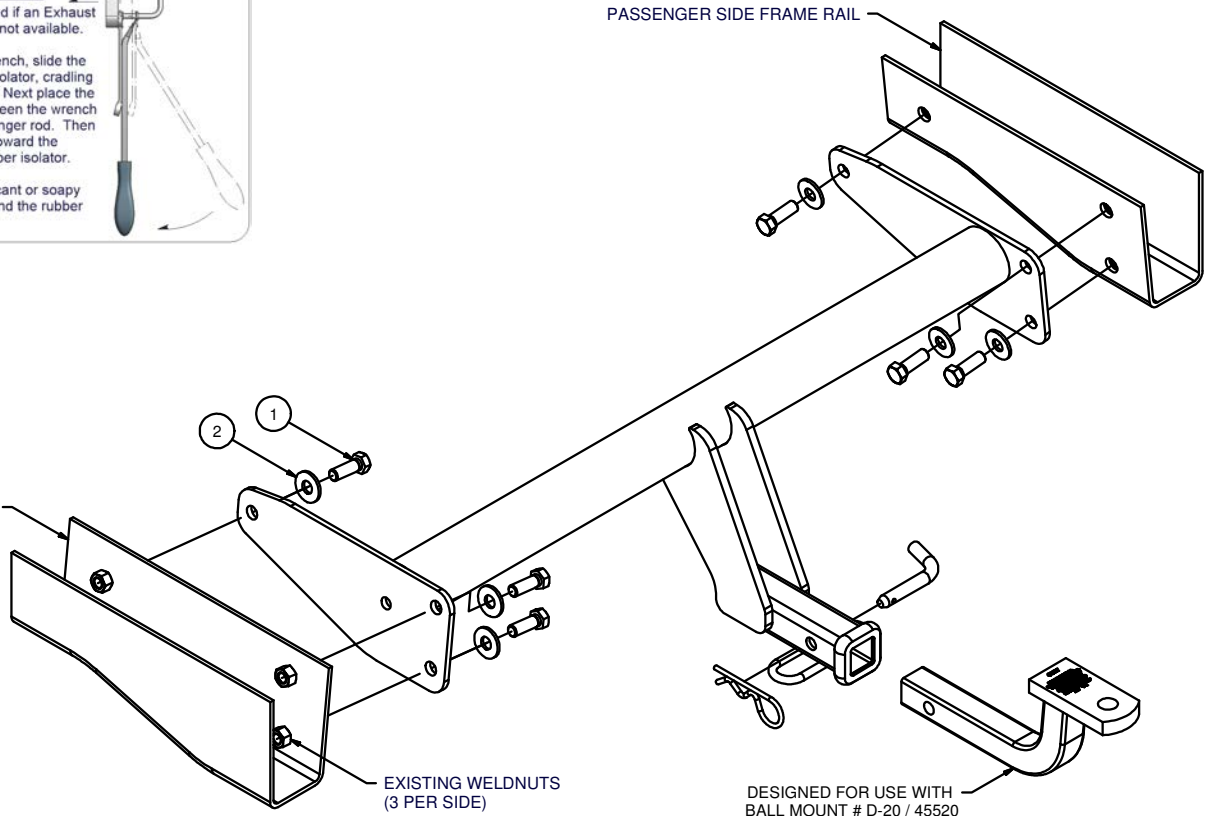

EXISTING WELDNUTS  
(3 PER SIDE)

DESIGNED FOR USE WITH  
BALL MOUNT # D-20 / 45520

HITCH WEIGHT: 28 LBS.  
INSTALL TIME: 20 MINUTES  
INSTALL NOTES:  
- LOWER EXHAUST  
- NO DRILLING REQUIRED

## INSTALLATION STEPS

- 1) Lower the exhaust by removing the (4) rear exhaust hangers. (See Rubber Isolator Removal Diagram.)
- 2) Raise the hitch into position between the frame rails, aligning the holes in the hitch with the weldnuts within the frame rails.
- 3) Install supplied 12mm hex bolts and conical toothed washers as shown.
- 4) Torque all 12mm fasteners to 79 lb-ft.

**PERIODICALLY CHECK THIS RECEIVER HITCH TO ENSURE THAT ALL FASTENERS ARE TIGHT AND THAT ALL STRUCTURAL COMPONENTS ARE SOUND.**



The **FIRST** Name  
in Towing Products™

[Trailer Hitches](#)