



JEEP Wrangler



BOLT TORQUE SPECIFICATIONS

STANDARD BOLTS:			METRIC BOLTS:	
Size	Grade	Torque	Size	Torque
5/16"	5	20 ft/lbs.	8mm	22 ft/lbs.
3/8"	5	35 ft/lbs.	10mm	42 ft/lbs.
7/16"	5	56 ft/lbs.	12mm	70 ft/lbs.
1/2"	5	85 ft/lbs.	14mm	95 ft/lbs.

BASEPLATE

Pin Height: 16-1/2" Centers: 22-1/4"

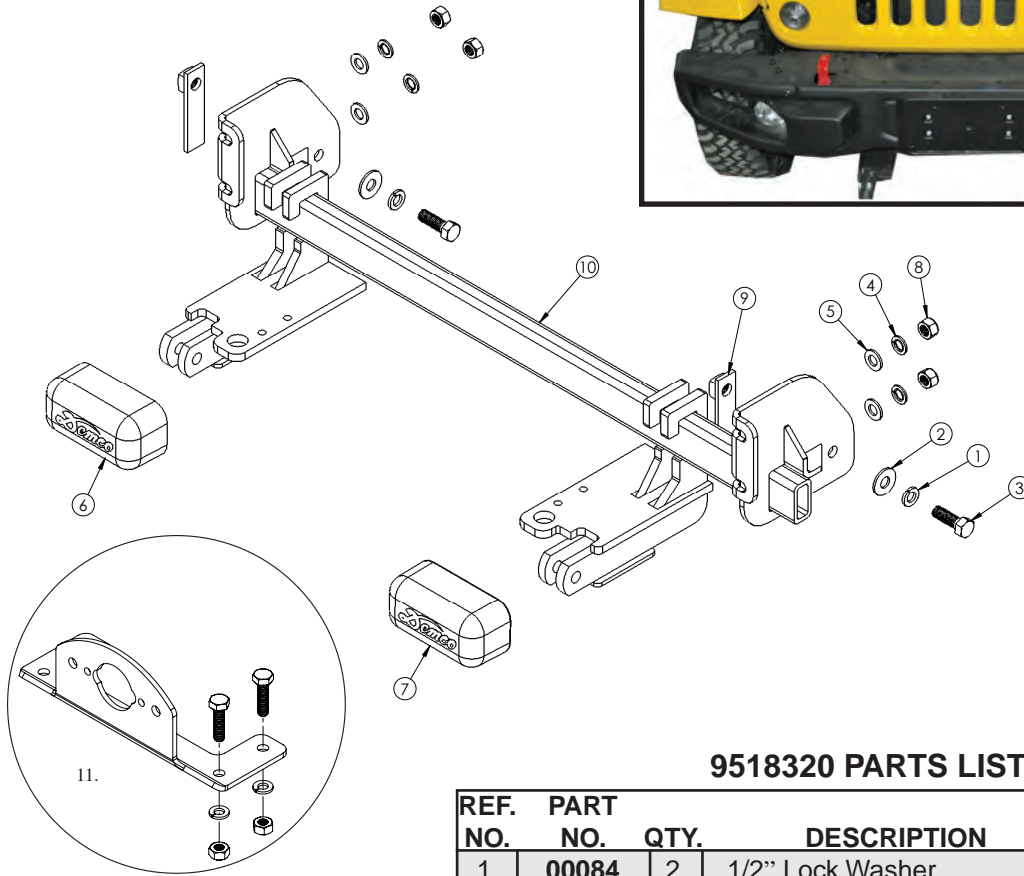

Please order replacement parts by PART NO. and DESCRIPTION.

9518320 PARTS LIST

REF. NO.	PART NO.	QTY.	DESCRIPTION
1.	00084	2	1/2" Lock Washer
2.	00085	2	1/2" Flat Washer
3.	01254	2	1/2"-NC x 1-1/2" Hex Bolt Gr.5
4.	07288	4	12mm Lock Washer
5.	07432	4	12mm Flat Washer
6.	12979	1	Pull Ear Cover "A"
7.	12980	1	Pull Ear Cover "B"
8.	13762	4	12mm-1.50 Hex Nut
9.	13908-35	2	Nut Strip f/ Jeep Wrangler
10.	15274-35	1	Baseplate Crossmember
11.	5937	1	Plug Mount Kit
12.	12329	1	Loctite (not shown)

ASSEMBLY
OPERATION
REPLACEMENT PARTS

READ complete manual CAREFULLY BEFORE attempting operation.

Doing Our Best to Provide You the Best

WARRANTY POLICY & REGISTRATION

WARNING: FAILURE TO FOLLOW THESE INSTRUCTIONS CAN RESULT IN LOSS OF TOWING VEHICLE CONTROL, SEPARATION OF THE TOW BAR FROM THE TOWING VEHICLE, SEPARATION OF THE TOWED VEHICLE FROM THE TOW BAR, CAUSING SEVERE PERSONAL INJURY, DEATH, OR PROPERTY DAMAGE.

CAUTION

Safety is of utmost importance at all times. There are several items that must be checked each time before using and while using a tow bar.

Before allowing anyone to hook up or operate a tow bar, be sure they have read and understand the proper operating procedure.

DO NOT use worn or damaged cables and/or pins.

Be sure the **SAFETY CABLES** are hooked, chassis to chassis, to both the towing and towed vehicles using the crisscross method.

Check clearance between vehicles in a turning situation.

Check base plate mounting bolts for tightness and frame for metal fatigue.

Do not load the towed vehicle with anything as you may exceed the towing capacity of the tow bar.

Keep fingers away from pivot points to prevent personal injury.

Be sure the steering components of the towed vehicle are properly aligned.

NOTE: This unit can be backed up in moderate increments. Any severe backwards cornering could result in damage to the Tow Bar and/or towed vehicle chassis.

For automatic transmissions: Consult your vehicle owners manual for towing suitability with the drive shaft connected. Otherwise, the towed vehicle will have to be equipped with a transmission pump or drive shaft disconnect.

Check to make sure that all lights are in proper working order.

The information on towability of vehicles is reprinted with permission of MotorHome® Magazine, and is believed to be reliable. However, Demco does not warrant the information to be correct. Always consult your towed vehicle owner's manual and follow towing instructions. Each year, MotorHome® Magazine, compiles a list of vehicles that can be towed four-down behind a motorhome with no modifications required.

 **Caution: MotorHome® Magazine** left out any vehicles that have towing speed limits slower than 55 m.p.h., or distance limits of less than 200 miles. At a minimum, these vehicles require significant modification, such as the use of an aftermarket product, to make them towable. The availability of a **Demco Tow Bar Base Plate** does **not** imply that these vehicles can be modified or that there is an aftermarket product available. Refer to your vehicle owner's manual or consult your dealer to determine whether your vehicle can be modified to make it towable. Failure to observe this precaution could result in property damage or personal injury.

IMPORTANT INSTALLATION ITEMS

DEMCO products and accessories are intended to be installed by professional installers with experience, proper equipment and the ability to do modification work. Installers with these qualifications can be found in RV and Automotive Service Centers.

If the car to be towed has been in an accident, the chassis may be damaged in an area where the Base Plate attaches. It may no longer be suitable for towing. Extreme caution and careful examination are required in such a situation. It is also likely, even from a minor accident, that the hole alignment will be more difficult due to hole alignment problems.

Many DEMCO Base Plates are designed to use existing holes and hardware to mount the Base Plate to the towed vehicle. Even though the bolt is there, however, do not assume it is adequate for mounting the Base Plate. Manufacturers make many changes in hardware both within and between model years. Be sure the bolt is long enough to protrude past the nut a distance no less than 1/2 the diameter of the bolt, after the Base Plate is mounted. The threads should be in good condition. **We require that "LOCTITE® Blue" be used on all bolts.** If a new bolt is required, be sure it is SAE Grade 5 or Metric 8.8.

NOTE: The dimensional variations between otherwise identical vehicles can be considerable. Some minor modifications may have to be made to ensure a proper fit.

INSTALLATION INSTRUCTIONS



1. Remove metal belly pan by removing seven screws.

2. Remove bumper by removing eight hex nuts and four backer plates from the back side of bumper. Two backer plates will be used later. **Note:** Before bumper can be set aside, unplug fog lights if equipped and remove wiring clips from bumper.

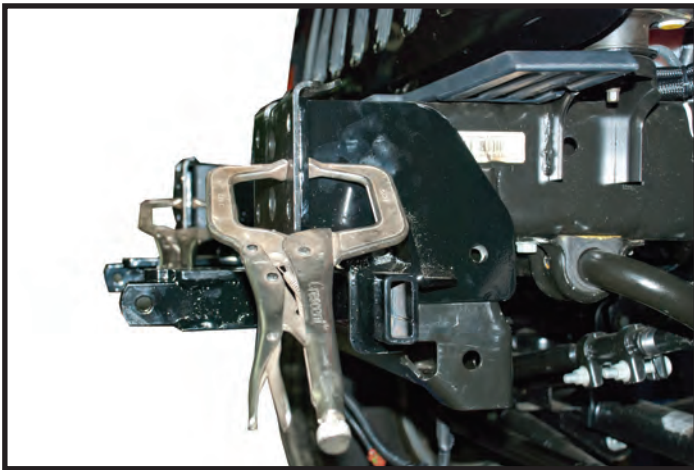

3. Drill top right hole on drivers side bumper mount to 9/16" as shown below. Put baseplate up from driver's side pushing tight towards passenger side. Align front slotted holes in baseplate with round holes of vehicle's bumper flange. Clamp each side so baseplate doesn't move. **NOTE:** Baseplate mounts on the inside of the passenger's frame and the outside of the driver's frame.



4. Using baseplate as template, drill 1/2" hole thru side of baseplate on each side. Install 1/2" x 1-1/2" bolt, 1/2" flat washer, 1/2" lock washer, and nut strip. Nut strip goes on frame side and bolt and washers thru baseplate side. Tighten bolts according to torque chart on front page. **Note:** Use **LOCTITE** on all bolts and nuts.



5. Reinstall bumper and use previously removed bumper hex nuts or use provided 12mm washer, 12mm lock washer and 12mm hex nut. The provided hardware has a smaller diameter than the OEM nut. **NOTE:** One bumper backer plate will be used on driver's side inside of frame and passenger's side outside of frame.



6. Cut out marked locations in above picture and trim as needed. Re-attach front of belly pan with the seven factory screws.

7. Plug mount (item #11) may be installed if desired in convenience holes on either chain anchor or as desired. **NOTE:** Excess material may be trimmed from bracket.