

WARNING

To prevent **SERIOUS INJURY, DEATH or PROPERTY DAMAGE:**

- **ALWAYS** read, understand and follow warnings and instructions for your hitch **BEFORE** installation. Keep for future reference.
- **DO NOT** cut, weld or modify this receiver.
- **CHECK** all fasteners are tight and your hitch is securely mounted to your vehicle periodically.
- **ALWAYS** read, understand and follow all warnings and instructions for your vehicle and for other accessories you will use with your hitch **BEFORE** use.
- **LOAD** the trailer heavier in front.
- **DO NOT** exceed lower of towing vehicle manufacturer's rating or:

Hitch Type	Max Gross Trailer Weight	Max Tongue Weight
Weight Carrying	6000 (2724 Kg)	900 (409 Kg)
Weight Distributing	8000 (3632 Kg)	900 (409 Kg)

- **ALWAYS** wear your seatbelt.
- **SLOW DOWN** when towing, **NEVER** exceed any posted speed limit.
- If **EXCESS SWAY** occurs, take your foot off the gas pedal and hold the steering wheel as steady as possible. **DO NOT** apply your brakes and **DO NOT** speed up.

Installation Instructions

PART NUMBERS: 76439, 84439, CQT76439

Applications:

Years	Make	Models
2014-Current*	Toyota	Highlander
2014-Current*	Lexus	RX350L

*Visit our website for the most up to date information regarding application years and trim levels.

Installation Time: 40 min

The time listed above is the average time for professional installers. If you do not feel comfortable performing this installation on your own or are in need of assistance, please contact a professional installer.



Representative Vehicle Photo

Equipment Required:

**DO NOT EXCEED LOWER OF TOWING VEHICLE
MANUFACTURER'S RATING OR:**

Hitch Type	Max Gross Trailer Weight	Max Tongue Weight
Weight Carrying	6000 (2724 Kg)	900 (409 Kg)
Weight Distributing	8000 (3632 Kg)	900 (409 Kg)

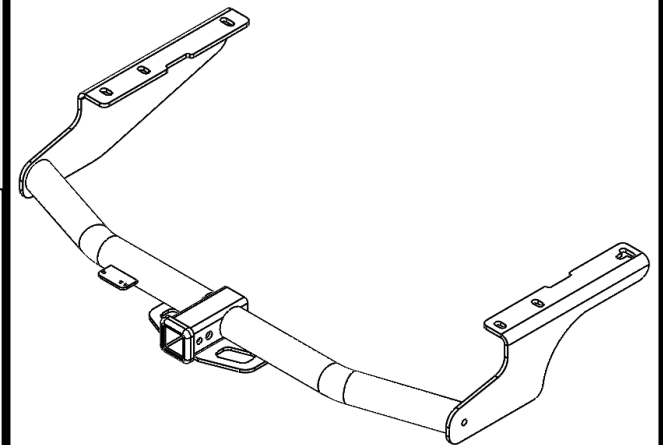

Hitch Illustration



Always wear SAFETY GLASSES when installing hitch

Installation Instructions

PART NUMBERS: 76439, 84439, CQT76439

Fastener Kit: 76439F

①	Qty. (6)	Hex Bolt M12 X 1.25 X 30mm	
②	Qty. (6)	Conical washer 1/2" Part No. 01292008	
③	Qty. (2)	Conical washer 3/8" Part No. 01292006	
④	Qty. (2)	Nut, M8 X 1.25	
⑤	Qty. (2)	Flange bolt M8x1.25x30	
⑥	Qty. (1)	Bracket Part No. 124773	



Vehicles heating/cooling hoses located in this area.

Use caution not to pinch.

Reuse Existing M8 Bolts

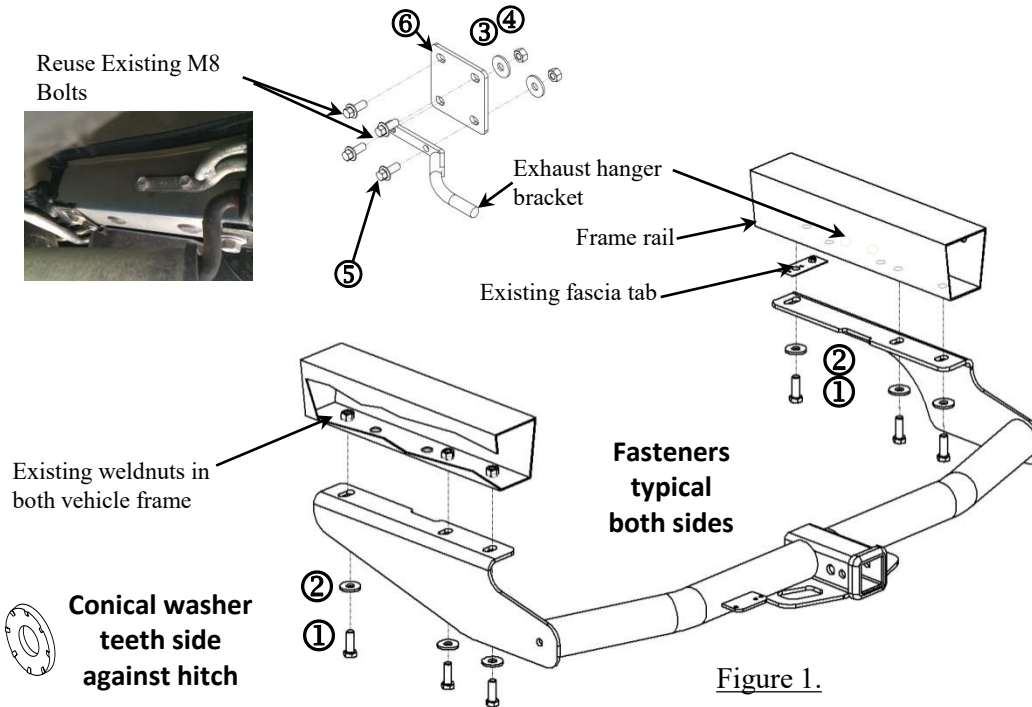
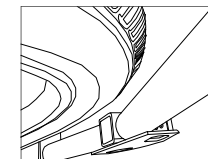

Figure 1.



Note: When stowing the spare or flat tire, it may be necessary to lift up on the rear edge of the tire to clear hitch.

1. Remove bracket from hitch, fasteners to be used in the hitch installation.
2. If present, remove plastic appearance panels which cover driver's and/or passenger's side frame rails. Remove the plastic rivets that fasten the fascia tabs to the appearance panel. Note: Remove the center of the rivet with a small screwdriver. Passenger's side panel can be reinstalled. Return drivers' side panel and fasteners to owner.
3. Remove tow hooks from each frame rail and return hooks and fasteners to vehicle owner.
4. Remove plastic and rubber plugs from bottom of frame rail. Return to owner.
5. Remove existing M8 bolts from exhaust hanger bracket. Install exhaust bracket (item 6) on frame rail using existing M8 bolts. Use M8-1.25 bolts to install exhaust hanger bracket to exhaust bracket.
6. Be careful not to pinch hoses on the outside of the passenger side frame rail or scratch fascia. Remove excess caulking from rails if needed.
7. Align hitch into position over existing weldnuts as shown and install fasteners to bottom of frame rails. Note: Existing fascia tab should be reinstalled between frame rail and bracket.
8. Tighten all M12 x 1.25 CL8.8 fasteners with torque wrench to 76 Lb.-Ft. (103 N*M) Tighten all M8 x 1.25 CL8.8 fasteners to 20 Lb.-Ft. (27 N*M)
9. Reinstall passenger side appearance panel.



Proper torque is needed to keep the hitch secure to the vehicle when towing.

Remove bracket from hitch, fasteners to be used in the hitch installation.

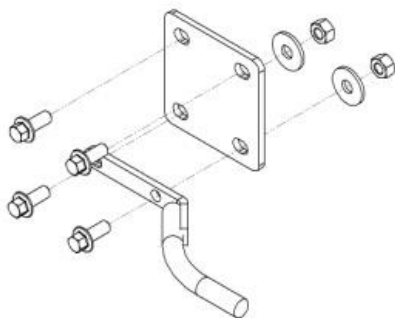

If present, remove plastic appearance panels which cover driver's and/or passenger's side frame rails. Remove the plastic rivets that fasten the fascia tabs to the appearance panel. Note: Remove the center of the rivet with a small screwdriver. Passenger's side panel can be reinstated. Return drivers' side panel and fasteners to owner.



If present, remove tow hooks from each frame rail and return hooks and fasteners to vehicle owner.



Remove plastic and rubber plugs from bottom of frame rail. Return to owner.



Remove existing M8 bolts from exhaust hanger bracket. Install exhaust bracket (item 6) on frame rail using existing M8 bolts. Use M8-1.25 bolts to install exhaust hanger bracket to exhaust bracket.



Be careful not to pinch hoses on the outside of the passenger side frame rail or scratch fascia. Remove excess caulking from rails if needed.



Align hitch into position over existing weldnuts as shown and install fasteners to bottom of frame rails. Note: Existing fascia tab should be reinstalled between frame rail and bracket.



Tighten all M12 x 1.25 CL8.8 fasteners with torque wrench to 76 Lb.-Ft. (103 N*M) Tighten all M8 x 1.25 CL8.8 fasteners to 20 Lb.-Ft. (27 N*M)

⚠ Proper torque is needed to keep the hitch secure to the vehicle when towing.



Reinstall passenger side underbody panel.

