



# Installation Instructions Vacuum/Magnet Mount Kit

**IMPORTANT!** Read all instructions before installing and using. Installer: This manual must be delivered to the end user.



## WARNING!

Failure to install or use this product according to manufacturers recommendations may result in property damage, serious bodily/personal injury, and/or death to you and those you are seeking to protect!



**Do not install and/or operate this safety product unless you have read and understand the safety information contained in this manual.**

1. Proper installation combined with operator training in the use, care, and maintenance of emergency warning devices are essential to ensure the safety of you and those you are trying to protect.
2. Exercise caution when working with live electrical connections.
3. This product must be properly grounded. Inadequate grounding and/or shorting of electrical connections can cause high current arcing, which can cause personal injury and/or severe vehicle damage, including fire.
4. Proper placement and installation are vital to the performance of this warning device. Install this product so that output performance of the system is maximized and the controls are placed within convenient reach of the operator so that s/he can operate the system without losing eye contact with the roadway.
5. It is the responsibility of the vehicle operator to ensure during use that all features of this product work correctly. In use, the vehicle operator should ensure the projection of the warning signal is not blocked by vehicle components (i.e., open trunks or compartment doors), people, vehicles, or other obstructions.
6. The use of this or any other warning device does not ensure all drivers can or will observe or react to a warning signal. Never take the right-of-way for granted. It is your responsibility to be sure you can proceed safely before entering an intersection, driving against traffic, responding at a high rate of speed, walking on or around traffic lanes.
7. This equipment is intended for use by authorized personnel only. The user is responsible for understanding and obeying all laws regarding warning signal devices. Therefore, the user should check all applicable city, state, and federal laws and regulations. The manufacturer assumes no liability for any loss resulting from the use of this warning device.

## Vacuum-Magnet Features:

The Vacuum-Magnet Mount kit features a magnet(s) inside of the suction cup(s) for a secure, temporary mount. The light should be placed in the center of the roof where the least amount of curvature occurs. Before installing, make sure there is no debris on the bottom of the light or on the roof of the vehicle, which could reduce the holding power of the suction cup(s) and magnet(s). Place and remove the light without sliding to avoid scratching the paint on the vehicle. After placement, the light should adhere firmly to the surface. If the unit slides or moves easily, a proper installation has not been obtained. To release the vacuum, lift the tab to release the airlock. To protect the Vacuum-Magnet Mount assembly, return the light to the box when not in use. **Do not attempt to attach the light to an ice-covered surface.**

## Magnet Features:

The Magnet Mount Kits offer a secure, temporary mount. The included adhesive disk(s) should be placed on the bottom of the magnet(s) to prevent scratching the vehicle finish upon installation. The light should be placed in the center of the roof where the least amount of curvature occurs. Before installing, make sure there is no debris on the bottom of the light or on the roof of the vehicle, which could reduce the holding power of the magnet. Place and remove the light without sliding to avoid scratching the paint on the vehicle. After Placement, the light should adhere firmly to the surface. If the unit slides or moves easily, a proper installations has not been obtained. To protect the light and magnet mount assembly, return light to the box when not in use. **Do not attempt to attach the light to an ice-covered surface.**



## WARNING!

Maximum recommended vehicle speed for safe operation using the Vacuum Mount model is 65 mph (104 km/h), when fitted to the center of a vehicle roof of steel construction. Higher speeds could cause the mount to fail, resulting in the beacon flying off of the vehicle, which could cause damage to other vehicles, and injury or death to the passengers.

The Vacuum Mount is not intended as a permanent mounting for the beacon. Metallic debris collected by the Vacuum Mount will contribute to rust stains. Ensure that the Vacuum Mount is kept clean.

**Note: The Magnet Mount is not recommended for use on a moving vehicle, nor is it intended as a permanent mount for the light. Long duration usage of the magnet in the presence of moisture will cause the steel to rust.**

### Vacuum Mount Installation for 5500 Series:

1. Remove round black stickers for vacuum placement
2. Remove lens screws, then remove lens.
3. Unclip and remove wire harness
4. Position vacuum magnets, place, and tighten screws.
5. Insert pinned end of cable through the wire harness hole from the bottom of the base. Pull at least 6 inches of slack.
6. Turn pins crimp side up, and insert pins into connector as shown in Figure 2.
7. Place zip-tie 1.0" from base of the connectors shown in Figure 3. Zip-tie must not slide on cord.
8. Trim excess zip-tie.
9. Clip connector to the PCA board and pull slack until zip-tie touches base.
10. Install lens, reverse of removal.
11. Slide o-ring onto screw until it reaches head, before placing into lens. If o-rings are damaged, replace with new ones.

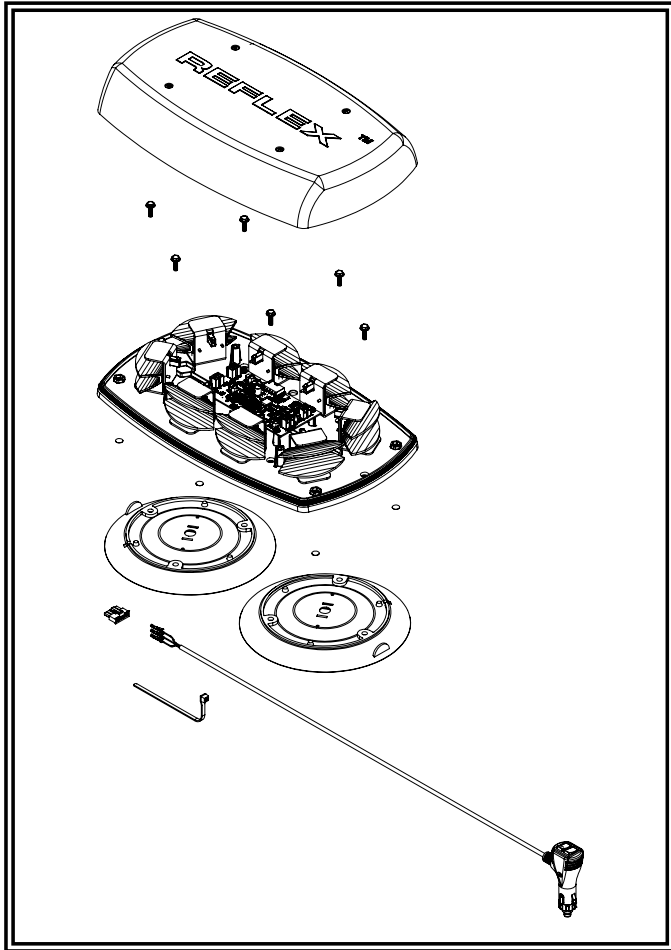

Figure 1



**NOTE:** Operating the vehicle without the outer lens installed on the product may result in damage that will NOT be covered under warranty.

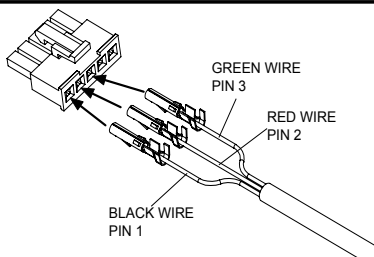

Figure 2

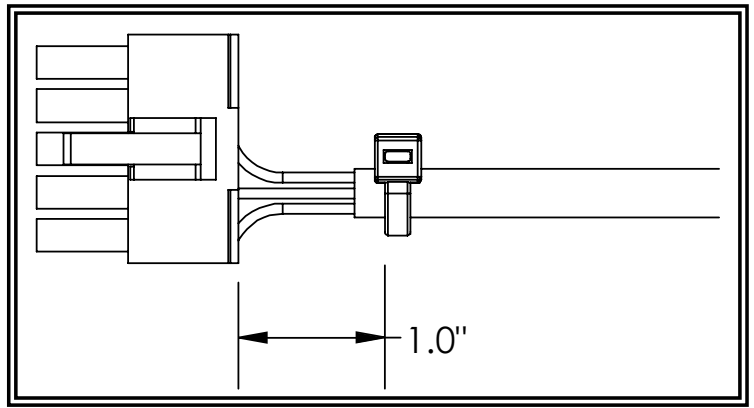

Figure 3

### Magnet Mount Installation for 5500 Series:

1. Refer to the appropriate Vacuum Mount Installation for the 5500 series, steps 2 through 9, and the corresponding Figures for wiring instructions for the cord.
2. Place hex nut into the hex shaped retaining cavity on the inside of the minibar base.
3. Place an internal star washer onto the enclosed M5 x 20 hex bolt and insert the hex bolt through the hole in the cup magnet as shown. Hold the magnet/bolt assembly with the bolt extended through the magnet as far as possible and feed the hex nut and the shank of the bolt through one of the openings at the 4 corners of the underside of the minibar base. Maintain tension on the bolt/nut by holding onto the cup magnet while tightening the assembly. Repeat this process for all four corners.
4. Place the adhesive magnet covers over the magnets.
5. Replace the lens.

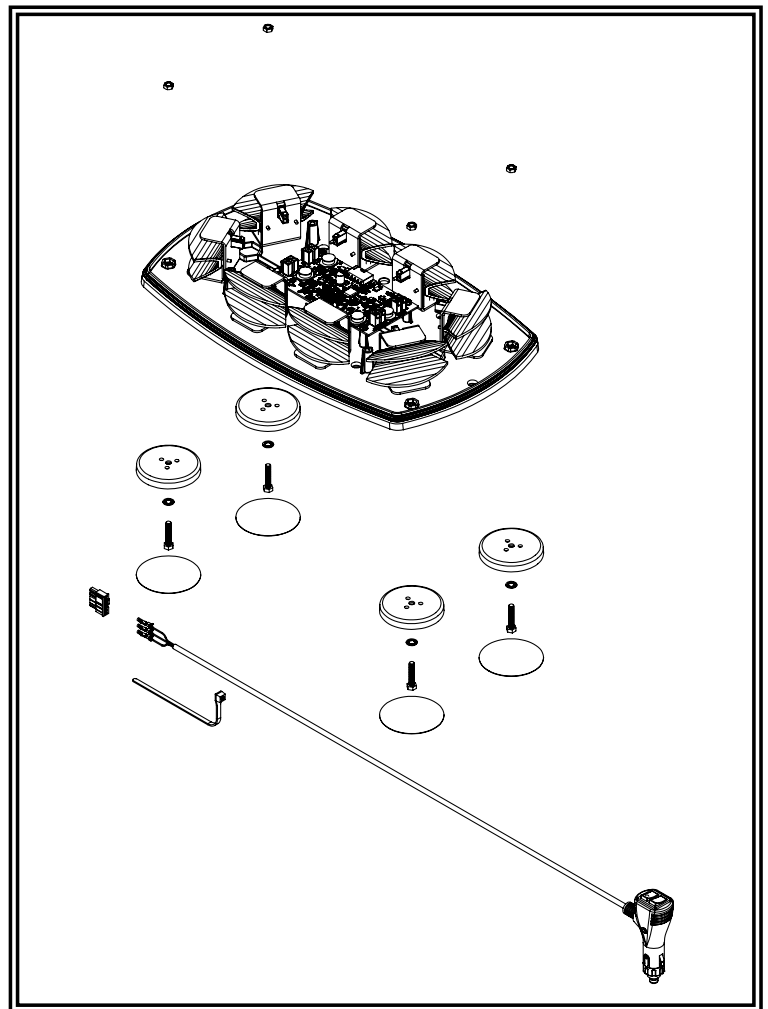

Figure 4