



# EGGO®

## Installation and Operation Instructions Mechanical Switch

### Introduction:

Back-up alarm activation switches are designed for use primarily on off-road vehicles that do not have a reversing light circuit or where routing the alarm's wiring into the reversing light circuit is not feasible. These switches are installed adjacent to the gear shift lever so that shifting into reverse will move the switch actuator arm, activating the back-up alarm.

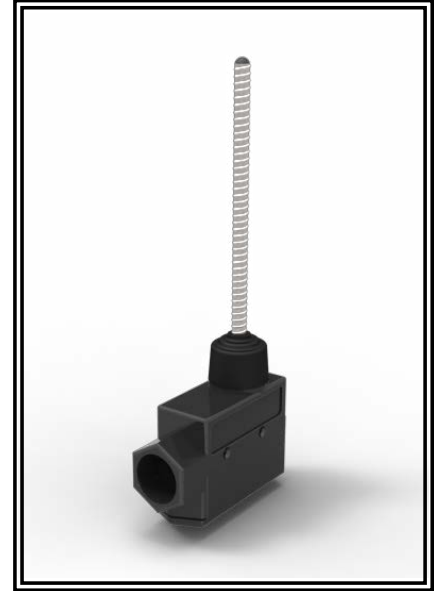

**IMPORTANT!** Read all instructions before installing and using. Installer: This manual must be delivered to the end user.

### **WARNING!**

Failure to install or use this product according to manufacturers recommendations may result in property damage, serious bodily/personal injury, and/or death to you and those you are seeking to protect!



**Do not install and/or operate this safety product unless you have read and understand the safety information contained in this manual.**

1. Proper installation combined with operator training in the use, care, and maintenance of emergency warning devices are essential to ensure the safety of you and those you are trying to protect.
2. Exercise caution when working with live electrical connections.
3. This product must be properly grounded. Inadequate grounding and/or shorting of electrical connections can cause high current arcing, which can cause personal injury and/or severe vehicle damage, including fire.
4. Proper placement and installation are vital to the performance of this warning device. Install this product so that output performance of the system is maximized and the controls are placed within convenient reach of the operator so that s/he can operate the system without losing eye contact with the roadway.
5. It is the responsibility of the vehicle operator to ensure during use that all features of this product work correctly. In use, the vehicle operator should ensure the projection of the warning signal is not blocked by vehicle components (i.e., open trunks or compartment doors), people, vehicles, or other obstructions.
6. The use of this or any other warning device does not ensure all drivers can or will observe or react to a warning signal. Never take the right-of-way for granted. It is your responsibility to be sure you can proceed safely before entering an intersection, driving against traffic, responding at a high rate of speed, walking on or around traffic lanes.
7. This equipment is intended for use by authorized personnel only. The user is responsible for understanding and obeying all laws regarding warning signal devices. Therefore, the user should check all applicable city, state, and federal laws and regulations. The manufacturer assumes no liability for any loss resulting from the use of this warning device.
8. This product contains high intensity LEDs, staring directly into these lights could result in temporary and/or permanent vision impairment.

Back-Up Alarms must be tested each day prior to vehicle operation. A record of this test must be recorded in the vehicle maintenance file.

**IMPORTANT!** *This unit is a safety device, and must be connected to it's own seperate, fused power point to assure it's continued operation should any other electrical accessory fail.*

### Installation:

Install the switch adjacent to the gear shift lever so that shifting into reverse will move the switch actuator arm sufficiently to make electrical contact.

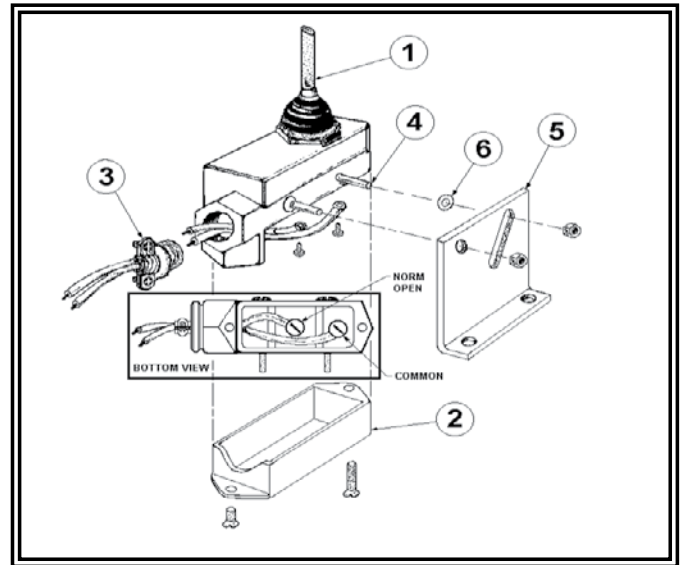
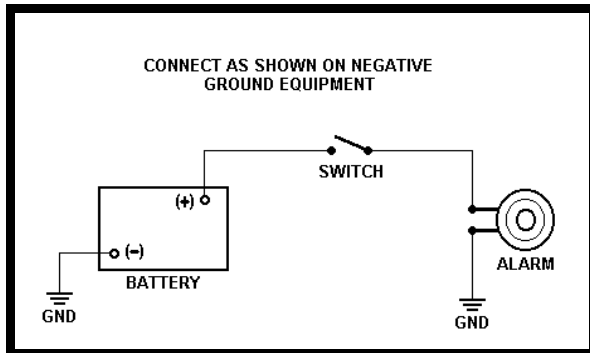

- A.** Select a convenient location for mounting the switch, either at the reverse gear linkage or shift lever, so the outer end of the switch actuating arm (1) will be moved a minimum of one inch when vehicle is put into reverse gear. Contact with the actuating arm should be made approximately 1 1/2" from the end.
- B.** Thread two 14 or 16 gage wires to this switch location. One from the positive terminal of the back-up alarm (red wire or front terminal) and the other from a good source of electricity.
- C.** Remove lower switch housing (2). Install wire clamp (3) and insert wires through clamp. Connect one of the wires to the terminal marked "COMMON". *NOTE: To improve moisture resistance apply a sealing compound around wires at clamp (3) after reassembly.*
- D.** Unscrew hex nuts from switch mounting bolts (4) and attach mounting bracket (5). Be sure that sealing washers (6) are in place between bracket and switch. Bolt bracket in position on vehicle.
- E.** Check back-up alarm system for proper operation before using vehicle. If alarm does not function, reverse power leads to alarm. If alarm still does not function, check to make sure actuating arm is moving one inch. *CAUTION: This switch is designed to handle the current draw of back-up alarms. No other circuit can be added to system without endangering life of the switch.*