



## INSTALLATION INSTRUCTIONS

FTS24211		2018-2020 JEEP JL INTERIOR CARGO RACK
1	FT50660	CARGO TRAY (CENTER)
1	FT50661	CARGO TRAY SIDE (DRIVER)
1	FT50662	CARGO TRAY SIDE (PASSENGER)
1	FT50685	HARDWARE SUBASSEMBLY

FT50685		HARDWARE SUBASSEMBLY
1	FT24211i	INSTRUCTIONS
1	FT50659	HARDWARE KIT
1	FT50697	EDGE TRIM 120"
1	FTAS12	STICKER FT BLUE
1	FTREGCARD	REGISTRATION CARD

FT50659 - HARDWARE KIT		LOCATION
6	3/8-16 X 1" BUTTON HEAD BOLT	
12	3/8" SAE WASHER	
6	3/8-16 NYLOCK NUT	

## 2018-2021 JEEP WRANGLER (JL) 4DR

### INTERIOR CARGO RACK

#### FTS24211

**NOTE:** TO ORDER WEARABLE REPLACEMENT COMPONENTS DO NOT USE PART NUMBERS SHOWN ON THIS INSTRUCTION SHEET. GO TO FABTECH WEBSITE AND LOOK UP WEARABLE REPLACEMENT PARTS TO FIND THE PROPER PART NUMBER TO ORDER.



## **- TOOL LIST -**

### ***Required Tools (Not Included)***

- Basic Hand Tools
- Assorted Metric and S.A.E sockets, and Allen wrenches
- Torque Wrench
- 7/32" Hex Tool
- 9/16" socket or wrench
- T-50 Torx Bit

## **- PRE-INSTALLATION NOTES -**

### ***READ THIS BEFORE YOU BEGIN INSTALLATION -***

Check all parts to the parts list above before beginning installation.

Read all instructions thoroughly from start to finish before beginning the installation.

Check your local city and state laws prior to the installation of this system for legality. Do not install if not legal in your area.

### ***FOOTNOTES -***

- Fits 4-door models only
- Designed for hard top models. Rack does not allow soft top models to fully retract.
- Does not fit vehicles with Sky One-Touch power top.

## - INSTRUCTIONS -

1. Before you begin the install, layout all of the parts and hardware. Next, locate the FT50660 (Center Tray) and install the FT50697 (Edge Trim) around the top edge. **SEE FIGURE 1**



2. Open the rear gate and window on your Jeep.
3. Using T-50 Torx bit, remove and save the two rear bolts that secure the side hard top panels to the body on both driver & passenger sides. **SEE FIGURE 2**

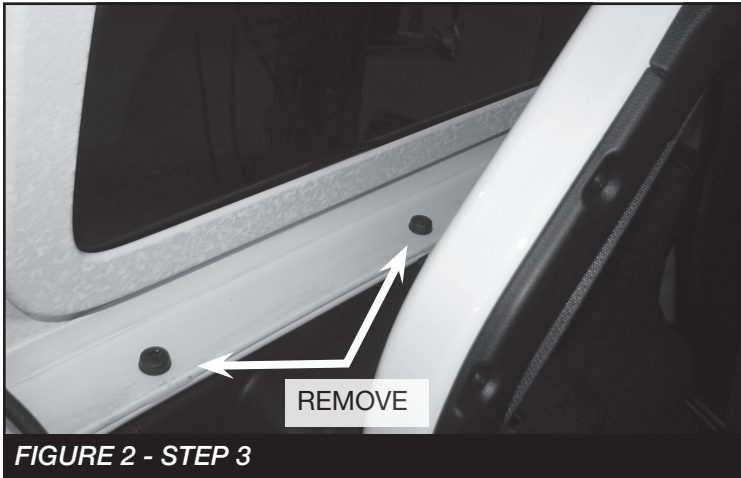

4. **Driver side:** Install FT50661 (Driver side tray) like shown in **FIGURE 3** using the factory bolts removed in step 3. Leave loose.



5. **Passenger side:** Install FT50662 (Passenger side tray) like shown in **FIGURE 4** using the factory bolts removed in step 3. Leave Loose



6. Install FT50660 (Center Tray) using the supplied 3/8" hardware. Torque to 44 ft-lbs. **SEE FIGURE 5**

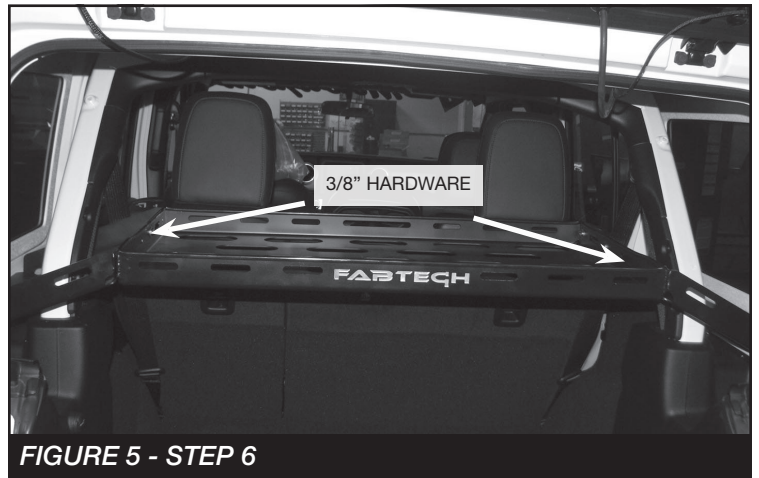

7. Torque the factory side panel T-50 bolts to 27 ft-lbs.
8. Install Driver Warning Decal. Complete product registration card and mail to Fabtech in order to receive future safety and technical bulletins on this suspension.