

Fowler

QuadraTest™ Multimode Electronic Test Indicator

- 4 Measuring Modes! (Min, Max, TIR and Direct)
- 4 Measuring Resolutions!

Fowler's QuadraTest multimode electronic test indicator offers unrivaled measuring versatility in an electronic test indicator!

Available with a 1/2" or 1-7/16" contact point. The QuadraTest is the perfect solution to test indicating applications.

The QuadraTest features four measuring modes (Min, Max, TIR and direct), with an RS-232 interface that is water, oil and coolant resistant to IP65 compliance WITH or WITHOUT the interface cable installed! The QuadraTest also features true inch/metric conversion, a 1-1/2" diameter dial face that rotates a FULL 360° with both analog bar graph and numeric digital display. It also meets or exceeds DIN/ISO standards (maximum error on .00005" scale at full range: .0004").

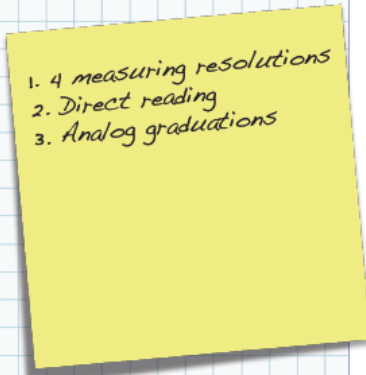

4 Measuring Resolutions!

Resolution	Smallest Division
0-40-0	.0005"
0-40-0	.00005"
0-1-0	0.01mm
0-1-0	0.001mm



Sylvac Battery Tray B1
Part Number: M281.221-101

Contact Points For: 54-562-888

Part Number	Tip Dia.
52-567-104-0	.040"
52-567-105-0	.080"
52-567-106-0	.120"



Large Diameter Dovetail Clamp
Part Number: 05-100-156

Contact Points For: 54-562-777

Part Number	Tip Dia.
52-567-101-0	.040"
52-567-102-0	.080"
52-567-103-0	.120"



Small Diameter Dovetail Clamp
Part Number: 05-100-157



Part Number	Contact Point Length	Range	Resolution
54-562-777-0	1/2"	.030"/.8mm	.00005"/.001mm
54-562-888-0	1-7/16"	.020"/.5mm	.00005"/.001mm
Accessories			
54-115-528-0	Output Cable USB		
54-100-350-0	Replacement Battery type CR2032		





Girod "Vertical" Test Indicators



Dial Face for 52-562-272
Part Number: 05-100-167



Dial Face for 52-562-273
Part Number: 05-100-168



Dial Face for 52-562-473
Part Number: 05-100-169



Dial Face for 52-562-474
Part Number: 05-100-170



- 52-565-090-0 5/32" dia. dovetail clamp
- 52-565-091-0 7/32" dia. dovetail clamp
- 52-565-092-0 1/4" dia. dovetail clamp
- 52-565-093-0 5/16" dia. dovetail clamp
- 52-565-094-0 3/8" dia. dovetail clamp



1-1/2" Girod Bezel and Crystal
Part Number: 05-100-165
Note: Compatible with test indicators 52-562-473 and 52-562-474.



1" Girod Bezel and Crystal
Part Number: 05-100-166
Note: Compatible with test indicators 52-562-272 and 52-562-273.



Girod Pivot P1
Part Number: 05-100-171
Note: Compatible with test indicators 52-562-273, 52-562-473, and 52-562-474.



Girod Pivot P2
Part Number: 05-100-172
Note: Compatible with test indicator 52-562-272.

Replacement Points for Test Indicators

Swiss Short		Swiss Long	
Contact Points		Contact Points	
Part Number	Tip Dia.	Part Number	Tip Dia.
52-567-101-0	.040"	52-567-104-0	.040"
52-567-102-0	.080"	52-567-105-0	.080"
52-567-103-0	.120"	52-567-106-0	.120"
For Indicators - Sylvac/Girod		For Indicators - Sylvac/Girod	
Part Number		Part Number	
52-562-272-0		52-562-474-0	

Part Number	Dial Reading	Grad.	Range	Accuracy	Dial Dia.	Point Length
Inch Series:						
52-562-272-0	0-15-0	.0005"	.030"	.00065"	1"	.500"
52-562-273-0	0-4-0	.0001"	.008"	.00016"	1"	.500"
52-562-474-0	0-10-0	.0005"	.020"	.00065"	1-1/2"	1.500"
52-562-473-0	0-4-0	.0001"	.008"	.00016"	1-1/2"	.500"
Metric Series:						
52-563-272-0	0-40-0	.01mm	.8mm	.013mm	28mm	12.5mm
52-563-273-0	0-100-0	.002mm	.2mm	.0035mm	28mm	12.5mm
52-563-474-0	0-25-0	.01mm	.5mm	.013mm	38mm	36mm
52-563-473-0	0-100-0	.002mm	.2mm	.0035mm	38mm	12.5mm

Fowler

Girod "Horizontal" Test Indicators



No. 52-562-453-0



- 52-565-090-0 5/32" dia. dovetail clamp
- 52-565-091-0 7/32" dia. dovetail clamp
- 52-565-092-0 1/4" dia. dovetail clamp
- 52-565-093-0 5/16" dia. dovetail clamp
- 52-565-094-0 3/8" dia. dovetail clamp



Dial Face for 52-562-453
Part Number: 05-100-174



1-1/2" Girod Bezel and Crystal
Part Number: 05-100-165
Note: Compatible with test indicator 52-562-453

Replacement Points

Swiss Short	
Contact Points	
Part Number	Tip Dia.
52-567-101-0	.040"
52-567-102-0	.080"
52-567-103-0	.120"
For Indicators - Sylvac/Girod	
Part Number	
52-562-253-0	
52-562-453-0	



Dial Face for 52-562-253
Part Number: 05-100-173



1" Girod Bezel and Crystal
Part Number: 05-100-166
Note: Compatible with test indicator 52-562-253.



Girod Pivot P1
Part Number: 05-100-171

Part Number	Dial Reading	Dial Grad.	Total Range	Dial Dia.	Accuracy	Dia. Points Included	Point Length
Inch Series:							
52-562-253-0	0-4-0	.0001"	.008"	1"	.00016"	.040, .080 & .120"	.500"
52-562-453-0	0-4-0	.0001"	.008"	1-1/2"	.00016"	.040, .080 & .120"	.500"
Metric Series:							
52-563-252-0	0-40-0	.01mm	.8mm	28mm	.013mm	1, 2 & 3 mm	12.5mm
52-563-253-0	0-100-0	.002mm	.2mm	28mm	.0035mm	1, 2 & 3 mm	12.5mm
52-563-452-0	0-40-0	.01mm	.8mm	38mm	.013mm	1, 2 & 3 mm	12.5mm
52-563-453-0	0-100-0	.002mm	.2mm	38mm	.0035mm	1, 2 & 3 mm	12.5mm

Vertical X-Test Indicator
TWICE the range of most indicators!



Part Number	Graduations	Dial Diameter
Inch:		
52-562-001-0	.0005"	1-1/2"
52-562-002-0	.0005"	1"
52-562-003-0	.001"	1"
Metric:		
52-562-007-0	.01mm	25mm
52-562-008-0	.01mm	38mm

Part Number	Graduations	Dial Diameter
Vertical X-Test Indicators:		
52-562-004-0	.0005"	1-1/2"
52-562-005-0	.0005"	1"
52-562-006-0	.001"	1"



1-1/2" Silver X-Test Bezel and Crystal
Part Number: 05-100-158



1" Silver X-Test Bezel and Crystal
Part Number: 05-100-159



X-Test Stem Old
Part Number: 05-100-160-0
Note: For silver bezel indicators, has a flat part.



X-Test Stem New
Part Number: 05-100-160-1
Note: For blue bezel indicators.



X-Test Pivot
Part Number: 05-100-161



Large Diameter Dovetail Clamp
Part Number: 05-100-156



Small Diameter Dovetail Clamp
Part Number: 05-100-157



Replacement Wrench
Part Number: 05-100-162

X-Test	
Contact Points	
Part Number	Tip Dia.
52-562-801-0	.040"
52-562-800-0	.080"
52-562-802-0	.120"
For Indicators	
Part Number	
52-562-001-0	
52-562-002-0	
52-562-003-0	
52-562-004-0	
52-562-005-0	
52-562-006-0	
52-562-007-0	
52-562-008-0	
52-562-100-0	
52-562-105-0	
52-562-110-0	
52-562-120-0	



Horizontal Test Indicators

All Fowler Test Indicators include bidirectional constant clockwise rotation, automatic reversal, three dovetail mountings, jeweled movement, two dovetail clamps and a molded case.

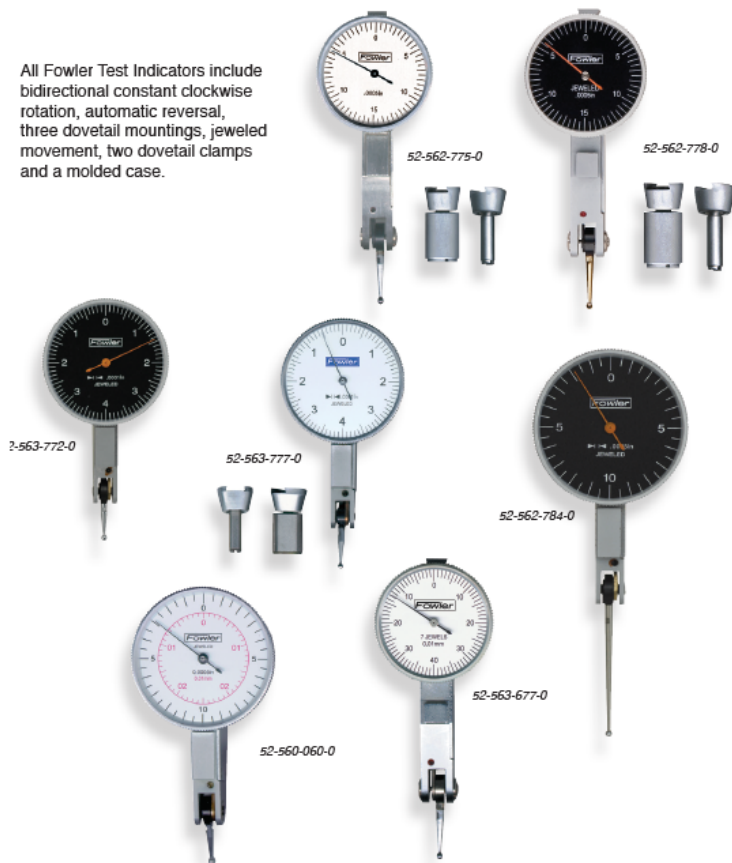

Large Diameter Dovetail Clamp
Part Number: 05-100-156



Small Diameter Dovetail Clamp
Part Number: 05-100-157



Replacement Wrench
Part Number: 05-100-162



Test Indicator Pivot P1
Part Number: 05-100-163
Note: Compatible with test indicators 52-562-775, -776, -778, -780, and 52-560-060.



Test Indicator Pivot P2
Part Number: 05-100-164
Note: Compatible with test indicators 52-563-777 and 52-563-770.

Part Number	Face Color	Total Range	Dial Reading	Graduation	Accuracy	Dial Dia.	Point Length
.030" Range:							
52-562-774-0	white	.030"	0-15-0	.001"	.0005"	1"	1/2"
52-562-778-0	black	.030"	0-15-0	.0005"	.0005"	1"	1/2"
52-562-775-0	white	.030"	0-15-0	.0005"	.0005"	1"	1/2"
52-562-776-0	white	.030"	0-15-0	.0005"	.0005"	1-1/2"	1/2"
52-562-780-0	black	.030"	0-15-0	.0005"	.0005"	1-1/2"	1/2"
.008" Range:							
52-563-770-0	white	.008"	0-4-0	.0001"	.00015"	1"	1/2"
52-563-771-0	black	.008"	0-4-0	.0001"	.00015"	1"	1/2"
52-563-777-0	white	.008"	0-4-0	.0001"	.00015"	1-1/2"	1/2"
52-563-772-0	black	.008"	0-4-0	.0001"	.00015"	1-1/2"	1/2"
.020" Range:							
52-562-781-0	white	.020"	0-10-0	.0005"	.0005"	1"	1-7/16"
52-562-782-0	black	.020"	0-10-0	.0005"	.0005"	1"	1-7/16"
52-562-783-0	white	.020"	0-10-0	.0005"	.0005"	1-1/2"	1-7/16"
52-562-784-0	black	.020"	0-10-0	.0005"	.0005"	1-1/2"	1-7/16"
.08mm Range:							
52-563-677-0	white	.08mm	0-40-0	.01mm	.01mm	1-1/4"	1/2"
Inch/metric:							
52-560-060-0	white/red	.025" .7mm	0-10-0 0-25-0	.0005" .01mm	.0005" .01mm	1-1/2"	1/2"



Test Indicator Accessories



▲ No. 52-565-010



▲ No. 52-565-012



▲ No. 52-565-015



▲ No. 52-565-030



▲ No. 52-565-025



▲ No. 52-565-060.



▲ No. 52-565-040



▲ No. 52-565-064



▲ No. 52-565-062



▲ No. 52-565-082



▲ No. 52-174-250



▲ No. 52-565-083

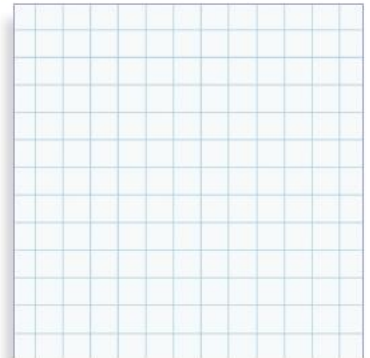

Locking Screw for 52-565-060 and 064
Part Number: 05-100-396



Part Number	Description	Shank Size
52-565-010-0	1/4" x 1/2" Holding bar with 1/4" pin	
52-565-012-0	Axial Support	3/8" x 5-1/4" long
52-565-015-0	3/16" x 5/16" Holding bar with 1/4" rod	
52-565-025-0	Dovetail clamp, bore diameter 1/4" and 3/8"	
52-565-030-0	1/4" x 7/16" Holding bar with 1/4" rod	
52-565-040-0	7.2mm x 10mm Holding bar with 1/4" rod	
52-565-060-0	Universal clamp, bore diameter 1/4"	
52-565-062-0	Short arm .600" with dovetail & fine adjustment	.315"
52-565-064-0	Long arm 4.765" with dovetail & fine adjustment	.315"
52-174-250-0	Rectangular holder with clamp for height gages	3/8"
52-565-082-0	Rectangular holder for 54-105 series	
52-565-083-0	Rectangular holder with clamp 1/4" x 1/2"	



Fowler

Mark VI Electronic Indicators

Indicators



Battery Tray for Mark VI
Part Number: M289.510-02



Reader Head for Mark VI
Part Number: M289.200-13



This Button is programmable for common functions

Part Number	Range	Maximum Error	Resolution
54-530-125-0	0-500"/12.5mm	0.0004"/.01mm	.0005"/.01mm
54-530-135-0	0-500"/12.5mm	0.00012"/.003mm	.00005"/.001mm
54-530-145-0	0-1"/25mm	0.0004"/.01mm	.0005"/.01mm
54-530-155-0	0-1"/25mm	0.00016"/.004mm	.00005"/.001mm
54-530-175-0	0-2"/50mm	0.00019"/.005mm	.00005"/.001mm
54-530-195-0	0-4"/100mm	0.00024"/.006mm	.00005"/.001mm
54-530-215-0	0-6"/150mm	0.0004"/.01mm	.00005"/.001mm
8mm Stem Models:			
54-530-136-0	0-500"/12.5mm	0.00012"/.003mm	.00005"/.001mm
54-530-156-0	0-1"/25mm	0.00016"/.004mm	.00005"/.001mm
IP67 Models: (with Rubber Boot)			
54-530-137-0	0-500"/12.5mm	0.00012"/.003mm	.00005"/.001mm
54-530-157-0	0-1"/25mm	0.00016"/.004mm	.00005"/.001mm

Mark VI Accessories:

- 54-530-211-0 Standard Lug Back
- 54-530-212-0 90° Lug Back
- 54-115-526-0 Proximity USB Cable
- 54-115-528-0 Power USB Cable

LIFETIME WARRANTY

Fowler
POWER
INTERFACE



Swiss Quality!

Fowler
PROXIMITY
INTERFACE



IP54

IP67

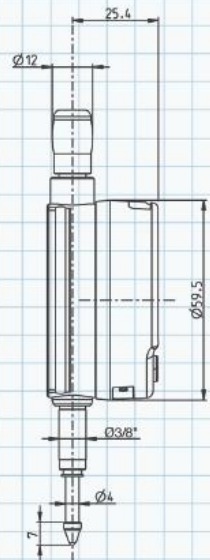



Mark VI Electronic Indicators With Integrated Bluetooth Technology



Battery Tray for Mark VI
Part Number: M289.510-02



Reader Head for Mark VI
Part Number: M289.200-13



LIFETIME WARRANTY

Part Number	Range	Maximum Error	Resolution
54-530-335-0	0-500"/12.5mm	0.00012"/.003mm	.00005"/.001mm
54-530-355-0	0-1.000"/25mm	0.00016"/.004mm	.00005"/.001mm
54-115-246-BT	USB Port Bluetooth receiver		

Mark VI Electronic Indicators With Analog Display



Battery Tray for Mark VI
Part Number: M289.510-02



Reader Head for Mark VI
Part Number: M289.200-13



LIFETIME WARRANTY

Part Number	Range	Maximum Error	Resolution
54-530-535-0	0-500"/12.5mm	0.00012"/.003mm	.00005"/.001mm
54-530-555-0	0-1.000"/25mm	0.00016"/.004mm	.00005"/.001mm



*IP65 protection
Direct reading with an
analog display.*

IP65 Specifications	
Dust (6)	Water (5)
Dust-tight	Protected against water projected in jets from any direction



IP65 Mini-Resistant Electronic Indicator

- Coolant, water & oil resistant to IP65 specifications!
- Non-contact measuring system!
- Tough carbide contact point!

- Range: 0— .5"/12.5mm
- High contrast LCD display
- Floating zero
- Preset & Hold features
- Menu customizable with free software
- Dual measuring references
- Dovetail back with lug
- 1.575" diameter bezel



Sylvac Battery Tray B1
Part Number: M281.221-101

Part Number	Range	Maximum Error	Resolution
54-520-680-2	0- .5"/12.5mm	.0004"/.01mm	.0005"/.01mm
54-520-680-3	0- .5"/12.5mm	.0002"/.005mm	.00005"/.001mm
Accessories:			
54-115-444-0	Output Cable RS-232		
54-115-528-0	USB		

Fowler

Vertical IP65 Mini-Resistant Electronic Indicator

- Data output RS-232 combined with power supply
- Clamping: Stem 8mm and dovetail
- Menu customizable with free software
- Water and coolant resistant according to IP65



Sylvac Battery Tray B1
Part Number: M281.221-101

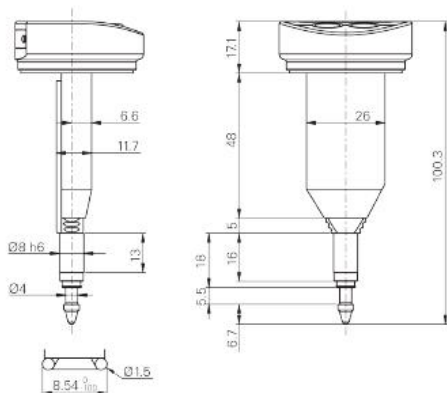
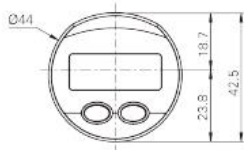

Swiss Quality!



Indicators

Part Number	Range	Maximum Error	Resolution
54-520-414-0	.200"/5mm	.0004"	.0005"
54-520-454-0	.200"/5mm	.0002"	.00005"

Direct reading and an analog display



2 Xtra
Contact Points
w/ purchase



Low Cost,
High Quality,
Multi-Function
Indicators



INDI-X[®] Electronic Indicator



Replacement Ball Contact Point

Part Number: 05-100-176



Spline Contact Point

Part Number: 05-100-118



Needle Contact Point

Part Number: 05-100-119



Indi-X Black Battery Tray

Part Number: 05-100-175

Fowler



Part Number	Description
54-520-025-1	Indi-X Electronic Indicator

INDI-X^{blue} Electronic Indicators

Now available in .5"/12.5mm & 1"/25mm ranges!



Indi-X Electronic Pack

Part Number: 05-100-121

Note: Not compatible with 54-520-260-0 indicators.



Indi-X Battery Tray

Part Number: 05-100-122



Replacement Ball Contact Point

Part Number: 05-100-176



Spline Contact Point

Part Number: 05-100-118



Needle Contact Point

Part Number: 05-100-119



Part Number	Description
54-520-250-0	1"/25mm Indi-X Blue Electronic Indicator
54-520-260-0	1"/25mm/64ths Indi-X Blue Inch-Metric-Fraction Electronic Indicator
54-520-255-0	.5"/12.5mm Indi-X Blue Electronic Indicator

Designed for use in harsh environments.



Fowler

X-PROOF® Dial Indicators



No. 52-520-444-1



No. 52-520-450-0



No. 52-520-250-1



No. 52-520-455-0



Crystal for 52-520-450
Part Number: 05-100-177



Rubber Boot for 52-520-250
Part Number: 05-100-180



Tolerance Marker for 52-520-450
Part Number: 05-100-178



Rubber Boot for 52-520-444
Part Number: 05-100-181



Rubber Boot for 52-520-450
Part Number: 05-100-179



Back Plate Screws (Set of 4)
Part Number: 05-100-182
Note: Compatible with indicators 52-520-450 and 52-520-455

Part Number	Graduation	Range	AGD Group	Reading	Contact Point
52-520-450-0	.001"	1"	2	0-100	4-48
52-520-455-0	.001"	1"	2	0-100	4-48
52-520-250-1	.0005"	.40"	2	0-50-0	M2.5
52-520-444-1	.001"	.40"	2	0-100	M2.5

Dial Indicators



Back Plate Screws (Set of 4)
Part Number: 05-100-182



Dial Indicator Top Screw
Part Number: 05-100-183



Replacement Ball Contact Point
Part Number: 05-100-176

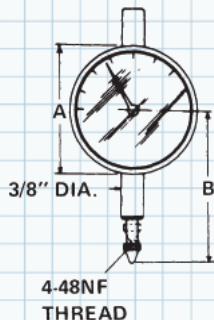
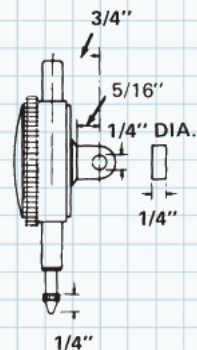

Part Number	Grad.	Range	Continuous Reading	Balanced Reading	Dim. A	Dim. B
AGD Group 1:						
Inch:						
52-520-005-0	.001"	.250"	0-100	—	1-58"	2-18"
52-520-010-0	.001"	.250"	—	0-50-0	1-58"	2-18"
AGD Group 2						
Inch:						
52-520-100-0	.001"	.250"	0-100	0-50-0	2-1/4"	2-7/32"
52-520-102-0	.001"	.250"	—	0-50-0	2-1/4"	2-7/32"
52-520-105-0	.001"	.500"	0-100	0-50-0	2-1/4"	2-1/2"
52-520-106-0	.0005"	.500"	0-50	0-25-0	2-1/4"	2-7/8"
52-520-107-0	.001"	.500"	—	0-50-0	2-1/4"	2-1/2"
52-520-110-0	.001"	1.00"	0-100	—	2-1/4"	3"
52-520-115-0	.001"	1.00"	—	0-50-0	2-1/4"	3"
52-520-120-0	.001"	2.00"	0-100	0-50-0	2-1/4"	5-1/2"
52-520-125-0	.0005"	.250"	0-50	0-25-0	2-1/4"	2-7/32"
52-520-127-0	.0005"	.250"	—	0-25-0	2-1/4"	2-7/32"
52-520-128-0	.0005"	1.00"	0-50	—	2-1/4"	3"
52-520-129-0	.0005"	1.00"	0-50	0-25-0	2-1/4"	3-3/8"
52-520-135-0	.0001"	.05"	0-10	0-5-0	2-1/4"	2-1/32"
52-520-137-0	.0001"	.05"	—	0-5-0	2-1/4"	2-1/32"
52-520-140-0	.0001"	.500"	0-10	—	2-1/4"	2-1/2"
Black Face:						
52-520-109-0	.001"	1.00"	0-100	0-50-0	2-1/4"	3-3/8"
Metric:						
52-520-300-0	.01mm	10mm	0-100	0-50-0	2-1/4"	2-1/2"
52-520-400-0	.002mm	5mm	—	0-10-0	2-1/4"	2-7/32"
52-520-500-0	.01mm	25mm	0-100	0-50-0	2-1/4"	3"
AGD Group 3						
Inch:						
52-520-200-0	.001"	.500"	0-100	0-50-0	3-1/4"	2-1/2"
52-520-205-0	.0005"	1.00"	0-50	0-25-0	3-1/4"	3"
52-520-210-0	.001"	2.00"	0-100	0-50-0	3-1/4"	5-1/32"
52-520-215-0	.0005"	.125"	0-50	0-25-0	3-1/4"	2-7/32"





Premium Dial Indicators with Certificate of Calibration

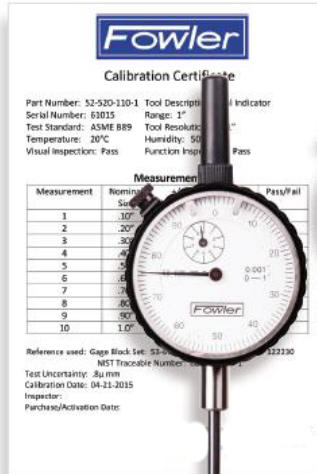

No. 52-520-110-1



No. 52-520-110-2



Back Plate Screws (Set of 4)
Part Number: 05-100-182

Part Number	Dial Face Color	Graduations	Range	AGD Group	Reading
52-520-110-1	Black	.001"	1"	2	0-100
52-520-110-2	White	.001"	1"	2	0-100

Inch/Metric Reading Dial Indicator



Dial Indicator Top Screw
Part Number: 05-100-183



Back Plate Screws (Set of 4)
Part Number: 05-100-182



Replacement Ball Contact Point
Part Number: 05-100-176



Part Number	Graduations	Range	AGD Group	Reading
52-530-110-0	.001"/.01mm	1"/25mm	2	0-100/0-100-0



Two gages in one!
This indicator simultaneously reads in both inch and metric.

