



FF50/ FF75

Mounting Instructions
Driving lamps
Fog lamps



for 55 W only
uniquement pour 55 W
solo para 55 W

Kit includes

FF 50



FF 75

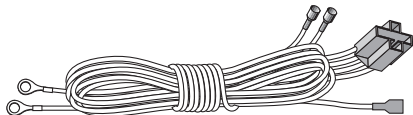
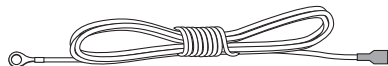
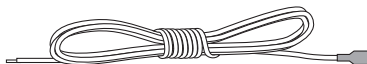
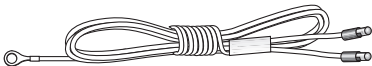
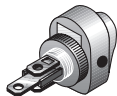
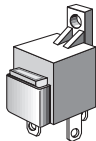
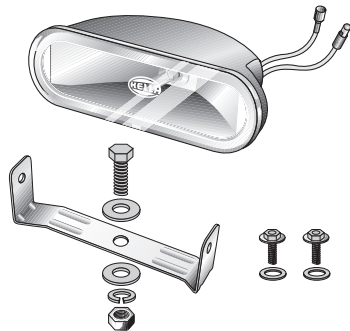



Driving lamps

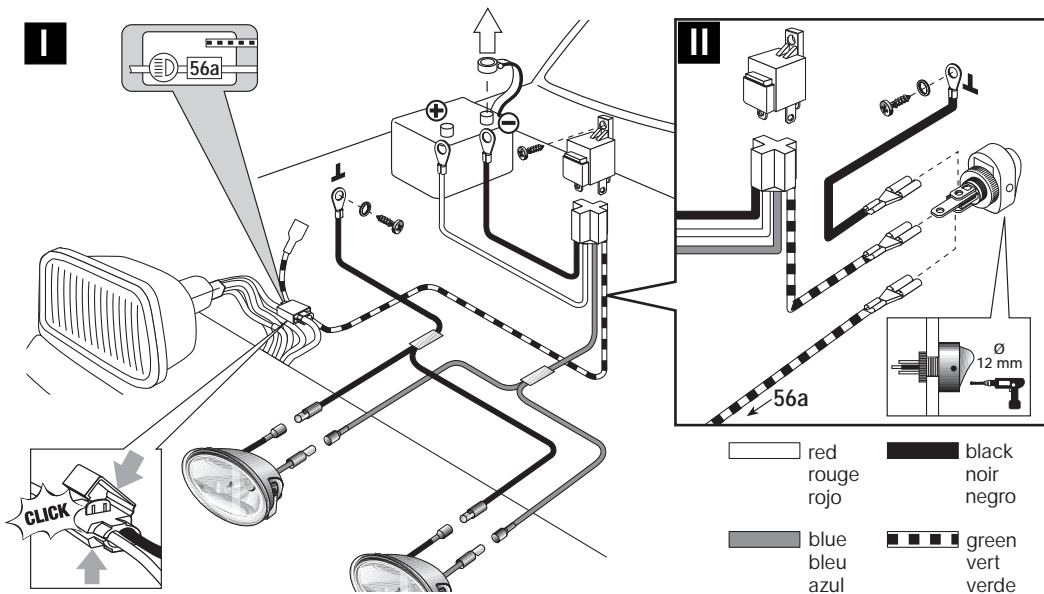

Fog lamps

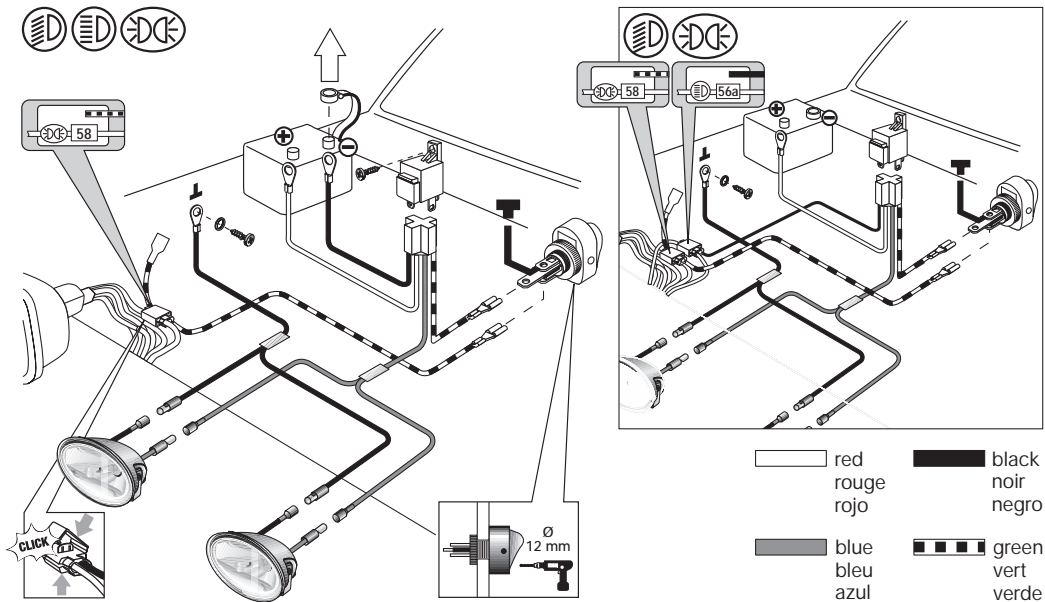

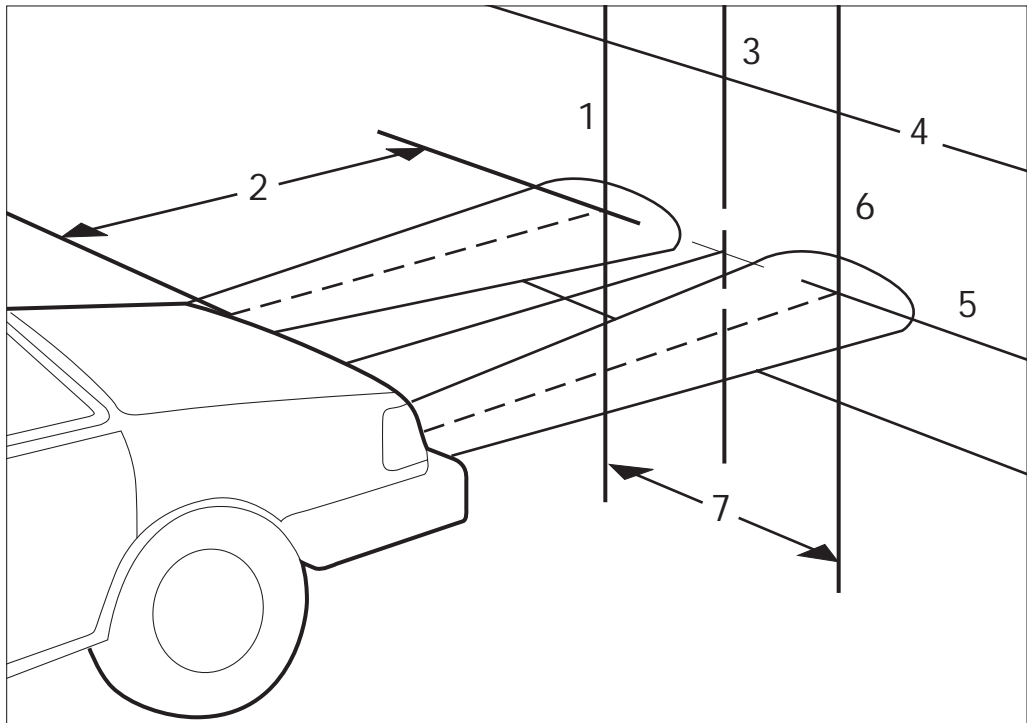

Tools required:

- Ruler
- Screwdriver for recessed-head screw
- Combination pliers
- 8, 14 mm open end or box wrench
- Drill with 3, 10 and 12 mm dia. bits

Mounting steps:

Please follow instructions carefully; some of them are legal requirements:

1. Consult your local state regulations regarding minimum and maximum height above ground.

2. Mounting position. Lamps must be mounted in such a way that:

- they are at exactly the same height

- they are at the same distance from the center of the vehicle.

Important:

Before fitting the lamps make sure that they do not prevent sufficient air reaching the radiator.

Lamps should not vibrate or extend above the bonnet and must be attached symmetrically.

Determine mounting position on flat surface (left illustration) and mark mounting points.

Drill pilot hole with 3 mm dia. bit and then bore out to 10 mm. Protect drilled metal parts with rust protection paint.

Screw lamps to vehicle (use two-point mount if required).

Align lamps and tighten screws

Reconnect earth lead (-) to battery. Check lights, tighten connection wires securely.

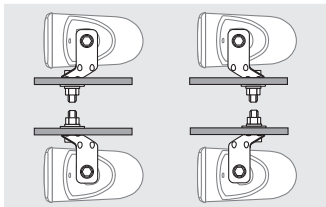

Electrical connection

Install relay with connection terminals pointing downwards so that they are protected against splashing water.

If required, install switch in dashboard.

Disconnect earth lead (-) from battery for safety.

Driving lamps see illustration on page 4:

Lay and connect wires according to circuit diagram.

According to circuit diagram **II** the auxiliary lamps can be switched on in addition to the main beams with a separate switch.

According to circuit diagram **I** the auxiliary lamps are switched on together with the existing main beams.

Fog lamps see illustration on page 5:

Lay and connect wires according to circuit diagram.

Adjusting the lamps, see illustration on page 6:

Have the driving lamps adjusted at a workshop or service station. Only properly adjusted lamps provide optimum illumination.

The correct visual aim is with the top of the beam 4" below the lamp center at 25 ft. The lamp shall be centered laterally about a vertical line directly ahead of the lamp. A higher visual aim may be desired, but the top of the beam should not be higher than the lamp center level at 25 ft.

- 1 Vertical centerline ahead of left headlamp
- 2 25 ft.
- 3 Centre of vehicle
- 4 Headlamp adjusting screen
- 5 Height of lamp centers (distance from ground to center of lamp)
- 6 Vertical centerline ahead of right headlamp
- 7 Distance between headlamps