

**Mounting Instructions LED**  
Daytime **Running Lights**/parklight

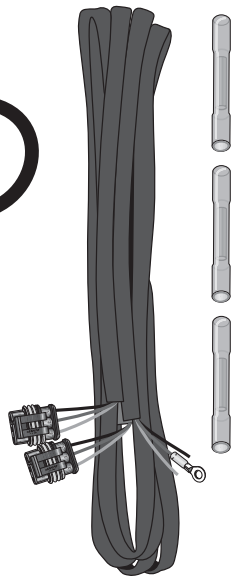

**Lieferumfang**  
**Kit includes**  
**Fourniture**

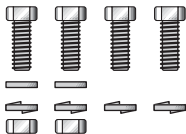

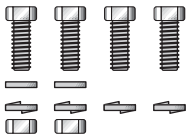
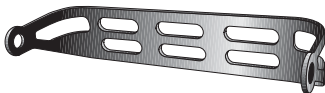
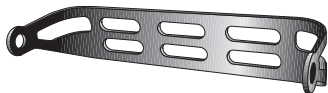
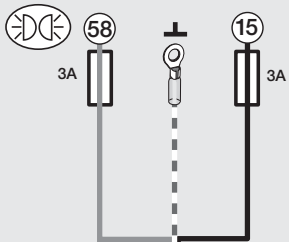
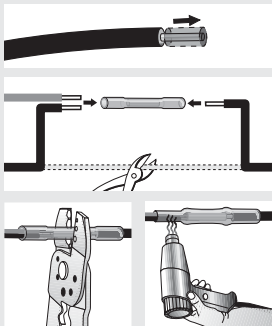

15 black

⊥ brown

58 grey

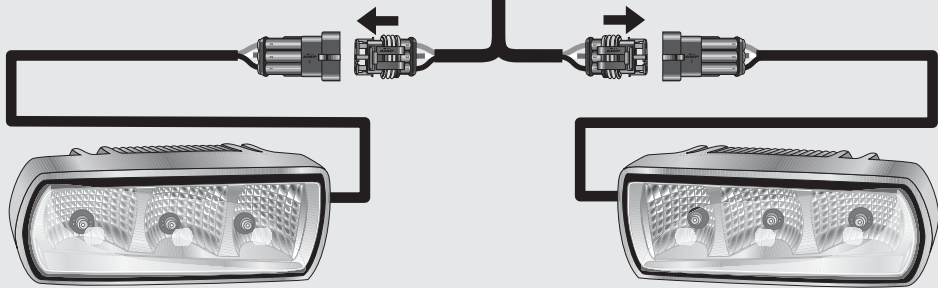

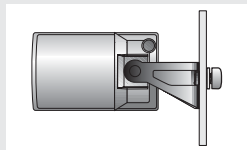
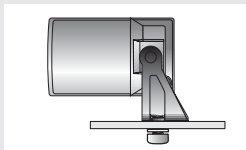
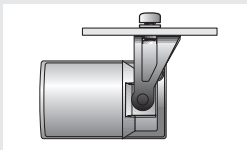
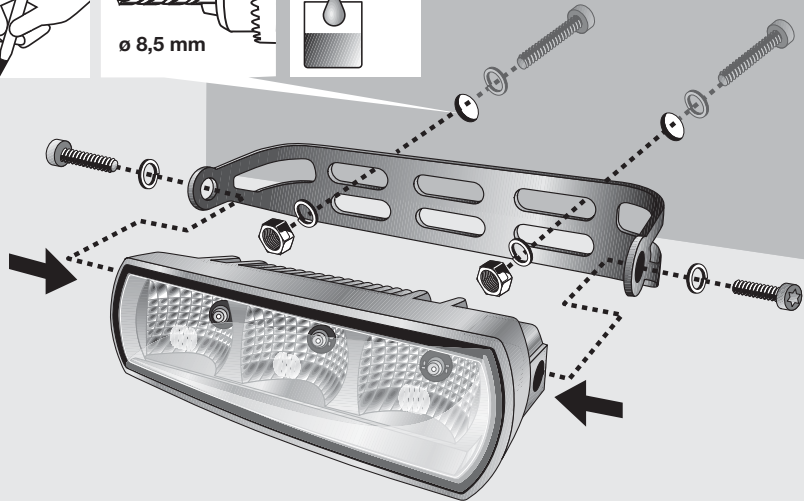
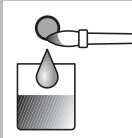
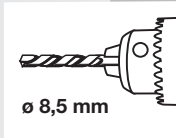

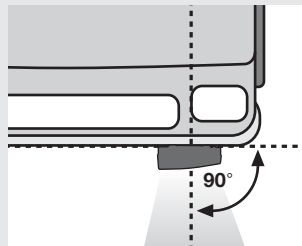
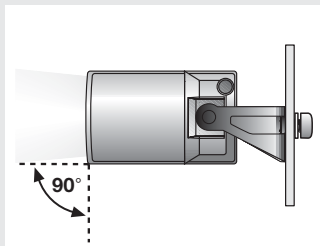
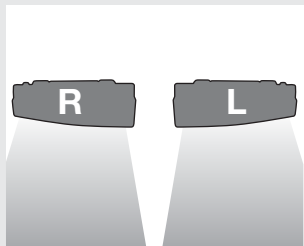

**Electrical connection  
Page 3**

Lay and connect the cables in accordance with the connection diagram.

According to the connection diagram, the daytime running lights are switched on automatically with the ignition.

**Caution!****Daytime running lights**

- are **not** a substitute for low beam at dawn/dusk or during darkness.
- they shine only when the vehicle lighting is switched off and the ignition is switched on.
- they switch off **automatically** when switching on the vehicle lighting.

- are approved in accordance with ECE R87.
- may be fitted in accordance with EC Directive EC R97/28 and ECE R48.

We recommend that the installation instructions are carried along with the vehicle documentation.

**Installation  
Page 4**

Determine the installation position and mark the fastening points.

Pre-drill using a 3 mm drill bit and drill out to 8,5 mm.  
Seal drilled metal parts with rust protection agent.

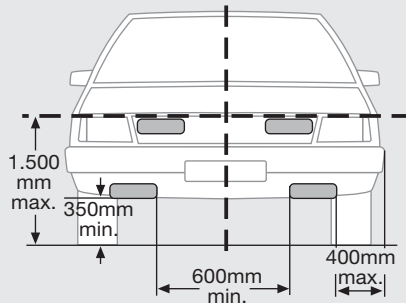

**Function**  
**LED Daytime running light**

<b>Input, daytime running light</b>	<b>Input, position light</b>	<b>Function of the light</b>	
0 V	0 V	Light	off
0 V	Supply voltage	Light	off
Supply voltage	0 V	Daytime running light	active
Supply voltage	Supply voltage	Daytime running light	off

<b>Supply voltage</b>	<b>Input, daytime running light</b>
12 V	< 360 mA, < 5 W
24 V	< 360 mA, < 11 W
Operating temperature range -40 °C to +50 °C	Protective class IP 6K 9K (splashproof and dustproof)