

PART #	DESCRIPTION
57805CP	05-UP TACOMA 0-1.5" REAR 2.5 VS RR CDCV PAIR

COMPONENTS INCLUDED	
(2) 154966C 05+ TACO REAR 2.5 RR CDCV (2) 611007 MED DUTY 9/16" STEM BUSHING KIT	(2) 250002 7.50 UNIVERSAL RESI MT PLATE (1) 611051 #40 2 1/16-3" HOSE CLAMP KIT (4)
HARDWARE INCLUDED	
(2) 605131 3/8 SPLIT LOCK WASHER GR8 (2) 257151 LOWER HEIM SPACER	(2) 605144 3/8-12 X .750 FLANGED SELF TAP BOLT
611007 HARDWARE KIT	
(2) 9/16" ID STEM BUSHING (1) 12MM ID STEM WASHER	(1) 9/16" ID STEM WASHER (1) M12-1.25 NYLOCK NUT
611051 HARDWARE KIT	
(4) 605931 1/2 X 2 1/16 - 3 ID #40 SS HOSE CLAMP	
TOOLS REQUIRED	
JACK JACK STANDS DRILL CENTER PUNCH 21/64 DRILL BIT LOCKING PLIERS	5/16" SOCKET / WRENCH 9/16" SOCKET / WRENCH 14MM SOCKET / WRENCH 15MM SOCKET / WRENCH 17MM SOCKET / WRENCH 19MM SOCKET / WRENCH TORQUE WRENCH
TECH NOTES	
<p>1. YOUR ICON SHOCK ASSEMBLIES COME FACTORY CHARGED TO 150 PSI. RELEASING NITROGEN PRESSURE MAY LEAD TO SHOCK MALFUNCTION AND REDUCED RIDE QUALITY. FAILURE CAUSED BY LOW NITROGEN PRESSURE IS NOT COVERED UNDER ICON'S WARRANTY POLICY.</p> <p>2. IF YOUR VEHICLE IS TWO OR MORE INCHES TALLER THAN STOCK, RIDE QUALITY WILL DIMINISH.</p>	



WARNING!
<p>** READ ALL INSTRUCTIONS THOROUGHLY FROM START TO FINISH BEFORE BEGINNING INSTALLATION! IF THESE INSTRUCTIONS ARE NOT PROPERLY FOLLOWED SEVERE FRAME, SUSPENSION AND TIRE DAMAGE MAY RESULT TO THE VEHICLE!</p> <p>** ICON VEHICLE DYNAMICS RECOMMENDS THAT YOU EXERCISE EXTREME CAUTION WHEN WORKING UNDER A VEHICLE THAT IS SUPPORTED WITH JACK STANDS.</p> <p>** ICON VEHICLE DYNAMICS RECOMMENDS ALL INSTALLTION TO BE PERFORMED BY A PROFESSIONAL SHOP/SERVICE TECHNICIAN. PRODUCT FAILURE CAUSED BY IMPROPER INSTALLATION WILL NOT BE COVERED UNDER ICON'S WARRANTY POLICY.</p>

INSTALLATION

- Using a properly rated jack, raise the rear of the vehicle and support the frame rails with jack stands. Ensure the jack stands are secure and set properly before lowering the jack. NEVER WORK UNDER AN UNSUPPORTED VEHICLE. Remove the rear wheels.
- Place a floor jack under the axle housing and slightly raise the jack to remove tension from the shock. Loosen and remove the lower shock bolt using a 17mm socket/wrench. Make sure the axle is well supported, then remove the stem bushing nut and upper stem bushings using a 17mm socket/wrench.
- Remove the rear shock.
- Install the lower shock mount in the factory location with the supplied misalignment spacers (257151) and reinstall the factory shock bolt and nut using a 17mm socket/wrench. [Torque to factory spec]
- Use a jack to raise the axle housing far enough to guide the shock stem into position in the factory shock mount. Install stem hardware as seen in diagram. Use a 19mm socket/wrench to install the lock nut until lock is engaged. Do not overtighten bushing assembly as this can lead to premature bushing wear. Failure caused by incorrect installation of bushings is not covered under ICON's warranty policy.

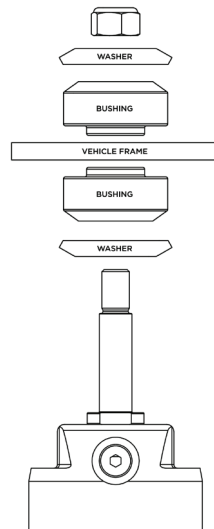

6. Mount the remote reservoir to the reservoir mount plate (250002) using the provided (605931) hose clamps. Be sure to install the hose clamps to the ends of the reservoir within the machined areas on the outer surface of the remote reservoir.

NOTE: Step 6 is just for mockup of reservoir mounting. The reservoir must be removed from the bracket before final installation to allow for adequate clearance while fastening to the frame rail.

7. Orient the reservoir mounting bracket on the frame rail and mark the center of the hole. The remote reservoir and bracket should not come in contact with any part of the frame or frame brackets. **[FIGURE 1]** **NOTE:** Be sure to allow adequate slack in the reservoir hose (before mounting the bracket) so that it does not create tension as the suspension cycles.

FIG.1



8. Center punch and drill to 21/64". **[FIGURE 2]**

FIG.2



9. Thread the supplied (605144) self tap bolt into the frame rail using a 9/16" socket/wrench, minimum of 2 full rotations.

10. Remove the (605144) self tap bolt and secure the remote reservoir bracket using a 9/16" socket/wrench. [Torque to 30ft-lbs]

11. Place reservoir in the reservoir mounting bracket with the ICON shield logo oriented up into the fender well and secure reservoir with the supplied (605931) hose clamps using an 5/16" nut driver.

12. Repeat steps 2-11 on opposite side.

13. Install wheels and lower vehicle back to the ground. [Torque to factory spec]

VERIFY ALL FASTENERS ARE PROPERLY TORQUED BEFORE DRIVING VEHICLE.

RETORQUE ALL NUTS, BOLTS AND LUGS AFTER 100 MILES AND PERIODICALLY THEREAFTER.

