

PART #	DESCRIPTION
216530	14-UP RAM HD 4.5" FRONT LIFT 2.0 VS IR

COMPONENTS INCLUDED	
(1) 214918 14+ RAM HD 4.5" FRONT 2.0 IR	(1) 611006 9/16 HD STEM BUSHING KIT
HARDWARE INCLUDED	
611006 HARDWARE KIT	
(2) 255200 STEM BUSHING 9/16 ID (2) 254200 9/16 STEM WASHER	(1) 605809 M12-1.25 JAM NUT (1) 605810 M12-1.25 NUT
TOOLS REQUIRED	
JACK JACK STANDS TORQUE WRENCH	19MM WRENCH (X2) 21MM SOCKET / WRENCH
TECH NOTES	
<p>1. YOUR ICON SHOCK ASSEMBLY COMES FACTORY CHARGED TO 180 PSI. RELEASING NITROGEN PRESSURE MAY LEAD TO SHOCK MALFUNCTION AND REDUCED RIDE QUALITY. FAILURE CAUSED BY LOW NITROGEN PRESSURE IS NOT COVERED UNDER ICON'S WARRANTY POLICY.</p> <p>2. ICON 4.5" BOX KIT (214205) IS REQUIRED FOR INSTALLATION OF SHOCKS.</p> <p>3. ICON 4.5" COIL SPRING KIT (218410) IS REQUIRED FOR INSTALLATION OF SHOCKS.</p>	



WARNING!
<p>** READ ALL INSTRUCTIONS THOROUGHLY FROM START TO FINISH BEFORE BEGINNING INSTALLATION! IF THESE INSTRUCTIONS ARE NOT PROPERLY FOLLOWED SEVERE FRAME, SUSPENSION AND TIRE DAMAGE MAY RESULT TO THE VEHICLE!</p> <p>** ICON VEHICLE DYNAMICS RECOMMENDS THAT YOU EXERCISE EXTREME CAUTION WHEN WORKING UNDER A VEHICLE THAT IS SUPPORTED WITH JACK STANDS.</p> <p>** ICON VEHICLE DYNAMICS RECOMMENDS ALL INSTALLTION TO BE PERFORMED BY A PROFESSIONAL SHOP/SERVICE TECHNICIAN. PRODUCT FAILURE CAUSED BY IMPROPER INSTALLATION WILL NOT BE COVERED UNDER ICON'S WARRANTY POLICY.</p>

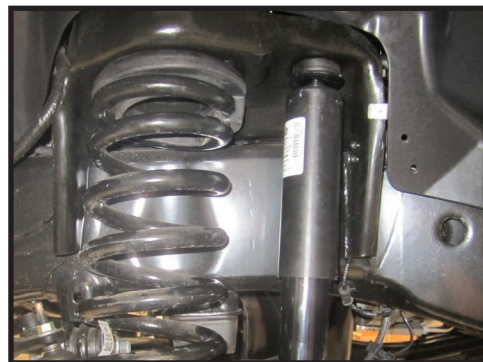
INSTALLATION

- Using a properly rated jack, raise the front of the vehicle and support the frame rails with jack stands. Ensure the jack stands are secure and set properly before lowering the jack. NEVER WORK UNDER AN UNSUPPORTED VEHICLE. Remove front wheels.
- Support the front axle with a jack. Loosen the driver side lower shock mount using a 21mm socket/wrench. Loosen the upper shock mount using a 19mm socket/wrench. Slowly lower jack until the stem is free from the upper shock mount and remove shock. [FIGURE 1 & 2]

FIG.1

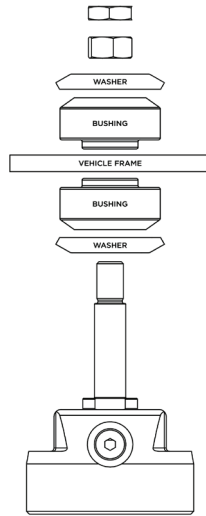


FIG.2



3. Install stem hardware as seen in diagram. Install (605810) tall nut and fasten bushing assembly until 3-4 threads are exposed for the (605809) jam nut. Install (605809) nut and torque to 50 ft-lbs while holding (605810) with a 19mm wrench. Do not overtighten bushing assembly as this can lead to premature bushing wear. Failure caused by incorrect installation of bushings is not covered under ICON's warranty policy.

NOTE: Tightening the upper shock stem nut before installing the lower bolt will increase the difficulty of lower bolt installation due to the way the radius arm swings as the suspension cycles down. Wait to tighten the upper shock stem nut until the lower mount has been installed.



4. Use a jack to raise the axle enough to allow for proper alignment of the lower shock mount. Install factory shock bolt and tighten using a 21mm socket/wrench. [Torque to factory spec] [FIGURE 3]

FIG.3



FIG.4



5. Fasten the supplied (605810) large nut until 2-3 threads are showing and then install the supplied (605809) thin jam nut to lock it against the tall nut. [Torque the jam nut to 50ft-lbs] [FIGURE 4]

NOTE: Over tightening the large stem nut will cause too much bushing preload which will cause premature wear on internal shock components and also effect vehicle ride characteristics.

11. Repeat steps 2-5 on the passenger side.

12. Install wheels and lower vehicle to the ground. [Torque to factory spec]

VERIFY ALL FASTENERS ARE PROPERLY TORQUED BEFORE DRIVING VEHICLE.

RETORQUE ALL NUTS, BOLTS AND LUGS AFTER 100 MILES AND PERIODICALLY THEREAFTER.

2.0 ALUMINUM SERIES TECHNICAL INFORMATION

MAINTENANCE

ICON shock absorbers are a high quality rebuildable race style shock absorber designed for optimal performance. With a unit of this caliber on your vehicle, routine maintenance is required to keep them looking and operating in like new condition. Residual oil and assembly lube may be present at all seal paths from the factory out of the box and is considered normal. Pooling of oil however is not acceptable at any time and one should contact the ICON dealer where purchased.

BELOW ARE GUIDELINES BASED ON HOW YOU USE YOUR VEHICLE BUT YOUR MILEAGE MAY VARY:

STREET USE:

- Send in for factory servicing every 40,000 miles or if a leak develops, ride quality decreases, or they begin to make excessive noise.
- Remove any buildup of road salt, mud, or debris from shocks anytime accrued
- Clean with mild soap and water with each oil change or anytime you notice build up.
- Wax the cylinders yearly with automotive wax to prevent corrosion.
- Check nitrogen pressure yearly. (252004 charge needle assembly available at any ICON distributor)

STREET/DIRT:

- Send in for factory servicing every 15,000 miles or if a leak develops, ride quality decreases, or they begin to make excessive noise.
- Clean with mild soap and water with each oil change, offroad trip, or anytime you notice build up.
- Wax the cylinders yearly with automotive wax to prevent corrosion.
- Check nitrogen pressure each dirt outing. (252004 charge needle assembly available at any ICON distributor)

DIRT USE:

- Send in for factory servicing every 1,000 miles.
- Check nitrogen pressure each outing. (252004 charge needle assembly available at any ICON distributor)
- Remove any buildup of mud or debris from shocks after every outing.