



INSTALLATION INSTRUCTIONS

PART No. 30532

MODEL No.

Light Brackets

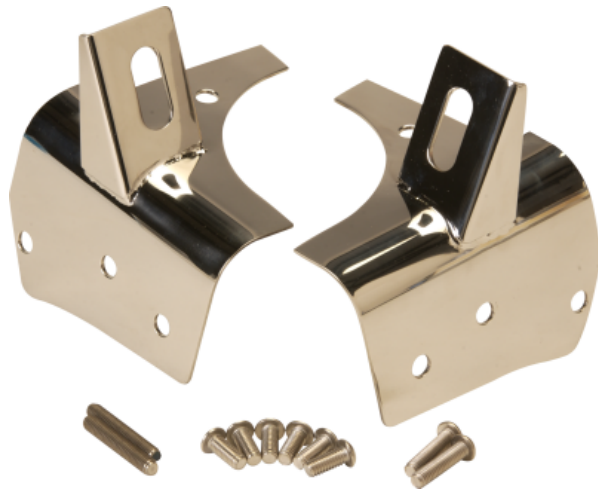

Remove the five bolts on the upper portion of the windshield hinge. Place the Light Bracket over the upper hinge and align the holes. Using the Stainless bolts provided start all five bolts then tighten evenly.



INSTALLATION INSTRUCTIONS

PART No. 30532

MODEL No.

Light Brackets

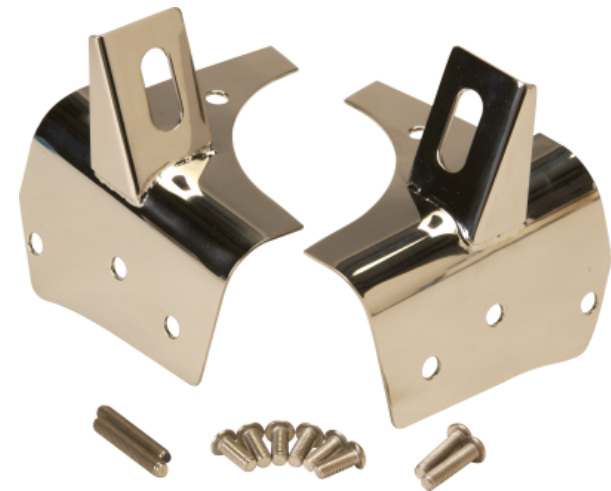

Remove the five bolts on the upper portion of the windshield hinge. Place the Light Bracket over the upper hinge and align the holes. Using the Stainless bolts provided start all five bolts then tighten evenly.