

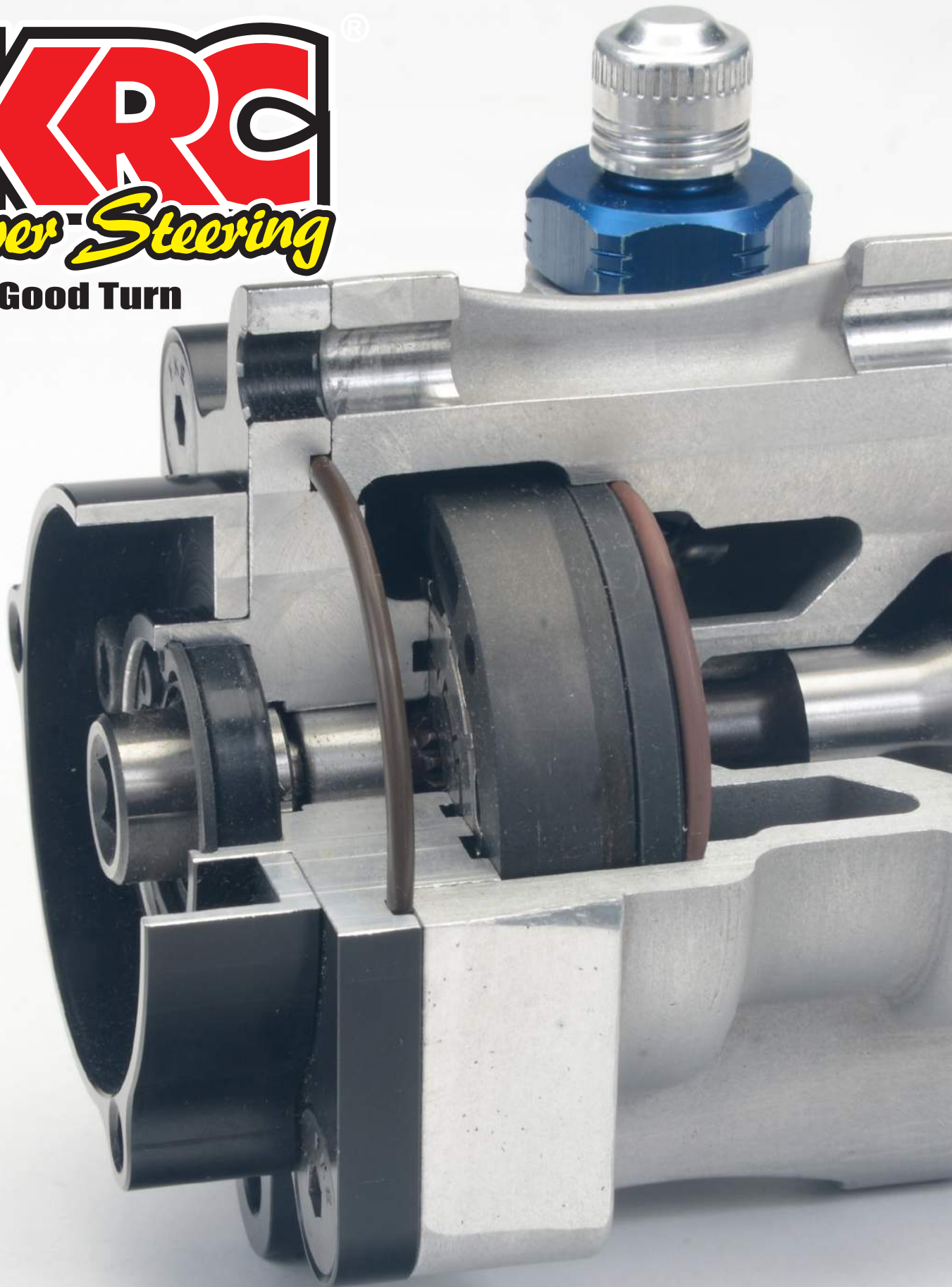

**A Good Turn**



**2018 Catalog**

Dear Loyal KRC Customers,

KRC has been designing and manufacturing cutting edge power steering and serpentine pulley systems since 1997. We pride ourselves in providing the highest quality product available complimented with dedicated service. We spend countless hours researching and developing every aspect of our products. From the machine finish and anodizing, to fit and placement, to the smallest of hardware particulars. KRC takes into consideration the needs of the market utilizing continual feedback from our loyal customers helps us to ensure that all of our products assemble and perform as they should. If you have an idea for a new product, or a way to improve an existing item, we would welcome your input.

Please browse our catalog and read up on all of our new and innovative products. We hope you will notice how the employees of KRC Power Steering create products that provide reliability that you can count on.

I would like to personally thank all of our valued customers. We value your trust in KRC products and you can always count on us to give you the commitment in providing the best product available.

Thank you for your continued support.

Best regards,

*Kenneth C. Roper*

President



KRC Power Steering designs & manufactures our products at our state of the art facility in Georgia. Investing in Mori Seiki CNC machines, lasers, 3D Printers, CAD/CAM & in house engineering results in great products.



## Featured New KRC Products

### KRC Power Steering Coyote Tank



KRC Engineers set out to solve the problem of mounting a power steering reservoir tank on the Ford Coyote Engine. Our unique design fits snugly under the head for a clean fit and easy install. Available with both our KRC Pro Series III & Elite Series Pumps.

### KRC Pro Series III Power Steering Pumps

KRC Pro Series III Power Steering Pumps are the ultimate in power steering technology. 9 levels of Adjustable Feel give you the tools to tailor the steering system for any track or driver. We designed our Pro Series III Pumps from the ground up to be the very best power steering pump money can buy. KRC Pumps are the choice of professional race teams worldwide.



### 9 Levels of Driver Feel Adjustment

**All New!**

### KRC Elite Series Power Steering Pumps

#### Affordable Short Track Quality

You asked for it and we made it! The All NEW KRC Power Steering Elite Series Pumps are perfect for Short Track Racers & High Performance Enthusiasts.

Direct bolt on replacement for racing GM Saginaw style pumps.



# Featured Products



**KRC Power Steering Fluid 6 Pack Case**



**KRC Power Steering Fluid Quart**



**10 - Rib System**



**KRC MicroFin Power Steering Cooler**



**KRC Remote Filtered Power Steering Reservoir**



**All New!**



**KRC Pro Series III Power Steering Pumps**

The choice of professional race teams worldwide.  
Fully Adjustable  
Saves 4 to 6 HP!

**NEW KRC ELITE SERIES POWER STEERING PUMPS**

Affordable KRC Quality. 9.6CC & Fully Adjustable  
Saves 4 to 6 HP!

## Power Steering Pumps and Accessories

Aluminum Power Steering Pumps . . . . .	6
Bellhousing Mounted . . . . .	9
Shaft Drive/ PTO . . . . .	10
Aluminum Pump Accessories . . . . .	11
Aluminum Power Steering Pump Kits . . . . .	12
Shaft Drive Adapters . . . . .	14
Cast Iron Pump . . . . .	16
Cast Iron Pump Kits and Accessories . . . . .	17
Flow Fittings . . . . .	20
Reservoir and Surge Tanks . . . . .	21
Power Steering Pump Brackets . . . . .	22
Cooling System Components . . . . .	26
Spacers . . . . .	27

## Engine Kits

### Chevrolet Engine Kits

#### SB Chevrolet Engine Kits

Basic Kits . . . . .	28
Add-Ons . . . . .	30
Small Block Chevy and Crate Engine Kits . . . . .	31
Water Pump Drive Only Kits . . . . .	35
HTD Kits . . . . .	38

#### LS Chevrolet Engine Kits

CT525 Pavement Kits . . . . .	39
CT525 Dirt Kits . . . . .	40
Alternator Add-Ons and Water Pump Drive Only Kits . . . . .	42
CT525 Accessories . . . . .	44
LS Truck Power Steering Kits . . . . .	45
F-Body/Y-Body Front Engine Kits . . . . .	46
LS Idler-Tensioners . . . . .	47

### Ford Engine Kits

D347SR & S347JR Short Deck Kits . . . . .	48
S374W Tall Deck Kits . . . . .	49
Water Pump Drive Only Kits . . . . .	50
HTD Kits (Short and Tall Deck) . . . . .	52
Boss 302 Coyote Kit . . . . .	55

### Dodge Engine Kits

#### Serpentine Pulley Kits

Chevrolet and Dodge Serpentine Pulley Kits . . . . .	56
Chevrolet Water Pump Drive Only Pulley Kits . . . . .	57
Ford Serpentine Pulley Kits . . . . .	58

#### Idler/Tensioner Pulley Kits

. . . . .	59
-----------	----

## Pulleys and Accessories

### R-Lok Pulleys

Modular Pulley Systems . . . . .	60
Crank Pulleys . . . . .	62

### Pump Pulleys

Aluminum Pump Pulleys . . . . .	64
Cast Iron and GM Press-On Pulleys . . . . .	65
HTD Dry-Sump Pulleys . . . . .	66

### Water Pump Pulleys

. . . . .	68
-----------	----

### Alternator Pulleys, Brackets and Accessories

. . . . .	70
-----------	----

### Bellhousing Alternator Brackets

. . . . .	72
-----------	----

### Aeroquip

. . . . .	73
-----------	----

## Technical Data

### Belts and Belt Chart

. . . . .	74
-----------	----

### Flow Fittings

. . . . .	76
-----------	----

### Dimensions

. . . . .	78
-----------	----

### Water Pump Tech

. . . . .	80
-----------	----

# THE LIGHTEST PULLEY SYSTEM

THUS THE LEAST AMOUNT OF ROTATING WEIGHT



**FOR CHEVY**  
Chevy Left Side Late Model  
With Pro Series III Pump  
KIT16612115

W/ Elite Series Pump  
KIT166XXXXX

NEW KRC alternator bracket moves the alternator assembly weight (7.5lbs) to the left of the racecar centerline.

## NEW Late Model Front Drive Kits



**FOR FORD**

Ford Head Mount  
KIT 67347120

W/ Elite Series Pump  
KIT67XXXXX

**FOR CHEVY** Kits include:

- Pro Series III power steering pump with bolt-on tank (Elite Series power steering pump Optional)
- Denso 138mm heavy-duty alternator
- CNC-Machined, hard anodized pulleys & brackets
- Hardware and belts
- CNC-Machined water pump (for Chevy kit)

**for use with 604 Crate Engines,  
Dirt Late Models, Modifieds  
& Street Stocks**

**CHEVROLET KITS FEATURE  
A 12.5% PULLEY RATIO—  
IMPROVING COOLING & WATER  
PUMP LONGEVITY.**



**Chevy  
604 Front  
Drive  
Pulley  
System  
16322600**

**Chevy Front Drive Kit:**

- KRC Chevy tensioner & bracket
- Water pump & head mount bracket kit
- Hard anodized power steering pulley, water pump pulley, crank pulley & crank hub adapter
- Assembly hardware & belt

*Engineered, machined, &  
assembled in the USA*

*Power steering pump and alternators available for  
front and rear drive applications*

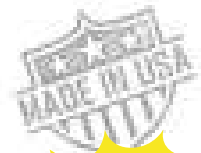

**All  
New!**

## NEW! Coyote Tank



KRC  
91415000



- Designed to fit neatly under the Coyote head
- Fits Pro Series III & Elite Series Pump
- Full capacity for optimal performance
- Bolt-on flange for a perfect seal



# NEW PUMPS LOWER PRICING

FROM THE QUALITY  
EXPERTS AT KRC

All  
New!

## Elite Series Pump

ESP 10096000

- Affordable KRC quality
  - Press-on pulleys
  - Compact durability
  - Feel adjustable



## KRC Power Steering Pump

- Adjustable flow control technology
- 9 Driver feel adjustments from firm to light
- AN fittings standard
- In-house precision design & manufacturing
- Approved by NASCAR

## Pro Series III Pump

2.58 LBS

- Saves 4 to 6 HP
- *Formula One*-style lubricated sealed roller bearings
- Splined pulley shaft
- Serial numbered & Dyno tested

PS3 29116813



Shown with  
optional  
reservoir



PSF 10032001  
(Quart)

## KRC Power Steering Fluid

- Lower running temps
- Prevents cavitation & foaming
- Extends system life



**KRC**<sup>®</sup>  
Power Steering

# BELL HOUSING MOUNTED COMBINATION FUEL PUMP, POWER STEERING PUMP AND ALTERNATOR ALL IN ONE COMPACT PACKAGE.



3/8" hex drive  
pump:  
Pump part #  
PS3 29326251



Alternator add-  
on kit: Part #  
KRC 40964000  
Alternator sold  
separately.

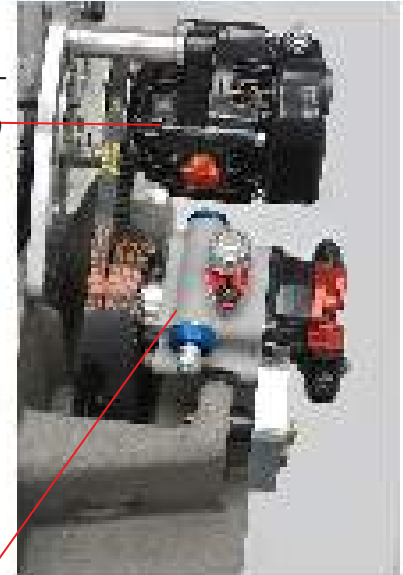

## Rear-mount application

Stand alone rear-mount with pulley driven power steering/fuel pump combo or run off the back of a dry-sump pump. Alternator Kit sold separately.

**Hex-Drive Power Steering/Fuel Pump Combo**  
for dry-sump applications & gas-powered sprint cars. Combo Pump weighs only 3.34 lbs. Mount at the rear of the engine to improve Center of Gravity balance. The KRC pump-combo stays with the bell housing resulting in ultra-quick engine swaps.

Also available in 17-spline drive and 17-spline pulley drive.



Engineered,  
machined, &  
assembled in  
the USA

Pump part #  
PS3 29126251

## NEW! Power Steering/Fuel Pump Combo Operates at front or rear of engine.



## Front-mount application

IMCA  
steering pump with fuel  
pump combo. Ideal  
addition for new 10-  
rib water pump drive  
system.

Complete IMCA  
add-on pump kit  
w/tank:  
KIT 16122810

10-Rib pulley  
system w/  
water pump:  
KIT 16122610



KRC 91150000



## RESERVOIR TANK W/ 115 Micron Filter

- Filter extends power steering system life
- Added volume cools fluid
- Easy mounting



# BELT SLIP?

## KRC'S NEW 10-RIB OFFERS 100% MORE CONTACT.

### Did you know Super Late Model fan belts slip twice on every lap?

Examine your current pulley system. If the coating has vanished you are likely experiencing chronic belt slippage.

Engine deceleration causes the fan rotation to drop nearly instantly from around 7800 to 3500rpm. Sudden deceleration occurs twice a lap resulting in belt slippage and premature wear.

KRC resolved the problem with a unique 10-rib belt constructed with Kevlar cords that offers 100% more surface contact than previously available.

"Driving the fan has not been the problem," says KRC President Ken Roper, "slowing it down in an instant is the cause of belt slippage and pulley wear. Deceleration forces are usually more than a five- or six-rib serpentine belt system can control."

#### KIT 16122600 - Components

KRC 38140505 10-Rib Pro R-LOK Crank adapter  
 KRC 38240410 10-Rib Crank pulley, 4.0"  
 KRC 38025510 10-Rib X 5.0" SBC Water  
 Pump pulley  
 GDY 272K10KRC 10-Rib X 27.2" Belt

**NEW!**



Engineered,  
 machined, &  
 assembled in  
 The USA



10-rib Water  
 Pump Drive  
 Kit 16122600

- Greater belt strength using Kevlar cords & superior belt design
- 100% greater surface contact between belt & pulleys
- Hard anodized water pump pulley, crank pulley & crank hub
- Assembly hardware & detailed installation instructions included
- Use in conjunction with an IMCA dual pump system (KIT 16122810)



KRC 95120606

#### Compact Power Steering/Transmission Cooler

- Easy mounting
- Lightweight micro fin cooling
- Great for power steering – transmissions & rear ends



# ALUMINUM POWER STEERING PUMPS

## NEW! PRO SERIES III: USES 50% LESS HORSEPOWER THAN COMPARABLE PUMPS YET WEIGHS ONLY 2.58 LBS.

- The New KRC Pro Series III Aluminum Power Steering Pump is unquestionably the most important development in it's field for 2017. The Pro Series III Pump is available in three volumes; 5.9cc, 7.2cc & 9.6cc. KRC Pro Series III Pumps consume 50% less horsepower than other brands.
- The new Pro Series III Pump offers our KRC flow control fittings to fine tune the driver's feel. KRC Adjustable Flow Technology offers 9 levels of adjustable feel from firm to light to optimize driver feel.
- KRC has three different shaft styles to choose from. Our Splined Shaft is most common facilitating our conventional pulley and retaining nut. KRC Pro Series III utilizes traditional pulley offsets with a 80mm bolt pattern. KRC Pro Series III Pumps have a splined shaft for a more positive drive and ease of replacement. Optionally, a 17 Spline Drive & a 3/8 Hex Nut Shaft are available.

### Pro Series III Pump Features - 9 Levels of Adjustable Feel Unrivaled steering feel

Available in three pump volumes:  
5.9cc, 7.2cc & 9.6cc

#### Popular Pump Only Part Numbers

**PS3 26116811**  
5.9CC Pro Series III Pump Only

**PS3 27116811**  
7.2CC Pro Series III Pump Only

**PS3 29116811**  
9.6CC Pro Series III Pump Only  
Above Pump Part Numbers are:  
Pulley Drive, Left/Up -6 Outlet,  
1600 PSI Aluminum Flow Fitting,  
Std. Flow Fitting Size, Flat Cover,  
-10 AN Inlet

Approved for competition  
by NASCAR®

All of the Pro Series pumps are available with an 8 oz. bolt-on tank. By changing the last digit in the part number from a "1" to a "3" specifies a bolt-on tank instead of a -10 fitting.

#### Available Options

Pro Series III Pumps are available as a pump only or with a Bolt-On Tank. For Example: Change PN# 26116811 to 26116813

You may order the KRC Adjustable Flow Valve of your choice in a new factory pump. Simply change the PN# 26116811 to reflect your Flow Valve choice.



### Pro Series III Pump Pulleys sold separately

KRC Pro Series III Power Steering Pumps are relied upon by multiple NASCAR® teams.

KRC Pro Series III Power Steering Pumps come Standard W/ 17 Spline & Threaded Shaft for Pulley. Pulley Sold Separately. STD -10 Inlet W/ STD -6 Flow Control Fitting



Hard-coat anodized rear cover for longer pump life

9 Adjustable Flow Valves  
optimal driver feel.

Simply change the specialized KRC Flow Control Valve & easily adapt driver feel from Bristol to Talladega.



Machined & Assembled in the USA

# ALUMINUM POWER STEERING PUMPS WITH TANKS

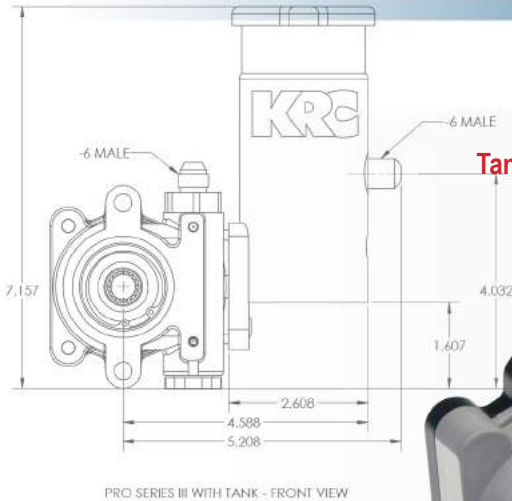

PRO SERIES III WITH TANK - FRONT VIEW

- PS3 26116813 - 5.9CC
- PS3 27116813 - 7.2CC
- PS3 29116813 - 9.6CC

Tanks are Available Separately



## Aluminum Power Steering Pumps with Bolt-on Tanks

Pro Series pumps are available with an 8 oz. bolt-on tank. Changing the last digit in the part number from a "3" to a "1" specifies a -10 inlet fitting instead of a bolt-on tank.

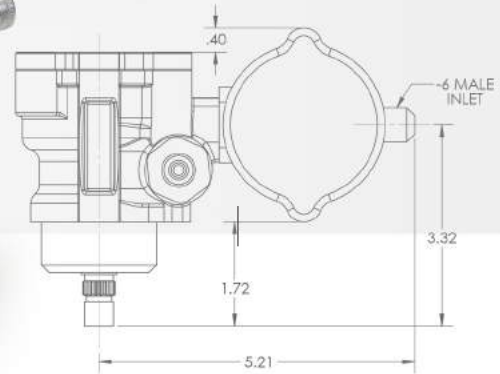

PRO SERIES III WITH STANDARD TANK - TOP VIEW

## KRC'S OBERG FILTERED RESERVOIR

### NEW! The first filtered power steering reservoir of its kind.

Though small, they are often placed in the inlet and outlet ports of power steering reservoirs, we made the tank with a 4in, 115-micron filter screen.

Filtering ensures clean oil is conveyed to the power steering pump free of restriction at the inlet.

Perfect for sand rails, rock crawlers, mud & desert racing vehicles. Ideal for short track oval dirt cars, off-road trucks & Monster trucks. Pavement racers can now protect competition power steering pumps & the steering gearbox. The 115 Micron filter eliminates dust, dirt and all contaminants in any vehicle increasing performance & reliability.

### Filtering at full flow

Reservoir swivels 360° to route the return line in any direction



**KRC 91150000**  
115 Micron Filtered Reservoir

Two-piece canister measures 4.5in diameter & 4.5in tall with a 4in 115-micron screen between each half.

Equipped with -8AN O-ring side port & -12AN O-ring port in bottom allowing the return fitting sizes -6AN or -8AN male. Outlet sizes are available in -10AN or -12AN male.

Deaerates return oil supply by discharging around inner wall perimeter.

Operates between 15 & 20 psi.

# KRC Pro Series III Power Steering Pumps

## KRC Adjustable Flow Technology

Adjust the KRC Flow Valves to quickly adjust fluid flow for optimal driver steering feel from firm to light. 9 levels of adjustment create the perfect feel for every driver & track.

Simply change the specialized KRC Flow Control Valve & easily adapt steering feel from Bristol to Talladega.

Rear Cover is Hard Coat Anodized for superior pump life.



## Pro Series III Pump - 9 Levels of Adjustable Feel!!!

*Sealed Bearings W/ Grease Developed in F1  
High Temp Viton Seals  
Lost Wax Casting Process  
9 Levels of Feel Adjustment*



**Engineered Performance**



**KRC Power Steering has simplified The process of Optimizing Driver Steering Feel**

KRC Power Steering has engineered a range of Changeable Flow Control Valve Fittings for KRC hydraulic steering pumps.

9 different KRC Flow Control Valves optimize steering feel to match driver preference in any condition or at any track.

The Flow Control Valves can be compared to the function of jets in a carburetor. By adjusting flow rates from 4 to 12 liters per minute, approximately 1 to 3 gallons, the largest Flow Valve provides maximum steering assistance while the smallest provides less assist while maximizing steering feel.

The standard KRC Flow Valve flows 8 liters per minute from the pump. Larger Flow Control Valves, B, C, D, or E, increases the flow rate in 1 liter increments up to 12 liters per minute (3.17gals).

The higher letter gives more hydraulic assistance, although less feel. In contrast, Flow Valves marked 4, 5, 6 & 7 provide less assistance; the lower the number, the greater the feel but the less assistance.



# KRC Pro Series III Power Steering Pumps

## Aluminum Power Steering Pumps with Bolt-on Tanks

All of our Pro Series pumps are available with an 8 oz. bolt-on tank. In the part number, changing the 6th digit from the left from a "1" to an "3" will give you a bolt-on tank instead of a -10 inlet fitting.



### Popular Pump W/Tank Part Numbers

#### PS3 26116813

5.9CC Pro Series III Pump with Bolt-On tank.

#### PS3 27116813

7.2CC Pro Series III Pump with Bolt-On tank.

#### PS3 29116813

9.6CC Pro Series III Pump with Bolt-On tank

Pulleys Sold Separately

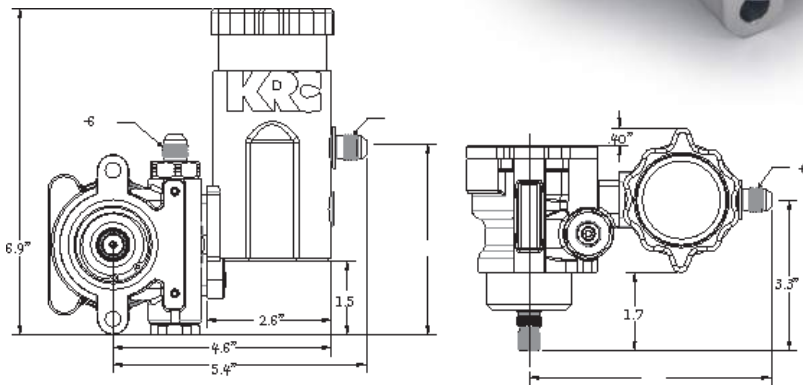

KRC Pro Series III Power Steering Pumps come Standard W/ 17 Spline & Threaded Shaft for Pulley. Pulley Sold Separately. STD -10 Inlet W/ STD -6 Flow Control Fitting

## Pro Series III Configurations

PS3 26116211	5.9CC PRO SERIES-III PUMP "E"	PS3 29116231	9.6CC MARINE PUMP LH
PS3 26116811	5.9CC PRO SERIES-III PUMP Only -10 IN -6 FLOW	PS3 29116811	9.6CC PRO SERIES-III PUMP Only -10IN -6 FLOW
PS3 26116813	5.9CC PRO SERIES-III PUMP Bolt-On Tank -10 IN -6 FLOW	PS3 29116813	9.6CC PRO SERIES-III PUMP Bolt-On Tank -10 IN -6 FLOW
PS3 26116814	5.9CC PRO SERIES-III PUMP	PS3 29116814	9.6CC PRO SERIES-III PUMP
PS3 26116821	5.9CC PRO SERIES III PTO	PS3 29116821	9.6CC PRO SERIES III PTO
PS3 26456211	5.9CC FOR PRESS-ON PULLEY	PS3 29126231	9.6CC MARINE PUMP RH
PS3 27114911	7.2CC PRO SERIES-III PUMP	PS3 29126811	9.6CC PRO SERIES-III PUMP RH
PS3 27116211	7.2CC PRO SERIES-III PUMP "E"	PS3 29126821	9.6CC PRO SERIES III PTO RH
PS3 27116811	7.2CC PRO SERIES-III PUMP Only -10 IN -6 FLOW	PS3 29136231	9.6CC LH HARD-ANODIZED MARINE PUMP
PS3 27116813	7.2CC PRO SERIES-III PUMP Bolt-On Tank -10 IN -6 FLOW	PS3 29216811	9.6CC PRO SERIES III PUMP
PS3 27116814	7.2CC PRO SERIES-III PUMP	PS3 29216821	9.6CC PRO SERIES III PTO
PS3 27216211	7.2CC PRO SERIES III PUMP	PS3 29316221	9.6CC PRO SERIES III PTO "E"
PS3 27216811	7.2CC PRO SERIES III PUMP	PS3 29316811	9.6CC PRO SERIES III PUMP
PS3 27226811	7.2CC PRO SERIES III PUMP RH 17-SPLINE	PS3 29316821	9.6CC PRO SERIES III PTO
PS3 27236211	7.2CC PRO SERIES III PUMP "E" FLOW	PS3 29316822	9.6CC PRO SERIES III PTO 90
PS3 27326011	7.2CC 3/8-HEX PRO SERIES III PUMP "C"	PS3 29456211	9.6CC FOR PRESS-ON PULLEY
PS3 27456211	7.2CC FOR PRESS-ON PULLEY		

# SHAFT DRIVE/PTO ALUMINUM PUMPS

## KRC Pro Series III Aluminum Shaft Drive & PTO Power Steering Pumps

are all high volume 9.6cc capacity.

Dry-sump oil pump-mounted applications, 3/8in hex drive or 17-spline are available.

**Choose a required pump adapter for all Shaft Drive Pumps**



### Why choose a 17-spline pump?

The industry standard input shaft is a 3/8in hex - KRC has developed a 17-spline alternative. Our design promotes greater shaft & spud-drive life compared with a 3/8in hex shaft. More contact points produces stronger engagement. A 17-spline drive spud (KRC 19570000) is required to connect the dry-sump pump.



**PS3 29216811**  
PRO SERIES III PUMP  
- 17-SPLINE DRIVE



**PS3 29316811**  
PRO SERIES III  
PUMP - 3/8in HEX  
DRIVE W/ -10  
straight inlet fitting



**KRC 21200090**

The KRC -10, 90° inlet rotates 360°. Provides plumbing in tight areas. Includes O-ring seal & Allen head bolts. Fits Pro Series III, Elite Series & KRC Cast Pumps.

KRC proven 9.6cc aluminum power steering pumps are also available for shaft drive Dry-Sump oil pump mounted applications. KRC Pro Series III Pumps are available with a 3/8" hex drive or a 17-spline input shaft. Our shaft drive power steering pumps can be seen on Dirt Late Models & Sprint Cars around the world.

NOTE: KRC Shaft drive pumps require a pump adapter/spud.

### Sprint Car Pump Build

PS3 29316811 Power Steering Pump  
KRC 6055200 Mounting Bracket & Hardware

Sprint Cars utilize a Pro Series III 3/8in hex drive power steering pump with a 3/8in hex Fuel Pump output drive. Mount w/ a Two-bolt slotted mid-plate adapter (KRC 60552000). Available for use with or without a raised cam.

KRC shaft drive pumps have the industry standard Hilborn 3-bolt pattern. Fits Hilborn, Waterman, BG, DSR, & other 3/8in hex drive



**PS3 29116821**  
PRO SERIES III PUMP - PULLEY  
DRIVE WITH PTO FUEL PUMP  
DRIVE OUTPUT.



**PS3 29216821**  
PRO SERIES III PUMP -  
17-SPLINE DRIVE WITH PTO  
FUEL PUMP OUTPUT.



**PS3 29316821**  
PRO SERIES III PUMP - 3/8in  
HEX DRIVE WITH PTO FUEL  
PUMP OUTPUT.

## Marine Optional Pump

PS3 29116231 (Left) PS3 29126231 (Right)

Ideal for marine engines. Built with stainless steel hardware with 3.17 GPM Flow Control Fitting for low speed power assist when docking.

**KRC 20008000**

3.5" V-Belt pulley

Sold Separately.



**KRC 60551000**

**Pro Series Hilborn 3-Bolt Adapter**

The KRC 3-bolt adapter uses a Hilborn pattern and will bolt directly to the rear of Peterson, Johnson, Wulff, Nutter, & Barnes pumps. Dry sump pumps with a PT

## Bellhousing Pump Mounting Brackets



**KRC 60750000**

Bellhousing Pump Mounting Bracket for Pro Series Pumps

Our Black Anodized bracket mounts a Pro Series II or III aluminum HTD power steering pump to a Bert, Brinn or Tilton bellhousing. Bert & Brinn bellhousings normally use a 600mm HTD drive belt. All hardware included.

Other bellhousings may require additional spacing of the

option on a KRC Pro Series Pump).

**KRC 1955300**

**SCP Dry-Sump Adapter**



The Stock Car Products adapter is utilized to mount a KRC shaft drive pump to the SCP dry-summ oil pump. The SCP pump must have the main shaft drilled & tapped 3/8in x 24in. A drilled SCP dry-summ main shaft is available directly from SCP. A 7/8in O.D. 17-spline or 3/8in hex drive spud is required. To complete the installation on a Pro Series II or III Pump use a KRC 60550300 spacer pump. Use a 19550300 to mount a Pro Series I pump to the adapter.

## Shaft Drive Pump Adapters

**KRC 19560300**

Barnes/Razor Dry-Sump Adapter

Required to mount a KRC shaft drive pump to a Barnes or Razor dry-summ oil pump.



**KRC 60550300**

**Pro Series .825in Pump Spacer**

A .825in thick 80mm bolt pattern spacer is required to use a KRC Pro Series aluminum pump on the KRC 1955300 and KRC 19560300 dry-summ adapters.



## Dry-Sump Pump Accessories



**KRC 19670000**

3/8" female hex to 1/4" x 28 male fuel output drive spud.



**KRC 19570000**

17-Spline x 3/8" x 24 drive spud. For use with shaft drive adapters.



**KRC 19571000**

3/8" Hex 3/8" x 24 drive spud. For use with shaft drive adapters.



**KRC 19575000**

17-Spline drive spud removal tool.

# Bellhousing Mounting Brackets



**KRC 60750000**  
Bellhousing Pump Mounting Bracket for Pro Series Power Steering Pumps

## Adjustable Flow Tech Tip

\*Fast ratio racks and bellhousing pumps may require a (KRC 25312000)

in low RPM steering.\*



**KRC Bellhousing Power Steering Pump Mount**

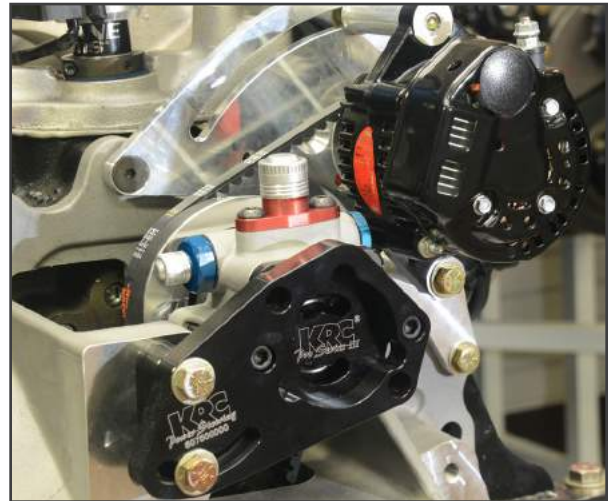

**Bellhousing Pump Mount & Alternator Mount**



## Bellhousing Alternator Mount Kits

A lack of voltage to the ignition can rob horsepower. Stay at full voltage with the KRC Bellhousing Alternator Mount Kit for Brinn, Bert, & more.

**KRC 40964000 Alternator Mount Kit - SB Chevy**

**KRC 40860000 Alternator Mount Kit - Ford**

Includes Alternator Bracket & Hardware Only



# Bellhousing Mounted Steering Pumps

KRC bellhousing power steering mounting systems feature our 9.6cc high volume Pro Series III aluminum power steering pump with a 32-tooth or a 40-tooth HTD pulley. Available with or without a fuel pump output drive. Non-fuel pump drive pumps can also be driven off the front of the engine with a HTD belt.

## Bellhousing Mounted Power Steering Pumps

All bellhousing mounted pumps require a **KRC 60750000** bracket to mount the pump to the bellhousing. (See opposing page)



**KRC 82308040**  
40TH HTD pulley for all Pro Series Pumps



**KRC 82308032**  
32TH HTD pulley for all Pro Series Pumps



**KRC 89202125**  
21th to 25th HTD Crank R-LOK Pulley Rock Guard

**KRC 89202629**  
26th to 29th HTD Crank R-LOK Pulley Rock Guard

**KRC 89008032**  
Rock guard for all 32TH KRC HTD power steering pulleys

**KRC 89008037**  
Rock guard for all 37TH KRC HTD power steering pulleys

**KRC 89008038**  
Rock guard for all 38TH KRC HTD power steering pulleys

**KRC 89008040**  
Rock guard for all 40TH KRC HTD power steering pulleys

## Bellhousing Mounted with PTO Fuel Pump Drive

Fuel pump drive pumps feature a 3/8" hex output drive and have the industry standard Hilborn aterman, BG, Ron's, DSR, and other fuel pumps.



Pulley, Bracket, Pump & Rock Guards Sold Separately

### PS3 29126251

Pro Series III Aluminum Power Steering Pump 9.6CC W/17 Spline & Combo Fuel Pump



### PS3 29116811

Pro Series III Aluminum Power Steering Pump 9.6CC W/17 Spline & Threaded Shaft for Pulley

### PS3 29126821

9.6CC Pro Series III Pulley Drive Pump with PTO.

### PS3 29126811

Standard 9.6CC Pro Series III Pump With PTO.

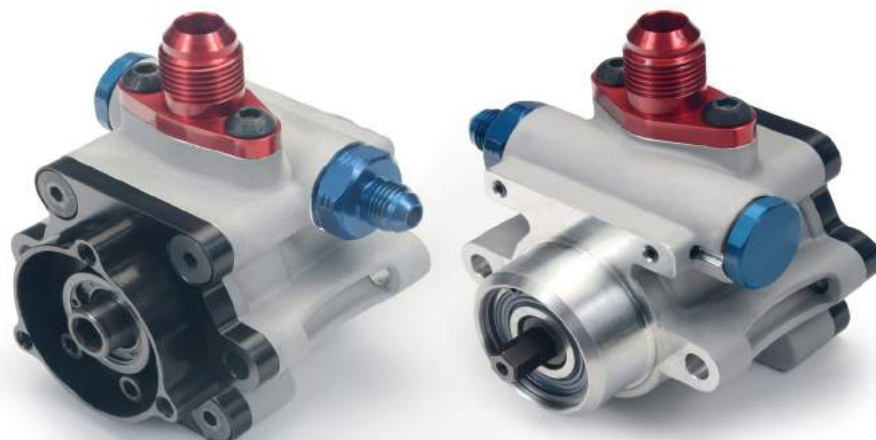

ADD Pumps # & NEW IMAGES Here

# Shaft Drive Pump Adapters



**KRC 19555300 SCP Dry-Sump Adapter**

KRC shaft drive pump to a (SCP) Dry-Sump oil pump. SCP pumps must have the main shaft factory drilled & tapped 3/8" x 24" which is available directly from SCP. A KRC 7/8" O.D. 17-spline or 3/8" hex drive spud is required. A KRC 60550300 spacer is required to mount a Pro Series III Pump.

**KRC 60550300 Pro Series .825" Pump Spacer**

A .825" thick - 80mm bolt pattern spacer is required for connecting Pro Series III Aluminum Pumps to Dry-sumps. Use KRC 19555300 & KRC 19560300 Dry-Sump adapters.



**KRC 19560300 Barnes/Razor Dry-Sump Adapter**

shaft drive pump to a Barnes or Razor Dry-Sump oil pump. The Dry-sump pump with the main shaft factory drilled & tapped 3/8" x 24 is available directly from the manufacturer. A 7/8" O.D. 17-spline or 3/8" hex drive spud is required. To complete the installation you will need KRC 60550300 spacer to mount a new Pro Series pump.



**KRC 60551000 Pro Series Hilborn 3-Bolt adapter**

The 3-bolt Hilborn pattern will bolt directly to the rear of Peterson, Johnson, Wulff, Nutter, Barnes & several other pump brands with a PTO built into the rear of the Dry-Sump pump. This is also one of our most popular sprint car mid-plate adapters. This adapter does not work on the new R4 Peterson pump, they make their own mount for our pump.



**KRC 60552000 2-bolt Raised Cam Sprint Car Adapter**

2-bolt adapter kit to mount a Pro Series aluminum pump. This adapter is slotted for use with raised cam Sprint Car engines. Includes bracket, bolts, and spacers.

**KRC 19670000**  
3/8" female hex to 1/4" x 28 male fuel output drive spud.



**KRC 19570000**  
17-Spline x 3/8" x 24 drive spud. For use with shaft drive adapters.



**KRC 19571000**  
3/8" Hex 3/8" x 24 drive spud. For use with shaft drive adapters.



**KRC 19575000**  
17-Spline drive spud removal tool.



# Power Steering Pump Accessories

## Pressure Relief Valves

Available for all Pro Series Aluminum Pumps

High banked tracks, short steering arms, extreme caster, bump-stops, high cross weight, aero down-force & soft wide tires create extreme pressure in the steering system. KRC offers several pressure relief valves to help compensate. Custom pressures available up to 2000 psi.



- KRC 18910120** 1200psi. Low pressure relief valve
- KRC 18910145** 1450psi. Medium pressure relief valve
- KRC 18910160** 1600psi. High pressure relief valve



**KRC 60197000**  
Replacement Hi-Temp Front Bearing for Pro Series III Pumps

## Replacement Pump Shafts



**KRC 60715000**

Heat treated replacement Splined Pulley Drive Shaft for Pro Series II and Pro Series III Aluminum Pumps. Does not fit Aluminum Pumps.



**KRC 60718000**

Heat treated replacement 17-Spline Drive Shaft for Pro Series II and Pro Series III Aluminum Pumps. Does not fit Pro Series I Aluminum Pumps.



**KRC 60720000**

Heat treated replacement 3/8in Hex Drive Shaft for Pro Series II and Pro Series III Aluminum Pumps. Does not fit Pro Series I Aluminum Pumps.

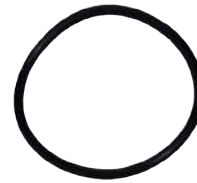

**KRC 19582000**  
Dry-Sump adapter O-ring used for KRC 1955300 & KRC 19560300 adapters.



**KRC 19580000**  
Seal kit for **KRC 1955300** and **KRC 19560300** Dry-Sump pump adapters.

## Inlet Fittings



**KRC 21205000**

A -12 inlet fitting is the perfect add-on for a KRC Pro Series III, Elite & KRC Cast Pumps. High Flow fitting moves more fluid to the steering pump in applications where a larger KRC Flow Control Fitting is used. O-ring included.



**KRC 21200090**

The KRC -10, 90° inlet fitting rotates 360° and provides plumbing flexibility in tight areas.. Includes O-ring seal & Allen head bolts. Fits Pro Series III, Elite Series & KRC Cast Pumps.



**KRC 21200000**

Replacement -10 pump inlet A small vacuum leak can cause aeration & pump overheating. Fits cast iron, Pro Series III & Elite Series pumps. Includes O-ring & Allen head bolts.

# Flow Control Fittings



## Aluminum Flow Control Fittings

Part No.	Description
KRC 25304000	Aluminum Flow Fitting, -6 Male, ID: 4
KRC 25305000	Aluminum Flow Fitting, -6 Male, ID: 5
KRC 25306000	Aluminum Flow Fitting, -6 Male, ID: 6
KRC 25307000	Aluminum Flow Fitting, -6 Male, ID: 7
KRC 25308000	Aluminum Flow Fitting, -6 Male, ID:
KRC 25309000	Aluminum Flow Fitting, -6 Male, ID: B
KRC 25310000	Aluminum Flow Fitting, -6 Male, ID: C
KRC 25311000	Aluminum Flow Fitting, -6 Male, ID: D
KRC 25312000	Aluminum Flow Fitting, -6 Male, ID: E

## Steel Flow Control Fittings

Part No.	Description
KRC 25404000	Steel Flow Fitting, -6 Male, ID: 4
KRC 25405000	Steel Flow Fitting, -6 Male, ID: 5
KRC 25406000	Steel Flow Fitting, -6 Male, ID: 6
KRC 25407000	Steel Flow Fitting, -6 Male, ID: 7
KRC 25408000	Steel Flow Fitting, -6 Male, ID: None
KRC 25409000	Steel Flow Fitting, -6 Male, ID: B
KRC 25410000	Steel Flow Fitting, -6 Male, ID: C
KRC 25411000	Steel Flow Fitting, -6 Male, ID: D
KRC 25412000	Steel Flow Fitting, -6 Male, ID: E



## Aluminum Flow Control Fitting Kits

KRC has two kits that include four Flow Control Fittings. 9 Levels of Adjustable Feel are created by the appropriate valve to create More Assist or Less Assist.



**KRC 25300407**  
Less Assist Kit



**KRC 25300912**  
More Assist Kit

## Pump Flow: Rating at 180° Fluid Temp and 500 PSI

9.6 CC Pro Series Aluminum Pumps			
Part Number		Pump Flow	ID Mark
Aluminum	Steel		
KRC 25304000	KRC 25404000	1.18 GPM	4
KRC 25305000	KRC 25405000	1.43 GPM	5
KRC 25306000	KRC 25406000	1.70 GPM	6
KRC 25307000	KRC 25407000	1.96 GPM	7
KRC 25308000	KRC 25408000	2.22 GPM	None
KRC 25309000	KRC 25409000	2.41 GPM	B
KRC 25310000	KRC 25410000	2.65 GPM	C
KRC 25311000	KRC 25411000	2.75 GPM	D
KRC 25312000	KRC 25412000	2.92 GPM	E

13.5 CC Cast Iron Pump			
Part Number		Pump Flow	ID Mark
Aluminum	Steel		
KRC 25304000	KRC 25404000	1.66 GPM	4
KRC 25305000	KRC 25405000	2.03 GPM	5
KRC 25306000	KRC 25406000	2.35 GPM	6
KRC 25307000	KRC 25407000	2.67 GPM	7
KRC 25308000	KRC 25408000	2.91 GPM	None
KRC 25309000	KRC 25409000	3.32 GPM	B
KRC 25310000	KRC 25410000	3.75 GPM	C
KRC 25311000	KRC 25411000	4.01 GPM	D
KRC 25312000	KRC 25412000	4.21 GPM	E

## Flow Control Fitting Technical Data

### Choosing the right Flow Control Fitting

Selecting the correct Flow Control Fitting for your application can bring changes to your steering system you never knew existed. There are a few things that need to be considered when determining which Flow Control Fitting is best for your application. Much of the time, the Standard Flow Control Fitting that comes in the pump from the factory is the best choice. A different Flow Control Fitting may be required depending on the track, driver preference, & steering system. KRC Adjustable Flow Technology also benefits Hot Rods, Muscle Cars or other applications.

### How does the Flow Control Fitting work?

The Flow Control Fitting is very simple to understand. Think of it like changing a jet in a carburetor. The bigger the Flow Control Fitting you choose, ID:B-E, the more fluid will be flowing out of the pump. More flow will give you more assist in the steering system, but will reduce some of the feel. The smaller the Flow Control Fitting you choose, ID:4-7, the less fluid will be flowing out of the pump giving you more feel while taking away some of the assist.

# Reservoir & Surge Tanks

## Reservoir Tanks

KRC tanks come with non-vented caps to reduce cavitation. -6 inlet & -10 outlet fittings are standard. Round tanks are available in both Economy & Deluxe models. Separate roll bar mounting brackets are included. Deluxe models have an internal tee to reduce aeration of the fluid returning to the tank. Flat tanks have internal baffling & a welded flat surface mounting bracket. Bolt-on tanks mount directly to the power steering pump to help save space & weight. **KRC 91312045** bolt-on tank has the -6 inlet fitting 45° further around the can from our standard **KRC 91312000**, allowing more clearance for plumbing in cramped engine compartments.

**9131 series tanks are not to be used on Old Model Pro Series II Pumps - damage will occur.**



**KRC 91515000**  
LH Flat Surface Mount Tank, -6 Fitting on LH Side Facing Tank



**KRC 91500000**  
Economy Round Tank with Roll Bar Mounting Bracket



**KRC 91312000**  
-6 return bolt-on reservoir for Pro Series III & cast iron pumps only



## Tank Accessories

**KRC 91550800**  
Replacement Reservoir Tank Cap, Non-Vented

**KRC 91510000**  
RH Flat Surface Mount Tank -6 Fitting on RH Side Facing Tank

**KRC 91504000**  
Deluxe Round Tank with Tee Baffle & Roll Bar Mounting Bracket

**KRC 91312045**  
45° Rear Facing, -6 return bolt-on reservoir for Pro Series III & cast iron pumps only

**KRC 91318000**  
-8 return bolt-on reservoir for Pro Series III & cast iron pumps only



**KRC 91501000**  
Mounting Bracket, Replacement for Round Tanks



**KRC 91150000**  
**Round Tank with 115 Micron Filter**

Debris in your power steering system can become a big problem. Our brand new, filtered tank keeps your fluid clean to protect against steering system damage. Flat panel mount or roll bar mount option.



**OBG 4020**  
4" Round, 1 screen for KRC 91150000



## KRC Surge Tank: SUR 95000000

Our aluminum surge tank has a billet aluminum neck, with two 1/4" pipe fittings on each side, one 1/2" pipe fitting on the bottom and one 1/8" pipe fitting on the neck. A roll-bar mounting bracket is welded to the back for installation in the engine compartment. This tank is required when running a CT525 with the factory water pump.

# KRC Elite Series Power Steering Pumps

## NEW KRC ELITE SERIES POWER STEERING PUMPS

**ESP 10096000** KRC Elite Series Pump Only - GM Press On - 9.6cc

**ESP 10096100** KRC Elite Series Pump Only W/Tank - GM Press On - 9.6cc

*Affordable KRC Quality. 9.6CC & Fully Adjustable*

**Saves 4 to 6 HP!**

KRC Elite Series Power Steering Pumps are affordable. Many features were developed in our Pro Series Line. Perfect for Late Models, Super Late Models, Modifieds, Hot Rods & More.



**ESP 10096100**



**ESP 10096000**



GM Type 2 Standard Bolt Pattern.

**9 Levels of Flow Adjustment!**

### GM Press-On Pump Pulleys STD.



ADD NEW LS OFFSET PULLEYS  
HEREXXXXXXXXXX

### KRC 40610600

6.0" V-Belt Pulley; fits .6645O.D. Saginaw Pump Shafts

### KRC 40160600

6.0" 6-Rib Press-On Serpentine Pulley; fits .6645O.D. Saginaw Pump Shafts

### KRC 40160000

4.20" 6-Rib Press-On Serpentine Pulley; fits .6645O.D. Saginaw Pump Shafts

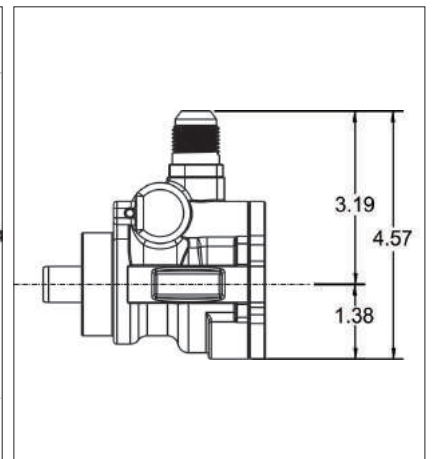
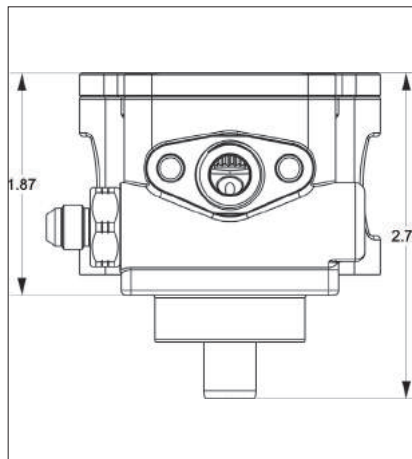
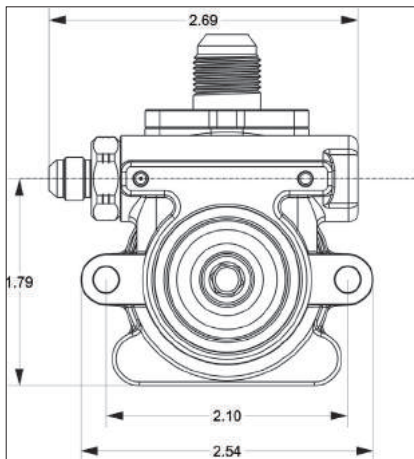

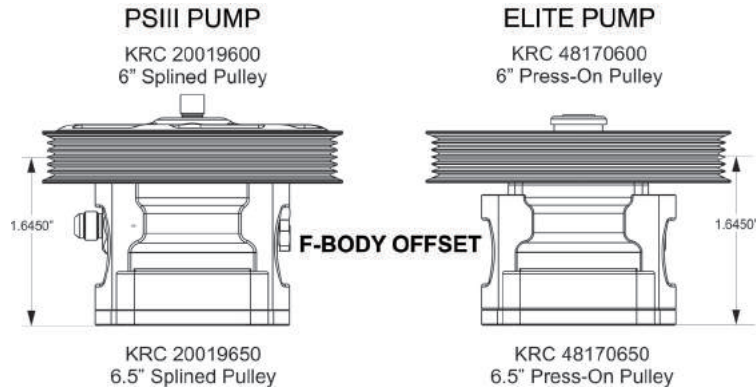

# KRC Power Steering

Which KRC Pump is Right For You?

PRO SERIES III

vs

Elite Series



Features	Pro Series III	Elite
	<i>Starting at:</i>	
5.9CC Volume Option	✓	
7.2CC Volume Option	✓	
9.6CC Volume Option	✓	✓
KRC Adjustable Flow Technology	✓	✓
Available W/Bolt On Tank	✓	✓
Available Press On Pulley Shaft	✓	✓
Standard Splined Pulley Shaft	✓	
Dyno Tested	✓	
Brown Viton Seals	✓	✓
Precision Quality SKF Front Sealed Bearing	✓	
Quality SKF Front Sealed Bearing		✓
Precision Ground Pressure Relief Valve	✓	✓
Burnished Pressure Relief Bore	✓	✓
Precision Sunnen Honed Pressure Relief Bore	✓	
Available with a Tandem Fuel Pump	✓	
Available W/Hex Drive (for dry sump)	✓	
Available W/PTO Drive (for fuel pump)	✓	
Anodized AN Fittings & Back Cover	✓	
Marine Version	✓	
Completely Machined & Assembled in USA	✓	✓



### Why choose KRC Power Steering Pumps?

We design our pumps in house from the ground up. KRC Pumps are created to be a high performance racing pump. Our exclusive aluminum housings are engineered for racing. The competition uses street car pumps. At KRC—We do it right.

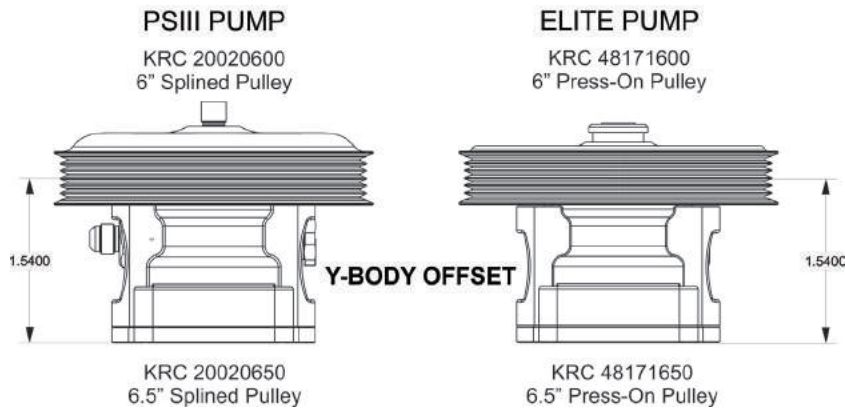

# Chevy Power Steering Pump Brackets

**KRC Power Steering Pump Bracket Features:**

- Long Adjustment Slot Allowing More Than One Belt will Fit Your Application
- Smooth Surface Captured Nut Makes Starting Bolts Easier
- Dual 72mm and 80mm Pump Bolt Patterns
- All Surfaces are CNC Machined
- Weight Reduction Pockets
- Aircraft Grade Hardware
- Black Anodized Finish

All brackets are black anodized or available without plating in a mill finish by special order.

## Small Block Chevrolet



Back of Bracket



**KRC 31410000**  
SB Head Mounted Power Steering Pump Bracket Kit



**KRC 31415000**  
SB Block Mounted Power Steering Pump Bracket Kit

## Big Block Chevrolet



**KRC 30021000**  
BBC Passenger Side Head Mounted Power Steering Pump Bracket Kit

**KRC 31411000**  
SB Head Mounted Power Steering Pump Bracket Only



**KRC 30020000**  
BBC Drivers Side Head Mounted Power Steering Pump Bracket Kit

**KRC 31416000**  
SB Block Mounted Power Steering Pump Bracket Only



**KRC 30026000**  
BBC Block Mounted Power Steering Pump Bracket Kit

## Bracket Kits vs. Brackets Only?

KRC Bracket Kits include appropriate hardware & spacers to align a KRC serpentine steering pump pulley with a KRC serpentine pulley kit. KRC pump mounting brackets can be used with other pulley systems with slight adjustments to the spacing. KRC Brackets "only" include the bracket & steering pump mounting hardware allowing you to make your own spacers to align the KRC power steering pump with the specific pulley system on your engine. Spacers & hardware are also available separately for each KRC bracket.



# Chevy Power Steering Pump Brackets

## LS Power Steering Pump Mounting Brackets



### KRC 71410525

#### Includes Hardware

CT525 Head Mount Pro Series Pump Bracket Kit including hardware. (Use with EMP/Stewart Water Pump Part# KRC 15425702 )



### KRC 71410000

#### Less Hardware

Pro Series Power Steering Pump LS Head Mount Bracket Only without hardware. (Use with EMP/Stewart Water Pump Part# KRC 15425702 )



### KRC 71410040

#### Includes Hardware

Pump Mounting Bracket Kit includes hardware for F-Body or Y-Body (LS Head Mount)



### KRC 71415525

#### Includes Hardware

CT525 Block Mount Pro Series Pump Bracket Kit (Use with EMP Water Pump)

### KRC 71415000

#### Less Hardware

CT525 Block Mount Pro Series Pump Bracket Only (Use with EMP Water Pump)



### KRC 71590525

#### Includes Hardware

CT525 KSE Tandem Pump Mounting Bracket Kit

# Power Steering Pump Brackets

Small Block Ford (302c.i. & 351c.i.)



**KRC 31610000**

Ford 302c.i. Head Mounted Power Steering Pump Bracket Complete Kit

**KRC 31611000**

Ford 302c.i. Head Mounted Power Steering Pump Bracket Only



**KRC 31620000**

Ford 351c.i. Head Mounted Power Steering Pump Bracket Complete Kit

**KRC 31621000**

Ford 351c.i. Head Mounted Power Steering Pump Bracket Only

**Ford Boss 302 Coyote Pump Mounting Bracket**

**KRC 66302500 - Bracket Only**

Convert your Ford electric power steering to hydraulic power steering with these KRC Power Steering bracket options.



**KRC 31100000 Universal Power Steering Pump Bracket**

The KRC Universal Power Steering Pump Bracket is 6" x 6". The mounting holes & adjusting slot are machined in the bracket for easy pump mounting. We give you plenty of material to adapt our pump to nearly any engine type out there.



**KRC Small Block Dodge Pump Bracket**

**KRC 31515000 - Includes All Hardware**

**KRC 31516000 - Bracket Only**

**KRC 31517000 - Spacers & Bolts Only**

Our Small Block Dodge Bracket mounts the power steering pump to the drivers side lower block of a 340ci./360ci. Dodge engine. For older blocks, without the third mounting location, a brace must be made from the cylinder head to the bracket.



# Power Steering Pump Brackets

## Bellhousing Mounted Pump Brackets



ADD IMAGE of PRO SERIES III Downward Facing Fitting [HERE](#)  
PS3 29126811

### Pro Series Bellhousing Pump Bracket KRC 60750000

Mount a KRC Pro Series HTD aluminum pump to a Bert, Brinn or Tilton bellhousing. All necessary hardware is included. Other bellhousings may require additional spacing of the bracket. Bert & Brinn bellhousings normally use a 600mm HTD drive belt. (Note: Use downward facing fitting option on Pro Series Pump).

## Pump Bracket Parts



**KRC 31000910**  
KRC Power Steering Pump Mounting Bolts & Slide Nut



**KRC 31412000**  
Bracket Mounting Spacers & Hardware Kit, SB Chevy Power Steering Pump Head Mount



**KRC 31417000**  
SB Chevy Power Steering Pump Block Mount Bolts Only



**KRC 72525930**  
CT525 Power Steering Pump Mounting Hardware Only Kit



**KRC 72525940**  
CT525 Hardware Only for KSE Brand Power Steering Pumps



**KRC 72525960**  
CT525 Dirt Pump Mounting Only Hardware Kit



**KRC 31517000**  
KRC Power Steering Pump Bracket Mounting Spacers & Hardware Only for SB Dodge



**KRC 31612000**  
Ford 302/351c.i. 7/16" Head Mounted Power Steering Pump Bolt Kit Only



**KRC 31613000**  
Ford 302/351c.i. 7/16" Head Mounted Spacer Kit

## Chevrolet Engine Kits

KRC basic kits are a great solution for any SB Chevrolet racing engine, including GM 602 and 604 crate engines. Our drive kits have become the most popular system when it comes to finishing your engine. From professional engine builders to a backyard mechanic, our kits include the appropriate components, hardware, spacers & complete detailed instructions to make installation simple.

## Modular Pulley Kit Product Ordering

As the popularity of KRC Chevrolet engine kits grows, the number of part numbers grows with it. We have over 45 different combinations of GM kits alone. To simplify product ordering, we created engine kit part numbering in a modular format. Choose the basic 12% water pump reduction drive kit in the configuration you want, then select the appropriate add on accessories based on your application, whether it is for dirt or pavement. It is that simple!

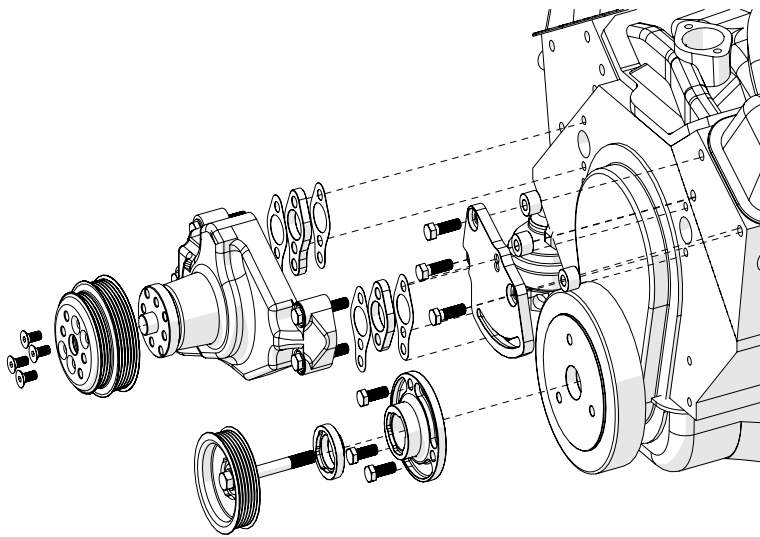

### KIT 16312610

Basic Chevrolet Engine Kit with Head Mounted Pump Bracket

#### Kit 16312610 Includes:

- KRC 15101001 Water Pump
- KRC 15003000 .375" W/P Spacer Kit
- KRC 31411000 Head Mtg Bracket Kit
- KIT 16312910 Hardware Kit
- KRC 38215375 .375" R-Lok Spacer
- KRC 38025400 4.0" Water Pump Pulley
- KRC 38140000 R-Lok Crank Adapter
- KRC 38235000 3.5" R-Lok Crank Pulley

\*Kits do not include power steering pump or belt, choose options below\*

### Cast Iron Pump Options

- KRC 50020000 Cast Iron Pump with 4.2" Serpentine Pulley or
- KRC 50020100** Cast Iron Pump with 4.2" Serpentine Pulley and tank
- GDY 4060380 38.0" Serpentine Belt

### Pro Series III Aluminum Pump Options

- PS3 29116811 Pro Series III Pump or PS3 29116813 with tank
- KRC 20015000 4.2" Serpentine Pulley
- GDY 4060380 38.0" Serpentine Belt

### Alternator Options

- KIT 16315000 Chevrolet Engine Denso Alternator Add-On Kit
- POW 8162 50 AMP, 12 Volt, Heavy Duty Alternator OR
- POW 8182** 85 AMP, 12 Volt, Heavy Duty Alternator



### Elite Series Aluminum Pump Options

- ESP 10096000 Elite Series Pump or
- ESP 10096100 with tank
- KRC 40160000 4.2" Serpentine Pulley
- GDY 4060380 38.0" Serpentine Belt
- ESP 10020000 Elite Pump Spacer .325



# SB Chevrolet Basic Kits

## SB Chevrolet Basic Kits with Idler-Tensioner

The KRC Front Drive Engine Pulley basic kits come with an idler-tensioner add-on. They are available with or without water pumps. In block or head mount configurations are available.

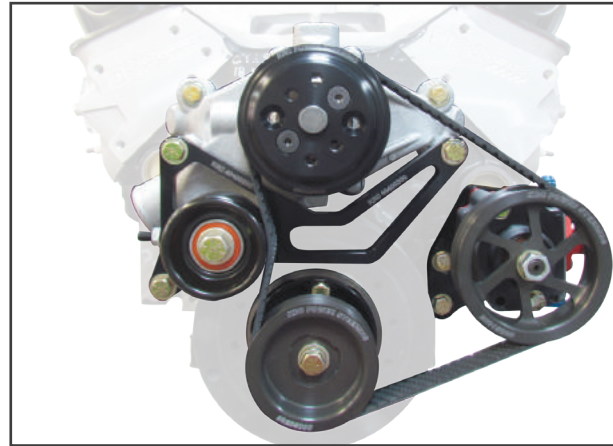
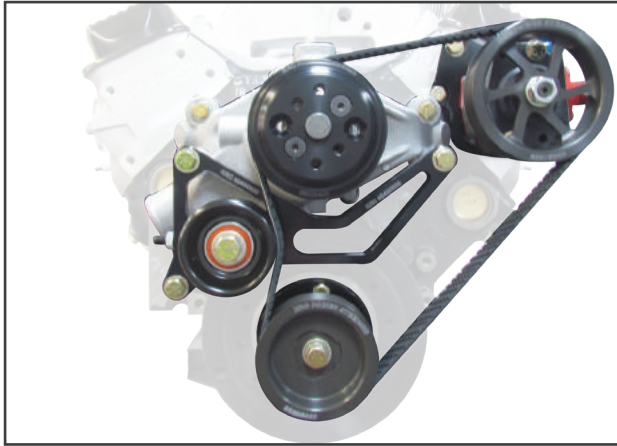

### KIT 16320610

Complete SB Chevrolet Kit with Idler-Tensioner (**Head Mount**)  
Power Steering Pump & Belt Sold Separately

#### Kit 16320610 Components:

- KRC 15003000 Water Pump Spacer Kit w/Gaskets .375"
- KRC 15101001 Water Pump For SBC 5.795" Length
- KRC 40400310 Assembled Chevrolet Idler
- KRC 31411000 SB Chevy Head Pump Mounting Bracket
- KRC 38215375 R-LOK to R-LOK Spacer, .375"
- KIT 16320910 Hardware for Crate Idler-Tensioner
- KRC 38025400 SB Chevy 4.0" Water Pump Pulley
- KRC 38140000 R-LOK Crank Adapter
- KRC 38235000 R-LOK Serpentine Crank Pulley 3.5"

### KIT 16320615

Complete SB Chevrolet Kit with Idler-Tensioner (**Block Mount**)  
Power Steering Pump & Belt Sold Separately

#### Kit 16320615 Components:

- KRC 15003000 Water Pump Spacer Kit w/Gaskets .375"
- KRC 15101001 Water Pump For SBC 5.795" Length
- KRC 40400310 Assembled Chevrolet Idler
- KRC 31416000 SB Chevy Block Pump Mounting Bracket
- KRC 38215375 R-LOK to R-LOK Spacer, .375"
- KIT 16320915 Hardware for Crate Idler-Tensioner
- KRC 38025400 SB Chevy 4.0" Water Pump Pulley
- KRC 38140000 R-LOK SB Chevy Crank Adapter
- KRC 38235000 R-LOK Serpentine Crank Pulley 3.5"

## Replacement Hardware

### KIT 16312910

Includes all hardware to install Crate Engine  
Head Mounted Power Steering Pump



### KIT 16312915

Includes all hardware to install Crate Engine  
Block Mounted Power Steering Pump



# Water Pump Drive Only Kits

## Chevy Water Pump Drive Only Kits without Bellhousing Mounted Steering Pump



### KIT 16322600 Components:

Complete Water Pump Only Drive Kit (**Power Steering Pump Sold Separately**)

- **KRC 15101001** Water pump for SB Chevrolet 5.795" Long
- **KRC 15003000** .375" W/P spacer kit with gaskets
- **KRC 38215375** R-LOK to R-LOK spacer .375"
- **GDY 4060260** 6-Rib x 26.0" serpentine belt
- **KRC 38025400** SB Chevy 4.0" W/P Pulley
- **KRC 38140000** R-LOK crank adapter SB Chevy
- **KRC 38235000** R-LOK serpentine crank pulley 3.5"
- **KRC 40400310** Assembled Chevrolet Idler
- **KIT 16322930** Crate Hardware kit

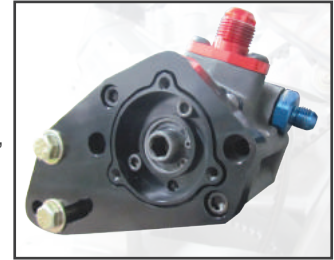

### Back of Kit

PS Pump Sold Separately

### KIT 16322650

Same as KIT 16322600 (listed above) without water pump

## Bellhousing Alternator Mounting Bracket Kit Add-On

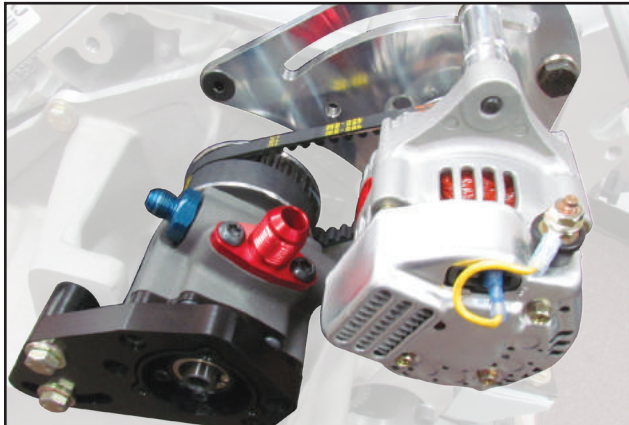

### KRC 40964000

A lack of voltage to the ignition can rob horsepower. Stay at full voltage with our bellhousing alternator mount kit for Brinn, Bert, and some others. This kit includes all hardware, a rear alternator bracket, 24TH HTD Denso alternator pulley, and two HTD belts; one to drive the alternator and one to replace the pump drive belt in the kits on the left-hand page. Belt lengths are for Pro Series power steering pumps only. **Alternator and power steering pump sold separately. Note: Included belts are for a Pro Series pump W/40TH pulley.**

**NOTE:** 1st design KRC aluminum power steering pumps require a 20mm x 536mm and a 10mm x 512mm HTD belts for a 32TH pulley.

## SB Chevrolet Alternator Only Kit

This kit is a complete front engine kit that was originally designed for Port City Racing Chassis. It's any race car that has the power steering pump mounted on a quick change rear-end. This kit includes a water pump pulley, R-LOK crank adapter and pulley, a 93mm Denso alternator bracket, KRC High Performance water pump, Continental Elite belt & appropriate hardware and spacers. **Denso alternator sold separately.**

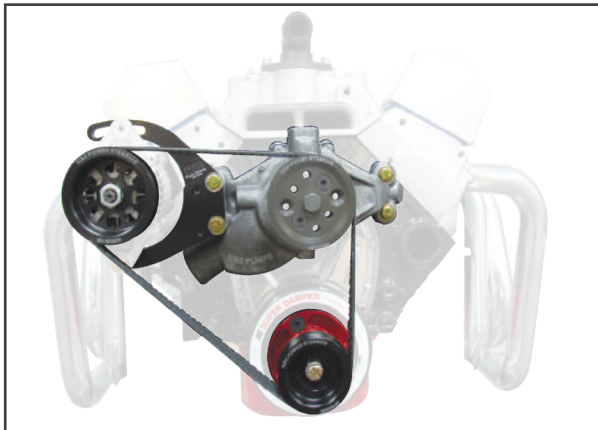

### KRC 16315PCR

#### Kit components include:

- **KRC 15101001** KRC Water Pump
- **KRC 38140000** R-LOK crank adapter
- **KRC 38230000** 3.0" R-LOK crank pulley
- **KRC 40122000** 3.5" twin 6-Groove Water Pump Pulley
- **KRC 38215375** R-LOK Spacer .375"
- **KRC 38216000** R-LOK Spacer 1.00"
- **GDY 4060370** 6-Rib X 37.0"
- **KRC 15003000** Water pump spacer kit with gaskets .375"
- **KRC 40510200** Chevrolet Alternator bracket kit
- **KRC 40150640** 6 Groove alternator pulley 3.5"
- **KIT 16315930** Hardware for alternator bracket

# SB Chevy Left Side Kit

Moves 7.1 lbs Left & Low!

## KIT 16612115

**KRC 15101001** Water pump for SBC 5.795" Length  
**KRC 31416000** SB Chevy block pump mounting bracket  
**KRC 38140000** R-LOK Crank adapter SB Chevy  
**KRC 38235000** R-LOK Serpentine crank pulley, 3.5"  
**KRC 38025400** Chevy 4.0" Water pump pulley  
**KRC 40565000** LH SBC DENSO Alternator bracket  
**POW 8162** DENSO 12V 50-AMP Heavy Duty  
**GDY 4060330** 6-RIB X 33.0"  
**KIT 16612915** Hardware kit for block mount pavement kit  
**GDY 4030220** 3-RIB X 22.0"  
**KRC 20015000** 4.2" Aluminum serpentine pulley  
**KRC 40130340** 1.75" DENSO Alternator pulley  
**PS3 27116813** 7.2CC Pro Series III Power Steering Pump  
**KRC 38205000** R-LOK Hex crank nut end cap

Move your weight Left & Low! Our engineers designed a clean & compact Engine Pulley Power Steering Pump Kit for Small Block Chevrolet Engines. Moving weight left & low gains you speed & reliability.

The KRC Power Steering Left Side Kit includes everything you need to drive a SB Chevy Crate Engine. 5.795" Water Pump and crank pulleys with our Hex End Cap. The Powermaster DENSO 50 AMP Heavy Duty Alternator supplies your system from Lap 1 to the checkered flag. The kit comes with the KRC Pro Series III Power Steering Pump. Serpentine pulleys, billet pump & alternator mounts are anodized black for a clean long lasting finish. Top quality, all hardware and easy installation instructions are all included! Kit includes a Pro Series III Power Steering Pump - a Elite Series Power Steering Pump version is available.



**Lightweight Left & Low!**



KRC Power Partner Leaveine Family Racing & winning Crew Chief Todd Parrott choose KRC Pro Series III Power Steering Pumps.

Reliability is paramount for a small team running the Monster Energy NASCAR Cup Series.

The FDNY Foundation car represents the dedication of the entire #95 organization

Todd Parrott is the most winning active crew chief on the Cup Series!

LFR & Todd Parrott are #Relentless.

# Serpentine Pulley Kits

Our Pro Series pulley kits come with a 4.0" aluminum water pump pulley that includes a 6-groove main drive & a 3-groove accessory drive, aluminum R-LOK crankshaft pulley, R-LOK crank adapter, & the appropriate hardware. Pro Series kits will clear cartridge style water pumps. All kits are designed to fit a 4.2" serpentine power steering pump pulley. Additional accessories and/or a different power steering pump pulley size will require different belt lengths.

## Chevrolet Kits Only



**KRC 36350000**

1-to-1 Serpentine pulley kit for Small Block Chevy, Crank Pulley-3.5" Water Pump Pulley -3.5"



**KRC 36351500**

15% Serpentine pulley kit for Small Block Chevy, Crank Pulley-3.0" Water Pump Pulley -3.5"



**KRC 36353000**

30% Serpentine pulley kit for Small Block Chevy, Crank Pulley-2.5" Water Pump Pulley -3.5"



**KRC 36400000**

1-to-1 Serpentine pulley kit for Small Block Chevy, Crank Pulley-4.0" Water Pump Pulley -4.0"



**KRC 36401500**

12% Serpentine pulley kit for Small Block Chevy, Crank Pulley-3.5" Water Pump Pulley -4.0"



**KRC 36403000**

25% Serpentine pulley kit for Small Block Chevy, Crank Pulley-3.0" Water Pump Pulley -4.0"

## Dodge Kits Only



**KRC 38521000**

1-to-1 Serpentine pulley kit for Small Block Dodge, Crank Pulley-3.5" Water Pump Pulley -3.5"



**KRC 38511000**

15% Serpentine pulley kit for Small Block Dodge, Crank Pulley-3.0" Water Pump Pulley -3.5"



**KRC 38501000**

30% Serpentine pulley kit for Small Block Dodge, Crank Pulley-2.5" Water Pump Pulley -3.5"



# Water Pump Only Drive Pulley Kits

## Water Pump Only/Single Belt Drive Kits with Idler-Tensioner

KRC water pump only/single belt serpentine drive kits are available in 1-to-1, 15% & 30% ratios for Small Block Chevy engines. Each kit includes a Pro Series water pump pulley, R-LOK crank pulley, R-LOK crank adapter, idler-tensioner bracket & pulley, system belt, appropriate hardware & spacers. Detailed instructions are included.



**KRC 37453000**



**KRC 37453510**

### Water Pump Only Drive Kit with Alternator Bracket

KRC now offers our popular Small Block Chevrolet water pump only drive kit with an optional alternator bracket. All of the components in our standard drive kit are included plus an alternator bracket, alternator pulley, hardware, spacers & an additional drive belt.

**Alternator sold separately.**

**Note:**

**Chevrolet SBC Kit:** If you are using a crank trigger and/or timing gear drive, give us a call & we will ensure you get the proper spacers & hardware for your application.

### Without Denso Alternator Bracket



**KRC 37451000**

1-to-1 Pro Series Water Pump Only Drive Kit with Idler-Tensioner



**KRC 37452000**

15% Pro Series Water Pump Only Drive Kit with Idler-Tensioner



**KRC 37453000**

30% Pro Series Water Pump Only Drive Kit with Idler-Tensioner

### With Denso Alternator Bracket



**KRC 37451510**

1-to-1 Pro Series Water Pump Only Drive Kit with Idler-Tensioner & 138mm Bolt Pattern Denso Alternator Bracket



**KRC 37452510**

15% Pro Series Water Pump Only Drive Kit with Idler-Tensioner & 138mm Bolt Pattern Denso Alternator Bracket



**KRC 37453010**

30% Pro Series Water Pump Only Drive Kit with Idler-Tensioner & 138mm Bolt Pattern Denso Alternator Bracket

# Small Block Chevy HTD Drive Kits

Same kit used by many of the top Late Model Engine Builders

**KIT 87030610** Power Steering Pump, Water Pump & Alternator Sold Separately

Complete Small Block Chevrolet 30% Reduction HTD front drive pulley kit with 6.0" V-Belt Pro Series power steering pump with bolt-on tank.

**Kit 87030610 components include:**

- KRC 31411000 SB Chevy head pump mounting bracket
- KRC 88208095 Mini R-LOK to R-LOK adapter
- KRC 86508032 32TH HTD oil pump pulley w/ C-LOK
- KRC 81508024 24TH HTD denso alternator pulley
- KRC 40510200 Chevrolet 2-piece alternator bracket kit
- KRC 88208018 18TH R-LOK HTD crank pulley
- KRC 38335000 3.5" V-Belt R-LOK pulley
- KIT 87030930HMR 30% HTD hardware kit
- HTD 45020640 HTD belt, 20mm x 640mm 80TH
- HTD 45020600 HTD belt, 20mm x 600mm 75TH
- HTD 45010656 HTD belt, 10mm x 656mm 82TH
- GDY 15366 V-Belt (7/16)" x 36.0"
- KRC 38207000 Mini R-LOK hex crank nut end cap
- KRC 63201000 Pro Series pump with 6.0" V-Belt pulley
- KRC 88008035 35TH HTD water pump pulley
- KIT 38140510 Pro R-LOK crank tab
- KRC 88205025 25TH R-LOK crank pulley

**UPDATE KIT & IMAGE PNXXXXXX**

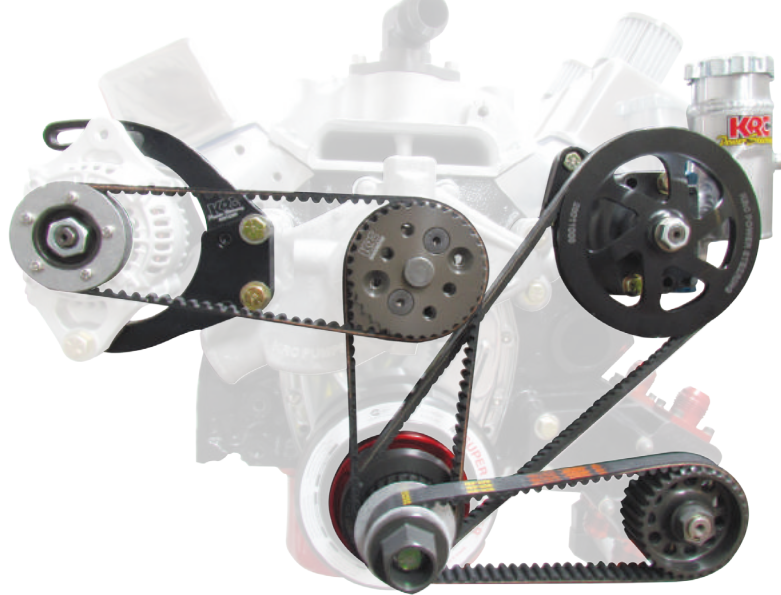

## Kit Features

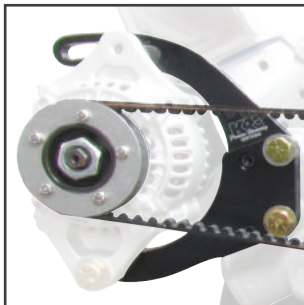

**KRC 40510200** Chevrolet 2-piece alternator bracket kit & **KRC 81508024** 24TH HTD denso alternator pulley.



**KRC 31411000** SB Chevy Head Pump Mounting Bracket Only. **Power Steering Pump & KRC 20011000 6" V-Belt Pulley Sold Separately**

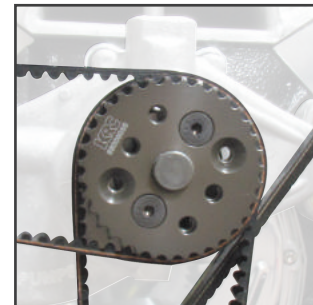

**KRC 88008035** 35TH HTD water pump pulley.

# SB Chevrolet Add-On Accessories



## KIT 16315000

### Chevrolet Engine Denso Alternator Add-On Alternator sold separately.

- KRC 40510261 2 piece Denso Alternator Bracket
- KRC 40130340 1.75" 3-Groove Alt. Pulley
- GDY 4030250 25.0" 3-Rib Belt



## KIT 16316000

### Chevrolet Engine Delco Alternator Add-On Alternator sold separately.

- KRC 40550060 Delco Alternator Bracket
- KRC 40140300 2.5" 3-Groove Alt. Pulley
- GDY 4030260 26.0" 3-Rib Belt



## KRC 40400360

### Chevrolet Engine Idler/Tensioner Add-On

- KRC 40400310 Idler/Tensioner Bracket
- HW1 SA-37-16-500 (3) 3/8-16 X 5CS Grade 8 Bolts
- HW1 SK-37-00-000 (3) 3/8" SAE Flat Washers
- SPC 90-1-325 (2) .390ID X 1.325" Long Spacers
- SPC 90-2-150 (1) .390ID X 2.150" Long Spacer
- SPC 90-2-000 (1) .390ID X 2.000" Long Spacer
- SPC 90-0-375 (1) .390ID X .375" Long Spacer



## KIT 16390000

### Denso Alternator/Idler Tensioner Add-On Alternator sold separately

- KRC 40450060 Denso Alternator/Idler Bracket Kit
- KRC 40130340 1.75 X 3 - Groove Alternator Pulley
- GDY 4030250 25" X 3-Rib Belt

# Chevrolet CT525 Complete Dirt Front Engine Kits

Included is a Stewart/KRC Pro Series clockwise rotation water pump. Our kits replace the counter-clockwise rotation factory water pump allowing a standard 4-blade fan to be used. We include an idler-tensioner to keep proper belt tension preventing the belt from slipping when a large heavy mechanical fan is used. Alternator add-on kits include an aluminum alternator bracket, Powermaster 95amp Denso alternator, 2.5" aluminum alternator pulley, belt & hardware. KRC recommends running an alternator on the CT525 due to the drain coil packs make on the battery. Running without an alternator risks voltage & electrical system issues.

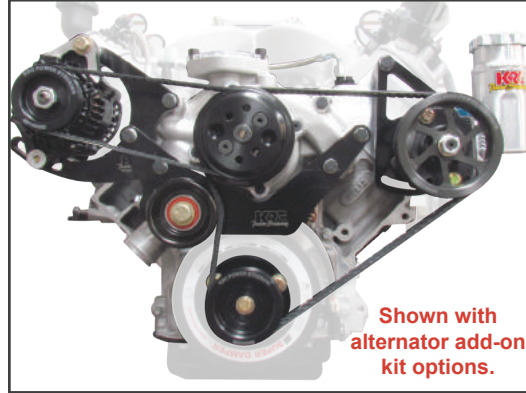
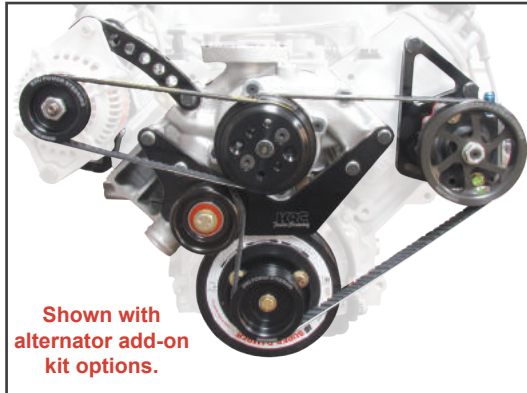

## Power Steering Pumps Sold Separately **Verify If 4.2 Pulley & Belt**

### KIT 77525010XXXX

Complete CT525 Dirt Kit with Head Mount & Stewart Water Pump

#### Kit Components

- KRC 20015000 4.2" serpentine pulley
- KRC 38152500 CT525 R-LOK crank adapter
- KRC 38232500 R-LOK serpentine crank pulley 3.25"
- KRC 70400525 CT525 dirt tensioner, Stewart W/P
- KRC 38025400 SB Chevy 4.0" W/P pulley
- GDY 4060374 6-Rib x 37.4" serpentine belt
- KRC 72525960 CT525 dirt hardware kit
- KRC 15200000 LS -4 water bypass adapters (2)
- KRC 71410525 CT525 head pump mounting bracket
- KRC 15203000 LS CT525 dirt water bypass kit
- KRC 15425702 LS Pro Series water pump (7.02" length)

#### Pro Series III Aluminum Pump Options

- PS3 29116811 Pro Series III Pump
- PS3 29116813 With Tank
- KRC 20015000 4.2" Serpentine Pulley



#### Elite Series Aluminum Pump Options

- ESP 10096000 Elite Series Pump
- ESP 10096100 With Tank
- KRC 4016000 4.2" Serpentine Pulley

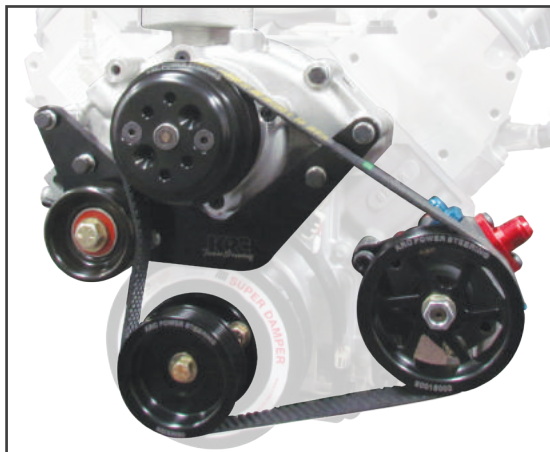

### KIT 77525015

Complete CT525 Kit Block Mount with Stewart Water Pump

#### Kit Components

- KRC 20015000 4.2" serpentine pulley
- KRC 38152500 CT525 R-LOK crank adapter
- KRC 38232500 R-LOK serpentine crank pulley 3.25"
- KRC 70400525 CT525 dirt tensioner, Stewart W/P
- KRC 38025400 SB Chevy 4.0" W/P pulley
- GDY 4060350 6-Rib x 35.0" serpentine belt
- KRC 72525960 CT525 dirt hardware kit
- KRC 15200000 LS -4 water bypass adapters (2)
- KRC 71415525 CT525 block pump mounting bracket
- KRC 15203000 LS CT525 dirt water bypass kit
- KRC 15425702 LS Pro Series water pump (7.02" length)

# LS Chevrolet Engine Kits

## Chevrolet CT525 Complete Pavement Front Engine Kit

KRC's new complete front drive system for the CT525 includes everything you need to finish off the front of your LS engine, plus a set of detailed installation instructions. The KRC kit includes a KRC aluminum fixed idler-tensioner, aluminum brackets, Continental Elite belt & all appropriate hardware and spacers.

### KIT 73525610

Power Steering Pump, Water Pump & Alternator Sold Separately

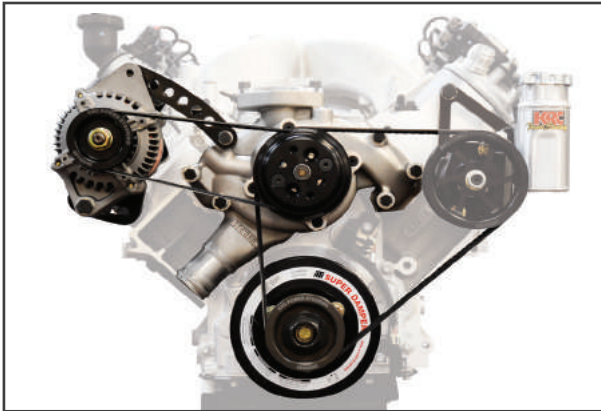

### Kit Components

- KRC 38230000 R-LOK serpentine crank pulley 3.0"
- KRC 71410525 CT525 head pump mounting bracket
- KRC 70510525 CT525 alternator bracket
- KRC 72525990 CT525 Pavement hardware kit
- GDY 4030267 3-Rib x 26.5" serpentine belt
- GDY 4060370 6-Rib x 37.0" serpentine belt
- KRC 15200000 LS -4 water bypass adapters (2)
- KRC 38025400 4.0" water pump pulley
- KRC 38152500 CT525 R-LOK crank adapter
- KRC 40140340 2.5" 3-Groove alternator pulley
- POW 8132-KRC Denso 12-volt 95 AMP alternator (LS)
- KRC 15425702 LS Pro Series water pump (7.02" length)
- KRC 15203000 LS CT525 dirt water bypass kit

### KIT ADD PUMP, BELTS. PULLEYXXXXX

## KRC Power Steering Fluid

### High Performance Racing & Hot Rod Fluid

Reduces Foaming & Cavitation Providing Exceptional Seal Protection  
 Petroleum Based for Superior Lubrication & Corrosion Prevention  
 Runs Quite & Reduces Friction Extending Steering System Life  
 Performance Tested by Professional Race Teams  
 Engineered & Performance Tested On Our Custom Pump Dyno

### Quart

### PSF 10032001



KRC Power Steering Fluid is engineered to perform. Our innovative formula is petroleum based for superior performance. Reduced operating temperatures, quiet operation, extended seal & steering system component life are built into our Dyno Developed formula. Corrosion Protection, reduced foaming & cavitation elimination are the result of feedback from professional race teams worldwide.

# LS Alternator and Water Pump Drive Kits

## CT525 Alternator Add-On Kits

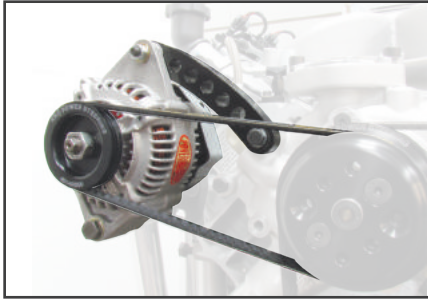

### KIT 77525060

CT525 Alternator Add-On Kit (163mm bolt pattern 95 AMP Alternator Included)

#### Kit Components

- KRC 40140340 Alternator pulley, 3-Groove 2.5"
- KRC 70510525 CT525 Alternator Bracket
- POW 8132-KRC Denso 12-Volt 95-Amp (for LS)
- GDY 4030267 3-Rib x 26.5" serpentine belt
- KRC 40510950 Alternator Ground Strap Kit

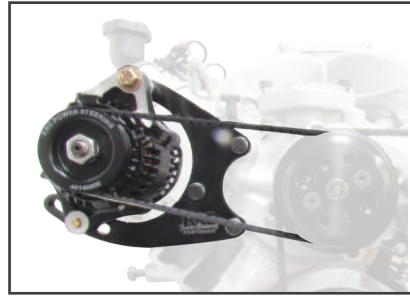

### KIT 77525075

CT525 Alternator Add-On Kit (138mm bolt pattern, 50 or 85 AMP Alternator Sold Separately. Applicable alternators are the POW 8162, POW 8166, POW 8172 or POW 8182 )

#### Kit Components

- KRC 40140340 Alternator pulley, 3-Groove 2.5"
- KRC 70515525 CT525 Dirt alternator Bracket
- GDY 4030260 3-Rib x 26.0" serpentine belt
- KRC 40510950 Alternator Ground Strap Kit

## Complete CT525 Single Drive Kits

**CT525 kits require a bellhousing mounted power steering pump**



### KIT 77525200

Complete CT525 Single Drive Dirt Kit with Water Pump

#### Kit 77525200 Components

- KRC 70400525 CT525 Dirt Tensioner, for Stewart water pump
- KRC 38152500 CT525 R-LOK crank adapter
- KRC 38232500 R-LOK serpentine crank pulley 3.25"
- KRC 38025400 SB Chevy and SB Ford 4.0" W/P pulley
- GDY 4060260 6-Rib x 26.0" serpentine belt
- KRC 72525960 CT525 dirt hardware kit
- KRC 15200000 LS -4 water bypass adapters (2)
- KRC 15203000 LS CT525 dirt water bypass kit
- KRC 15425702 LS Pro Series water pump (7.02" length)
- KRC 79000000 LS engine mounts

### KIT 77525201

Complete CT525 Single Drive Dirt Kit with Water Pump **without LS to SBC engine mounts**

## KIT 77525050

### Chevrolet CT525 Complete Dirt Front Engine Kit

Complete CT525 Dirt Kit with Head Mount with Stewart Water Pump; Power Steering Pump, Water Pump & Belt Sold Separately



### KIT 77525050 Components:

- KRC 15425702 CT525 water pump (7.025" Length)
- KRC 15200000 LS -4 water bypass adapters (2)
- KRC 38025400 SB Chevy 4.0" water pump pulley
- KRC 38152500 -CT525 R-LOK crank adapter
- KRC 70400525 CT525 tensioner, Stewart water pump
- KRC 72525960 CT525 hardware kit
- KRC 71410525 CT525 head mount bracket kit
- KRC 15203000 LS CT525 water bypass kit
- KRC 38232500 R-LOK serpentine crank pulley, 3.25"

## Bellhousing Alternator Mounting Bracket Kit Add-On

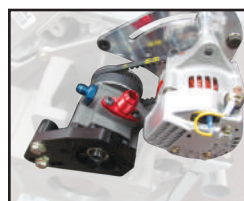

### KRC 40964000

See Next Page for Full Details >>>>>>>

# Chevrolet LS Water Pump Only Drive Kit

## Chevrolet LS Under-Drive Water Pump Pulley Kits

The Chevrolet LS under-drive water pump pulley kits are mainly used in dirt-track racing applications where a clockwise rotation water pump is required allowing the use of a mechanical fan. LS Under-Drive Kits work in conjunction with a bellhousing mounted Pro or Elite Series aluminum power steering pump or a Dry-Sump mounted Pro/Elite Series power steering pump. See the rear alternator mounting bracket kit below. Other configurations available.



### KRC 37752000

20% Reduction Water Pump only drive

#### KRC 37752000 Components

- KRC 70400525 CT525 Dirt Tensioner, for Stewart water pump
- KRC 38152500 CT525 R-LOK crank adapter
- KRC 38232500 R-LOK serpentine crank pulley 3.25"
- KRC 38025400 SB Chevy and SB Ford 4.0" W/P pulley
- GDY 4060260 6-Rib x 26.0" serpentine belt
- KRC 72525960 CT525 dirt hardware kit

### KRC 37753000

25% Reduction Water Pump only drive. Same as KRC 37752000 Except with KRC 38230000, 3.0" diameter crank pulley

## Featured Components in KIT 77525200 shown on the Left Page



KRC 70400525  
CT525 Idler-Tensioner



KRC 15203000  
LS CT525 dirt water bypass kit

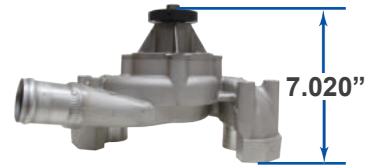

KRC 15425702  
Water Pump

## Bellhousing Alternator Mounting Bracket Kit Add-On

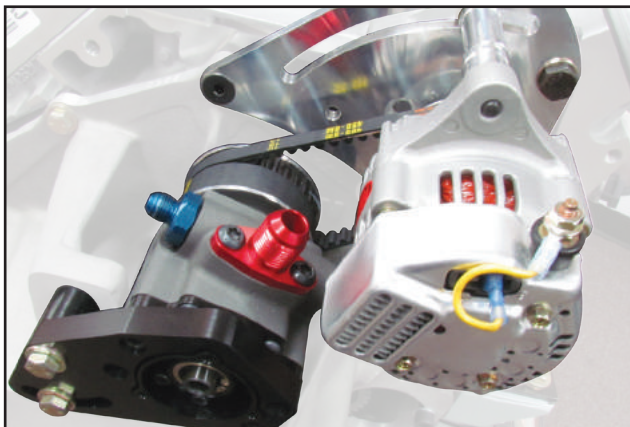

### KRC 40964000

A lack of voltage to the ignition can rob horsepower. Stay at full voltage with our bellhousing alternator mount kit for Brinn, Bert, and some others. This kit includes all hardware, a rear alternator bracket, 24TH HTD Denso alternator pulley, and two HTD belts; one to drive the alternator and one to replace the pump drive belt in the kits on the left-hand page. Belt lengths are for Pro & Elite Series power steering pumps only. **Alternator and power steering pump sold separately.**

**NOTE:** 1st design KRC aluminum power steering pumps require a 20mm x 536mm and a 10mm x 512mm HTD belts.

# Chevy CT525 Accessories



A fixed idler-tensioner with high temperature bearing and aluminum pulley is included to provide a solid tensioning system, unlike spring loaded tensioners. A Top Quality belt drives everything.

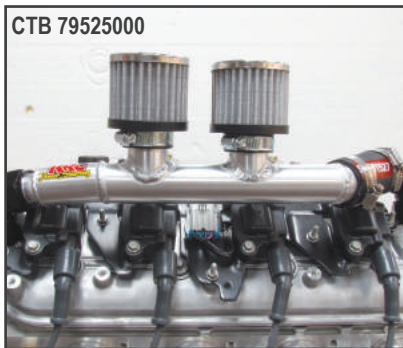

KRC CT525 engine breather kit mounts to the factory bungs. It sits at an angle to allow the oil to drain back properly. It also includes four baffles welded into the main breather tube. It includes an aluminum breather tube, two breathers, fittings, and connector hose.

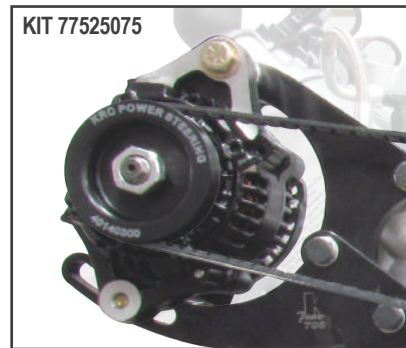

CT525 Alternator Add-On Kit For Denso Alternator (138mm bolt pattern, 50 AMP Alternator Sold Separately. Other applicable alternators are the POW 8162, POW 8166, POW 8172 or POW 8182)

## Chevrolet CT525 Parts and Accessories



### LS Engine Mounts (Pair)

KRC 79000000

KRC engine mounts will bolt a LS based engine into the exact same location as a Small Block Chevrolet on most racing chassis using Howe type frame mounts. Includes hardware.

### KRC Surge Tank

SUR 95000000

Required on CT525 Pavement Kits. Tank has a billet aluminum



KRC 15203000

LS CT525 Water Pump Bypass Hose Kit

### LS CT525 Water Bypass Kit

KRC 15203000

CT525 LS engines utilizing a KRC water pump. It requires a KRC 15200000 bypass adapter kit.



KRC 15200000

-4 AN LS Water Bypass adapter kit (pair)



# LS Truck Power Steering Pump Kit

## KIT 763XXXXX NEED NEW PART NUMBER BOM

The KRC LS kit utilizes as many factory components as possible to make it an easy and inexpensive swap to get a better steering pump for your off-road vehicle or GM truck engine. A Block mounting bracket, pulley, & a belt are included. Add the Power Steering Pump to meet your needs (Sold Separately).

### Kit 763XXBOM components include:

- **KRC 50219650** 6.5" 6-Rib serpentine pulley (LS/LS6)
- **KRC 71415327** LS pump mounting bracket
- **GDY 4060935** 93.5" Serpentine belt
- All appropriate hardware

**Power Steering Pump & Pulley Sold Separately**

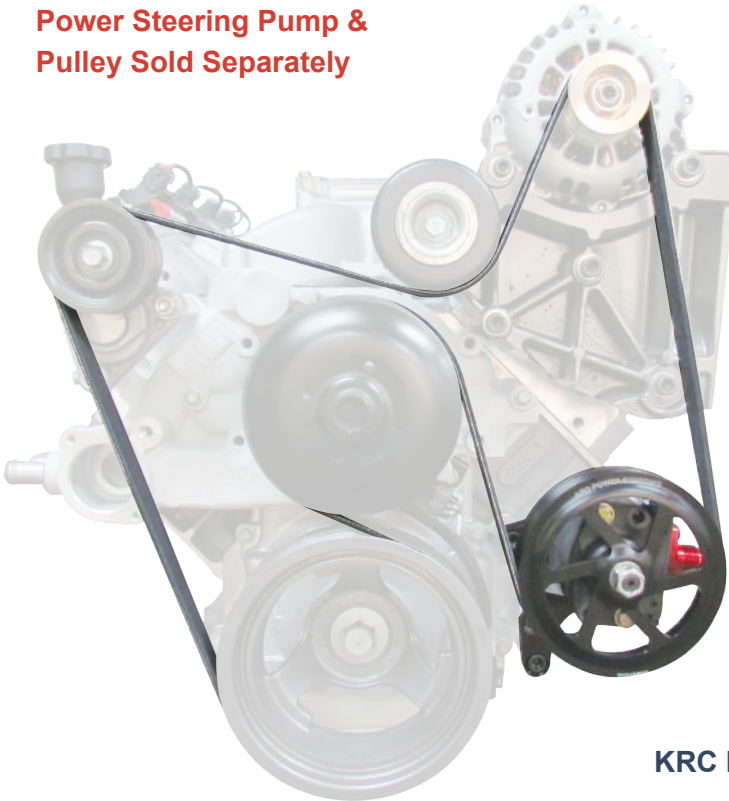

## KRC Pro Series III Power Steering Pumps



- PS3 26116811**  
5.9CC Pro Series III Pump Only
- PS3 27116811**  
7.2CC Pro Series III Pump Only
- PS3 29116811**  
9.6CC Pro Series III Pump Only

- PS3 26116813**  
5.9CC Pro Series III Pump W/Tank
- PS3 27116813**  
7.2CC Pro Series III Pump W/Tank
- PS3 29116813**  
9.6CC Pro Series III Pump W/Tank



## KRC ELITE Series Power Steering Pumps

- ESP 10096000**  
Elite Series Power Steering Pump 9.6CC

- ESP 10096100**  
9.6CC Pro Series III Pump W/Tank  
9.6CC



## Elite Series Pulleys

- KRC 40610600**
- KRC 40160600**
- KRC 40160000**

**ADD LS Images & #'s for pulleys**

## LS Truck Power Steering Kit Features



**KRC 20019650**  
6.5" 6-Rib serpentine pulley  
(For Pro Series III Pump)



**KRC 71415000**  
LS Pump Mounting Bracket  
(Fits all KRC pumps and GM Saginaw TC style pumps.)

# Chevrolet F-Body & Y-Body Front Engine Kits

Our F-body and Y-body front engine kits are available in multiple configurations to suit your needs. They utilize your factory water pump and harmonic balancer and it features a special alternator that hugs the block tightly for clearance in street rods and many other applications.



## KIT 763XXXXX BOM

Complete Y-Body Front Engine Kit - Uses your O.E.M Damper & water pump pulley. Power Steering Pump Sold Separately

### Kit Components:

- KRC 70550000 LS alternator bracket, and tensioner kit
- POW 8206 CS130D(C) 115 AMP Camaro offset
- KRC 40150640 6-Groove 3.5" Alternator pulley
- KRC 20020650 6.5" Pro Series Pulley
- GDY 4060798 6-Rib X 79.8" belt
- KRC 71410040 F-Body & Y-Body head mount bracket
- KRC 70470040 Y-Body deluxe manual tensioner
- All appropriate hardware.



## KIT 763XXXX BOM

Complete F-Body Front Engine Kit with Bolt-On Tank - Uses your O.E.M Damper and water pump pulley.

### Kit Components:

- KRC 70550000 LS alternator bracket, and tensioner kit
- POW 8206 CS130D(C) 115 AMP Camaro offset
- KRC 20020650 6.5" Pro Series Pulley
- KRC 40150640 6-Groove 3.5" Alternator pulley
- GDY 4060798 6-Rib X 79.8" belt
- KRC 71410040 F-Body & Y-Body head mount bracket
- KRC 70470080 F-Body deluxe manual tensioner
- All appropriate hardware.



## KIT 763XXXXXBOM

same as KIT 763XXXXX without tensioner; use your own tensioner, in location shown as "A" Above



## KIT 76XXXXX BOM

same as KIT 763XXXXX without tensioner; use your own tensioner, in location shown as "A" Above

# LS Corvette & Camaro Idler-Tensioners

KRC offers two fixed adjustable idler-tensioner bracket & pulleys for Y-Body & F-Body LS engines. KRC tensioners replace the factory spring loaded piece that can wear out over time. Wear can throw the belt off on higher horsepower engines. Made from billet aluminum, KRC tensioners feature a large adjustment slot for adaptability on non-factory pulley system applications. Our tensioners feature a third mounting point, instead of the factory two, creating a solid assembly for high horsepower engines. The pulley mounts on a steel shaft for added strength. KRC manufactures tensioners for both Y-Body & F-Body pulley systems. Our Deluxe version features an aluminum hard anodized idler pulley with tall rock guards & a high temperature bearing. The Economy version features a factory-type elastomer pulley & bearing assembly.

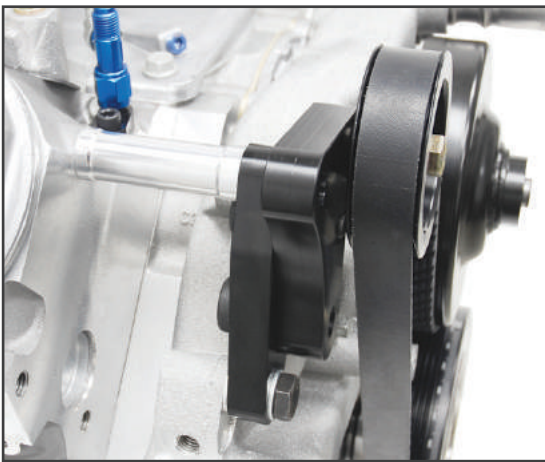

Third mounting point bolts to the cylinder head creating additional tensioner support.



The Idler pulley spins on a steel shaft providing extra strength & support for the pulley.

## Deluxe



### KRC 70470050

F & Y-Body Deluxe Manual Tensioner Kit Includes a KRC machined aluminum pulley.

## Economy



### KRC 70475040

Y-Body Economy Manual Tensioner Kit with plastic O.E.M. Style pulley

### KRC 70475080

F-Body Economy Manual Tensioner Kit with plastic O.E.M. Style pulley

## Idler without Pulley



### KRC 70480040

Y-Body Manual Tensioner Kit without Pulley

### KRC 70480080

F-Body Manual Tensioner without Pulley

# Ford Engine Kits

## Ford D347SR and S347JR Complete Front Engine Kits

The D347SR and S347JR crate engines are the latest sealed engines from the Ford Racing factory. KRC has worked with Ford Motorsport directly to develop these pulley systems for both pavement and dirt cars. We have taken all the guess work out of getting a pulley system aligned on the front of the engine. These kits will work with any Ford engine that uses a Ford Motorsport water pump and standard 3-bolt harmonic balancer. Everything you need to complete the engine drive kit is included in one box. **Get your kit today.**

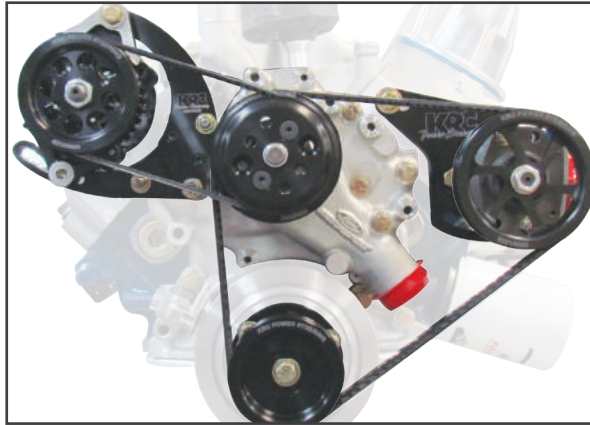

### **KIT 66347615**

Complete D347SR/S347JR Short Deck Pavement Front Engine Kit With Denso Alternator Bracket.

Power Steering Pump Sold Separately

#### **Kit 66347615 Components:**

- **KRC 31610000** SB Ford Short Deck LH Pump Mount
- **KRC 40150340** Alternator Pulley 3-Groove 3.5"
- **KRC 40610401** ASM, high Mount Ford Denso Bracket
- **KRC 38025400** SB Ford 4.0" Water Pump Pulley
- **GDY 4030240** 3-Rib 24.5" Serpentine Belt
- **KRC 38235000** R-LOK Serpentine Crank Pulley 3.5"
- **KRC 38161000** R-LOK Crank Adapter 3-Bolt Ford
- **KIT 66347915** Hardware Kit



### **KIT 66347620**

Complete D347SR/S347JR Short Deck Dirt Front Engine Kit Power Steering Pump, Belt Sold Separately

#### **Kit 66347620 Components:**

- **KRC 31610000** SB Ford Short Deck LH Pump Mount
- **KRC 40410210** Assembled SB Ford Idler
- **KIT 66374920** Hardware Kit
- **KRC 38025400** SB Ford 4.0" Water Pump Pulley
- **KRC 38235000** R-LOK Serpentine Crank Pulley 3.5"
- **KRC 38161000** R-LOK Crank Adapter 3-Bolt Ford

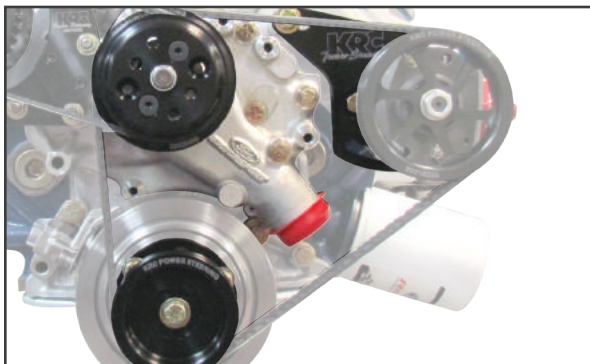

### **KIT 66347612**

Ford 347SR/JR Short Deck Basic Kit without Power Steering Pump

#### **Kit Components:**

- **KIT 66347912** Hardware Kit
- **KRC 31610000** SB Ford Left Head Pump Mount
- **KRC 38161000** R-LOK Crank Adapter 3-Bolt Ford
- **KRC 38025400** SB Ford 4.0" Water Pump Pulley
- **KRC 38235000** R-LOK Serpentine Crank Pulley 3.5"

Power Steering Pump, Belt Sold Separately

# Ford S374W Complete Front Engine Kits

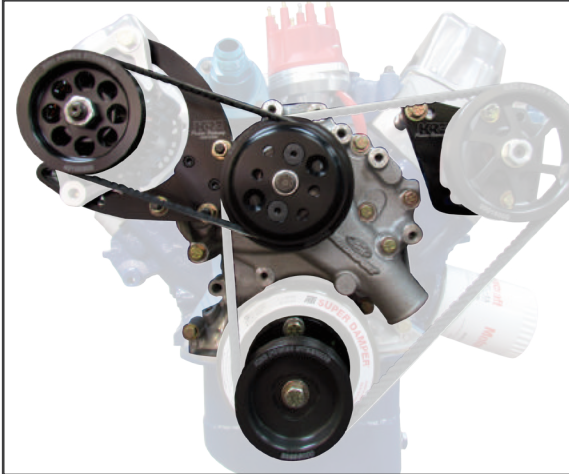

## KIT 66374615

Complete Ford S374W Tall Deck Pavement Kit With Denso Alternator Bracket & Pulley  
Power Steering Pump, Belt Sold Separately

### Kit 66374615 Components:

- KRC 31620000 SB Ford Tall Deck LH Pump Mount
- KRC 40150340 Alternator Pulley 3-Groove 3.5"
- KRC 40610401 ASM, high Mount Ford Denso Bracket
- KRC 38230000 R-LOK Serpentine Crank Pulley 3.0"
- KRC 38025400 SB Ford 4.0" Water Pump Pulley
- KRC 38161000 R-LOK Crank Adapter 3-Bolt Ford
- KIT 66347915 Hardware Kit
- GDY 4030245 3-Rib 24.5" Serpentine Belt

Power Steering Belt & Pulley for above kits Sold Separately



## KIT 66374620

Complete Ford S374W Tall Deck Dirt Kit With Idler/Tensioner  
Power Steering Pump, Belt & Pulley Sold Separately

### Kit 66374620 Components:

- KRC 31620000 SB Ford Tall Deck LH Pump Mount
- KRC 40410210 Assembled SB Ford Idler
- KRC 38230000 R-LOK Serpentine Crank Pulley 3.0"
- KRC 38025400 SB Ford 4.0" Water Pump Pulley
- KRC 38161000 R-LOK Crank Adapter 3-Bolt Ford
- KIT 66347920 Hardware Kit

## KRC 20015000

4.2" 6-Rib Serpentine Pulley for Aluminum Pump



GDY 4060374 6-Rib 37.4" Serpentine Belt

## Small Block Ford Serpentine Kit

Complete SB Ford Front Engine Serpentine Pulley  
Kit With Pro Series III Pump & DENSO Alternator

### Kit 66347610 components:

- PS3 27116813 7.2CC Pro Series III Power Steering Pump
- POW 8162 DENSO 12V 50 Amp Heavy Duty Alternator
- GDY 4030240 3-Rib 24.0"
- GDY 4060380 6-Rib 38.0"
- KRC 20017600 6.0" Aluminum Serpentine Pulley
- KRC 31610000 SB Ford Kit (Short deck 260, 289, 302CI)
- KRC 38025400 Ford 4.0" Water Pump Pulley
- KRC 38161000 R-LOK Crank adapter 3-Bolt Ford
- KRC 40510950 Alternator ground strap kit
- KRC 40130340 1.75" DENSO Alternator pulley
- KRC 40610450 Ford Mid-Mount DENSO Alternator bracket
- KRC 38230000 R-LOK Serpentine crank pulley, 3.0"
- KRC 38230000 R-LOK Hex crank nut end cap
- KIT 66347915 R-LOK Ford 347SR/JR Alternator hardware kit

**NEW Photo**

# Water Pump Drive Only Kits

## Ford D347SR and S347JR Water Pump Only Drive Kits

Water pump only drive kits were designed for Dirt Late Model applications where the engine is equipped with a large fan with a lot of pitch in the blades. The power steering pump is normally mounted on the dry-sump pump or directly on a Bert or Brinn bellhousing. These KRC drive kits fit all small block Ford 8.2" - 8.5" deck height engines.

### Rear view KIT 66347026



UPDATE PHOTOS

### KIT 66347026

Ford 347SR/JR water pump only drive kit  
Power Steering Pump Sold Separately

#### Kit 66347026 Components:

- KIT 66347922 Hardware kit for 66347022
- KRC 40410210 Assembled SB Ford idler
- GDY 4060260 6-Rib 26.0" serpentine belt
- KRC 38025400 SB Chevy and SB Ford 4.0" W/P pulley
- KRC 38235000 R-LOK serpentine crank pulley, 3.5"
- KRC 38161000 R-LOK crank adapter, 3-bolt Ford

### KRC 60750000

**Bellhousing Pump Mounting Bracket for Pro Series Power Steering Pumps**



### KRC 40860000

A lack of voltage to the ignition can rob horsepower. Stay at full voltage with our bellhousing alternator mount kit for Brinn, Bert, and some others. This kit includes all hardware, a rear alternator bracket, 24TH HTD Denso alternator pulley, and two HTD belts; one to drive the alternator and one to replace the pump drive belt in the kits on the left-hand page. Belt lengths are for Pro Series power steering pumps only. **Alternator and power steering pump sold separately.**

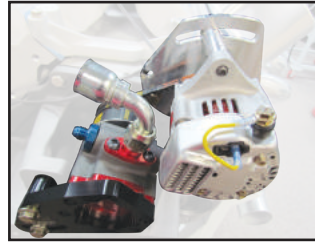

### KIT 66374026

## Ford S374W Water Pump Only Drive Kits

Water pump only drive kits were designed for Dirt Late Model applications where the engine is equipped with a large fan with a lot of pitch in the blades. The power steering pump is normally mounted on the Dry-Sump pump or directly on a Bert or Brinn bellhousing. These kits fit all small block Ford 9.2" - 9.5" deck height engines.

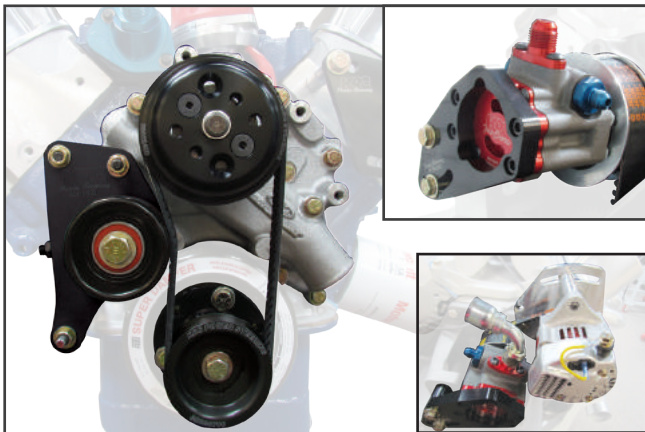

### Back of KIT 66374026

Optional Bellhousing Kits Shown  
Sold Separately

#### Kit 66374026 Components:

- KIT 66347922 Hardware kit for 66374026
- KRC 40410210 Assembled SB Ford idler
- GDY 4060250 6-Rib 25.0" serpentine belt
- KRC 38025400 SB Chevy & SB Ford 4.0" W/P pulley
- KRC 38228700 R-LOK serpentine crank pulley, 2.870"
- KRC 38161000 R-LOK crank adapter, 3-bolt Ford

# Ford Boss 302 Coyote Hydraulic Power Steering Pump Conversion Kit

KIT 66302001

The KRC Boss Coyote Power Steering Pump Kit converts the factory 2013 Ford Mustang electric power steering to hydraulic power steering. Our kit allows the use of the Ford factory AC, OEM accessories & belts. The kit includes the power steering mounting bracket, belt & water pump pulley. Add the KRC Power Steering Pump of your choice & a 6" Serpentine Pulley. **Power Steering Pump & Pulley Sold Separately.**

## Kit components include:

**KIT 66302001**

- KRC 66302301 Coyote water pump pulley
- KRC 66302500 Coyote power steering pump bracket
- GDY 4050280 5-Rib X 28.0"
- All appropriate hardware

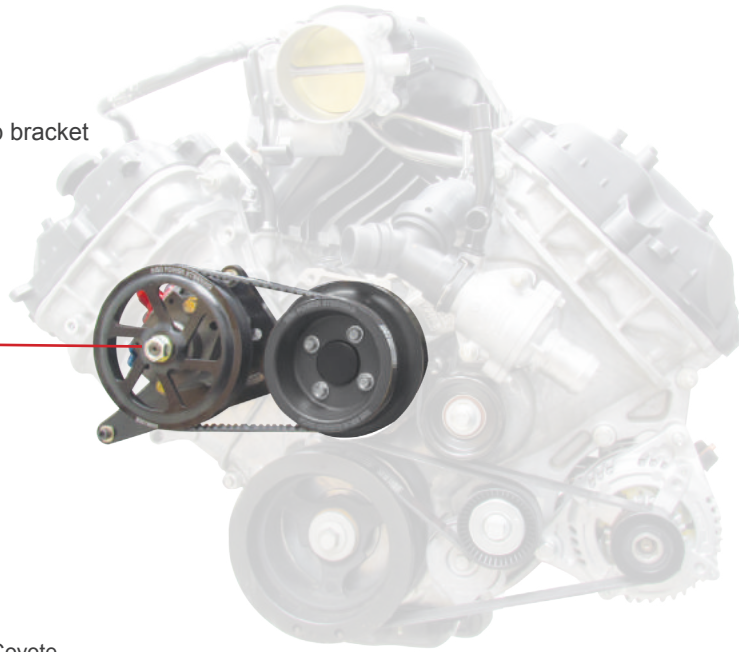

## KIT 66302001 Detail



The KRC Coyote T head. The engineered tight space found in the Coyote engine. The KRC Coyote T III & Elite Series Pumps. **Pumps/Pulley Sold Separately.**



PS3 29126811  
Aluminum Pro Series  
Power Steering pump with

## Coyote Tank KRC 91412000

## Kit Features



**KRC 66302300**  
Water Pump Pulley  
with **GDY 4050280**  
5-Rib X 28.0".

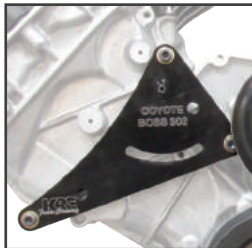

**KRC 66302500**  
Coyote Power Steering  
Mounting Bracket.



**KRC 20019600**  
6.0" Aluminum Serpentine  
Pulley shown on a KRC  
Power Steering Pump.  
**Tank & Pump Sold Separately.**



**ESP 10096000**  
KRC Elite Series  
Power Steering Pump.  
Affordable Quality.

# Small Block Ford HTD Kits

## Short Deck

**KIT 66347610**

Power Steering Pump, Pulley Sold Separately

### Kit 66347610 components:

- KRC 31611000 SB ford short deck left head mounting bracket
- KRC 38215375 R-LOK to R-LOK spacer .375"
- KRC 88208095 Mini R-LOK to R-LOK adapter
- KRC 86508032 32TH HTD oil pump pulley w/ C-LOK
- KRC 81508024 24TH HTD denso alternator pulley
- KRC 40610400 ford high denso alternator bracket
- KRC 88208019 19TH R-LOK HTD crank pulley
- HTD 45020632 HTD belt, 20mm x 632mm 79TH
- HTD 45010576 HTD belt, 10mm x 576mm 72TH
- KRC 38207000 Mini R-LOK hex crank nut end cap
- KRC 88008037 37TH HTD water pump pulley
- KIT 38161500 R-LOK pro crank hub 3-bolt
- KRC 88208032 32TH R-LOK crank pulley
- FRD 66374DRY-930 Ford Dry-Sump hardware kit

## Tall Deck

**KIT 66374610**

Power Steering Pump, Pulley Sold Separately

### Kit 66374610 components:

- KRC 31621000 SB ford tall deck LH mounting bracket
- KRC 38215375 R-LOK to R-LOK spacer .375"
- KRC 88208095 Mini R-LOK to R-LOK adapter
- KRC 86508032 32TH HTD oil pump pulley w/ C-LOK
- KRC 81508024 24TH HTD denso alternator pulley
- KRC 40610400 ford high denso alternator bracket
- KRC 88208019 19TH R-LOK HTD crank pulley
- KRC 38335000 3.5" V-Belt R-LOK pulley
- HTD 45020632 HTD belt, 20mm x 632mm 79TH
- HTD 45010576 HTD belt, 10mm x 576mm 72TH
- KRC 38207000 Mini R-LOK hex crank nut end cap
- KRC 63201000 Pro Series pump with V-Belt pulley
- KRC 88008037 37TH HTD water pump pulley
- KIT 38161500 R-LOK pro crank hub 3-bolt
- KRC 88208032 32TH R-LOK crank pulley
- FRD 66374DRY-930 Ford Dry-Sump hardware kit

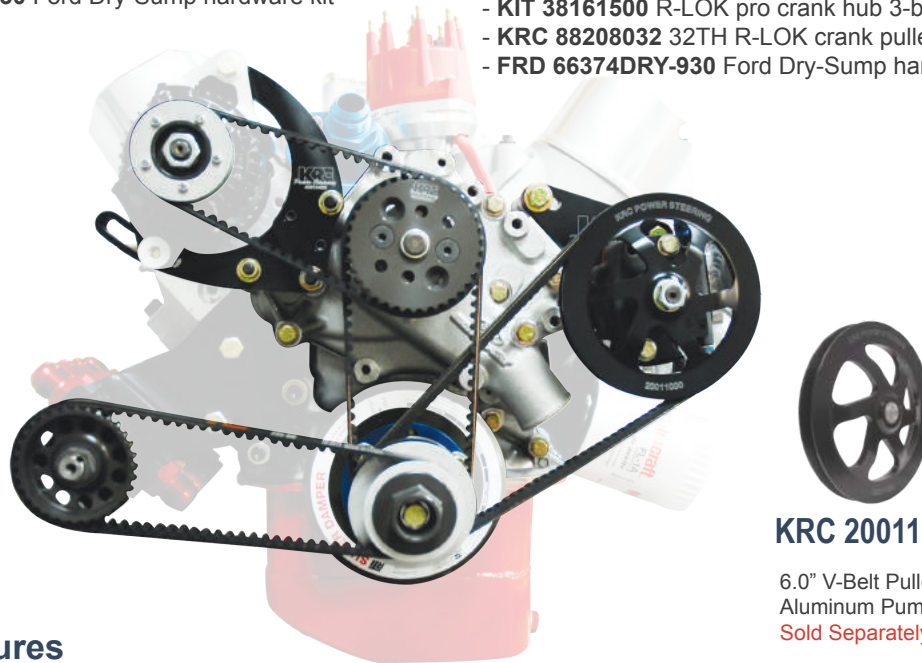

**KRC 20011000**

6.0" V-Belt Pulley for Aluminum Pump  
Sold Separately

### Kit Features

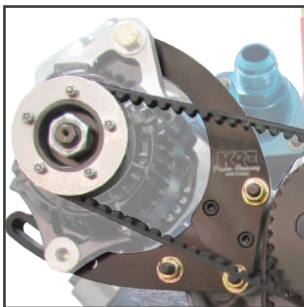

KRC 40610400 ford high Denso alternator bracket and KRC 81508024 24TH HTD Denso alternator pulley.

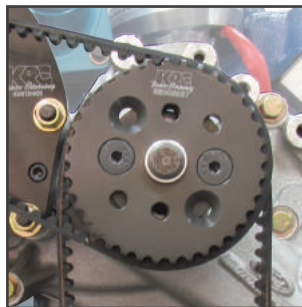

KRC 88008037 37TH HTD water pump pulley

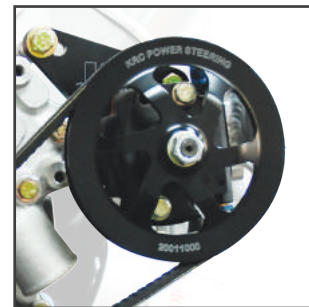

KRC 31621000 SB ford left head pump mounting bracket.  
Power Steering Pump Sold Separately



# Ford Serpentine Pulley Kits



### KRC 38620000

1-to-1 Serpentine pulley kit for Small Block Ford 3-Bolt Crank Adapter, Crank Pulley-3.5" Water Pump Pulley -3.5"



### KRC 38625000

1-to-1 Serpentine pulley kit for Small Block Ford 4-Bolt Crank Adapter, Crank Pulley-3.5" Water Pump Pulley -3.5"



### KRC 38610000

15% Serpentine pulley kit for Small Block Ford 3-Bolt Crank Adapter, Crank Pulley-3.0" Water Pump Pulley -3.5"



### KRC 38615000

15% Serpentine pulley kit for Small Block Ford 4-Bolt Crank Adapter, Crank Pulley-3.0" Water Pump Pulley -3.5"



### KRC 38600000

30% Serpentine pulley kit for Small Block Ford 3-Bolt Crank Adapter, Crank Pulley-2.5" Water Pump Pulley -3.5"



### KRC 38605000

30% Serpentine pulley kit for Small Block Ford 4-Bolt Crank Adapter, Crank Pulley-2.5" Water Pump Pulley -3.5"

## Water Pump Only/Single Belt Drive Kits with Idler-Tensioner

KRC water pump only/single belt serpentine drive kits are available in 1-to-1, 15% & 30% ratios for Small Block Ford engines. Each kit includes a Pro Series water pump pulley, R-LOK crank pulley, R-LOK crank adapter, idler-tensioner bracket & pulley, system belt, appropriate hardware & spacers. Detailed instructions are included.



### KRC 37651000

1-to-1 Pro Series Water Pump Only Drive Kit with Idler-Tensioner 4.0" Crank Pulley



### KRC 37652000

15% Pro Series Water Pump Only Drive Kit with Idler-Tensioner 3.5" Crank Pulley

### KRC 37653000

30% Pro Series Water Pump Only Drive Kit with Idler-Tensioner 3.0" Crank Pulley

#### Notes:

**Ford:** Ford single drive kits are designed for standard blocks with 5/16" x 18 tapped holes at the timing pointer. Boss 302/351 & R302 blocks have 3/8" x 16 tapped holes. If you have Boss 302/351 & R302 blocks - please give us a call & we will provide information ensuring you identify the correct parts for the desired package.

# Dodge Front Engine Kits

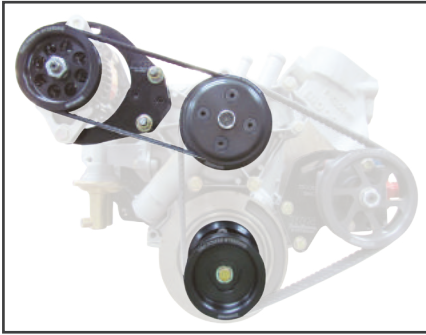

## KIT 16515600

Complete Dodge 360 Crate engine Kit with Denso Alternator Bracket.

Power Steering Pump Sold Separately

### Kit Components:

- KRC 31515000 360 Dodge block pump mounting bracket
- KRC 38050400 4.0" Dodge water pump pulley
- KRC 40710200 138MM Dodge Denso Alternator bracket kit
- GDY 4030267 3-Rib X 26.5" belt
- KRC 38500900 Hardware kit
- KRC 40150300 3-Rib 3.5" alternator pulley
- KRC 38235000 3.5" R-LOK serpentine crank pulley
- KRC 38150000 R-LOK crank adapter



## KRC Power Steering Fluid

KRC Power Steering Fluid is manufactured to perform. We test and retest our fluid on the KRC Power Steering Pump Dyno to ensure that your KRC Power Steering Pump operates the same from race start to race finish.



## KRC 40400500

**NEW!** Idler Tensioner for Dodge 360

## Belt Size Chart

	Pro Series Aluminum Belt #	Belt Length	Cast Iron 1st Design Belt #	Belt Length
1-1	GDY 4060345	34.5"	GDY 4060335	33.5"
15%	GDY 4060340	34.0"	GDY 4060330	33.0"
30%	GDY 4060335	33.5"	GDY 4060335	33.5"



## KRC Power Steering Pump Dyno

Our custom Power Steering Pump Dyno was manufactured by the same company that makes pump dyno's for the United States Air Force. We test every Pro Series III pump and place the dyno sheet right in the box.

# Bellhousing Alternator Mounting Bracket Add-On Kits

A lack of voltage to the ignition can rob horsepower. Stay at full voltage with our bellhousing alternator mount kit for Brinn, Bert, & some more. Belt lengths are for Pro Series Power Steering Pumps Only. **Alternator & power steering pump sold separately.**

## Chevrolet

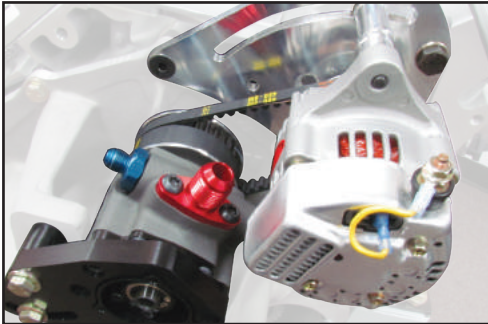

### KRC 40964000

The KRC Chevy Bellhousing Mounting Kit includes all hardware, a rear alternator bracket, 24TH HTD Denso alternator pulley, & two HTD belts (one to drive the alternator & one to replace the pump drive belt). The power steering pump belt included is for a 40TH pump pulley. Power Steering Pump (Sold Separately) needs a downward facing fitting.

## Ford



### KRC 40860000

The KRC Ford Bellhousing Mounting Kit includes all hardware, a rear alternator bracket, 24TH HTD Denso alternator pulley, & two HTD belts (one to drive the alternator & one to replace the pump drive belt). The power steering pump belt included is for a 32TH pump pulley. Power Steering Pump (Sold Separately) needs to have a downward facing fitting.

## Dry-Sump

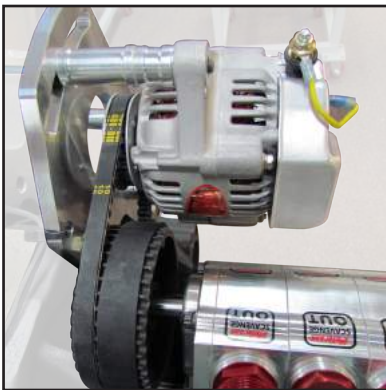

### KRC 40970000

KRC Alternator Dry Sump Drive Kit includes all hardware, a rear alternator bracket, 24TH HTD Denso alternator pulley, 40TH 40mm wide HTD Dry Sump Pulley with C-LOK, & two 40TH HTD Rock Guards. (Dry Sump & Dry Sump bracket not included).

## KSE



### KRC 40980000

The KRC to KSE Dry Sump Drive Kit includes all hardware, a rear alternator bracket, 24TH HTD Denso alternator pulley, 40TH 40mm wide HTD pulley with C-LOK, two 40TH HTD Rock Guards, & two HTD belts (one to drive the alternator & one to replace the pump drive belt).

NOTE: KSE Rear alternator bracket kit Pump Mounting Bracket not included, use your KSE bellhousing mounting bracket.

# ALUMINUM V-BELT PULLEYS

**KRC 20008000**  
3.5in V-Belt Pulley for KRC  
Splined Aluminum Pump Shafts



**KRC 20013000**  
8.0in V-Belt Pulley for  
KRC Splined Aluminum  
Pump Shafts



KRC offers an extensive line of front engine pulleys. All KRC pulleys are CNC-Machined from 6061-T6 aluminum. Exacting tolerances are produced by our experienced machine shop team. Our serpentine pulleys offer 30% more surface area, for increased belt contact, than other manufacturers. Every KRC serpentine pulley is machined to SAE specifications.

**KRC 20011000**  
6.0in V-Belt Pulley for KRC  
Splined Aluminum Pump Shafts



# ALUMINUM 3-RIB PULLEYS

**KRC 20015300**  
4.2in 3-Rib Serpentine Pulley for  
KRC Splined Aluminum Pump Shafts



**KRC 20017300**  
6in 3-Rib NASCAR Serpentine  
Pulley for KRC Splined  
Aluminum Pump Shafts



All KRC pulleys are black, hard anodized to 62- Rockwell hardness. Mill finish is available by special order.

**KRC 20030500**  
4.95in 3-Rib Serpentine Pulley  
for KRC Splined Aluminum  
Pump Shafts



# ALUMINUM 6-RIB PULLEYS

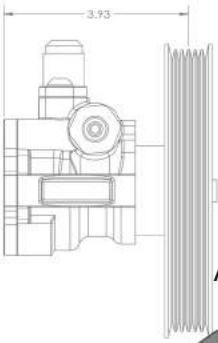

**KRC 20017600**  
6.0in 6-Rib Serpentine Pulley for KRC Splined Aluminum Pump Shafts

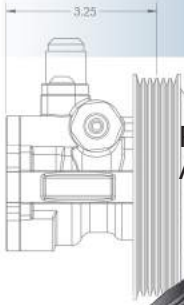

**KRC 20015000**  
4.2in 6-Rib Serpentine Pulley for KRC Splined Aluminum Pump Shafts



**KRC 20019462**  
4.62in 6-Rib Serpentine Pulley for KRC Splined Aluminum Pump Shafts

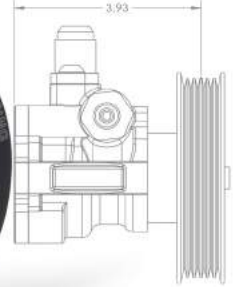

KRC Pro Series III Power Steering Pumps have a 17-spline shaft retained by a nut & washer.  
KRC Cast Iron Pumps have a different register than the Pro Series. The spline is the same, but the register is different.  
*KRC Cast Iron & KRC Aluminum Pro Series Pump Pulleys are not interchangeable. The cast iron pump register measures 0.668in while the aluminum pump register measures 0.590in.*

All KRC pulleys are black, hard anodized to 62- Rockwell hardness. Mill

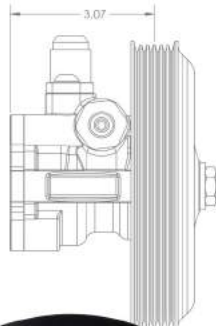

**KRC 20020650**  
6.5in 6-Rib Serpentine Pulley Y-Body LS Offset for KRC Splined Aluminum Pump Shafts



**KRC 20020600**  
6.0in 6-Rib Serpentine Pulley Y-Body LS Offset for KRC Splined Aluminum Pump Shafts

**KRC 20019600**  
6.0in 6-Rib Serpentine Pulley F-Body LS Offset for KRC Splined Aluminum Pump Shafts



# R-LOK Modular Pulley Systems

## The Revolutionary KRC Modular Pulley System

KRC R-LOK crankshaft adapters allow for a complete modular system in which pulleys can be changed in minutes. Available for Chevrolet, Ford & Dodge engines. KRC adapters are made from 6061-T6 aluminum & are fully CNC machined including weight reduction pockets. Anodized black.

## Why KRC R-LOK compared to pin-drive and mandrel systems?

KRC R-LOK adapters reduce side loads on damper bolts which is a problem on typical mandrel type systems. The KRC R-LOK system is more concentric than pin-drive systems. With a pin drive system, you may get some run out on the pulley due to the inconsistency of pressing in dual pins. The KRC R-LOK system components are machined from a center point ensuring proper pulley centering to the crank adapter & damper.

### Chevrolet Crank Adapters



**KRC 38130000**  
R-LOK Crank Adapter Big Block Chevy or SBC W/ BB ATI damper 1.045" long, 2.280" Register



**KRC 38140000**  
R-LOK Crank Adapter Small Block Chevrolet 1.245" long, 1.243" Register



**KRC 38140500**  
Pro R-LOK Crank Adapter Small Block Chevrolet 1.245" long, 1.243" Register



**KRC 38140600**  
Pro R-LOK Crank Adapter SB Chevy 2 Piece .620" long 1.243" Register



**KRC 38140920**  
R-LOK Crank Adapter SB Chevy .920" long for use with Crank Trigger 1.243" Register



**KRC 38152500**  
CT525 R-LOK Crank Adapter 1.015" long. For CT525 with ATI Balancer



**KRC 40200200**  
R-LOK Crank Adapter Small Block Chevrolet 1.045" long, 1.243" Register



**KRC 40205000**  
Pulley Adapter, Use SB Pulleys on BB Chevrolet Balancer. Adapts register from 2.280" to 1.243" register.

**NOTE:**

KRC 38140500 & KRC 38140600 SB Chevy 2-Piece Pro Crank Adapter eliminates the need for a long crank bolt. The steel tab installs with a shorter bolt securing the damper to the engine. An R-LOK crank adapter mounts over the damper. All of the pulleys are then bolted to the crank adapter with a shorter bolt.



**LS Chevrolet**



**SB Chevrolet**

### Chevrolet

Our KRC 38140000 & KRC 38140500 Chevrolet crank adapter will align the crank pulley with any KRC water pump pulley mounted on a 5.795" long water pump. If your water pump measures 5.545" or 5.595" long you can use either a .200" or .250" water pump flange spacer or our water pump gasket spacers to align the water pump pulley with the crankshaft pulley.

# R-LOK Modular Pulley Systems

## Ford Crank Adapters



**KRC 38161000**  
R-LOK Crank Adapter 3-Bolt Ford  
2.445" long



**KRC 38162000**  
R-LOK Crank Adapter  
3-Bolt Ford 2.580" long



**KRC 38161500**  
R-LOK Crank Adapter 3-Bolt  
Ford 1.445" long



**KRC 38164000**  
R-LOK Crank Adapter  
4-Bolt 1.580" long

**NOTE:**

**KRC 38161500** Pro Crank Adapter for a 3-Bolt Ford is 1.0" shorter than our KRC 38161000. This allows a drive pulley to be installed behind the main drive or to allow for spacing on shorter Ford water pumps.

**Ford:** Ford 3-Bolt & 4-Bolt crank adapters are designed to align the crank pulley with a KRC water pump pulley mounted on a 5.700" long water pump. Ford 4-Bolt crank adapters have a female register while Ford 3-Bolt crank adapters have a male register. Some dampers are made with both patterns. If both bolt patterns are present a KRC 3-Bolt crank adapter is the proper choice.



**4 Bolt**



**3 Bolt**

## Dodge Crank Adapters



**KRC 38150000**  
R-LOK Crank Small Block  
Dodge 2.855" long



**Dodge:** Our Dodge crank adapters will align the crank pulley with a KRC water pump pulley mounted on a 5.547" long water pump.

## Adapter Spacers and Crank Bolts

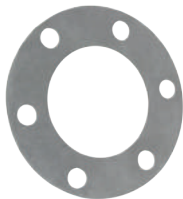

**KRC 38815030**  
Chevrolet /Ford Adapter Spacer  
for Belt Alignment, .030" Thick



**KRC 38815200**  
Chevrolet Adapter Spacer  
for Belt Alignment  
KRC 38815200 .200"  
KRC 38815250 .250"  
KRC 38815375 .375"  
KRC 38815500 .500"  
KRC 38815575 .575"



**KRC 38470000**  
Chevy Crank Bolts  
KRC 38470000 7/16" x 20 x 3.5"  
KRC 38471000 7/16" x 20 x 4.0"  
KRC 38472000 7/16" x 20 x 4.5"  
KRC 38473000 7/16" x 20 x 5.0"  
KRC 38474000 7/16" x 20 x 5.5"

# R-LOK Crank Pulleys

## R-LOK Serpentine Crank Pulleys

KRC pulleys are black, hard anodized to 62 Rockwell hardness. Mill finish is available by special order.



**KRC 38225000**  
R-LOK Aluminum  
6-Rib Serpentine  
Crank Pulley, 2.50"



**KRC 38228700**  
R-LOK Aluminum  
6-Rib Serpentine  
Crank Pulley, 2.875"



**KRC 38230000**  
R-LOK Aluminum  
6-Rib Serpentine  
Crank Pulley, 3.00"



**KRC 38232500**  
R-LOK Aluminum  
6-Rib Serpentine  
Crank Pulley, 3.25"



**KRC 38235000**  
R-LOK Aluminum  
6-Rib Serpentine  
Crank Pulley, 3.50"



**KRC 38240000**  
R-LOK Aluminum  
6-Rib Serpentine  
Crank Pulley, 4.00"



**KRC 38257500**  
R-LOK Aluminum  
6-Rib Serpentine  
Crank Pulley, 5.75"



**KRC 38440475**  
R-LOK Aluminum  
3-Rib Serpentine  
Crank Pulley, 4.75"



**KRC 38335000**  
R-LOK Aluminum  
V-Belt Crank Pulley,  
3.50"

## R-LOK Accessories

KRC modular R-LOK serpentine pulley system allows the stacking of multiple pulleys to drive additional accessories. PN# **KRC 38210000** is required to fill the space between a KRC serpentine R-LOK pulley when adding a second or third R-LOK crank pulley. See drawing below for a typical installation of a serpentine crank pulley with a HTD crank pulley stacked in front.



**KRC 38210000**  
R-LOK to R-LOK Pulley Spacer installed in pulley

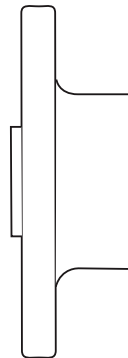

Crank  
Adapter

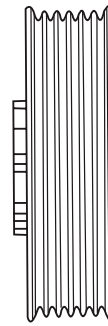

Serpentine  
Pulley

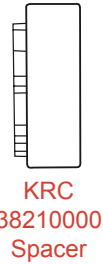

**KRC  
38210000  
Spacer**

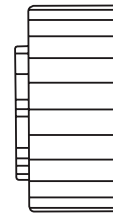

HTD or  
other R-LOK  
Crank Pulley

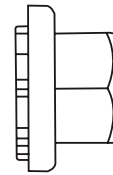

Hex  
End Cap  
(optional)



**KRC 38205000**  
R-LOK End Cap, 1-1/8"  
Nut to Rotate Engine  
**KRC 38207000**  
MINI R-LOK End Cap



**KRC 38206000**  
R-LOK Smooth End Cap  
**KRC 38208000**  
MINI R-LOK Smooth End Cap



**KRC 88208095**  
MINI R-LOK To R-LOK  
Adapter



**KRC 38215200**  
R-LOK Crankshaft Hub to  
Pulley Spacer, .200"  
KRC 38215250 .250"  
KRC 38215375 .375"  
KRC 38215575 .575"  
KRC 38215600 .600"  
KRC 38216000 1.000"



# R-LOK Crank Pulleys

## R-LOK HTD Crank Pulleys

All KRC pulleys are black, hard anodized to 62 Rockwell hardness. Mill finish is available by special order. Custom tooth count HTD pulleys are manufactured to order - call for quote.



### KRC 88208017

17TH 20mm wide R-LOK HTD Crank Pulley, Includes 2 Mini R-LOK Rock Guards & a Mini R-LOK to R-LOK Adapter



### KRC 88208018

18TH 20mm wide R-LOK HTD Crank Pulley, Includes 2 Mini R-LOK Rock Guards & a Mini R-LOK to R-LOK Adapter



### KRC 88208019

19TH 20mm wide R-LOK HTD Crank Pulley, Includes 2 Mini R-LOK Rock Guards & a Mini R-LOK to R-LOK Adapter



### KRC 88208020

20TH 20mm wide R-LOK HTD Crank Pulley, Includes 2 Mini R-LOK Rock Guards & a Mini R-LOK to R-LOK Adapter



### KRC 88208021

21TH 20mm wide R-LOK HTD Crank Pulley, Includes 2 R-LOK Rock Guards & a Mini R-LOK Rock Guard



### KRC 88208022

22TH 20mm wide R-LOK HTD Crank Pulley, Includes 2 R-LOK Rock Guards & a Mini R-LOK Rock Guard



### KRC 88208023

23TH 20mm wide R-LOK HTD Crank Pulley, Includes 2 R-LOK Rock Guards & a Mini R-LOK Rock Guard



### KRC 88208024

24TH 20mm wide R-LOK HTD Crank Pulley, Includes 2 R-LOK Rock Guards & a Mini R-LOK Rock Guard



### KRC 88208025

25TH 20mm wide R-LOK HTD Crank Pulley, Includes 2 R-LOK Rock Guards & a Mini R-LOK Rock Guard



### KRC 88208026

26TH 20mm wide R-LOK HTD Crank Pulley, Includes 2 R-LOK Rock Guards & a Mini R-LOK Rock Guard



### KRC 88208027

27TH 20mm wide R-LOK HTD Crank Pulley, Includes 2 R-LOK Rock Guards & a Mini R-LOK Rock Guard



### KRC 88208032

32TH 20mm wide R-LOK HTD Crank Pulley, Includes 2 R-LOK Rock Guards & a Mini R-LOK Rock Guard



### KRC 88208033

33TH 20mm wide R-LOK HTD Crank Pulley, Includes 2 R-LOK Rock Guards & a Mini R-LOK Rock Guard



### KRC 38815030

.030" Thick Crank Hub Adapter Spacer for Chevy or 3-Bolt Ford Adapters



### KRC 38211000

R-LOK to Pin-Drive Pulley Spacer

# Power Steering Pump Pulleys

KRC offers an extensive line of front engine drive pulleys. All KRC pulleys are CNC machined from 6061-T6 aluminum to exacting tolerances. Our serpentine pulleys offer 30% more surface area for the belt to contact than most manufacturers. Each serpentine pulley is machined to SAE specifications.

KRC Pro Series Power Steering Pumps include a 17-Spline shaft that is retained by a nut and washer. The spline is the same on our Cast Iron & Pro Series III Aluminum Pumps, but the shaft register is different - the Cast Iron Pump register is .668" while the Aluminum pump register is .590". NOTE: **Cast Iron & Pro Series III Aluminum Pump pulleys are not interchangeable.**

**All KRC pulleys are black, hard anodized to 62 Rockwell hardness. Mill finish is available by special order.**

## Aluminum Pump Pulleys



**KRC 20008000**

3.5" V-Belt Pulley for Aluminum Pump



**KRC 20011000**

6.0" V-Belt Pulley for Aluminum Pump



**KRC 20011000**

8.0" V-Belt Pulley for Aluminum Pump



**KRC 20015000**

4.2" 6-Rib Serpentine Pulley for Aluminum Pump



**KRC 20015300**

4.2" 3-Rib Serpentine Pulley for Aluminum Pump



**KRC 20017600**

6.0" 6-Rib Serpentine Pulley for Aluminum Pump



**KRC 20019600**

6.0" 6-Rib Serpentine Pulley F-Body LS Offset for Aluminum Pump



**KRC 20019650**

6.5" 6-Rib Serpentine Pulley F-Body LS Offset for Aluminum Pump

**KRC 20551000**

5.51" 6-Rib Serpentine Pulley for Aluminum Pump No Windows



**KRC 20020600**

6.0" 6-Rib Serpentine Pulley Y-Body LS Offset for Aluminum Pump



**KRC 20020650**

6.5" 6-Rib Serpentine Pulley Y-Body LS Offset for Aluminum Pump



**KRC 82308032**

32TH 30mm Wide HTD Pulley for Aluminum Pump

**KRC 82308031**

31TH 30mm Wide HTD Pulley for Aluminum Pump. No windows in pulley



**KRC 82308040**

40TH 30mm Wide HTD Pulley for Aluminum Pump

**KRC 82708032**

32TH 40mm Wide HTD Pulley for Aluminum Pump

# Power Steering Pump Pulleys

Aluminum Pump Pulleys for Cast Iron Pumps



**KRC 50100000**  
6.0" V-Belt Pulley for  
Cast Iron Pump



**KRC 50120000**  
4.2" 6-Rib Serpentine  
Pulley for Cast Iron Pump



**KRC 50120300**  
4.2" 3-Rib Serpentine  
pulley for Cast Iron Pump



**KRC 50013000**  
8.0" V-Belt Pulley for  
Cast Iron Pump



**KRC 50217600**  
6.0" 6-Rib Serpentine  
Pulley for Cast Iron Pump



**KRC 50219600**  
6.0" 6-Rib Serpentine Pulley, F  
Body LS Offset for Cast Iron Pump



**KRC 50219650**  
6.5" 6-Rib Serpentine Pulley, F  
Body LS Offset for Cast Iron Pump



**KRC 50315500**  
40TH HTD Pulley for Cast  
Iron Pump



**KRC 40160900**  
.325" Mounting Bracket  
Spacers for Saginaw Pumps

## GM Press-On Pump Pulleys



**KRC 40610600**  
6.0" V-Belt Pulley; fits .6645O.D.  
Saginaw Pump Shafts



**KRC 40160600**  
6.0" 6-Rib Press-On Serpentine  
Pulley; fits .6645O.D. Saginaw  
Pump Shafts



**KRC 40160000**  
4.20" 6-Rib Press-On Serpentine  
Pulley; fits .6645O.D. Saginaw  
Pump Shafts

**GM Press On Pulleys  
for  
KRC Elite Series  
Power Steering Pumps**

# HTD Dry-Sump Pulleys

## HTD Dry-Sump Pulleys with C-LOK Adapter

Have you ever tried to change your belt alignment on your Dry-Sump pump? Do you remember how hard it is to remove the set screws & get the pulley to slide on the shaft? Our new C-LOK system will allow you to loosen your pulley, move it, & tighten it back up in seconds using an open-ended wrench. With KRC C-LOK pulleys, removing Loctite & rust to make a small adjustment in belt alignment is eliminated. The KRC pulleys below come complete with a C-LOK installed.

**All KRC pulleys are black, hard anodized to 62 Rockwell hardness. Mill finish is available by special order. Custom HTD pulleys in any tooth count are available - call for quote.**



**KRC 86508028**  
28TH 30MM wide HTD Dry-Sump Pump Pulley w/C-LOK Clamp



**KRC 86508030**  
30TH 30MM wide HTD Dry-Sump Pump Pulley w/C-LOK Clamp



**KRC 86508032**  
32TH 30MM wide HTD Dry-Sump Pump Pulley w/C-LOK Clamp

**KRC C-LOK System**  
Simplifies Alignment.  
Just slide & LOK!



**KRC 86508037**  
37TH 30MM wide HTD Dry-Sump Pump Pulley w/C-LOK Clamp



**KRC 86508038**  
38TH 30MM wide HTD Dry-Sump Pump Pulley w/C-LOK Clamp



**KRC 86508040**  
40TH 40MM wide Dry-Sump Pulley with C-LOK to drive an alternator on the bellhousing. Our Extra-Wide pulley allows you to use a 30mm wide drive belt from the

### KRC C-LOK Simplifies Dry-Sump Pulley Alignment

#### KRC 89000625

The KRC C-LOK is the easiest mounting and pulley alignment system made for 5/8" HTD Dry-Sump pulleys. Save countless hours aligning your Dry-Sump pulley. Our C-LOK design allows you to simply slide the pulley & lock it down. Fits KRC Pulleys only.



drive belt to the alternator.



### HTD Pulley Rock Guards

Part includes one rock guard per package. Available for 32, 37, 38, and 40TH HTD Pulleys.



**KRC 89008032**  
32TH HTD Rock Guard



**KRC 89008037**  
37TH HTD Rock Guard



**KRC 89008038**  
38TH HTD Rock Guard



**KRC 89008040**  
40TH HTD Rock Guard

# HTD Dry-Sump Pulleys

HTD Dry-Sump REPLACEMENT Pulleys WITHOUT C-LOK Adapter  
 Re-Use the C-LOK you own to save money!

All KRC pulleys are black, hard anodized to 62 Rockwell hardness. Mill finish is available by special order. Custom HTD pulleys in any tooth count are available - call for quote.



**KRC 86508128**  
 28TH 30MM wide HTD Dry-Sump  
 Pump Pulley w/out C-LOK Clamp



**KRC 86508130**  
 30TH 30MM wide HTD Dry-Sump  
 Pump Pulley w/out C-LOK Clamp



**KRC 86508132**  
 32TH 30MM wide HTD Dry-Sump  
 Pump Pulley w/out C-LOK Clamp



**KRC 86508137**  
 37TH 30MM wide HTD Dry-Sump  
 Pump Pulley w/out C-LOK Clamp



**KRC 86508138**  
 38TH 30MM wide HTD Dry-Sump  
 Pump Pulley w/out C-LOK Clamp



**KRC 86508140**  
 40TH 30MM wide HTD Dry-Sump  
 Pump Pulley w/out C-LOK Clamp

## Extra-Wide Dry-Sump Replacement Pulley

### KRC 87508040

40TH 30MM wide HTD Dry-Sump  
 Pump Pulley w/out C-LOK Clamp

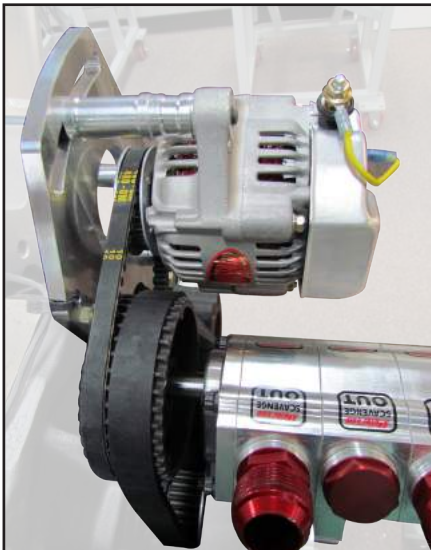

## Dry-Sump Rear Alternator Bracket Kit KRC 40970000

KRC Alternator Dry Sump Drive Kit includes all hardware, a rear alternator bracket, 24TH HTD Denso alternator pulley, 40TH 40mm wide HTD Dry Sump Pulley with C-LOK, & two 40TH HTD Rock Guards. (Dry Sump & Dry Sump bracket not included).

# Alternator Pulleys

All KRC pulleys are black, hard anodized to 62 Rockwell hardness. KRC Pulleys are available by special order without plating in a mill finish.

## Denso Alternator Pulleys

KRC Denso alternator pulleys do not require any spacers or bushing sets .



**KRC 40130340**  
1.75" Aluminum Denso Alternator Pulley, 3-Groove



**KRC 40140340**  
2.5" Aluminum Denso Alternator Pulley, 3-Groove



**KRC 40140640**  
2.5" Aluminum Denso Alternator Pulley, 6-Groove



**KRC 40150340**  
3.5" Aluminum Denso Alternator Pulley, 3-Groove



**KRC 40150640**  
3.5" Aluminum Denso Alternator Pulley, 6-Groove

### Denso

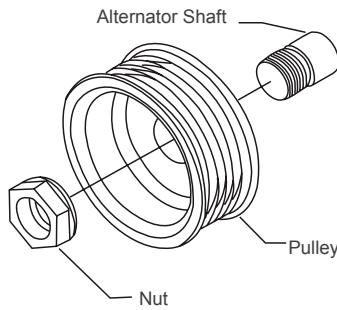

### Delco

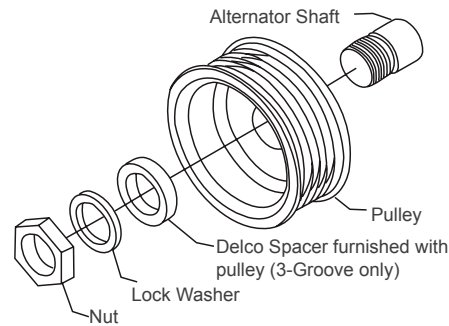

## Delco Alternator Pulleys

Delco alternator pulleys include a .200" spacer to ensure



**KRC 40130380**  
1.75" Aluminum Delco Alt Pulley, 3-Groove



**KRC 40140380**  
2.5" Aluminum Delco Alternator Pulley, 3-Groove



**KRC 40140680**  
2.5" Aluminum Delco Alt. Pulley, 6-Groove



**KRC 40150680**  
3.5" Aluminum Delco Alt. Pulley, 6-Groove

## Denso/Delco Alternator Pulleys

These alternator pulleys include the bushing set so



**KRC 40140300**  
2.50" 3-Rib Denso or Delco Alternator Pulley



**KRC 40140600**  
2.50" 6-Rib Denso or Delco Alternator Pulley



**KRC 40150300**  
3.50" 3-Rib Denso or Delco Alternator Pulley



**KRC 40150600**  
3.50" 6-Rib Denso or Delco Alternator Pulley



**KRC 40155600**  
4.20" 6-Rib Denso or Delco Alternator Pulley

# Alternators & Alternator Brackets ADD NEW

## Powermaster Alternators



**POW 8162**

93mm Denso, 50 AMP, 12 Volt, Heavy Duty Model (138mm Bolt Pattern)



**POW 8172**

93mm Denso, 50 AMP, 12 Volt, Sportsman Model (138mm Bolt Pattern)



**POW 8206**

CS130D ( 115 AMP Camaro Offset), (156mm Bolt Pattern)



**POW 8132-KRC**

110mm Denso 95 AMP, 12 Volt, (custom for LS engine) (163mm bolt Pattern)



**POW 8166**

93mm Denso, 50 AMP, 16 Volt, Heavy Duty Model (138mm Bolt Pattern)



**POW 8182**

93mm Denso, 85 AMP 12 Volt, Heavy Duty Model (138mm Bolt Pattern)



**KRC 40551000**

3-Bolt Delco Alternator to 2-Bolt Alternator adapter will allow mounting a 3-bolt alternator to a 2-bolt mount



**KRC 40450000**

SB Chevy 1st Design Alternator Bracket & Tensioner Kit, Mid Mount, 93mm Denso (138mm Bolt Pattern). Includes all hardware & spacers.

### Alternator Brackets

KRC alternator bracket kits mount on the passenger side. Kits include all hardware & spacers. Our kits work on most small block Chevrolet, Ford & Dodge engines - alternator spacer length may need to be adjusted to match your pulley system. Variances in spot facing by different water pump manufacturers may require spacing.



**KRC 40510200**

SB Chevy Alternator Bracket Kit, Mid Mount, 93mm Denso (138mm Bolt Pattern)



**KRC 40550000**

SB Chevy 2-Piece Alternator Bracket Kit, Mid Mount, CS130 Delco (156mm Bolt Pattern)



**KRC 40510000**

SB Chevy 1st Design Alternator Bracket Kit, Mid Mount, 93mm Denso (138mm Bolt Pattern)

**KRC 40450010**

SB Chevy 1st Design Alternator Bracket compatible with tensioner (Sold Separately). Complete Kit Shown above - See KRC 40450000



**KRC 40710200**

SB Dodge Alternator Bracket Kit, Mid Mount, 93mm Denso (138mm Bolt Pattern)

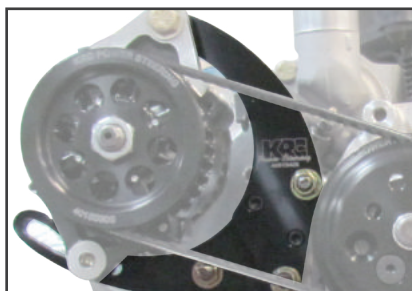

**KRC 40610400**

SB Ford Alternator Bracket Kit, High Mount, 93mm Denso (138mm Bolt Pattern)

Our Ford 93mm Denso alternator bracket, **KRC 40610400**, sits higher allowing room for a Dry-Sump pump. Setting the timing is easy due to improved visibility of the timing pointer.

# Water Pump Pulleys

**KRC Water Pump Pulley Offsets (Measured from water pump flange to center of groove):**

**KRC 38025400/KRC 38050400:** To center of 6-Groove - 1.168" Center 3-Groove - 0.278"

**KRC 40122000/KRC 38050000:** To center of Back 6-Groove - 1.168" Center Front 6-Groove - 0.174"

**All pulleys are black, hard anodized to 62 Rockwell hardness.**

**Mill finish is available by special order.**

## Serpentine Water Pump Pulleys



**KRC 38025400**  
4.0" Aluminum Water Pump Pulley, Chevy & Ford, 6-Groove Drive & 3-Groove



**KRC 38050400**  
4.0" Aluminum Water Pump Pulley, Dodge, 6-Groove Drive & 3-Groove



**KRC 40122000**  
3.5" Aluminum Water Pump Pulley, Chevy & Ford, Twin 6-Groove



**KRC 38050000**  
3.5" Aluminum Water Pump Pulley, Dodge, Twin 6-Groove



**KRC 20110000**  
3.5" Aluminum Water Pump 3-Groove Drive Pulley, Chevy & Ford



**KRC 20100000**  
3.5" Aluminum Water Pump V-Belt Drive Pulley, Chevy & Ford

### KRC 20100000

3.5" aluminum V-belt, & KRC 20110000 3.5" aluminum 3-groove serpentine water pump drive pulleys mount to the front of the water pump pulley to drive accessories such as a power steering pump or alternator at reduced speed.

## Ford Coyote Boss 302 Water Pump Pulley

### KRC 66302301

Our billet aluminum pulley replaces the factory Ford water pump pulley included with a Coyote Boss 302 engine. The KRC Coyote Water Pump Pulley adds a 5-Rib accessory pulley to drive the power steering pump.





# Water Pump Pulley Accessories

All pulleys are black, hard anodized to 62 Rockwell hardness. Mill finish is available by special order. Any tooth count HTD pulleys can be manufactured by special order. Call our Tech Line for quotes.

## HTD Water Pump Pulleys



**KRC 88008035**  
35TH 50MM wide HTD  
water pump pulley



**KRC 88008037**  
37TH 50MM wide HTD  
water pump pulley



**KRC 88008040**  
40TH 50MM wide HTD  
water pump pulley

## Water Pump Pulley Accessories



**KRC 15050250** .250 thick adapter converts 5/8" shaft X 5.545" length water pumps to 3/4" shaft X 5.795" length.

**KRC 15050170** .170 thick adapter converts 5/8" shaft X 5.545" length water pumps to 3/4" shaft X 5.795" length.

## Water Pump Pulley Spacers

KRC water pump adapters enable various length Chevrolet water pumps to be converted to a standard 5.795" length X 3/4" shaft. Proper pulley & belt alignment is obtained without changing your current water pump. Dual hole pattern will fit most engines except Dodge.



**KRC 15050030**  
Water Pump Pulley  
Spacer .030" Thick



**KRC 40124000**  
Water Pump Pulley Bolts  
with Tapered Seat (4)



**KRC 15120000**

Adapter converts 5/8" shaft water pumps to a 3/4" shaft, adapting 3/4" shaft pulleys to a 5/8" shaft.



**KRC 15121000**

Adapter converts 5/8" shaft water pumps to a 3/4" shaft, adapting 3/4" shaft pulleys to a 5/8" shaft. NOTE: The pulley must be machined to accept the 1" OD x .050" thick flange to retain the adapter on the shaft.

# Cooling System Components

## KRC Small Block Chevy Custom High Performance Water Pump

**KRC 15101001** Custom Aluminum High Performance Water Pump is unique in that each of the mounting bosses are CNC machined to exact height specifications. Proper alignment of KRC pulleys, brackets & belts is ensured. Simple. Exacting. Quality.

### Custom KRC Water Pump Features

- 5.795" Pump Length
- Heavy Duty 3/4" Shaft
- Fully Machined Cast Impeller
- Heavy Duty Bearing and Seal Assembly
- High Flow 356-T6 Heat Treated Aluminum Casting



**KRC 15101001**



### KRC 15425702

Our custom made Stewart water pump is the standard replacement for CT525 LS engines. A replaceable pump cartridge is featured. Clockwise rotation.

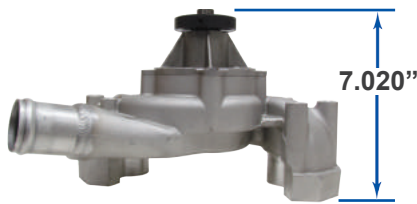

**KRC 15403000**

Replacement Clockwise rotation water pump cartridge for most cartridge style water pumps.

### KRC 15425920

Extended Stewart/EMP water pump is required to fit extended timing covers with a front distributor mount. Clockwise rotation.

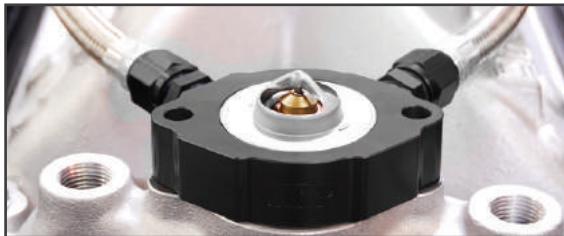
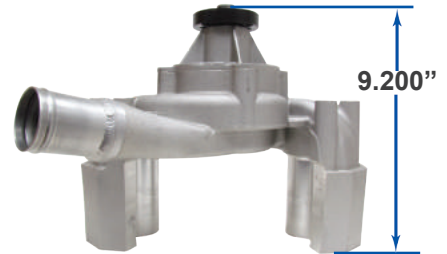

### Thermostat Housing Spacer

**KRC 15375000** (Black Anodized) & **KRC 15375007-NP** (Non-anodized), one inch thermostat housing spacer is machined to accept a thermostat above the two 3/8" female pipe fittings. Raising the thermostat above the fittings will allow the engine to reach operating temperatures faster. Hoses & Fittings (Sold Separately) run from the spacer to two points on the back of the intake manifold to eliminate hot spots in cylinder heads & engine blocks.

### Water Bypass Fittings & Hose Kits

KRC AN Fittings & Hose Kits replace factory clamp-on hoses with quality systems designed for high performance plumbing.

**KRC 15203000**



**KRC 15200000**



### Water Pump Spacers



KRC Chevrolet water pump spacers are designed to help align the water pump & pulley with the crank pulleys when using gear drive & belt drive timing systems. KRC spacers are ideal for clearing the tamper proof bolts on most crate engines while aligning pulleys when utilizing a crank trigger system.



**KRC 15000300**

Water Pump Spacer Kit, .375"

Part No.	Thickness
KRC 15001000	.200"
KRC 15002000	.250"
KRC 15003000	.375"
KRC 15005000	.500"
KRC 15006000	.625"



**KRC 15000525**

CT525 water pump spacers (pair)  
.775" Thick

# Spacers



KRC offers a wide selection of machined aluminum spacers to help you gain perfect alignment of nearly any engine bracket. Our spacers work great for KRC products or for applications that require you to adjust bracket spacing for proper pulley alignment. Inner diameters for 5/16" (.330"ID), 3/8" (.390"ID), & 7/16" (.455"ID). Bolts sold separately.

Part No.	Description
SPC 08-0-400	Spacer 8mm ID x .400" Long
SPC 90-0-050	Spacer .390ID x .050" Long
SPC 90-0-079	Spacer .390ID x .079" Long
SPC 90-0-114	Spacer .390ID x .114" Long
SPC 90-0-154	Spacer .390ID x .154" Long
SPC 90-0-200	Spacer .390ID x .200" Long
SPC 90-0-250	Spacer .390ID x .250" Long
SPC 90-0-266	Spacer .390ID x .200" Long
SPC 90-0-280	Spacer .390ID x .280" Long
SPC 90-0-300	Spacer .390ID x .300" Long
SPC 90-0-325	Spacer .390ID x .325" Long
SPC 90-0-331	Spacer .390ID x .331" Long
SPC 90-0-375	Spacer .390ID x .375" Long
SPC 90-0-400	Spacer .390ID x .400" Long
SPC 90-0-454	Spacer .390ID x .454" Long
SPC 90-0-475	Spacer .390ID x .475" Long
SPC 90-0-500	Spacer .390ID x .500" Long
SPC 90-0-554	Spacer .390ID x .554" Long
SPC 90-0-575	Spacer .390ID x .575" Long
SPC 90-0-604	Spacer .390ID x .604" Long
SPC 90-0-675	Spacer .390ID x .675" Long
SPC 90-0-700	Spacer .390ID x .700" Long
SPC 90-0-750	Spacer .390ID x .750" Long
SPC 90-0-772	Spacer .390ID x .722" Long
SPC 90-0-805	Spacer .390ID x .805" Long
SPC 90-0-850	Spacer .390ID x .850" Long
SPC 90-0-860	Spacer .390ID x .860" Long
SPC 90-0-900	Spacer .390ID x .900" Long
SPC 90-0-935	Spacer .390ID x .935" Long
SPC 90-1-000	Spacer .390ID x 1.000" Long
SPC 90-1-110	Spacer .390 ID x 1.110" Long
SPC 90-1-175	Spacer .390ID x 1.175" Long
SPC 90-1-228	Spacer .390ID x 1.228" Long

Part No.	Description
SPC 90-1-271	Spacer .390ID x 1.271" Long
SPC 90-1-300	Spacer .390ID x 1.300" Long
SPC 90-1-325	Spacer .390ID x 1.325" Long
SPC 90-1-425	Spacer .390ID x 1.425" Long
SPC 90-1-460	Spacer .390ID x 1.460" Long
SPC 90-1-550	Spacer .390ID x 1.550" Long
SPC 90-1-605	Spacer .390ID x 1.605" Long
SPC 90-1-625	Spacer .390ID x 1.625" Long
SPC 90-1-650	Spacer .390ID x 1.650" Long
SPC 90-1-750	Spacer .390ID x 1.750" Long
SPC 90-1-805	Spacer .390ID x 1.805" Long
SPC 90-1-810	Spacer .390ID x 1.810" Long
SPC 90-1-884	Spacer .390ID x 1.884" Long
SPC 90-1-919	Spacer .390ID x 1.919" Long
SPC 90-1-950	Spacer .390ID x 1.950" Long
SPC 90-1-985	Spacer .390ID x 1.985" Long
SPC 90-2-000	Spacer .390ID x 2.000" Long
SPC 90-2-050	Spacer .390ID x 2.050" Long
SPC 90-2-100	Spacer .390ID x 2.100" Long
SPC 90-2-110	Spacer .390ID x 2.110" Long
SPC 90-2-140	Spacer .390ID x 2.140" Long
SPC 90-2-150	Spacer .390ID x 2.150" Long
SPC 90-2-180	Spacer .390ID x 2.180" Long
SPC 90-2-240	Spacer .390ID x 2.240" Long
SPC 90-2-250	Spacer .390ID x 2.250" Long
SPC 90-2-305	Spacer .390ID x 2.305" Long
SPC 90-2-350	Spacer .390ID x 2.350" Long
SPC 90-2-400	Spacer .390ID x 2.450" Long
SPC 90-2-450	Spacer .390ID x 2.450" Long
SPC 90-2-469	Spacer .390ID x 2.469" Long
SPC 90-2-677	Spacer .390ID x 2.677" Long
SPC 90-2-780	Spacer .390ID x 2.780" Long
SPC 90-2-850	Spacer .390ID x 2.850" Long

Part No.	Description
SPC 90-2-970	Spacer .390ID x 2.970" Long
SPC 90-3-260	Spacer .390ID x 3.260" Long
SPC 91-0-050	Spacer .455ID x .050" Long
SPC 91-0-137	Spacer .455ID x .137" Long
SPC 91-0-360	Spacer .455ID x .3605" Long
SPC 91-1-468	Spacer .455ID x 1.468" Long
SPC 91-1-499	Spacer .455ID x 1.499" Long
SPC 91-1-540	Spacer .455ID x 1.540" Long
SPC 91-1-580	Spacer .455ID x 1.580" Long
SPC 91-1-600	Spacer .455ID x 1.600" Long
SPC 91-1-625	Spacer .455ID x 1.625" Long
SPC 92-0-050	Spacer .330ID x .050" Long
SPC 92-0-100	Spacer .330ID x .100" Long
SPC 92-0-120	Spacer .330ID x .120" Long
SPC 92-0-200	Spacer .330ID x .200" Long
SPC 92-0-300	Spacer .330ID x .300" Long
SPC 92-0-350	Spacer .330ID x .350" Long
SPC 92-0-400	Spacer .330ID x .400" Long
SPC 92-0-600	Spacer .330ID x .600" Long
SPC 92-0-900	Spacer .330ID x .900" Long
SPC 92-1-070	Spacer .330ID x 1.070" Long
SPC 92-1-170	Spacer .330ID x 1.170" Long
SPC 92-1-250	Spacer .330ID x 1.250" Long
SPC 92-1-270	Spacer .330ID x 1.270" Long
SPC 92-1-400	Spacer .330ID x 1.400" Long
SPC 92-1-780	Spacer .330ID x 1.780" Long
SPC 92-1-895	Spacer .330ID x 1.895" Long
SPC 92-1-950	Spacer .330ID x 1.950" Long
SPC 92-2-000	Spacer .330ID x 2.000" Long
SPC 92-2-814	Spacer .390ID x 2.814" Long
SPC 93-0-100	Spacer .500ID x .100" Long



**KRC 15120000**

Water Pump Shaft Adapter converts 5/8" shaft water pumps to a 3/4" shaft allowing 3/4" shaft pulleys to be installed on a 5/8" shaft.



**KRC 15121000**

Water Pump Shaft Flanged Adapter converts 5/8" shaft water pumps to a 3/4" shaft allowing 3/4" shaft pulleys to securely install on a 5/8" shaft. The pulley must be machined to accept the 1" OD x .050" thick flange to retain the adapter on the shaft.



**Aluminum Fan Spacers**

KRC aluminum CNC machined water pump fan spacers are available in 1.5", 2.0", 2.5" & 3.0". These spacers allow for proper spacing of the water pump fan.

- KRC 15815000 1.5" Long Spacer
- KRC 15820000 2.0" Long Spacer
- KRC 15825000 2.5" Long Spacer
- KRC 15830000 3.0" Long Spacer

## Why do I need an idler-tensioner?

An idler-tensioner should be used anytime you are running a large diameter, heavy mechanical fan blade or fan blade with a lot of pitch. A belt tensioner resists slippage that can occur due to the forces created by heavy rotating weight.

## What happens if my belt slips?

If your belts slip continuously you will wear out your crank pulley & belt quickly. Additionally, your engine could overheat. Running a mechanical fan without a tensioner can show belt slippage damage after running 50 to 100 laps. If your crank pulley plating disappears quickly - belt slippage is likely the cause. If belts are allowed to slip, aluminum crank pulleys will flake off and embed into the belt. The end result will be pulleys that must be replaced prematurely due to damage to the grooves. If you continue to use a damaged pulley a new belt will not properly engage causing a loss of pulley drive. We have seen pulley systems without a tensioner require the crank pulley to be replaced after only 100 to 200 laps while incurring abnormal belt wear.

## How does belt slippage occur with my mechanical fan?

Belt slippage occurs from the centrifugal force coming from large diameter or heavy fan as it decelerates under braking. An object in motion wants to stay in motion. Without a tensioner, the fan belt & pulleys are required to work like brake shoes to slow the fan. The fan stretches the belt causing undesirable belt slip under deceleration & braking. Slippage quickly heats the belt causing permanent damage. The belt will continue to stretch as the race goes on reducing fan efficiency resulting in excessive engine temps. After extensive testing, KRC engineers have determined that the only way to properly tension the belt to prevent slippage is with an idler pulley mounted on the passenger side of the engine. The properly tensioned idler pulley helps your engine run cooler. Belt & pulley life are increased due to the consistency created by the tensioner. A well designed engine pulley drive system gains you improved acceleration at corner exit while allowing you to brake harder on corner entry.

## Do I need an idler on Water Pump Only drive kits as well as systems with a power steering pump?

**Yes. Water pump only drive kits should always have a tensioner.** KRC engineers recommend a tensioner on single belt water pump only drive kits - competitors often omit a tensioner in single belt applications leading to problems. Proper single belt serpentine drive belt tension is nearly impossible to attain without installing a tensioner. Even with a power steering pump mounted in the system, a tensioner should always be installed when utilizing a mechanical fan.

### KRC Idler-Tensioner Pulley Kits



**KRC 40400300**  
Small block Chevrolet adjustable idler pulley kit



**KRC 40450000**  
Small block Chevrolet adjustable idler pulley kit with 93mm Denso alternator bracket.  
**NOT APPLICABLE FOR CRATE MOTORS**



**KRC 40410200**  
Small block Ford adjustable idler pulley kit

### **NEW!** Idler Tensioner for Dodge 360



**KRC 40400500**  
Dodge 360 adjustable idler pulley kit  
(Pulleys & Belts Sold Separately)

### Replacement Tensioner Pulleys

**KRC 40305000**  
Replacement 76mm idler pulley



**KRC 40406000**  
Replacement pulley with stud and bolt



# Aeroquip & GM Steering Box Fittings

KRC carries a complete line of Aeroquip Hose & Fittings for all power steering plumbing needs. The Aeroquip AQP line meets all of our recommendations for your power steering system. The AQP -6 hose is rated at 2,250 psi maximum operating pressure & the vacuum service is rated at 28 inches of Mercury. The AQP fittings guarantee sufficient inside diameter. Use caution as other brands can have a smaller than spec inside diameter that can impact fluid flow leading to system problems.

## Straight Fitting

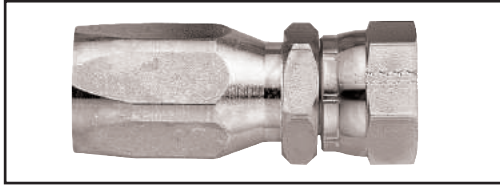

Hose Size	Part Number	Thread Size
-06	AQPFBM1302	9/16" - 18
-08	AQPFBM1305	3/4" - 16
-10	AQPFBM1307	7/8" - 14
-12	AQPFBM1310	1 1/16" - 12

## 45° Elbow Fitting

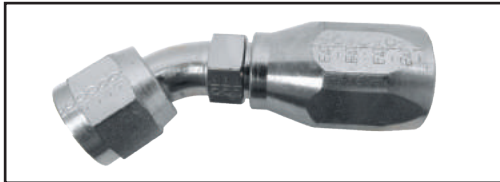

Hose Size	Part Number	Thread Size
-06	AQPFBM1386	9/16" - 18
-08	AQPFBM1384	3/4" - 16
-10	AQPFBM1338	7/8" - 14
-12	AQPFBM1339	1 1/16" - 12

## 90° Elbow Fitting

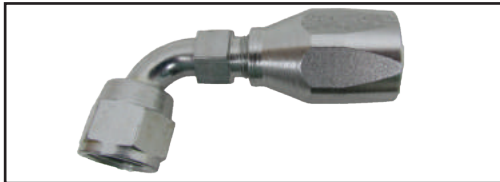

Hose Size	Part Number	Thread Size
-06	AQPFBM1389	9/16" - 18
-08	AQPFBM1387	3/4" - 16
-10	AQPFBM1374	7/8" - 14
-12	AQPFBM1376	1 1/16" - 12

## AQP High Pressure Hose



## GM Power Steering Box Fittings

KRC's steel power steering box fittings will convert your steering box to a -6 Male AN fitting. **KRC 10122000 & KRC 10123000** fit most 1978-up GM steering boxes with o-ring fittings. **KRC 10124000 & KRC 10125000** fit most 1965-1977 GM steering boxes with inverted flare.

### KRC 10122000



16mm X 1.5 O-Ring

### KRC 10123000



18mm X 1.5 O-Ring

### KRC 10124000



5/8" X 18 Inverted Flare

### KRC 10125000



1 1/16" X 18 Inverted Flare

Available in bulk packs of 25

# Belts



## HTD Belts

Part No.	Description
HTD 45010480	HTD Belt, 10mm x 480mm, 60-Tooth
HTD 45010512	HTD Belt, 10mm x 512mm, 64-Tooth
HTD 45010536	HTD Belt, 10mm x 536mm, 67-Tooth
HTD 45010560	HTD Belt, 10mm x 560mm, 70-Tooth
HTD 45010576	HTD Belt, 10mm x 576mm, 72-Tooth
HTD 45010608	HTD Belt, 10mm x 608mm, 76-Tooth
HTD 45010656	HTD Belt, 10mm x 656mm, 82-Tooth
HTD 45020480	HTD Belt, 20mm x 480mm, 60-Tooth
HTD 45020536	HTD Belt, 20mm x 536mm, 67-Tooth
HTD 45020560	HTD Belt, 20mm x 560mm, 70-Tooth
HTD 45020576	HTD Belt, 20mm x 576mm, 72-Tooth
HTD 45020600	HTD Belt, 20mm x 600mm, 75-Tooth
HTD 45020608	HTD Belt, 20mm x 608mm, 76-Tooth
HTD 45020624	HTD Belt, 20mm x 624mm, 78-Tooth
HTD 45020632	HTD Belt, 20mm x 632mm, 79-Tooth
HTD 45020640	HTD Belt, 20mm x 640mm, 80-Tooth
HTD 45020656	HTD Belt, 20mm x 656mm, 82-Tooth
HTD 45020672	HTD Belt, 20mm x 672mm, 84-Tooth
HTD 45020680	HTD Belt, 20mm x 680mm, 85-Tooth
HTD 45020720	HTD Belt, 20mm x 720mm, 90-Tooth
HTD 45020736	HTD Belt, 20mm x 736mm, 92-Tooth
HTD 45020760	HTD Belt, 20mm x 760mm, 95-Tooth
HTD 45020776	HTD Belt, 20mm x 776mm, 97-Tooth
HTD 45020784	HTD Belt, 20mm x 784mm, 98-Tooth
HTD 45020800	HTD Belt, 20mm x 800mm 100Tooth
HTD 45020824	HTD Belt, 20mm x 820mm 103Tooth
HTD 45020880	HTD Belt, 20mm x 880mm 105Tooth
HTD 45030480	HTD Belt, 30mm x 480mm, 60-Tooth
HTD 45030536	HTD Belt, 30mm x 536mm, 67-Tooth
HTD 45030560	HTD Belt, 30mm x 560mm, 70-Tooth
HTD 45030600	HTD Belt, 30mm x 600mm, 75-Tooth
HTD 45030608	HTD Belt, 30mm x 608mm, 76-Tooth
HTD 45030624	HTD Belt, 30mm x 624mm, 78-Tooth
HTD 45030632	HTD Belt, 30mm x 632mm, 79-Tooth
HTD 45030640	HTD Belt, 30mm x 640mm, 80-Tooth
HTD 45030656	HTD Belt, 30mm x 656mm, 82-Tooth
HTD 45030672	HTD Belt, 30mm x 672mm, 84-Tooth
HTD 45030680	HTD Belt, 30mm x 680mm, 85-Tooth
HTD 45030720	HTD Belt, 30mm x 720mm, 90-Tooth
HTD 45030800	HTD Belt, 30mm x 800mm 100Tooth

## V-Belts

Part No.	Description
GDY 15285	V-Belt, 7/16" x 28.0"
GDY 15301	V-Belt, 7/16" x 29.5"
GDY 15305	V-Belt, 7/16" x 30.0"
GDY 15325	V-Belt, 7/16" x 32.0"
GDY 15335	V-Belt, 7/16" x 33.0"
GDY 15340	V-Belt, 7/16" x 33.5"
GDY 15346	V-Belt, 7/16" x 34.0"
GDY 15351	V-Belt, 7/16" x 34.5"
GDY 15361	V-Belt, 7/16" x 35.5"
GDY 15366	V-Belt, 7/16" x 36.0"
GDY 15371	V-Belt, 7/16" x 36.5"
GDY 15386	V-Belt, 7/16" x 38.0"
GDY 15420	V-Belt, 7/16" x 41.5"
GDY 15436	V-Belt, 7/16" x 43.0"
GDY 15440	V-Belt, 7/16" x 43.5"
GDY 15446	V-Belt, 7/16" x 44.0"
GDY 15450	V-Belt, 7/16" x 44.5"
GDY 15456	V-Belt, 7/16" x 45.0"
GDY 15466	V-Belt, 7/16" x 46.0"
GDY 15475	V-Belt, 7/16" x 47.0"
GDY 17341	V-Belt 17/32" x 34."

## Serpentine Belts

Part No.	Description
GDY 4030240	Serpentine Belt, 3-Rib x 24.0"
GDY 4030245	Serpentine Belt, 3-Rib x 24.5"
GDY 4030250	Serpentine Belt, 3-Rib x 25.0"
GDY 4030260	Serpentine Belt, 3-Rib x 26.0"
GDY 4030267	Serpentine Belt, 3-Rib x 26.7"
GDY 4030280	Serpentine Belt, 3-Rib x 28.0"
GDY 4030325	Serpentine Belt, 3-Rib x 32.5"
GDY 4030350	Serpentine Belt, 3-Rib x 35.0"
GDY 4040235	Serpentine Belt, 4-Rib x 23.5"
GDY 4050280	Serpentine Belt, 5-Rib x 28.0"
GDY 4060240	Serpentine Belt, 6-Rib x 24.0"
GDY 4060250	Serpentine Belt, 6-Rib x 25.0"
GDY 4060252	Serpentine Belt, 6-Rib x 25.2"
GDY 4060260	Serpentine Belt, 6-Rib x 26.0"
GDY 4060267	Serpentine Belt, 6-Rib x 26.7"
GDY 4060295	Serpentine Belt, 6-Rib x 29.5"
GDY 4060315	Serpentine Belt, 6-Rib x 31.5"
GDY 4060320	Serpentine Belt, 6-Rib x 32.0"
GDY 4060325	Serpentine Belt, 6-Rib x 32.5"
GDY 4060330	Serpentine Belt, 6-Rib x 33.0"
GDY 4060335	Serpentine Belt, 6-Rib x 33.5"
GDY 4060340	Serpentine Belt, 6-Rib x 34.0"
GDY 4060345	Serpentine Belt, 6-Rib x 34.5"
GDY 4060350	Serpentine Belt, 6-Rib x 35.0"
GDY 4060355	Serpentine Belt, 6-Rib x 35.5"
GDY 4060360	Serpentine Belt, 6-Rib x 36.0"
GDY 4060365	Serpentine Belt, 6-Rib x 36.5"
GDY 4060370	Serpentine Belt, 6-Rib x 37.0"
GDY 4060374	Serpentine Belt, 6-Rib x 37.4"
GDY 4060380	Serpentine Belt, 6-Rib x 38.0"
GDY 4060385	Serpentine Belt, 6-Rib x 38.5"
GDY 4060390	Serpentine Belt, 6-Rib x 39.0"
GDY 4060395	Serpentine Belt, 6-Rib x 39.5"
GDY 4060400	Serpentine Belt, 6-Rib x 40.0"
GDY 4060410	Serpentine Belt, 6-Rib x 41.0"
GDY 4060740	Serpentine Belt, 6-Rib x 74.0"
GDY 4060785	Serpentine Belt, 6-Rib x 78.5"
GDY 4060935	Serpentine Belt, 6-Rib x 93.5"

## Gilmer Belts

Part No.	Description
GIL 210L100	Gilmer, 1.0" x 21.0"
GIL 225L075	Gilmer, .75" x 25.5"
GIL 225L100	Gilmer, 1.0" x 22.5"
GIL 240L050	Gilmer, .50" x 24.0"
GIL 240L075	Gilmer, .75" x 24.0"
GIL 240L100	Gilmer, 1.0" x 24.0"
GIL 255L050	Gilmer, .50" x 25.5"
GIL 255L075	Gilmer, .75" x 25.5"
GIL 255L100	Gilmer, 1.0" x 25.5"
GIL 270L075	Gilmer, .75" x 27.0"
GIL 270L100	Gilmer, 1.0" x 27.0"
GIL 285L075	Gilmer, .75" x 28.5"
GIL 285L100	Gilmer, 1.0" x 28.5"
GIL 300L050	Gilmer, .50" x 30.0"
GIL 300L100	Gilmer, 1.0" x 30.0"
GIL 322L050	Gilmer, .50" x 32.2"
GIL 345L050	Gilmer, .50" x 34.5"

Belts have changed. Goodyear belts are now manufactured & branded by Continental. Same great quality - New name. GDY will remain the prefix for the Continental Elite Belts.

## KRC Serpentine Belts By Mitsubishi

MBL 4060240	6-RIB X 24.0"
MBL 4060250	6-RIB X 25.0"
MBL 4060252	6-RIB X 25.2"
MBL 4060260	6-RIB X 26.0"
MBL 4060267	6-RIB X 26.7"
MBL 4060295	6-RIB X 29.5"
MBL 4060315	6-RIB X 31.5"
MBL 4060320	6-RIB X 32.0"
MBL 4060325	6-RIB X 32.5"
MBL 4060330	6-RIB X 33.0"
MBL 4060335	6-RIB X 33.5"
MBL 4060340	6 RIB X 34.0"
MBL 4060345	6-RIB X 34.5"
MBL 4060350	6-RIB X 35.0"
MBL 4060355	6-RIB X 35.5"
MBL 4060360	6-RIB X 36.0"
MBL 4060365	6-RIB X 36.5"
MBL 4060370	6-RIB X 37.0"
MBL 4060374	6-RIB X 37.4"
MBL 4060380	6 RIB X 38.0"
MBL 4060385	6-RIB X 38.5"
MBL 4060390	6 RIB X 39.0"
MBL 4060395	6-RIB X 39.5"
MBL 4060400	6-RIB X 40.0"
MBL 4060410	6-RIB X 41.0"



## Belt Gauges



**GDY 09001**  
Belt Gauge, 30-150lbs



**GDY 09002**  
Belt Gauge, 100-300lbs

# Belt Chart

## Belt Lengths for KRC Alternator Brackets:

Chevrolet (Denso and Delco): 28.0" Belt with 3.5" Pulley and 26.0" Belt with 2.5" Pulley

Ford (Denso): 24.5" Belt with 3.5" Pulley and 24.0" Belt with 2.5" Pulley

Dodge (Denso) 26.7" Belt with 3.5" Pulley and 25.0" Belt with 2.5" Pulley **\*\*Bolt Pattern for Pro Series Pump\*\***  
**NEED NEW IMAGE PS3**

### Chevrolet SB Pumps with 4.2" Serpentine Pump Pulley

Pulley Size	Pump Mount	Pulley Reduction	Pro Series III, Elite, Cast Iron #	Belt Length	Pro Series II Aluminum Belt #	Belt Length	Bolt Pattern
4.0" 2.5"	Head	37.50%	GDY 4060370	37"	GDY 4060374	37.5"	A
4.0" 3.0"	Head	25.00%	GDY 4060374	37.5"	GDY 4060380	38"	A
4.0" 3.2"	Head	20.00%	GDY 4060374	37.5"	GDY 4060390	39"	A
4.0" 3.5"	Head	12.50%	GDY 4060380	38"	GDY 4060390	37.4"	B
4.0" 4.0"	Head	0.00%	GDY 4060385	38.5"	GDY 4060400	38"	B
4.0" 2.5"	Block	37.50%	GDY 4060320	32"	GDY 4060330	33"	A
4.0" 3.0"	Block	25.00%	GDY 4060325	32.5"	GDY 4060330	33"	A
4.0" 3.2"	Block	20.00%	GDY 4060325	32.5"	GDY 4060335	33.5"	A
4.0" 3.5"	Block	12.50%	GDY 4060330	33"	GDY 4060340	34.0"	A
4.0" 4.0"	Block	0.00%	GDY 4060335	33.5"	GDY 4060345	34.5"	A

### Chevrolet SB Pumps with 6.0" Serpentine Pump Pulley

Pulley Size	Pump Mount	Pulley Reduction	Pro Series III, Elite, Cast Iron #	Belt Length	Pro Series II Aluminum Belt #	Belt Length	Bolt Pattern
4.0" 2.5"	Head	37.50%	GDY 4060390	39"	GDY 4060380	38"	B
4.0" 3.0"	Head	25.00%	GDY 4060395	39.5"	GDY 4060385	38.5"	B
4.0" 3.2"	Head	20.00%	GDY 4060395	39.5"	GDY 4060390	39"	B
4.0" 3.5"	Head	12.50%	GDY 4060400	40"	GDY 4060395	39.5"	B
4.0" 4.0"	Head	0.00%	GDY 4060405	40.5"	GDY 4060400	40"	B
4.0" 2.5"	Block	37.50%	GDY 4060335	33.5"	GDY 4060340	34.5"	A
4.0" 3.0"	Block	25.00%	GDY 4060340	34"	GDY 4060350	35"	A
4.0" 3.2"	Block	20.00%	GDY 4060340	34"	GDY 4060355	35.5"	A
4.0" 3.5"	Block	12.50%	GDY 4060345	34.5"	GDY 4060355	35.5"	B
4.0" 4.0"	Block	0.00%	GDY 4060350	35"	GDY 4060360	36"	B

**\*\*For Chevrolet Tensioners, add 0.5" for Belt Length\*\***

### 302ci. Ford Pump Belt Chart

Pulley Size	Pump Mount	Pulley Reduction	Pro Series III, Elite, Cast Iron #	Belt Length	Pro Series II Aluminum Belt #	Belt Length	Bolt Pattern
4 2.5	Head	37.50%	GDY 4060355	35.5"	GDY 4060350	35"	B
4 3.0	Head	25.00%	GDY 4060360	36"	GDY 4060355	35.5"	B
4 3.2	Head	20.00%	GDY 4060365	36.5"	GDY 4060355	35.5"	B
4 3.5	Head	12.50%	GDY 4060365	36.5"	GDY 4060360	36"	B
4 4.0	Head	0.00%	GDY 4060370	37"	GDY 4060365	36.5"	B
<b>6.0" Serpentine Pump Pulley</b>							
4 2.5	Head	37.50%	GDY 4060375	37.5"	GDY 4060365	36.5"	A
4 3.0	Head	25.00%	GDY 4060380	38"	GDY 4060370	37"	A
4 3.2	Head	20.00%	GDY 4060380	38"	GDY 4060374	37.4"	A
4 3.5	Head	12.50%	GDY 4060385	38.5"	GDY 4060380	38"	A
4 4.0	Head	0.00%	GDY 4060390	39"	GDY 4060380	38"	A

### 351ci. Ford Pump Belt Chart

Pulley Size	Pump Mount	Pulley Reduction	Pro Series III, Elite, Cast Iron #	Belt Length	Pro Series II Aluminum Belt #	Belt Length	Bolt Pattern
4 2.5	Head	37.50%	GDY 4060360	36"	GDY 4060370	37"	A
4 3.0	Head	25.00%	GDY 4060360	36"	GDY 4060374	37.4"	A
4 3.2	Head	20.00%	GDY 4060365	36.5"	GDY 4060380	38"	A
4 3.5	Head	12.50%	GDY 4060370	37"	GDY 4060380	38"	A
4 4.0	Head	0.00%	GDY 4060374	37.4"	GDY 4060390	39"	A
<b>6.0" Serpentine Pump Pulley</b>							
4 2.5	Head	37.50%	GDY 4060380	38"	GDY 4060374	37.4"	B
4 3.0	Head	25.00%	GDY 4060385	38.5"	GDY 4060380	38"	B
4 3.2	Head	20.00%	GDY 4060390	39"	GDY 4060385	38.5"	B
4 3.5	Head	12.50%	GDY 4060390	39"	GDY 4060385	38.5"	B
4 4.0	Head	0.00%	GDY 4060395	39.5"	GDY 4060390	39"	B

**\*\*3.5" water pump pulley, decrease the belt length by .5"\*\*\***

### Dodge 360 Crate Pump Belt Chart

Pulley Size	Pump Mount	Cast Iron 1st Design Belt #	Belt Length	Pro Series Aluminum Belt #	Belt Length	Bolt Pattern
<b>4.2" Serpentine Pump Pulley</b>						
4 2.5	Block	GDY 4060320	32"	GDY 4060330	33"	B
4 3.0	Block	GDY 4060325	32.5"	GDY 4060335	33.5"	B
4 3.2	Block	GDY 4060330	33"	GDY 4060335	33.5"	B
4 3.5	Block	GDY 4060330	33"	GDY 4060340	34"	B
4 4.0	Block	GDY 4060335	33.5"	GDY 4060345	34.5"	B
<b>6.0" Serpentine Pump Pulley</b>						
4 2.5	Block	GDY 4060335	33.5"	GDY 4060350	35"	B
4 3.0	Block	GDY 4060340	34"	GDY 4060355	35.5"	B
4 3.2	Block	GDY 4060345	34.5"	GDY 4060355	35.5"	B
4 3.5	Block	GDY 4060350	35"	GDY 4060360	36"	B
4 4.0	Block	GDY 4060355	35.5"	GDY 4060365	36.5"	B

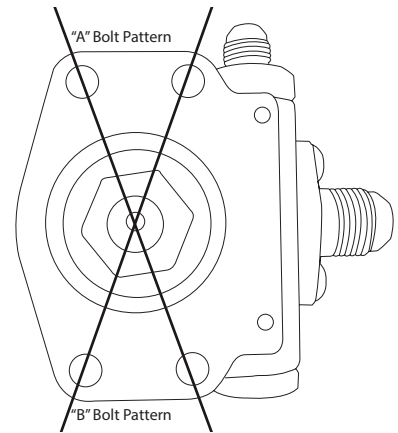

**Chevrolet 350 Water Pump Only Drive Kit with Idler-Tensioner**

Pulley Size	W/P	Crank	Belt Size	Part Number
4.0"	3.0"	25.2"	25.2"	GDY 4060252
4.0"	3.5"	26.0"	26.0"	GDY 4060260
4.0"	4.0"	26.5"	26.5"	GDY 4060265

**Ford 302 Water Pump Only Drive Kit with Idler-Tensioner**

Pulley Size	W/P	Crank	Belt Size	Part Number
4.0"	3.0"	25.2"	25.2"	GDY 4060252
4.0"	3.5"	26.0"	26.0"	GDY 4060260
4.0"	4.0"	26.5"	26.5"	GDY 4060265

**Ford 351 Water Pump Only Drive Kit with Idler-Tensioner**

Pulley Size	W/P	Crank	Belt Size	Part Number
4.0"	3.0"	25.2"	25.2"	GDY 4060252
4.0"	3.5"	26.0"	26.0"	GDY 4060260
4.0"	4.0"	26.5"	26.5"	GDY 4060265

**Chevrolet 350 Alternator Belt 3.5" Accessory Drive Pulley**

Alt. Pulley Size	Belt Size	Part Number
2.5"	26.0"	GDY 4030260
3.5"	28.0"	GDY 4060280

**Ford 302 Alternator Belt 3.5" Accessory Drive Pulley**

Alt. Pulley Size	Belt Size	Part Number
2.5"	24.0"	GDY 4030240
3.5"	24.5"	GDY 4030245

**Ford 351 Alternator Belt 3.5" Accessory Drive Pulley**

Alt. Pulley Size	Belt Size	Part Number
2.5"	24.0"	GDY 4030240
3.5"	24.5"	GDY 4030245

**Dodge Alternator Belt**

Alt. Pulley Size	Belt Size	Part Number
2.5"	25.0"	GDY 4030250
3.5"	26.5"	GDY 4030265

## Pro Series & Cast Iron Pump Lengths to Pulley Centerline

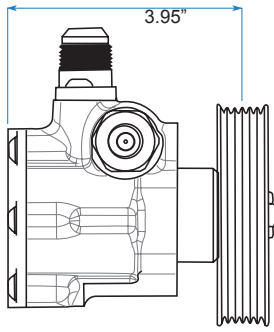

**6-Rib Serpentine Pulley**  
Pump Rotated 90°

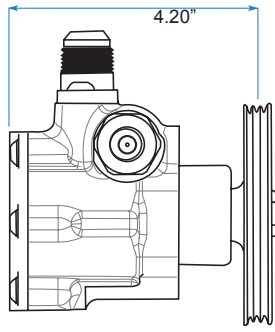

**3-Rib Serpentine Pulley**  
Pump Rotated 90°

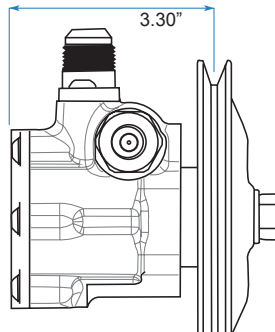

**GM Offset V-Belt Pulley**  
Pump Rotated 90°

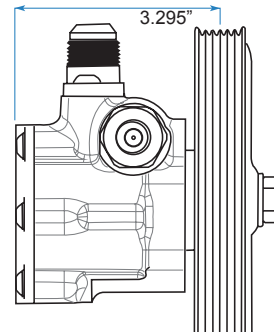

**6-Rib LS F-Body Serpentine Pulley**  
Pump Rotated 90°

**With These Pulleys**

KRC 20015 \_\_\_  
KRC 20017 \_\_\_  
KRC 50120000  
KRC 50217 \_\_\_

**With These Pulleys**

KRC 20015300  
KRC 50120300

**With These Pulleys**

KRC 20008000  
KRC 20011000  
KRC 20012000

**With These Pulleys**

KRC 200196 \_\_\_  
KRC 502196 \_\_\_

**6-Rib LS Y-Body Serpentine Pulley**

Length is 3.085"  
KRC 200206 \_\_\_

## Pro Series Pump Dimensions

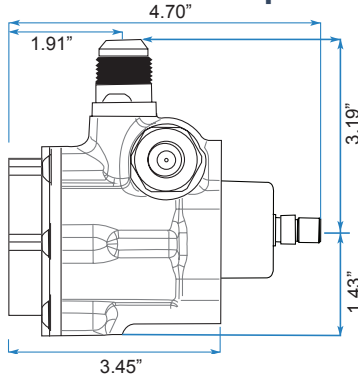

**Fuel Pump With PTO Drive**  
Pump Rotated 90°

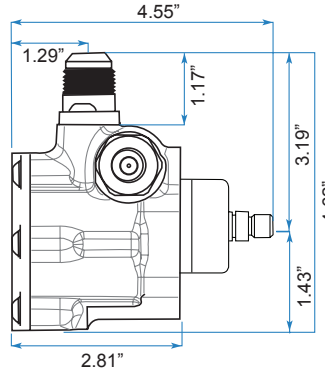

**Aluminum Pump**  
Pump Rotated 90°

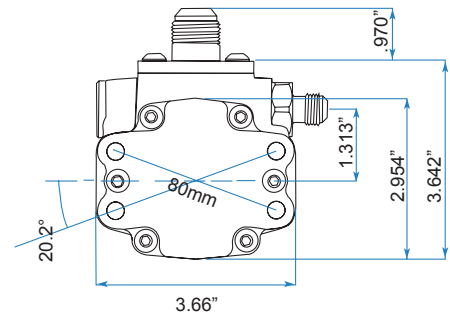

**Aluminum Pump Back View**  
Pump Not Rotated 90°

Flat for Pulley Clearance

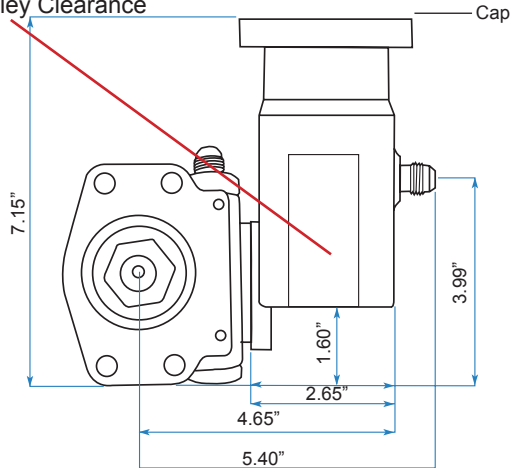

**Aluminum Pump with Tank Front View**

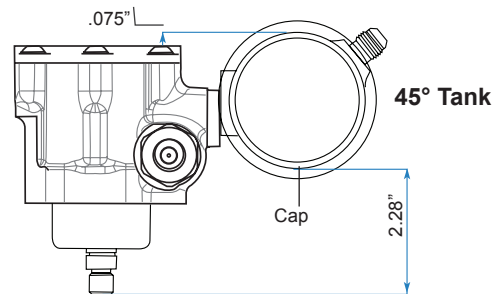

**Standard Tank**

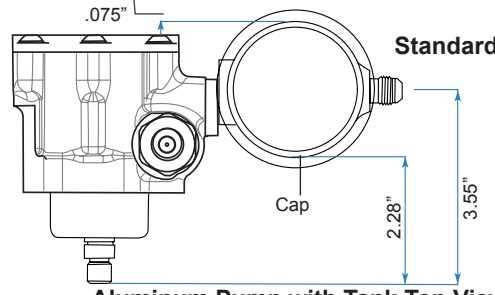

**Aluminum Pump with Tank Top View**

NOTE: Drawings Not to Scale



### Small Block Chevrolet Brackets

Chevrolet small block brackets 350ci. engines. The head bracket mounts to the drivers side cylinder head. The block bracket mounts to the lower drivers side of the engine.

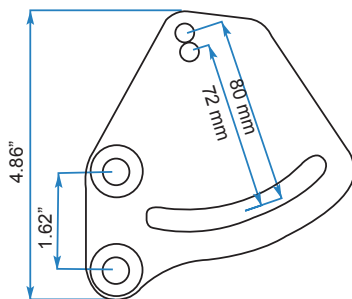
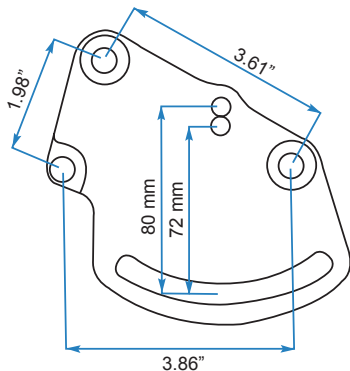

### Small Block Dodge Bracket

Dodge brackets will fit most 340ci. & 360ci. Mopar blocks.

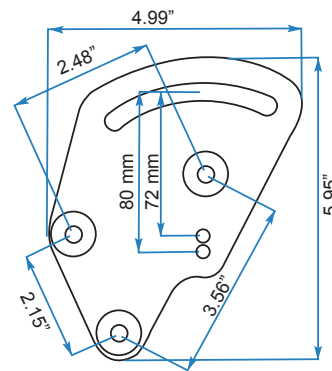

### Big Block Chevrolet Brackets

Chevrolet big block brackets will most 396ci., 402ci., 427ci., 502ci. & 572ci. engines. Three brackets are available, one for each cylinder head, as well as one for the driver's side block.

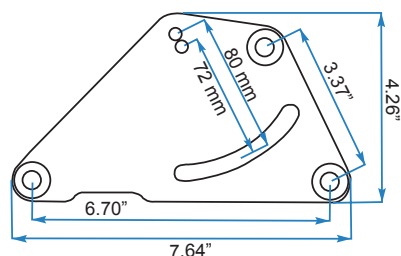

Big Block Chevrolet Left/Driver Cylinder Head

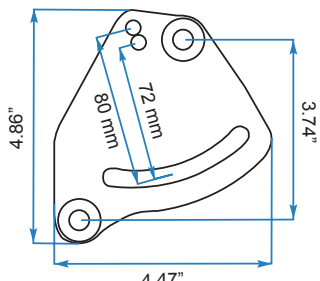

Big Block Chevrolet Left Block

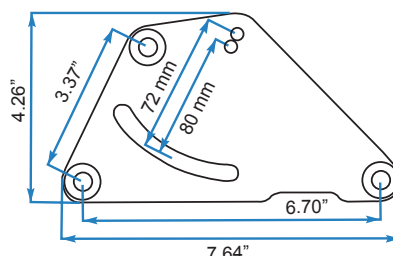

Big Block Chevrolet Right/Passenger Cylinder Head

### Ford Brackets

Ford head mounting bracket kits, **KRC 31611000** & **KRC 31621000**, will fit several head bolt patterns. Refer to the four drawings to the right to see if they will fit in your application. Bolt patterns for both brackets are the same. Bracket **KRC 31611000** will fit short deck 260ci., 289ci. & 302ci. (8.2" - 8.7" deck height) blocks regardless of which head is bolted to the block. Bracket **KRC 31621000** is the same except it fits all tall deck 351ci. or 400ci. blocks (9.2" - 9.5" deck height)

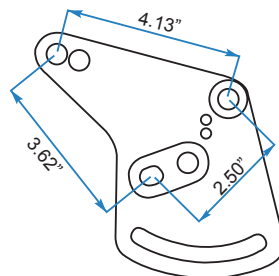

Old 302-351 Windsor Head Bolt Pattern

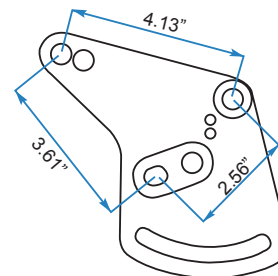

New 302-351 Windsor Head Bolt Pattern

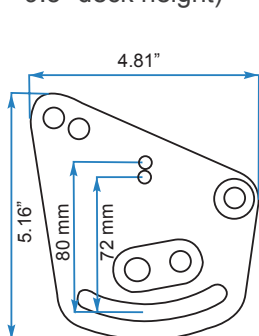

351ci.-400ci. With 9.2"-9.5" Deck Height

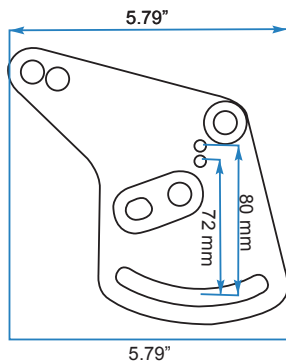

260ci.-289ci.-302ci. With 8.2"-8.7" Deck Height

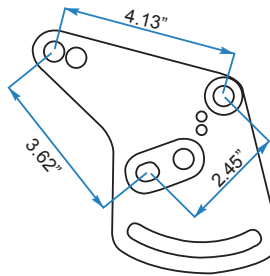

351N Sportsman Head Bolt Pattern

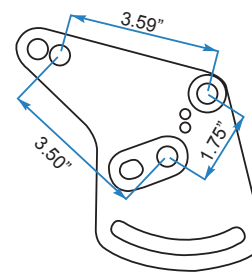

351 Cleveland Head Bolt Pattern

## Water Pump Technical Information

Note: If you are using a mechanical fan, make sure the fan is balanced before bolting it to the water pump. Out of balance fan blades can damage the pump seal or loosen the fan hub. For vehicles running electric fans, you should design the radiator opening to cool the engine at race speeds. Electric fans should be utilized under cautions allowing air flow to manage cooling at race speeds.

### SBC Water Pump Mounting Boss Height

Water pump bolt faces typically have large variations in the spot facing. The surface that the bolt head mates to can vary from pump to pump making it difficult to align your pulleys & brackets. KRC High Performance water pump (**KRC 15101001**) features CNC machined mounting bosses ensuring that brackets bolt down at the same height every time. Proper belt alignment of all pulleys, brackets & belts is ensured when using KRC components. If you are not using a KRC water pump you will need to adjust for the varying your mounting bosses.

To verify the mounting boss height, place the water pump on a flat surface. With calipers, measure the mounting boss height using the flat surface as a reference - see fig 1. Refer to fig 2 for **KRC 15101001** mounting boss heights. If your pump does not match the KRC water pump height, you will need to adjust for potential differences.

If the height of one of your water pump bosses is higher than the KRC height, you will either have to spot face the mounting boss with a .875" spot face tool to achieve the proper KRC height, or subtract the difference from the spacers included with your bracket.

If the height of one of your water pump bosses is lower than the KRC height, add washers or machine custom spacers to compensate for the difference in height.

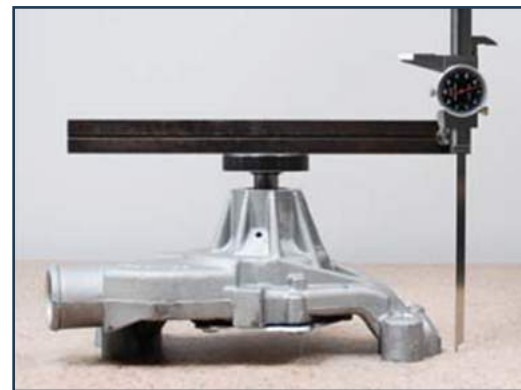
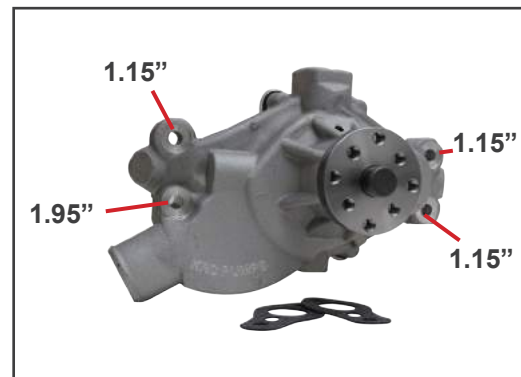

# Water Pump Technical Information

## Water Pump Length

To check the length of your water pump do the following.

- 1) Set the water pump on a flat surface. Then place a straight edge over the water pump flange. (For Ford Water pumps the back water pump plate, gasket and bolt must be removed to measure Height.)
- 2) With a set of calipers, measure from the flat surface to the bottom edge of the straight edge.

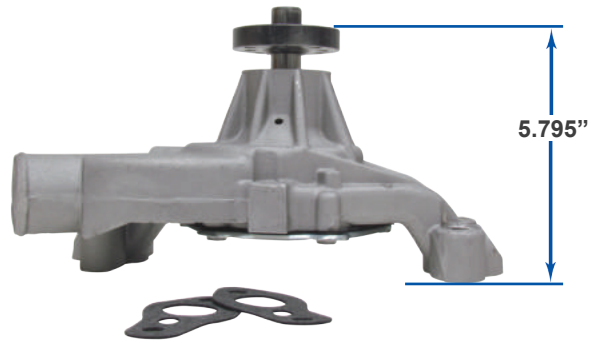

**KRC 15101001**

## Small Block Chevrolet:

KRC High Performance water pump (**KRC 15101001**) has a water pump height of 5.795" with a 3/4" shaft. All KRC small block Chevrolet pulley kits are designed for this length water pump. If you have a water pump that is shorter than 5.795", we have a few options that will allow you to still use a KRC serpentine pulley system. If you have a 5.595" water pump with a 5/8" shaft, you can use **KRC 15050200** water pump pulley spacer, or a **KRC 15001000** water pump spacer to obtain proper alignment with a KRC pulley system. If you have a short water pump we have 1.045" and .620" long crank adapters that will work with the short pump.

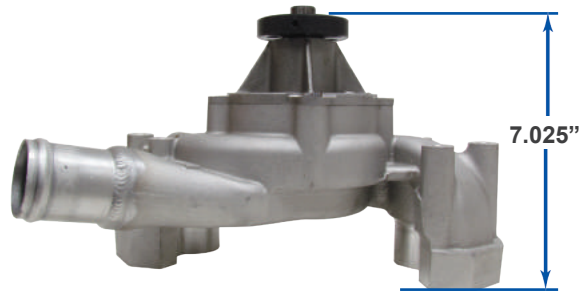

**KRC 15425702**

## Small Block Ford:

All KRC 302ci. & 351ci. Pulley Kits are designed for a 5.700" long water pump.

## Small Block Dodge:

All KRC 340ci. & 360ci. Pulley kits are designed for a 5.547" long water pump.

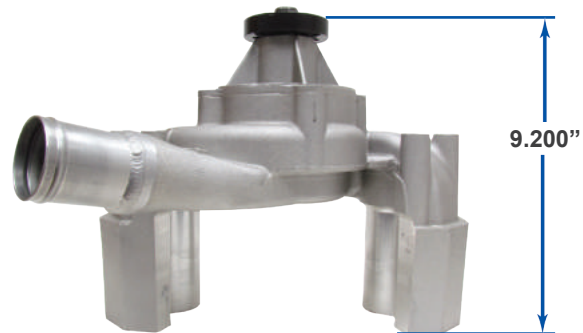

**KRC 15425920**

# Plumbing Tips



Photo 1

Power steering pumps require a hose with a vacuum rating of 28 INCHES/HG on the inlet side, and a minimum 1/2" inside diameter. This is required to keep the hose from collapsing at higher RPM. As seen in Photo 1 on the left, common hydraulic hose may have a -10 fitting on them, yet the inside diameter is smaller than it should be. This will damage the pump because there is no way for the pump to intake enough fluid to meet its requirement through such a small hole. Be sure to verify the correct hose type & diameter are always used.



Photo 2

Never use Push-lock hose. It may be the proper inside diameter, but the vacuum rating is only 18 INCHES/MG. As the fluid warms up, the hose softens further reducing the rating. Push-lock hose will suck shut in operation starving the pump of fluid. Severe damage to the internals of the pump will occur if fluid flow is interrupted - See Photo 2



Photo 3

The -6 pressure hose, leaving the pump, must have an operating pressure of 2,250 psi. & an inside diameter of .31". Common hydraulic hose may have the proper operating range, but their inside diameter is slightly smaller. See Photo 3. The smaller diameter can restrict the flow to the steering gear. This can cause problems in your steering, such as tight spots in the turns & increased driver effort.

Make sure the -10 feed line from the reservoir tank (remote tanks only) has a 1/2" inside diameter. Some brands import tanks to the U.S. that have a 3/8" inside diameter. The reduced diameter will restrict flow to the pump & will damage the pump within a few races.

KRC recommends Aeroquip AQP high pressure power steering hose & fittings or equivalent.

When assembling new hoses thoroughly clean them with a rifle bore brush & then flush them out with hot water. Air dry hoses before use. Most problems with power steering systems are due to contamination from new hoses & steering components resulting in damage to the pump. Always place caps on pumps, steering gears and hoses when system is open to the air.

Do not install any filters or coolers on the high pressure -10 side of the reservoir. Install them on the lower pressure return side if they are needed.

Never start your engine without fluid in the reservoir tank. Running the pump without fluid can permanently damage the pump in seconds.

Route all hoses and reservoir tanks away from headers to keep from adding heat to the system and burning the fluid.

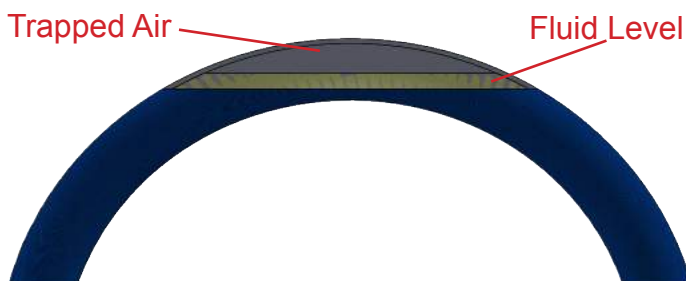

A loop going upwards on the pump inlet side can easily provide an area that will trap air blocking proper flow. The trapped air can actually decrease the amount of flow to the pump since the fluid has to flow under the air pocket reducing the flow to the pump. Trapped air in hose loops can cause cavitation in the pump, especially at high RPM's.

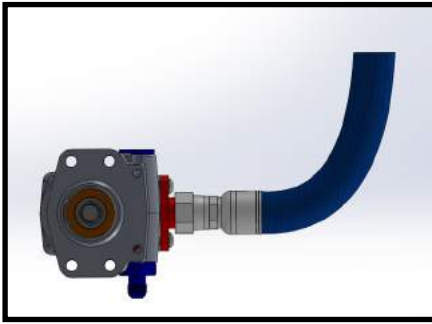

A power steering pump needs to be gravity fed creating a downhill route free from loops from the tank. Mounting the reservoir tank above the pump provides optimal flow.

Ensure your hose routing eliminates any chance for loops to form in your power steering system plumbing.

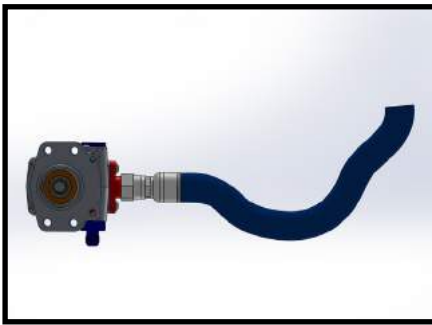

If space requires you to form a loop (see photo to left) be sure that the loop is on the bottom with smooth transitions. Avoid a bottom loop if at all possible - the bottom loop will work, but is not advised.

Loop towards the bottom.

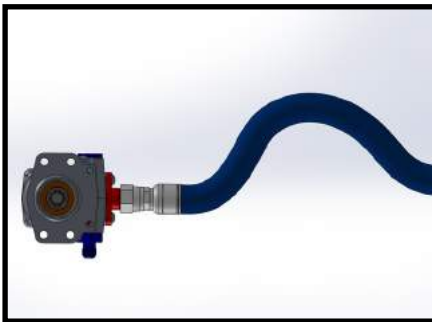

Avoid loops going upwards as air pockets can negatively impact performance. Restricted flow will result in damage to your pump.

Loop going upwards is a problem - avoid at all cost.

## System Bleeding

Never start your engine without filling and bleeding your power steering system. A system without fluid flow can damage components within seconds.

- 1) Begin bleeding process with the car on jack stands allowing the front wheels to turn.
- 2) Fill the reservoir slowly and bring the level up near the top with cap off.
- 3) Crack the pressure line at the steering gear or rack allowing fluid to seep out of the loosened fitting until you get a steady flow without air.
- 4) Without starting the motor either crank it over with the starter or take the belt off and prime the pump with a drill. NOTE: Be sure to turn it in the correct direct direction (clockwise when looking at the pump from the front) as the pump only works in one direction of rotation.
- 5) Turn the steering wheel left & right a few times completely from side to side while it's still on jack stands.
- 6) Check the fluid level & fill it to 2 inches above the return line fitting. Install the cap securely.
- 7) Lower the car & start it. Let everything warm up for a 3 to 5 minutes. Then, turn the wheel from side to side multiple times. Recheck the fluid level.
- 8) KRC Power Steering caps are non-vented so you will want to burp the system after it's warm. With the car still running at idle, turn the cap to burp the pressure off & then tighten the cap securely.

# TESTING YOUR PUMP

## KRC Power Steering Invests In Custom Built Pump Dyno Testing Equipment Discovering 4 to 6 HP Savings

The KRC Power Steering Pump Dyno identifies pump efficiency. One pump can consume twice the power of another! The Dyno records operating pressures and flow referenced to RPM. HP losses are calculated during each lap. Pressure flow, tire and steering loads. are recorded by lap. Our Dyno synchronizes data acquisition with a GoPro® camera.

The KRC Power Steering Pump Dyno was manufactured to our specifications by Chant Engineering. Chant builds pump Dyno's for the United States Air Force. Our tester has discovered power steering system secrets reminiscent of racing aerodynamic revelations found by race teams via wind



tunnel.

Our detailed testing creates a definitive HP edge. KRC Power Steering President Ken Roper states, "NASCAR race teams strive to identify every gain possible. KRC Dyno runs provide the data to create repeatable performance gains.. Road Race and short

track racers benefit from our exhaustive testing process and feedback received from professional Race Teams worldwide".

The KRC tester confirms that a small 5.9cc pump is capable of developing as much flow as a larger pump while consuming half the horsepower. Testing of GM-style power steering pumps discovered that they drain a significant amount of HP. KRC Pro Series III 5.9cc pumps used on Aston Martin's winning Le Mans Sports Cars consumes only 1.9 HP resulting in increased power at the rear wheels.

### Using Data Acquisition & GoPro® Video To Identify Power Loses.

The KRC Dyno measures pressure, flow while calculating power consumption. With data acquisition, we are able to simulate racing conditions in a variety of real world scenarios. By providing KRC with the relevant data acquisition—operating pressures and flow referenced to RPM—the information is entered into the KRC Dyno. Horsepower consumption is calculated during

each lap. Data acquisition synchronized with a GoPro® video camera, visually identifies pressures, flow, tire and steering loads and horsepower consumption all while providing visual feedback at any given position on the track.

For example, in Turn 4 the Race Car has data of 500psi of pressure and 2.3 gallons per minute of flow which equates to consumption of 4hp. In this case, a different pulley diameter could improve HP loss. The KRC Dyno can identify optimal performance in a variety of simulated conditions. We can check data over a 500 mile race monitoring many data points such as temp, fluid flow, efficiency and more.

Our test equipment demonstrates that the power steering system's greatest efficiency is achieved when the pump is operating between 2,000 and 4,000 RPM. Therefore, if an engine operates mostly at 8,000 RPM, the power steering pump would function more efficiently at around half of engine speed.

## CUSTOM PUMP ORDERING

KRC has hundreds of different combinations when ordering a custom pump. Use our easy numbering system for all Series III pump options per the table below.

Pump Type	Pump Volume	Shaft Type	Outlet fitting	PSI & Flow Fitting Material	Flow Fitting Size	Rear Cover	Intake Type
Series III = 2	6 = 5.9cc	1 = Pulley Drive	1 = Left/Up	2 = 1200psi, Aluminum	4 = 4	1 = Flat Cover	1 = -10AN fitting
	7 = 7.2cc	2 = 17-Spline Drive	2 = Right/Down	3 = 1200psi, Steel	5 = 5	2 = PTO Cover	2 = -10AN, Swivel 90°
	8 = 9.6cc	3 = 3/8in Hex Nut	3 = HAH* Left/Up	4 = 1450psi, Aluminum	6 = 6	3 = Marine, Flat Cover	3 = Bolt-on tank
			4 = HAH* Right/Down	5 = 1450psi, Steel	7 = 7	4 = Marine, PTO Cover	4 = Bolt-on tank 45°
			* Hard Anodized Housing	6 = 1600psi, Aluminum	8 = Std		5 = -12AN fitting
				7 = 1600psi, Steel	9 = B		
					0 = C		
					1 = D		
					2 = E		

For example: Part # 29116811 would be KRC Series III Pump built to the following specifications: 9.6cc pump volume, a pulley drive with an outlet fitting facing upwards left, a pressure relief of 1600psi (aluminum pump), a standard flow valve, a rear flat cover with a -10 intake fitting.

# Cast Iron Pump Accessories

## Cast Iron Pump Repair Parts and Accessories

**KRC 21205000 and KRC 21200090 are not to be used on the Pro Series Aluminum power steering pump.**



### KRC 21205000\*

A -12 inlet fitting is the perfect add-on for a KRC cast iron pump. This fitting allows more fluid to the steering pump in applications where a larger flow control fitting is used. Includes new O-ring. For Cast Iron & Pro Series III pumps only.



### KRC 21200090\*

This -10, 90° inlet fitting rotates 360° and provides greater flexibility when plumbing the power steering system in engine compartments that are cramped. Includes a new pump O-ring seal and allen head mounting bolts. Fits KRC Cast Iron & Pro Series III pumps only.



### KRC 21200000\*

-10 pump inlet fitting. Replace if damaged or shows any sign of wear. A small vacuum leak can cause aeration of the fluid and make the pump run hot. For KRC Cast Iron & Pro Series III pumps only. Pro Series II pumps require a KRC 60212000



### KRC 50050000

Replacement stand-off spacers for cast iron pumps.



### KRC 51050000

O-ring and seal kit for cast iron pumps.



### KRC 51450000

Replacement 1450 psi Pressure Relief Spool Valve & Spring. Cast iron pumps only.



### KRC 21201000

Bolts (2) for -10 Pump Fittings



### KRC 51060000

Replacement Front Bearing for cast iron pumps.



### KRC 51220000

Replacement shaft for cast iron pumps.

## Cast Iron Pump Water Pump Pulley Drive Kit

KRC 3.5" V-belt water pump pulley drive kit, **KRC 20102000** will reduce the power steering pump speed by 42% if using a 6" power steering pump pulley. This makes it an ideal kit for high rpm engines using a V-Belt power steering pump. This kit will help keep the speed of the power steering pump below 5,500 RPM, increasing the life of the pump by reducing the fluid temperature. Includes bracket spacers, pulley, belt & hardware. For head mounted Small Block Chevy steering pump brackets only.



### KRC 20102000

3.5" V-Belt Accessory Drive Pulley Kit (Chevrolet Head Mount Only)

# Flow Control Fitting Technical Data

## How To Choose the Right Flow Control Fitting

Selecting the correct Flow Control Fitting for your application can bring changes to your steering system you never knew existed. There are a few things that need to be considered when determining which Flow Control Fitting is best for your application. Much of the time, the Flow Control Fitting that comes in the pump from the factory is the best choice. Depending on the track, driver preference, and steering system, a different Flow Control Fitting may be required. The same goes for use in Hot Rods, Muscle Cars or other applications, there are a lot of variables that come into play.

## How to identify which Flow Control Fitting you have?

Each Flow Control Fitting comes from the factory with an identification mark (I.D.) on the hex of the Flow Control Fitting. If there are no letters or numbers on the valve, then it is the standard valve that comes with the pump. If the valve has a letter B-E stamped on it, then you have a “more assist” Flow Control Fitting. The ID:E valve will give you the most flow and assist. If the valve has a number 4-7 on it, then you have a more feel Flow Control Fitting. The ID:4 valve will give you the least amount of flow and the most feel.

## How does the Flow Control Fitting work?

The Flow Control Fitting is very simple to understand. Think of it like changing a jet in a carburetor. The bigger the Flow Control Fitting you use, ID:B-E, the more fluid will be coming out of the pump. This will give you more assist in the steering system, but will take away some of the feel. The smaller the Flow Control Fitting you use, ID:4-7, the less fluid will be coming out of the pump. This will give you more feel, but take away some of the assist.

## What valve do I need to use with my steering rack?

The size of your steering rack will be the biggest determinate as to which size Flow Control Fitting is needed. If you have a rack that is 3.5” or larger, then an ID:E Flow Control Fitting would be the first option to place in the pump and try. If you feel the steering is too light and you have too much assist, then you can back the Flow Control Fitting down in size to an ID:D or ID:C.

## What valve do I need to use with my steering box with **no quickener**?

A steering box type system may or may not require a Flow Control Fitting change. If you have a quick steering box, 6-to-1 or 8-to-1, you may have to increase the Flow Control Fitting size to an ID:E valve. If you have too much assist and not enough feel, you can then drop down in Flow Control Fitting size. The key is to find the best match between the pump, driver feel and steering box. If you experience a tight spot while turning the wheel left and right, it is called “pump catch.” To resolve this issue, you will want to increase the Flow Control Fitting size until it goes away. If you are running a 12-to-1 box you may need to start with an ID:C valve. See how the steering feels. You may have to adjust accordingly with a higher valve to get more assist or a smaller valve to get more feel. Make sure you don’t drop the flow down too low to a point where you experience pump catch. If you have a 16-to-1 box or higher the standard Flow Control Fitting should work best and then changing it would be per driver preference.

## What Flow Control Fitting do I need to use with my steering box **with a quickener**?

A steering system with quickener will more than likely require a larger Flow Control Fitting. The reason for this is the servo inside the steering box is moving either 1.5 times or 2.0 times faster. Due to the quickness, more fluid is required to fill the void as the servo moves. If you do not have enough fluid coming into the servo you may experience “pump catch” in the middle of the corner. This will feel like a tight spot in the steering system when turning the wheel left and right at race speeds. The size of the steering box will also determine what size valve will be required. If you have a high ratio box with a quickener you may want to start with an ID:C valve. If you experience pump catch or need more assist then increase the Flow Control Fitting size. If you are using a lower ratio box, then you may want to start with an ID:E valve. If you need more feel than the ID:E valve provides, just drop down in Flow Control Fitting size. Make sure you don’t drop down too low to the point where you experience pump catch.



### How do I adjust my Flow Control Fitting to the race track and car?

A car with wide tires and a lot of positive caster may also require more fluid flow out of the pump (ID:B-E Flow Control Fittings). If you race on smaller tracks with tight corners or a higher banked track, a larger Flow Control Fitting, ID:B-E, can be used to give you more assist through the corners. If you race on a larger track with long straightaways and sweeping corners, a smaller Flow Control Fitting, ID:4-7, can be used to gain more feel and stability in the steering system. When selecting a Flow Control Fitting for a race track only car, the driver should use the valve that feels the best at races speeds.

### How do I adjust the Flow Control Fittings for street rod applications?

highway stability. Also pump speed at lower RPM must be taken into consideration to optimize the pump.

### Which pressure relief valve do I need?

KRC offers three pressure relief valves, 1200psi., 1450psi. and 1600psi. On higher banked race tracks and cars with short steering arms, wide tires, a big bar soft spring setup, running on bump stops and/or a lot of positive caster, a higher pressure relief valve should be used, as well as possibly a higher volume Flow Control Fitting. You will know if you are having pressure problems when you drive into the corner and around the apex of the turn the steering assist feels like it goes away for a split second. That is created by the pump going into bypass. Our 9.6cc pumps come with 1600psi. of pressure relief. This has been a running change over the past several years. If you are unsure as to which relief valve you have in your pump, please call us with the serial number off the back of the pump.

### Pump Flow: Rating at 180° Fluid Temp and 500 PSI

9.6 CC Pro Series Aluminum Pump			
Part Number		Pump Flow	ID Mark
Aluminum	Steel		
KRC 25304000	KRC 25404000	1.18 GPM	4
KRC 25305000	KRC 25405000	1.43 GPM	5
KRC 25306000	KRC 25406000	1.70 GPM	6
KRC 25307000	KRC 25407000	1.96 GPM	7
KRC 25308000	KRC 25408000	2.22 GPM	None
KRC 25309000	KRC 25409000	2.41 GPM	B
KRC 25310000	KRC 25410000	2.65 GPM	C
KRC 25311000	KRC 25411000	2.75 GPM	D
KRC 25312000	KRC 25412000	2.92 GPM	E

13.5 CC Cast Iron Pump			
Part Number		Pump Flow	ID Mark
Aluminum	Steel		
KRC 25304000	KRC 25404000	1.66 GPM	4
KRC 25305000	KRC 25405000	2.03 GPM	5
KRC 25306000	KRC 25406000	2.35 GPM	6
KRC 25307000	KRC 25407000	2.67 GPM	7
KRC 25308000	KRC 25408000	2.91 GPM	None
KRC 25309000	KRC 25409000	3.32 GPM	B
KRC 25310000	KRC 25410000	3.75 GPM	C
KRC 25311000	KRC 25411000	4.01 GPM	D
KRC 25312000	KRC 25412000	4.21 GPM	E

### Aluminum Flow Control Fittings



### Steel Flow Control Fittings

