



# Set of bearing extracting tools, 25-A

## Contents

Inhalt/ Art.-No.			Inhalt/ Art.-No.
	<b>21-1</b>	12-16	15/32 - 5/8
	<b>21-2</b>	14-19	9/16 - 3/4
	<b>21-3</b>	18-23	23/32 - 29/32
	<b>21-4</b>	20-30	25/32 - 1 3/16
	<b>21-5</b>	28-40	1 7/64 - 1 9/16
	<b>21-6</b>	35-46	1 3/8 - 1 13/16
			<b>22-1</b>
			<b>22-2</b>

## INFO: slide hammer and internal extractors

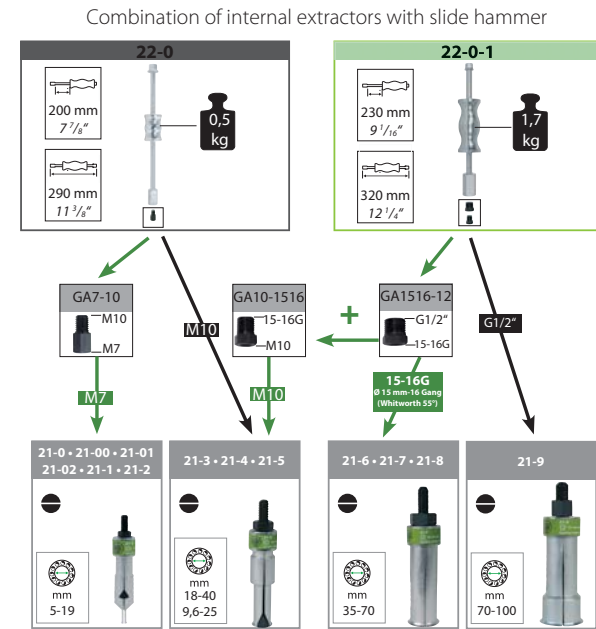

## INFO: counterstays and internal extractors

### Combination of internal extractors with counterstays

