



Mastercool[®] Inc.
"World Class Quality"

HYDRA-KRIMP FABRICATING A/C HOSES JUST GOT EASIER...



SPECIFICATIONS:

Part#	Description
71500 - 001AB	Hydra - Krimp Pump
71500 - 001B	Hydra - Krimp Yoke
71500-001C	Complete Die Set Assembly (7 pc. set)
71500 - 6	Die Set - #6 (5/16") Reduced Barrier
71500 - 8	Die Set - #8 (13/32")
71500 - 10	Die Set - #10 (1/2")
71500 - 12	Die Set - #12 (5/8")
71500 - 6SRB	Die Set - #6 (5/16") Reduced Barrier
71500 - 10SRB	Die Set - #10 (1/2") Reduced Barrier
71500 - 12SRB	Die Set - #12 (5/8") Reduced Barrier
71500 - PB	Custom Molded Box

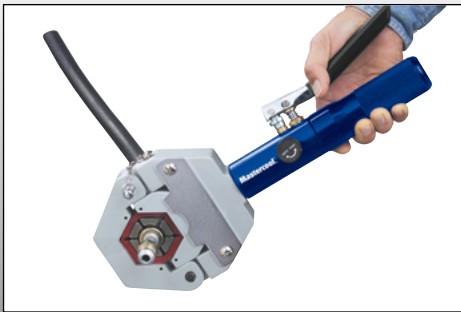

Easy to use hydraulic hand-held pump crimps the hose fitting in under 10 pumps.

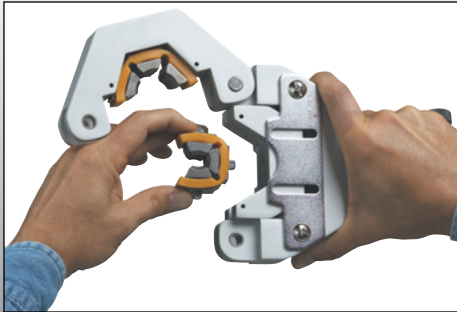

The die snaps quickly into the press fixture requiring no pins or screws.

71500-A HYDRA-KRIMP

Mastercool's patented "Hydra - Krimp" makes crimping barbed and beaded fittings as easy as 1 - 2 - 3!

The lightweight hand-held hydraulic press is very portable and ideal for shop and field applications. The kit comes with a complete set of dies covering hose sizes #6, #8, #10, #12 and reduced barrier #6, #8, #10 and #12. The dies snap quickly into the press fixture requiring no pins or screws. Kit comes in a custom molded case.

- ACCEPT NO IMITATIONS, Mastercool's US designed A/C crimper has been the standard for over 25 years
- IDEAL FOR SHOP AND FIELD APPLICATIONS, the mobility of the 71500 allows the technician to work directly to repair or fabricate a/c hoses on the vehicle
- HYDRAULIC BODY CREATES OVER 10,000 PSI OF PRESSURE allowing technicians to recrimp existing hose assemblies that might have a leak
- MASTERCOOL'S DIES ALLOW FOR AN OE DESIGN 6 SEGMENTED CRIMP to ensure no leaks
- EASY TO USE HYDRAULIC HAND-HELD PUMP crimps the hose fitting in under 10 pumps



Part #	Description	FIG.
71500	HYDRA-KRIMP HOSE KRIMPER	
71500-001A	Complete Hydraulic Assembly	A
71500-001B	Yoke Assembly	B
71500-001C	Die Set Assembly	C
71500-PB	Plastic Molded Box for 71500	
71500-INST	Operating Instructions	
71500-001	HYDRA-KRIMP ASSEMBLY	
71500-001A	Complete Hydraulic Assembly	A
71500-001B	Yoke Assembly	B
71500-001A-1	HANDLE SHAFT ASSEMBLY FOR 71500	1
71500-001A-2	HANDLE	
71500-56	Handle only for 71500	56
71500-37A	Back Pin & Ring for Handle	37A
71500-37B	Front Pin & Ring for Handle	37B
71500-001A-3	OIL RESERVOIR ASSEMBLY	
71500-51	Rubber Oil Reservoir	51
71500-52	Oil Reservoir O-ring	52
71500-40K-NEW	NEW VALVE ASSEMBLY KIT	10
71500-38	.187" Silver Ball	
71500-40K-OLD	OLD VALVE ASSEMBLY KIT	11
71500-38	.250" Silver Ball	
71500-001B-1	YOKE PIN & CHAIN ASSEMBLY	
71500-2A	Pin Chain for 71500	2A
71500-2	Yoke Pin for 71500	2
71500-3	Yoke Pin O-ring for 71500	3
71500-001B-2	YOKE & HINGE PIN ASSEMBLY	
71500-5	Yoke Hinge Pin	5
71500-2A	Pin Chain for 71500	2A
71500-2	Yoke Pin for 71500	2
71500-3	Yoke Pin O-ring for 71500	3
71500-06	Snap Ring for Hinge Pin 71500-5	6
71500-001C	DIE SET ASSEMBLY	
71500-6	Die Set #6 (5/16")	
	Purple (#8 Reduced Barrier)	9
71500-8	Die Set #8 (13/32") Red	9
71500-10	Die Set #10 (1/2") Yellow	9
71500-12	Die Set #12 (5/8") Green	9
71500-6SRB	Die Set #6 Black (5/16" Reduced Barrier)	9
71500-10SRB	Die Set #10 Orange (1/2" Reduced Barrier)	9
71500-12SRB	Die Set #12 Blue (5/8" Reduced Barrier)	9
71500-001C-1	PLASTIC DIE HOLDER ASSEMBLY	
71500-6-PURPLE	Plastic Die Holder #6 (5/16")	
	(13/32" #8 Reduced Barrier) Purple	7
71500-8-RED	Plastic Die Holder #8 (13/32") Red	7
71500-10-YELLOW	Plastic Die Holder #10 (1/2") Yellow	7
71500-12-GREEN	Plastic Die Holder #12 (5/8") Green	7
71500-6RB-BLACK	Plastic Die Holder #6 (5/16" Reduced Barrier) Black	7
71500-10RB-ORANGE	Plastic Die Holder #10 (1/2" Reduced Barrier) Orange	7
71500-12RB-BLUE	Plastic Die Holder #12 (5/8" Reduced Barrier) Blue	7

Part #	Description	FIG.
71500-001A-6	2 OZ. HYDRAULIC OIL	
71500-18-KIT		
71500-18-BO	Backup O-Ring	12
71500-18-O	O-Ring	13
71500-17-R	Piston Shaft	14
71500-15	Piston Cap	15

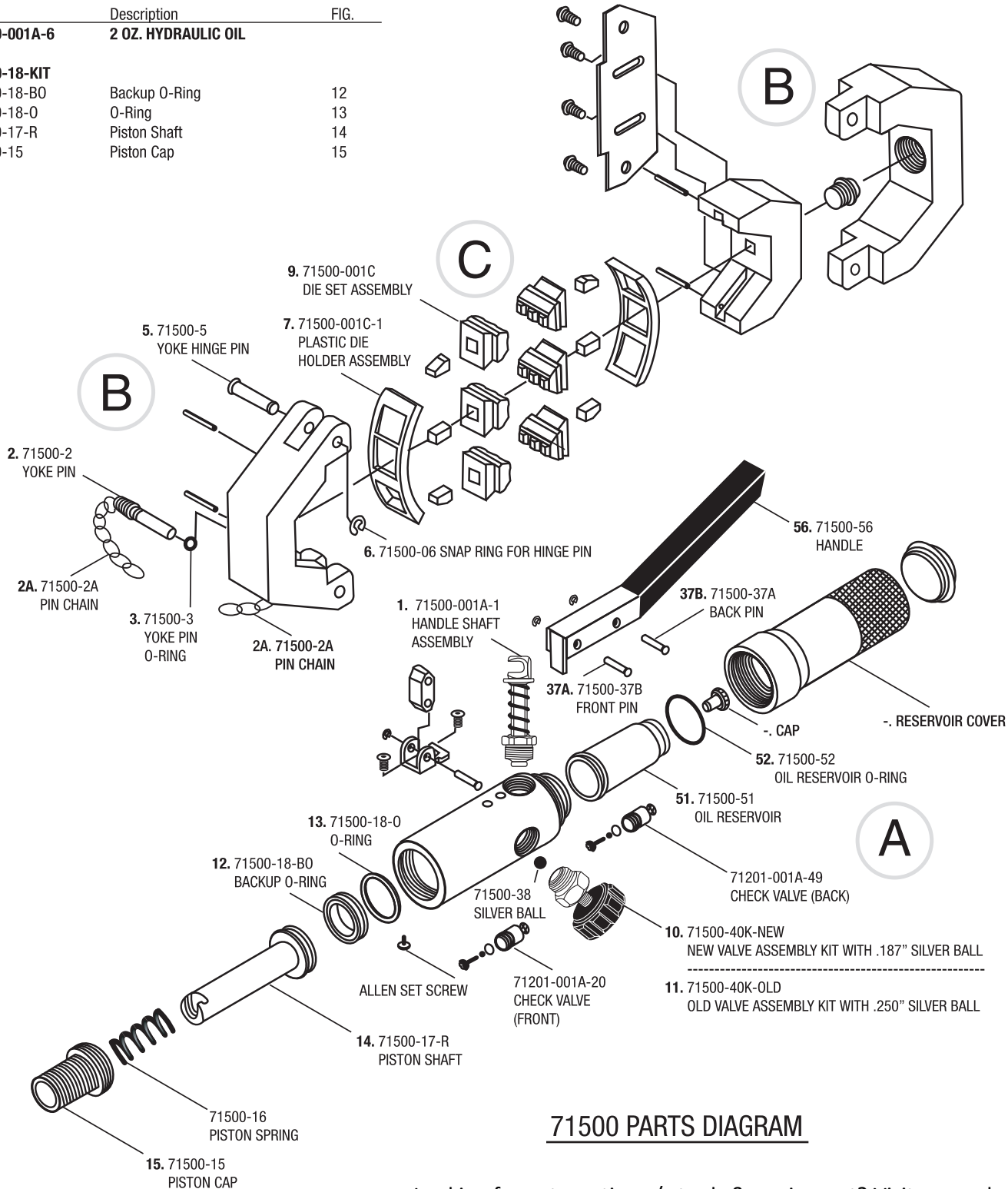

71500 PARTS DIAGRAM

Looking for automotive a/c tools & equipment? Visit our website.