



INSTALLATION INSTRUCTIONS FOR PART 82-9601

APPLICATIONS

Harley-Davidson 1998-2013

(FL models with fairings)

82-9601

KIT FEATURES

- Mounts aftermarket 6.5" to 6.75" speakers into factory speaker locations.

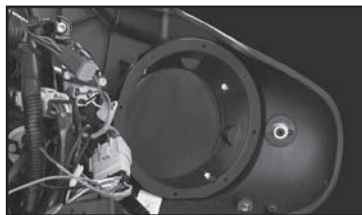

KIT COMPONENTS

- A) (2) **speaker adapters** • B) (6) #8 x 1" Pan-head Phillips screws

A

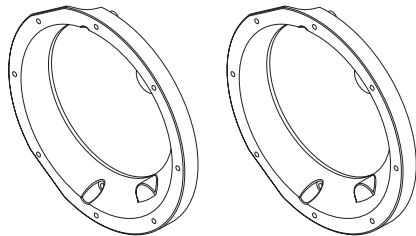

B

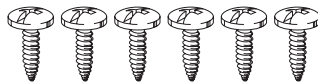

TOOLS REQUIRED

- Panel removal tool • Phillips screwdriver • Socket Wrench (T-25, T-27, 6mm or 3/16 hex)

CAUTION: Metra recommends disconnecting the negative battery terminal before beginning any installation. All accessories, switches, and especially air bag indicator lights must be plugged in before reconnecting the battery or cycling the ignition.

NOTE: Refer to the instructions included with the aftermarket radio.

Fairing Disassembly

FLH/Batwing models:

1. Cover the front fender.
2. Remove (2) T-27 Torx bolts from inner fairing (under mirrors) (Figure A, step 2)
3. Remove (2) T-27 Torx bolts from outer edges of inner fairing near the fork tubes (facing forward) (Figure A, step 3)
4. Remove (3) T-27 Torx bolts from bottom edge of windshield. (Figure A, step 4)

NOTE: Windshield and fairing will be loose once these screws are removed. Use extreme caution not to damage fairing or windshield.

5. Remove windshield taking caution that the outer fairing is loose.

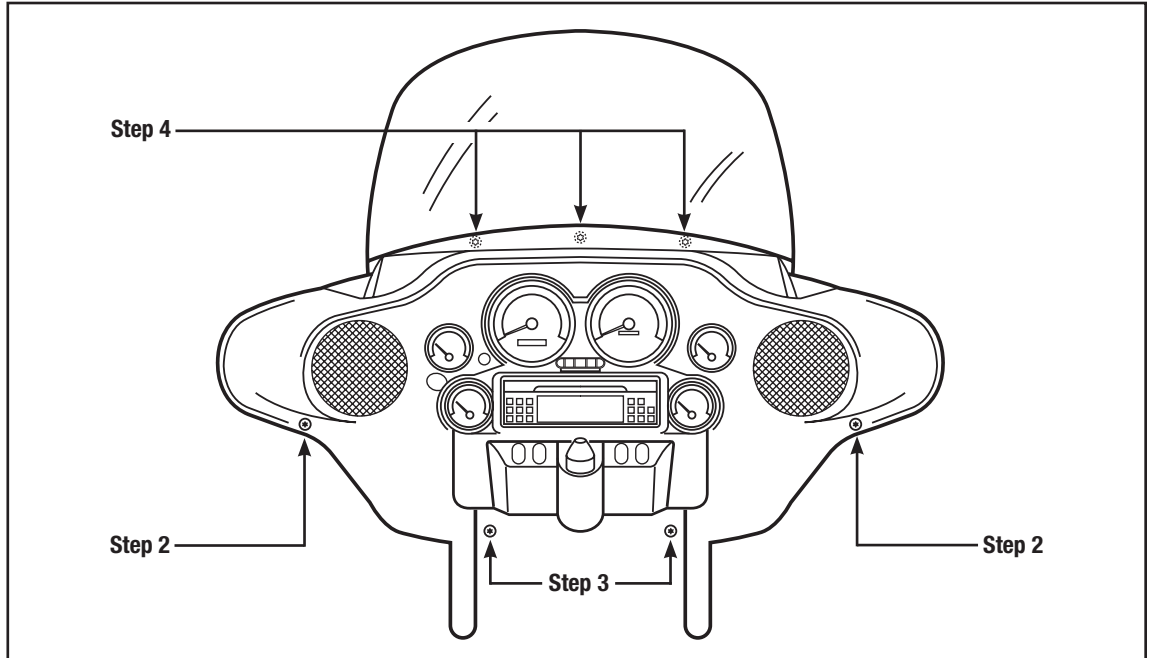

(Figure A)

Fairing Disassembly

FLH/Batwing models: (cont.)

6. Lift away and unplug headlight to remove outer fairing. (Figure B)
7. Unbolt and remove inner fairing support brackets from each side (3/16" Allen & T-25 Torx screws)

Note the Torx screw is also a shared speaker screw. (Figure C)

8. Remove the remaining speaker screws and the speaker.

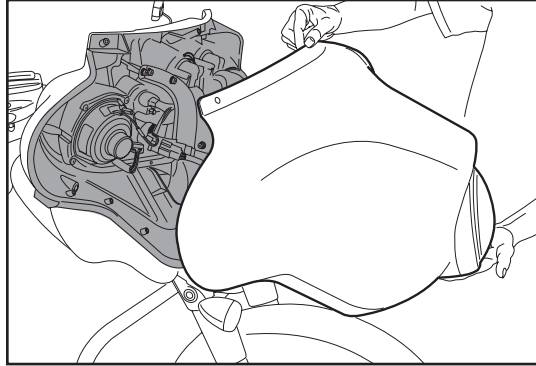

(Figure B)

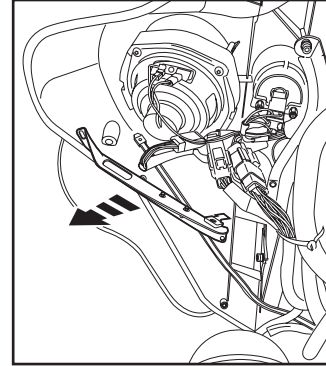

(Figure C)

Fairing Disassembly

Roadglide/Sharknose models

1. Loosen (6) T-25 Torx bolts from bottom, middle and top of left and right sides of the inner fairing. (Figure A)

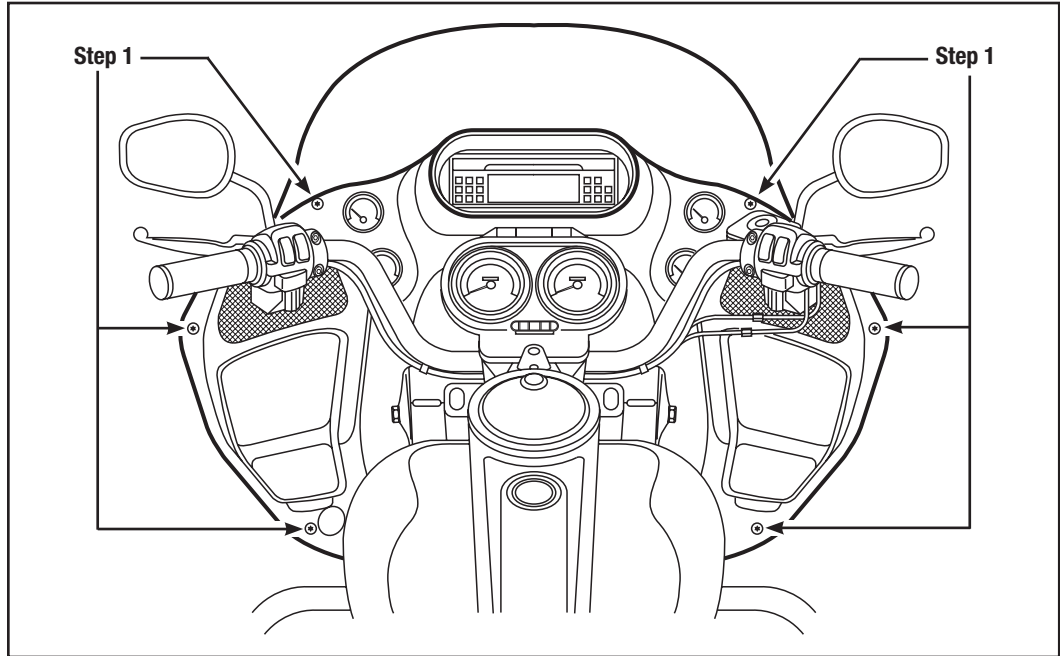

(Figure A)

Fairing Disassembly

Roadglide/Sharknose models: (cont.)

2. Use a 1/2" socket or box wrench to remove the (2) acorn nuts that hold each turn signal at the lower fairing. Let the signals hang loose. (Figure B)
3. Lift away the fairing, unplug the headlights and remove.
4. Remove the speaker screws and the speaker.

Continue to kit assembly

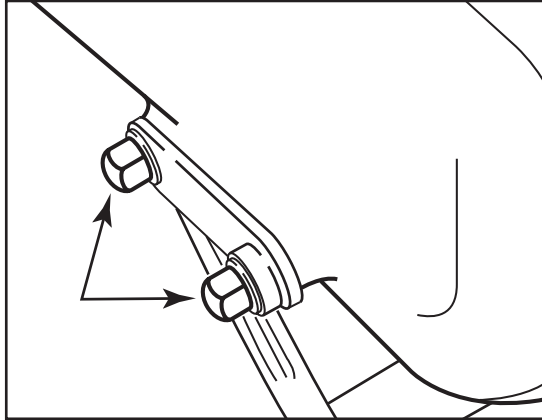

(Figure B)

Kit Assembly

1. Using 3 of the screws in the provided hardware, mount the speaker adapter to the inner fairing. The 4th inner bottom screw locations are not used on FLH/batwing models. For Road Glide models, rotate the adapter until the notches in the adapter do not hit the factory mounting posts and the flat spots on the outside of the adapter are toward the outer edge of the fairing. (Figure A)
2. Mount the new speaker with the hardware provided with the speakers. (Figure B)

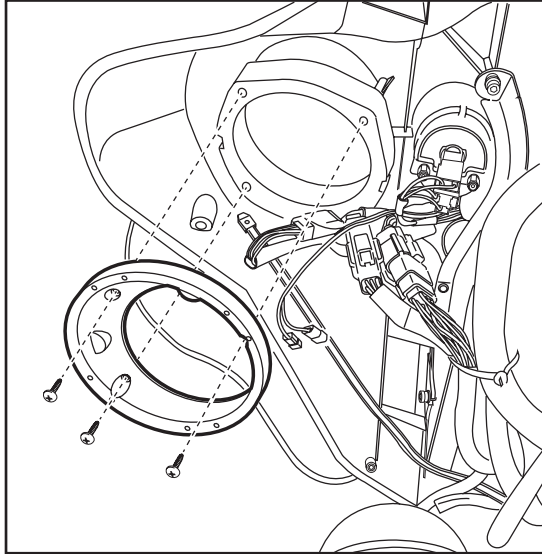

(Figure A)

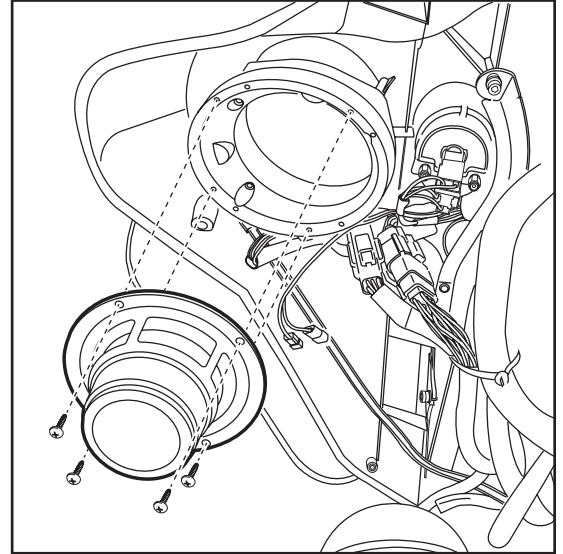

(Figure B)