

Light-Duty Transmission Adapters

Maximum Capacity: 454 kg (1000 lbs.)

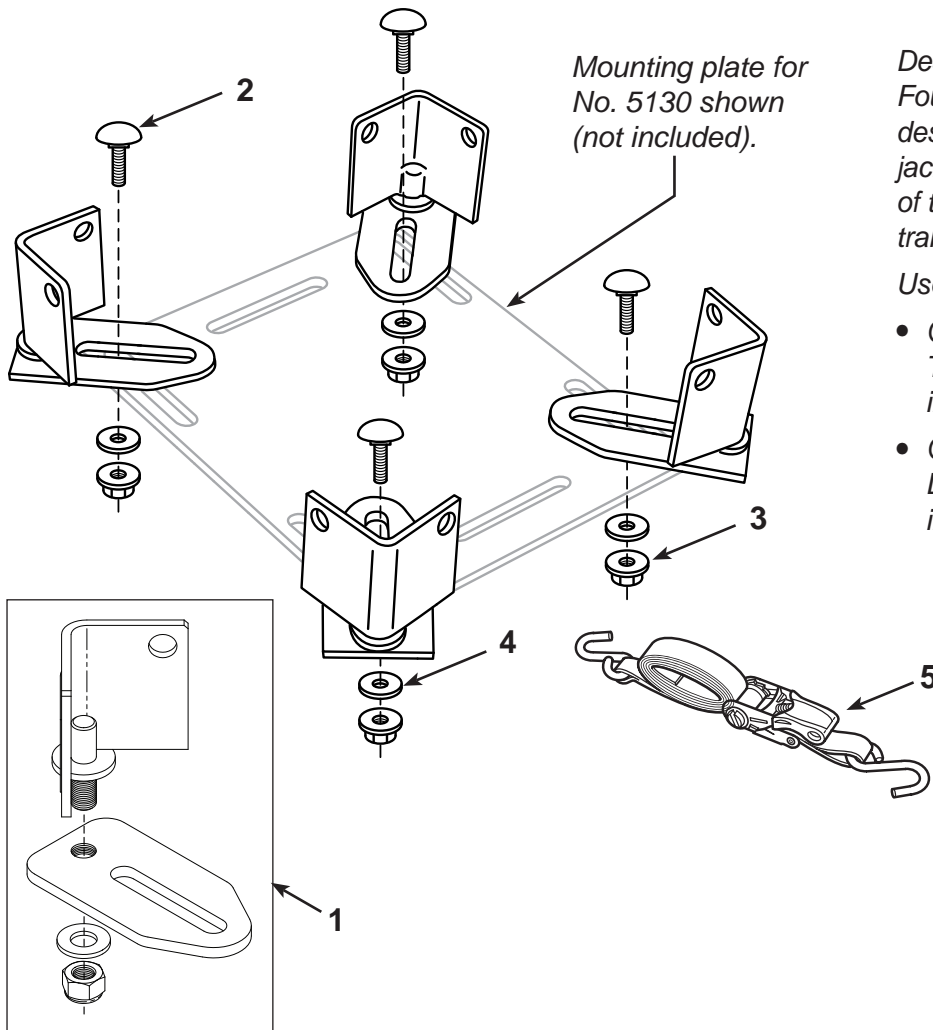

Description:

Four universal mounting adapters designed to be used on a transmission jack mounting plate for the purpose of transporting and repairing vehicle transmissions.

Use with:

- OTC No. 5019A, 5078, or 1522A Transmission Jack for removal and installation of differential assemblies.
- OTC No. 5130 DriveMaster™ Driveline Lift for removal and installation of driveline components.

Parts List

Item No.	Part No.	No. Req'd	Description
1	561947	1	Transmission Adapter Assembly (consists of adapter, flat washer, hex nut)

Repair Kit No. 569966

Item No.	Qty.	Description
2	4	Carriage Bolt — 1/2-13 x 30.48 mm (1.25 in.)
3	4	Flange Nut — 1/2-13 thread
4	4	Washer — plain, type "A"
5	1	Ratchet Strap — 4 ft. (122 cm)

Parts List & Operating Instructions

Explanation of Safety Signal Words

The safety signal word designates the degree or level of hazard seriousness.



DANGER: Indicates an imminently hazardous situation which, if not avoided, will result in death or serious injury.



WARNING: Indicates a potentially hazardous situation which, if not avoided, could result in death or serious injury.



CAUTION: Indicates a potentially hazardous situation which, if not avoided, may result in minor or moderate injury.

CAUTION: Used without the safety alert symbol indicates a potentially hazardous situation which, if not avoided, may result in property damage.

Safety Precautions



CAUTION: To prevent personal injury and/ or property damage,



- Study, understand, and follow all safety precautions and operating instructions before using these transmission adapters. If the operator cannot read instructions, operating instructions and safety precautions must be read and discussed in the operator's native language.



- Only qualified operators may install, operate, adjust, maintain, clean, repair, inspect, or transport these transmission adapters.
- Wear eye protection that meets ANSI Z87.1 and OSHA standards.
- Do not exceed the rated capacity of these transmission adapters as stated in this document and on the warning decal.



- These adapters are designed to work together in a group of four. Using fewer than four adapters in a setup could result in personal injury caused by the load tipping or falling.
- Do not use these transmission adapters for anything other than their intended purpose.
- Use the ratchet strap included to secure the load to the transmission jack.
- No alteration shall be made to this product.
- Inspect the condition of the transmission adapters before each use; do not use if damaged, altered, or in poor condition.
- Use only those repair parts called out in the parts list in this document. Items found in the parts list have been carefully tested and selected by OTC.

Operating Instructions

1. Install the transmission adapters on the transmission jack mounting plate using the carriage bolts, washers, and flange nuts provided. Hand tighten the flange nuts. See Figure 1.
2. Raise the arm of the jack up to the transmission.
3. Adjust the transmission adapters as needed to fit the transmission. Tighten the flange nuts.
4. Use ratchet strap to secure the transmission to the transmission jack as shown in Figure 2. Attach the hooks on the end of the ratchet strap to the slots provided in the mounting plate, the top holes in the transmission adapters, or other suitable locations.

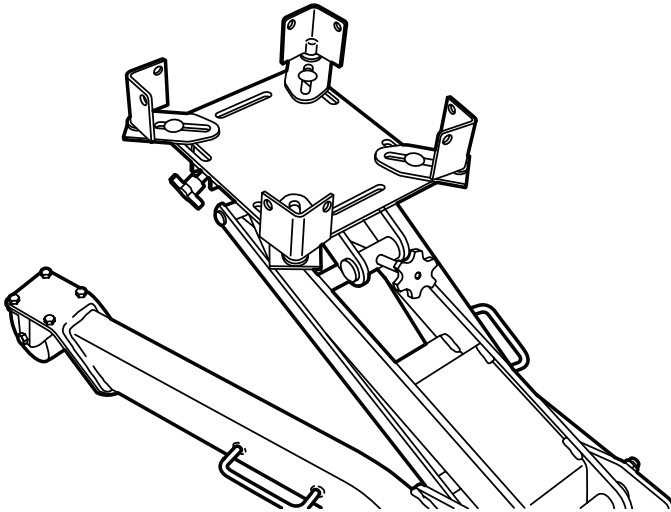

Figure 1

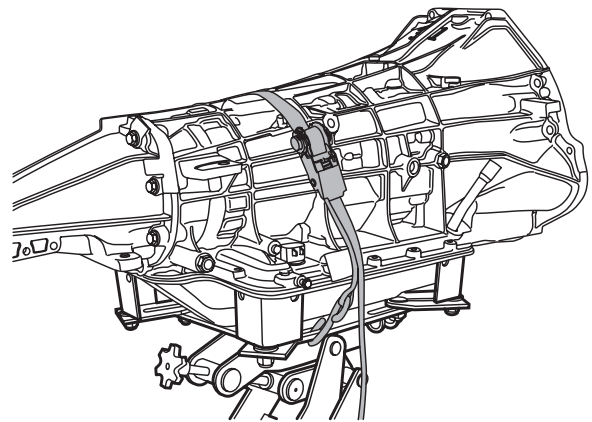

Figure 2

Inspection and Maintenance



CAUTION: To prevent personal injury,

- Only qualified personnel shall perform inspections and repairs to these transmission adapters.
- Before each use, an approved inspector must inspect the transmission adapters for bends, cracks, dents, elongated holes, or missing hardware. If damage is found, discontinue use.
- Use only those repair parts called out in the parts list in this document. Items found in the parts list have been carefully tested and selected by OTC.

Auxiliary Box Adapter

Maximum Capacity: 227 kg (500 lbs.)

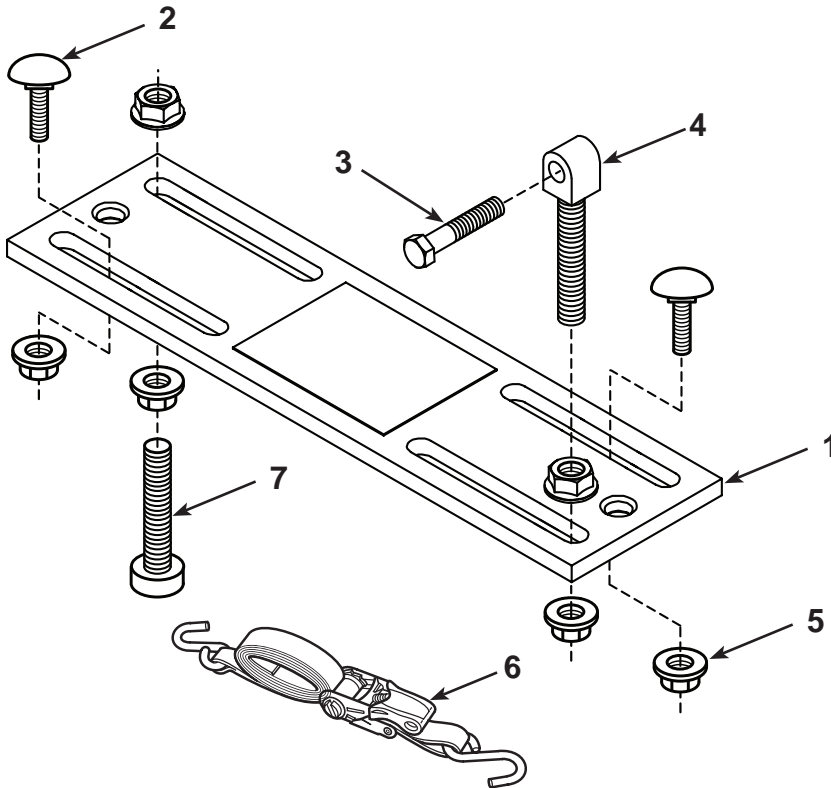

Description:

Mounting adapter designed to be used on a transmission jack mounting plate for the purpose of removing and installing the transmission housing auxiliary box.

Use with:

- OTC No. 5019A, 5078, or 1522A Transmission Jack for removal and installation of differential assemblies.
- OTC No. 5130 DriveMaster™ Driveline Lift for removal and installation of driveline components.

Parts List

Item No.	Part No.	No. Req'd	Description
1	569968	1	Plate Assembly (consists of plate & decal)

Repair Kit No. 569967

Item No.	Qty.	Description
2	2	Carriage Bolt — 1/2-13 x 30.48 mm (1.25 in.)
3	1	Hex Head Screw — 3/8-16 x 50.8 mm (2 in.)
4	1	Stud — .500-13 x 101.6 mm (4 in.)
5	6	Flange Nut — 1/2-13 thread
6	1	Ratchet Strap — 122 cm (4 ft.)
7	1	Support Screw — 95.25 mm (3.75 in.)

Parts List & Operating Instructions

Explanation of Safety Signal Words

The safety signal word designates the degree or level of hazard seriousness.



DANGER: Indicates an imminently hazardous situation which, if not avoided, will result in death or serious injury.



WARNING: Indicates a potentially hazardous situation which, if not avoided, could result in death or serious injury.



CAUTION: Indicates a potentially hazardous situation which, if not avoided, may result in minor or moderate injury.

CAUTION: Used without the safety alert symbol indicates a potentially hazardous situation which, if not avoided, may result in property damage.

Safety Precautions



CAUTION: To prevent personal injury and/ or property damage,



- Study, understand, and follow all safety precautions and operating instructions before using the auxiliary box adapter. If the operator cannot read instructions, operating instructions and safety precautions must be read and discussed in the operator's native language.

- Only qualified operators may install, operate, adjust, maintain, clean, repair, inspect, or transport this auxiliary box adapter.



- Wear eye protection that meets ANSI Z87.1 and OSHA standards.
- Do not exceed the rated capacity of this auxiliary box adapter as stated in this document and on the warning decal.



- Do not use this auxiliary box adapter for anything other than their intended purpose.
- Use the ratchet strap included to secure the load to the transmission jack.
- No alteration shall be made to this product.
- Inspect the condition of the auxiliary box adapter before each use; do not use if damaged, altered, or in poor condition.
- Use only those repair parts called out in the parts list in this document. Items found in the parts list have been carefully tested and selected by OTC.

Operating Instructions

1. Install the auxiliary box adapter on the transmission jack mounting plate using the carriage bolts and flange nuts provided. Tighten the flange nuts. See Figure 1.
2. Plan the placement of the support screw and stud to fit your application. Figure 1 shows the support screw and the stud assembled to the adapter plate in one of several possible arrangements.
3. Assemble both the support screw and the stud to the plate with one flange nut above the plate and one flange nut below the plate. The flat side of each flange nut must rest against the plate.
4. Thread the lower flange nut on the stud all the way to the bottom of the threads. This allows room for adjustment.
5. Remove a bolt from the front of the transmission auxiliary box.
6. Move the jack under the transmission, aligning the stud with the hole where the bolt was removed in the auxiliary box. Insert the bolt through the stud and into the auxiliary box. See Figure 2.

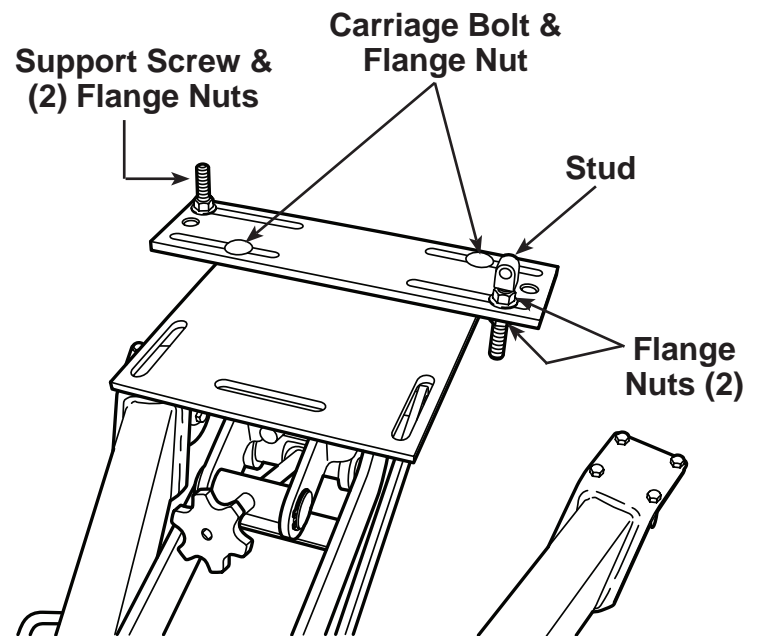

Figure 1

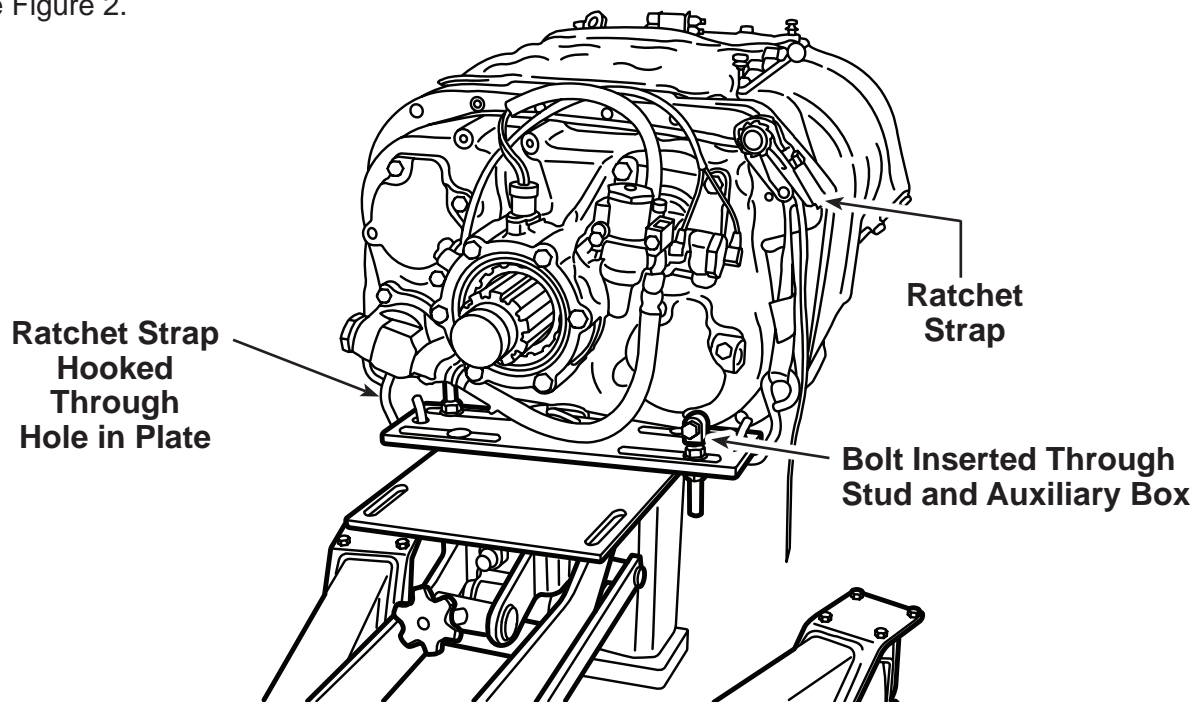
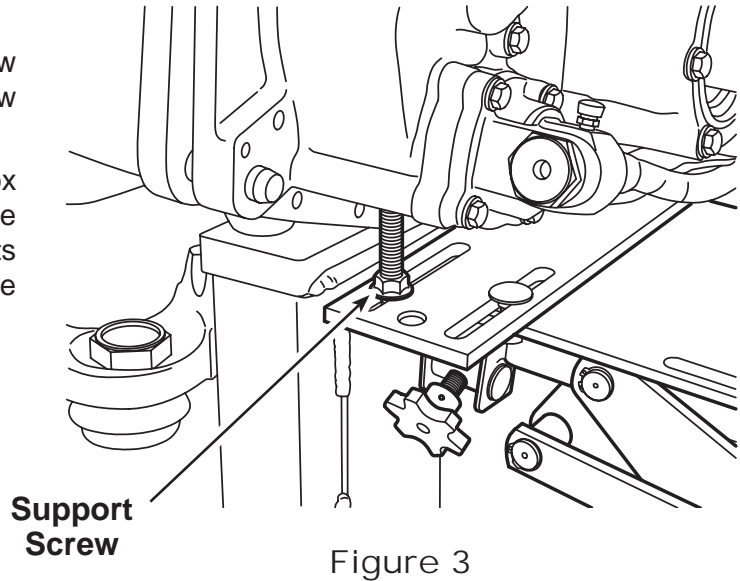

Figure 2

Operating Instructions contd.

7. Thread the upper flange nut on the support screw to the bottom of the threads until the support screw touches the housing. See Figure 3.
8. Install the ratchet strap to secure the auxiliary box to the transmission jack. See Figure 2. Attach the hooks on the end of the ratchet strap to the slots provided in the mounting plate or other suitable locations.

**Inspection and Maintenance**

CAUTION: To prevent personal injury,

- Only qualified personnel shall perform inspections and repairs to this auxiliary box adapter.
- Before each use, an approved inspector must inspect the auxiliary box adapter for bends, cracks, dents, elongated holes, or missing hardware. If damage is found, discontinue use.
- Use only those repair parts called out in the parts list in this document. Items found in the parts list have been carefully tested and selected by OTC.

Parts List &
Operating Instructions
for:
1522A

Low Lift Transmission Jack

Max. Capacity: 2,000 lbs.

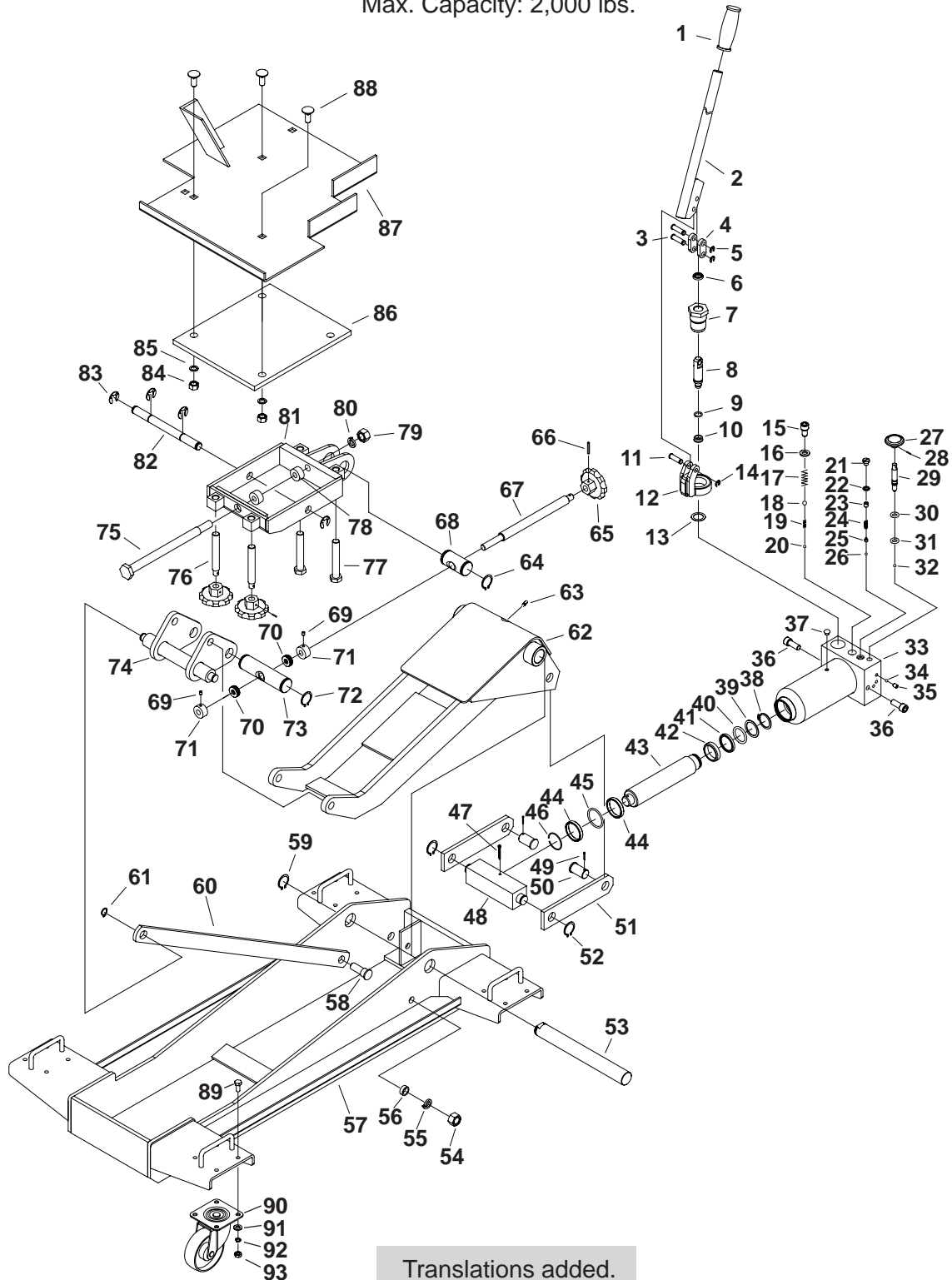

Translations added.

Parts List

Item No.	Qty.	Description	Item No.	Qty.	Description
1	1	Handle Sleeve	48	1	Connecting Block
2	1	Handle	49	2	Pin
3	2	Pin	50	2	Shaft
4	2	Rod Joint	51	2	Rod Link
5	2	Snap Ring	52	2	Snap Ring
6	1	Dustproof	53	1	Shaft
7	1	Pump Cylinder	54	2	Nut
8	1	Pump Plunger	55	2	Lock Washer
9	1	O-ring	56	2	Washer
10	1	Y-seal	57	1	Frame
11	1	Pin	58	2	Shaft
12	1	Pump Seat	59	1	Snap Ring
13	1	Copper Washer	60	2	Connecting Bar
14	1	Snap Ring	61	2	Snap Ring
15	1	Bolt	62	1	Arm
16	1	Copper Washer	63	1	Oil Nipple
17	1	Spring	64	4	Snap Ring
18	1	Steel Ball	65	3	Knob
19	1	Spring	66	3	Pin
20	1	Steel Ball	67	1	Screw
21	1	Bolt	68	1	Shaft
22	1	Sealing Washer	69	2	Screw
23	1	Screw	70	2	Bearing
24	1	Spring	71	2	Bushing
25	1	Ball Seat	72	4	Snap Ring
26	1	Steel Ball	73	1	Shaft
27	1	Release Knob	74	1	Bracket
28	1	Pin	75	1	Bolt
29	1	Oil Release Valve Rod	76	2	Screw
30	1	O-ring	77	2	Bolt
31	1	O-ring	78	2	Bushing
32	1	Steel Ball	79	1	Nut
33	1	Oil Cylinder Assembly	80	1	Lock Washer
34	3	Steel Ball	81	1	Bracket
35	3	Screw	82	1	Shaft
36	2	Bolt	83	4	Snap Ring
37	1	Oil Filler Plug	84	3	Nut
38	1	Snap Ring	85	3	Washer
39	1	O-ring Retainer	86	1	Fixing Board
40	1	O-ring	87	1	Saddle
41	1	Sealing Washer	88	3	Bolt
42	1	Piston Ring	89	16	Bolt
43	1	Piston Rod	90	4	Swivel Caster
44	2	Bushing	91	16	Flat Washer
45	1	O-ring	92	16	Lock Washer
46	1	Snap Ring	93	16	Nut
47	1	Pin			

Replacement Parts Kits

Item
No. Qty. Description

Caster Kit No. 529028

89 4 Bolt
90 1 Swivel Caster
91 4 Flat Washer
92 4 Lock Washer
93 4 Nut

Handle Kit No. 529029

1 1 Handle Sleeve
2 1 Handle
3 2 Pin
4 2 Rod Joint
5 2 Snap Ring

Hardware Kit No. 529034

47 1 Pin
49 2 Pin
52 2 Snap Ring
54 2 Nut
55 2 Lock Washer
56 2 Washer
58 2 Shaft
59 1 Snap Ring
61 2 Snap Ring
63 1 Oil Nipple
64 4 Snap Ring
66 3 Pin
69 2 Screw
70 2 Bearing
71 2 Bushing
72 4 Snap Ring
75 1 Bolt
79 1 Nut
80 1 Lock Washer
83 4 Snap Ring
84 3 Nut
85 3 Washer
88 3 Bolt
89 16 Bolt
91 16 Flat Washer
92 16 Lock Washer
93 16 Nut

Hydraulic Unit Kit No. 529031

Item
No. Qty. Description

6 1 Dustproof
7 1 Pump Cylinder
8 1 Pump Plunger
9 1 O-ring
10 1 Y-seal
11 1 Pin
12 1 Pump Seat
13 1 Copper Washer
14 1 Snap Ring
15 1 Bolt
16 1 Copper Washer
17 1 Spring
18 1 Steel Ball
19 1 Spring
20 1 Steel Ball
21 1 Bolt
22 1 Sealing Washer
23 1 Screw
24 1 Spring
25 1 Ball Seat
26 1 Steel Ball
27 1 Release Knob
28 1 Pin
29 1 Oil Release Valve Rod
30 1 O-ring
31 1 O-ring
32 1 Steel Ball
33 1 Oil Cylinder Assembly
34 3 Steel Ball
35 3 Screw
36 2 Bolt
37 1 Oil Filler Plug
38 1 Snap Ring
39 1 O-ring Retainer
40 1 O-ring
41 1 Sealing Washer
42 1 Piston Ring
43 1 Piston Rod
44 2 Bushing
45 1 O-ring
46 1 Snap Ring

Miscellaneous Parts Kit

Item
No. Qty. Description

No. 529033

47 1 Pin
48 1 Connecting Block
49 2 Pin
50 2 Shaft
51 2 Rod Link
52 2 Snap Ring
53 1 Shaft
54 2 Nut
55 2 Lock Washer
56 2 Washer
58 2 Shaft
59 1 Snap Ring
60 2 Connecting Bar
61 2 Snap Ring

Saddle Kit No. 529030











74 1 Bracket
81 1 Bracket
84 3 Nut
85 3 Washer
86 1 Fixing Board
87 1 Saddle
88 3 Bolt

Tilt Screws Kit No. 529032

64 4 Snap Ring
65 3 Knob
66 3 Pin
67 1 Screw
68 1 Shaft
69 2 Screw
70 2 Bearing
71 2 Bushing
72 4 Snap Ring
73 1 Shaft
75 1 Bolt
76 2 Screw
77 2 Bolt
78 2 Bushing
79 1 Nut
80 1 Lock Washer
82 1 Shaft
83 4 Snap Ring

Parts List & Operating Instructions

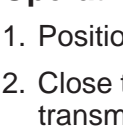
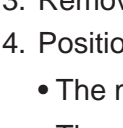
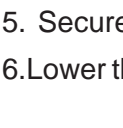
Safety Precautions

-  To avoid possible personal injury, damage to equipment, or property:
-  Study, understand, and follow all instructions, including the ANSI B30.1 safety code for jacks.
 -  Wear eye protection that meets ANSI Z87.1 and OSHA standards.
 -  Inspect the jack before each use; do not use the jack if it is damaged, altered, or in poor condition.
 -  No alterations shall be made to this product.
 -  Only attachments and/or adapters supplied by the manufacturer shall be used.
 -  Use the jack only on hard, level surfaces.
 -  Adequately support the vehicle before starting repairs.
 -  Use of this product is limited to the removal, installation, and transportation in the lowered position of transmissions, transfer cases, and transaxles.
 -  The load must never exceed the rated jack capacity.
 -  Stay out from underneath the load at all times.
 -  Secure the load to the jack.
 -  Lower the load completely before moving the jack.
 - SLOWLY AND CAREFULLY move the jack around corners, because the load could tip.
 - Use only approved hydraulic fluid (Chevron AW Hydraulic Oil MV or equivalent). The use of alcohol or hydraulic brake fluid could damage seals and result in jack failure.

Operating Instructions

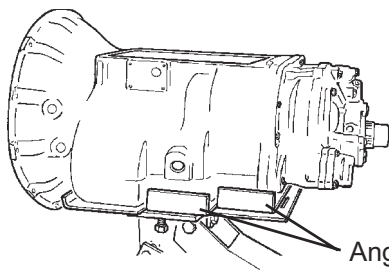

Angle Plates

Figure 1
The transmission must rest against the angle plates as shown.

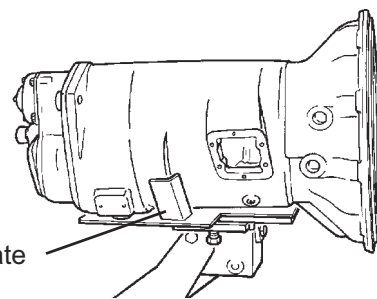

Angle Plate

Operating Instructions

1. Position the jack under the transmission.
2. Close the control valve. Operate the pump handle to raise the boom and align the mounting plate with the transmission. See Figure 1.
3. Remove the transmission according to the instructions in the vehicle service manual.
4. Position the transmission on the mounting plate, resting against the angle plates as shown in Figure 1.
 - The mounting plate may be tilted forward and backward by turning the tilt knob.
 - The mounting plate may be tilted side-to-side by adjusting the two vertical hex hd. cap screws.
5. Secure the transmission to the mounting plate.
6. Lower the load by slowly opening the control valve. The control valve regulates how fast the boom is lowered.

Preventive Maintenance

IMPORTANT: Dirt is the greatest single cause of failure in hydraulic units. Keep the jack clean and well lubricated to prevent foreign matter from entering the system. If the jack has been exposed to rain, snow, sand, or grit, it must be cleaned before it is used.

1. Store the jack in a well-protected area where it will not be exposed to corrosive vapors, abrasive dust, or any other harmful elements.
2. Regularly lubricate the moving parts.
3. To check the oil level, place the jack on level ground and lower the lift arm completely. Remove the filler plug. The oil level should be within 3/8" of the filler plug hole. Do not overfill. If necessary, add approved anti-wear hydraulic jack oil, and install the filler plug again. **IMPORTANT: The use of alcohol, hydraulic brake fluid or detergent motor oil could damage the seals and result in jack failure.**
4. Inspect the jack before each use. Take corrective action if any of the following problems are found:
 - a. Cracked or damaged housing
 - b. Excessive wear, bending, or other damage
 - c. Leaking hydraulic fluid
 - d. Scored or damaged piston rod
 - e. Malfunctioning swivel heads or adjusting screws
 - f. Loose hardware
 - g. Modified or altered equipment

Troubleshooting Guide

Repair procedures must be performed in a dirt-free environment by qualified personnel who are familiar with this equipment.

Trouble	Cause	Solution
Jack does not lift	<ol style="list-style-type: none"> 1. Release valve is open. 2. Low/no oil in reservoir. 3. Air-locked system. 4. Load is above capacity of jack. 5. Delivery valve and/or bypass valve not working correctly. 6. Packing worn out or defective. 	<ol style="list-style-type: none"> 1. Close release valve. 2. Fill with oil and bleed system. 3. Bleed system. 4. Use correct equipment. 5. Clean to remove dirt or foreign matter. Replace oil. 6. Replace power unit.
Jack lifts only partially	<ol style="list-style-type: none"> 1. Too much or not enough oil. 	<ol style="list-style-type: none"> 1. Check oil level.
Jack advances slowly	<ol style="list-style-type: none"> 1. Pump not working correctly. 2. Leaking seals. 	<ol style="list-style-type: none"> 1. Replace power unit. 2. Replace power unit.
Jack lifts load, but doesn't hold	<ol style="list-style-type: none"> 1. Cylinder packing is leaking. 2. Valve not working correctly (suction, delivery, release, or bypass). 3. Air-locked system. 	<ol style="list-style-type: none"> 1. Replace power unit 2. Inspect valves. Clean and repair seat surfaces. 3. Bleed system.
Jack leaks oil	<ol style="list-style-type: none"> 1. Worn or damaged seals. 	<ol style="list-style-type: none"> 1. Replace power unit.
Jack will not retract	<ol style="list-style-type: none"> 1. Release valve is closed. 	<ol style="list-style-type: none"> 1. Open or clean release valve.
Jack retracts slowly	<ol style="list-style-type: none"> 1. Cylinder damaged internally. 2. Link section is binding. 	<ol style="list-style-type: none"> 1. Send jack to OTC authorized service center for repair. 2. Lubricate link section.