

**Parts List &
Assembly Instructions**
for:

5095A
5096A

Easy Lever™ Tire and Wheel Caddie

The Easy Lever tire and wheel caddie makes moving tires and wheels an easy task. Use the following steps to assemble the Easy Lever:

1. Secure the handle over the U-frame, as shown, using two hex head bolts, two spring washers, two flat washers, and two nuts.
2. Fasten the kickstand under the frame tabs using a hex head bolt, a spring washer, and a flat washer.

NOTE: Fully tighten all nuts at this time. To prevent damage to the kickstand, do not overtighten its bolt.

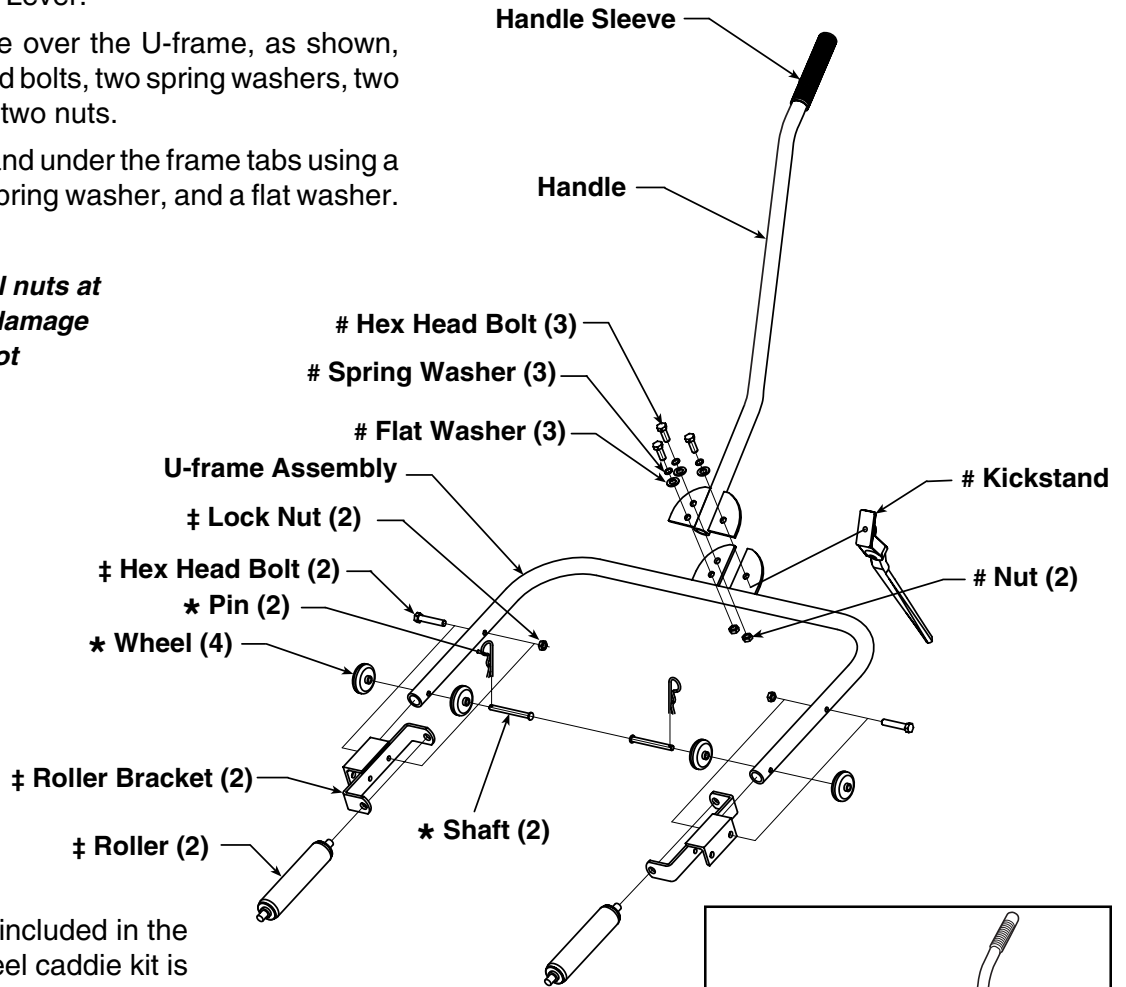

The number of parts included in the Easy Lift tire and wheel caddie kit is identified in parenthesis on the illustration. Parts not identified with a number are single units.

Replacement Parts:

Kit No.	Items Included in Kit	Description
533873	*	Wheel/Axle Kit
533874	‡	Roller Kit
533875	#	Kick Stand/Hardware Kit

Wear eye protection that meets ANSI Z87.1 and OSHA standards.

