

# Installation Manual SWITCH-PAC SHIFTER MOUNTED ON/OFF SWITCH



L6407



## C18040 & C18041 Installation Procedure

- 1 Remove the center cap screw using a 3/16" Allen key.
- 2 Place one half of the switch bracket on each side of the transmission shifter.
- 3 Loosely install the center cap screw.
- 4 Orientate the switch in the bracket for desired position (on/off) and adjust the height of the bracket for the driver's convenience.
- 5 Torque the cap screw to 50 in-lbs.

Consult the diagrams below for the correct wiring connections.

## MANUAL TRANSMISSION ONLY

C18040  
C18041

EXHAUST BRAKE CONNECTIONS WITH STANDARD SWITCH

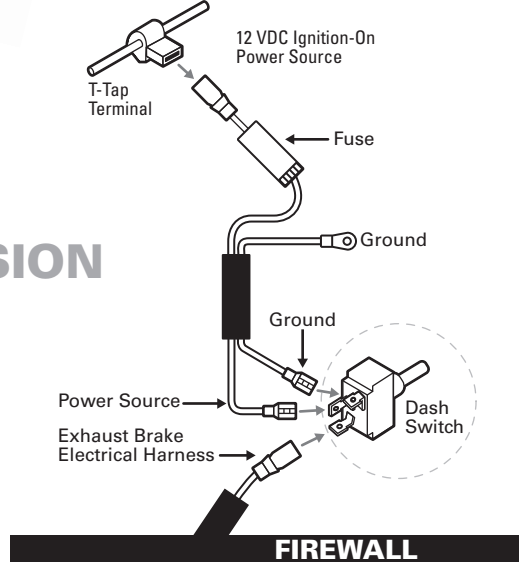

EXHAUST BRAKE CONNECTIONS WITH OPTIONAL SWITCH-PAC

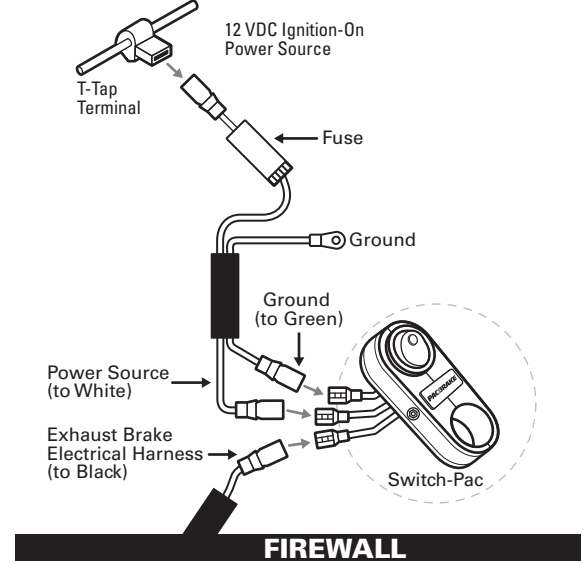

## MANUAL TRANSMISSION ONLY

C18042

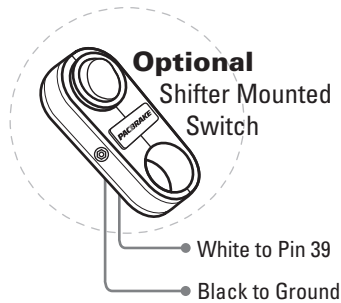

## UNIVERSAL ACCESSORY

