

# BEARING KIT

171720



<b>Description:</b>	BEARING KIT
<b>SKU:</b>	171720
<b>OEM:</b>	3801260
<b>Product Group:</b>	ENGINE PARTS
<b>Product Class:</b>	ENGINE BEARINGS (ALL)
<b>UPC Code:</b>	193807104467
<b>Sell Pack:</b>	1 EA
<b>Weight:</b>	7.40 LBS
<b>Package Dimensions (LxWxH):</b>	14 x 5 x 3 inches
<b>Warranty:</b>	2 Years

**Details:**

Standard size Main Bearing kit  
Cummins 743, 855, N14 Applications

**Substitutes:**

SKU	Sell Pack	Weight	Warranty	Description
<a href="#">171004</a>	1	7.30 LBS	2 Years	BEARING KIT
<a href="#">171720HP</a>	1	7.44 LBS	3 Years	HIGH PERFORMANCE MAIN BEARING KIT

**E-Catalog Pages:**

Catalog Page	Description

Copyright © 2020 PAI Industries, Inc.  
All rights reserved. All content is property of PAI Industries, Inc, and may not be reproduced or redistributed in any form.

Any reference to OEM names or OEM product identification numbers/descriptions/model numbers is for identification only and does not indicate that it is an OEM part. PAI is not affiliated with Mack Truck, Inc.®, Volvo®, Fuller®, Cummins®, Eaton®, Rockwell®, Caterpillar®, Freightliner®, Hendrickson®, Kenworth®, Detroit Diesel®, International®, Peterbilt®, or Dana®. All Manufacturer's names, numbers, symbols and descriptions are used for reference only. It is not implied that any part listed is the product of these manufacturers.

# BEARING KIT

171720

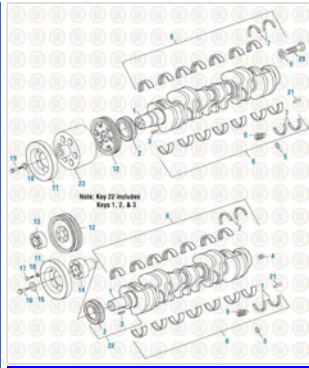

**Cummins Engine 2017**  
Crankshafts - 855 Series



**Cummins Engine 2017**  
Inframe Kit Breakdowns - N14 Series

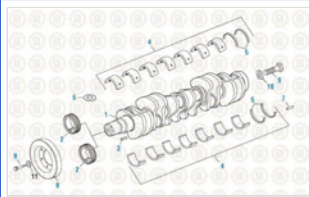

**Cummins Engine 2017**  
Crankshaft and Components - N14 Series



**Cummins Engine 2017**  
Pistonless Overhaul Kit Breakdown - N14 Series





**Cummins Engine 2017**  
743 Series - Miscellaneous Engines

Copyright © 2020 PAI Industries, Inc.  
All rights reserved. All content is property of PAI Industries, Inc, and may not be reproduced or redistributed in any form.

Any reference to OEM names or OEM product identification numbers/descriptions/model numbers is for identification only and does not indicate that it is an OEM part. PAI is not affiliated with Mack Truck, Inc.®, Volvo®, Fuller®, Cummins®, Eaton®, Rockwell®, Caterpillar®, Freightliner®, Hendrickson®, Kenworth®, Detroit Diesel®, International®, Peterbilt®, or Dana®. All Manufacturer's names, numbers, symbols and descriptions are used for reference only. It is not implied that any part listed is the product of these manufacturers.

# BEARING KIT

171720

Consists Of:				
SKU	OEM	Image	Description	Quantity
<a href="#">171000</a>	3801260-100	.	BEARING KIT	1
<a href="#">171695</a>	3009213		LOCKPLATE	14
<a href="#">171700</a>	3019218		THRUST BEARING	4

Component Of:		
SKU	Image	Description
<a href="#">855000-001</a>	.	ENGINE KIT
<a href="#">855000-017</a>	.	ENGINE KIT
<a href="#">855000-065</a>	.	ENGINE KIT
<a href="#">855001-001</a>	.	ENGINE KIT
<a href="#">855001-017</a>	.	ENGINE KIT
<a href="#">855001-033</a>	.	ENGINE KIT
<a href="#">855001-065</a>	.	ENGINE KIT
<a href="#">855002-001</a>	.	ENGINE KIT
<a href="#">855006-001</a>	.	ENGINE KIT
<a href="#">855006-017</a>	.	ENGINE KIT
<a href="#">855007-001</a>	.	ENGINE KIT
<a href="#">855007-017</a>	.	ENGINE KIT
<a href="#">855008-001</a>	.	ENGINE KIT
<a href="#">855008-005</a>	.	ENGINE KIT
<a href="#">855008-017</a>	.	ENGINE KIT
<a href="#">855008-033</a>	.	ENGINE KIT
<a href="#">855008-065</a>	.	ENGINE KIT
<a href="#">855008-081</a>	.	ENGINE KIT
<a href="#">855009-017</a>	.	ENGINE KIT
<a href="#">855009-081</a>	.	DUAL-NI PISTON ENGINE KIT
<a href="#">855010-017</a>	.	ENGINE KIT

Copyright © 2020 PAI Industries, Inc.  
 All rights reserved. All content is property of PAI Industries, Inc. and may not be reproduced or redistributed in any form.

Any reference to OEM names or OEM product identification numbers/descriptions/model numbers is for identification only and does not indicate that it is an OEM part. PAI is not affiliated with Mack Truck, Inc.®, Volvo®, Fuller®, Cummins®, Eaton®, Rockwell®, Caterpillar®, Freightliner®, Hendrickson®, Kenworth®, Detroit Diesel®, International®, Peterbilt®, or Dana®. All Manufacturer's names, numbers, symbols and descriptions are used for reference only. It is not implied that any part listed is the product of these manufacturers.

## BEARING KIT

171720

<a href="#">855011-017</a>	.	ENGINE KIT
<a href="#">855012-021</a>	.	ENGINE KIT
<a href="#">855013-001</a>	.	ENGINE KIT
<a href="#">855013-017</a>	.	PREMIUM KIT
<a href="#">855013-033</a>	.	ENGINE KIT
<a href="#">855013-065</a>	.	ENGINE KIT
<a href="#">855013-081</a>	.	ENGINE KIT
<a href="#">855014-001</a>	.	ENGINE KIT
<a href="#">855014-065</a>	.	ENGINE KIT
<a href="#">855015-001</a>	.	ENGINE KIT
<a href="#">855015-005</a>	.	ENGINE KIT
<a href="#">855015-017</a>	.	ENGINE KIT
<a href="#">855015-033</a>	.	ENGINE KIT
<a href="#">855015-065</a>	.	ENGINE KIT
<a href="#">855015-081</a>	.	ENGINE KIT
<a href="#">855016-001</a>	.	ENGINE KIT
<a href="#">855016-033</a>	.	ENGINE KIT
<a href="#">855017-001</a>	.	ENGINE KIT
<a href="#">855017-017</a>	.	ENGINE KIT
<a href="#">855017-065</a>	.	ENGINE KIT
<a href="#">855019-017</a>	.	ENGINE KIT
<a href="#">855020-001</a>	.	ENGINE KIT
<a href="#">855020-017</a>	.	ENGINE KIT
<a href="#">855020-033</a>	.	ENGINE KIT
<a href="#">855020-065</a>	.	ENGINE KIT
<a href="#">855021-001</a>	.	ENGINE KIT
<a href="#">855021-033</a>	.	ENGINE KIT
<a href="#">855021-065</a>	.	ENGINE KIT
<a href="#">855022-001</a>	.	ENGINE KIT
<a href="#">855022-017</a>	.	ENGINE KIT
<a href="#">855022-065</a>	.	ENGINE KIT
<a href="#">855022-081</a>	.	ENGINE KIT
<a href="#">855024-001</a>	.	ENGINE KIT
<a href="#">855024-017</a>	.	ENGINE KIT
<a href="#">855024-065</a>	.	ENGINE KIT
<a href="#">855026-001</a>	.	ENGINE KIT
<a href="#">855026-017</a>	.	ENGINE KIT
<a href="#">855026-033</a>	.	ENGINE KIT
<a href="#">855026-065</a>	.	ENGINE KIT
<a href="#">855026-069</a>	.	ENGINE KIT

Copyright © 2020 PAI Industries, Inc.

All rights reserved. All content is property of PAI Industries, Inc. and may not be reproduced or redistributed in any form.

Any reference to OEM names or OEM product identification numbers/descriptions/model numbers is for identification only and does not indicate that it is an OEM part. PAI is not affiliated with Mack Truck, Inc.®, Volvo®, Fuller®, Cummins®, Eaton®, Rockwell®, Caterpillar®, Freightliner®, Hendrickson®, Kenworth®, Detroit Diesel®, International®, Peterbilt®, or Dana®. All Manufacturer's names, numbers, symbols and descriptions are used for reference only. It is not implied that any part listed is the product of these manufacturers.

## BEARING KIT

171720

<a href="#">855026-081</a>	.	ENGINE KIT
<a href="#">855027-001</a>	.	ENGINE KIT
<a href="#">855027-017</a>	.	ENGINE KIT
<a href="#">855027-049</a>	.	ENGINE KIT
<a href="#">855027-065</a>	.	ENGINE KIT
<a href="#">855027-081</a>	.	ENGINE KIT
<a href="#">855027-085</a>	.	ENGINE KIT
<a href="#">855028-001</a>	.	ENGINE KIT
<a href="#">855028-065</a>	.	ENGINE KIT
<a href="#">855029-001</a>	.	ENGINE KIT
<a href="#">855029-017</a>	.	ENGINE KIT
<a href="#">855029-021</a>	.	ENGINE KIT
<a href="#">855029-049</a>	.	ENGINE KIT
<a href="#">855029-065</a>	.	ENGINE KIT
<a href="#">855029-081</a>	.	ENGINE KIT
<a href="#">855029-085</a>	.	ENGINE KIT
<a href="#">855029-113</a>	.	ENGINE KIT
<a href="#">855029-145</a>	.	ENGINE KIT
<a href="#">855030-017</a>	.	ENGINE KIT
<a href="#">855030-049</a>	.	ENGINE KIT
<a href="#">855030-065</a>	.	ENGINE KIT
<a href="#">855030-081</a>	.	ENGINE KIT
<a href="#">855031-001</a>	.	ENGINE KIT
<a href="#">855031-017</a>	.	ENGINE KIT
<a href="#">855031-049</a>	.	ENGINE KIT
<a href="#">855031-065</a>	.	ENGINE KIT
<a href="#">855031-081</a>	.	ENGINE KIT
<a href="#">855032-001</a>	.	ENGINE KIT
<a href="#">855032-017</a>	.	ENGINE KIT
<a href="#">855032-081</a>	.	ENGINE KIT
<a href="#">855033-001</a>	.	ENGINE KIT
<a href="#">855033-017</a>	.	ENGINE KIT
<a href="#">855033-033</a>	.	ENGINE KIT
<a href="#">855033-065</a>	.	ENGINE KIT
<a href="#">855034-001</a>	.	ENGINE KIT
<a href="#">855034-017</a>	.	ENGINE KIT
<a href="#">855034-033</a>	.	ENGINE KIT
<a href="#">855034-065</a>	.	ENGINE KIT
<a href="#">855034-081</a>	.	ENGINE KIT

Copyright © 2020 PAI Industries, Inc.

All rights reserved. All content is property of PAI Industries, Inc. and may not be reproduced or redistributed in any form.

Any reference to OEM names or OEM product identification numbers/descriptions/model numbers is for identification only and does not indicate that it is an OEM part. PAI is not affiliated with Mack Truck, Inc.®, Volvo®, Fuller®, Cummins®, Eaton®, Rockwell®, Caterpillar®, Freightliner®, Hendrickson®, Kenworth®, Detroit Diesel®, International®, Peterbilt®, or Dana®. All Manufacturer's names, numbers, symbols and descriptions are used for reference only. It is not implied that any part listed is the product of these manufacturers.

## BEARING KIT

171720

<a href="#">855035-001</a>	.	ENGINE KIT
<a href="#">855035-017</a>	.	ENGINE KIT
<a href="#">855035-021</a>	.	ENGINE KIT
<a href="#">855035-033</a>	.	ENGINE KIT
<a href="#">855035-049</a>	.	ENGINE KIT
<a href="#">855035-061</a>	.	ENGINE KIT
<a href="#">855035-065</a>	.	ENGINE KIT
<a href="#">855035-081</a>	.	ENGINE KIT
<a href="#">855036-001</a>	.	ENGINE KIT
<a href="#">855036-017</a>	.	ENGINE KIT
<a href="#">855036-033</a>	.	ENGINE KIT
<a href="#">855036-049</a>	.	ENGINE KIT
<a href="#">855036-065</a>	.	ENGINE KIT
<a href="#">855036-081</a>	.	ENGINE KIT
<a href="#">855036-097</a>	.	ENGINE KIT
<a href="#">855036-113</a>	.	INFRAME ENGINE KIT
<a href="#">855037-001</a>	.	ENGINE KIT
<a href="#">855037-017</a>	.	ENGINE KIT
<a href="#">855037-065</a>	.	ENGINE KIT
<a href="#">855038-017</a>	.	ENGINE KIT
<a href="#">855039-017</a>	.	ENGINE KIT
<a href="#">855042-001</a>	.	ENGINE KIT
<a href="#">855042-005</a>	.	ENGINE KIT
<a href="#">855042-017</a>	.	ENGINE KIT
<a href="#">855042-033</a>	.	ENGINE KIT
<a href="#">855042-065</a>	.	ENGINE KIT
<a href="#">855042-073</a>	.	ENGINE KIT
<a href="#">855042-081</a>	.	ENGINE KIT
<a href="#">855044-001</a>	.	ENGINE KIT
<a href="#">855044-017</a>	.	ENGINE KIT
<a href="#">855044-033</a>	.	ENGINE KIT
<a href="#">855044-065</a>	.	ENGINE KIT
<a href="#">855044-081</a>	.	ENGINE KIT
<a href="#">855046-001</a>	.	ENGINE KIT
<a href="#">855046-017</a>	.	ENGINE KIT
<a href="#">855046-065</a>	.	ENGINE KIT
<a href="#">855047-001</a>	.	ENGINE KIT
<a href="#">855047-017</a>	.	ENGINE KIT
<a href="#">855047-065</a>	.	ENGINE KIT
<a href="#">855047-081</a>	.	ENGINE KIT

Copyright © 2020 PAI Industries, Inc.

All rights reserved. All content is property of PAI Industries, Inc. and may not be reproduced or redistributed in any form.

Any reference to OEM names or OEM product identification numbers/descriptions/model numbers is for identification only and does not indicate that it is an OEM part. PAI is not affiliated with Mack Truck, Inc.®, Volvo®, Fuller®, Cummins®, Eaton®, Rockwell®, Caterpillar®, Freightliner®, Hendrickson®, Kenworth®, Detroit Diesel®, International®, Peterbilt®, or Dana®. All Manufacturer's names, numbers, symbols and descriptions are used for reference only. It is not implied that any part listed is the product of these manufacturers.

## BEARING KIT

171720

<a href="#">855047G-017</a>	.	INFRAME ENGINE KIT
<a href="#">855047G-113</a>	.	INFRAME ENGINE KIT
<a href="#">855048-001</a>	.	ENGINE KIT
<a href="#">855048-017</a>	.	ENGINE KIT
<a href="#">855049-017</a>	.	ENGINE KIT
<a href="#">855049-081</a>	.	ENGINE KIT
<a href="#">855050-001</a>	.	ENGINE KIT
<a href="#">855050-017</a>	.	ENGINE KIT
<a href="#">855050-021</a>	.	ENGINE KIT
<a href="#">855050-049</a>	.	ENGINE KIT
<a href="#">855050-081</a>	.	ENGINE KIT
<a href="#">855051-001</a>	.	ENGINE KIT
<a href="#">855051-017</a>	.	ENGINE KIT
<a href="#">855051-081</a>	.	ENGINE KIT
<a href="#">855052-001</a>	.	ENGINE KIT
<a href="#">855052-017</a>	.	ENGINE KIT
<a href="#">855052-033</a>	.	ENGINE KIT
<a href="#">855052-049</a>	.	ENGINE KIT
<a href="#">855052-065</a>	.	ENGINE KIT
<a href="#">855052-081</a>	.	ENGINE KIT
<a href="#">855055-001</a>	.	ENGINE KIT
<a href="#">855055-017</a>	.	ENGINE KIT
<a href="#">855056-001</a>	.	ENGINE KIT
<a href="#">855056-017</a>	.	ENGINE KIT
<a href="#">855057-001</a>	.	ENGINE KIT
<a href="#">855057-017</a>	.	ENGINE KIT
<a href="#">855058-017</a>	.	ENGINE KIT
<a href="#">855059-001</a>	.	ENGINE KIT
<a href="#">855059-017</a>	.	ENGINE KIT
<a href="#">855062-001</a>	.	ENGINE KIT
<a href="#">855062-017</a>	.	ENGINE KIT
<a href="#">855067-017</a>	.	ENGINE KIT
<a href="#">855069-017</a>	.	ENGINE KIT
<a href="#">855069-021</a>	.	ENGINE KIT
<a href="#">855069-081</a>	.	ENGINE KIT
<a href="#">855070-017</a>	.	ENGINE KIT
<a href="#">855070-081</a>	.	ENGINE KIT
<a href="#">855072-001</a>	.	ENGINE KIT
<a href="#">855072-017</a>	.	ENGINE KIT

Copyright © 2020 PAI Industries, Inc.

All rights reserved. All content is property of PAI Industries, Inc. and may not be reproduced or redistributed in any form.

Any reference to OEM names or OEM product identification numbers/descriptions/model numbers is for identification only and does not indicate that it is an OEM part. PAI is not affiliated with Mack Truck, Inc.®, Volvo®, Fuller®, Cummins®, Eaton®, Rockwell®, Caterpillar®, Freightliner®, Hendrickson®, Kenworth®, Detroit Diesel®, International®, Peterbilt®, or Dana®. All Manufacturer's names, numbers, symbols and descriptions are used for reference only. It is not implied that any part listed is the product of these manufacturers.

## BEARING KIT

171720

<a href="#">855072-081</a>	.	ENGINE KIT
<a href="#">855075-001</a>	.	ENGINE KIT
<a href="#">855075-017</a>	.	ENGINE KIT
<a href="#">855077-001</a>	.	ENGINE KIT
<a href="#">855077-017</a>	.	ENGINE KIT
<a href="#">855078-001</a>	.	ENGINE KIT
<a href="#">855078-017</a>	.	ENGINE KIT
<a href="#">855078-049</a>	.	ENGINE KIT
<a href="#">855078-065</a>	.	ENGINE KIT
<a href="#">855078-081</a>	.	ENGINE KIT
<a href="#">855079-001</a>	.	ENGINE KIT
<a href="#">855079-017</a>	.	ENGINE KIT
<a href="#">855079-021</a>	.	DUAL-NI ENGINE KIT
<a href="#">855079-049</a>	.	ENGINE KIT
<a href="#">855079-065</a>	.	ENGINE KIT
<a href="#">855079-081</a>	.	ENGINE KIT
<a href="#">855079G-017</a>	.	ENGINE KIT
<a href="#">855080-001</a>	.	ENGINE KIT
<a href="#">855081-001</a>	.	ENGINE KIT
<a href="#">855082-001</a>	.	ENGINE KIT
<a href="#">855100-017</a>	.	ENGINE KIT
<a href="#">855100-081</a>	.	INFRAME ENGINE KIT
<a href="#">855100-085</a>	.	INFRAME ENGINE KIT
<a href="#">855108-001</a>	.	ENGINE KIT
<a href="#">855128-001</a>	.	ENGINE KIT
<a href="#">855148-001</a>	.	ENGINE KIT
<a href="#">855345-001</a>	.	ENGINE KIT
<a href="#">855345-065</a>	.	ENGINE KIT
<a href="#">N14101-017</a>	.	ENGINE KIT
<a href="#">N14101-081</a>	.	INFRAME ENGINE KIT
<a href="#">N14102-017</a>	.	ENGINE KIT
<a href="#">N14102-021</a>	.	INFRAME ENGINE KIT
<a href="#">N14102-025</a>	.	ENGINE KIT
<a href="#">N14102-049</a>	.	INFRAME ENGINE KIT
<a href="#">N14102-081</a>	.	INFRAME ENGINE KIT
<a href="#">N14103-017</a>	.	ENGINE KIT
<a href="#">N14103-081</a>	.	INFRAME ENGINE KIT
<a href="#">N14104-017</a>	.	ENGINE KIT
<a href="#">N14104-021</a>	.	INFRAME ENGINE KIT
<a href="#">N14104-081</a>	.	INFRAME ENGINE KIT

Copyright © 2020 PAI Industries, Inc.

All rights reserved. All content is property of PAI Industries, Inc. and may not be reproduced or redistributed in any form.

Any reference to OEM names or OEM product identification numbers/descriptions/model numbers is for identification only and does not indicate that it is an OEM part. PAI is not affiliated with Mack Truck, Inc.®, Volvo®, Fuller®, Cummins®, Eaton®, Rockwell®, Caterpillar®, Freightliner®, Hendrickson®, Kenworth®, Detroit Diesel®, International®, Peterbilt®, or Dana®. All Manufacturer's names, numbers, symbols and descriptions are used for reference only. It is not implied that any part listed is the product of these manufacturers.



# BEARING KIT

171720

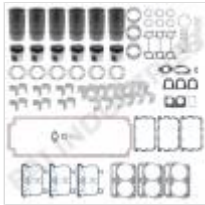
<a href="#">N14124-017</a>	.	ENGINE KIT
<a href="#">N14124-081</a>	.	ENGINE KIT
<a href="#">N14125-017</a>	.	ENGINE KIT
<a href="#">N14125-049</a>	.	ENGINE KIT
<a href="#">N14126-017</a>	.	ENGINE KIT
<a href="#">N14221-017</a>		ENGINE KIT
<a href="#">N14221-021</a>	.	ENGINE KIT
<a href="#">N14221-081</a>	.	ENGINE KIT
<a href="#">N14221-113</a>	.	ENGINE KIT
<a href="#">N14221-145</a>	.	ENGINE KIT
<a href="#">N14222-017</a>	.	INFRAME ENGINE KIT
<a href="#">N14222-021</a>	.	ENGINE KIT
<a href="#">N14222-049</a>	.	ENGINE KIT
<a href="#">N14222-081</a>	.	INFRAME ENGINE KIT
<a href="#">N14222-113</a>	.	INFRAME ENGINE KIT
<a href="#">N14222-145</a>	.	INFRAME ENGINE KIT
<a href="#">N14223-017</a>	.	ENGINE KIT
<a href="#">N14223-081</a>	.	ENGINE KIT

Cross Reference:	
Manufacturer	OEM Number
CUMMINS	3014051
CUMMINS	3030221
CUMMINS	3801260
CUMMINS	AR-7110
CUMMINS	AR-7240
CUMMINS	AR7110
CUMMINS	AR7240

Copyright © 2020 PAI Industries, Inc.  
 All rights reserved. All content is property of PAI Industries, Inc. and may not be reproduced or redistributed in any form.

Any reference to OEM names or OEM product identification numbers/descriptions/model numbers is for identification only and does not indicate that it is an OEM part. PAI is not affiliated with Mack Truck, Inc.®, Volvo®, Fuller®, Cummins®, Eaton®, Rockwell®, Caterpillar®, Freightliner®, Hendrickson®, Kenworth®, Detroit Diesel®, International®, Peterbilt®, or Dana®. All Manufacturer's names, numbers, symbols and descriptions are used for reference only. It is not implied that any part listed is the product of these manufacturers.