

CONTROL VALVE

EM36270



Description: CONTROL VALVE
SKU: EM36270
OEM: 20QE3126
Product Group: SUSPENSION
Product Class: LEVELING VALVES
UPC Code: 193807118259
Sell Pack: 1 EA
Weight: 2.60 LBS
Warranty: 1 Year



Details:

Control Valve
 All Ports 1/8in P.T.
 R application

Substitute:

SKU	Sell Pack	Weight	Warranty	Description
LCV-3627	1	2.75 LBS	2 Years	CONTROL VALVE

E-Catalog Pages:

Catalog Page	Description
--------------	-------------

Copyright © 2020 PAI Industries, Inc.
 All rights reserved. All content is property of PAI Industries, Inc, and may not be reproduced or redistributed in any form.

Any reference to OEM names or OEM product identification numbers/descriptions/model numbers is for identification only and does not indicate that it is an OEM part. PAI is not affiliated with Mack Truck, Inc.®, Volvo®, Fuller®, Cummins®, Eaton®, Rockwell®, Caterpillar®, Freightliner®, Hendrickson®, Kenworth®, Detroit Diesel®, International®, Peterbilt®, or Dana®. All Manufacturer's names, numbers, symbols and descriptions are used for reference only. It is not implied that any part listed is the product of these manufacturers.

CONTROL VALVE

EM36270

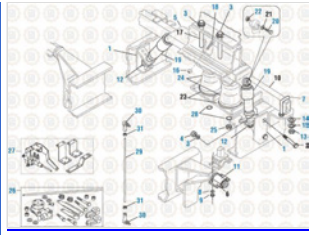

Cab Catalog
R / RB / RD Models



Air & Electrical 2019
Delay Type - Valves

Copyright © 2020 PAI Industries, Inc.
All rights reserved. All content is property of PAI Industries, Inc, and may not be reproduced or redistributed in any form.

Any reference to OEM names or OEM product identification numbers/descriptions/model numbers is for identification only and does not indicate that it is an OEM part. PAI is not affiliated with Mack Truck, Inc.®, Volvo®, Fuller®, Cummins®, Eaton®, Rockwell®, Caterpillar®, Freightliner®, Hendrickson®, Kenworth®, Detroit Diesel®, International®, Peterbilt®, or Dana®. All Manufacturer's names, numbers, symbols and descriptions are used for reference only. It is not implied that any part listed is the product of these manufacturers.