

THRUST WASHER

GTW-5999



Description: THRUST WASHER
SKU: GTW-5999
OEM: 223KD241
Product Group: TRANSMISSION
Product Class: GEARS, SHAFTS, CLUTCHES
UPC Code: 193807236946
Sell Pack: 1 EA
Weight: 0.13 LBS
Warranty: 2 Years



Details:
 Mack T2050, T2060 / A, T2070 / A / B / C / D, T2080 / B, T2090, T2100, T2110B / D, T2130, T2180 T309L, T310 / M, T313L, T318L Application

E-Catalog Pages:

Catalog Page	Description
	<p>Drive Train 2016 Main Case Components - T2080B</p>

Copyright © 2020 PAI Industries, Inc.
 All rights reserved. All content is property of PAI Industries, Inc, and may not be reproduced or redistributed in any form.

Any reference to OEM names or OEM product identification numbers/descriptions/model numbers is for identification only and does not indicate that it is an OEM part. PAI is not affiliated with Mack Truck, Inc.®, Volvo®, Fuller®, Cummins®, Eaton®, Rockwell®, Caterpillar®, Freightliner®, Hendrickson®, Kenworth®, Detroit Diesel®, International®, Peterbilt®, or Dana®. All Manufacturer's names, numbers, symbols and descriptions are used for reference only. It is not implied that any part listed is the product of these manufacturers.

THRUST WASHER

GTW-5999

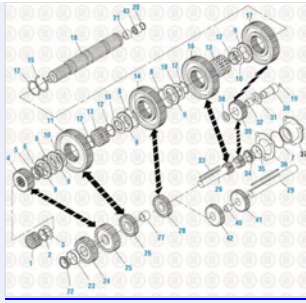
**Drive Train 2016**

Main Case Components - T2080, T2090 and T2100

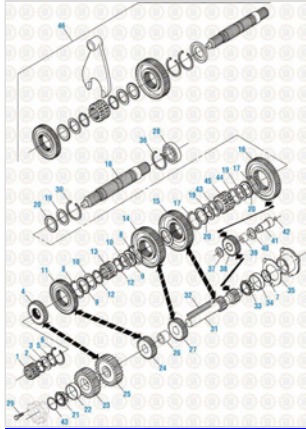
**Drive Train 2016**

Main Case Components - Original Mainshaft Design - T2050

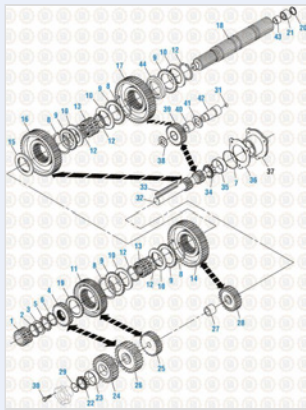
**Drive Train 2016**

Main Case Components - T2060 & T2070

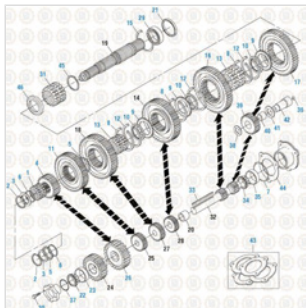
**Drive Train 2016**

Main Case Components - T2060A

Copyright © 2020 PAI Industries, Inc.

All rights reserved. All content is property of PAI Industries, Inc. and may not be reproduced or redistributed in any form.

Any reference to OEM names or OEM product identification numbers/descriptions/model numbers is for identification only and does not indicate that it is an OEM part. PAI is not affiliated with Mack Truck, Inc.®, Volvo®, Fuller®, Cummins®, Eaton®, Rockwell®, Caterpillar®, Freightliner®, Hendrickson®, Kenworth®, Detroit Diesel®, International®, Peterbilt®, or Dana®. All Manufacturer's names, numbers, symbols and descriptions are used for reference only. It is not implied that any part listed is the product of these manufacturers.

THRUST WASHER

GTW-5999

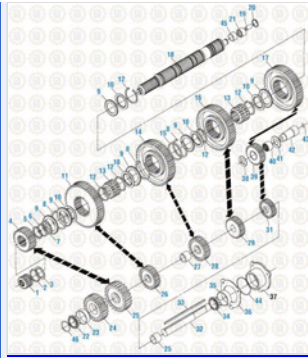

Drive Train 2016
Main Case Components - T2130 and T2180

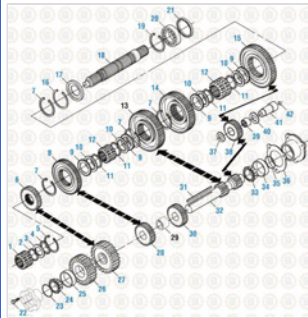

Drive Train 2016
Main Case Components - Current Mainshaft Design - T2050

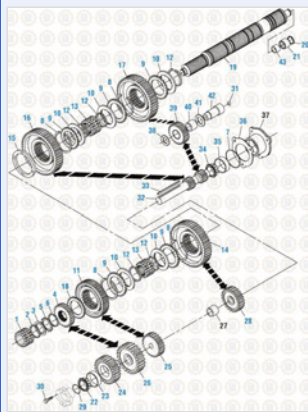

Drive Train 2016
Main Case Components - T2070 A & C

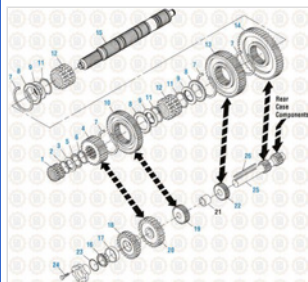

Drive Train 2016
Main Case Components - Long Rear Case, Multi-Speed Reverse, Rear Mounted Main Shifter - T2070 B & D

Copyright © 2020 PAI Industries, Inc.
All rights reserved. All content is property of PAI Industries, Inc. and may not be reproduced or redistributed in any form.

Any reference to OEM names or OEM product identification numbers/descriptions/model numbers is for identification only and does not indicate that it is an OEM part. PAI is not affiliated with Mack Truck, Inc.®, Volvo®, Fuller®, Cummins®, Eaton®, Rockwell®, Caterpillar®, Freightliner®, Hendrickson®, Kenworth®, Detroit Diesel®, International®, Peterbilt®, or Dana®. All Manufacturer's names, numbers, symbols and descriptions are used for reference only. It is not implied that any part listed is the product of these manufacturers.

THRUST WASHER

GTW-5999

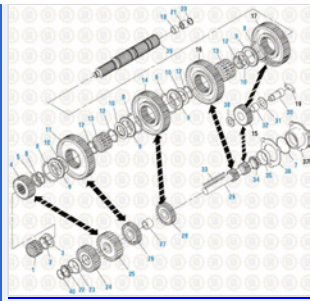

Drive Train 2016
Main Case Components - T309L and T310

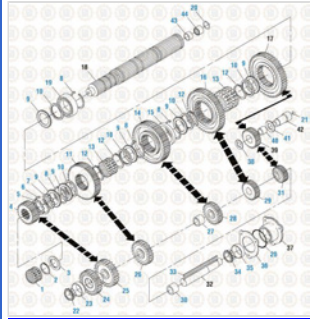

Drive Train 2016
Main Case Components - T2110 B and D

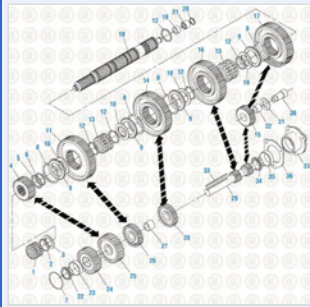

Drive Train 2016
Main Case Components - T313L and T318L

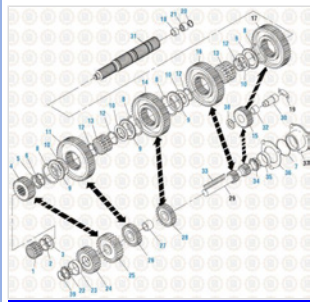

Drive Train 2016
Main Case Components - T310M

Component Of:





SKU	Image	Description

Copyright © 2020 PAI Industries, Inc.
All rights reserved. All content is property of PAI Industries, Inc. and may not be reproduced or redistributed in any form.

Any reference to OEM names or OEM product identification numbers/descriptions/model numbers is for identification only and does not indicate that it is an OEM part. PAI is not affiliated with Mack Truck, Inc.®, Volvo®, Fuller®, Cummins®, Eaton®, Rockwell®, Caterpillar®, Freightliner®, Hendrickson®, Kenworth®, Detroit Diesel®, International®, Peterbilt®, or Dana®. All Manufacturer's names, numbers, symbols and descriptions are used for reference only. It is not implied that any part listed is the product of these manufacturers.

THRUST WASHER

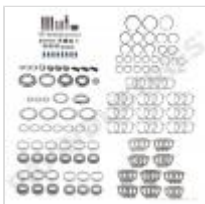
GTW-5999

GBK-5942		BEARING AND SEAL KIT
GBK-6153		BEARING AND SEAL KIT
GBK-6565		BEARING AND SEAL KIT
GBK-6573		BEARING AND SEAL KIT
GBK-6637		BEARING AND SEAL KIT
GBK-6685		BEARING AND SEAL KIT
GBK-8955		BEARING AND SEAL KIT
GBK-8956		BEARING AND SEAL KIT
GBK-8957		BEARING AND SEAL KIT
GBK-8958		BEARING AND SEAL KIT
GBK-8963		BEARING AND SEAL KIT
806869		BEARING AND SEAL KIT
806871		BEARING KIT
806872		BEARING AND SEAL KIT

Cross Reference:	
Manufacturer	OEM Number

Copyright © 2020 PAI Industries, Inc.
 All rights reserved. All content is property of PAI Industries, Inc. and may not be reproduced or redistributed in any form.

Any reference to OEM names or OEM product identification numbers/descriptions/model numbers is for identification only and does not indicate that it is an OEM part. PAI is not affiliated with Mack Truck, Inc.®, Volvo®, Fuller®, Cummins®, Eaton®, Rockwell®, Caterpillar®, Freightliner®, Hendrickson®, Kenworth®, Detroit Diesel®, International®, Peterbilt®, or Dana®. All Manufacturer's names, numbers, symbols and descriptions are used for reference only. It is not implied that any part listed is the product of these manufacturers.

THRUST WASHER

GTW-5999

MACK	223KD241
MACK	25499258

Copyright © 2020 PAI Industries, Inc.

All rights reserved. All content is property of PAI Industries, Inc. and may not be reproduced or redistributed in any form.

Any reference to OEM names or OEM product identification numbers/descriptions/model numbers is for identification only and does not indicate that it is an OEM part. PAI is not affiliated with Mack Truck, Inc.®, Volvo®, Fuller®, Cummins®, Eaton®, Rockwell®, Caterpillar®, Freightliner®, Hendrickson®, Kenworth®, Detroit Diesel®, International®, Peterbilt®, or Dana®. All Manufacturer's names, numbers, symbols and descriptions are used for reference only. It is not implied that any part listed is the product of these manufacturers.