

# TAPERED ROLLER BEARING CONE

806998



**Description:** TAPERED ROLLER BEARING CONE  
**SKU:** 806998  
**OEM:** 89KB25  
**Product Group:** WHEEL, HUB & DRUMS  
**Product Class:** WHEEL BEARINGS  
**UPC Code:** 193807233037  
**Sell Pack:** 1 EA  
**Weight:** 3.13 LBS  
**Warranty:** 2 Years



**Details:**

Tapered Roller Bearing Cone  
 Mack CRD 150 Differential application

**E-Catalog Pages:**

**Catalog Page** **Description**

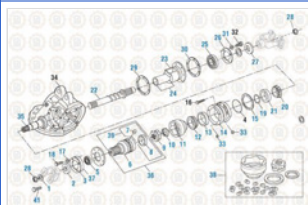

**Drive Train 2016**  
 CRD 150

Copyright © 2020 PAI Industries, Inc.  
 All rights reserved. All content is property of PAI Industries, Inc, and may not be reproduced or redistributed in any form.

Any reference to OEM names or OEM product identification numbers/descriptions/model numbers is for identification only and does not indicate that it is an OEM part. PAI is not affiliated with Mack Truck, Inc.®, Volvo®, Fuller®, Cummins®, Eaton®, Rockwell®, Caterpillar®, Freightliner®, Hendrickson®, Kenworth®, Detroit Diesel®, International®, Peterbilt®, or Dana®. All Manufacturer's names, numbers, symbols and descriptions are used for reference only. It is not implied that any part listed is the product of these manufacturers.

# TAPERED ROLLER BEARING CONE

806998

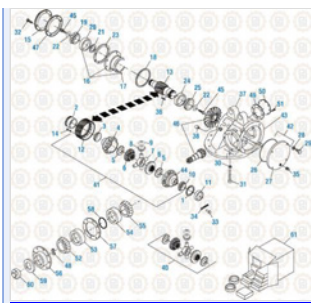

PAI Mack & Volvo Applications 2018  
Components - CRD 151

**Component Of:**

SKU	Image	Description
<a href="#">806865</a>		BEARING AND SEAL KIT
<a href="#">806866</a>		BEARING KIT

**Cross Reference:**

Manufacturer	OEM Number
CATERPILLAR	3H4026
GMC TRUCK	9412494
GMC TRUCK	9412495
MACK	21170161
MACK	4333-79015R91
MACK	4333-79290R91
MACK	89KB25
NAVISTAR	79015R91
NAVISTAR	79290R91

Copyright © 2020 PAI Industries, Inc.  
All rights reserved. All content is property of PAI Industries, Inc. and may not be reproduced or redistributed in any form.

Any reference to OEM names or OEM product identification numbers/descriptions/model numbers is for identification only and does not indicate that it is an OEM part. PAI is not affiliated with Mack Truck, Inc., Volvo®, Fuller®, Cummins®, Eaton®, Rockwell®, Caterpillar®, Freightliner®, Hendrickson®, Kenworth®, Detroit Diesel®, International®, Peterbilt®, or Dana®. All Manufacturer's names, numbers, symbols and descriptions are used for reference only. It is not implied that any part listed is the product of these manufacturers.