

# ROLLER TAPPET

# ERT-8559



<b>Description:</b>	ROLLER TAPPET
<b>SKU:</b>	ERT-8559
<b>OEM:</b>	72GC372A
<b>Product Group:</b>	ENGINE PARTS
<b>Product Class:</b>	VALVES & VALVE TRAIN, ROCKER COVER PARTS
<b>UPC Code:</b>	193807260149
<b>Sell Pack:</b>	1 EA
<b>Weight:</b>	0.65 LBS
<b>Package Dimensions (LxWxH):</b>	2 x 2 x 6 inches
<b>Warranty:</b>	2 Years



**Details:**  
 Roller Tappet  
 Ceramic E-Tech and ASET  
 12 required

**E-Catalog Pages:**

Catalog Page	Description
	<p><b>PAI Mack &amp; Volvo Applications 2018</b>                      Rocker Arm Assembly                      E7, E-Tech, ASET - E7 Series</p>

**Copyright © 2020 PAI Industries, Inc.**  
 All rights reserved. All content is property of PAI Industries, Inc, and may not be reproduced or redistributed in any form.

Any reference to OEM names or OEM product identification numbers/descriptions/model numbers is for identification only and does not indicate that it is an OEM part. PAI is not affiliated with Mack Truck, Inc.®, Volvo®, Fuller®, Cummins®, Eaton®, Rockwell®, Caterpillar®, Freightliner®, Hendrickson®, Kenworth®, Detroit Diesel®, International®, Peterbilt®, or Dana®. All Manufacturer's names, numbers, symbols and descriptions are used for reference only. It is not implied that any part listed is the product of these manufacturers.

# ROLLER TAPPET

# ERT-8559

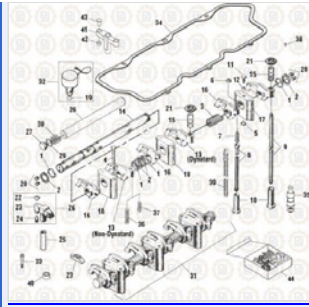

**Volvo / Renault Engine Components 2015**  
Rocker Arm Assembly - Renault / E-Tech

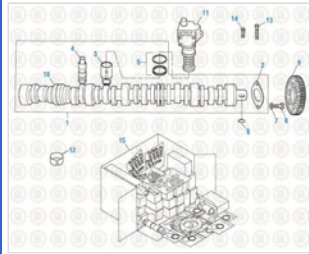

**PAI Mack & Volvo Applications 2018**  
E-Tech E-Tech, ASET - E7 Series

**Volvo / Renault Engine Components 2015**  
Camshaft - E-Tech - Renault / E-Tech

**Component Of:**

SKU	Image	Description
<a href="#">ECK-9059-100</a>		CAMSHAFT INTALLATION KIT

**Cross Reference:**

Manufacturer	OEM Number
MACK	20706585
MACK	25502568
MACK	72GC372
MACK	72GC372A

Copyright © 2020 PAI Industries, Inc.  
All rights reserved. All content is property of PAI Industries, Inc. and may not be reproduced or redistributed in any form.

Any reference to OEM names or OEM product identification numbers/descriptions/model numbers is for identification only and does not indicate that it is an OEM part. PAI is not affiliated with Mack Truck, Inc., Volvo®, Fuller®, Cummins®, Eaton®, Rockwell®, Caterpillar®, Freightliner®, Hendrickson®, Kenworth®, Detroit Diesel®, International®, Peterbilt®, or Dana®. All Manufacturer's names, numbers, symbols and descriptions are used for reference only. It is not implied that any part listed is the product of these manufacturers.