

# OUTER POWER DIVIDER RING

# BRG-0126



**Description:** OUTER POWER DIVIDER RING  
**SKU:** BRG-0126  
**OEM:** 35KN24  
**Product Group:** DIFFERENTIAL  
**Product Class:** POWER DIVIDER & SHIFTER PARTS  
**UPC Code:** 193807166977  
**Sell Pack:** 1 EA  
**Weight:** 0.19 LBS  
**Warranty:** 2 Years



**Details:**  
 Use w/ BWE-1235 Wedge Set

E-Catalog Pages:	
Catalog Page	Description
	<b>Drive Train 2016</b> CRDPC 92/112
	<b>Drive Train 2016</b> CRDPC 92/112 With Lockout

Copyright © 2020 PAI Industries, Inc.  
 All rights reserved. All content is property of PAI Industries, Inc. and may not be reproduced or redistributed in any form.

Any reference to OEM names or OEM product identification numbers/descriptions/model numbers is for identification only and does not indicate that it is an OEM part. PAI is not affiliated with Mack Truck, Inc.®, Volvo®, Fuller®, Cummins®, Eaton®, Rockwell®, Caterpillar®, Freightliner®, Hendrickson®, Kenworth®, Detroit Diesel®, International®, Peterbilt®, or Dana®. All Manufacturer's names, numbers, symbols and descriptions are used for reference only. It is not implied that any part listed is the product of these manufacturers.

# OUTER POWER DIVIDER RING

# BRG-0126

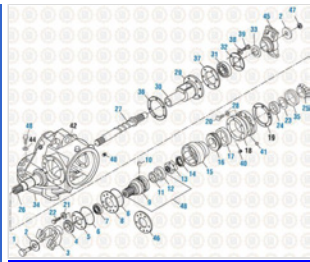

**Drive Train 2016**  
CRDP 200/202

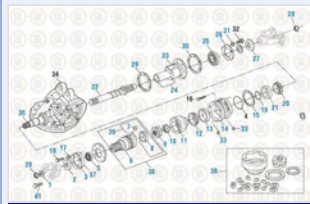

**Drive Train 2016**  
CRD 150

### Component Of:

SKU	Image	Description
<a href="#">EM20590</a>	.	POWER DIVIDER KIT
<a href="#">BPD-2059</a>	.	POWER DIVIDER KIT
<a href="#">BPD-2066</a>	.	POWER DIVIDER KIT
<a href="#">BPD-2067</a>		POWER DIVIDER KIT
<a href="#">BPD-2068</a>	.	CAGE KIT
<a href="#">BWK-2161</a>		WEDGE KIT

### Cross Reference:

Manufacturer	OEM Number
MACK	35KN24
MACK	25102626

Copyright © 2020 PAI Industries, Inc.  
All rights reserved. All content is property of PAI Industries, Inc. and may not be reproduced or redistributed in any form.

Any reference to OEM names or OEM product identification numbers/descriptions/model numbers is for identification only and does not indicate that it is an OEM part. PAI is not affiliated with Mack Truck, Inc.®, Volvo®, Fuller®, Cummins®, Eaton®, Rockwell®, Caterpillar®, Freightliner®, Hendrickson®, Kenworth®, Detroit Diesel®, International®, Peterbilt®, or Dana®. All Manufacturer's names, numbers, symbols and descriptions are used for reference only. It is not implied that any part listed is the product of these manufacturers.