

# RETAINER

# EF10880



**Description:** RETAINER  
**SKU:** EF10880  
**OEM:** 21320  
**Product Group:** TRANSMISSION  
**Product Class:** GEARS, SHAFTS, CLUTCHES  
**UPC Code:** 193807100858  
**Sell Pack:** 1 EA  
**Weight:** 0.19 LBS  
**Warranty:** 1 Year



**Details:**

Retainer  
 Fuller Transmission application

**E-Catalog Pages:**

Catalog Page	Description
	<p><b>Web Electronic</b>                      Auxiliary Components - Fuller Transmission</p>

Copyright © 2020 PAI Industries, Inc.  
 All rights reserved. All content is property of PAI Industries, Inc. and may not be reproduced or redistributed in any form.

Any reference to OEM names or OEM product identification numbers/descriptions/model numbers is for identification only and does not indicate that it is an OEM part. PAI is not affiliated with Mack Truck, Inc.®, Volvo®, Fuller®, Cummins®, Eaton®, Rockwell®, Caterpillar®, Freightliner®, Hendrickson®, Kenworth®, Detroit Diesel®, International®, Peterbilt®, or Dana®. All Manufacturer's names, numbers, symbols and descriptions are used for reference only. It is not implied that any part listed is the product of these manufacturers.

# RETAINER

# EF10880

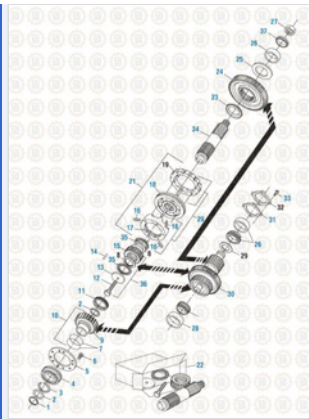

**Drive Train 2016**  
 Auxiliary Components - Current Style - RT/RTO/RTOO/RTLO 14613 and 14813

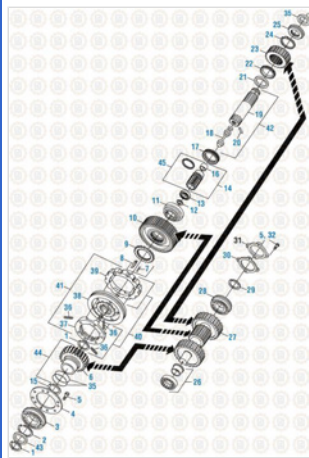

**Drive Train 2016**  
 Auxiliary Components - Early Style - RT/RTO/RTOO/RTLO 14613 and 14813

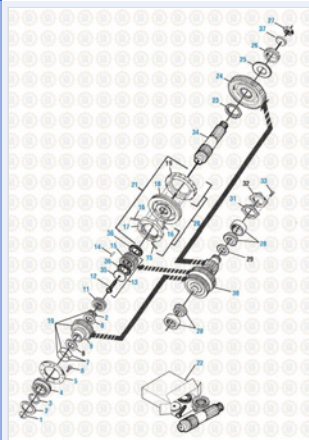

**Drive Train 2016**  
 Auxiliary Components - RTLO 16618

**Component Of:**

SKU	Image	Description
<a href="#">EF61580</a>		AUXILIARY DRIVE GEAR KIT

Copyright © 2020 PAI Industries, Inc.  
 All rights reserved. All content is property of PAI Industries, Inc, and may not be reproduced or redistributed in any form.

Any reference to OEM names or OEM product identification numbers/descriptions/model numbers is for identification only and does not indicate that it is an OEM part. PAI is not affiliated with Mack Truck, Inc.®, Volvo®, Fuller®, Cummins®, Eaton®, Rockwell®, Caterpillar®, Freightliner®, Hendrickson®, Kenworth®, Detroit Diesel®, International®, Peterbilt®, or Dana®. All Manufacturer's names, numbers, symbols and descriptions are used for reference only. It is not implied that any part listed is the product of these manufacturers.

# RETAINER

# EF10880

<a href="#">EF65270</a>		GEAR KIT
<a href="#">EF65270HP</a>		HIGH PERFORMANCE GEAR KIT
<a href="#">EF65380</a>	.	BEARING AND SEAL KIT
<a href="#">EF65430</a>	.	BEARING AND SEAL KIT
<a href="#">EF65450</a>	.	BEARING AND SEAL KIT
<a href="#">EF65460</a>	.	BEARING AND SEAL KIT
<a href="#">EF65840</a>	.	BEARING AND SEAL KIT
<a href="#">EF65850</a>	.	BEARING AND SEAL KIT
<a href="#">EF65980</a>	.	BEARING AND SEAL KIT
<a href="#">EF65990</a>	.	BEARING AND SEAL KIT
<a href="#">EF66040</a>	.	BEARING AND SEAL KIT
<a href="#">EF66090</a>		BEARING AND SEAL KIT
<a href="#">EF66410</a>		AUXILIARY DRIVE KIT
<a href="#">900143</a>		AUXILIARY MAINDRIVE GEAR KIT
<a href="#">900439</a>	.	SMALL PARTS KIT
<a href="#">900469</a>	.	BEARING AND SEAL KIT

Copyright © 2020 PAI Industries, Inc.

All rights reserved. All content is property of PAI Industries, Inc. and may not be reproduced or redistributed in any form.

Any reference to OEM names or OEM product identification numbers/descriptions/model numbers is for identification only and does not indicate that it is an OEM part. PAI is not affiliated with Mack Truck, Inc.®, Volvo®, Fuller®, Cummins®, Eaton®, Rockwell®, Caterpillar®, Freightliner®, Hendrickson®, Kenworth®, Detroit Diesel®, International®, Peterbilt®, or Dana®. All Manufacturer's names, numbers, symbols and descriptions are used for reference only. It is not implied that any part listed is the product of these manufacturers.

# RETAINER

# EF10880

**Cross Reference:**

Manufacturer	OEM Number
FULLER	21320
NAVISTAR	1666386C1

**Copyright © 2020 PAI Industries, Inc.**

All rights reserved. All content is property of PAI Industries, Inc, and may not be reproduced or redistributed in any form.

Any reference to OEM names or OEM product identification numbers/descriptions/model numbers is for identification only and does not indicate that it is an OEM part. PAI is not affiliated with Mack Truck, Inc.®, Volvo®, Fuller®, Cummins®, Eaton®, Rockwell®, Caterpillar®, Freightliner®, Hendrickson®, Kenworth®, Detroit Diesel®, International®, Peterbilt®, or Dana®. All Manufacturer's names, numbers, symbols and descriptions are used for reference only. It is not implied that any part listed is the product of these manufacturers.