



PANTHERTM

MARINE PRODUCTS

**DURABILITY &
DEPENDABILITY**

CMPH

PANTHER™

For over 30 years Panther trim and tilts, Safe-Skeg, Outboard motor brackets, and PRO series oil extractors have been a top seller throughout the United States and around the world. The Model 35 Trim and Tilt is the number one trim and tilt used on the Masters Walleye Circuit.

Within the last few years, Panther has grown its product line to include many quality accessory products; Panther manufactures a high quality shallow water anchor system called King Pin, in addition Panther in 2015 launched Panther Security Systems which offers lower unit locks, turnbuckle and transom bolt style locks. In 2017 Panther took another leap by launching Panther XPS Power Steering. This revolution in steering continues the innovative trend that Panther is known for.

In addition, Panther Products offers a full line of steering solutions, battery gauges, rope cleats, transom savers/ motor supports and a curated offering of the best ladders on the market.

- XPS Steering System4
- Security Systems6
- King Pin Anchors.....8
- Safe-Skeg Skeg Protection & Repair10
- Outboard Motor Brackets12
- Motor Lift/Set-Backs14
- Fluid Extractors15
- Trim & Tilt16
- Ladders18
- Accessories19
- NEW 2020 PRODUCTS.....22**
- Kicker Steering24



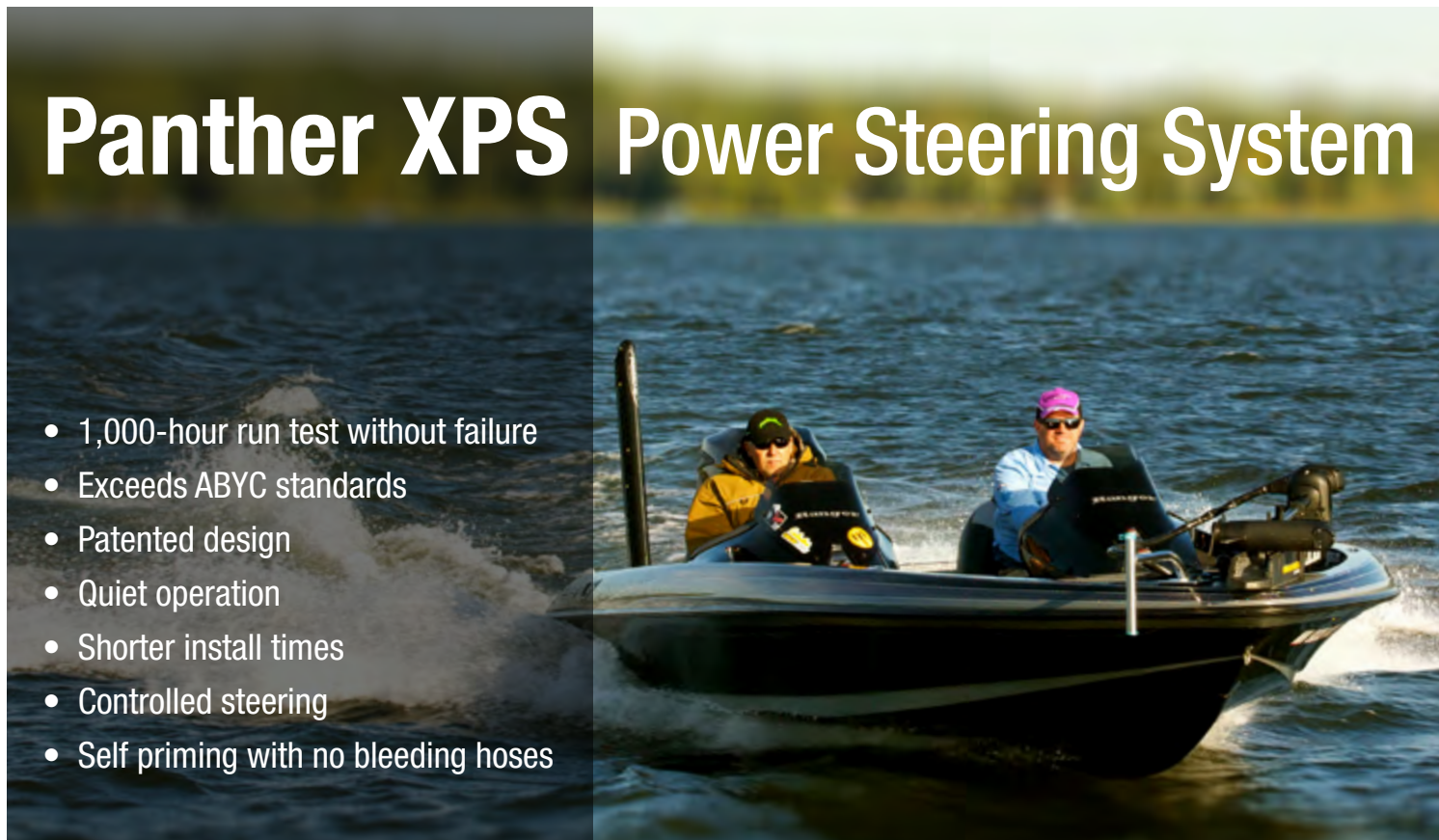

- 1,000-hour run test without failure
- Exceeds ABYC standards
- Patented design
- Quiet operation
- Shorter install times
- Controlled steering
- Self priming with no bleeding hoses



The Panther XPS Power Steering System by MarineTech Products is a hybrid steering system that combines the durability and dependability of cable steering with the ease of automobile-like power steering.

Easy to maneuver in tight quarters, the Panther XPS System eliminates prop torque so high-speed turns are safer, easier and more controlled.

This patented Panther XPS System uses stored power by delivering pressurized fluid to the cylinder so the pump only runs when the volume of fluid in the accumulator drops to a predetermined level (typically less than 10% of the engine run time).

Other systems run continuously or when there is ANY steering input to the wheel. Limited run time saves power and reduces the risk of dead batteries.



10-7200

The Panther XPS System gradually reverts to cable steering in case of hose failure, steering fluid leak or power loss to pump.

Each Panther XPS Power Steering System comes with specially formulated, fully synthetic power steering fluid.

The Panther XPS System is designed to be installed on 75 to 300 HP outboard motors that are equipped with a single steering-cable system.

Hose Kits

10-0205	Panther Synthetic Power Steering Fluid (1 qt.) – case packs only (12 qts.)
10-6106	Panther XPS Hose Kit 6' – 1/4" Hi-Pressure Hose plus 7' – 5/16" Return Hose
10-6107	Panther XPS Hose Kit 7' – 1/4" Hi-Pressure Hose plus 8' – 5/16" Return Hose
10-6108	Panther XPS Hose Kit 8' – 1/4" Hi-Pressure Hose plus 9' – 5/16" Return Hose
10-6110	Panther XPS Hose Kit 10' – 1/4" Hi-Pressure Hose plus 11' – 5/16" Return Hose*
10-6112	Panther XPS Hose Kit 12' – 1/4" Hi-Pressure Hose plus 13' – 5/16" Return Hose*
10-6114	Panther XPS Hose Kit 14' – 1/4" Hi-Pressure Hose plus 15' – 5/16" Return Hose*
10-6116	Panther XPS Hose Kit 16' – 1/4" Hi-Pressure Hose plus 17' – 5/16" Return Hose*
10-6118	Panther XPS Hose Kit 18' – 1/4" Hi-Pressure Hose plus 19' – 5/16" Return Hose*
10-6120	Panther XPS Hose Kit 20' – 1/4" Hi-Pressure Hose plus 21' – 5/16" Return Hose*
10-6122	Panther XPS Hose Kit 22' – 1/4" Hi-Pressure Hose plus 23' – 5/16" Return Hose*
10-6124	Panther XPS Hose Kit 24' – 1/4" Hi-Pressure Hose plus 25' – 5/16" Return Hose*
10-7200	Panther XPS Power Steering Unit

* All hose sets greater than 8' in length require additional steering fluid.

The hose kit contains two hoses—high pressure and low pressure—with fittings. The low-pressure hose is 12" longer to allow for uninterrupted travel when connected to the cylinder actuator.

Multiple hose lengths are available so you can custom fit the Panther XPS System to your boat. (One hose kit is needed per system.)



Other Cylinder Mount Plates

Standard system includes Mercury/Honda cylinder mount plate. For Honda applications, an additional link arm is required (Honda part no. 06532-ZY3-U00).

- 10-1120 Suzuki Plate Kit
- 10-1126 Yamaha Plate Kit



- 10-1122 Evinrude Plate Kit





Lower Unit Locks

- Tamper-resistant
- Marine-grade stainless steel construction
- Quick & easy installation
- No alteration required

Motor	HP / Description	Configuration	MarineTech Part #
Evinrude Outboard	150 - 300 HP	Single Engine	75-8410
Evinrude Outboard	150 - 300 HP	Twin Engine	75-8420
Evinrude Outboard	200 - 300 HP	Triple Engine	75-8430
Mercury Verado and Optimax Outboard	Verado 150 - 350 HP, Optimax 115 - 250 HP	Single Engine	75-8310
Mercury Verado and Optimax Outboard	Verado 150 - 350 HP, Optimax 115 - 250 HP	Twin Engine	75-8320
Mercury Verado and Optimax Outboard	Verado 150 - 350 HP, Optimax 115 - 250 HP	Triple Engine	75-8330
Suzuki Outboard	200 - 300 HP	Single Engine	75-8710
Suzuki Outboard	200 - 300 HP	Twin Engine	75-8720
Suzuki Outboard	200 - 300 HP	Triple Engine	75-8730
Yamaha-Honda Outboard	Yamaha 200 HP Plus, All Honda	Single Engine	75-8610
Yamaha-Honda Outboard	Yamaha 200 HP Plus, All Honda	Twin Engine	75-8620
Yamaha-Honda Outboard	Yamaha 200 HP Plus, All Honda	Triple Engine	75-8630
Yamaha Outboard	Short Bolt 150 HP and less - 20" Shaft	Single Engine	75-8510
Yamaha Outboard	Short Bolt 150 HP and less - 25" Shaft	Single Engine	75-8520
Yamaha Outboard	Short Bolt 150 HP and less - 20" Shaft	Twin Engine	75-8540
Yamaha Outboard	Short Bolt 150 HP and less - 25" Shaft	Twin Engine	75-8550
Yamaha Outboard	150 HP and above - 30" Shaft	Single Engine	75-8531
Yamaha Outboard	150 HP and above - 30" Shaft	Twin Engine	75-8532
Yamaha Outboard	150 HP and above - 30" Shaft	Triple Engine	75-8533

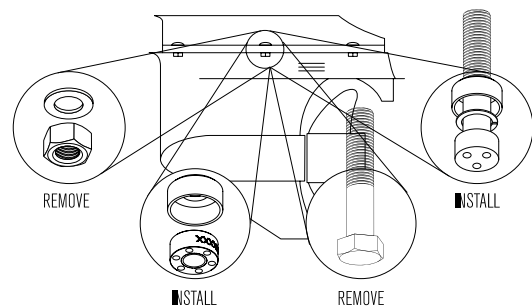

Remove the existing nut, washer or bolt and replace with the security nut or bolt and bell washer and rest easy —your lower unit is now secure.

Evinrude Triple

75- 8430



Mercury Verado & Optimax Triple

75-8330



Yamaha/Honda, Suzuki Triple

75-8630, 75-8730



Yamaha Twin

75-8550



Panther Outboard Lock

75-8000, C75-8000



The Panther Outboard Lock is a heavy carbon steel design and fits Turnbuckle mounted engines. It has a recessed, solid brass lock and noise dampeners that reduce rattle. NOT suitable for saltwater. Also available in camo.

Heavy-Duty Outboard Lock

75-8201, 75-8202



This Outboard Lock fits Turnbuckle design and has anti-drill protection. It has polished, marine-grade stainless steel and noise dampeners that reduce rattle. The two security keys cannot be duplicated.

SCM Certified 75-8201
SSF Certified 75-8202

High-Security Outboard Lock

75-8101, 75-8102



This high-security Outboard Motor Lock has anti-drill protection and fits up to 1/2" (12 mm) engine bolts. Made from marine-grade stainless steel. The two security keys cannot be duplicated.

SCM Certified 75-8101
SSF Certified 75-8102

2-PIECE POLES
Available in 8', 10' or 12' lengths for easy storage in standard rod lockers (8' 1-piece also available).

MOLDED FOAM GRIPS
No-slip molded handles allow for a tight grip to firmly secure the pole into the lake or river bottom.

PROPRIETARY POLE LOCK
Lock secures the pole in place for quick moves with no loose parts to fall overboard.

QUICK-RELEASE MOUNTING PLATE
Allows for easy removal of the bow-mount bracket for a clean, unobstructed deck.

STAINLESS STEEL POLE TIP
Eliminates wear and splintering and helps with quick penetration of the lake or river bottom.

King Pin Anchor Systems

SET the pin to STOP the spin!

Designed to mount on the bow or transom, King Pin Anchors are a great alternative—or complement—to expensive power actuator poles for keeping your boat from spinnin' in the wind.

King Pin offers a convenient, shallow-water anchoring system for a quick, no-maintenance way to hold your boat in position in shallow water without heavy anchors and wet, cumbersome ropes. Ideal for precision bait presentations, especially in windy or high-current conditions. With no power, switches or wires, King Pin is the perfect complement or alternative to power-actuated pole anchors. Available in bow or transom mount with a wide range of anchor pole selections.

Features

King Pin Signature Anchor Poles

2-piece poles feature a pool-cue-style stainless steel butt collar for quick breakdown and easy storage or transport. Constructed of 3/4" diameter, high-impact fiberglass. Equipped with molded foam grips and stainless steel tips to protect the pole while allowing easy bottom penetration. Rubber storage clips with mounting screws included. 2-piece poles are of equal length. (8', single-piece pole also available.)

Quick-Release Bow and Transom Mount Brackets

With a quick pull of the plunger pin and a short twist, the bracket can be removed leaving only the mounting plate for a clean, obstacle-free deck or transom. Includes integrated O-rings eliminating the need for sealant. Bow mounts are available in 3" or 6" rise for safe and easy gunnel clearance. Transom mounts are available in 2.5" and 5" setback. Clear anodized or black powder-coated aluminum. Mounting hardware included.

Signature Pole Lock

All brackets are equipped with a proprietary, integrated pole lock. Just flip the lever to secure the pole in the bracket. No loose parts that can fall in the water.

BOW MOUNTS

Quick-Release Bow Mount Brackets 3" RISE



- KPB30A Clear Anodized
- KPB30B Black Powder Coat
- KPB30C Camo

Quick-Release Bow Mount Brackets 6" RISE

- KPB60A Clear Anodized
- KPB60B Black Powder Coat

Universal Engine Mount Plate

For engine-mount application, combine only with 2.5" Transom Mount Bracket.

- KPMMP Black Powder Coat



TRANSOM MOUNTS

Transom Mount Brackets 2.5" SETBACK



- KPS25A Clear Anodized
- KPS25B Black Powder Coat
- KPS25C Camo

Mount Plate dimensions: 4" x 6"



- KPS50A Clear Anodized
- KPS50B Black Powder Coat
- KPSQ50A Quick Release Clear Anodized
- KPSQ50B Quick Release Black Powder Coat

One (1) base plate is included.
Base Plate dimensions: 4" x 6"

POLES



ACCESSORIES

Spare Bow Mount Base Kit only - Aluminum

Dimensions: 4" x 6"

- KPBQCKA Clear Anodized
- KPBQCKB Black Powder Coat
- KPBQCKC Camo



Spare Pole Clips

Securely mount a 2-piece pole in a convenient location.

- KPPC Rubber Pole Clip



2-Piece Anchor Poles

5" SETBACK

- KPP802W 8', White
- KPP802B 8', Black
- KPP802C 8', Camo
- KPP100W 10', White
- KPP100B 10', Black
- KPP120W 12', White
- KPP120B 12', Black

1-Piece Anchor Poles

- KPP801W 8', White
- KPP801B 8', Black



Panther's Full Line of Ultimate Skieg Protection & Repair



BEFORE



AFTER



The Ultimate Stainless Steel Skieg Protection

Whether you're looking to protect your new skieg, repair your damaged one, or just add some shine, the 316 marine-grade, stainless steel construction Safe-Skeg is brilliantly polished and ready to install.

KITS INCLUDE: Mounting hardware, instructions, Allen wrench and Loctite 262

Motor	HP / Description	Stroke	Year Range	MarineTech Part #
Evinrude/Johnson Outboard	150-175-185-200-225	2	1986-2003	35-SS630
Evinrude/Johnson Outboard	150 DBX & DPL (E-TEC)	2	2004-Present	35-SS630
Evinrude/Johnson Outboard	225-250 DCX, DCZ, DPX (E-TEC)	2	2004-Present	35-SS630
Evinrude/Johnson Outboard	175-200 DPL, DSL Blue (E-TEC)	2	2004-Present	35-SS630
Evinrude/Johnson Outboard	90-100-115-120-140	2	1980-2001	35-SS635
Evinrude/Johnson Outboard	60-70	2	1984-2002	35-SS640
Evinrude/Johnson Outboard	40-50 & 60 (E-TEC)	2	1984-2013	35-SS640
Evinrude/Johnson Outboard	150-175-200 DCX & DPX (E-TEC)	2	2004-Present	35-SS670
Evinrude/Johnson Outboard	225-250 DPL Blue (E-TEC)	2	2004-Present	35-SS670
Evinrude/Johnson Outboard	75 & 90 (E-TEC)	2	2002-2008	35-SS675
Evinrude/Johnson Outboard	100-115	2	2003-2005	35-SS675
Evinrude/Johnson Outboard	115 HP, DBX, DCX, DPX (E-TEC)	2	2006-2008	35-SS675
Evinrude/Johnson Outboard	60-70-90-115-140 (by Suzuki)	4	1999-2003	35-SS680
Evinrude/Johnson Outboard	40-50 (by Suzuki)	4	1999-2003	35-SS710
Force Outboard	70-90 (by Mercury)	2	1998-2002	35-SS625
Force Outboard	70-75	2	1991-1997	35-SS650
Honda Outboard	75-90-115	4	1995-2007	35-SS625
Honda Outboard	35-40-45-50-90	4	1991-Present	35-SS650
Honda Outboard	135-150-200-225	4	2004-Present	35-SS685
Honda Outboard	115	4	2010-Present	35-SS685

Motor	HP / Description	Stroke	Year Range	MarineTech Part #
MerCruiser Inboard/Outboard	Pre Alpha #1 Drives		1973-1984	35-SS600
MerCruiser Inboard/Outboard	Alpha 1 Drives		1985-1990	35-SS605
MerCruiser Inboard/Outboard	Alpha 1 Generation II Drives		1991-Present	35-SS610
MerCruiser Inboard/Outboard	Bravo 1 & 3 Drives		1990-Present	35-SS615
Mercury/Mariner Outboard	135-150-175-200 Optimax	2 & 4	1978-2011	35-SS620
Mercury/Mariner Outboard	225	2	1978-1995	35-SS620
Mercury/Mariner Outboard	50-60 (Big Foot)	2 & 4	2003-Present	35-SS625
Mercury/Mariner Outboard	70-75-80	2 & 4	1984-Present	35-SS625
Mercury/Mariner Outboard	70-90-100-115-125 Optimax	2 & 4	1983-Present	35-SS625
Mercury/Mariner Outboard	40-50-60	2	1986-2002	35-SS650
Mercury/Mariner Outboard	200-225 Optimax	2	1996-2004	35-SS660
Mercury/Mariner Outboard	225-250-275-300 Verado	4	2005-Present	35-SS660
Mercury/Mariner Outboard	40-50-60	2 & 4	2003-Present	35-SS710
Mercury Outboard	90-115 Optimax	4	2012-Present	35-SS620
Mercury Outboard	Verado & Optimax 150-300	4	2012-Present	35-SS715
Nissan Outboard	70-90-115-120-140	2	1993-2010	35-SS625
Nissan Outboard	35-40-50	2	1993-2010	35-SS650
OMC Inboard/Outboard	Cobra V6 & V8 Cylinder Drives		1986-1994	35-SS630
OMC Inboard/Outboard	Cobra 4 Cylinder Drives		1986-1994	35-SS635
Suzuki Outboard	300	4	2009-2011	35-SS630
Suzuki Outboard	150-175-200-225	2	1986-2002	35-SS645
Suzuki Outboard	150-175-200-225	4	2003-Present	35-SS645
Suzuki Outboard	250SS & 300	4	2006-2011	35-SS645
Suzuki Outboard	40-50-60-70	4	2003-Present	35-SS650
Suzuki Outboard	90-115-140	4	2003-Present	35-SS680
Tohatsu Outboard	70-90-115-120-140	2	1993-Present	35-SS625
Tohatsu Outboard	35-40-50	2	1993-Present	35-SS650
Volvo Penta Inboard/Outboard	DP Drives (Dual Prop)		1996-2007	35-SS655
Volvo Penta Inboard/Outboard	SX Drives (Single Prop)		2007-Present	35-SS655
Volvo Penta Inboard/Outboard	SX Drives (Single Prop)		1995-2006	35-SS665
Yamaha Outboard	60-70-80-90-100	2 & 4	1998-2001	35-SS625
Yamaha Outboard	115-130	2	1984-2002	35-SS645
Yamaha Outboard	150	2 & 4	1984-Present	35-SS645
Yamaha Outboard	175-200-225-250	2	1984-2002	35-SS645
Yamaha Outboard	350	4	2009-Present	35-SS645
Yamaha Inboard/Outboard	3.0 L thru 5.7 L		1989-1993	35-SS645
Yamaha Outboard	40-48 & 50-85CV	2	1984-2000	35-SS650
Yamaha Outboard	115-130	2	2003-Present	35-SS690
Yamaha Outboard	115-130	4	2000-Present	35-SS690
Yamaha Outboard	200-225-250-300	2 & 4	2003-Present	35-SS695
Yamaha Outboard	60-70-80-90-100	2 & 4	2002-Present	35-SS700
Yamaha Outboard	40-50	2 & 4	2001-2011	35-SS705
Yamaha Outboard	V Max SHO 200-225-250	4	2013-Present	35-SS720
Replacement Bolt Kit				35-SSKIT1

Motors must be removed from the bracket before trailering.

Safety Cables (55-0415) and Lift Assist Springs included in all motor brackets.



Adjustable 55-0410

Max. HP 35 HP 4-stroke
 Max. Motor Weight 263 lbs.
 Material Aluminum
 Travel 10"
 Adjustment Positions 5
 Setback Up 8.75"/Down 14"
 Meets ABYC standards



Adjustable 55-0407AL

Max. HP 20 HP 2-stroke/15 HP 4-stroke
 Max. Motor Weight 132 lbs.
 Material Aluminum
 Travel 10"
 Adjustment Positions 5
 Setback Up 8.75"/Down 14"
 Meets ABYC standards



Adjustable 55-0416

Max. HP 35 HP 4-stroke
 Max. Motor Weight 263 lbs.
 Material Aluminum
 Travel 16"
 Adjustment Positions 4
 Setback Up 9.5"/Down 18.5"
 Meets ABYC standards



Adjustable 55-0408SS

Max. HP 20 HP 2-stroke/15 HP 4-stroke
 Max. Motor Weight 132 lbs.
 Material Stainless Steel
 Travel 11"
 Adjustment Positions 4
 Setback Up 8.75"/Down 14"
 Meets ABYC standards



Adjustable 55-0012

Max. HP 12 HP 2-stroke
 Max. Motor Weight 85 lbs.
 Material Aluminum
 Travel 14"
 Adjustment Positions 5
 Setback Up 7.75"/Down 14.5"



Adjustable 55-0021

Max. HP 20 HP 2-stroke/9.9 HP 4-stroke
 Max. Motor Weight 115 lbs.
 Material Aluminum
 Travel 11"
 Adjustment Positions 5
 Setback Up 6.75"/Down 12"



Adjustable 55-0010

Max. HP 20 HP 2-stroke/15 HP 4-stroke
 Max. Motor Weight 132 lbs.
 Material Stainless Steel
 Travel 11"
 Adjustment Positions 4
 Setback Up 8.75"/Down 14"

SS Outboard Safety Cable 55-0415

Braided, stainless steel cable, plastic coated for protection. Use with all outboard motor brackets to secure the motor to your boat.



Motors must be removed from the bracket before trailering.

Swim Platform Outboard Motor Bracket

55-0030

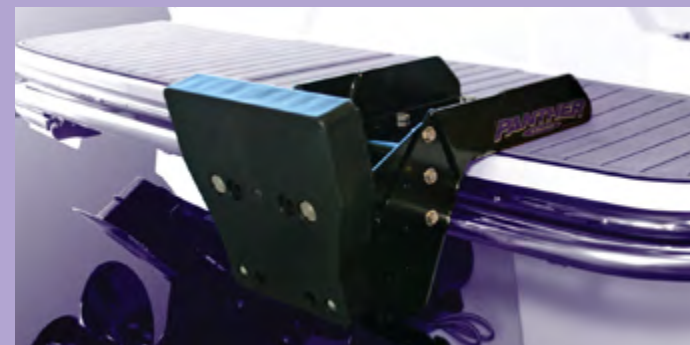

Adjustable outboard motor bracket designed to mount on most swim platforms. Rated for 2- and 4-stroke motors up to 20 HP, 195 lbs. max. Constructed of black powder-coated aluminum and can be adjusted to fit most platform heights and motor shaft lengths for optimal prop depth and performance. Meets ABYC Standards. Comes complete with transom support bar for weight support and torque resistance. (Do not use without Panther 55-0415 Safety Cable—included.)

NEW for 2019! Pontoon Kicker Motor Bracket Kit

55-0065



Our Pontoon Kicker Motor Bracket Kit makes what has long been a difficult installation a breeze. The kit contains the new Adapter Bracket (55-0060) plus the new Swim Platform Bracket (55-0030) with all mounting hardware included. The Adapter Bracket mounts to the pontoon frame rails. Pontoon boats become more popular every year, and we receive many requests for a solution to mount a kicker motor for trolling or backup. Rated for auxiliary motors up to 20 HP.

55-0060 Adapter Bracket

Fixed-Mount Outboard Motor Brackets

55-0028, 55-0024



Vertical, fixed-mount outboard motor bracket. Constructed of stainless steel with heavy-duty polypropylene mounting board. Includes stainless steel mounting hardware and safety cable. (Do not use without Panther safety cable 55-0415 - included.)

55-0028 4-stroke, 35 HP, 263 lbs. max. (safety cable included)

55-0024 2-stroke, 12 HP, 85 lbs. max. (recommend using safety cable—NOT included)

Pro-Strap Kicker Tie Down

55-1500



The Panther Pro-Strap provides hands-free, heavy-duty retention for the Model 35. Use to prevent motor bounce.

Motors must be removed from the bracket before trailering.

3/8" and 2" Set-Back 5-Degree Reversible Plate

55-0420



The reversible wedge plate provides 5 degrees of trim or tuck. Its one-piece, cast-aluminum design provides a stable platform for the largest of today's outboards. Standard BIA bolt pattern when used in either the tuck or trim position.

2" Set-Back Static Auxiliary Motor Mount Plate

55-0405



For mounting auxiliary or kicker motors only. This rugged cast-aluminum plate offers a sturdy and flat mounting area for your kicker motor clamps. When direct-to-transom motor mounting is difficult, our Static Motor Mount Plate provides a flat secure mounting surface for clamp-on or bolt-on kicker motors. Rated for 2- or 4-stroke motors up to 35 HP with a max. weight of 263 lbs. Meets ABYC Standards. Not for main motor applications.

2" Set-Back Plate

55-0220



This cast-aluminum spacer provides 2" of set-back for bolt-on motors, allowing performance seekers to fine tune their boats. Dipped in zinc-rich primer and powder coated, this solid spacer installs directly to the transom, or adds additional set-back to an existing Jack Plate. A standard BIA hole pattern makes mounting a snap but is drillable for non-standard patterns.

4" Set-Back Plate

55-0240



A flared shape allows this set-back bracket more transom contact area to reduce stress and improve the motor's stability. The two piece, T-6 heat-treated, hard-coated, anodized aluminum bracket will work with the most powerful main engines. An inexpensive solution to lagging performance while maintaining maximum durability. Pre-drilled hole patterns allow for an extensive range of motor installations. Rated for marine engines up to 750 HP and 1,500 lb. engine weight.

8" Set-Back Bracket

55-0027



The fixed kicker motor bracket is designed for adjustable mount on the transom. Designed for the heavier 4-stroke motors. 5" height adjustment will accommodate long- and short-shaft motors.

PRO SERIES HEAVY-DUTY FLUID EXTRACTORS

Heavy-duty construction and larger-volume capacities make these extractors perfect for shop use or for the mobile service professional. Newly designed decompression valve to release negative pressure. See-through container for quick visual reference. Convenient foot board for added stability while in operation. Pour spout for no-mess fluid disposal. Suitable for engine oil, gear lube, brake fluid, coolant, water, etc.

NOTE: NOT FOR USE WITH FLAMMABLE OR CORROSIVE PRODUCTS.



75-6015P Oil Extractor

15 Liter Pneumatic or Manual Pro Series Oil Extractor

Conveniently attaches to pneumatic compressor or can be operated manually. 1/4" air inlet and 40-170 PSI working range. Complete with air-inlet control valve, negative pressure quick-exhaust valve, and fluid-draining pressure balancer. High capacity accommodates larger 4-stroke engines. Check valve for easy release of displaced air in container. Extra-long 48" hoses with fittings included for almost any extraction application.

75-6015 15 Liter Pro Series Manual Oil Extractor

Same as above without pneumatic (manual only—not pictured).



75-60V Pro Series In-line Valve

In-line charging valve for the Panther 75-6015P, Pneumatic/Manual Pro Series Oil Extractor. Allows the user to hold vacuum in receptacle for extraction without constant connection to air compressor. Brass valve installs directly in the extraction tube.



75-6065 Oil Extractor

6.5 Liter Pro Series Manual Oil Extractor

Mid-size container for smaller jobs and tighter areas. Extra-long 48" hoses with fittings included for almost any extraction application.

75-6099 Pro Series Replacement Hose Kit

Use with 75-6015, 75-6015P and 75-6065 (not pictured)

DIY SERIES OIL EXTRACTORS

These compact, powerful pumps make oil changes fast, efficient and cleaner than you ever thought possible. They take less than 10 seconds to prime and have see-through calibrated containers for quick visual reference of oil level. Non-kinking, flexible metallic extractor tubes.

NOTE: NOT FOR USE WITH FLAMMABLE PRODUCTS.



75-6060

Large, 6-liter capacity to meet the needs of most boaters.

75-6025

A downsized, 2.5-liter version of the 75-6060 that's perfect for 4-strokes up to 50 HP and sailboats with small engines.

75-6060

Integral Trim & Tilt

55-0025



The Panther Integral Trim and Tilt is designed for use with Johnson and Evinrude, 20 to 35 HP 2-stroke, 2 cylinder only, outboard motors, made between 1976 and 2004 with thru-hub exhaust. Made to provide trim and tilt features on motors that don't have factory trim and tilt. In a matter of minutes the Panther Integral Trim and Tilt fastens directly to your existing motor bracket without modification. Offers a break-away safety feature that releases the motor if you strike a log or any underwater stationary object.



12 volt power-driven actuator includes 12' of cable with a push-button up/down switch.

Model 35 Trim & Tilt

55-0035



This heavy-duty bracket easily handles auxiliary outboards up to 35 HP or 150 lbs. Kicker motors are supported in any position with this durable design. In addition to its ruggedness, the Model 35 is the only kicker motor lift with a convertible setback. The unit can be adjusted from 8" to 13" of setback, making it ideal for inboards, I/O's, jet-drives and outboards when over-the-transom mounting is unavailable. 3" setback bracket (55-9035) also available for boats that need 16" of clearance.

12 volt power-driven actuator includes 12' of cable with a push-button up/down switch.

Model 40 Trim & Tilt

55-0040



This trim and tilt is designed specifically for the weekend fisherman. The Model 40 is a heavy-duty, fabricated aluminum bracket. Holds 2- and 4-stroke motors up to 150 lbs. Its powerful electromechanical actuator provides automatic trim and tilt with the push of a button. Bracket comes with electrical relay and 2-button switch (12' cord). 7" setback.

12 volt power-driven actuator includes 12' of cable with a push-button up/down switch.

Model 435 Fixed Bracket

55-0435



This fixed motor bracket is designed for those who prefer to use their own strength to lift up their motors. It comes with the adjustable 13" setback feature and is made of 713-alloy aluminum. If lifting your motor becomes a strain, this bracket can be converted to a power lift by adding our 12 volt actuator (99-55005).

Model 55 Trim & Tilt

55-0055



The compact trim and tilt Model 55 conveniently matches outboards from 15 to 55 HP, weighing up to 250 lbs. Perfectly designed for pontoons, fishing or pleasure boats. Adapts to clamp-on or bolt-through outboards. Standard BIA bolt pattern made of heavy-duty 713 cast aluminum. 7" setback.

12 volt power-driven actuator includes 12' of cable with a push-button up/down switch.

Model 135 Trim & Tilt

55-0135



The Model 135 is the perfect option for older outboard motors with bad hydraulic trim and tilts, when repair costs are prohibitively expensive. The heavy-duty bracket is designed for outboards up to 135 HP or 350 lbs. It maximizes lifting power (even greater than the outboards tilt range) and also allows for increased tuck-under to get heavy boats on plane quickly. 7" setback.

12 volt power-driven actuator includes 12' of cable with a push-button up/down switch.

Model 45 Auxiliary Motor Lift

55-0045A



ENHANCED DESIGN

Quickly and easily deploy your kicker motor by flipping a switch with the Model 45A Motor Lift. Improvements for 2019 for this already impressive motor lift allow for 20% faster travel from fully raised to deployed position. With 15.5" of vertical lift, the Model 45A is perfect for boats where a clamp-on kicker motor will be mounted to a tall transom. Rugged construction features 1/4" thick fabricated aluminum plates, heavy-duty black powder-coat paint, and stainless steel hardware. This 12 volt Electro/Hydraulic system includes all wiring (25'), relays and a dash-mounted rocker switch.

Motor Mount Bolt Bar

55-9100



The Motor Mount Bolt Bar will supply the added support for your transom when mounting your main or auxiliary motors. Made from heavy-duty 713 cast aluminum, this bolt bar is chromate dipped and black powder coated for years of like-new-looking support. Uses standard BIA bolt pattern.

Dimensions: 15" x 2.12" x 1/2"
C-C: 12-7/8"

Engine Mounting Washers

55-9150

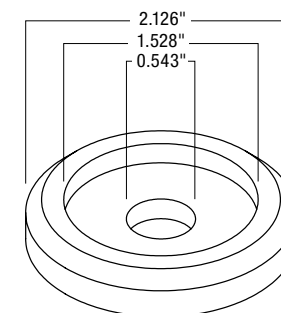

Panther Engine Mount Washers are designed to support outboard engines with transom mount bolts. Perfect for OEM or after-market use. Constructed of heat-treated, hard-coated, anodized aluminum. Sold in pairs.

Sport/Dive Ladders



**Stainless Steel
3-Step 25-0001**

Overall height: 33.8"

- Both rated at 400 lbs. load capacity
- 1.75" electropolished stainless tubing
- Wrap-around PVC tread provides maximum foot comfort
- Includes mounting bracket (25-0004) with locking tab for positive lock and quick release for trouble-free stowage
- Step width: 14"
- Meets ABYC standards

**Stainless Steel
4-Step 25-0002**

Overall height: 44.5"

Over-Platform Telescoping Ladders



SPECIAL ORDER ONLY

**Stainless Steel
3-Step 25-0007**

- Length deployed: 34.5"
- Length stowed: 14.5"
- Height stowed: 1.8"
- Overall width: 11.8"
- Centerline width: 10"
- Weight: 6 lbs.
- Meets ABYC standards

**Stainless Steel
4-Step 25-0008**

- Length deployed: 45.5"
- Length stowed: 15.5"
- Height stowed: 2"
- Overall width: 12.5"
- Centerline width: 10"
- Weight: 9 lbs.
- Meets ABYC standards

Deck-Mount Folding Ladder

25-0070



Stainless Steel 5-Step

- 1-1/4" diameter
- Corrosion-resistant stainless steel tubing
- Integrated, large-radius handles provide solid support while climbing
- Wide plastic steps for safe and comfortable climbing
- Mounts directly to pontoon deck and includes ladder support against pontoon or side of boat
- Overall height: 60"
- Meets ABYC standards

Under-Platform Telescoping Ladder

25-0014



**Stainless Steel
3-Step**

- Length deployed: 37.8"
- Length stowed: 18.9"
- Height stowed: 6"
- Overall width: 12.52"
- Centerline width: 10"
- Weight: 7.5 lbs.
- Meets ABYC standards

Removable, Aluminum Folding Pontoon Ladder

25-0003



4-Step

- Length deployed: 42.5"
- Length stowed: 30.18"
- Height stowed: 4"
- Overall width: 15.88"
- Centerline width: 13.38"
- Weight: 6 lbs.
- Meets ABYC standards

PONTOON ACCESSORIES

Gate Hinge



Unique sound-dampening washers built in to minimize noise, rattle and wear. For use with pontoon gates that lift up and out of the door stop. 2.75" H x 2.5" W x .41" D

25-0203A Port (shown) 25-0204A Starboard

Gate Anti-Pinch

25-0208



Protect your fingers from pinching in your pontoon gate. Installs easily between the gate and the rail. Mounts to both the rail and gate. Fits 1-1/4" rails.

Grab Handle

25-0212, 25-0225



Make navigating stairs and decks safer with these stainless steel grab handles. Mounting nuts not included.

Overall length: 12" & 8"

Handle diameter: 7/8"

Stud length: .94"

Stud diameter: 5/16"

Stud center to center: 11-15/16" & 7-5/8"

25-0212 12" Grab Handle

25-0225 8" Grab Handle

Doorstop



Secure your pontoon gate from rattling during operation with this molded door stop. Simple installation with one screw (not included). Use on portside gates. Fits 1-1/4" rails.

1.875" H x 1.688" W x 1.53" D

25-0206 Port (shown) 25-0207 Starboard

Gate Support



Strengthen your pontoon's rail system with these aluminum supports. This design helps support the rails at any point along the fencing, where needed. Mounting hardware not included.

9.625" H x 3.875" W x 1.125" D

25-0210 Left Gate Support (shown)

25-0211 Right Gate Support

6" Cleat

25-0217



Heavy-duty, through-deck, stud-mount design. Zamak construction. Hardware included.

Overall length: 6" with a 1" rise off the deck

Stud length: 1.625"

Stud diameter: 5/16"

Stud center to center: 2.25"

HEAVY-DUTY OARLOCKS, SOCKETS & SOCKET BUSHINGS

Wynn™ Heavy-Duty Oarlocks



Wynn Heavy-Duty Oarlocks are the original clamp-on style. Made with heavy-gauge steel, hardened bushings and unique U-bracket construction. They provide unsurpassed strength and reliability. Easy to install, no drilling and adjustable. To fit oars 1-3/8" to 1 5/8" in diameter. Sold as a pair.

85-G807MAR 1/2" Post

85-G808MAR 9/16" Post

Nylon Socket Bushings

85-G814MAR



Nylon Socket Bushings make rowing easier and quieter by minimizing the resistance of metal-on-metal friction. Panther bushings convert 5/8" oarlock sockets to 1/2".

5/8"-1/2"

HAPPY HOOKER MOORING AIDS

Makes picking up moorings a snap. This unique product allows the user to easily pass a rope, mooring line, dock line or cable through an eye hook, ring, bow eye or mooring buoy eye and retrieve, all in one simple motion. Easily fastens to most any type of extension pole with a bolt or hose clamp. (Pole not included.)

Stainless Steel

85-B203STN



This larger, heavy-duty, stainless steel model can secure rope to a 4" max. structure diameter. Support pole diameter: 1.12"

Glass Reinforced Plastic

85-B203MAR



This recreational, light-use model can secure rope to a 2" max. structure diameter. Support pole diameter: 1"

Flush Buddy

75-5000



Easy-to-use inboard motor flusher. Great for winterizing, maintenance or any time you need to run your inboard engine while out of the water. Just connect the garden hose, fit the cup over the water intake, and extend the leg sealing cup to the hull. Constructed of aluminum and heavy-duty rubber. Conveniently adjustable from 19" to 30-1/4".



Adjustable Motor Support

55-2100



The Adjustable Motor Support has a universal design and comes with both the bolt-on bracket and the over-the-roller bracket. Adjustable from 34" to 46" and comes with two rubber straps.

Adjustable Transom Saver

55-1900



This Transom Saver adjusts from 28" to 59" to reach hard-to-access trailer crossbars that extend under the boat. Comes with an easy-to-install bracket attachment. Fits most popular brands of trailers and is easily removed for loading and unloading.

Digital Battery Gauge

55-6500



The Panther Digital Battery Gauge allows you to determine the exact amount of charge remaining in your batteries. Perfect for any boating, automotive or industrial use and can be used with all standard and deep-cycle 12 volt lead-acid batteries. LED display meets MIL specifications for heat and vibration resistance.

Outboard Stabilizer Clips

55-2190



Fits most cylinder rods on engines manufactured in 1997 and newer. Snaps over outboard's hydraulic steering and cylinder rods. Helps keep engine centered during transport. (2 per package.)

4" long, 3/4" ID

Water Spike Anchor

55-9200, 55-9300, 55-9400

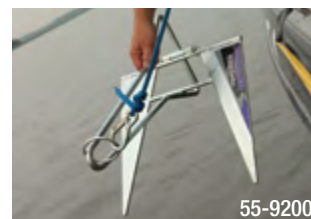

Made of 1/4" plated steel. Unmatched holding power. Completely collapsible for compact storage and incredibly lightweight.

- 55-9200 Up to 16' boat - 7 lbs.
- 55-9300 Up to 22' boat - 10 lbs.
- 55-9400 Up to 35' boat - 13 lbs.

Shore Spike

55-9500, 55-9525, 55-9600



Quickly anchor your boat or personal watercraft in shoreline materials including sand, clay or firm soil. Securely holds boats up to 26'. Dimensions: 1/2" x 4" x 36"

- 55-9500 Zinc Plated Carbon Steel
- 55-9525 Same as 9500 with rope
- 55-9600 304 Solid Stainless Steel

Panther Anchor Rope

75-7000, 75-7010



Panther anchor rope is manufactured with the outdoorsman in mind. Made from heavy-duty 3/8" blue polypropylene, it has an amazing tensile strength of 2,800 lbs. Comes packaged with a no-tie rope cleat and snap hook. Available in both 50' and 100' lengths.

- 75-7000 50'
- 75-7010 100'

85-G843MAR Quick boat snap 3/8" plated steel. Fits 1/2" rope. 1,300 lbs. break strength.

Panther Portable Rope Cutter

75-7060B



Panther's Portable Rope Cutting Gun is ideal for boat, camper and home use. Lightweight (1.5 lbs.), the handle fits in the palm of your hand with easy finger-pull operation. It makes quick, clean cuts in all types of synthetic ropes, lines and strapping. Comes with a generous 4' cord. Operates on 120 volt AC power. Replacement blades available. Dimensions: 6" H X 6" L X 2" D

Replacement Blades 75-7061

The Original Gripper Rope Cleat



A no tie, no-knot, rope cleat that will secure any rope or line up to 3/8" diameter (55-8300 and 55-8500 will secure 1/2" rope) with no knots. Just what you needed for a variety of purposes ranging from boats and docks to trucks and trailers. Secures just about any object up to 200 lbs. with no knots. Also available in camo.

Black Nylon 2-Pack
55-8100 3" 2-Pack
Camo Nylon 2-Pack
C55-8100 3" 2-Pack

Die Cast Zinc Plated
55-8400 3" 2-Pack
55-8500 4" 2-Pack (special order)

Die Cast Chrome Plated
55-8200 3" 2-Pack
55-8300 4" 2-Pack (special order)

Lowrance Elite Means Strength & Versatility

Because quality rods, reels, sonar, chart plotters, GPS units, and trolling motors have all become vital tools for the serious angler, we've created a full line of products that give the boater and angler a consistent advantage—while protecting your investment.



Lowrance Elite & Mark Series Quick-Mount

AP-507



The AP-507 utilizes the versatility of the Angler's Pal nylon composite electronics mount (AP-MT4NYL) coupled with the AP-505 Lowrance quick-connect adapter which provides the user with an easy, quick connection for Lowrance Elite and Mark series electronics. Just snap into place for viewing at almost any angle. With just a press of the release button, the unit can be removed and stored for security.

4" Quick-Release Mount

AP-509



The AP-509 couples the AP-MT4NYL 4" nylon composite mount with the NEW AP-500 Quick-Release Mount. Now you can quickly and effortlessly remove expensive electronics from the boat for safe storage. With just a push of the stainless steel plunger pin and a quick twist, your unit is protected. Constructed of corrosion resistant, lightweight and durable materials that will stand up to fresh or saltwater environments.

- Stainless steel mounting hardware included
- Not recommended for use with electronics weighing over 5 lbs.

Lowrance Elite & Mark Series Quick-Connect

AP-505



Designed to work with Angler's Pal mounts, this adapter allows the user to quickly connect a Lowrance Elite or Mark Series Sounder/GPS to an Angler's Pal mount. Just replace the universal mount plate that was provided with the original AP mount with the new AP-505 adapter and attach the unit. When ready for storage, just press and lift to remove your electronics from the mount. Fits Lowrance and Mark series units.

Quick-Release

AP-500



The Angler's Pal quick release allows the user to quickly and effortlessly remove expensive electronics from the boat for safe storage. With just a push of the plunger pin and a quick twist, the unit is protected. Only for use with Angler's Pal electronics mounts. Constructed of corrosion-resistant, fiberglass-reinforced polypropylene and stainless steel, the quick-release is lightweight and suitable for fresh or saltwater environments.

- 3-3/4" D x 15/16" H
- Stainless steel mounting hardware included
- Not recommended for use with electronics weighing over 5 lbs.
- For use with Angler's Pal electronics mounts only

MOUNTING PLATES



AP-12001
Universal Mount Plate, anodized aluminum
(6-7/16" x 2-1/2")



AP-12001NYL
Universal Mount Plate, nylon
(6-7/16" x 2-1/2")



AP-12006
TROLLMaster, nylon for AP-MT4NYL
(4" x 2-1/2")



AP-12003NYL
Humminbird/Lowrance, nylon
(4-1/2" x 4-1/2")

Rod Holders

Angler's Pal 700 and 800 Series Rod Holders now feature new 25-degree and 45-degree, Posi-Lock anti-slip notches for the big fish experience. These models are corrosion resistant, making them ideal for fresh and saltwater use. Constructed of precision-machined, hard-anodized aluminum and stainless steel. They have a unique, 360-degree full hemisphere of positive locking positions and can be easily adjusted and locked into the exact position for optimum fishing performance. The rod holders can quickly be removed from the base mount for storage. Available in a variety of sizes.

AP-800A , CAP-800A

Stainless steel tube with black anodized aluminum or camo wrap, 10" deep tube socket, 1-3/4" diameter.



AP-700A, CAP-700A

Stainless steel tube with black anodized aluminum or camo wrap, 7-3/4" deep tube socket, 1-3/4" diameter.



AP-100

Chrome-plated steel tube, 6" deep tube socket, 1-3/8" diameter.



Rail Mount Kit

AP-RM1



Designed to work with all Angler's Pal mounts and rod holders (excluding the AP-MT4NYL). Side-mount adapter included for vertical or horizontal applications such as gunnels and transoms. Constructed of high-impact-resistant material with stainless steel hardware included. Fits round and square rails.

Round: 7/8", 1", 1-1/8"
Square: 1"

Spare Base Plates, 2-3/4"

AP-13003, AP-50003, AP-50003NYL



AP-50003

AP-13003 Chrome-plated steel (for AP-100)
AP-50003 Anodized aluminum (for all mounts excluding AP-100)
AP-50003NYL Nylon composite

Multi-Mounts

Angler's Pal Multi-Mounts offer the strength and flexibility to mount your sonar/GPS and chart-plotting equipment anywhere in the boat for easy reading. Specifically designed to eliminate drift with unmatched stability to firmly support the heaviest electronic equipment. This holding power is achieved with the patented Universal Ball Locking Device making them virtually vibration free. These models give you a 360-degree full hemisphere of possible positions whether mounting on the deck, gunnel, console or rail (Panther Universal Rail Mount Kit available). Made of corrosion-resistant stainless steel and hard-anodized aluminum for fresh and saltwater use. Easily removed for security or storage. Available in stainless steel or camo wrap.

Trolling Motor Mounts

CAP-MM10, AP-MM14



CAP-MM10

AP-MM14

Angler's Pal Trolling Motor Mount features a unique rubber lock-down strap that keeps your trolling motor from moving when cruising across the lake or traveling down the road. Made of corrosion-resistant stainless steel and hard-anodized aluminum for fresh and saltwater use. Protect your trolling motor from excessive vibration that can cause damage to the trolling motor shaft.

CAP-MM10 Overall length: 10" (9" deck to center of grip)

AP-MM14 Overall length: 17" (16" deck to center of grip)

MT4 Multi-Mounts

AP-MT4, AP-50003



AP-MT4 Our lowest-profile model at only 2-3/4" to 4" off the mount surface, allowing you to mount your electronics in the tightest spots.
AP-50003 Base Plate only (anodized aluminum)

Other Multi-Mount Models



AP-MT14

CAP-MT10

Rated for fishfinders of all sizes.

CAP-MT8 Overall length: 8"

CAP-MT10 Overall length: 10"

AP-MT14 Overall length: 14-5/8"

AP-MT17 Overall length: 17"

Conversion Kit

AP-40005KIT



Designed to convert the electronics multi-mounts to a trolling motor mount. Converts these multi-mounts:

AP-MT4
AP-MT14
AP-MT17

TROLLMaster Mount

AP-TM



Designed to mount any wired TROLLMaster remote control for convenient viewing at almost any angle. TROLLMaster Remote Control sold separately.

UPGRADE YOUR FISHING EXPERIENCE

Securely fasten electronic units and start catching fish! Designed to work with all major electronics brands, Panther Electronics Mounts instantly elevate each outing by providing additional deck space and allowing you to comfortably operate the foot pedal.

Fits any full-sized fishfinders and sonar/GPS units for both tournament pros and weekend anglers.

Angled Deck Mount Electronics Bracket 95-4200



Securely mount fishfinders and sonar/GPS up to 16" on most casting decks. Designed to mount over recessed trolling motor foot-control pedals to more freely operate the pedal and free up deck space for rod butts. Features a 22.5° angled plate. Best suited for decks with less space forward of the foot pedal, allowing more aft foot clearance over the pedal. Fits most major electronics brands. Spans most recessed foot pedals. Powder-coated, marine-grade aluminum construction. Inside span: 14.1"



Flat Deck Mount Electronics Bracket 95-4400



Securely mount fishfinders and sonar/GPS up to 16" on most casting decks. Designed to mount over recessed trolling motor foot-control pedals to more freely operate the pedal and free up deck space for rod butts. Fits most major electronics brands. Spans most recessed foot pedals. Powder-coated, marine-grade aluminum construction. Inside span: 14.1"



Dash Mount Electronics Bracket 95-4000



Securely mount most brands of electronic units up to 12" to most flat-console dash panels. Created to give the angler better visibility and adjustment flexibility over flush-mounted electronics. Powder-coated, marine-grade aluminum construction. Overall length: 10.6"



Rod Holders 95-0700, 95-0800



360-degree full hemisphere of positive locking positions can be easily adjusted and locked into the exact position for optimum fishing performance. Precision-machined, hard-anodized aluminum and black stainless steel tube construction. Ideal for fresh and saltwater use.



FISH IN COMFORT & STREAMLINE YOUR DECK

Reduce back and foot pain and fish all day with the Panther Recessed Foot-Control Tray. The tray mounts flush to your boat and levels out the foot pedal while you fish. This unit adds a clean look to your deck and easily fits all Minn Kota and MotorGuide foot-control trolling motors.



- Forward taper design makes foot pedal level and drains water faster
- Water flows through a 3/8" ID x 8' flexible vinyl tube
- Constructed of high-impact, UV-resistant, high-density polyethylene
- Color-molded throughout
- No paint to chip or fade
- Installs easily in any brand of boat
- Includes installation instructions, cutting template, drain tube and hardware
- Fits all Minn Kota and MotorGuide foot-control trolling motors
- Inside Dimensions: 9-1/2" W x 13-1/2" L x 4-1/2" D

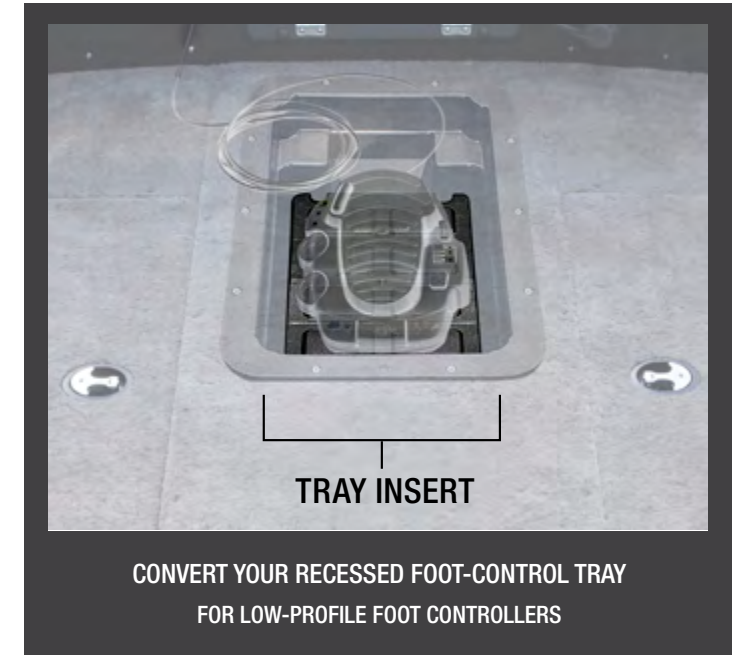

- 55-9815 Foot Tray
- 55-9825 Foot Tray Insert
- 55-9800 Foot Tray with Insert

MULTI / TROLLING / TROLLMASTER MOUNTS

Our NEW ALL-BLACK mounts will give your boat an enhanced and contemporary look.



Quick Guide to TROLLMaster & Panther Kicker Steering & Throttle Control



REMOTE CONTROLLERS



TROLLMaster PRO 3 PLUS
Precise throttle control and optional steering control via wireless remote. AAA batteries included. Motor-specific servo mounting kit sold separately.



TROLLMaster PRO
Precise throttle control via cabled remote. Motor-specific servo mounting kit included.



Panther Wireless Remote
For use with Electro Steer. (Not for use with TROLLMaster)

(PANTHER Electro Steer drive unit required for steering option.)

DRIVE UNITS



Panther 100 Drive Unit
The original Electro Steer. For use with motors without threaded tilt tube or when space doesn't allow use of T-4 or T-5. Mounts on boat, forward of motor.

(TROLLMaster required for throttle control)



Panther T-4 Drive Unit
Mounts directly to threaded tilt tube. **A > 12" / B > 13"** (see diagram)

(TROLLMaster required for throttle control)



Panther T-5 Drive Unit
Mounts directly to threaded tilt tube. Designed for compact applications. **A > 14" / B > 7"** (see diagram)

(TROLLMaster required for throttle control)

TIE BAR KITS

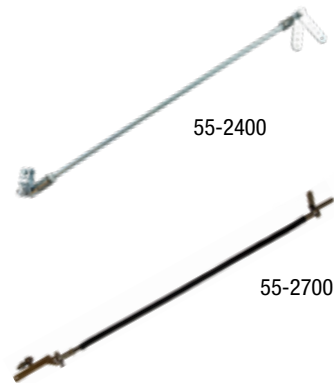

All Panther Electro Steer drive units are the same electronically. Use either the cabled switch (included), the Panther Wireless Remote (55-0105) or the TROLLMaster PRO 3 PLUS wireless remote.

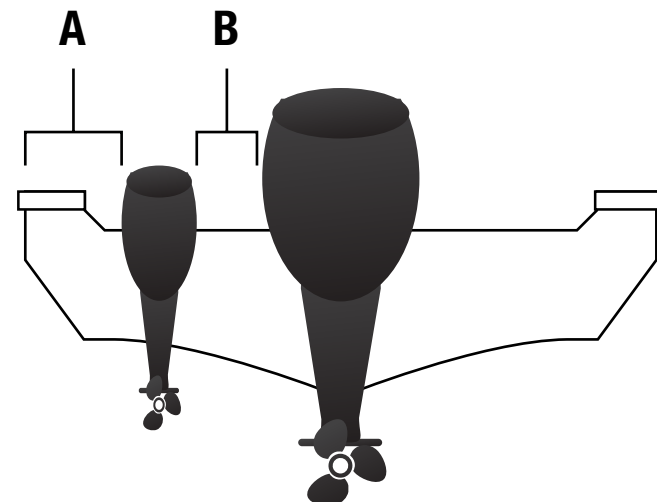

NOTE: All Panther Electrosteers (T-4, T-5, Models 100A and 101A) are the same electronically. They all use the same electric motor and come with the same wiring harness and switch. These units can also be used with a Panther Wireless Remote (55-0105) or a TROLLMaster PRO 3 Plus. If a Panther Electrosteer is going to be used with either of these, the Electrosteer can be ordered as an "NE" or "No Electronics" version at a reduced price.

T5

55-0503



T5 4" between motors PATENTED DESIGN
55-0502 Freshwater
55-0503 Saltwater

T4

55-0102



T4 9" between motors
55-0102 Freshwater
55-0103 Saltwater

Unique solutions to steer a kicker motor. Can be installed on kickers with threaded tilt tube without drilling holes. Installs in minutes and requires only inches between the main motor and auxiliary O/B. 2-button, hand-held remote with 24' cable and mounting hardware included.

Model 100A & Model 101A

55-0100A, 55-0101A



55-0100A

(See optional wireless remote, 55-0105)

It's trolling made easy. Steer your kicker from anywhere in the boat. The Panther 100 Electrosteer is easy to install anywhere in the transom area. Operated with a 24' cable and 2-button, hand-held remote. The Electrosteer will move from full right to left in only 4 seconds with the fast and precise kicker control that's necessary for contour trolling. The connecting rod between the Electro Steer and the kicker easily disconnects, allowing for versatile applications.

55-0100A Freshwater (All component hardware is made of zinc.)

55-0101A Saltwater (All component hardware is made of stainless steel.)

TROLLMaster PRO 3 Plus



All of the Panther Electrosteers come fitted with a two-way switch on a 24' cable, but did you know that they can also be controlled with one of our WIRELESS remotes? There are two choices, either the Panther Wireless Remote Control or our ALL-NEW TROLLMaster PRO 3 Plus (shown). The TROLLMaster PRO 3 Plus will allow the user to not only control steering, but also to adjust the trolling speed in small increments and say goodbye to cumbersome cables. FCC and IC approved.

SEE PAGE 30 FOR MORE INFORMATION ON THE NEW TROLLMASTER PRO 3 PLUS.

Wireless Remote Control

55-0105



50' range. The receiver is operated from a standard 12 volt battery. The transmitter operates from a A23-type battery. Adapted to fit all Panther steering and Trim and Tilt units. Universal use with any 2-prong molded wiring harness. FCC and IC approved. Lanyard included.

Auxiliary Motor Steering Kit

55-2400, 55-2600

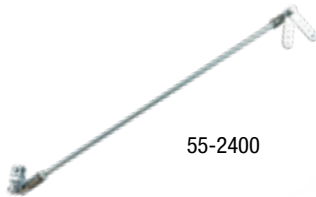

The Auxiliary Motor Steering Kit is the ideal way to connect your main engine to the kicker motor. For use with trolling motors up to 25 HP.

55-2400 Freshwater. Constructed of zinc plated steel.

55-2600 Saltwater. Constructed of marine-grade stainless steel.

Main Engine Trolling Motor Tie Bar Kit

SeaStar™ 55-2700, Uflex™ 55-2900

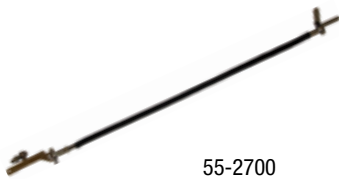

The Panther Trolling Motor Tie Bar Kit connects an auxiliary trolling motor adaptable to SeaStar™ and Uflex™ hydraulic steering. The Trolling Motor Tie Bar is 1/2" thick and, along with the drive bracket, composed entirely of marine-grade stainless steel. Extremely heavy duty. Rod is fully threaded so it can be cut for custom installations.

55-2700 Main Engine Trolling Motor Tie Bar for SeaStar™ Steering

55-2900 Same as 55-2700, fits Uflex™ steering

Drive Bracket, Stainless Steel

SeaStar™ 55-2750



The Panther Drive Bracket is made of marine-grade stainless steel and is the same bracket included with the Panther Model 55-2700 Trolling Motor Tie Bar Kit. The bracket attaches directly to SeaStar™ and can be combined with our Model 55-2400 and 55-2600 for a professional installation. It's never been easier to install a main engine/kicker tie bar kit.

Drive Bracket, Stainless Steel

Uflex™ 55-2950



The Panther Drive Bracket is made of marine-grade stainless steel and is the same bracket included with the Panther Model 55-2900 Trolling Motor Tie Bar Kit. The bracket attaches directly to Uflex™ and can be combined with our Model 55-2400 and 55-2600 for a professional installation. It's never been easier to install a main engine to kicker tie bar kit.