

# ***DIESEL COMPRESSION TEST KIT***

Stock Number W89731

## **OWNER'S MANUAL**



**Performance  
Tool®**

**IMPORTANT SAFETY INSTRUCTIONS,  
READ AND UNDERSTAND ALL INSTRUCTIONS**

Failure to follow all instructions detailed in this manual may result in serious personal injury. **SAVE THESE INSTRUCTIONS**

## PRODUCT SPECIFICATIONS

Pressure Scale:	0-1000psi (0-7000 kPa)
Gauge Accuracy:	+ / - 2 %
Hose Size:	15/64" I.D. x 35/64" O.D. x 16" L
Accessories:	Carrying case, 9 adapter configurations



## WARNING

1. Do not exceed 1000psi maximum pressure.
2. Wear ANSI approved safety goggles and protective wear during setup and use.
3. Use tester in well ventilated areas.
4. Before using, set transmission in park (for automatic transmission) or neutral (for manual transmission) and set parking brake.
5. Keep out of reach of children.
6. Install and remove tester only while engine is stopped.
7. Keep work area clean and well lit.
8. Dress properly. Do not wear loose clothing or jewelry as they can be caught in moving engine parts. Protective clothes and nonskid footwear are recommended when working. Wear restrictive hair covering to contain long hair.
9. Do not overreach. Keep proper footing and balance at all times.
10. Maintain test kit with care. Keep clean for better and safer performance. Inspect hoses periodically, and if damaged, have them repaired by a qualified technician.
11. Stay alert. Watch what you are doing, use common sense. Do not operate when you are tired.
12. Check for damaged parts. Before using, any part that appears damaged should be carefully checked to determine that it will operate properly and perform its intended function. Check for alignment and binding of moving parts; any broken parts or mounting fixtures; and any other condition that may affect proper operation. Any part that is damaged should be properly repaired or replaced by a qualified technician.
13. Do not operate if under the influence of alcohol or drugs. Read warning labels if taking prescription medicine to determine if your judgment or reflexes are impaired while taking drugs. If there is any doubt, do not operate.
14. Do not start an engine in an enclosed area (like a garage). A running gasoline engine generates carbon monoxide; carbon monoxide is a colorless, odorless gas that can cause serious injury and death, if inhaled.
15. Keep hands away from the moving parts and hot parts of vehicle's engine.
16. Read and understand all instructions and safety precautions as outlined in the vehicle manufacturer's manual for air condition servicing.

## INSTRUCTIONS

1. Check that vehicle battery is fully charged. Set car in neutral or park and set parking brake.
2. Refer to adapter chart for correct engine adapter. Secure assemble as shown in diagram.
3. Start engine and allow to warm up to operating temperature.
4. Once engine is warm, shut off engine and remove fuel shutdown solenoid (refer to vehicles repair manual for location).
5. Remove all of the glow plugs or injectors depending on adapter being used. Mark injector wires for ease in reassembly. Label all injectors and glow plugs for reinstallation.
6. Connect compression tester to engine. With accelerator pedal fully depressed, turn engine over for 8 revolutions. **CAUTION: Continuing to crank engine for a longer period of time may result in damage to the starter motor or draining the battery.**
7. Read and record compression number displayed on gauge. Press air release button and remove gauge from engine.
8. Repeat for remaining cylinders.
9. Reinstall injectors or glow plugs and reinstall fuel injection solenoid.
10. Clean tester and store in a cool, dry place out of reach of children.

**Note: A good engine will see a quick jump in initial compression figures on the gauge, with a slow rise to maximum upon the 8th revolution of the motor. A poor engine will see a slow rise in compression and be below specifications in vehicle repair manual. In general, all cylinders should be within 10% from best to worst cylinder.**

## ADAPTERS

Manufacturer	Engine	Type	Thread	Adapter #
Audi®	Early models, see VW® for TDI	Injector	24 x 2.00	C
Mercedes-Benz®	Early models	Injector	24 x 2.00	C
VW®	1970's Rabbit®	Injector	24 x 2.00	C
Volvo®	Early models except 30's & 40's	Injector	24 x 2.00	C
BMW®	2.4L	Glow Plug	12 x 1.25	H <sup>U</sup>
Chevette®/Isuzu®; Luv®/Isuzu®	1.8L, 2.2L	Glow Plug	10 x 1.25	E
Deutz®	Many models	Glow Plug	12 x 1.25	H <sup>U</sup>
Ford®/Mazda®	(1984-87) 2.0L (1983-84) 2.2L Escort®, Lynx®, Ranger®, Tempo®, Topaz®	Glow Plug	10 x 1.25	F
Ford®/Mitsubishi®	(1985-87) Ranger® 2.3L	Glow Plug	10 x 1.25	F
Ford®/Navistar®	6.9L and 7.3L (up to 1994)	Glow Plug	10 x 1.00	A
General Motors®	4.3L V6, 4.3L V8, 5.7L V8	Glow Plug	10 x 1.00	A
	Duramax® 6.6L Turbo Diesel	Glow Plug	10 x 1.25	E
Hummer®	Optimizer 6500® V8 Turbo	Glow Plug	10 x 1.25	E
Isuzu®/Isuzu® Truck	(1992-98) 4HE1-TC (1998-2005) 6HK1- TC (1998-2005)	Glow Plug	10 x 1.25	E
	4HE1-TC (Up to 1998) 6HK1- TC	Glow Plug	12 x 1.25	H <sup>U</sup> <sup>U</sup>
Kubota®	Some models	Glow Plug	10 x 1.25	F
Lincoln®, Mark VII®	2.4L used in 1984-85	Glow Plug	12 x 1.25	H
Continental®	autos with Volvo® engines	Glow Plug	10 x 1.25	F
Mercedes-Benz®	(1988-89) 190E 2.5L	Glow Plug	12 x 1.25	I <sup>U</sup>
	(1991-99) E300	Glow Plug	12 x 1.25	H <sup>U</sup>
	2005 E320 CDI	Glow Plug	10 x 1.00	A

<sup>U</sup> - Indicates that part 7 must be removed for these applications.

Mitsubishi®	2 and 3 cylinder engines	Glow Plug	10 x 1.25	F			
Mitsubishi-Fuso®	Medium	Glow Plug	10 x 1.25	F			
Navistar®/ International®	6.9L and 7.3L	Glow Plug	10 x 1.00	A			
Nissan®/ UD Truck®	2.2L	Glow Plug	10 x 1.25	F			
	Medium	Glow Plug	10 x 1.25	F			
Peugeot®	Most	Glow Plug	12 x 1.25	H <sup>U</sup>			
	Certain Models		18 x 1.50	H			
Toyota®	1.8L	Glow Plug	10 x 1.25	E			
	2.2L	Glow Plug	10 x 1.25	F			
VW®	(1979-84) Rabbit®	Glow Plug	12 x 1.25	H <sup>U</sup> <sup>U</sup>			
	(1979-99) Jetta®						
	(1981-84) Pick-Up						
	(1987-99) Golf®						
	(1992-97) Passat®						
	(1992-98) Eurovan®						
	(1995-97) Passat®				Glow Plug	10 x 1.00	A
	(1997-05) Golf®						
	(1997-05) Jetta® & Jetta® Wagon						
(1998-05) New Beetle® 2004 Touareg®							

<sup>U</sup> - Indicates that part 7 must be removed for these applications.

## PARTS LIST

Part	Description	Qty
1	Pressure Gauge	1
2	Air Release Button	1
3	Rubber Hose	1
4	1/8" NPT Quick Coupler	1
5	7/16"-20 (F) Quick Coupler	3
6	M12 x 1.25 (M)-7/16"-20 (M) Adapter	3
7	M12 x 1.25 (F)-M18 x 1.5 (M) Adapter	2
8	M10 x 1.25 Short Adapter	1
9	M10 x 1.25 Long Adapter	1
10	ZG 1/8" (M) Male Quick Coupler	1
11	ZG 1/8" (F)-M24 x 2 (M) Adapter	1
12	Adapter Sleeve	1
13	Quick Connect with Ball Tip	1
14	1/2"-19 Lock Nut	1
15	7/16"-20 (M)-7/16" x 20 (F) 90° Connector	1
16	ZG 1/8" (M)-M24 x 1.5 (M) Adapter	1
17	M10 x 1 (M) Adapter	1
18	Copper Washer	2

# ASSEMBLY DIAGRAM

Letters designate adapter assemblies

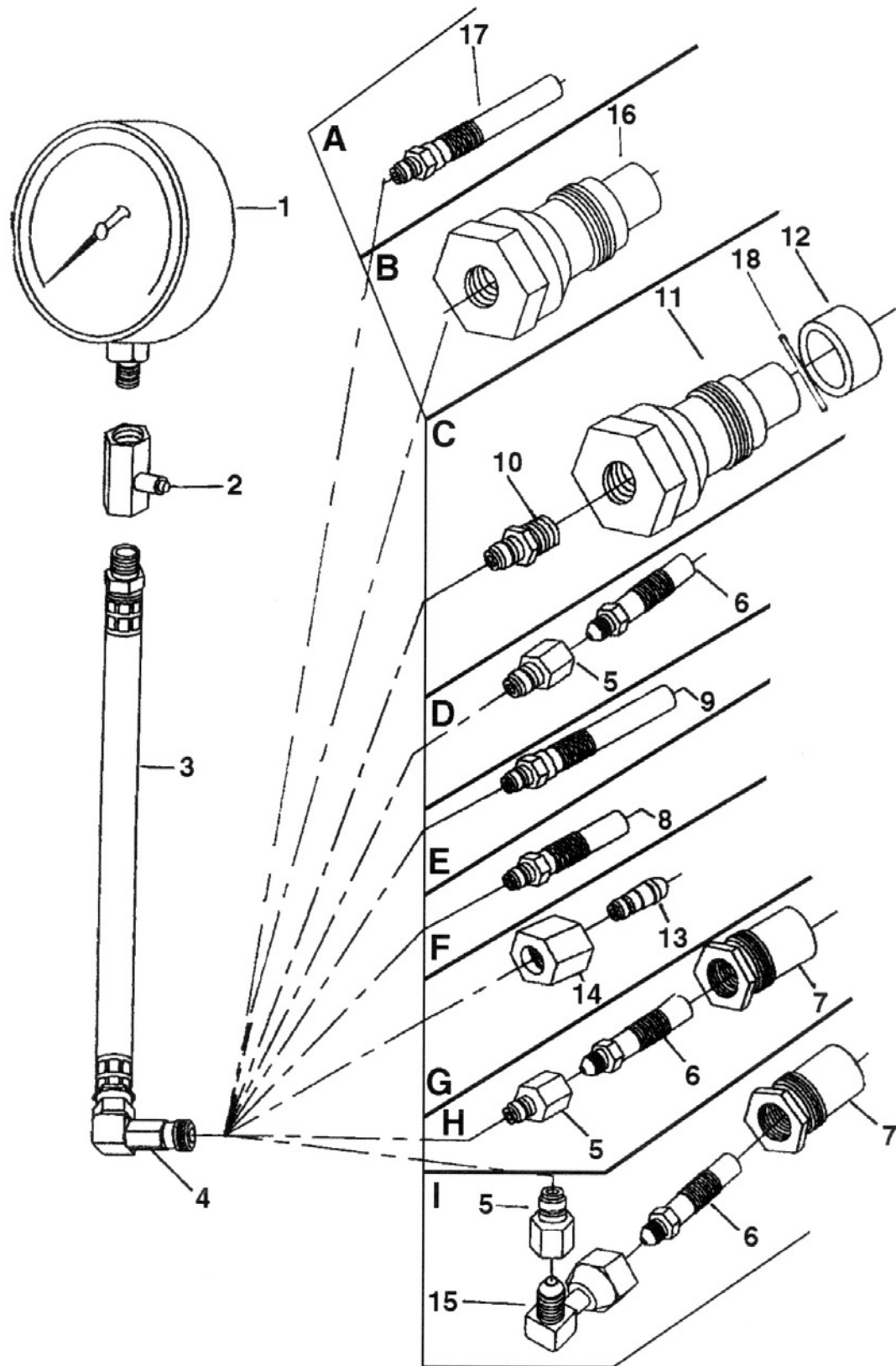

#### LIMITED WARRANTY

PERFORMANCE TOOL® extends only the following warranties, and only to original retail purchasers. These warranties give specific legal rights. Except where prohibited by local law, the law of the State of Washington governs all warranties and all exclusions and limitations of warranties and remedies. There may be other rights which vary from state to state.

PERFORMANCE TOOL® warrants the product to be free from defects in materials and workmanship under normal use and service. A defective product may be returned for a free replacement within 90 days from the date of purchase, provided that product is returned to place of purchase immediately after discovery of defect. After 90 days and up to one year from date of purchase, PERFORMANCE TOOL® will replace at no charge any parts which our examination shall disclose to be defective and under warranty. These warranties shall be valid only when a sales receipt showing the date of purchase accompanies the defective product or defective part (s) being returned.

These warranties exclude blades, bits, punches, dies, bulbs, fuses, hoses, and other consumables which must be replaced under normal use and service. These warranties shall not apply to any product or part which is used for a purpose for which it is not designed, or which has been repaired or altered in any way so as to affect adversely its performance or reliability, nor shall these warranties apply to any product or part which has been subject to misuse, neglect, accident or wear and tear incident to normal use and service.

PERFORMANCE TOOL® does not authorize any other person to make any warranty or to assume any liability in connection with its products.

Except for warranties of title and the limited express warranties set forth above, PERFORMANCE TOOL® makes no express or implied warranties of any kind with respect to its products. In particular, PERFORMANCE TOOL® makes no implied warranty of merchantability and no implied warranty of fitness for any particular purpose, except that for goods purchased primarily for personal, family or household use and not for commercial or business use, PERFORMANCE TOOL® makes an implied warranty of merchantability (and, if otherwise applicable, an implied warranty of fitness for a particular purpose), but only for the particular qualities or characteristics, and for the duration, expressly warranted above.

The laws on limitation of implied warranties may differ from state to state, so the above limitations may not apply in all cases.

PERFORMANCE TOOL® shall not be liable for consequential, incidental or special damages resulting from or in any manner related to any product, or to the design, use, or any inability to use the product. The sole and exclusive remedy for a defective product or part shall be the repair, or replacement thereof as provided above. The laws on limitation of remedies or on consequential, incidental or special damages may vary from state to state, so the above limitations may not apply in all cases.

#### PLEASE READ THE FOLLOWING CAREFULLY

**THE MANUFACTURER AND/OR DISTRIBUTOR HAS PROVIDED THE PARTS LIST AND ASSEMBLY DIAGRAM IN THIS MANUAL AS A REFERENCE TOOL ONLY. NEITHER THE MANUFACTURER OR DISTRIBUTOR MAKES ANY REPRESENTATION OR WARRANTY OF ANY KIND TO THE BUYER THAT HE OR SHE IS QUALIFIED TO REPLACE ANY PARTS OF THE PRODUCT. IN FACT, THE MANUFACTURER AND/OR DISTRIBUTOR EXPRESSLY STATES THAT ALL REPAIRS AND PARTS REPLACEMENTS SHOULD BE UNDERTAKEN BY CERTIFIED AND LICENSED TECHNICIANS, AND NOT BY THE BUYER. THE BUYER ASSUMES ALL RISKS AND LIABILITY ARISING OUT OF HIS OR HER REPAIRS TO THE ORIGINAL PRODUCT OR REPLACEMENT PARTS THERETO, OR ARISING OUT OF HIS OR HER INSTALLATION OF REPLACEMENT PARTS THERETO.**