



TRAILGUARD REAR BUMPER TIRE CARRIER

For proper installation and best possible fit, please read all instructions BEFORE you begin.

Important Safety Information



- **CAUTION** - Before driving, ensure that the bumper & tire are properly secured to vehicle.
- Periodically check all components for tightness.
- Be sure to wear safety goggles while installing.
- When using power tools, read and understand all operating instructions.

Contents

NOTE: Actual product may vary from illustration.



Pivot (1)



U Shape Mounting Bracket (1)



Heim Joint (1)



Pivot Cover (1)



M8-8 Hex Socket Screw (1)



Tire Carrier (1)



NSK Bearing (1)



NSK L68149/10 Bearing (1)



Seal Cover (1)

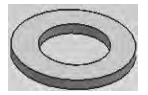

Pivot Flat Washer (1)



Dia. 36 Pivot Flat Washer (1)



Light Mounting Bracket (1)

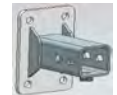

Support Bracket (1)



Tire Carrier Mounting Bracket (1)



Mounting Bracket (1)



Brake Light Mounting Bracket (1)



Mounting Bracket 2 (1)



1/2"-20 Lug Nut (3)



Rubber Bumper (1)



Slope Bracket (1)



Pin (1)



Rubber Bumper Mounting Bracket (1)



M12 x 24 OD (20)



M12 x 29 OD (4)



M10 x 20 OD (4)



M6 x 18 OD (4)



M6 x 12 OD (6)



12mm Lock Washer (8)



M6-20 Button Head Socket Cap Screw (2)



M6-25 Button Head Socket Cap Screw (4)



M4-8 Phillips Screw (1)



M6 Nylon Lock Nut (6)



M10 Nylon Lock Nut (2)



M12 Nylon Lock Nut (8)



M24 Castle Nut (1)



M12x70x31 Hex Bolt (2)



M10x30 Hex Bolt (2)



M12x40 Hex Bolt (9)



M12x60 Hex Bolt (4)



M12x80 Hex Bolt (2)

Tools Required



Socket Wrench



Socket
(18 & 19 mm)

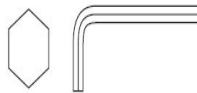

Allen Wrench
4mm



Torx Head Screwdriver



18mm Wrench

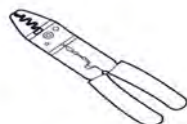

Crimps



Safety Glasses

Before Installation Remove Original Bumper

Using appropriate tools, remove the factory original rear bumper by removing all of the bolts and nuts holding the bumper to frame mount brackets. The original hardware can be discarded as the installation kit contains all new necessary attaching hardware for your Trail Guard Bumper. Note: The original third brake light assembly will be re-used later in this installation. If needed please reference original owners manual.

Installation Steps **NOTE: Actual product may vary from illustration.**

Install U Shape Mounting Bracket to the rear tailgate re-using the 6 factory bolts

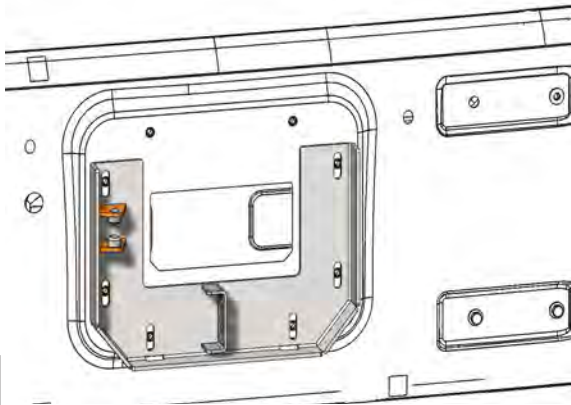

1

Insert the Rubber Bumper into the slot.

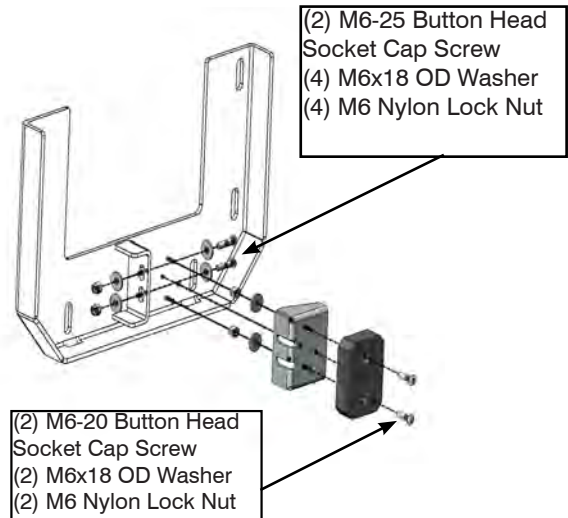

2

Make sure the pivot is centered properly in the pass-through hole of the bumper and is straight up. A level may be useful in making sure the pivot is perpendicular to the ground.

- (4) M12x60 Hex Bolt
- (4) M12x29 OD Washer
- (4) M12 Lock Washer

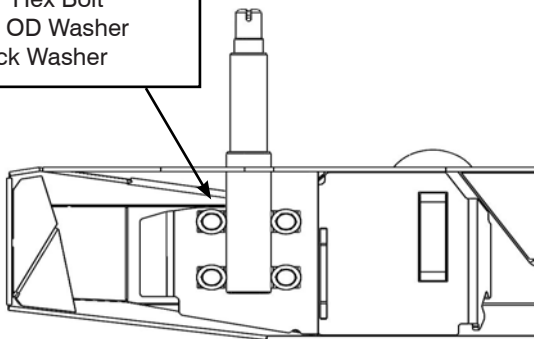

3

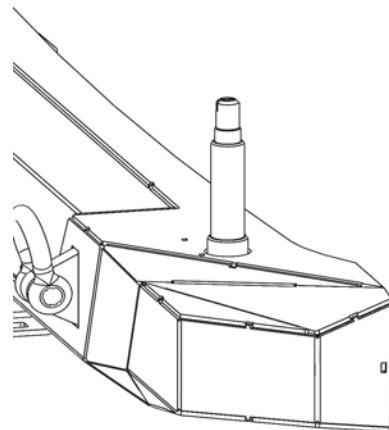

Insert bearing race of NSK L68149/10 Bearing (large) into the bottom side of the tube on the Swing Away.
Note: Make sure the bearing race is fully seated in to the machined housing. Pack the bearing with Marine-Grade grease.

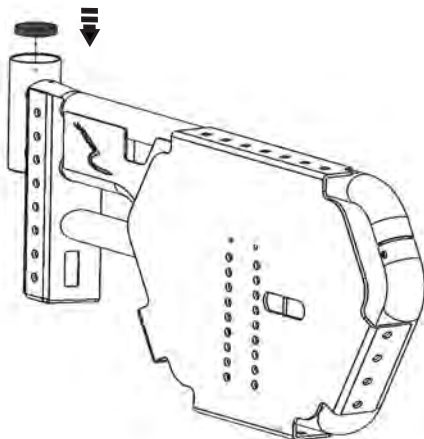

4



Installation Steps **NOTE: Actual product may vary from illustration.**

Pack NSK L68149/10 Bearing (large) with Marine-Grade grease & insert the bearing into the race.

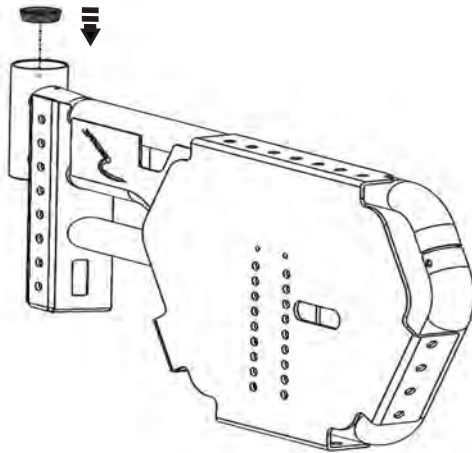

5

Place Dia. 36 Pivot Flat Washer onto the bearing

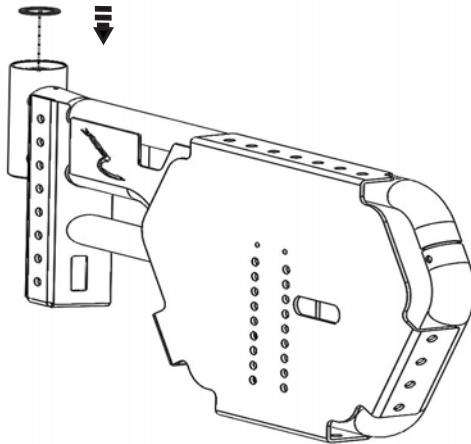

6

Insert Seal Cover into the housing by tapping evenly all around the seal.
Make sure the seal is fully seated and flush with the housing edge

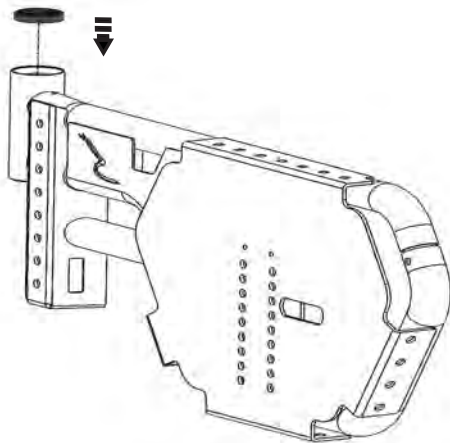

7

Installation Steps **NOTE: Actual product may vary from illustration.**

Insert bearing race of NSK Bearing (small) into the top of the tube by tapping evenly all around the edge.
Note: Make sure tapping evenly the bearing race all around the edge and fully seated into the housing.

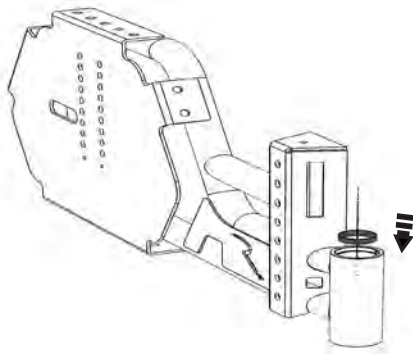

8

Place the Swing Away onto the pivot on the bumper.

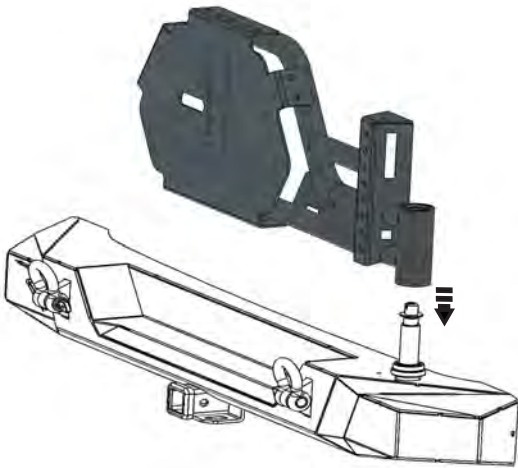

9

Pack the NSK Bearing (small) with Marine-Grade grease. Insert the NSK Bearing (small) and place Pivot Flat Washer in the house, on the Pivot and into the Race.

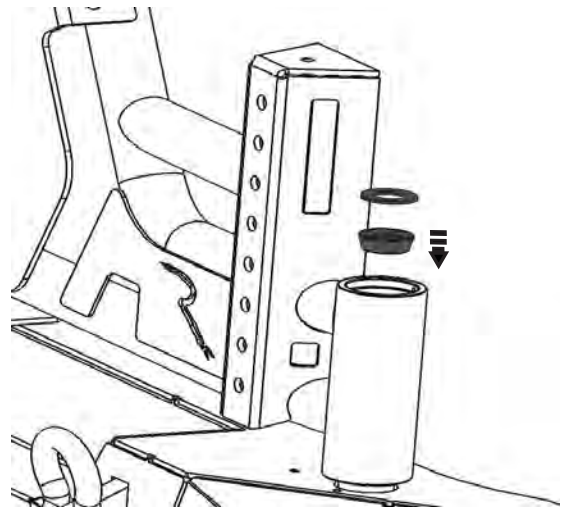

10

Thread on the Castle Nut. Tighten the Castle Nut by hand as far as you can while pivoting the Swing Away. This will help make sure the bearings are properly seated. Then, using a 36mm Socket, tighten the castle nut as tight as it will go. Then back off the Castle Nut until the slots align. Pivot the swing away through the full range of motion to make sure it moves smoothly

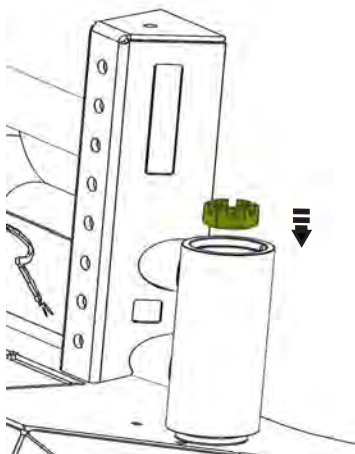

11



Installation Steps NOTE: Actual product may vary from illustration.

Insert the Square Pin into the slot.



12

Thread M8-8 Hex Socket Screw into the top of the Pivot. Tighten the Set Screw to lock down the Square Pin.



13

Install Pivot Cover and M4 Phillips Screw.

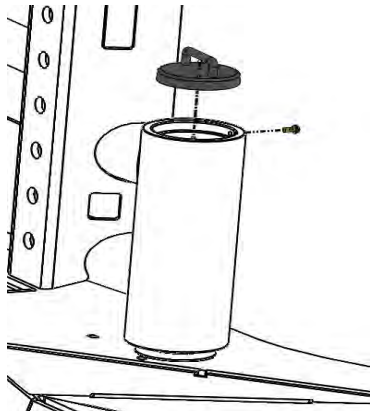

14

VERTICAL TIRE MOUNT option. Determine the height required based on the size tires you have. Larger tire 35" plus will use lower 4 holes in bracket and 4 upper holes in tire swing.

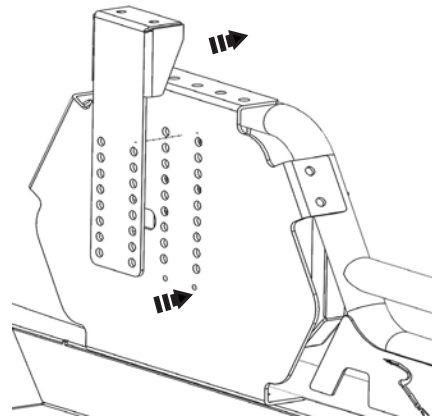

15

VERTICAL TIRE MOUNT option. Mount 3rd brake light to vertical mount as show below.

- (2) M6-25 Button Head Socket Cap Screw
- (4) M6x18 OD Washer
- (2) M6 Nylon Lock Nut

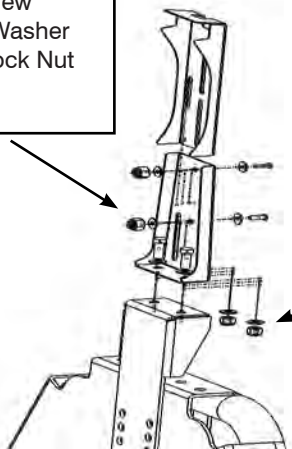

- (2) M10x30 Hex Bolt
- (4) M10x20 OD Washer
- (4) M10 Nylon Lock Nut

16

Install original 3rd brake light onto brake light bracket with (4) screws as shown below then plug in harness connection.

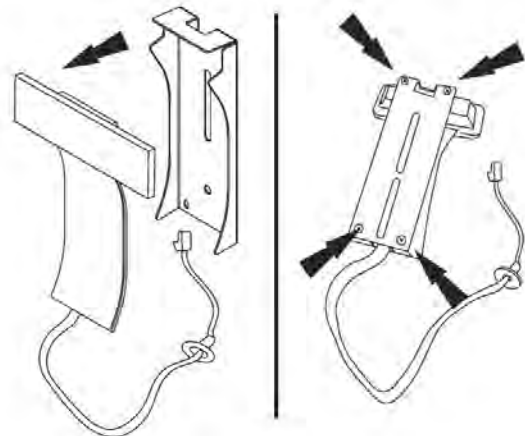

17

Installation Steps NOTE: Actual product may vary from illustration.

VERTICAL TIRE MOUNT option. Mount tire holding bracket. Note: We recommend to set the tire mount into the width of the spare tire.

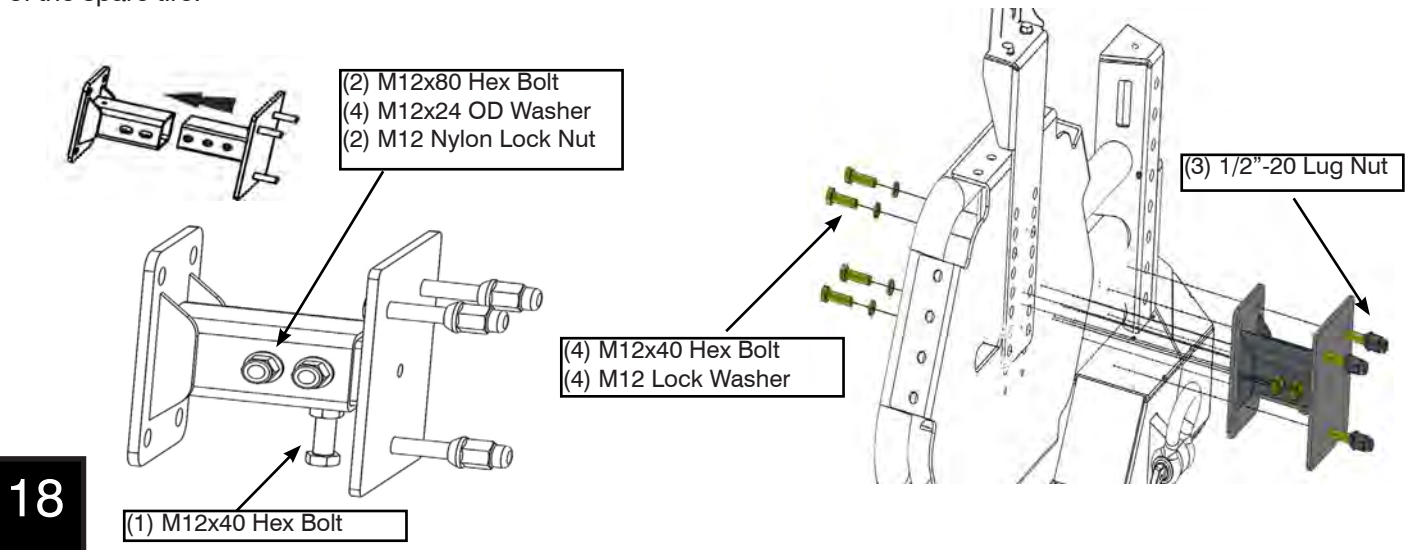

18

Assemble Heim joint together and Mount Heim Joint and connect to rear tailgate plate as shown below.

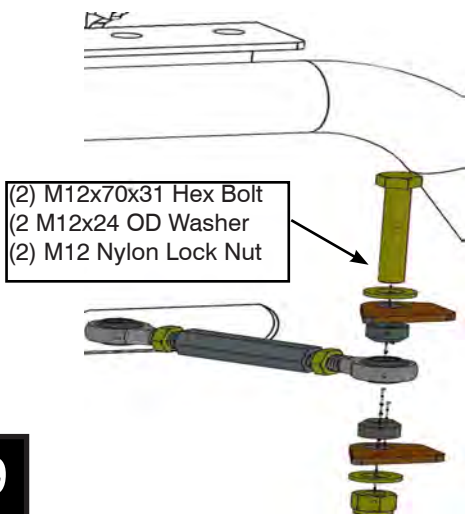

19

Mount the other side of the Heim Joint and connect to rear tire swing away arm as shown below.

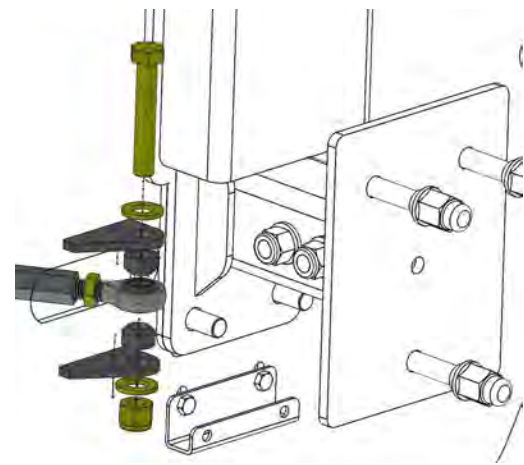

20

Mount spare tire the tire mount using the supplied wheel Lug Nuts as shown below.

⚠ CAUTION: 2 person lift

VERTICAL TIRE

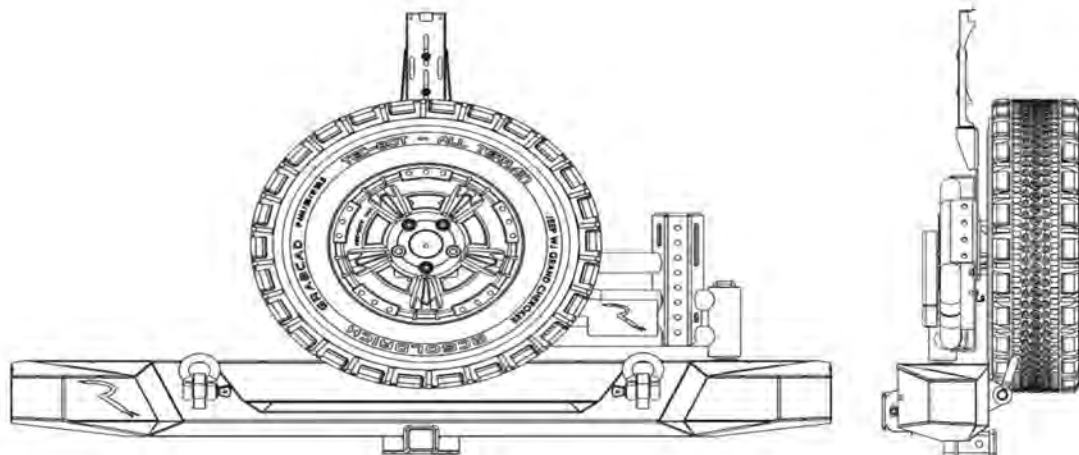

21

Installation Steps **NOTE: Actual product may vary from illustration.**

Mount spare tire the tire mount using the supplied wheel Lug Nuts as shown below.

⚠ **CAUTION:** 2 person lift

SLOPE TIRE

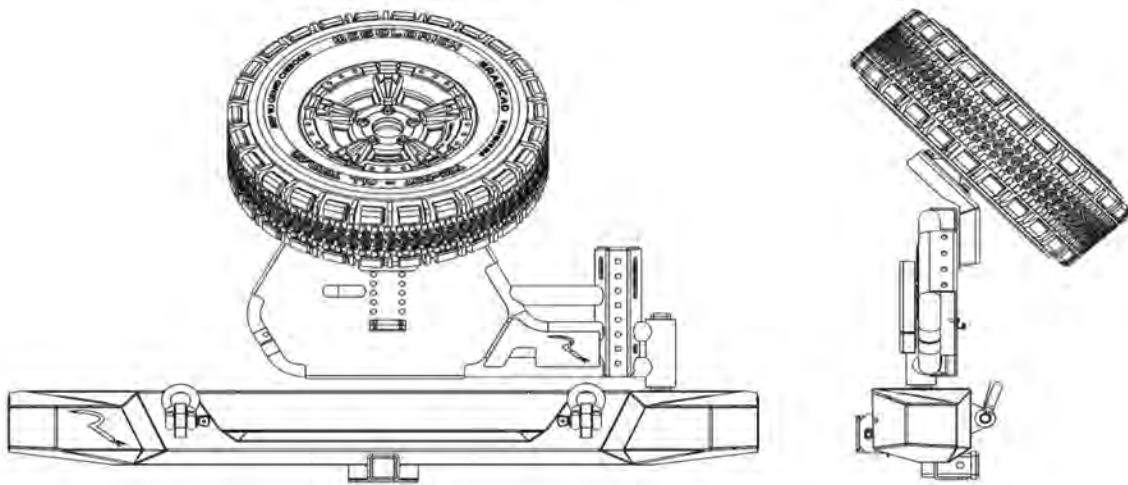

22

Care and Cleaning

- Rampage parts are built to last. Use mild soap and dry clean cloth to wash your TRAILGUARD REAR BUMPER TIRE CARRIER.
- Do not use any harsh abrasive detergents or cleaning solvents of any kind.
- Periodically check and lubricate moving parts.

Congratulations!

You have purchased one of the many quality Rampage branded products offered by Lund International, Inc. We take the utmost pride in our products and want you to enjoy years of satisfaction from your investment. We have made every effort to ensure that your product is of the highest quality for fit, durability, finish, and ease of installation.