

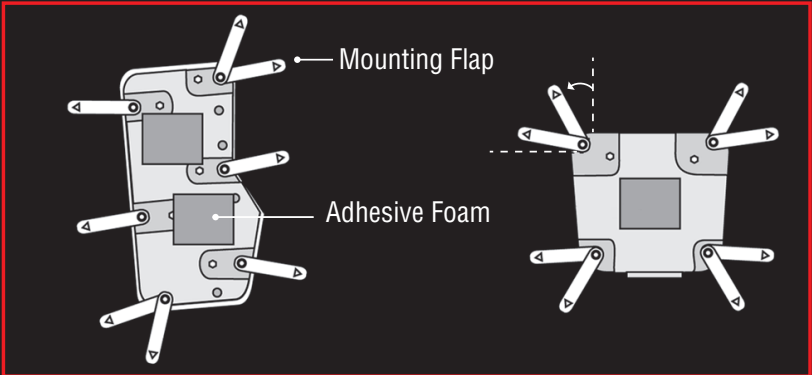

RBP-4131ZR

**WARNING:** Before installation: Park the car/truck safely. Take the keys out of the ignition and apply the hand (parking) brake. After installation: Check the pedals' mounting mechanism periodically to ensure the stiffness and the safely movement against the factory pedal.

## INSTALLATION INSTRUCTIONS



1. Rotate the mounting flaps on the rear side of the racing pedals, adjust each flap to a proper angle against the vertical/horizontal line, corresponding to the shape and the size of the factory pedal.

## INSTALLATION INSTRUCTIONS

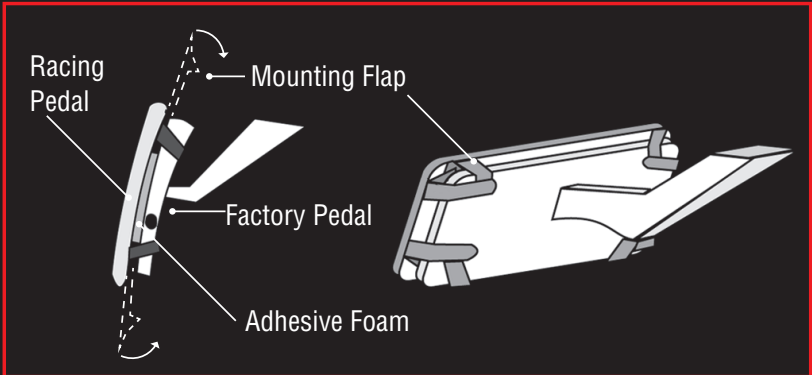

2. To install on the smaller size pedals, keep extra flaps not needed in their fold-in positions (Fig. 2)

## INSTALLATION INSTRUCTIONS

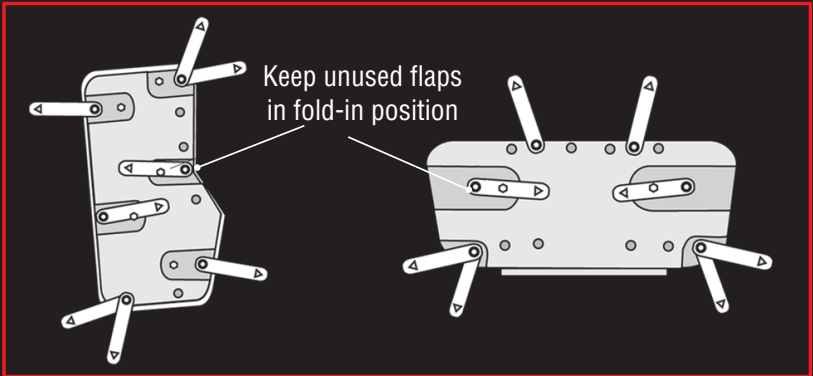

3. Place the racing pedal on the center top of the factory pedal, apply the adhesive foam in between (if available), bend the top flaps to the rear side of the factory pedal so the flaps will tightly grasp against the edge of the factory pedal (use pliers if necessary). Bend the lateral flaps and the bottom flaps in the same way.
4. Step on the pedals to test for fit. The racing pedal should have no relative movement against the factory pedal.

[View other automotive pedals made by RBP on our website.](#)