

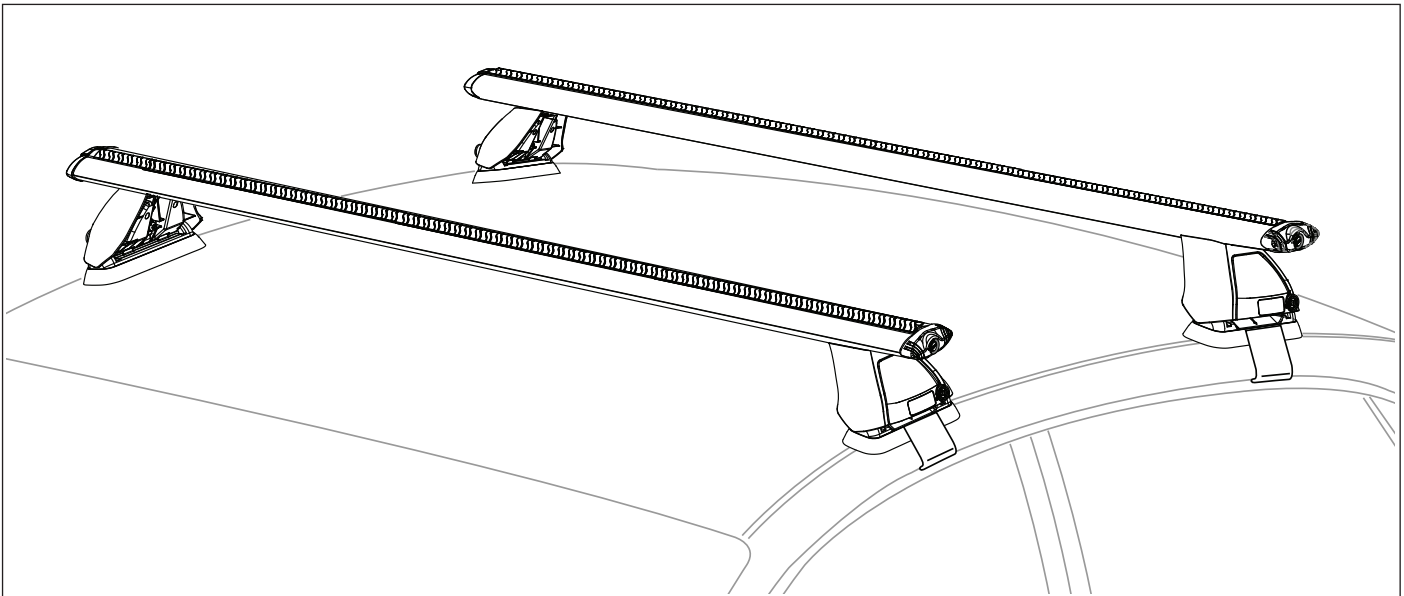

RHINO-RACK

Rhino 2500 Series

- Important:**
- 1. Please refer to your fitting instruction to ensure that the roof racks are installed in the correct locations.
 - 2. Check the contents of kit before commencing fitment and report any discrepancies.
 - 3. Place these instructions in the vehicle's glove box after installation is complete.
 - 4. This kit also requires the DK fitting instructions
 - 5. These instructions must be followed for warranty to be upheld.



Maximum carrying capacity: 75kg (165lbs) evenly distributed over crossbars. Please refer to your vehicle manufacturers handbook and DK Specification sheet for maximum roof loading. Always use the lower of the two figures.

Advisory:

It is essential that all bolt connections be checked after 48hrs from when you first install your crossbars. Bolt connections should be checked again at regular intervals (once a week is enough, depending on road conditions, usage, loads and distances travelled). You should also check the crossbars each time they are refitted. Make sure to fasten your load securely (see page 2 for advisory diagrams). Please ensure that all loads are evenly distributed and that the centre of gravity is kept as low as possible.

Use only non-stretch fastening ropes or straps.

Load Ratings

When these roof racks are to be used on a vehicle that is driven off sealed roads, the manufacturer maximum roof load rating (to be found in the vehicle's User Manual) should be divided by a safety factor of **2**. For example, if the vehicle's maximum roof load rating is 75kgs\165lbs, these racks, when fitted to this vehicle should have no more than 37.5kgs/82lbs loaded on them.

Caution:

The handling characteristics of the vehicle changes when you transport a load on the roof. For safety reasons we recommend you exercise extreme care when transporting wind-resistant loads. Special consideration must be taken into account when cornering and braking. **Please remove crossbars when putting vehicle through an automatic car wash.**

Note for Dealers and Fitters:

It is your responsibility to ensure these fitting instructions are given to the end user or client



Rhino 2500 Series

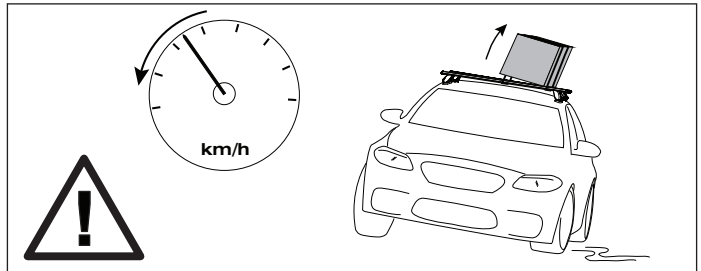
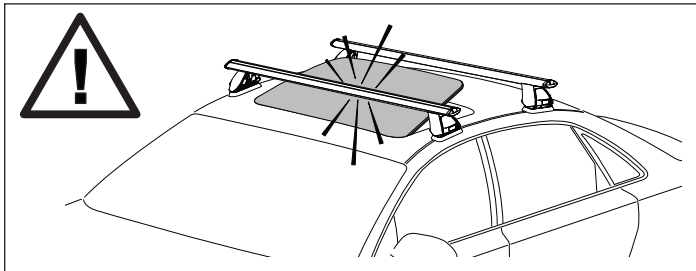
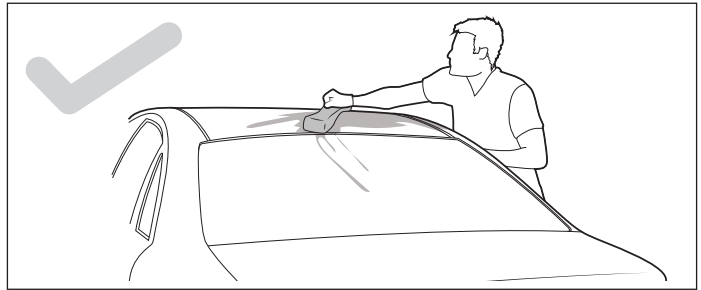
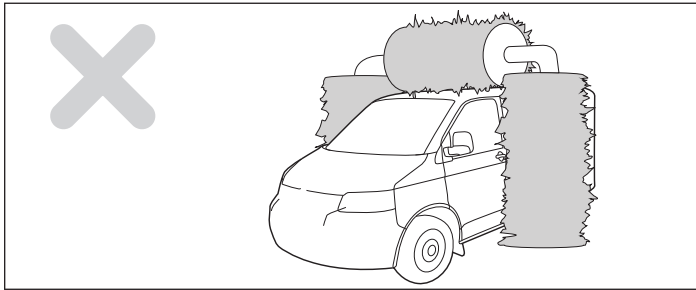
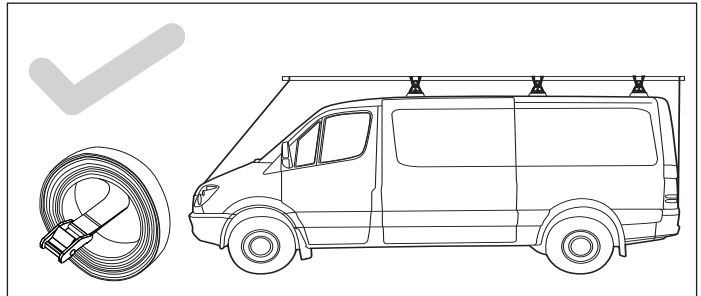
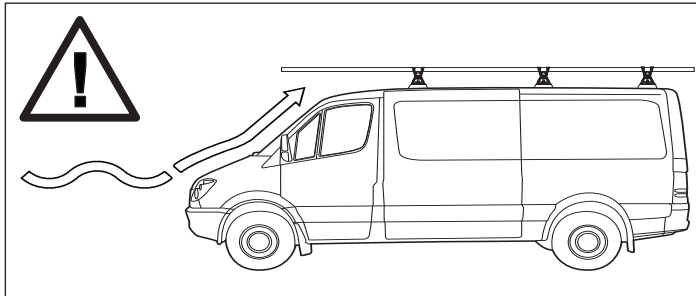

The handling characteristics of the vehicle changes when you transport a load on the roof. For safety reasons we recommend you exercise extreme care when transporting wind-resistant loads. Special consideration must be taken into account when cornering and braking.

Although the system is tested and approved to AS1235-2000 / ISO 11154, off-road conditions can be much more rigorous. Extreme care must be taken in off road conditions

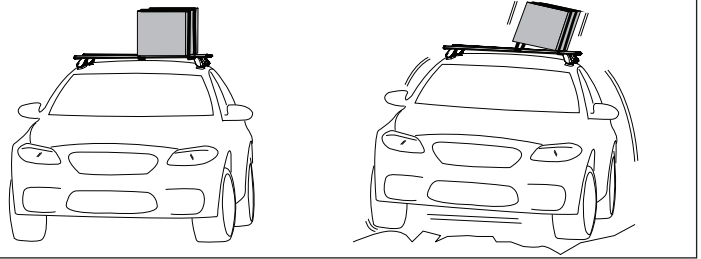

Paddle/ Surfboards should be fixed to the front of the vehicle.

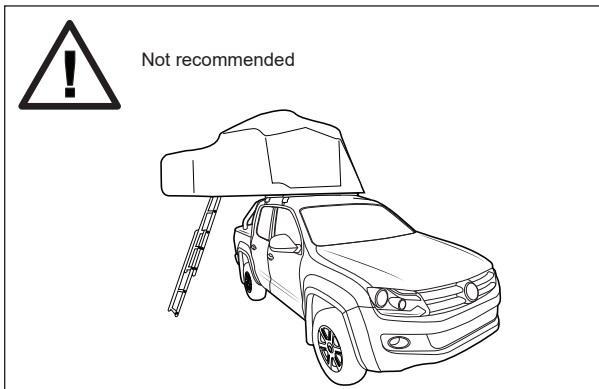
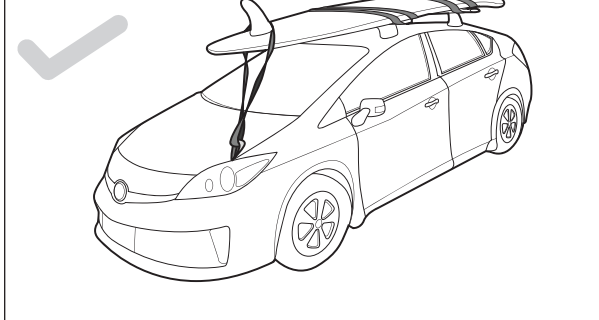

(A)

(B)



Rhino 2500 Series

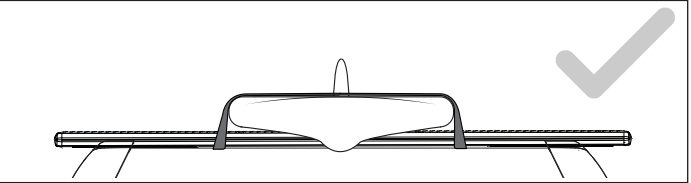
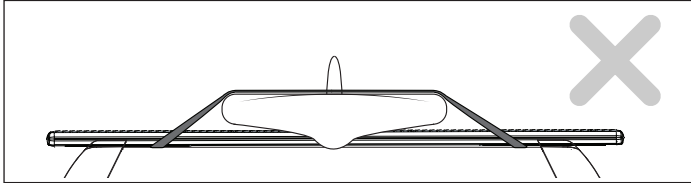
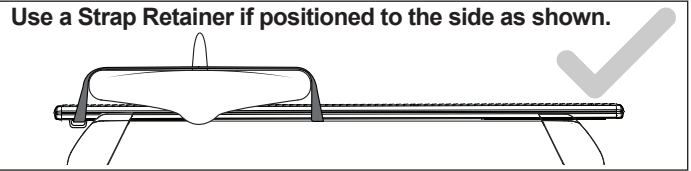
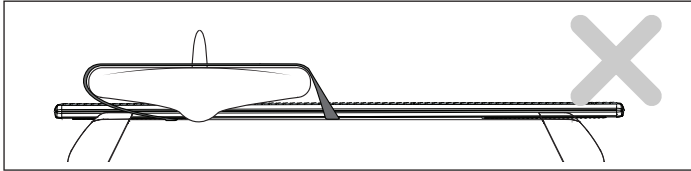

Paddle/ Surf boards to be rear facing and secure a strap around the fin and to the front of the vehicle.

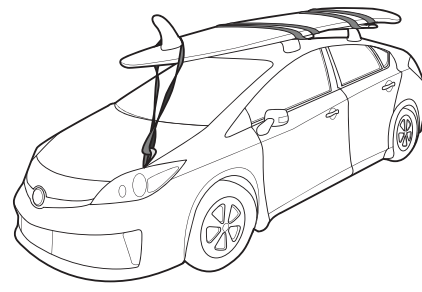
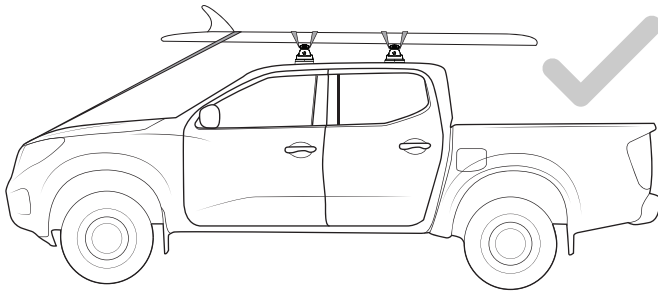

Kayaks should use additional straps to secure the load at the front and rear of the vehicle where possible. Always use Kayak Carrier Cradles when transporting Kayaks on the roof.

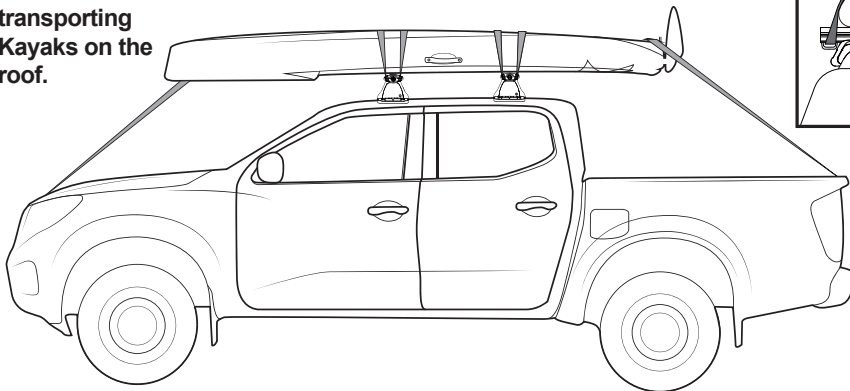
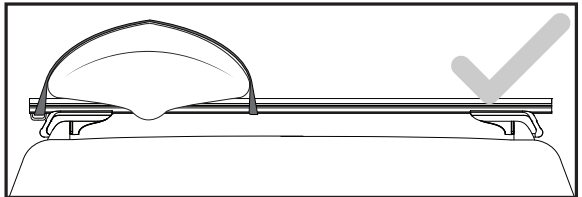
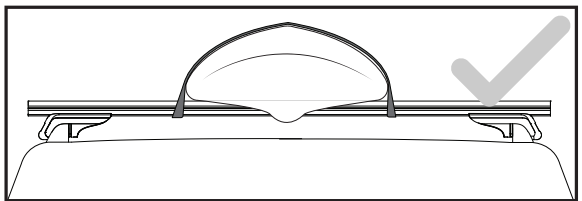
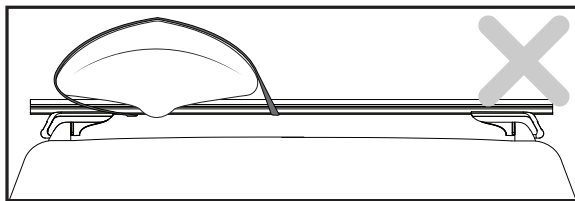

Optimal Setup:
The Kayak should be housed in Cradles and held in place with tension straps. The front and rear of the Kayak should be fixed to the front and rear of the vehicle. A Nose Tie Down (RBAS1) should be used to secure the front of the Kayak.

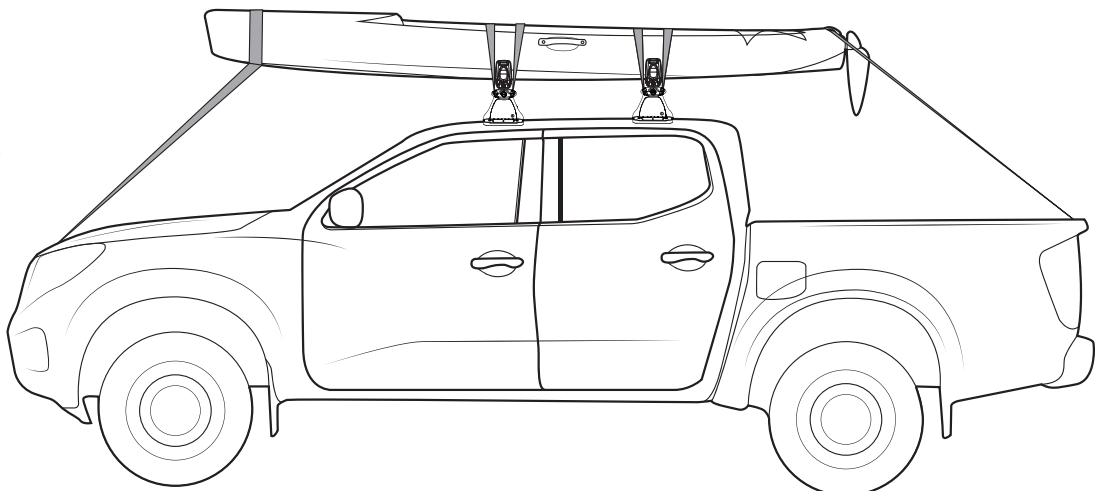



Rhino 2500 Series

Note: To complete installation, crossbars, leg and DK kits required. Be sure to have all three before attempting to begin.

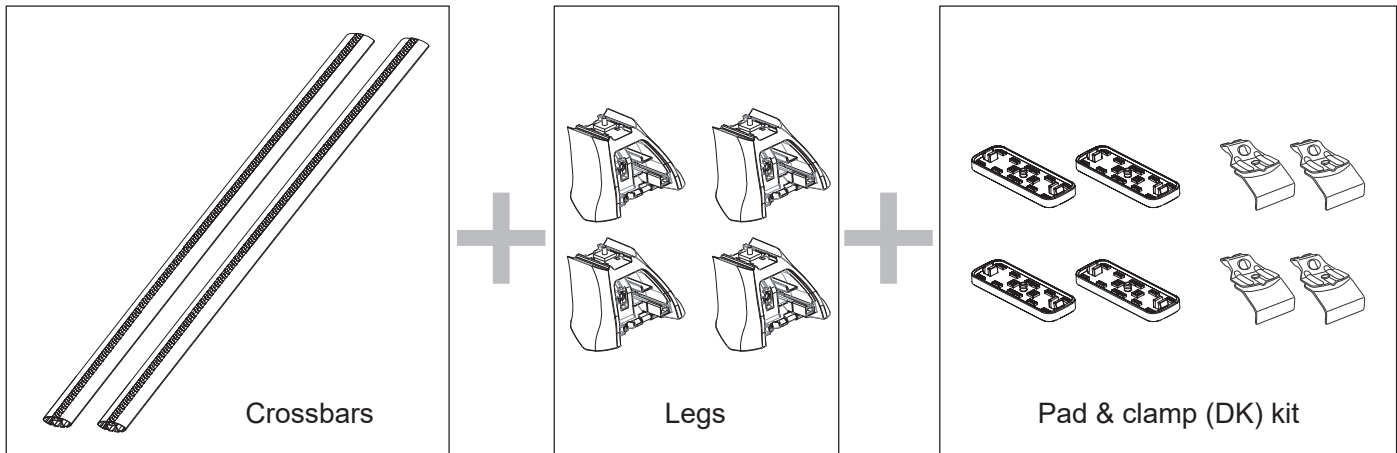

Parts List

Item	Component Name	Qty	Part No.
1	Rubber Buffer Strip	varies	M626
2	VA Crossbar	2	-
3	M8 x 50mm Security Bolt	4	B154
4a	End Cap	4	M640
4b	Barrel	4	M622
4c	Key	2	M623
5	Measurement Strip	4	M641
6	M8 Pivot Nut	4	N047
7	Leg	4	M310
8	M6 Nut	4	N057
9	M6 Flat Washer	4	W031
10	M6 Spring Washer	4	W004
11	M6 x 20mm Socket Head Screw	4	B054
12	Front Cover	4	M312
13	Key (x2 per kit) and Barrel	4	CA1339-BK
14	Foot Plate	4	M311
15	Torque Key	1	Torkey-L
16	Location Decals	4	S365
17	Positioning Decals	4	S364
18*	2500 Plastic Barrel	1-4	M313
19*	2500 Plastic Key	1-4	M314
20	Fitting Instructions	1	2501

NOTE: Items 1-5 are packed within crossbar. 6 - 12 are installed on legs

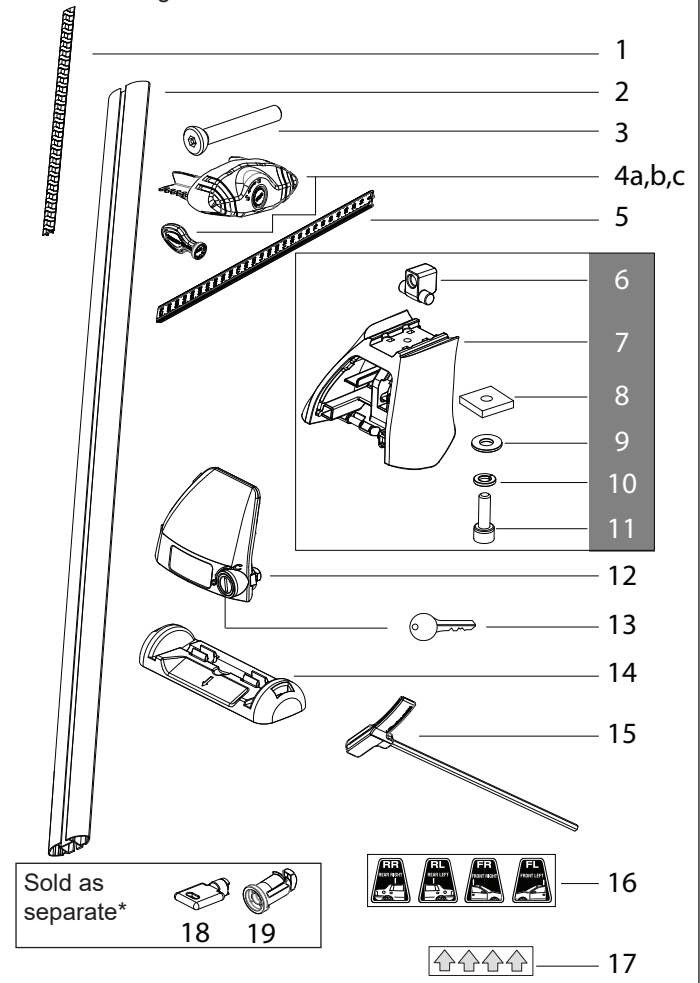

Tools Required: Security Allen key, provided in kit. Tape measure. Scissors.

NOTE : Refer to the DK kit specification sheet for correct placement (Front & Rear, Left & Right) of the foot plate, rubber pad and metal strap. Also refer for sizes to cut the bar measurement strips.



Rhino 2500 Series

1 Open the Crossbar box and remove the end caps. Shake the crossbar up and down to remove measurement strips and rubber buffer strips.

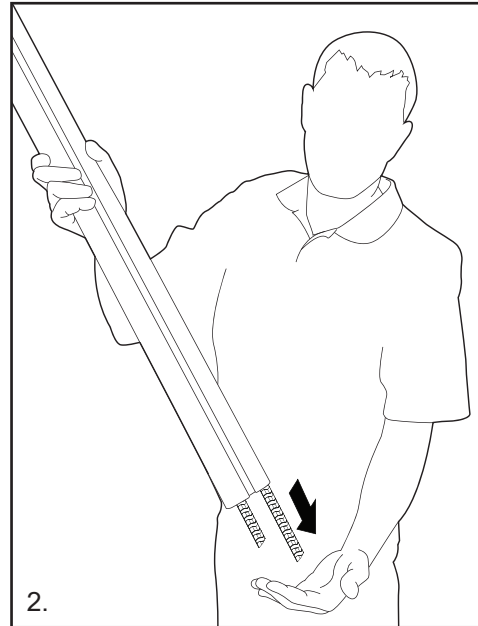
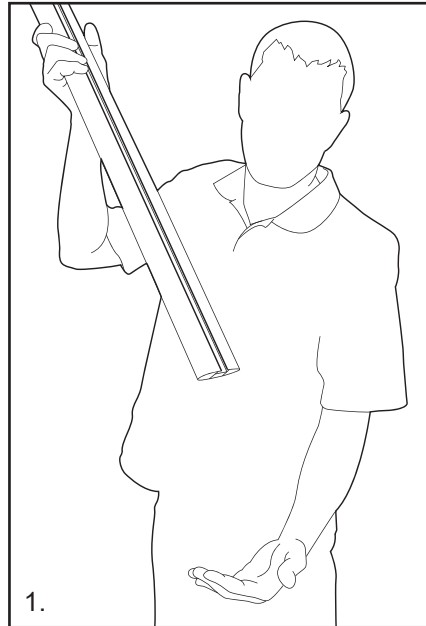

2 Install the Rubber Buffer Strips. Cut to size if required.

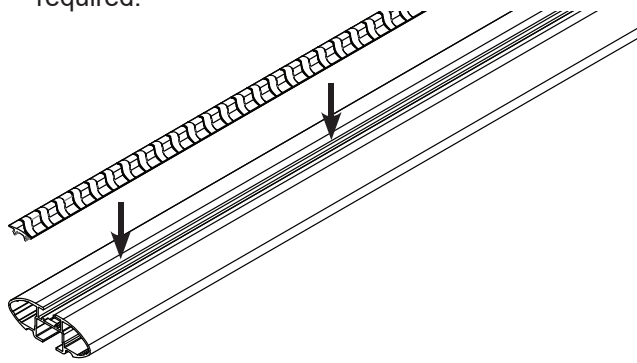

3 Using the key provided, remove the Cover Plate from the Legs.

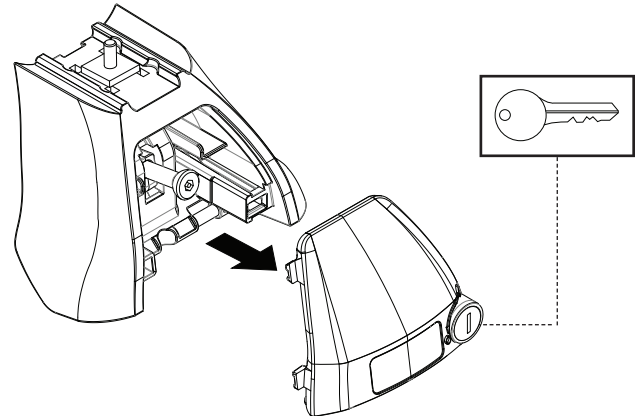

4 The 2500 Legs will come with hardware assembled, however if the Pivot Nut is not attached to the leg, install as shown with the angled face of the nut facing outwards (as below).

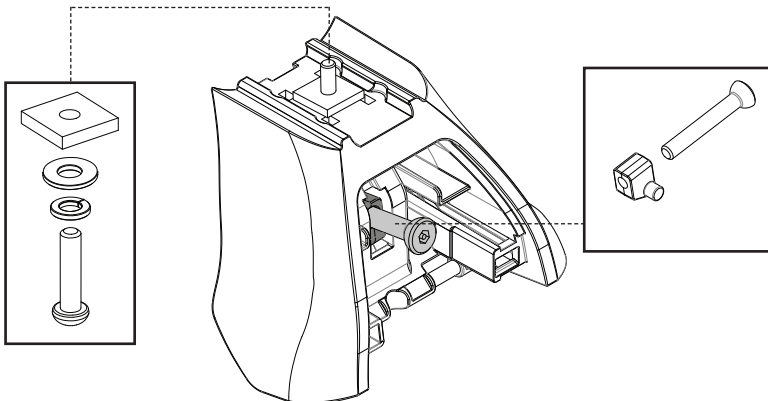

Leg will come assembled as shown.

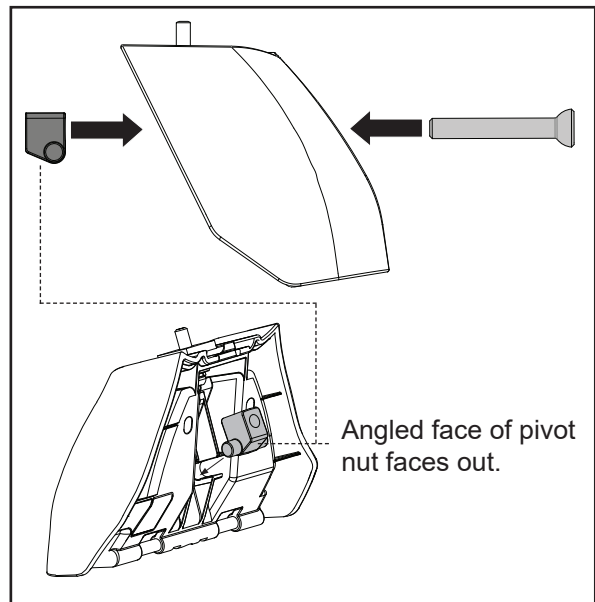



Rhino 2500 Series

5 Attach pad to foot plate.

Clip rubber pad onto foot plate. Pad central locator lug and end tabs must fully locate into the foot plate. Refer to DK Kit Specification Sheet for correct orientation under pad/clamp numbers.

DK spec sheet.

Foot plate row section	Rear Right Pad/ Clamp	Rear Left Pad/ Clamp	Measurement per
UT	M365 114490	M365 114490	18"
	Arrow FORWARD		
	M365	M365	

example only.

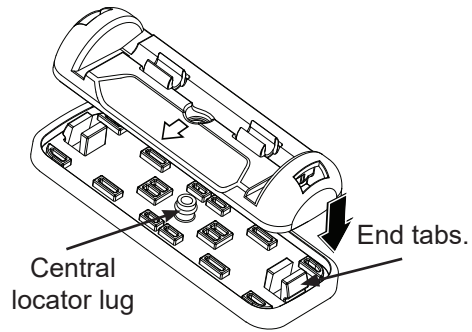
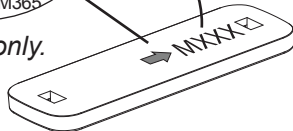

Central locator lug

End tabs.

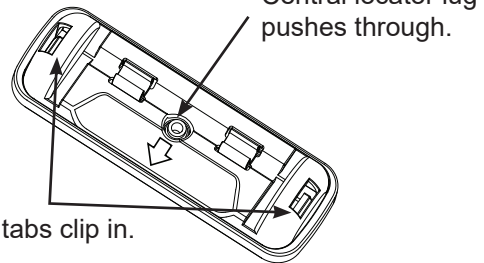

Central locator lug pushes through.

End tabs clip in.

Attach foot plate to leg.

With the pad correctly fitted to the foot plate as per the DK spec sheet, clip the foot plate onto the base of the leg with the arrow facing **In or Out** according to your vehicle listed in the DK Kit specification sheet.

DK spec sheet.

Foot plate row section	Foot plate arrow direction	Rear Right Pad/ Clamp	Rear Left Pad/ Clamp	Measurement per
UT	OUT	M365 114490	M365 114490	18"
		Arrow FORWARD		
		M365	M365	

example only.

Example:

Attach foot plate to leg with arrow facing **OUT**

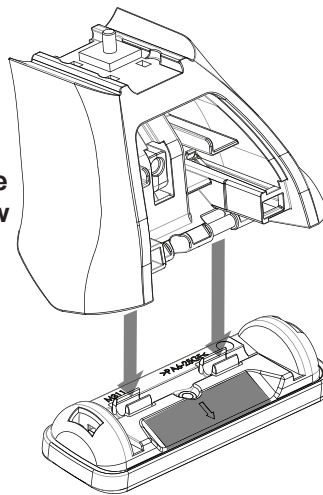

Example:

Attach foot plate to leg with arrow facing **IN**. Note: Facing **IN** is for a small number of vehicles.

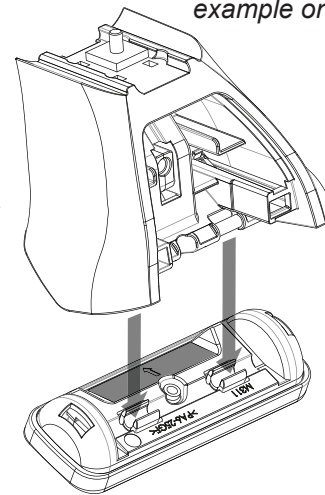

6

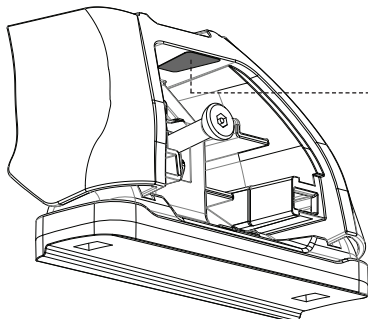

Decal.

Leg location decals:

Stick the leg position labels inside the leg. The labels identify the position of the leg on the vehicle roof. Use as a guide when re-fitting the crossbars after removal. Refer layout below.

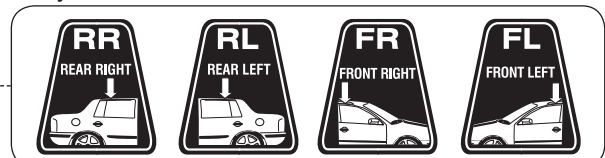



Rhino 2500 Series

7 Measurement strip length:

Refer to DK Specification Sheet for cut length of bar measurement strips.

NOTE: front and rear bar generally have different lengths.

- a. Accurately cut measurement strips to length. Slide into each end of crossbar. Repeat for front & rear crossbar.
- b. Locate M6 nut into the crossbar then slide leg in to butt up against the measurement strip.
- c. The measurement strip must butt up against the end of the crossbar cut out. Tighten M6 security screw with the allen key provided. **Tighten to 4-5 Nm (2-3 lb/ft)**

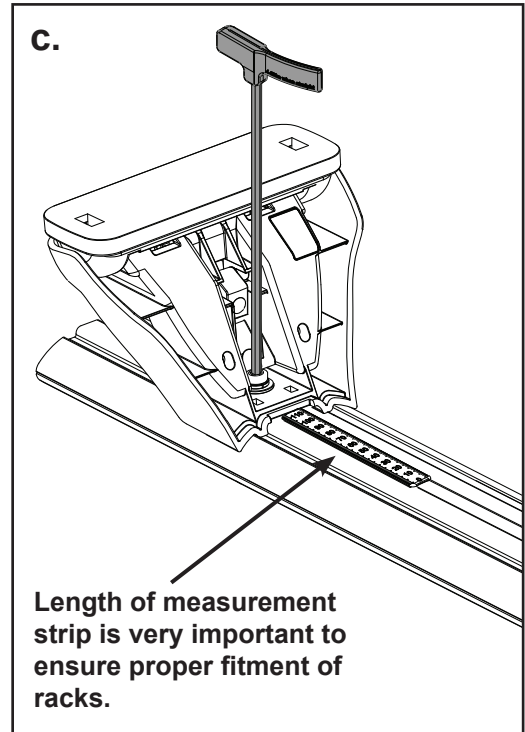
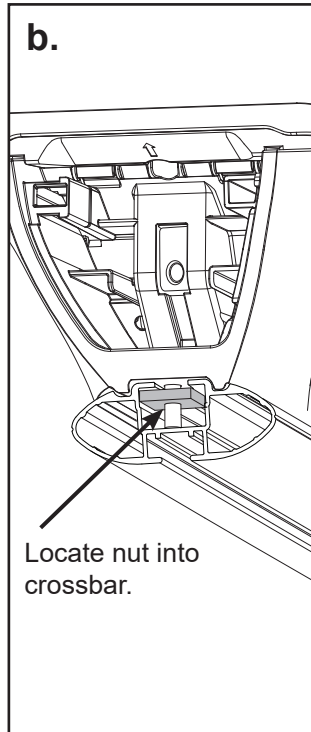
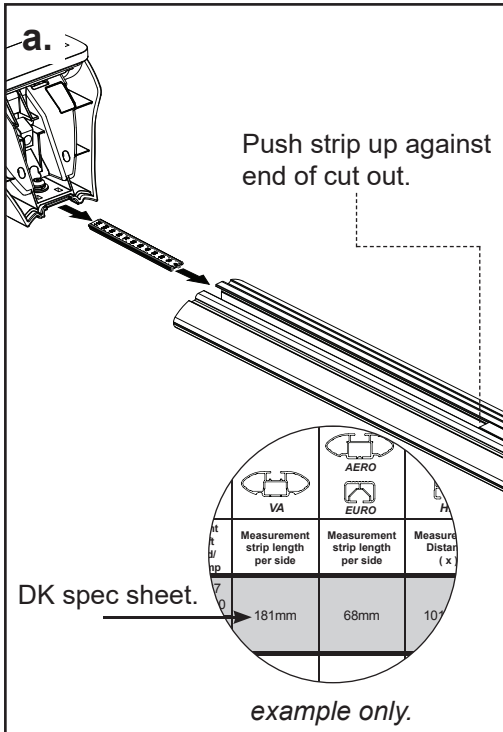

Note:

The measuring strip sits flush against the leg as shown. Do not push the leg over the strip.

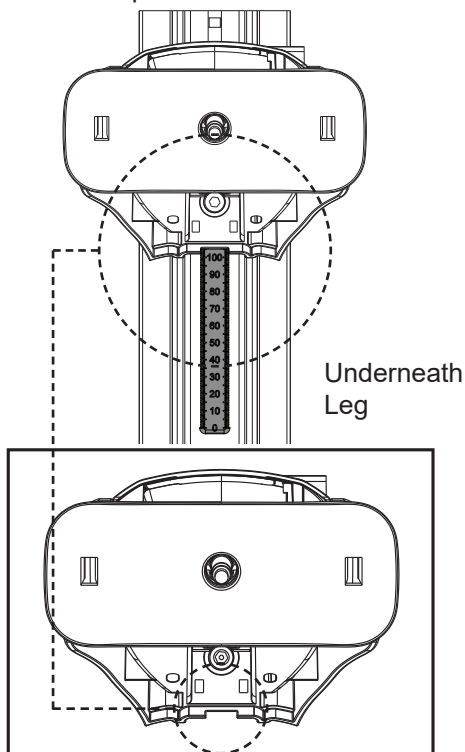

With Torque Key inserted, turn clockwise until handle straightens out as shown.

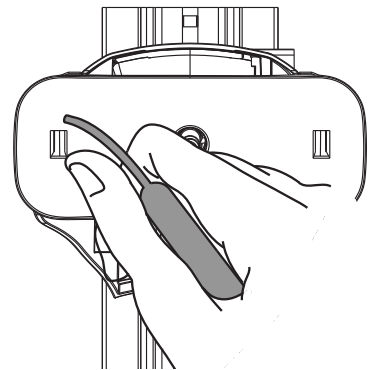

This indicates 4-5 Nm. More pressure may be required in extreme climates.

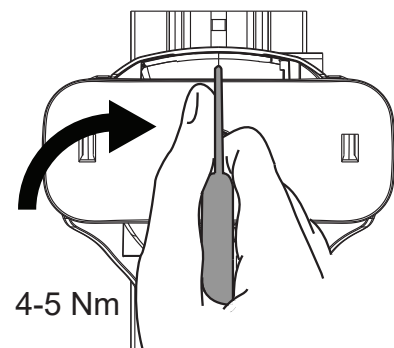



Rhino 2500 Series

- 8** Slide the remaining measurement strip that corresponds to the inside length into the end of the crossbar. Repeat this for front and rear crossbars. Cut strips flush with end of crossbar if required.

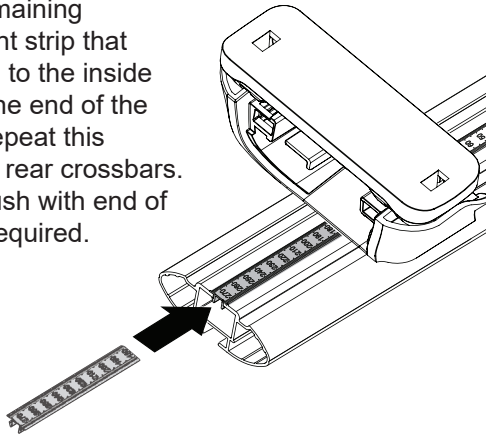

- 9** Insert the end cap into the crossbar and lock with key provided.

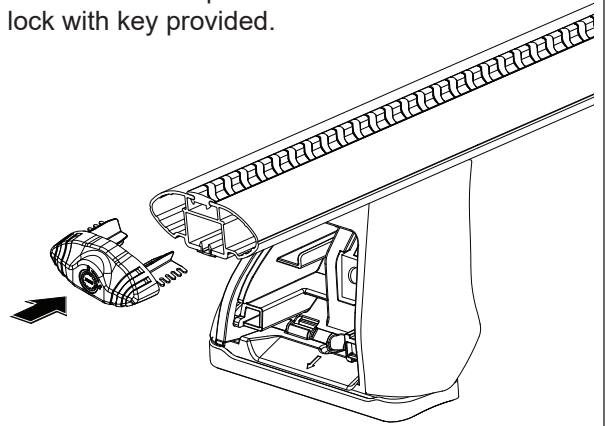

10 Position roof racks:

Place racks onto the vehicle roof.

Refer to DK specification sheet for correct positioning of your roof racks.

A. Measure forward from where the front and rear doors meet/close.

B. Measure back to set distance between crossbars, centre of front foot plate arrow to centre of rear foot plate arrow.

A and B measurements are to be in line with arrow in centre of foot plate.

DK spec sheet.

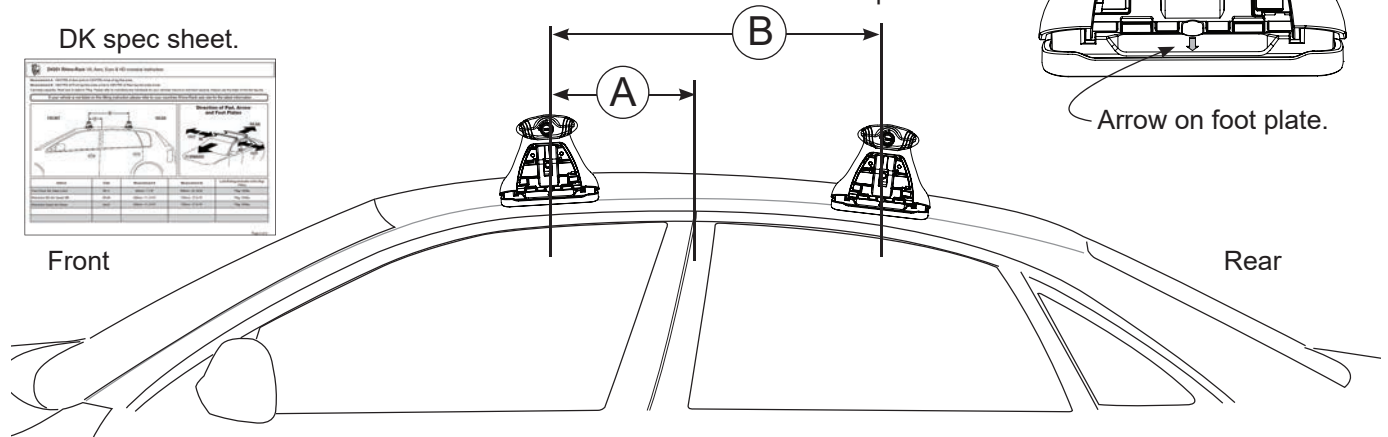
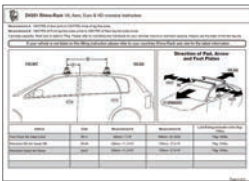

11 Positioning decals:

Stick the white arrow decals in line with foot plate arrows onto the body work inside the door jamb. This marks reference points for future use when racks are removed and then replaced.

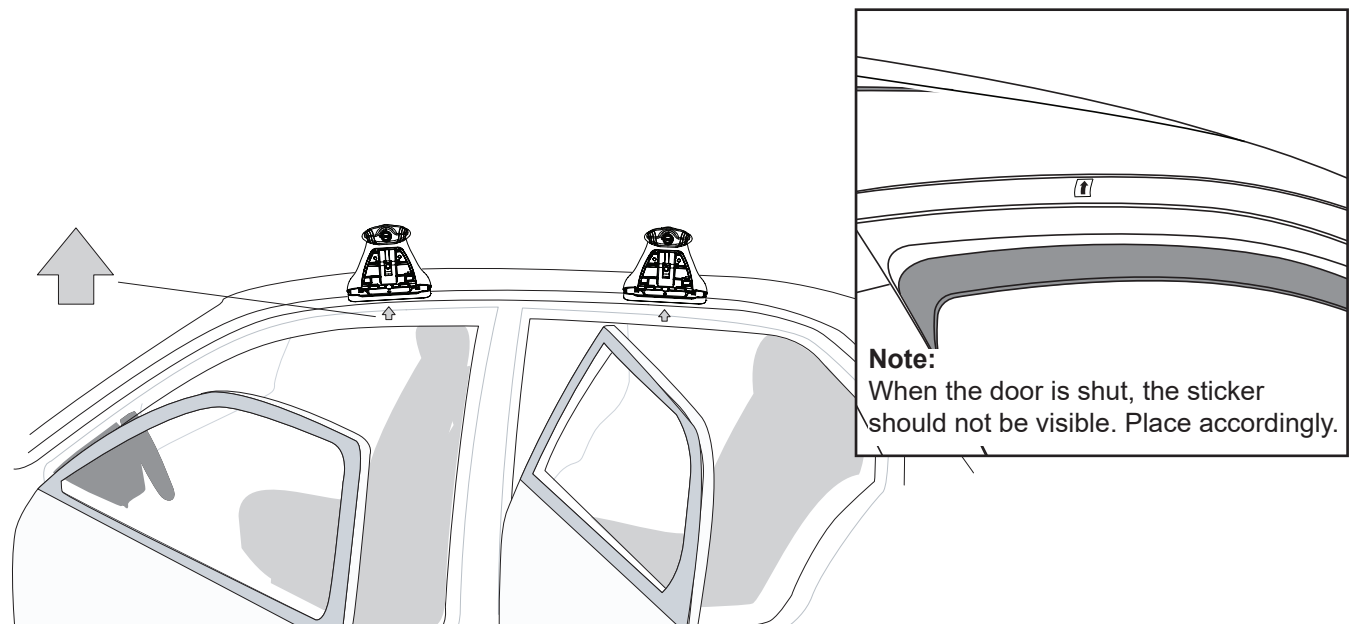

Note:
When the door is shut, the sticker should not be visible. Place accordingly.



Rhino 2500 Series

12

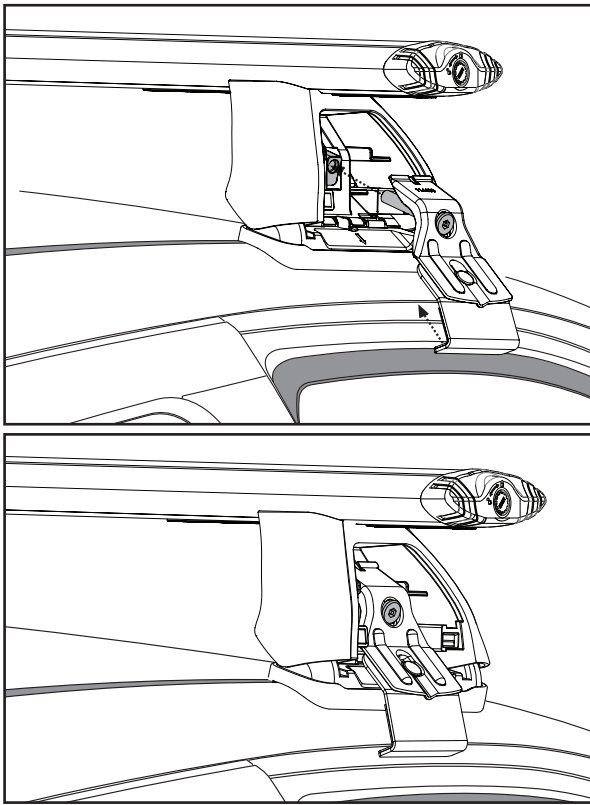

Attach clamps:

Hook the lower part of the metal clamp in at the top of the door jamb. Fasten M8 bolt to pivot nut.

Bolts must be tensioned evenly each side of the vehicle to avoid pulling the rack to one side.

Tighten to 4-5 Nm (35-44 lbf.in). DO NOT OVER TIGHTEN.

Refer to DK instruction for correct clamp and pad combination for front and rear of vehicle.

Check that the assembly is tight by shaking the crossbars vertically and horizontally

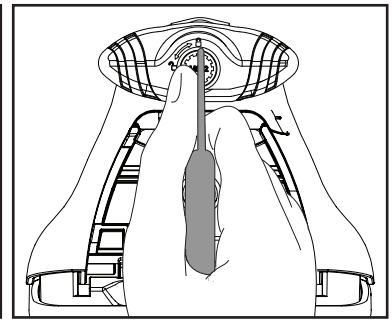
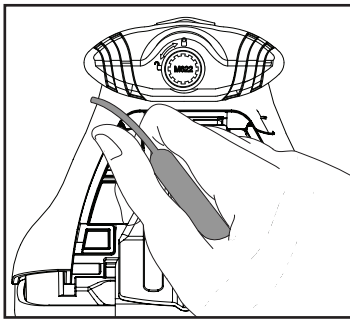
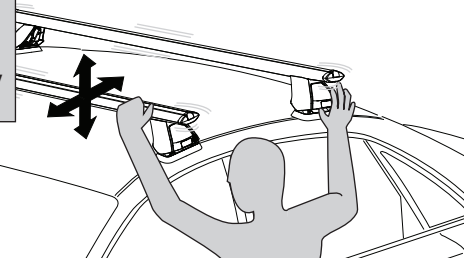

13

Visually inspect and ensure that the clamp is correctly seated against the body of the vehicle.

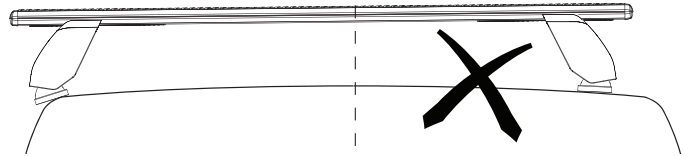
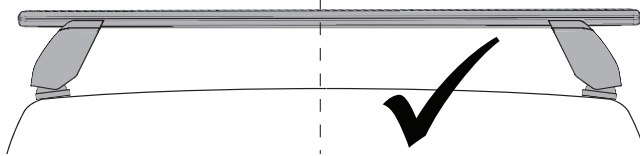

Side View: The clamp must have full contact along its face.

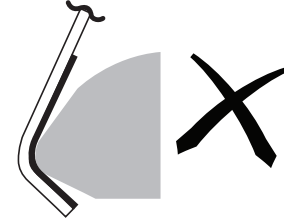
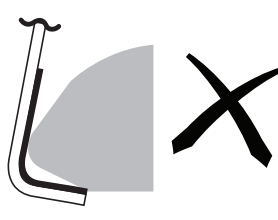
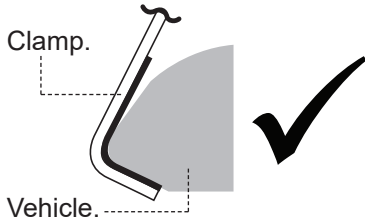

14

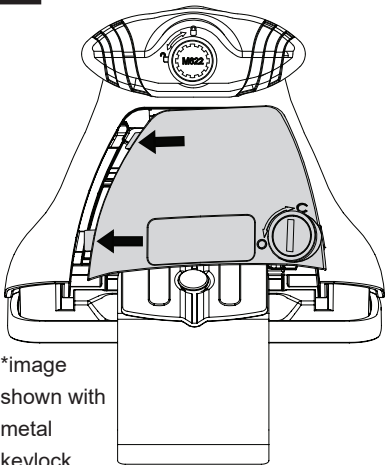

Front cover key

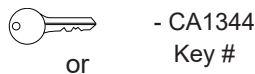

or



Plastic key - M314

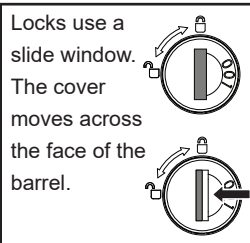

*image shown with metal keylock

15

Insert the two lugs on left side of front cover into the leg. Use key provided to turn lock barrel to the open position (O). Engage locking tab into leg. Turn to close (C).

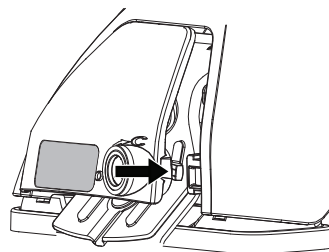

Open.

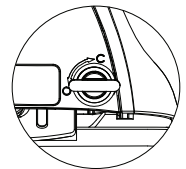

Closed.

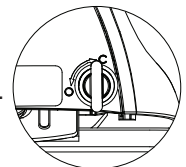
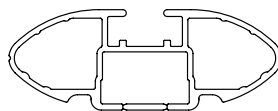

*image shown with plastic keylock



DK294 Rhino-Rack VA, Aero, Euro & HD crossbar instruction

IDENTIFICATION CHART



VA crossbar

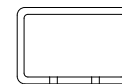

EB Steel Euro crossbar

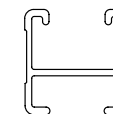

HD crossbar

Check Rhino Rack website to ensure these are the latest issue of instructions to suit the fit for the vehicle.

Vehicle	Date	Crossbar	FRONT CROSSBAR					REAR CROSSBAR				
			Front Right Pad/Clamp	Front Left Pad/Clamp	Measurement strip length per side	Measurement strip length per side	Measurement Distance (x)	Foot plate arrow direction	Rear Right Pad/Clamp	Rear Left Pad/Clamp	Measurement strip length per side	Measurement strip length per side
Ford Ranger PX Double Cab	2011-	1260mm	M367 SUB0146	191mm	191mm	1040mm / 40,15/16"	OUT	M367 SUB0145	180mm	180mm	1020mm/ 40,3/16"	OUT
			Arrow FORWARD					Arrow FORWARD				
Ford Ranger PX Double Cab (single FRONT bar)	2011-	1260mm	M367 SUB0146	191mm	191mm	1040mm/ 40,15/16"	OUT	N/A	N/A	N/A	N/A	N/A
			Arrow FORWARD					N/A				
Ford Ranger PX Double Cab (single REAR bar)	2011-	1260mm	N/A	N/A	N/A	N/A	N/A	M367 SUB0145	180mm	180mm	1020mm/ 40,3/16"	OUT
			N/A					Arrow FORWARD				
Mazda BT50 Dual Cab	2011-	1260mm	M367 SUB0146	191mm	191mm	1040mm/ 40,15/16"	OUT	M367 SUB0145	180mm	180mm	1020mm/ 40,3/16"	OUT
			Arrow FORWARD					Arrow FORWARD				
Mazda BT50 Dual Cab (single FRONT bar)	2011-	1260mm	M367 SUB0146	191mm	191mm	1040mm/ 40,15/16"	OUT	N/A	N/A	N/A	N/A	N/A
			Arrow FORWARD					N/A				



DK294 Rhino-Rack VA, Aero, Euro & HD crossbar instruction

Measurement A: CENTRE of door jamb to CENTRE arrow of leg foot plate.

Measurement B: CENTRE of Front leg foot plate arrow to CENTRE of Rear leg foot plate arrow.

Carrying capacity: Roof rack is rated to 75kg. Please refer to manufacturers handbook for your vehicles maximum roof load capacity. Always use the lower of the two figures.

If your vehicle is not listed on this fitting instruction please refer to your countries Rhino-Rack web site for the latest information.

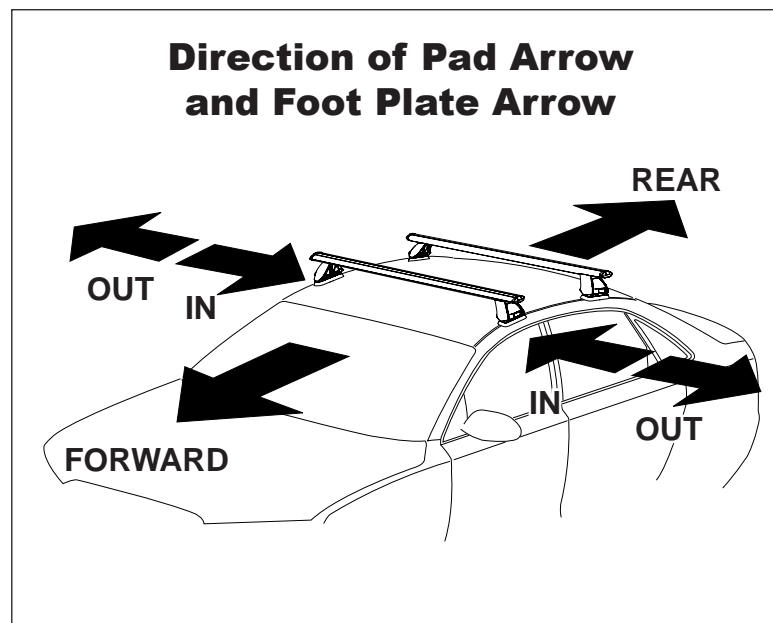
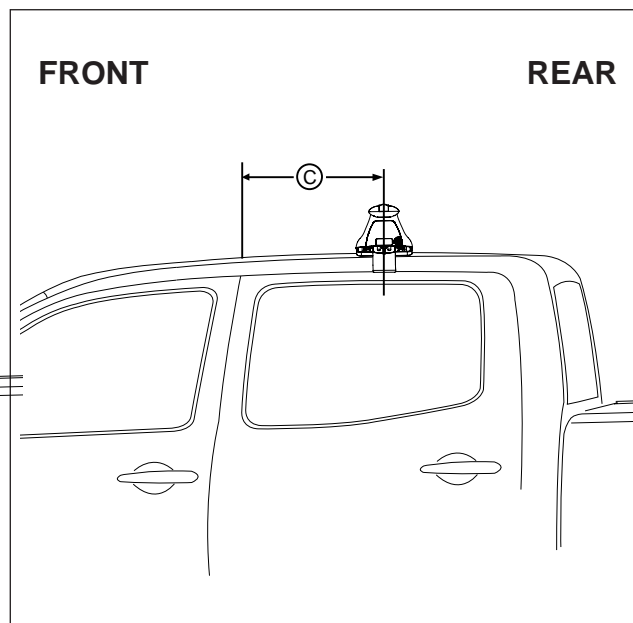
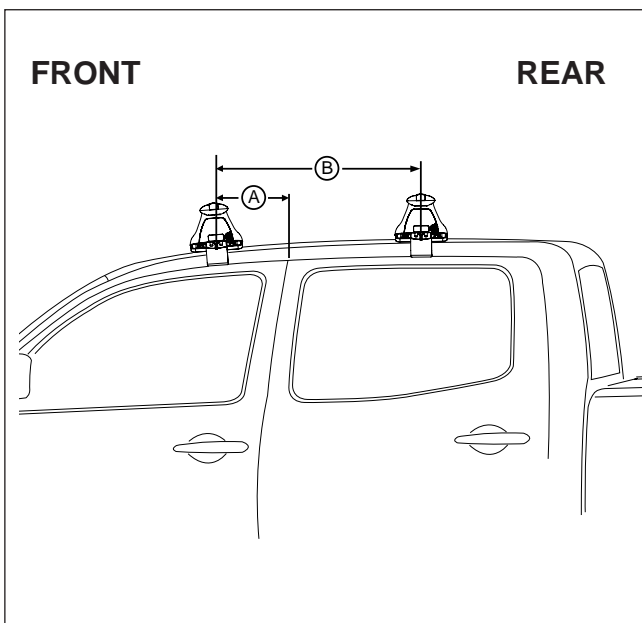

VEHICLE	Date	Measurement A	Measurement B	Measurement C	Load Rating (includes racks 5kg/ 11lbs)
Ford Ranger PX Double Cab	2011-	200mm / 7,7/8"	800mm / 31,1/2"	N/A	75kg / 165lbs
Ford Ranger PX Double Cab (single FRONT bar)	2011-	200mm / 7,7/8"	N/A	N/A	35kg / 77lbs
Ford Ranger PX Double Cab (single REAR bar)	2011-	N/A	N/A	600mm / 23,5/8"	35kg / 77lbs
Mazda BT50 Dual Cab	2011-	200mm / 7,7/8"	800mm / 31,1/2"	N/A	75kg / 165lbs
Mazda BT50 Dual Cab (single FRONT bar)	2011-	200mm / 7,7/8"	N/A	N/A	35kg / 77lbs
Mazda BT50 Dual Cab (single REAR bar)	2011-	N/A	N/A	600mm / 23,5/8"	35kg / 77lbs



RHINO-RACK

ROC25 Vortex Crossbar Overhang - RLKVO/H

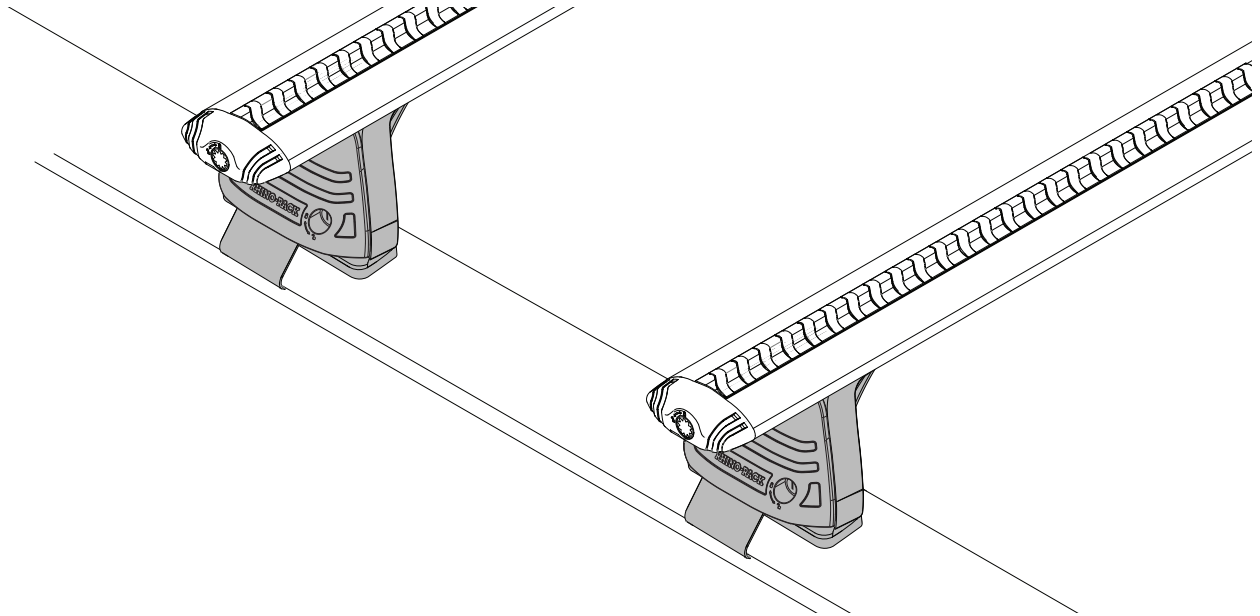

Important Information

Maximum carrying capacity:

On Road Cargo Allowance	Off Road Cargo Allowance	Roof Allowance	Rack Weight
70kg / 154lb	35kg / 77lbs	75kg / 165lbs	5kg / 11lbs

- Off Road:** Any driven path taken that is not on sealed (tared / bitumen) and maintained
- Roof Allowance:** Total permissible weight attached to the roof of the car. This is inclusive of the weight of the roof rack system
- Cargo Allowance:** Total permissible weight allowed on top, and attached to roof racks whilst the vehicle is in motion
- Static Allowance:** Total permissible weight allowed on top, and attached to roof racks whilst the vehicle is stationary
- Load must be evenly distributed over the entire system. Weight of roof rack accessories is to be included in cargo allowance.

Torque settings

Unless stated otherwise in these instructions, all fasteners should be set to the following torque settings - M6: 4-5Nm (3-4lbs/ft), M8: 8-10Nm (6-7.5lbs/ft) and M10: 16-18Nm (12-13lbs/ft).

Warning:

- Check the Rhino-Rack website to ensure you have the latest issue of the instructions
- Check Part No. and / or Kit is correct for use with your vehicle
- Do not attempt to fit the rack system to your vehicle unless you fully understand these fitting instructions. Please direct any questions regarding fitting to the dealer from where the roof racks were purchased.
- **Use only non-stretch fastening ropes or straps.**
- The handling characteristics of the vehicle changes when you transport a load on the roof. For safety reasons we recommend you exercise extreme care when transporting wind-resistant loads. Special consideration must be taken into account when cornering and braking.
- Although the system is tested and approved to AS1235-2000 / ISO 11154, off-road conditions can be much more rigorous. Extreme care must be taken in off road conditions

Recommendations:

It is essential that all bolt connections be checked after driving a short distance when you first install your roof racks. Bolt connections should be checked again at regular intervals (once a week is enough, depending on road conditions, usage, loads and distances travelled). You should also check the roof racks each time they are re-fitted. Always make sure to fasten your load securely. Please also ensure that all loads are evenly distributed and that the centre of gravity is kept as low as possible and must be entirely contained within the extents of the roof racks.

Note for Dealers and Fitters:

It is your responsibility to ensure these fitting instructions are given to the end user or client.

ROC25 Vortex Crossbar Overhang - RLKVO/H

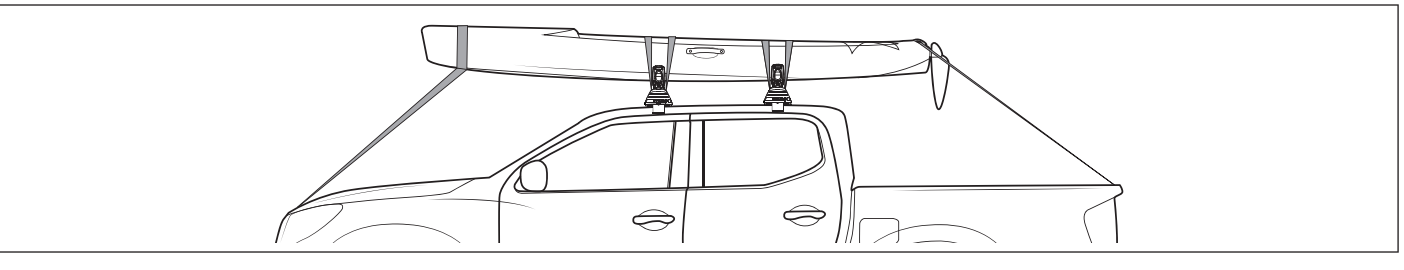
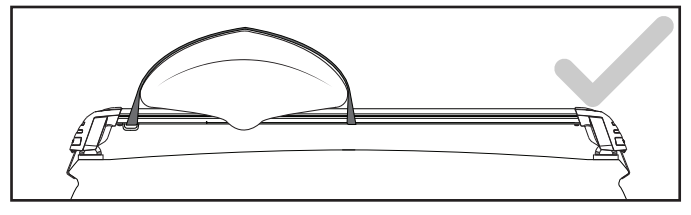
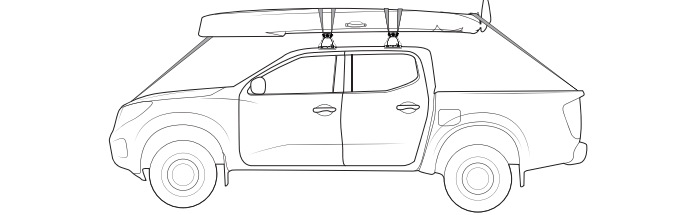
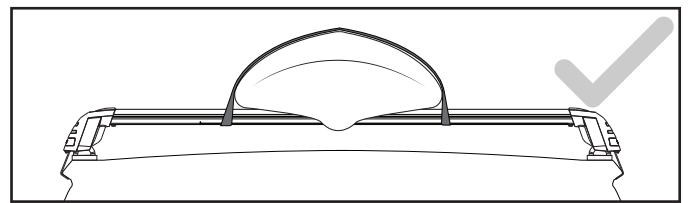
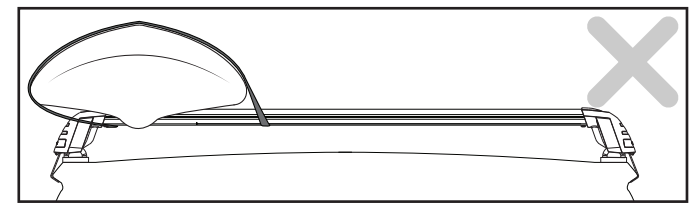
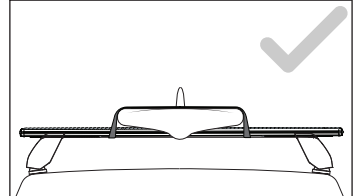
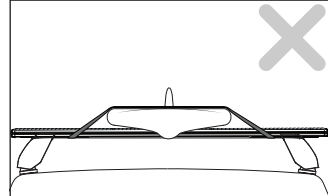
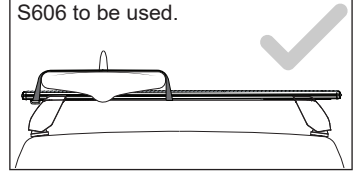
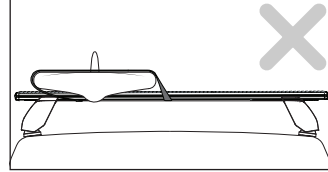
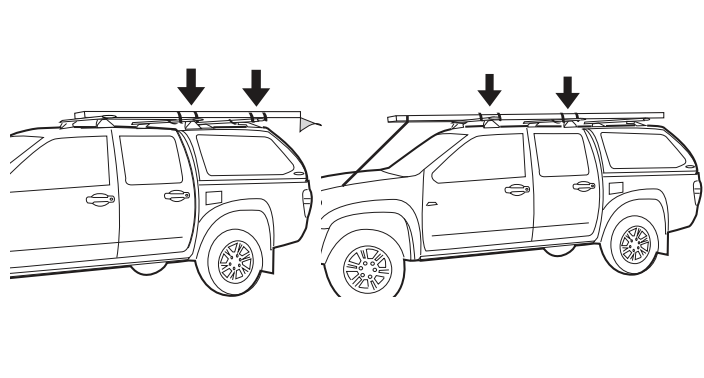
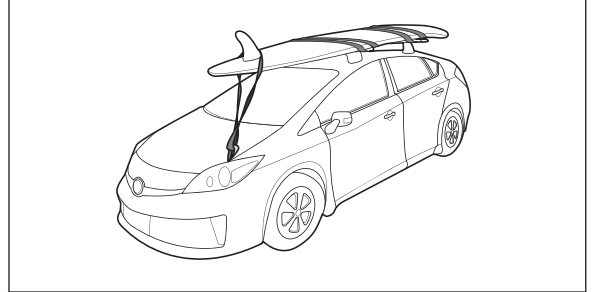
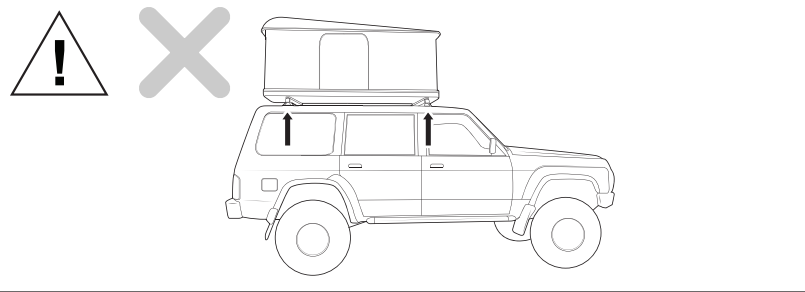
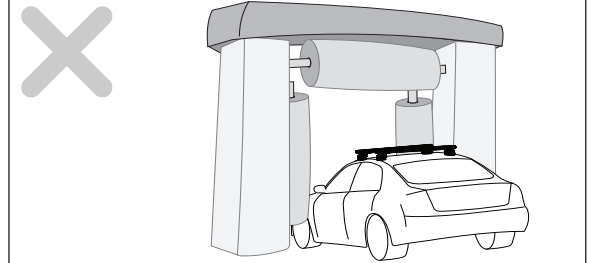
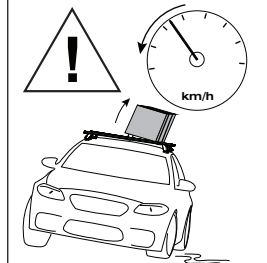
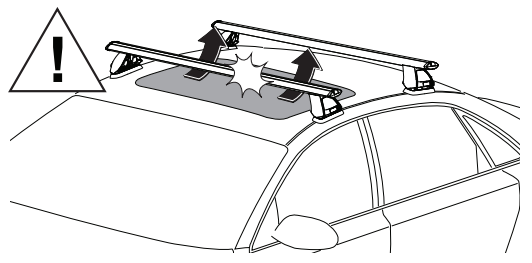
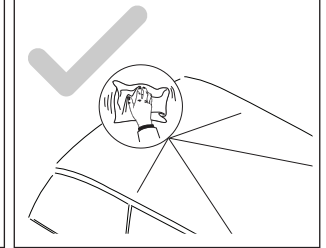
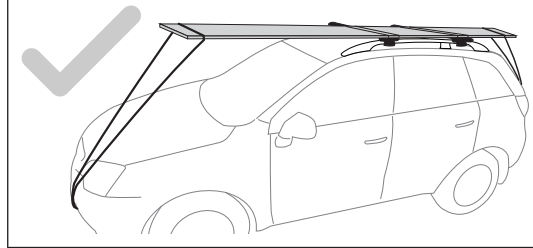
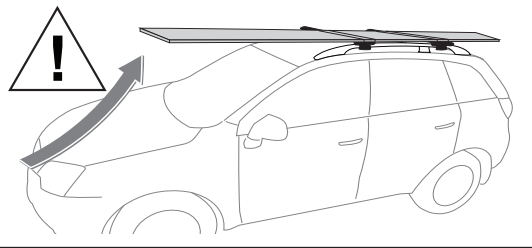

ROC25 Vortex Crossbar Overhang - RLKVO/H

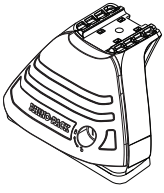

Leg kit

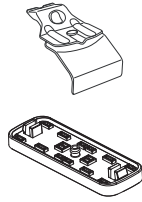

DK Pad & clamp kit

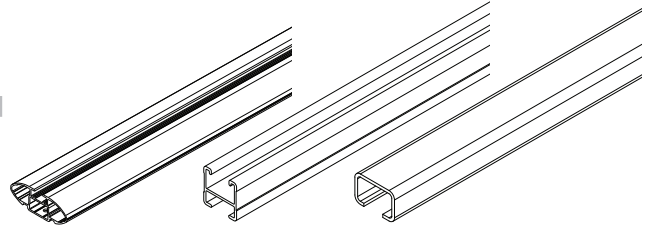

Vortex, Heavy Duty & Steel Euro Crossbars and adaptor kits

Parts List

Item	Component Name	1 Bar	2 Bar	Part No.
1	Torque Allen Key	1	1	TORKEY-L
2	M8 Pivot Nut	2	4	N047
3	M8 x 57mm Attachment Bolt	2	4	B154
4	Cover Plate Standard	2	4	M885
5	ROC25 Leg Overhang	2	4	M884
6a	Key and Barrel	2	2	CA1339-BK
6b	Barrel	2	2	CA1339-B
7	Arrow Label	2	4	S364
8	Leg Location Label	2	4	S365
9	Base	2	4	M311
10	M6 Nut 24x 24 x 4mm	2	4	N068
11	M6 Flat Washer	2	4	W031
12	M6 Spring Washer	2	4	W004
13	M6 x 20mm Skt Head Screw	2	4	B054
14	Fitting Instruction	1	1	R1798

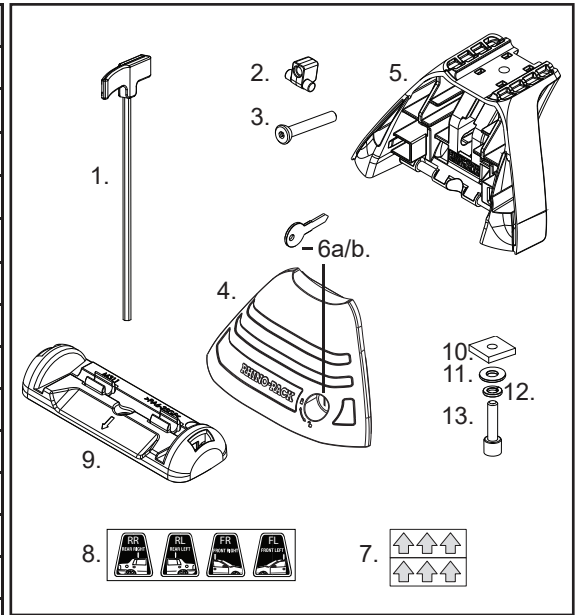

Note: Crossbars require purchase of leg kit, pad/ DK clamp kit and VA crossbars.

Instructions

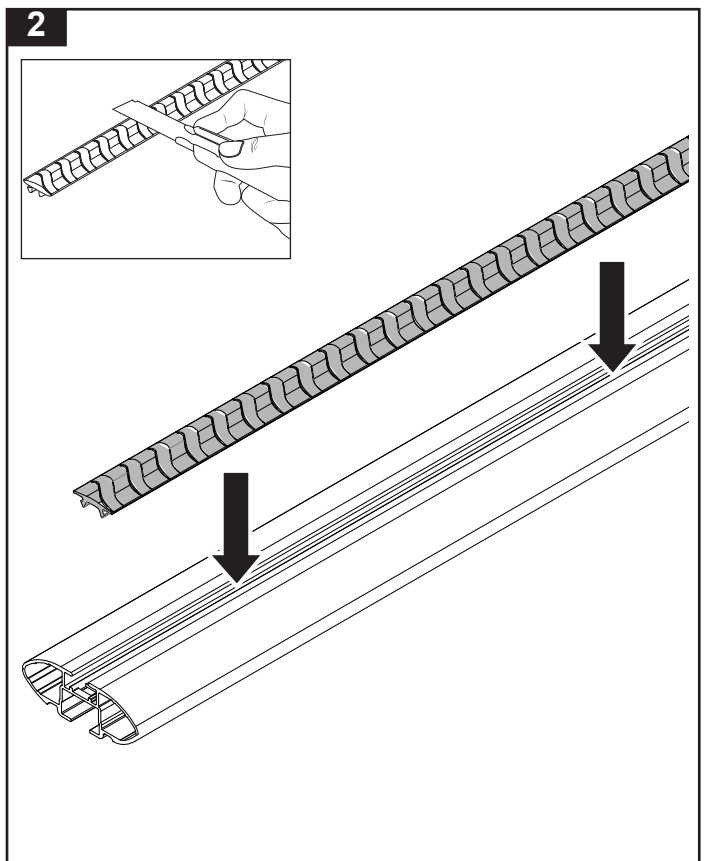
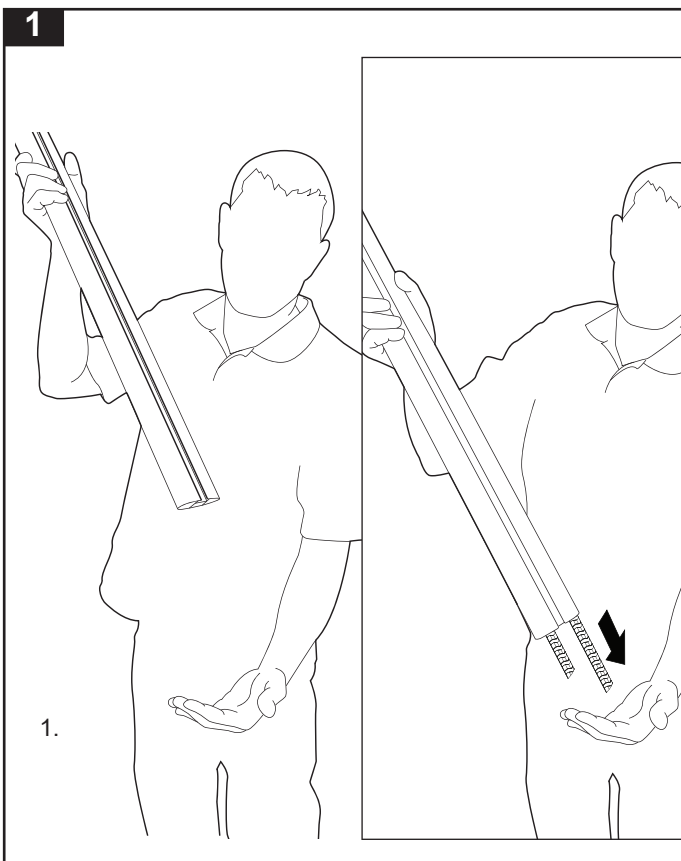

ROC25 Vortex Crossbar Overhang - RLKVO/H

3

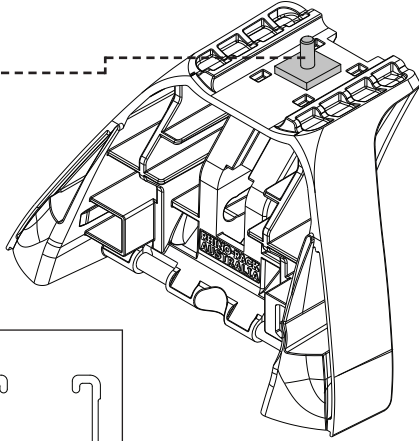
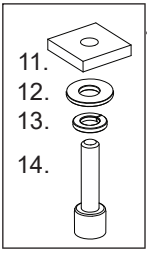

Pg 8.

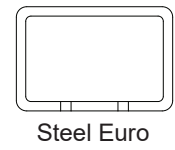

Steel Euro

Heavy Duty

4

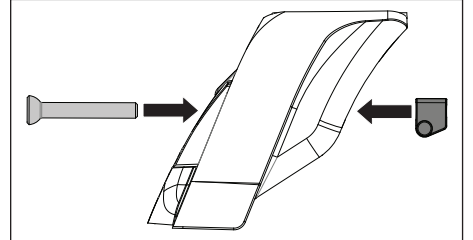
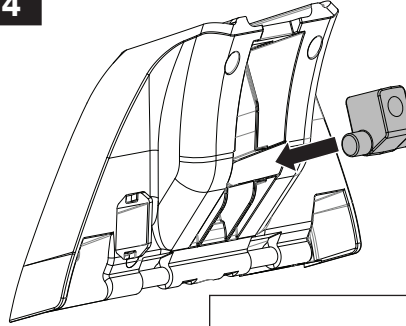

4a

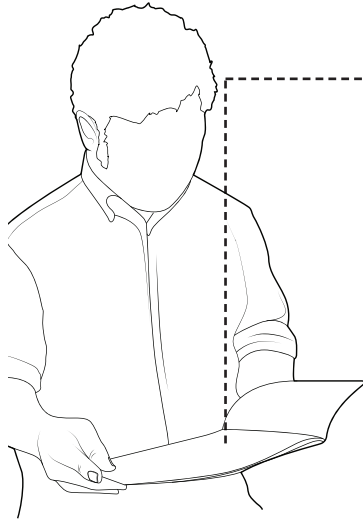

DK -Example

CROSSBAR IDENTIFICATION

		VA crossbar		Steel Euro crossbar		EURO crossbar		HD crossbar	
		FRONT CROSSBAR				REAR CROSSBAR			
Vehicle	Size	Front Right Pad/Clamp	Front Left Pad/Clamp	Measurement (mm)	Measurement (mm)	Rear Right Pad/Clamp	Rear Left Pad/Clamp	Measurement (mm)	Measurement (mm)
Holmen Composites Hatch	15	M282	M281	177mm	84mm	M284	M283	167mm	97mm / 38.5"16"
Black Regel Sportlink									
Opel Insignia Sportlink									
Visual Regras Clearpoint	17	Pad Arrows FORWARD				Pad Arrows FORWARD			

Document No. 81778 Issue: 1: 15 May 2018 Page: 1 of 2

Front Right Pad/Clamp	Front Left Pad/Clamp
M282	M281
SUB0612	SUB0612

Rear Right Pad/Clamp	Rear Left Pad/Clamp
M284	M283
SUB0612	SUB0612

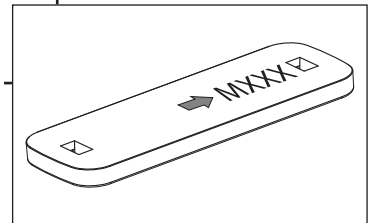
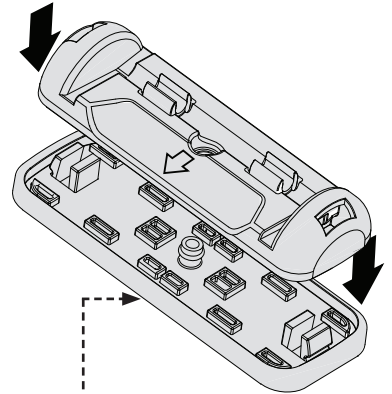

4b

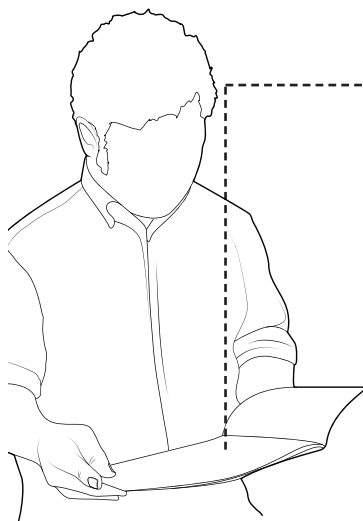

DK -Example

CROSSBAR IDENTIFICATION

		VA crossbar		Steel Euro crossbar		EURO crossbar		HD crossbar	
		FRONT CROSSBAR				REAR CROSSBAR			
Vehicle	Size	Front Right Pad/Clamp	Front Left Pad/Clamp	Measurement (mm)	Measurement (mm)	Rear Right Pad/Clamp	Rear Left Pad/Clamp	Measurement (mm)	Measurement (mm)
Holmen Composites Hatch	15	M365	M365	1010mm	114490	M365	M365	1010mm	114490
Black Regel Sportlink									
Opel Insignia Sportlink									
Visual Regras Clearpoint	17	Pad Arrows FORWARD				Pad Arrows FORWARD			

Document No. 81778 Issue: 1: 15 May 2018 Page: 1 of 2

Measurement distance (x)	Foot plate arrow direction	Rear Right Pad/Clamp
1010mm	IN	M365
		114490
		Arrow FORW
		M365
		114490
		OUT

Measurement distance (x)	Foot plate arrow direction	Rear Left Pad/Clamp
1010mm	OUT	M365
		114490
		Arrow FORW
		M365
		114490
		OUT

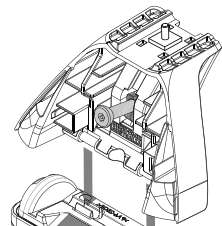

OR

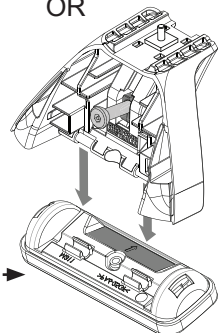

ROC25 Vortex Crossbar Overhang - RLKVO/H

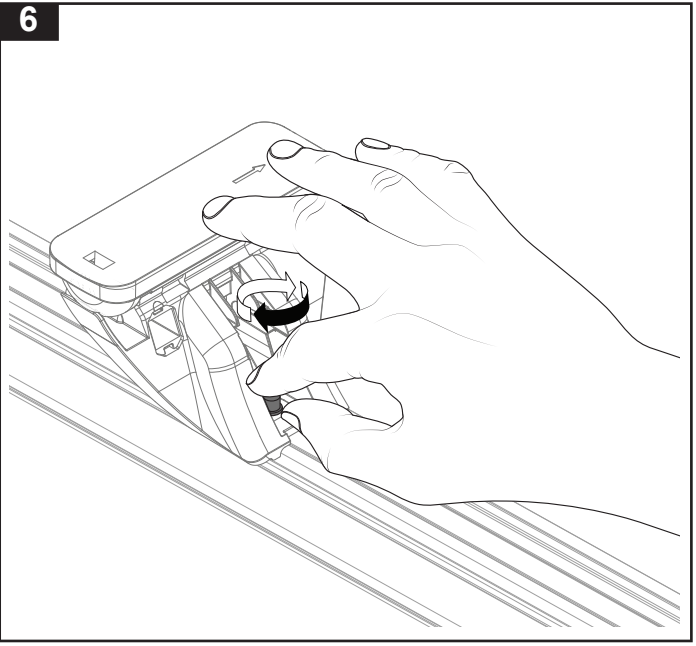
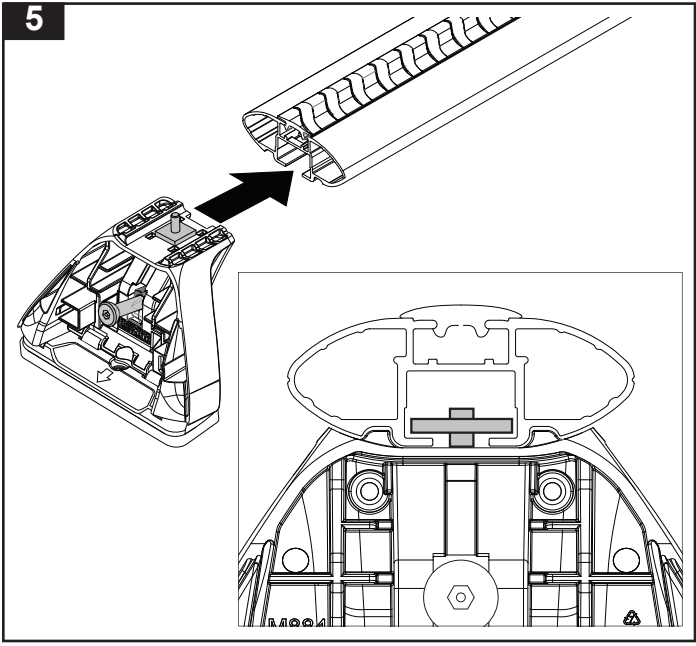

7

DK -Example instruction

		FRONT CROSSBAR				REAR CROSSBAR			
Vehicle	Year	Clamp	Part No.	Measurement per side	Measurement per side	Part No.	Measurement per side	Measurement per side	Part No.
Subaru 200	05-08	100mm	M367	14500	181mm	M699	14500	115mm	B0552
Subaru 200	09-12	100mm	M367	14500	181mm	M699	14500	115mm	B0552
Subaru 200	13-15	100mm	M367	14500	181mm	M699	14500	115mm	B0552
Subaru 200	16-18	100mm	M367	14500	181mm	M699	14500	115mm	B0552
Subaru 200	19-21	100mm	M367	14500	181mm	M699	14500	115mm	B0552
Subaru 200	22-23	100mm	M367	14500	181mm	M699	14500	115mm	B0552
Subaru 200	24-27	100mm	M367	14500	181mm	M699	14500	115mm	B0552

VA EU

Front Left Pad/Clamp	Measurement strip length per side	Measurement strip length per side
M367 14500	181mm	6

VA EU

Rear Left Pad/Clamp	Measurement strip length per side	Measurement strip length per side
M699 B0552	115mm	

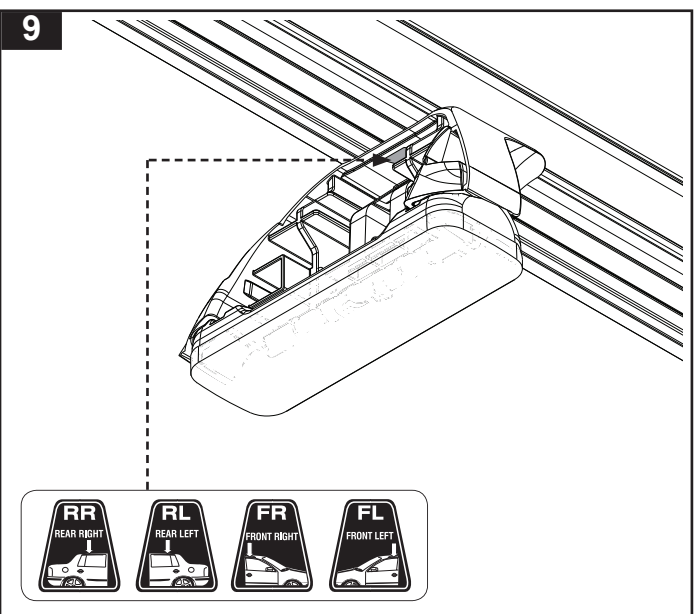
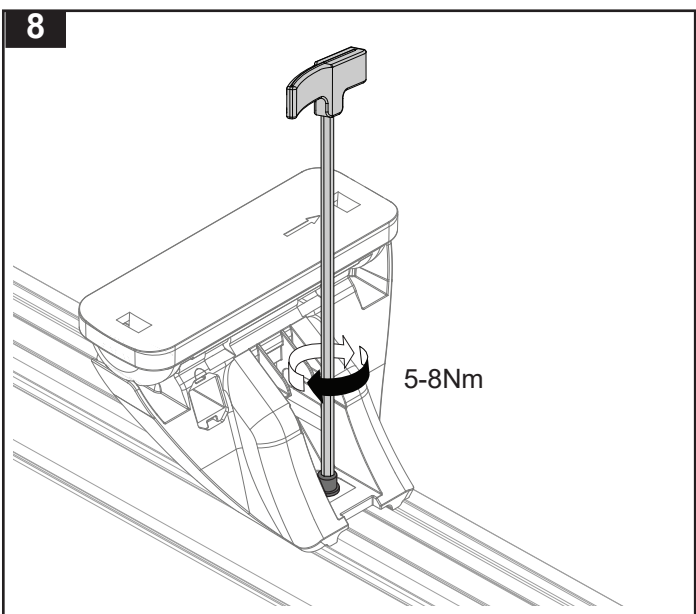

ROC25 Vortex Crossbar Overhang - RLKVO/H

10

DK-Example instruction

CENTRE of base plate to CENTRE of roof rack base.

CENTRE of front leg foot plate area to CENTRE of Rear leg foot plate area.

Roof rack to be used to 75kg. Please refer to manufacturer's handbook for your vehicle's maximum roof load capacity. Always use the lower of the two figures.

Roof is not listed on this fitting instruction please refer to your country's Rhino-Rack web site for the latest information.

Direction of Pad, Arrow and Foot Plates

FRONT REAR FORWARD REAR

Vehicle	Date	Measurement A	Measurement B	Load Rating (includes racks & Shg)
Ford Focus SW Hatch L5&V	05-11	200mm / 7,7/8"	650mm / 25,19/32"	15kg / 105kg
Mitsubishi 200-4dr Sedan CB	05-08	300mm / 11,13/16"	700mm / 27,9/16"	15kg / 105kg
Mitsubishi Galant 4dr Sedan	04-07	300mm / 11,13/16"	700mm / 27,9/16"	15kg / 105kg

Page 2 of 2

Measurement A

200mm / 7,7/8"

300mm / 11,13/16"

300mm / 11,13/16"

Measurement B

650mm / 25,19/32"

700mm / 27,9/16"

700mm / 27,9/16"

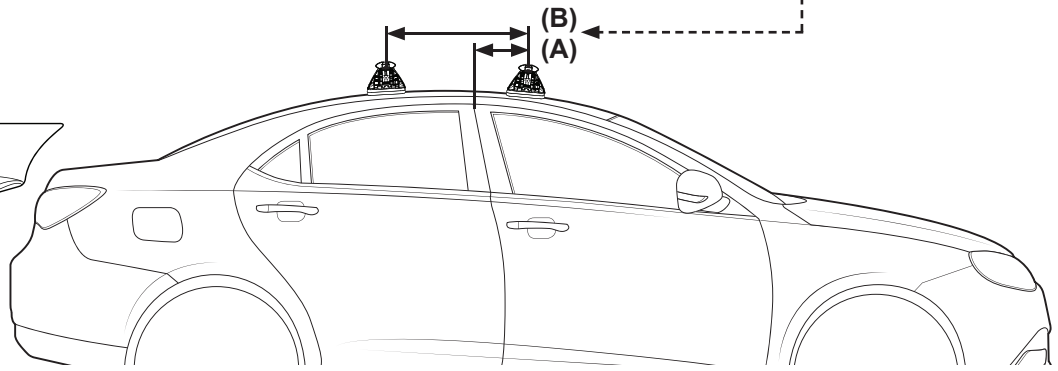
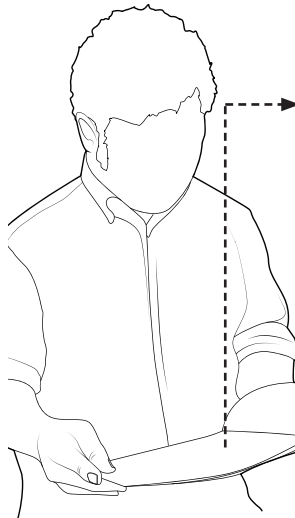

11

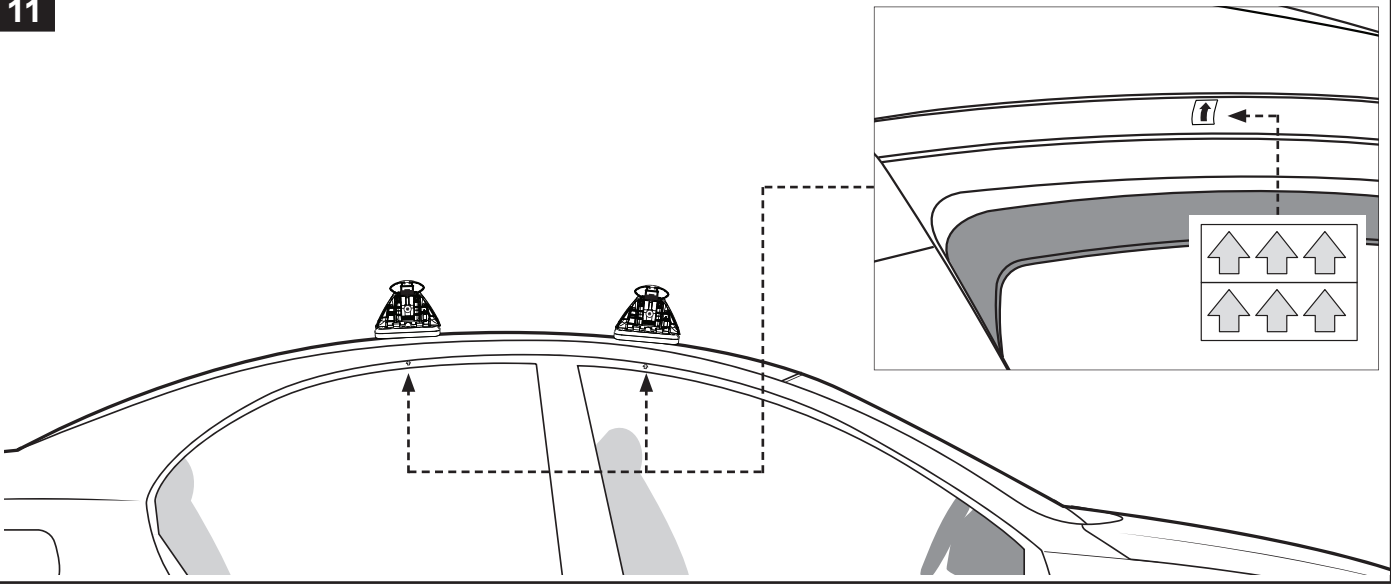

12

DK-Example instruction

IDENTIFICATION CHART

Vehicle	Date	FRONT CROSSBAR				REAR CROSSBAR				Particulars (see manual)
		Part	Ref. No.	Measurement	Attachment	Part	Ref. No.	Measurement	Attachment	
Ford Focus SW Hatch L5&V	05-11	M367	114500	180mm	100mm	M367	114490	180mm	100mm	OUT
Mitsubishi 200-4dr Sedan CB	05-08	M365	114490	180mm	70mm	M365	114490	180mm	50mm	OUT
Mitsubishi Galant 4dr Sedan	04-07	M365	114490	180mm	70mm	M365	114490	180mm	50mm	OUT

Page 1 of 2

Front Right Pad/ Clamp

M367 114500

Front Left Pad/ Clamp

M367 114500

Arrow FORWARD

M367 M367

Rear Right Pad/ Clamp

M365 114490

Rear Left Pad/ Clamp

M365 114490

Arrow FORWARD

M365 M365

ROC25 Vortex Crossbar Overhang - RLKVO/H

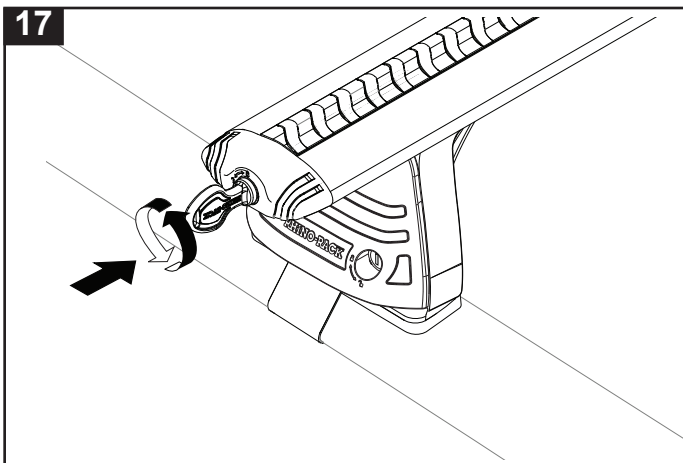
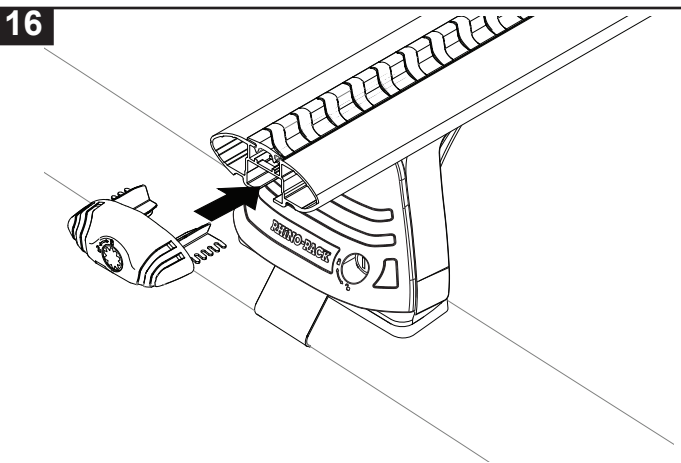
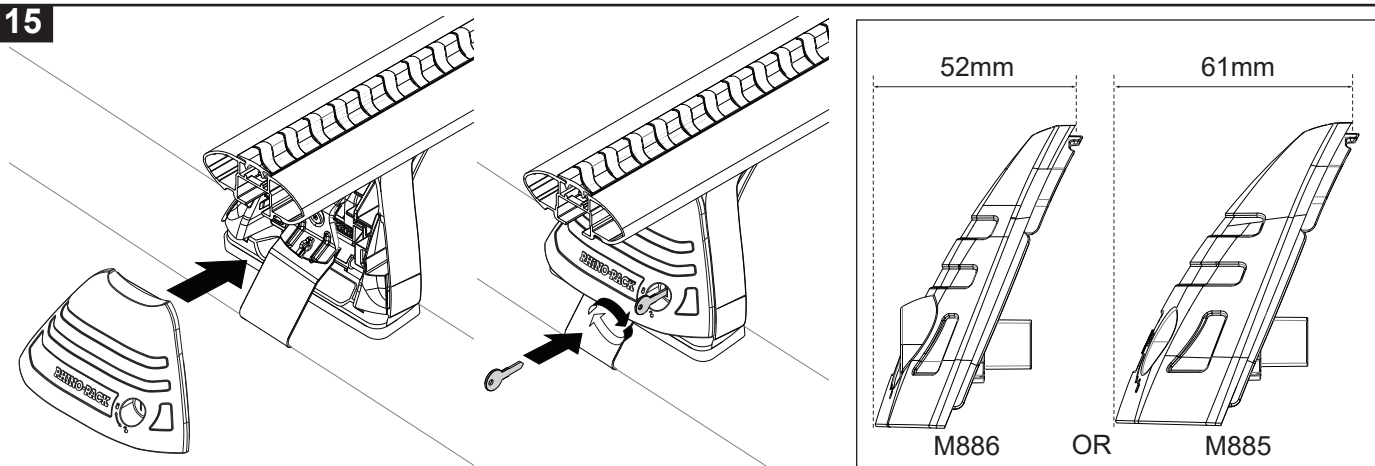
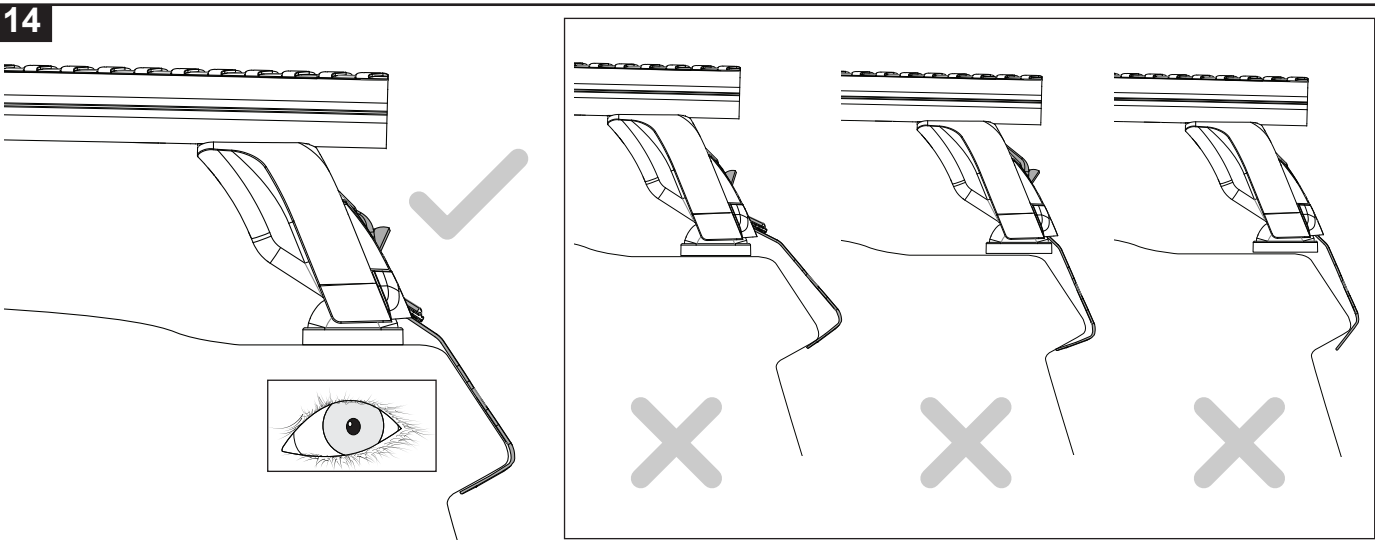
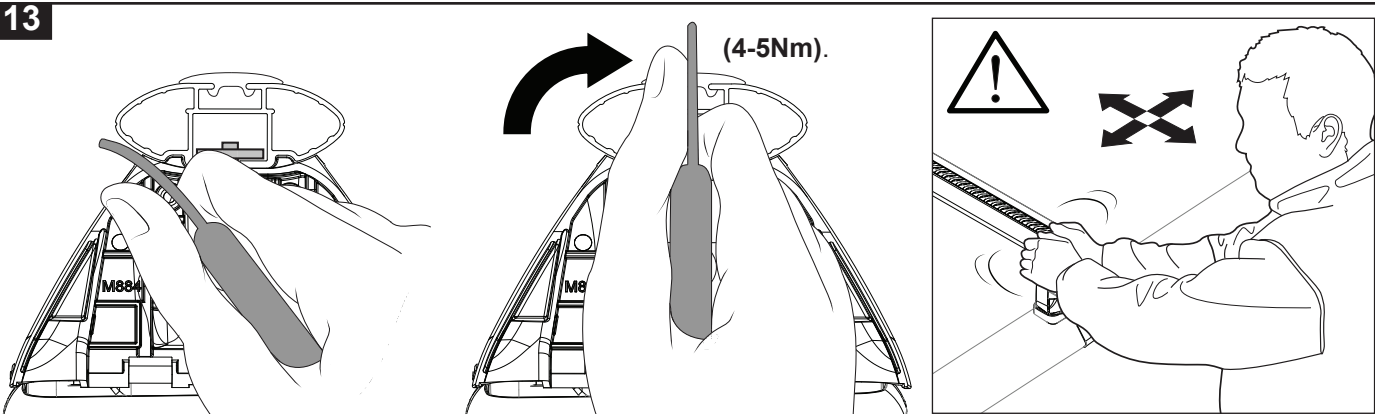

ROC25 Vortex Crossbar Overhang - RLKVO/H

Vortex

Sold as separate*

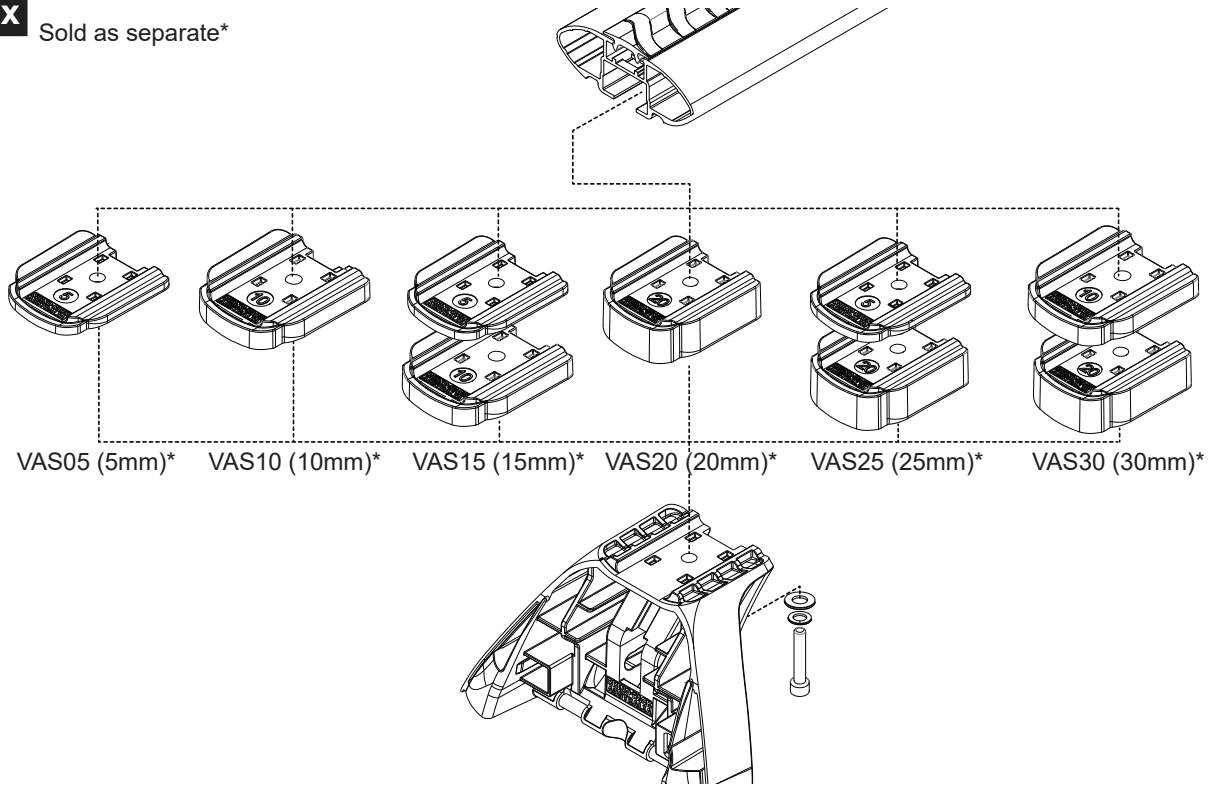

Heavy Duty

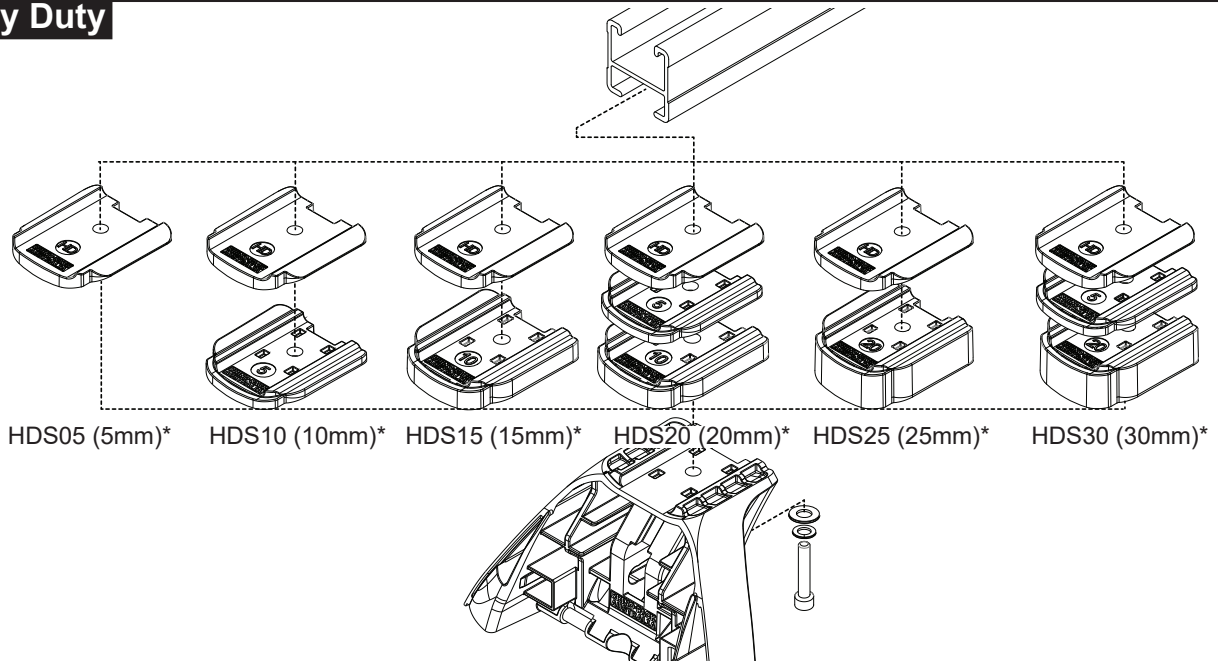

Steel Euro

