

# INSTALLATION & CARE

## 2017-2019 FORD F250 PROJECTOR HEADLIGHTS INSTALLATION INSTRUCTIONS

### BEFORE INSTALLATION:

- If you experience any difficulties that the instructions did not cover, please seek assistance at a local automotive shop.
- Please wear proper protective equipment before you work on any vehicle.
- An assistant is recommended when removing the front bumper from your vehicle.
- Please be cautious when working with the bumper or any parts belonging to the vehicle's body to prevent scratching.
- Do not make direct contact with the halogen bulbs or the wire assembly until the unit has cooled down after use.

### TOOLS AND SUPPLIES REQUIRED

1/4" Ratchet	1/2" Socket	10 mm Socket	1/4" Socket Extension
			
Trim Pad Remover	12" Flathead Screwdriver		
			

### PRODUCT NUMBER

2LHP-F25017-TM  
2LHP-F25017JM-TM

2LHP-F25017G-TM  
2LHP-F25017BK-TM



### LET'S START THE INSTALLATION



STEP 1

Remove the thirteen plastic fastener clips

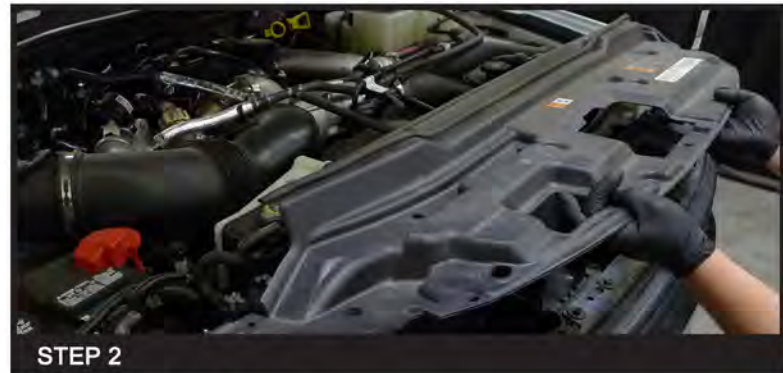

STEP 2

Remove the plastic radiator cover



STEP 3

Remove the eight 10mm front grille mounting bolts at the top



STEP 4

Gently pull out the top and the side of the front grille, access the bottom lock clip from the top



STEP 5A

Use a flathead screwdriver to push down to release the four clips at the bottom



**STEP 5B**

Use a flathead screwdriver to push down to release the four clips at the bottom



**STEP 5C**

Use a flathead screwdriver to push down to release the four clips at the bottom



**STEP 6**

Remove the front grille



**STEP 7**

Remove the 10mm headlight mounting bolt at the bottom of the headlight



**STEP 8**

Remove the two 10mm headlight mounting bolts at the side of the grille



**STEP 9**

Remove the 10mm headlight mounting bolt at the top of the headlight



**STEP 10**

Unseat the factory headlight housing



**STEP 11**

Disconnect the headlight harness and remove the factory headlight housing



**STEP 12A**

Use the quick connectors to tap the wire plug to the car signal light wires



**STEP 12B**

The black tap to the black yellow, and the yellow tap to the blue green



**STEP 12C**

The black tap to the black yellow, and the yellow tap to the blue green



**STEP 13**

Connect the wires plug to the new headlight housing



**STEP 14**

Reconnect the headlight harness to the new headlight housing



**STEP 15**

Seat the new headlight assembly in place



**STEP 16A**

Remove the T25 screw from the factory headlight housing



**STEP 16B**

Remove the headlight trim from the factory headlight housing



**STEP 17**

Install the headlight trim to the new headlight housing



**STEP 18**

Tighten the T25 screw



**STEP 19**

Reinstall the two 10mm headlight mounting bolts at the side of the grille

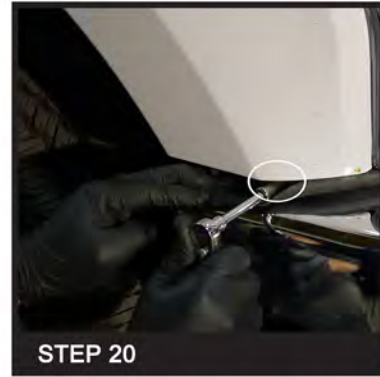

**STEP 20**

Reinstall the 10mm headlight mounting bolt at the bottom of the headlight



**STEP 21**

Reinstall the 10mm headlight mounting bolt at the top of the headlight



**STEP 22**

Please repeat the steps from 7 to 21 for the opposite side

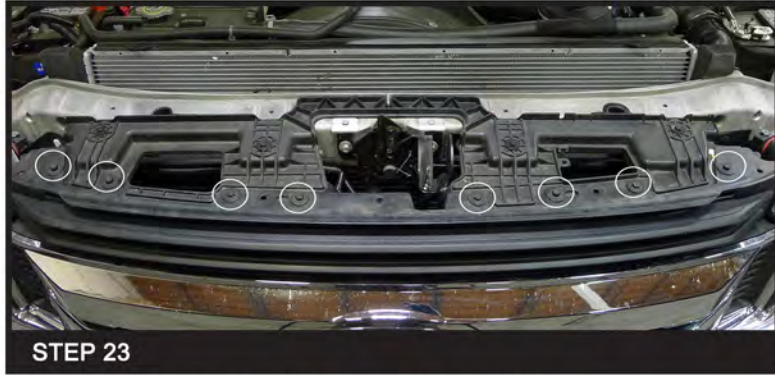

**STEP 23**

Reinstall the eight 10mm front grille mounting bolts at the top

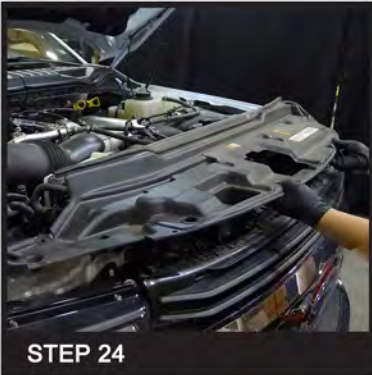

**STEP 24**

Reinstall the plastic radiator cover



**STEP 25**

Reinstall the thirteen plastic fastener clips

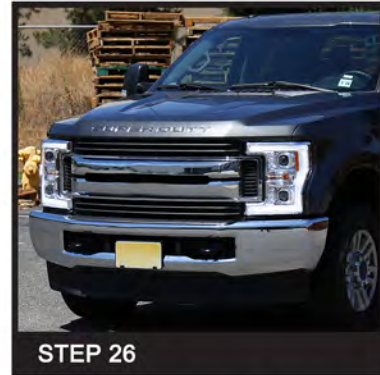

**STEP 26**

Close the hood to complete the installation



# INSTALLATION & CARE

## 2017-2019 FORD F250 PROJECTOR HEADLIGHTS INSTALLATION INSTRUCTIONS

### BEFORE INSTALLATION:

- If you experience any difficulties that the instructions did not cover, please seek assistance at a local automotive shop.
- Please wear proper protective equipment before you work on any vehicle.
- An assistant is recommended when removing the front bumper from your vehicle.
- Please be cautious when working with the bumper or any parts belonging to the vehicle's body to prevent scratching.
- Do not make direct contact with the halogen bulbs or the wire assembly until the unit has cooled down after use.

## 2017-2019 FORD F250 PROJECTOR HEADLIGHTS INSTALLATION INSTRUCTIONS

### HIGH BEAM/LOW BEAM ADJUSTERS



Learn more about custom and factory headlights we have.