

Installation instructions

FPW13 - HARNESS

WIRE COLOR AND FUNCTION

Color	New harness description	Color	Original harness description
Red	Pump Positive (Larger gauge wire)	Gray	Pump Positive (Larger gauge wire)
Black	Pump Negative (Larger gauge wire)	Black	Pump Negative (Larger gauge wire)
Blue	Fuel Level Sender Signal (Smaller gauge wire)	Purple	Fuel Level Sender Signal (Smaller gauge wire)
Black	Fuel Level Sender Ground (Smaller gauge wire)	Black / White	Fuel Level Sender Ground (Smaller gauge wire)

Flange and pump connector with terminal lock

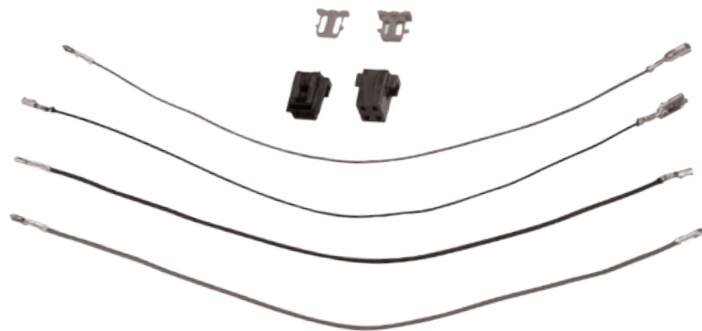

Wiring kit for pump and fuel level sender

Installation instructions

CAUTION

When fuel is involved, work in a well-ventilated area away from sparks and open flames. To eliminate the risk of fire and personal injuries, the fuel lines should be plugged or capped upon removal. Have a class "B" fire extinguisher nearby. Basic hand tools are necessary to accomplish the repair. Personal safety equipment should be used when handling flammable materials such as gasoline. Safety glasses, gloves and appropriate clothing (long sleeve shirt, pants and safety shoes) are necessary to reduce the risk of injuries. Any fuel spill must be handled and cleaned immediately. Consult manufacturer's technical repair manuals for appropriate procedures.

THIS HARNESS IS STRICTLY INTENDED FOR AUTOMOTIVE USE
NOT APPROVED FOR AIRCRAFT OR MARINE USE

Harness installation procedures

1. Follow repair manual instructions for the fuel tank removal and pump assembly.
2. Disconnect the fuel pump # 2 wire connector.
3. Disconnect the top flange # 4 wire connector.
4. Disconnect the 2 terminals from the fuel level sender.

Installing the terminals into the connector

The wire terminal will only fit the plastic connector one way.

The locking tab on the terminal (figure A) must be positioned with the small indent found on the plastic connector (figure B).

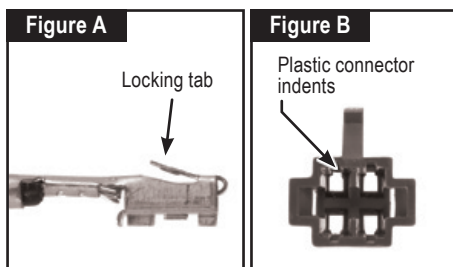

To install a TWO-WIRE connector at the pump top cover

5. Insert the BLACK wire (Larger gauge) into position opening A. (figure 2.1)
6. Insert the RED wire (Larger gauge) into position opening B. (figure 2.2)
7. Insert the smaller blue locking tab securing the terminals into the 2 wire connector. (figure 2.2)

To install a FOUR-WIRE connector at the pump top cover

8. Insert the RED and the BLACK wire (Larger gauge) into position opening E or C. (figure 4.1) Compare with original harness that was removed
9. Insert the BLUE and the BLACK wire (Smaller gauge) into position opening B or D. (figure 4.2) Compare with original harness that was removed
10. Insert the large blue locking tab securing the terminals into the 4 wire connector. (figure 4.3)

Reconnecting wiring harness to the fuel pump assembly

11. Install the 4 pin connector to the upper pump flange assembly.
12. Route the wires along the pump assembly to prevent wire interference with the float arm.
13. Connect the 2-pin connector to the fuel pump.
14. Connect the fuel level sender wires to the appropriate terminals on the rheostat. (figure 2.3)

Re-install the fuel pump assembly into the fuel tank

15. Install fuel pump assembly and tank back into the vehicle.

FOLLOW REPAIR MANUAL INSTRUCTION.

