

ASSEMBLY INSTRUCTIONS

STEP 1:

Insert one side frame (#3) into bottom frame (#5) until they are connected tightly.

STEP 2:

Insert bolt (#4) into bolt hole on bottom and side frame and tighten.

STEP 3:

Repeat step 1 with the other side frame.

STEP 4:

Repeat step 2 with the other bolt.

STEP 5:

Locate plastic tray (#2) between bottom frame (#5) until bolt holes are aligned at bottom frame.

STEP 6:

Insert casters (#6) into holes of bottom frame (#5) and insert hex nuts (#8) into holes on frame and tray. Fasten nut. Repeat this procedure on all four casters.

STEP 7:

Locate seat pad (#1) on top of both side frames (#3).

STEP 8:

Inset bolts (#9) into threaded nut holes of the pad and tighten.

STEP 9:

Now go back and tighten all loose nuts and bolts.

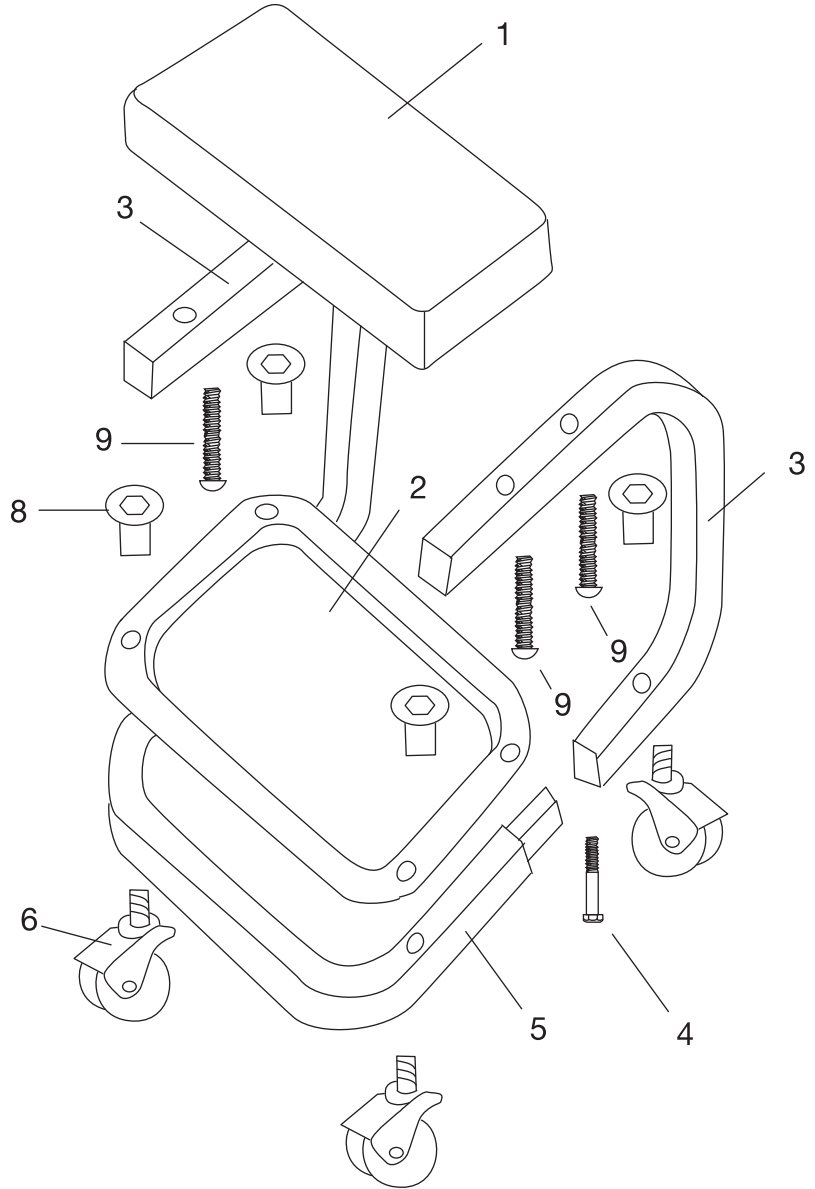

Ref. #	Part #	Description	Qty.
1	RS850701	Seat Pad	1
2.	RS850702	Plastic Tray	1
3.	RS850703	Side Frame	2
4.		Bolt	2
5.	RS850705	Bottom Frame	1
6.	8503	2-1/2" Caster (incl. #8)	4
8.		Hex Nut	4
9.		Bolt	4

Ref #4, 8 & 9 available only as a bolt kit, part #RS8507BK

⚠ WARNING

- Read, study, understand and follow all instructions before using creeper seat.
- Do not exceed 300 lb. load capacity.
- Use only on hard level surface capable of supporting the load and to avoid tipping.
- Do not stand on or use creeper seat as a cart.
- Failure to heed these warnings may result in serious or fatal personal injury and/or property damage

⚠ **WARNING:** This product can expose you to chemicals including nickel which is known to the State of California to cause cancer and birth defects or other reproductive harm.