

# SumoSprings Front

Ford F53 Motor Home, 16k-22k GVWR, 1990-2003

Part #SSF-172-40-2

Drivers Side (Passenger Side Similar)

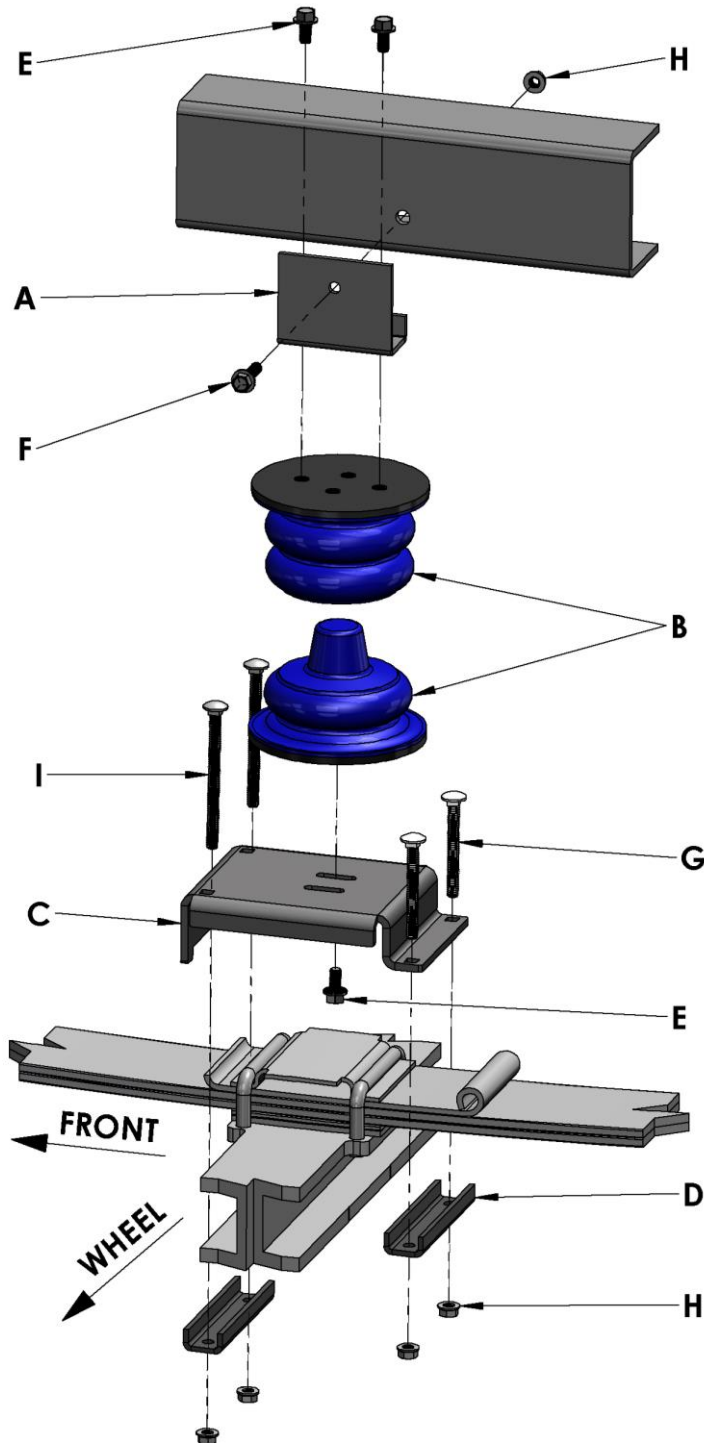

PARTS			
Part #	Description	Quant.	Item
512035	Upper bracket	2	A
511419	SumoSpring	2	B
512034	Lower bracket	2	C
512042	U-bracket strap	4	D
512207	3/8-16 x 3/4" serrated flange hex bolt	6	E
512301	3/8-16 x 1.5" serrated flange hex bolt	2	F
512211	3/8-16 x 3.5" carriage bolts	4	G
512302	3/8-16 Locking flange nut	10	H
5122360	3/8-16 x 5.5" carriage bolts	4	I
512265	3/8-16 x 3 1/2" hex bolt	1	

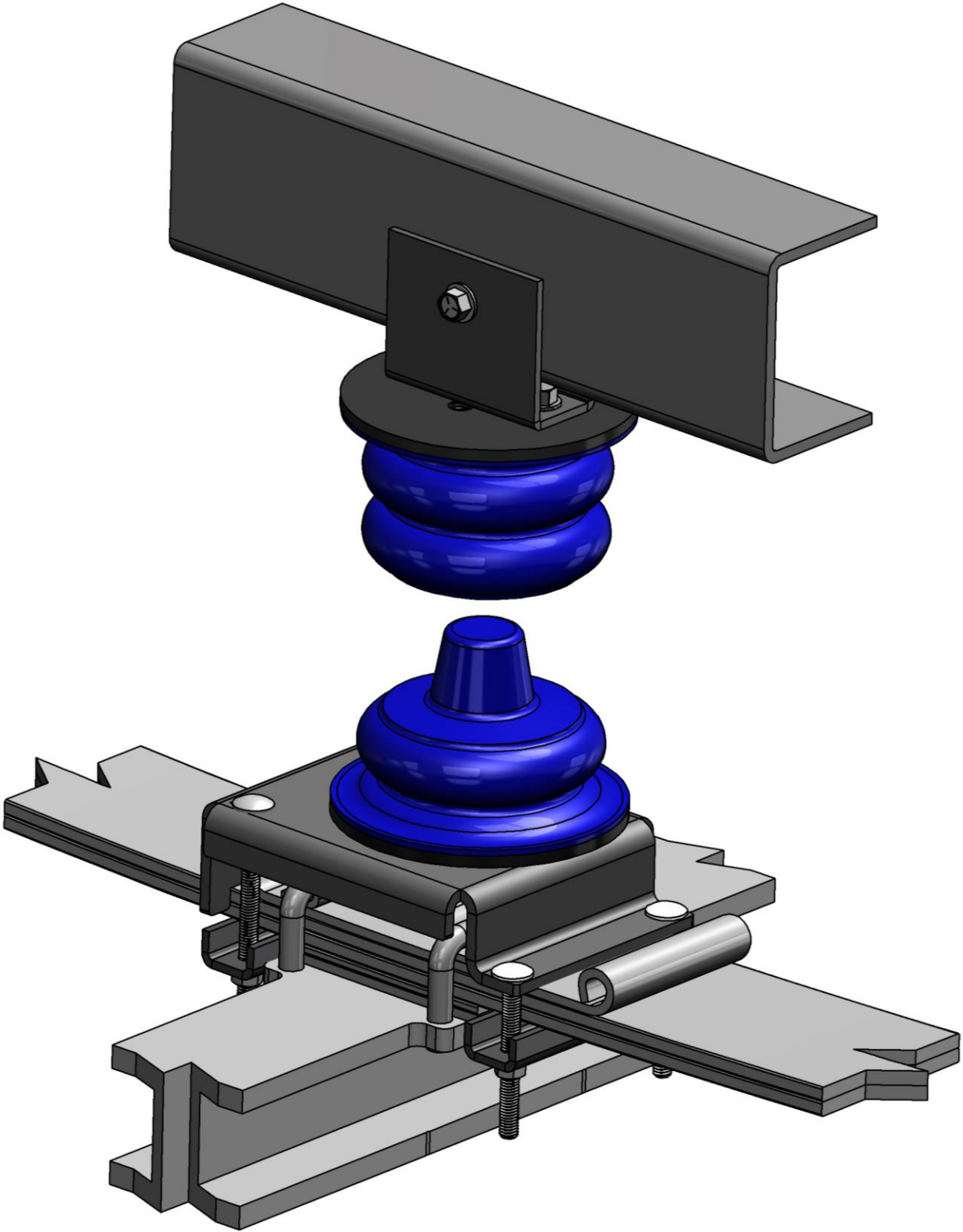

## **Installation Instructions**

- 1) Park vehicle on level hard surface. Engage emergency brake. Place blocks in front and behind rear wheels to prevent rolling. Observe all safety precautions and wear safety glasses.
- 2) Raise front of vehicle using the front leveling jacks to sufficient height to allow the assembly to be installed. Support the frame using safety jack stands.
- 3) Starting on the drivers remove the lower bracket (item C), upper bracket (item A), and SumoSpring (item B) from the box.
- 4) Attach the upper bracket to the top half of the SumoSpring (item B) using two 3/8-16 x 3/4" flanged hex bolts (item E) and set aside.
- 5) While consulting the diagram on page 1, attach the lower bracket to the bottom half of the SumoSpring in the correct orientation using a single 3/8"-16 flanged hex bolt (item E). Please note that the lower bracket attachment utilizes the inside slot closest to the frame.(or furthest from the wheel - see diagram on page 1) **Center the bolt in the adjustment slot and tighten securely.**
- 6) Insert two 3/8"-16 x 3 1/2" and two 3/8"-16 x 5" carriage bolts (item G and I) through the four square openings in the lower bracket as shown on page 1.
- 7) Place the lower assembly on the factory spring-pack ensuring orientation is correct as in pictures on page 2. See exploded diagram on page 1.
- 8) Attach the u-bracket straps (item D) to the carriage bolts using four 3/8" Top-lock nuts (item H).
- 9) Place the upper Sumo/bracket assembly on top of the lower assembly with the upper bracket in correct orientation to the frame.
- 10) Repeat steps 3 through 8 on the passenger's side.
- 11) Jack up the axle until the top J-bracket (item A) seats firmly against the underside of the frame on both driver and passenger side.
- 12) Using the J-bracket as a template drill the holes through the frame, both driver's side and passenger's side, using a 7/16 drill bit then secure the upper assembly to the frame by bolting the upper J-bracket to the chassis frame using a 3/8-16 x 1.25" bolt (item F) and 3/8"-16 Top-lock nut (item H).
- 13) Jack up vehicle, remove safety jack stands.
- 14) Carefully lower vehicle to the hard surface. Remove the blocks in front and back of the rear wheels.
- 15) Release emergency brake.
- 16) Fill out warranty card and send to SuperSprings. The warranty card is on the reverse side of this page.

**Important Notice.**

- 1) For easy installation please read instructions completely first and have all necessary tools available.
- 2) We recommend that this installation be done by a professional or persons with sound mechanical knowledge.
- 3) SumoSprings are designed to work with the original factory springs only. If they have been replaced with aftermarket springs then please consult with Supersprings International.
- 4) These instructions are meant as a guide for the installation of SumoSprings. SuperSprings International assumes no liability for the actual installation process. Installers should apply common automotive safety practices when raising, lowering and working on vehicles.
- 5) SumoSprings are designed to enhance the vehicles load carrying performance and road handling however it does not authorize (or recommend) loading beyond the manufacturer's GVWR specifications.

***To prevent damage to the vehicle and to ensure safety, do not exceed the maximum load recommended by the vehicles manufacturer (GVWR).***

# SumoSprings Front

Suspension Enhancement  
FORD F-53 Chassis Motor Home  
Modification with aftermarket Davis trackbar  
SumoSprings Part #SSF-172/176-40-2



Front Passenger's Side  
SumoSprings



Slot both passenger and drive  
side bottom bracket

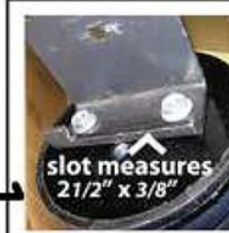

Modify driver's side top  
bracket



Front Driver's Side  
SumoSprings

or slot as  
required

## Passenger Side Installation [with vehicle on the ground]



## Driver Side Installation [vehicle off the ground]



SumoSprings enhance load carrying capability, handling & towing. Never exceed vehicle manufacturer's GVWR rating.

# SumoSprings Front

Suspension Enhancement  
FORD F-53 Chassis Motor Home

SumoSprings Part #SSF-172/176-40-2

Modification with aftermarket Davis trackbar  
for passenger side steering stabilizer bracket



Use 9/16" wrench closed end  
to reach bolt head inside of lower  
channel bracket.

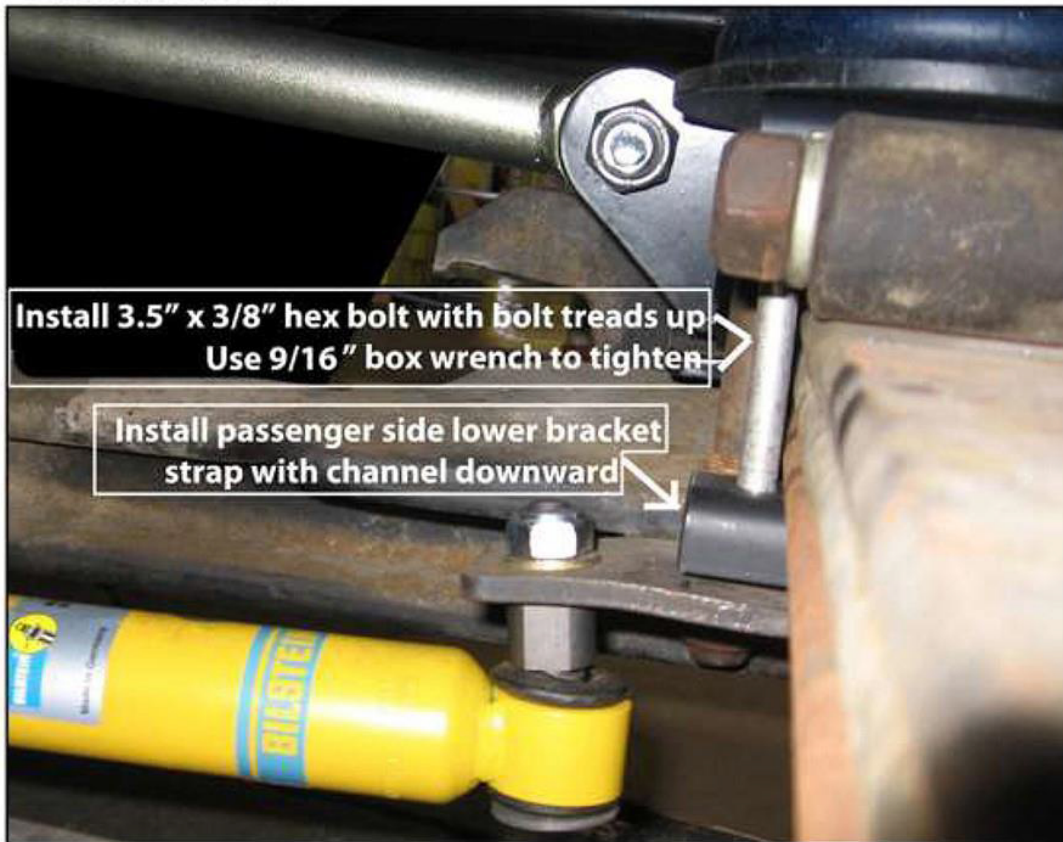

SumoSprings enhance load carrying capability, handling & towing. Never exceed vehicle manufacturer's GVWR rating.