

# ABSTRFK

# TOYOTA

Rear suspension package

## INSTALLATION INSTRUCTIONS

- a) Remove and replace components according to OEM guidelines.
- b) Torque 1/2" fasteners to 75 lb-ft.

### NOTE:

These instructions are not intended to replace OEM guidelines for safe removal and replacement of the OEM fasteners.

*Do not exceed vehicle manufacturer's recommended axle weight rating. Check for AEON<sup>®</sup> interference with vehicle components - Under load AEON<sup>®</sup> will "expand" in diameter.*

Ref. = Reference  
Part = Part #.  
Qty. = Quantity

Ref	Part	Qty
1	F31003-250	2
2	A00515-55P30	2
3	A1602B-003	2
4	F11059-180	4
5	F41034-050	4
6	K10549-003	2
7	F12063-653	2
8	F36005-150	8
9	F40051-080	8
10	K51388-003	2
11	F17U27-150	4

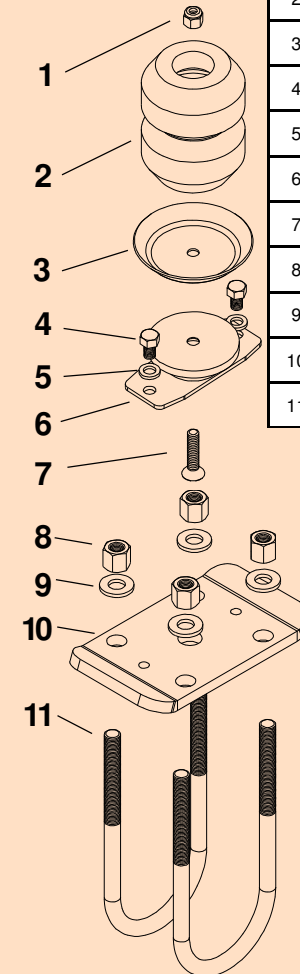

ABSTRFK



## ABSTRFK

TIMBREN INDUSTRIES INC.

PART NUMBER	DESCRIPTION	QTY	LOCATION
F31003-250	NYLOCK LOCKNUT 3/8 UNC GR 5 Z	2	G1B
F12063-653	FHSCS 3/8 x 1-1/2 F/T UNC GR 5 B	2	J2E
F41034-050	WASHER SPLIT LOCK 3/8 GR5 Z	4	G1C
F11059-180	HCS 3/8 x 1/2 UNF GR 8 Z	4	G6D
F36005-150	NUT HI 1/2 UNF x 11/16 LONG GR5 Z	8	P1B
F40051-080	WASHER FLAT 1/2 x 1-1/16 F436 Z	8	P1B
F17U27-150	U-BOLT RND 1/2 UNF x 7-3/4 x 3-1/4 X 3-1/4 GR5 Z	4	O3A

A00515-55P30	Hollow Rubber Spring	2	C5B
--------------	----------------------	---	-----

K51388-003	TIE PLATE PAINTED	2	D17D
K10549-003	ABSTRFK WELDMENT PTD.	2	D17D
A1602B-003	STEEL CUP 3-7/8 od x 13/32 id x 1/2" dp. PTD	2	D21B

B90215	Carton 8.5 x 6.5 x 5	1	A5A
B10000	8" x 12" BUBBLE FOR KITS	1	
B00029-010	BARCODE LABEL FOR KIT	1	
B90121-010	OFFROAD KIT BOX LABEL	1	

### Clearance Instructions:

Rear SES Kits for Pick-Ups and Vans should have a 1/2" to 1-1/2" gap between the rubber spring and contact point when empty.

A partial load, or vehicle accessories will reduce or eliminate the gap.

Front SES kits are usually in full contact.

Medium and Heavy-Duty Trucks, Trailers and Motorhomes will be in constant contact, and have no gap.

### ASSEMBLY NOTES:

**NOTE: PACKAGE F17U27-150 U-BOLTS  
LOOSE IN BOX**