

# FF650UH

# FORD

Front suspension package

## INSTALLATION INSTRUCTIONS

- a) Raise vehicle allowing the axle to hang freely.
- b) Mount Timbren assembly using existing holes & Timbren supplied fasteners.
- c) Lower vehicle.

*Do not exceed vehicle manufacturer's recommended axle weight rating. Check for AEON® interference with vehicle components - Under load AEON® will "expand" in diameter.*

Ref. = Reference  
Part = Part #.  
Qty. = Quantity

Ref	Part	Qty
1	F31052-350	4
2	F40320-020	8
3	F12539-353	2
4	K10502-003	2
5	F11568-380	4
6	A00540-65Q30	2
7	F31051-350	2

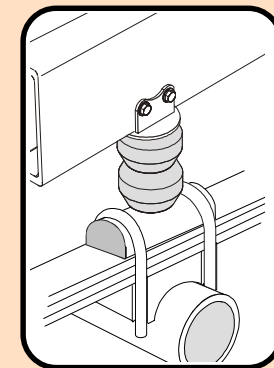
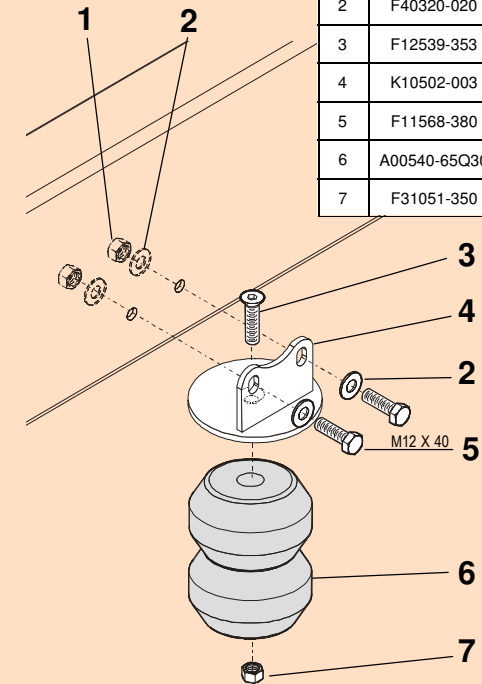

FF650UH **TIMBREN**

## FF650UH

PART NUMBER	DESCRIPTION	QTY	LOCATION
F31052-350	NYLOCK LOCKNUT M12 x 1.75 Gr 8.0 Z	4	H3E
F40320-020	WASHER FLAT M12 GR 4.6 Z	8	H3E
F11568-380	HCS M12 x 40 x 1.75 Gr 10.9 Z	4	G6E
F31051-350	NYLOCK LOCKNUT M10 x 1.50 PGr 8.0 Z	2	I1D
F12539-353	FHSCS M10 x 45 x 1.5 Gr 8.8 B	2	J2B
A00540-65Q30	Hollow Rubber Spring	2	C8B
K10502-003	FF650UH WELDMENT PAINTED	2	D1A
B90200-CF	SMALL FRONT BOX - 9.5 x 7 x 5.5	1	A--E
B10000	8" x 12" BUBBLE FOR KITS	1	
B00029-010	BARCODE LABEL FOR KIT	1	

### Clearance Instructions:

Rear SES Kits for Pick-Ups and Vans should have a 1/2" to 1-1/2" gap between the rubber spring and contact point when empty.

A partial load, or vehicle accessories will reduce or eliminate the gap.

Front SES kits are usually in full contact.

Medium and Heavy-Duty Trucks, Trailers and Motorhomes will be in constant contact, and have no gap.