

FF9000A

FORD

Front suspension package

INSTALLATION INSTRUCTIONS

- Raise vehicle allowing the axle to hang freely.
- Remove existing bump stop located on U-bolt pad & retain fastener.
- Mount Timbren lower bracket using OEM fasteners.
- Assemble Aeon rubber spring and bracket as shown in the adjacent diagram.
- Position Timbren assembly above U-bolt pad on frame & drill through bracket & frame.
- Mount Timbren assembly to frame using 3 Gr.8 bolts of 1/2" diameter
- Lower vehicle.

NOTES:

When removing OEM fasteners, use penetrating fluid.

SAFETY CAUTIONS:

Always refer to and follow the vehicle manufacturer's guidelines when welding or drilling during installation of this kit.

Do not exceed vehicle manufacturer's recommended axle weight rating. Check for AEON® interference with vehicle components - Under load AEON® will "expand" in diameter.

Ref. = Reference
Part = Part #.
Qty. = Quantity

Ref	Part	Qty
1	F12106-253	2
2	K10248-003	2
3	A01525-65G70	2
4	F31005-250	2
5	K10247-003	2

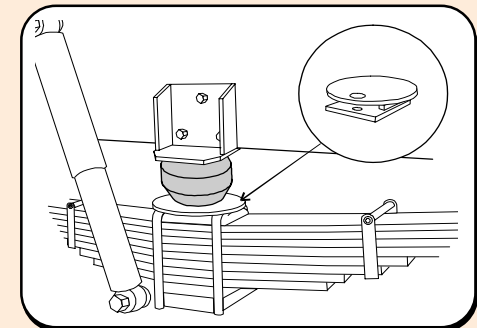
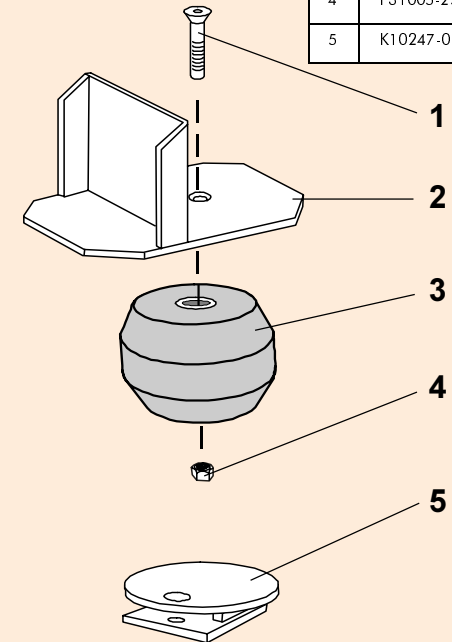

FF9000A



FF9000A

PART NUMBER	DESCRIPTION	QTY	LOCATION
F31005-250	NYLOCK LOCKNUT 1/2 UNC GR 5 Z	2	G1B
F12106-253	FHSCS 1/2 x 2-1/2 UNC GR 5 B	2	J2C
A01525-65G70	Hollow Rubber Spring	2	C18B
K10247-003	FF9000A WELD'T (PAINTED)	2	E3A
K10248-003	FF9000 WELD'T (PAINTED)	2	D14E
B90223	10-3/4 x 9-1/2 x 7 DW Carton	1	A1A
B10100	NEWSPRINT 18" ROLL	1	
B00029-010	BARCODE LABEL FOR KIT	1	

Clearance Instructions:

Rear SES Kits for Pick-Ups and Vans should have a 1/2" to 1-1/2" gap between the rubber spring and contact point when empty.

A partial load, or vehicle accessories will reduce or eliminate the gap.

Front SES kits are usually in full contact.

Medium and Heavy-Duty Trucks, Trailers and Motorhomes will be in constant contact, and have no gap.